

**ENGO
CONTROLS
E901WIFI
Wireless
Internet
Thermostat**



ENGO CONTROLS E901WIFI Wireless Internet Thermostat User Guide

[Home](#) » [ENGO CONTROLS](#) » ENGO CONTROLS E901WIFI Wireless Internet Thermostat User Guide 

Contents

- 1 ENGO CONTROLS E901WIFI Wireless Internet Thermostat
- 2 Product Usage Instructions
- 3 FAQ
- 4 INTRODUCTION
- 5 SAFETY INFORMATION
- 6 INSTALLATION
- 7 Technical specification
- 8 Wall Mounting
- 9 Wiring Diagrams
- 10 Installation of the thermostat in the app
- 11 Pairing process with the receiver
- 12 Installer settings
- 13 Documents / Resources
 - 13.1 References



ENGO CONTROLS E901WIFI Wireless Internet Thermostat



Product Usage Instructions

- Press any button to activate the screen
- Press ‘;’ to enter manual mode (hand icon displayed)
- Use ‘+’ or ‘-’ to set new temperature value
- Confirm with ‘PROG’ or wait for auto-approval
- Press any button to activate the screen
- Press ‘;’ to enter OFF mode (LCD off, no signal sent)
- To exit OFF mode, press ‘;’ again

FAQ

- **Q:** How can I pair the thermostat with the receiver?
- **A:** The devices are pre-paired and ready for use, no additional pairing is required.
- **Q:** Can I control the thermostat remotely?
- **A:** Yes, you can control the heating system remotely via smartphone or tablet using the ENGO Smart / TUYA Smart app.
- **Q:** What network should I use for connection?
- **A:** Use only a Wi-Fi 2.4GHz network for optimal performance.

INTRODUCTION

- The product is a wireless, Wi-Fi room thermostat that enables economical and ecological control of any type of heating.
- The operation of the thermostat is very simple and allows the user to adjust the heating cycle to the user's

rhythm of the day.

- Built-in WiFi module (in the receiver) enables remote control of the heating system via a smartphone or a tablet using the ENGO application Smart / TUYA Smart.
- The devices are pre-paired and ready for work.

Product Compliance

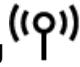
- This product complies with the following EU Directives: 2014/53/EU, 2011/65/EU  868.0 MHz – 868.6 MHz; <13dBm WIFI 2,4 GHz

Please note!

- This document is a brief manual of the installation and operation of the product and highlights its most important features and functions.

SAFETY INFORMATION

- Use in accordance with national and EU regulations.
- Use the device only as intended, keeping it in a dry condition.
- The product is for indoor use only.
- Please read the entire manual, before installation or use.

INSTALLATION

- Installation must be performed by a qualified person with appropriate electrical qualifications, per the standards and regulations in force in a given country and in the EU.
- The manufacturer is not responsible for non-compliance with the instructions.

WARNING: For the entire installation, there may be additional protection requirements, which the installer is responsible for.

Technical specification

Thermostat supply	2 x AA batteries
Receiver supply	230 V AC 50 Hz
Receiver rating max	16 (5) A
Receiver outputs	Voltage-free NO/COM relay
Temperature range	5 – 35°C
Control algorithm	TPI or Histeresis ($\pm 0.25^{\circ}\text{C}$ to $\pm 2.0^{\circ}\text{C}$)
Communication	Wireless, 868 Mhz +WIFI 2,4 GHz
Dimensions [mm]	thermostat: 150 x 84 x 22 receiver: 96 x 96 x 27

Wall Mounting

1. Remove the thermostat cover as shown in the picture. If there are batteries inside, remove them.

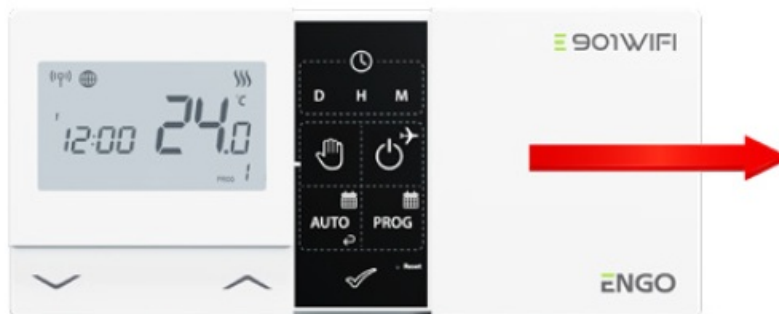

2. Use a screwdriver to push the plastic tabs in as shown in the figure until you feel resistance, and tilt the front part of the housing.



3. Separate the front part from the back part in the direction shown above



4. Use the supplied mounting screws and mount the back cover to the wall (use holes as shown in arrows)

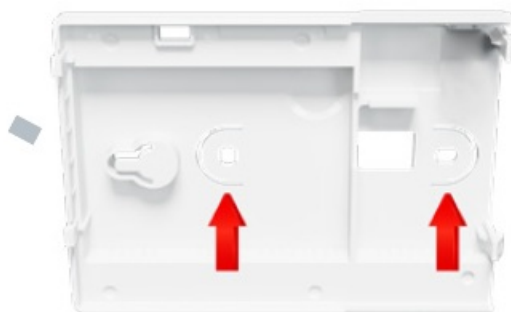

5. Using the hinges on the left, fold the front and back covers together as shown in the picture above until they click into place.



Wiring Diagrams

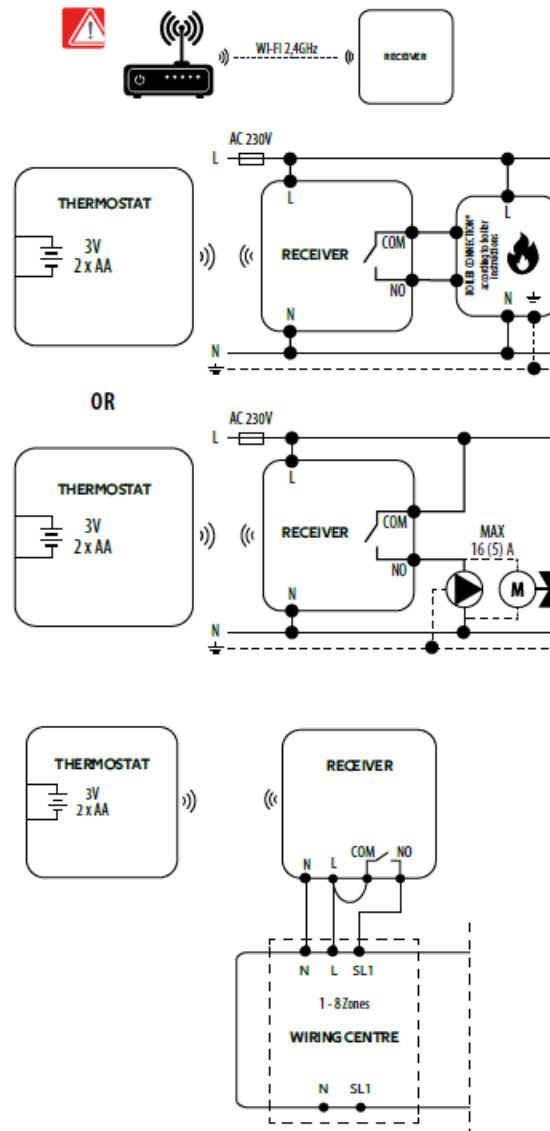

Receiver

Receiver's switch description



	LEFT SWITCH
1.	ON – Manual mode – receiver ON
2.	OFF – Manual mode – receiver OFF
	RIGHT SWITCH
3.	MANUAL – The receiver works in manual mode (according to the left switch)
4.	AUTO – The receiver works in AUTO mode (according to the thermostat's command)

LED indications in the receiver

The status of the receiver is indicated by two LEDs. These are LEDs with the following colors:

1. red (upper one),
 - green (upper one),
 - blue (upper one),
 - pink (upper one),
2. orange (lower one).



A detailed explanation of the meaning of the LEDs





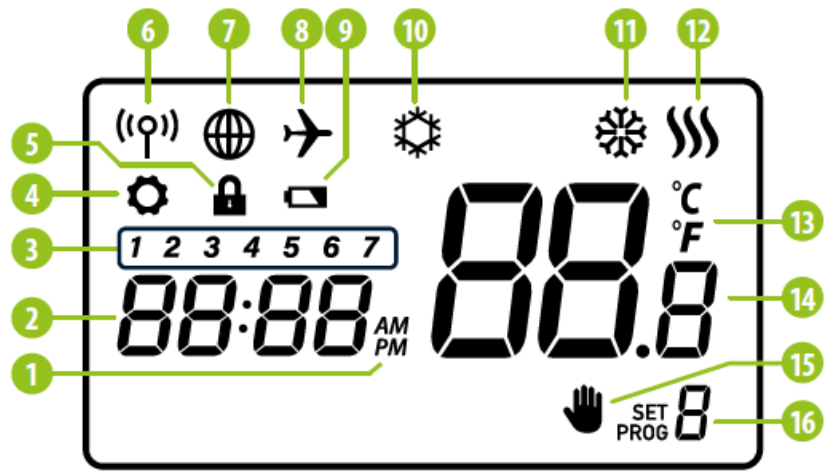



	DESCRIPTION
The red LED flashes	<p>The red LED diode flashes – Receiver and thermostat are prepared for installation in the app.</p> <p>LED always flashes red:</p> <ul style="list-style-type: none"> – immediately after connecting the receiver to the power supply, if the thermostat is not added to the app – after running the parameter“APP”->YES (installer parameters) – after removing the thermostat from the app (device automatically entered pairing mode)
The red LED steady	<p>The red LED is steady – has not been installed in the app and it is working in Offline mode. It means also the app pairing mode timed out (pairing with the app must be done within 10 minutes after enabling pairing mode).</p>
The green LED is solid	The receiver is connected to a router but there is no connection to the Internet (the router is offline)
The green LED flashes	The receiver lost connection with a router (the router is off)
The blue LED is solid	The receiver is connected to a router that has Internet access (the router is online)
The blue LED flashes	The receiver was paired but lost communication with the thermostat due to range or low battery in the thermostat. When the receiver loses communication with the thermostat, it starts flashing after 15 minutes.
The orange LED is a solid	<p>In automatic mode, the receiver receives a heating/cooling signal from the thermostat or</p> <p>the receiver was started in manual mode (left switch ON, right switch MANUAL)</p>
The orange LED flashes	The receiver is in the pairing mode and is looking for a signal from the thermostat (then you must activate the“SYNC” parameter in the thermostat).
The orange LED is off	The receiver does not send a heating/cooling signal.
The pink LED is on	<p>The update process started. To increase the chance of success of the update</p> <ul style="list-style-type: none"> – immediately after the pink diode appears, click any thermostat’s button to turn on backlight

LCD icon description



1. AM/PM
2. Clock
3. Day of the week indicator
4. Settings icon
5. Key lock function
6. Send a signal (pairing)
7. Internet connection
8. Holiday Mode
9. Low battery indicator
10. Antifrost Mode
11. Cooling mode
12. Heating mode
13. Temperature unit
14. Room/setpoint temperature
15. Manual mode/ Temporary override mode
16. Program number

Button description

Button	Function
	Change the parameter value down
	Change the parameter value up
D	Set the day of the week
H	Set the hour
M	Set the minutes
	Manual mode
	OFF mode / Holiday mode
AUTO  	AUTO mode / Back button (to go back - press and hold)
PROG 	Programming / Program selection
	Confirm function
● Reset	Thermostat reboot, time reset

Setting Time / Setting Date

In the online mode,

- the thermostat reads the current time from the application.

In the offline mode

- D/H/M buttons are active and day/time can be set manually

WARNING! For the regulator to work properly in offline mode, you must first set the time.

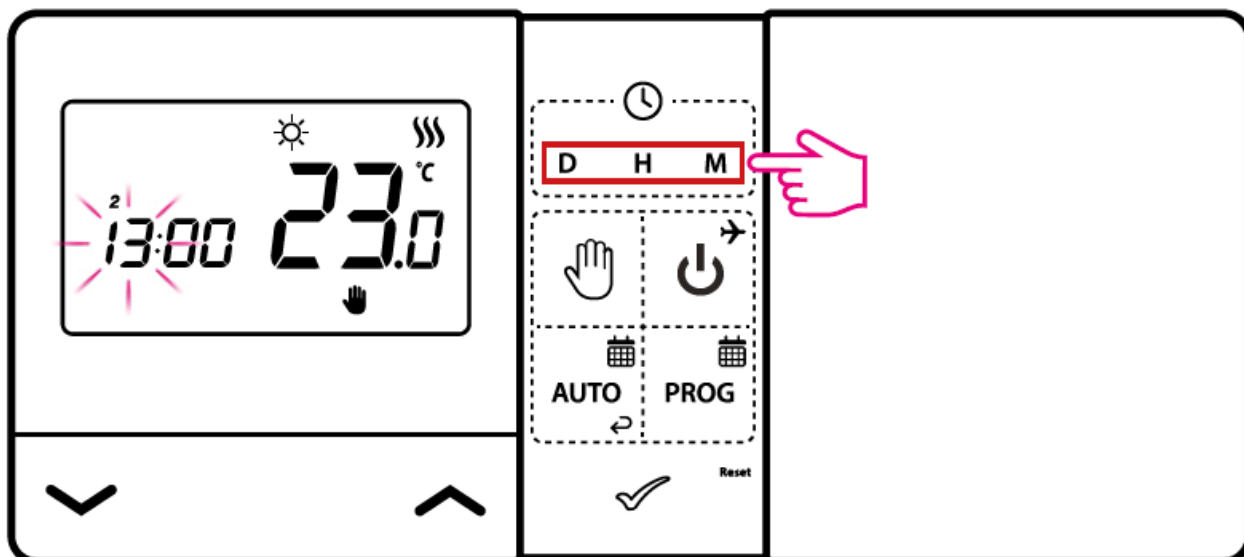

- **D**: Press the D button to set the day
- **H**: Press the H button to set the hour.
- **M**: Press the M button to set the minutes.

Video tutorials



Installation of the thermostat in the app

- Make sure your router is within range of your smartphone.
- Make sure you are connected to the Internet. This will reduce the pairing time of the device. Use only Wi-Fi 2,4GHz network.

STEP 1 – DOWNLOAD ENGO SMART APP

- Download the ENGO Smart app from Google Play or Apple App Store and install it on your smartphone.



Powered By



STEP 2 – REGISTER THE NEW ACCOUNT

- To register a new account, please follow the steps below:

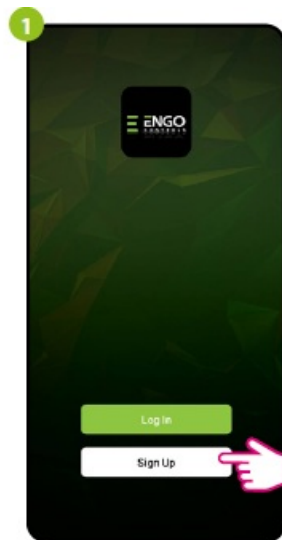

Click „Register” to create new account.

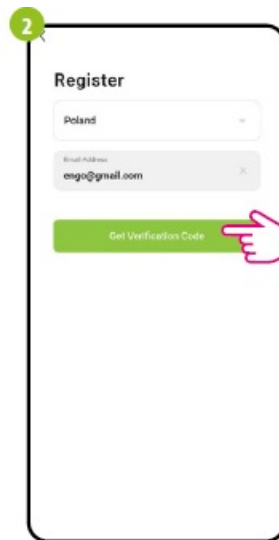

Enter your e-mail address to which the verification code will be sent.

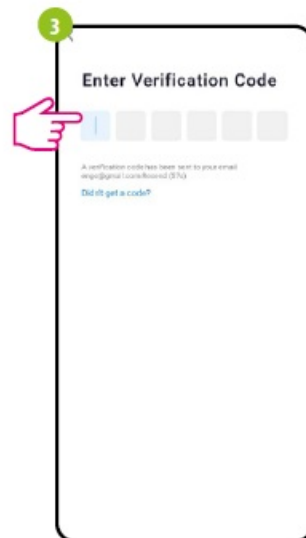

Enter the verification code received in the email. Remember that you only have 60 seconds to enter the code!

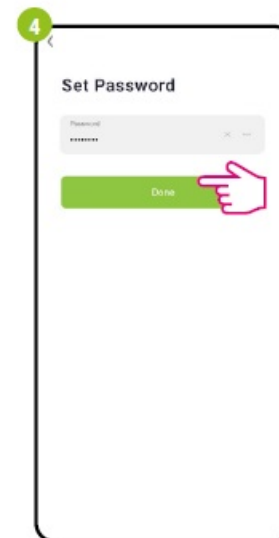

Then set the login password.

STEP 3 – CONNECT THE THERMOSTAT TO WI-FI

- After installing the app and creating an account:



- On your mobile device, make sure the ENGO Smart has access to permissions (Location, Bluetooth, Nearby devices). Then turn on Bluetooth and Location. Connect to the 2.4GHz Wi-Fi network to which you want to assign the device.

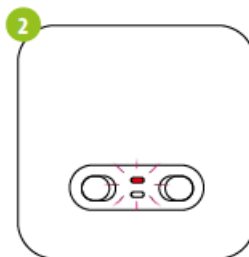

- Connect the receiver to the power supply. When first powered up, the red LED will start flashing, which means that devices are ready to be added to the application. Go to step 7 (adding devices in the app). If the red LED on the receiver is not flashing, proceed with the next steps.

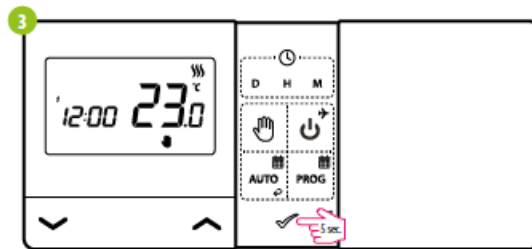

Press and hold ✓ button for 5 seconds.

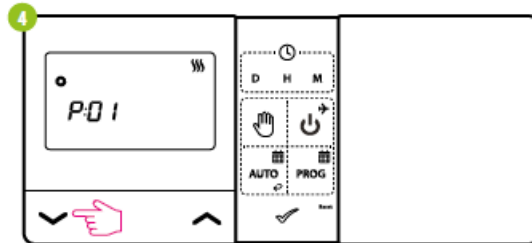

Use ^ or v, button to choose APP
- add to application parameter.

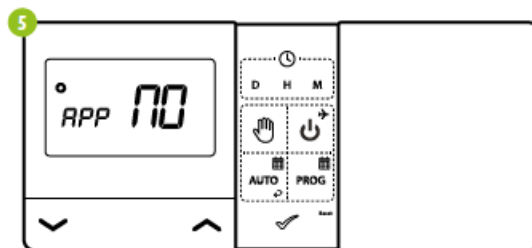

Confirm with ✓ button.

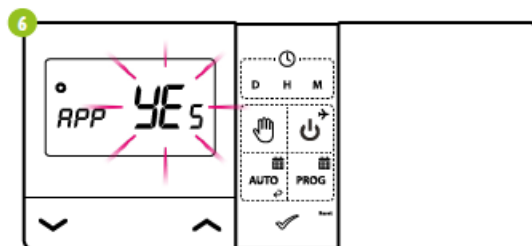

Use ^ or v button to choose YES and confirm with (OK) button
to start the process of adding to the application. ✓.

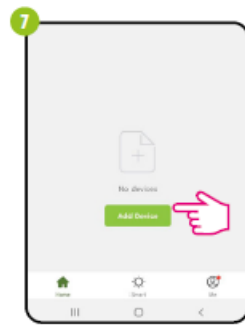

In the app, select:
„Add Device“.

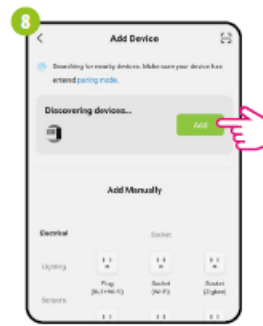

After finding the
thermostat, go „Add“.

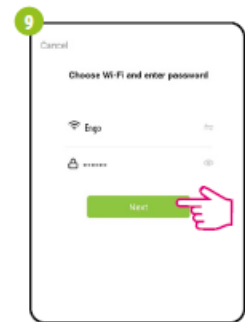

Select the Wi-Fi network in which
the thermostat will operate and
enter the password of this network.

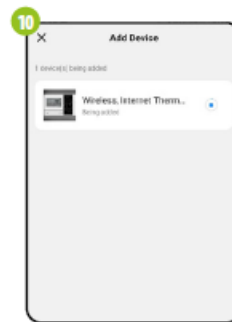

Wait for the app to configure the
thermostat with the selected Wi-Fi
network.

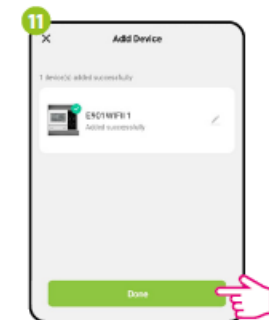

Go „DONE“.

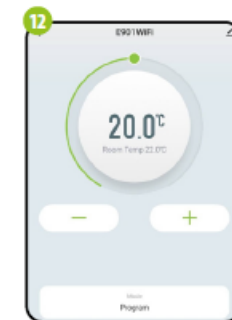

Thermostat has been installed and
displays the main interface.

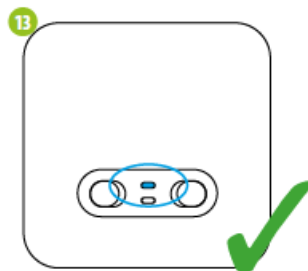

When the blue LED on the receiver will light up, it means the device has been
correctly added to the application and is now connected to the Internet.

Pairing process with the receiver

PLEASE NOTE! THE THERMOSTAT IS ALREADY PAIRED WITH THE RECEIVER

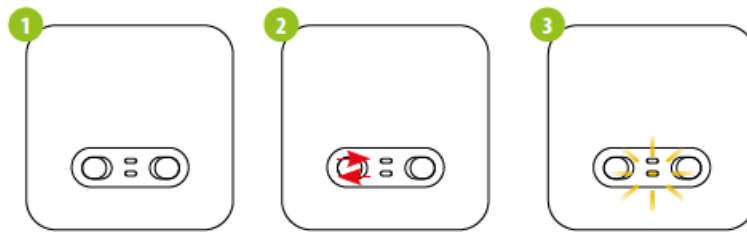

If you want to repair the receiver and thermostat with each other and then add it to the application, make sure that the receiver is disconnected from the power supply, and the switches on it are in the ON and AUTO positions. Then connect the receiver to the power supply and wait a few seconds. Next, move the left switch to the OFF position and back to the ON position with a quick motion. The orange LED will start blinking, which will confirm that the receiver has entered the pairing mode.

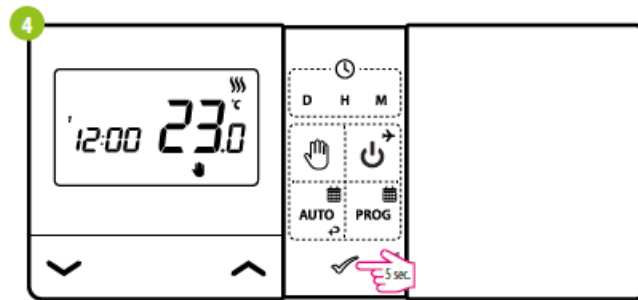

Press and hold the ✓ button for 5 seconds.

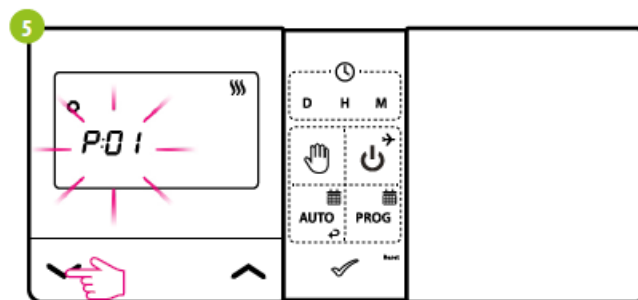

Use ^ or v, button to select SYNC parameter.

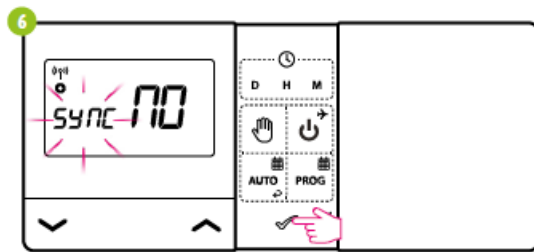

Confirm with ✓ button.

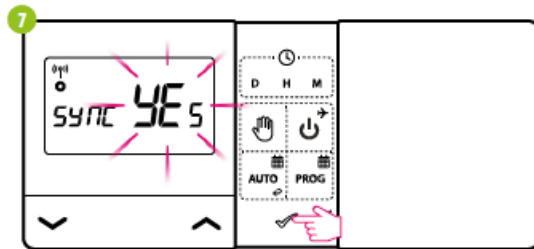

Using ^ or v buttons choose YES and start the pairing process on a new frequency by pressing the button ✓.

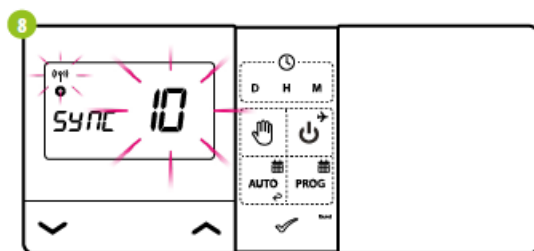

- The thermostat started to send a signal to find the receiver (the symbol of the blinking antenna) and started the countdown with the number 10 (min). The pairing process may take up to 10 minutes.

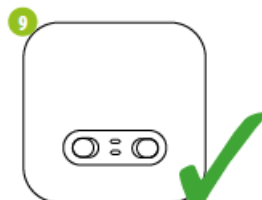

- When the orange LED stops blinking, the devices have been paired on a new frequency.

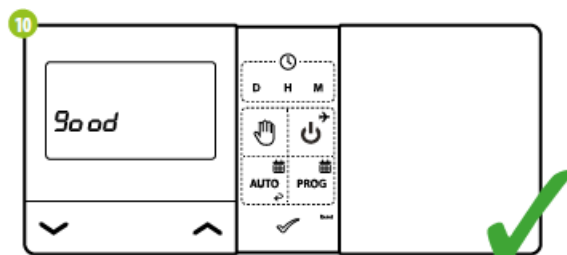

- The thermostat will display the message „good”, which means that the devices are successfully paired with each other. The thermostat will return to the next APP parameter in the service menu (adding to the application).
- You can skip this step and return to the main menu by clicking the (OK) button a few times.

WARNING! If the orange LED on the receiver has not stopped blinking after 10 minutes, repeat the pairing process taking into account the distance between devices, obstacles, and interference.

Installer settings

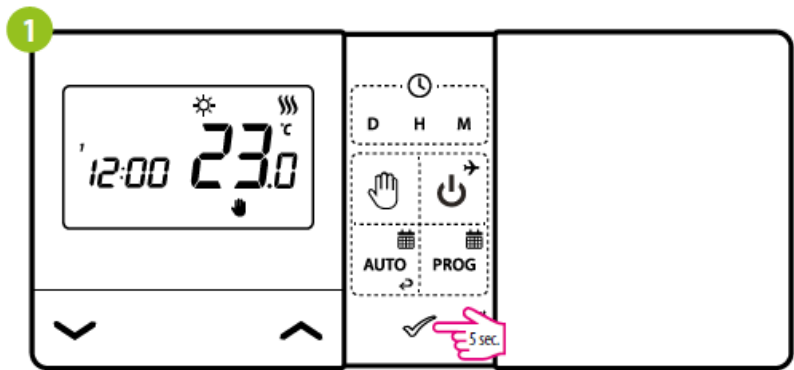

To enter installer parameters press and hold ✓ button for 5 secon

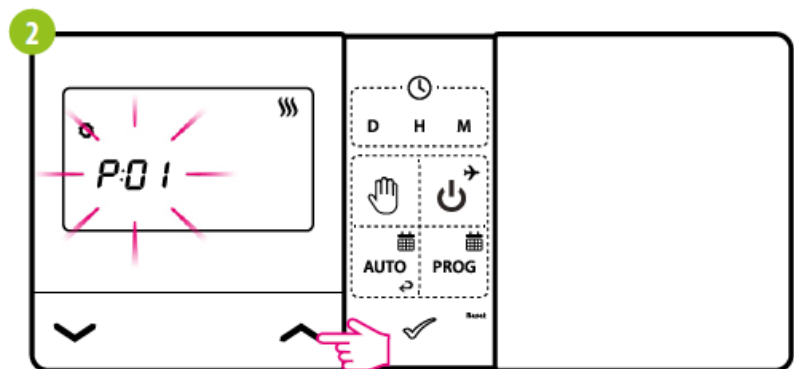

Use ^ or v . button to move between parameters.
Enter the parameter by ✓ . Edit the parameter using ^ or v .
Confirm the new parameter value with the ✓ button.

Installer parameters

Pxx	Function	Value	Description	Default v alue
P01	Heating/Cooling Selection		Cooling	
			Heating	
P02	Control algorithm	1	SPAN ±0,25°C	1
		2	SPAN ±0,5°C	
		3	TPI for Underfloor Heating	
		4	TPI for Radiators	
		5	TPI for Electrical Heating	
		6	SPAN ±1,0°C	
		7	SPAN ±1,5°C	

		8	SPAN $\pm 2,0^{\circ}\text{C}$	
P03	Offset temperature	-3.5°C to $+ 3.5^{\circ}\text{C}$	If the thermostat indicates the wrong temperature, you can correct it by $\pm 3.5^{\circ}\text{C}$	0°C
P04	Relay type	NO	Normally Open type of relay	NO
		NC	Normally Closed type of relay	
P05	Clock format	24h	24 hour	24h
		12h	12 hour	
P06	Minimum setpoint	$5^{\circ}\text{C} - 20^{\circ}\text{C}$	Minimum heating/cooling is a temperature that can be set	5°C
P07	Maximum setpoint	$20^{\circ}\text{C} - 35^{\circ}\text{C}$	Maximum heating/cooling the temperature that can be set	35°C
P08	Key sound	NO	Key sound Off	YES
		YES	Key sound On	
P09	PIN Code	NO	Disabled	NO
		PIN	Enabled	
P10	Require a PIN to unlock the keys every time	NO	Function disabled	YES
		YES	Function enabled	
SYNC	Pairing with the receiver function	NO	Function disabled	NO
		YES	Function enabled	
APP	Pairing with the application function	NO	Function disabled	NO
		YES	Function enabled	
CLR	Clear settings factory reset	NO	No action	NO
		YES	Factory Reset	

Powered By



Producer

- Engo Controls sp z o.o. sp. k. Rolna 4 St. 43-262 Kobielice Poland
- www.engocontrols.com

Documents / Resources

	ENGO CONTROLS E901WIFI Wireless Internet Thermostat [pdf] User Guide E901WIFI, E901-TXWIFI, E901-RXWIFI, E901WIFI Wireless Internet Thermostat, E901WIFI, Wireless Internet Thermostat, Internet Thermostat, Thermostat
--	--

References

- [ENGO Controls - Sterowanie ogrzewaniem](#)
- [User Manual](#)

Manuals+, Privacy Policy

This website is an independent publication and is neither affiliated with nor endorsed by any of the trademark owners. The "Bluetooth®" word mark and logos are registered trademarks owned by Bluetooth SIG, Inc. The "Wi-Fi®" word mark and logos are registered trademarks owned by the Wi-Fi Alliance. Any use of these marks on this website does not imply any affiliation with or endorsement.