

Enerlites HET06A-J Preset In Wall Countdown Timer Instruction Manual

[Home](#) » [ENERLITES](#) » Enerlites HET06A-J Preset In Wall Countdown Timer Instruction Manual 

Contents

- [1 Enerlites HET06A-J Preset In Wall Countdown Timer](#)
- [2 Product Information](#)
- [3 Product Usage Instructions](#)
- [4 SPECIFICATIONS](#)
- [5 DESCRIPTION AND FEATURES](#)
- [6 WIRING DIRECTIONS](#)
- [7 SETTING/ OPERATING](#)
- [8 WARRANTY INFORMATION](#)
- [9 Documents / Resources](#)
 - [9.1 References](#)
- [10 Related Posts](#)

Enerlites®

Enerlites HET06A-J Preset In Wall Countdown Timer



Product Information

The HET06A-J is a timer switch with 6 preset time buttons and 1 Manual ON button. It is designed to replace a standard light or fansingle pole switch and can work with most common lighting types. This timer switch is ideal for use in closets, pantries, garages, laundry rooms, outdoor lighting, and spas.

- **Specifications**

- Seven-button Preset Time Switch
- **Time Delay:** 1, 5, 10, 15, 20, and 30 minutes
- Use Copper wires ONLY

Wiring Directions

1. Turn the power off at the circuit breaker before installing the Timer.
2. Read and understand these instructions before installing. It is recommended that a qualified electrician performs this installation.
3. Make sure to turn off the circuit breaker or fuse(s) and ensure power is off before wiring the device.
4. Connect the BLACK wire on the switch to the HOT wire.
5. Connect the RED wire on the switch to the LOAD wire.
6. Connect the GREEN wire on the switch to the GROUND wire.

Product Usage Instructions

Preset Buttons

- The LED indicator will blink twice to confirm each button press.
- There are 6 buttons with preset times of 1 Min, 5 Mins, 10 Mins, 15 Mins, 20 Mins, and 30 Mins.
- Press the desired time once to turn the Load on for that selected amount of time.
- When the time expires, the Load will automatically turn off.
- Press the button with the desired time once to restart the countdown with the newly selected time.

Manual ON Button

- The LED indicator will blink twice to confirm each button press.
- The Manual ON button is the large button located below the preset buttons.
- Press and release the Manual ON button to turn the Load ON with the last selected timer preset.
- Press and release the Manual ON button again within 8 seconds to override the timer and turn the Load OFF.
- The Load will turn ON and stay ON. The timer WILL NOT turn the Load OFF.
- Press and release the button with the desired time once to keep the Load on for that selected amount of time.

LED Light

- The LED indicator light next to each selected button blinks twice each time it is pressed to mark the time selected.

SPECIFICATIONS

- Voltage120VAC, 60Hz
 - Load(Single Pole Circuit)
- Tungsten.....800W
- Electronic Ballast.....800VA
- Resistive.....6.4A
- Motor 1/4Hp
- Time Delay.....1,5,10,15,20,30minutes
- Humidity.....95% RH, non-condensing
- Operation Temperature..... 32° F–131° F

DESCRIPTION AND FEATURES

DESCRIPTION

- The HET06A-J is a timer switch with 6 preset time buttons and 1 Manual ON button.
- All Loads connect to this timer will automatically turn OFF when the selected time expires.
- The 6 selectable times are 1 Min, 5 Mins, 10 Mins, 15 Mins, 20 Mins, 30 Mins.

FEATURES

- Seven-button Preset Time Switch
- Time Delay
 - 1, 5, 10, 15, 20, 30 minutes
- Replace a standard light or fan single pole switch
- Work with most common lighting types
- Ideal for closet, pantry, garage, laundry room, outdoor lighting and spa.

WARNING: Turn the power off at the circuit breaker before installing the Timer.

Read and understand these instructions before installing. It is recommended that a qualified electrician performs this installation. Make sure to turn off the circuit breaker or fuse(s) and make sure power is off before wiring the device.

“Caution: High Voltage-Disconnect power supply before servicing”

This device is intended for installation in accordance with the National Electric Code and local regulations. Use Copper wires ONLY.

WIRING DIRECTIONS

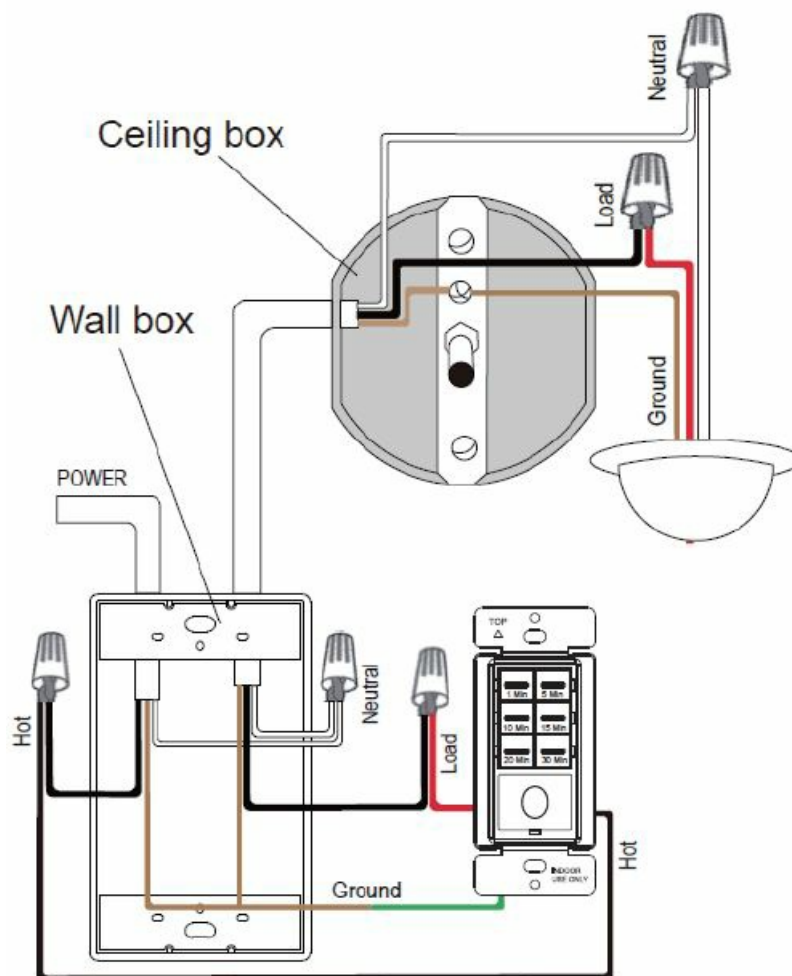

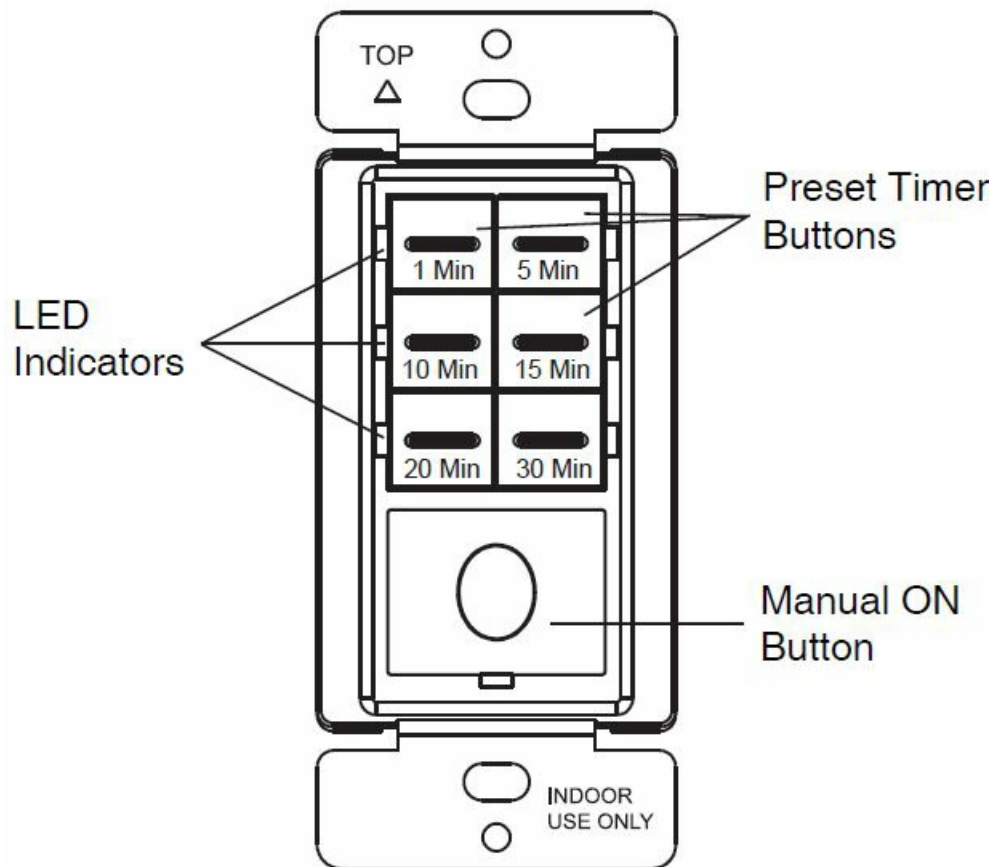

1. Connect the BLACK wire on the switch to the HOT wire.
2. Connect the RED wire on the switch to the LOAD wire.
3. Connect the GREEN wire on the switch to the GROUND wire.

SETTING/ OPERATING

- **Preset Buttons:** The LED indicator will blink twice to confirm each button press. There are 6 buttons with preset times of 1 Min, 5 Mins, 10 Mins, 15 Mins, 20 Mins, 30 Mins.
- While the Load is OFF, press and release the button with the desired time once to turn the Load on for that selected amount of time.
 - When the time expires, the Load will automatically turn off.
- While the Load is ON, press and release the button with the desired time once to restart the countdown with the newly selected time.
- **Manual ON Button:** The LED indicator will blink twice to confirm each button press. The Manual ON button is the large button located below the preset buttons.
- While the Load is OFF, press and release the Manual ON button to turn the Load ON with the last selected timer preset.
- While the Load is ON, press and release the Manual ON button to override the timer and turn the Load OFF.
- To hold the Load ON: Press and hold the Manual ON button for 8 seconds. The Load will turn ON and stay ON. The timer WILL NOT turn the Load OFF.
 - Press and release the Manual ON button to turn the Load OFF.
 - Press and release the button with the desired time once to keep the Load on for that selected amount of time.
- **LED Light:** the LED indicator light next to each selected button blinks twice each time it is pressed to mark the

time selected.

WARRANTY INFORMATION

This device is warranted to be free of material and workmanship defects for 2 years from the date of purchase. Original receipt or proof of purchase from an authorized retailer must be presented upon warranty claim. ALL claims must be verified and approved by Enerlites, Inc. Warranties from other Enerlites products may vary. This warranty is nontransferable and does not cover normal wear and tear or any malfunction, failure, or defect resulting from misuse, abuse, neglect, alteration, modification, or improper installation.

To the fullest extent permitted by the applicable state law, Enerlites shall not be liable to the purchaser or end user customer of Enerlites products for direct, indirect, incidental, or consequential damages even if Enerlites has been advised of the possibility of such damages. Enerlites' total liability under this or any other warranty, express or implied, is limited to repair, replacement or refund. Repair, replacement or refund are the sole and exclusive remedies for breach of warranty or any other legal theory.

© 2021 Enerlites Inc.
CA, U.S.A.
WWW.ENERLITES.COM
0205210182
REV 20230802

Documents / Resources

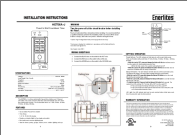
	Enerlites HET06A-J Preset In Wall Countdown Timer [pdf] Instruction Manual HET06A-J Preset In Wall Countdown Timer, HET06A-J, Preset In Wall Countdown Timer, In W all Countdown Timer, Wall Countdown Timer, Countdown Timer, Timer
---	--

References

- [🔗 Homepage - Enerlites - Electrical Supplier](#)
- [User Manual](#)