

Enerlites HET06-J 4 Hr 7 Button Countdown Timer Switch Instruction Manual

[Home](#) » [ENERLITES](#) » Enerlites HET06-J 4 Hr 7 Button Countdown Timer Switch Instruction Manual 

Contents

- [1 Enerlites HET06-J 4 Hr 7 Button Countdown Timer Switch](#)
- [2 Product Information](#)
- [3 Product Usage Instructions](#)
- [4 SPECIFICATIONS](#)
- [5 FEATURES](#)
- [6 WARRANTY INFORMATION](#)
- [7 Documents / Resources](#)
 - [7.1 References](#)

Enerlites®

Enerlites HET06-J 4 Hr 7 Button Countdown Timer Switch

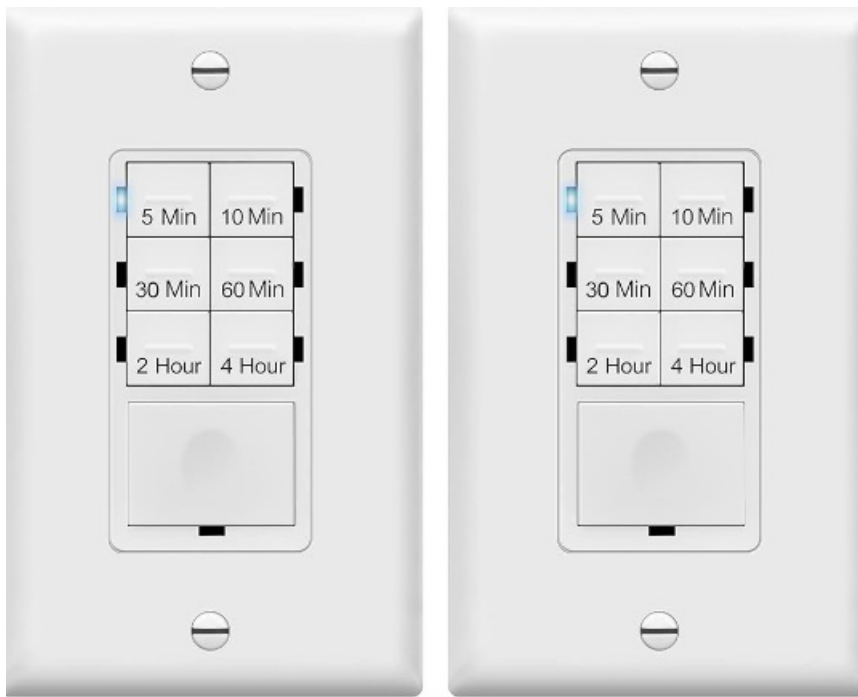

Product Information

Model	HET06-J
Name	Preset In-Wall Countdown Timer

Specifications

Features	LED Indicators, Preset Timer Buttons, Manual ON Button
Preset Times	5 Min, 10 Mins, 30 Mins, 60 Mins, 2H, 4H

Warranty Information

For warranty information, please visit www.enerlites.com

Product Usage Instructions

1. Before installing the Timer, turn off the power at the circuit breaker.
2. Read and understand the instructions before installing. It is recommended to have a qualified electrician perform the installation.
3. Ensure the circuit breaker or fuse(s) are turned off and the power is off before wiring the device.
4. **Caution:** High Voltage – Disconnect power supply before servicing.
5. This device is intended for installation in accordance with the National Electric Code and local regulations.
6. Use Copper wires ONLY for wiring.

7. Wiring Directions

- Connect the BLACK wire on the switch to the HOT wire.
- Connect the RED wire on the switch to the LOAD wire.
- Connect the GREEN wire on the switch to the GROUND wire.

8. Setting/Operating

- **Preset Buttons:** The LED indicator will blink twice to confirm each button press. There are 6 buttons with preset times of 5 Min, 10 Mins, 30 Mins, 60 Mins, 2H, 4H.
- Press and release the Manual ON button to turn the Load OFF.
- Press and release the button with the desired time once to keep the Load on for that selected amount of time.
- **LED Light:** The LED indicator light next to each selected button blinks twice each time it is pressed to mark the time selected.

Note: Always refer to the user manual for complete instructions and safety guidelines.

SPECIFICATIONS

- Voltage 120VAC,60Hz Load(Single Pole Circuit)
- Tungsten.....800W
- Electronic Ballast800VA
- Resistive.....6.4A
- Motor 1/4Hp
- Time Delay.....5, 10, 30, 60 minutes, 2H, 4H
- Humidity.....95% RH, non-condensing
- Operation Temperature..... 32° F–131° F

DESCRIPTION

The HET06-J is a timer switch with 6 preset time buttons and 1 Manual ON button. All Loads connect to this timer will automatically turn OFF when the selected time expires. The 6 selectable times are 5 Min, 10 Mins, 30 Mins, 60 Mins, 2H, 4H.

FEATURES

- Seven-button Preset Time Switch
- Time Delay 5, 10, 30, 60 minutes, 2H, 4H
- Replace a standard light or fan single pole switch
- Work with most common lighting types
- Ideal for closet, pantry, garage, laundry room, outdoor lighting and spa.

WARNING

Turn the power off at the circuit breaker before installing the Timer.

- Read and understand these instructions before installing. It is recommended that a qualified electrician performs this installation. Make sure to turn off the circuit breaker or fuse(s) and make sure power is off before wiring the device.
- **“Caution: High Voltage-Disconnect power supply before servicing”**
- This device is intended for installation in accordance with the National Electric
- Code and local regulations.

- Use Copper wires ONLY.

WIRING DIRECTIONS

1. Connect the BLACK wire on the switch to the HOT wire.
2. Connect the RED wire on the switch to the LOAD wire.
3. Connect the GREEN wire on the switch to the GROUND wire.

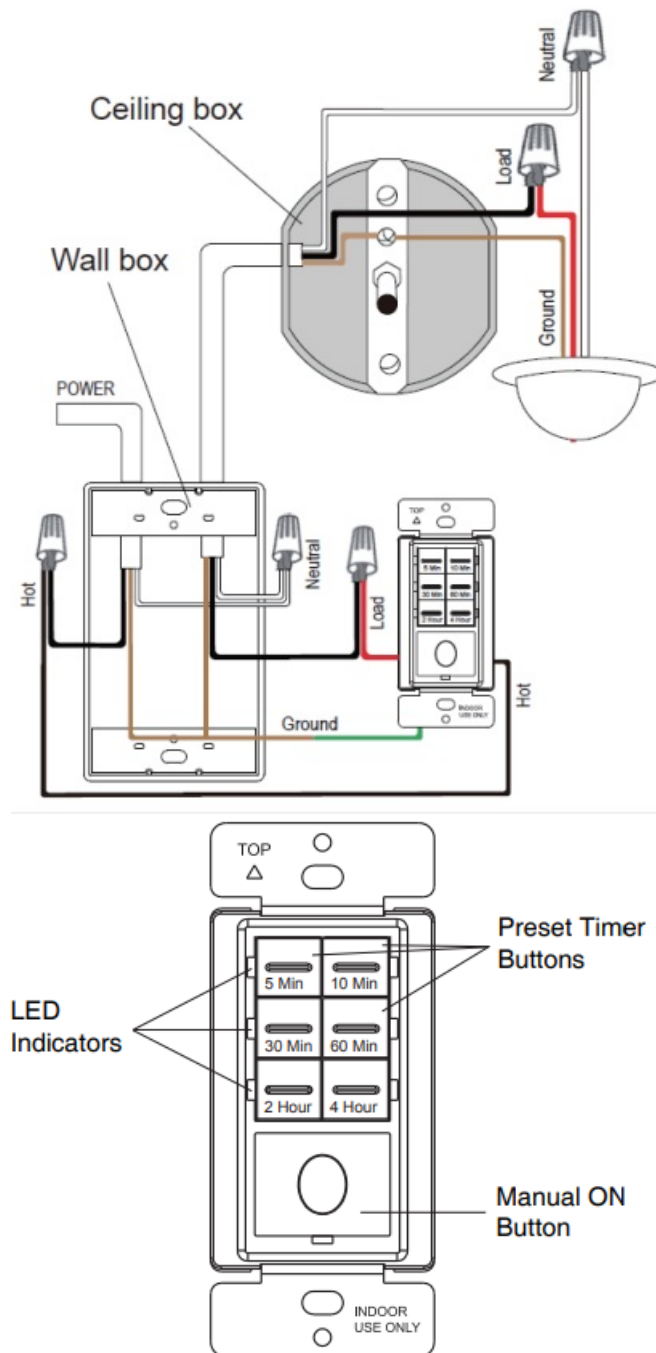

SETTING/ OPERATING

- **Preset Buttons:** The LED indicator will blink twice to confirm each button press. There are 6 buttons with preset times of 5 Min, 10 Mins, 30 Mins, 60 Mins, 2H, 4H.
- While the Load is OFF, press and release the button with the desired time once to turn the Load on for that selected amount of time.

- When the time expires, the Load will automatically turn off.
- While the Load is ON, press and release the button with the desired time once to restart the countdown with the newly selected time.
- **Manual ON Button:** The LED indicator will blink twice to confirm each button press. The Manual ON button is the large button located below the preset buttons.
- While the Load is OFF, press and release the Manual ON button to turn the Load ON with the last selected timer preset.
- While the Load is ON, press and release the Manual ON button to override the timer and turn the Load OFF.
- **To hold the Load ON:** Press and hold the Manual ON button for 8 seconds. The Load will turn ON and stay ON. The timer WILL NOT turn the Load OFF.
 - Press and release the Manual ON button to turn the Load OFF.
 - Press and release the button with the desired time once to keep the Load on for that selected amount of time.
- **LED Light:** the LED indicator light next to each selected button blinks twice each time it is pressed to mark the time selected.

WARRANTY INFORMATION

This device is warranted to be free of material and workmanship defects for 2 years from the date of purchase. Original receipt or proof of purchase from an authorized retailer must be presented upon warranty claim. ALL claims must be verified and approved by Enerlites, Inc. Warranties from other Enerlites products may vary. This warranty is nontransferable and does not cover normal wear and tear or any malfunction, failure, or defect resulting from misuse, abuse, neglect, alteration, modification, or improper installation. To the fullest extent permitted by the applicable state law, Enerlites shall not be liable to the purchaser or end user customer of Enerlites products for direct, indirect, incidental, or consequential damages even if Enerlites has been advised of the possibility of such damages. Enerlites' total liability under this or any other warranty, express or implied, is limited to repair, replacement or refund. Repair, replacement or refund are the sole and exclusive remedies for breach of warranty or any other legal theory.

- © 20 Enerlites Inc. CA, U.S.A.
- WWW.ENERLITES.COM
- 0212300154-01
- REV 20230802

Documents / Resources

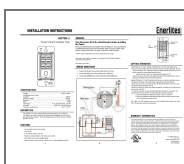

[Enerlites HET06-J 4 Hr 7 Button Countdown Timer Switch](#) [pdf] Instruction Manual
HET06-J 4 Hr 7 Button Countdown Timer Switch, HET06-J, 4 Hr 7 Button Countdown Timer Switch, Countdown Timer Switch, Timer Switch

References

- [🔗 Homepage - Enerlites - Electrical Supplier](#)
- [User Manual](#)

Manuals+.