



## Energizer Indoor Fixed Camera EIX1-1002 User Guide

[Home](#) » [Energizer](#) » Energizer Indoor Fixed Camera EIX1-1002 User Guide 



## Contents

- [1 GETTING STARTED](#)
- [2 CONNECT THE DEVICE](#)
- [3 INSTALLATION](#)
- [4 LIVE VIEW CONTROLS](#)
- [5 RECORDING CONTROLS](#)
- [6 PLAYBACK CONTROLS](#)
- [7 VOICE ACTIVATION](#)
  - [7.1 Voice Activation for Alexa](#)
  - [7.2 Voice Activation for the Google Assistant](#)
- [8 LEGAL & WARRANTY](#)
- [9 TROUBLESHOOTING](#)
- [10 Documents / Resources](#)
- [11 Related Posts](#)

## GETTING STARTED

Thank you for choosing the Energizer Smart Camera. This quick start guide will help you with setup and installation.

### Package Includes:

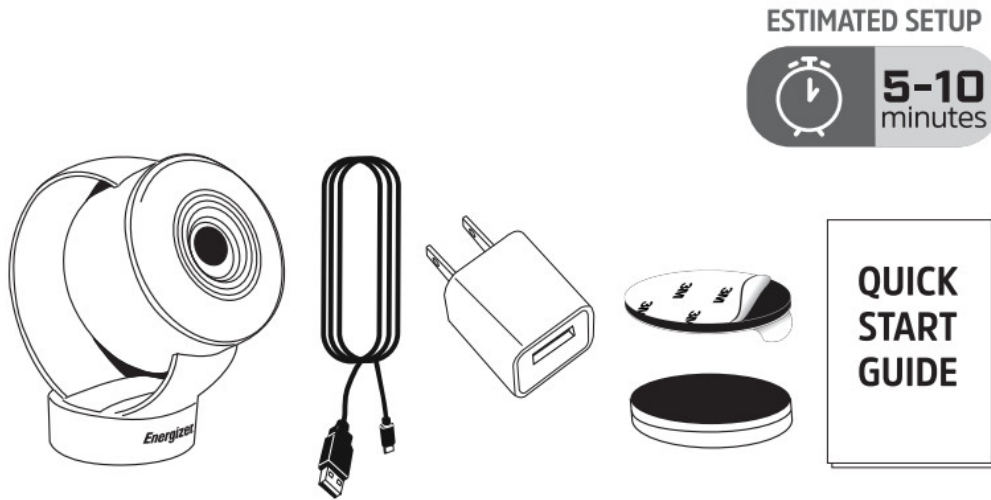

- Smart Camera
- 6ft Cable
- USB Power Adapter
- Magnet
- Double-Sided Tape
- Quick Start Guide

### What You Need:



**App**



2.4GHz



5GHz



**2.4GHz WiFi**



Before setup, make sure your phone is connected to the 2.4GHz WiFi network that your device will be placed on.

You may also need to turn on location and & Bluetooth to find nearby networks.



## CONNECT THE DEVICE

### STEP 1

Download the free Energizer. Connect app from the App Store (for iPhones) or Google Play Store (for Android phones).

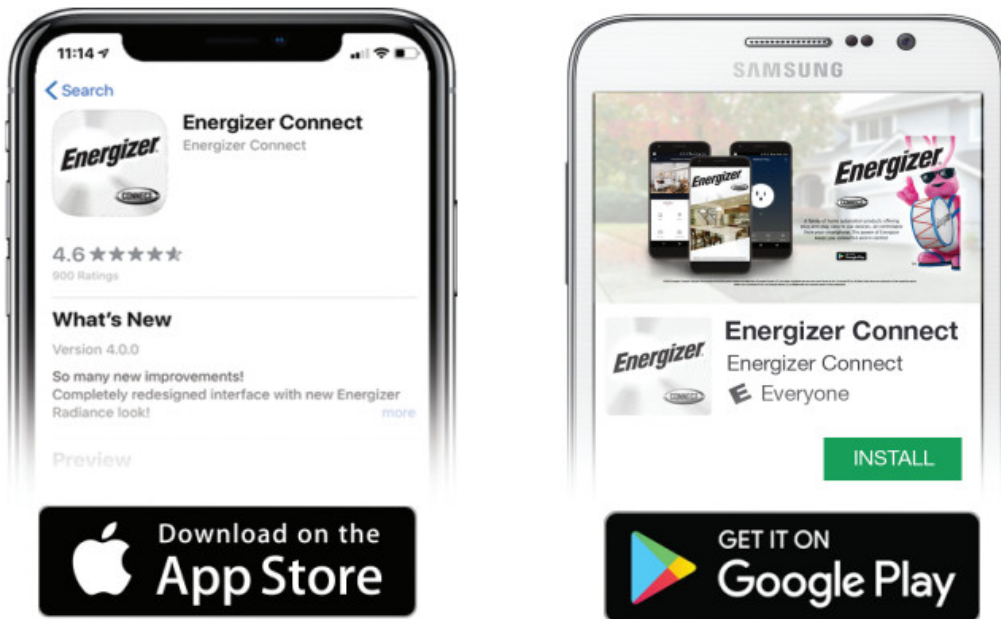

### STEP 2

Make sure your mobile device is connected to your 2.4GHz Wifi network.

Open the app and click "Create Account" by following the on-screen instructions.

After your initial sign-in, your app will remember your password and log you in automatically. You can also choose to manually log out under Settings in the Main menu.

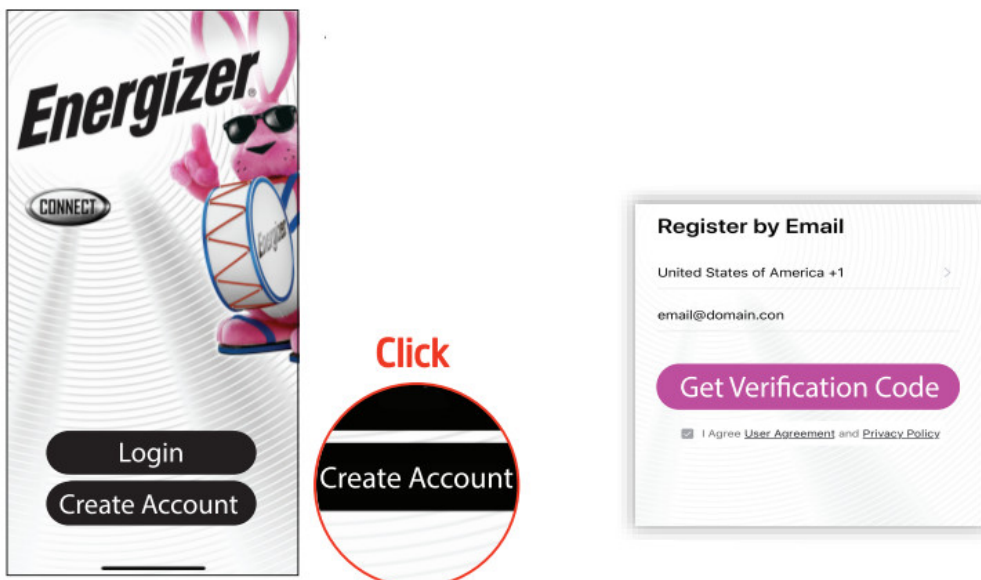

You may need to check your Spam Lil folder for the verification code

### STEP 3

Plug the camera into a wall outlet using the provided 6-foot cable and USB power adapter.



The indicator light on the camera should start blinking RED for pairing mode.  
The camera will also make a chime sound, letting you know it has started up.

LED Behavior		Device Status
Red	Blinking	Pairing Mode
	Solid	Starting Up
Blue	Blinking	Attempting to Pair
	Solid	Connected

If the LED is not blinking, then you are not in pairing mode. Reset the camera by using your finger to hold down this button for 5 seconds until you hear the camera make a chime sound.

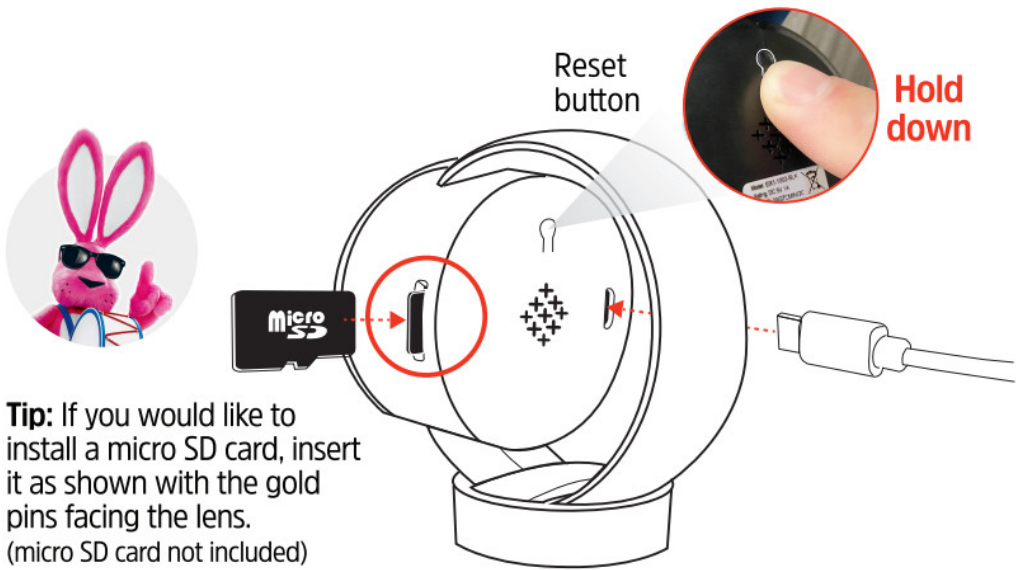

**STEP4**

After logging in, click “+” on the top right of the screen and select “Add device”.

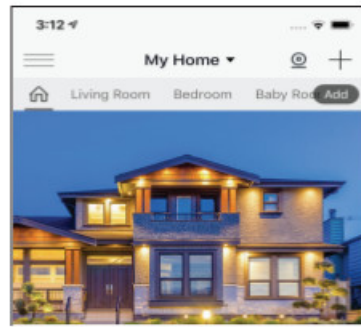

Click

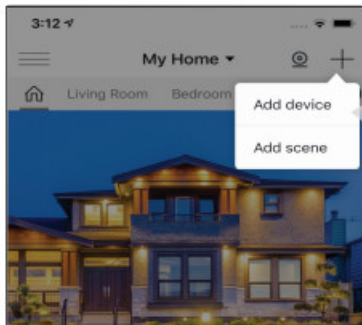
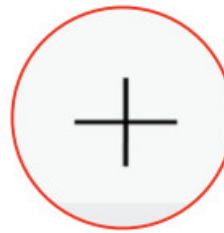

Select

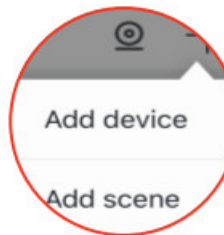

## STEP 5

Select the Camera category and confirm the indicator light is still blinking red. Click "Next Step".



**Help:** Switch between pairing modes.  
See troubleshooting page 13.

Select

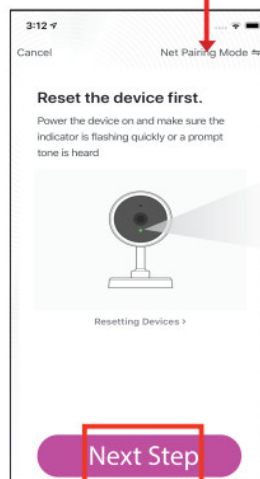
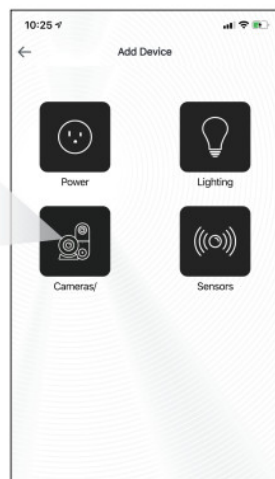

Click

Confirm



## STEP 6

Confirm that the displayed WiFi network is your 2.4GHz WiFi network, enter your WiFi password and click "Confirm".



## Confirm WiFi

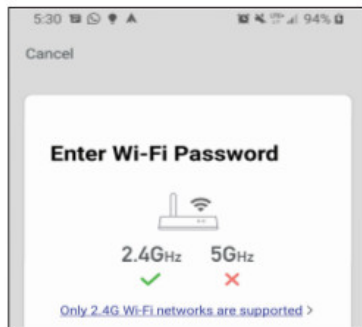

## Enter and Click

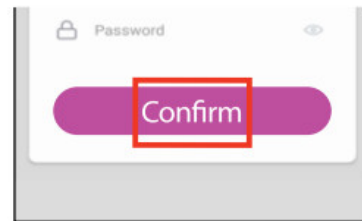

 **Help:** If you need information about **2.4GHz WiFi** networks, click the link to go to our Connect FAQs on our website.

### STEP7

On the next screen, a QR Code will appear.

Position your camera to scan this QR code on your phone.

Click "Continue" when you are ready. Touch the lens of the camera directly against the QR code on your phone and slowly move the camera away.



Once you hear an audible prompt from the camera, click the "I Heard a Prompt" button.



Click



Click

Once you hear an audible prompt from the camera, click the “I Heard a Prompt” button.



Tip: If you don't hear the prompt, try pairing using EZ mode. Take a look at troubleshooting on page 13.

## STEP 8

Your Smart Camera will now be connected to the network. Confirm the settings for your device and then click “Done”.

**TIP:** You can put your camera directly in a room by selecting one of the available rooms. Click the e button to change the name of the product.



## PROCESSING TIME

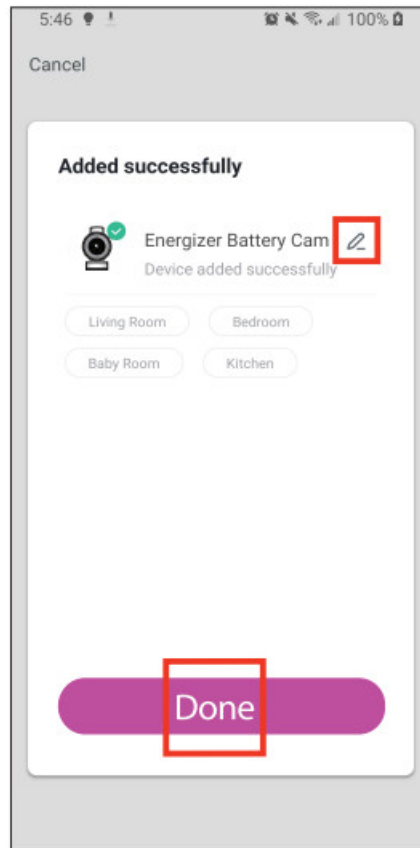
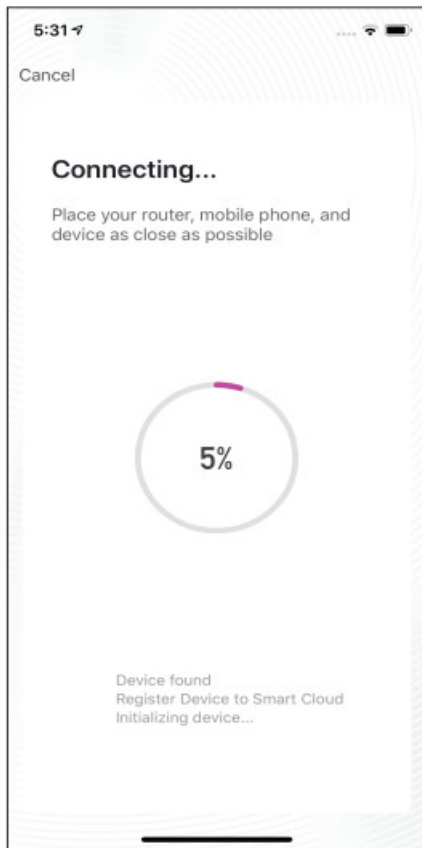

**Click**

Your Energizer, Smart Camera is now ready to use. You can now view the camera remotely and receive mobile alerts. We hope you enjoy using your Energizer,, Smart Camera. For frequently asked questions and instruction videos, please visit our website at [www.energizerconnect.com](http://www.energizerconnect.com).

## INSTALLATION

### STEP 1

Remove adhesive back from magnet mount.



surface.

**NOTE:** For best mounting “results first clean placement area with a clean cloth and rubbing alcohol. Place adhesive with one attempt. Reapplying multiple times will not guarantee secure mounting onto the

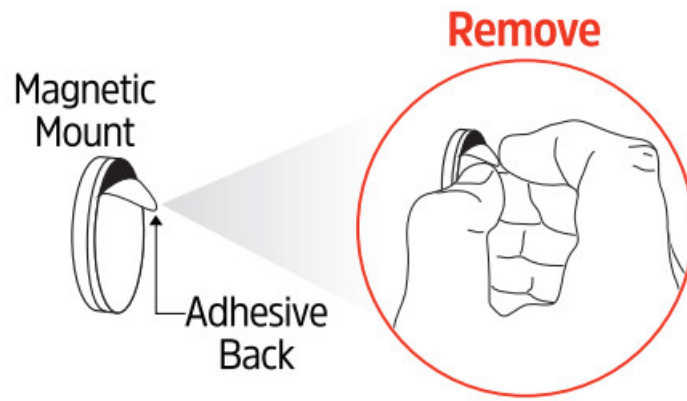

### STEP 2

Firmly place the magnet on the wall. Hold it tightly against the wall for 5 seconds to help create a good bond. For best bonding results, let the magnet sit on the wall for at least 10 minutes before attaching the camera.



### STEP 3

Place camera base directly onto magnet mount.

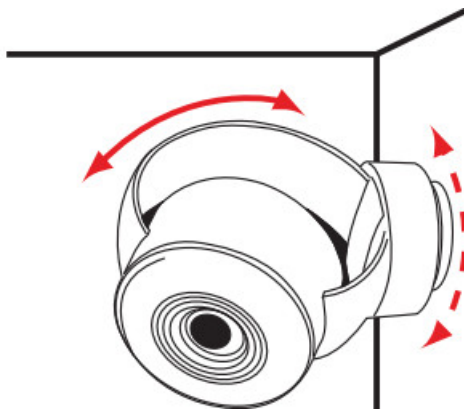

Manually rotate for best viewing angle.

### LIVE VIEW CONTROLS

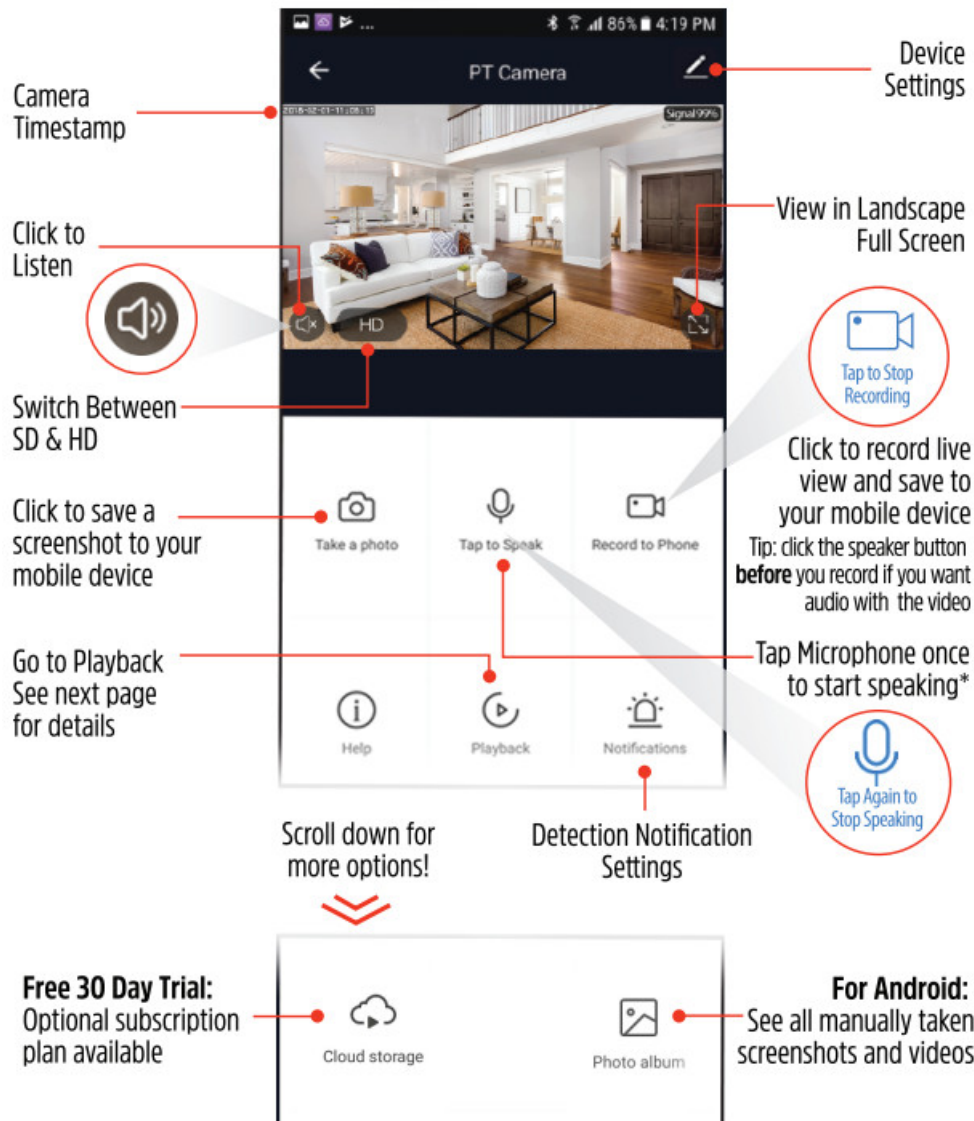

By default, when you click to turn off your microphone, the speaker will automatically turn on. This way once you are done speaking, you can immediately hear a response!  
 You won't be able to turn the microphone and speaker on at one time. See Troubleshooting on page 14 for more details.

## RECORDING CONTROLS

How to turn on Event (Motion) Triggered Recordings that save to the microSD card in the camera.

### STEP 1

Click the icon in the top right of the live view screen to enter Device Settings.



### STEP 2

Scroll down and click "Storage Settings".



**Click**



If you don't see the Storage settings take out the micro SD card (not included) from the camera and make sure it is inserted properly.

### STEP 3

Switch on the local recording switch to enable recording to your SD card.

### STEP 4

Select "Event Recording" to enable recording to your SD card when motion is detected.

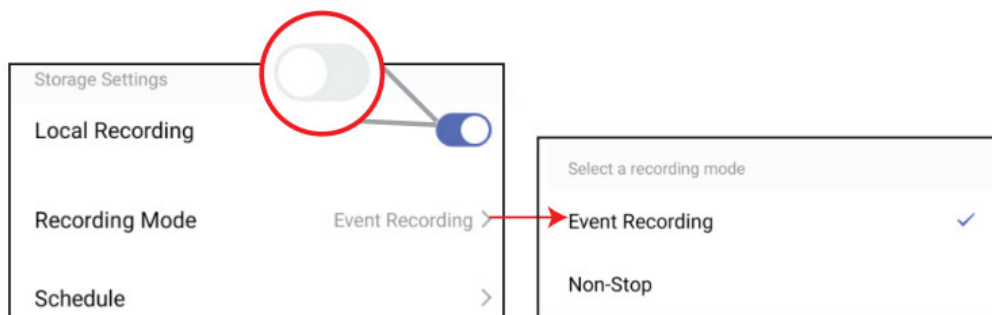

**Tip:** You can also set schedules for when you want recordings to be enabled. Enabling Event Recording will allow you to select individual recordings triggered by motion in the Playback Controls.

## PLAYBACK CONTROLS

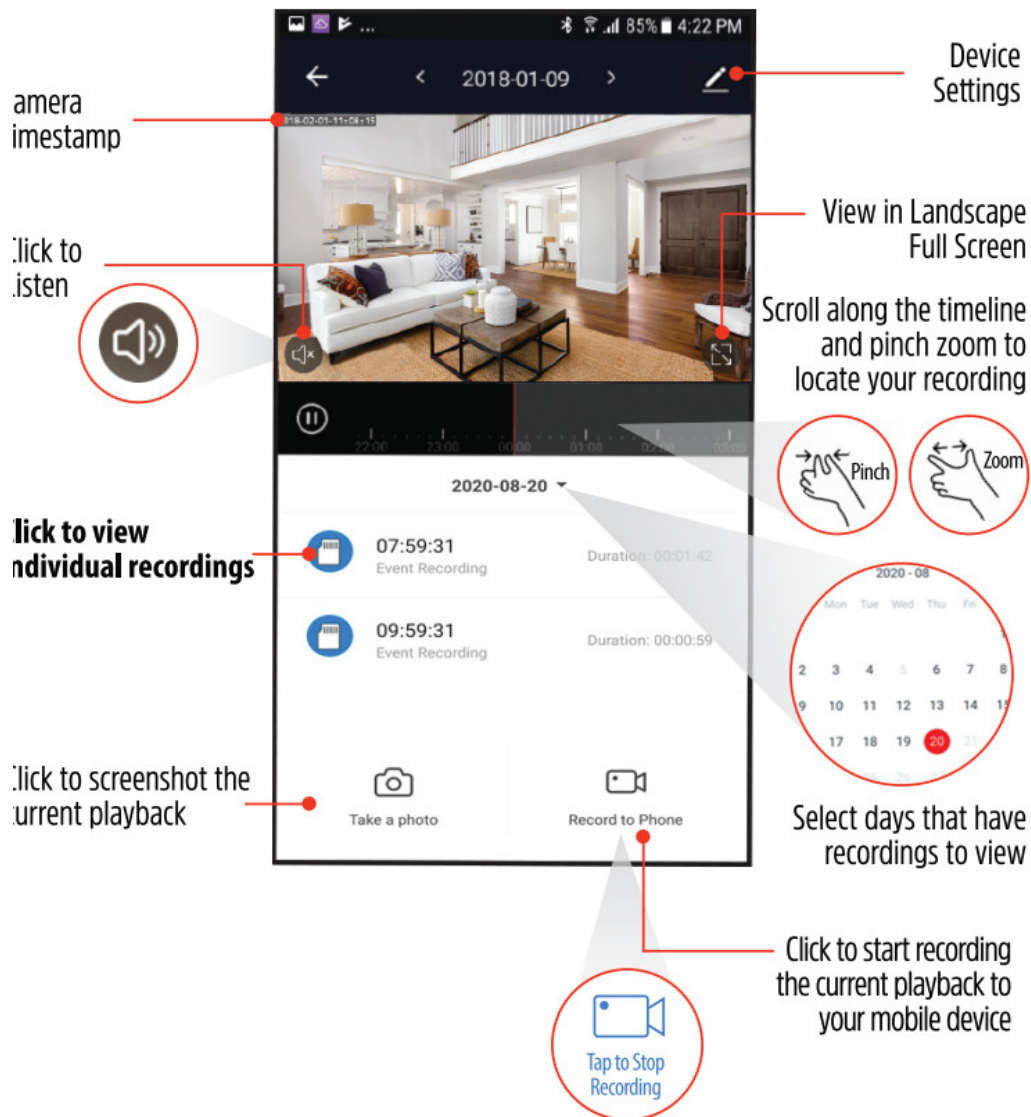

**Tip:** Click the speaker button before you record if you want audio with the video.

## VOICE ACTIVATION

To enable voice access for your Smart Camera, you will need to link the Energizer, Connect skill with your choice of voice assistant.

### Voice Activation for Alexa

Make sure your Alexa device is installed and set up first.

#### STEP 1

Open your Alexa app.

#### STEP 2

Open the menu to search for "Skills".

#### STEP 3

Search for & choose Energizer, Connect.

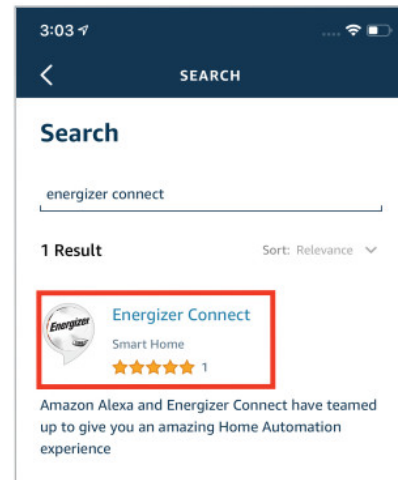
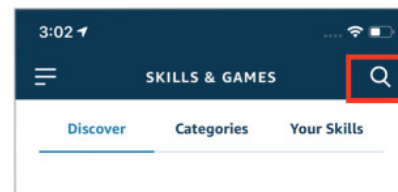
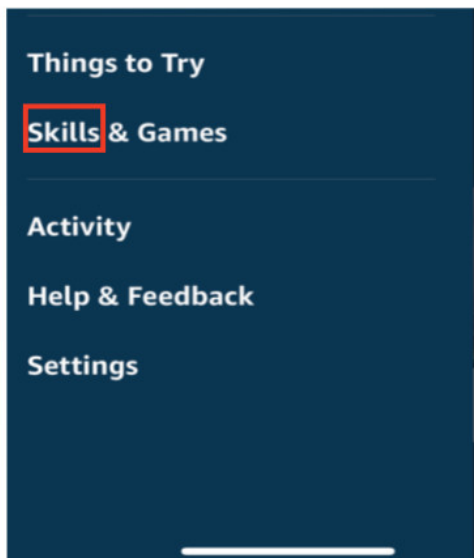

#### STEP4

Authorize your account with the Alexa skill using the username and password from your Energizer, Connect app.

#### STEP 5

Using the name you assigned your camera, you can ask Alexa to turn on/off your camera.

Ex: "Alexa, show me the kitchen camera".

#### Voice Activation for the Google Assistant

Make sure your Google Assistant device is installed and set up first.

#### STEP 1

Open your Google Home app.

#### STEP 2

Click the "+" to add a new device.

#### STEP 3

Click "Set up device".

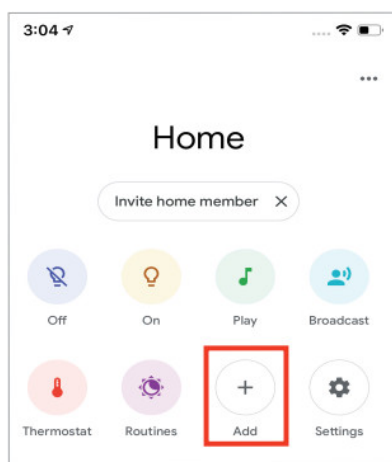

Click

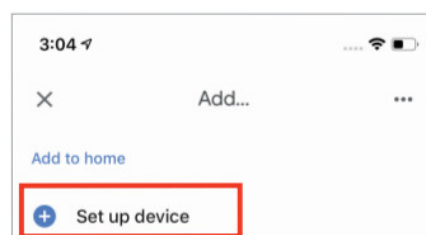

Click

#### STEP4

Click "Have something already set up?"

#### STEP 5

Search for & choose Energizer, Connect.

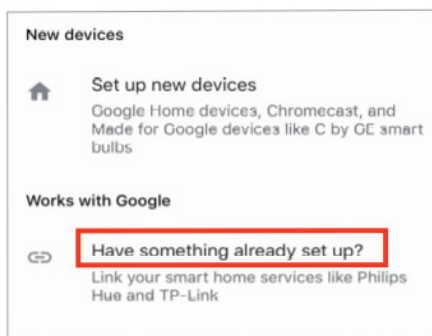

**Click**

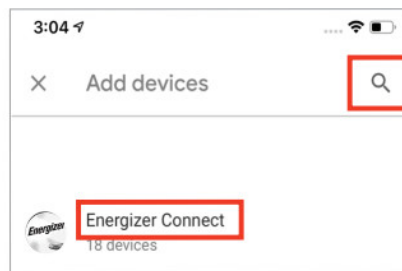

**Choose**

## STEP 6

Authorize your account with the Google Assistant skill using the username and password from your Energizer, Connect app.

## STEP 7

Using the name you assigned your camera, you can ask the Google Assistant to turn on/off your camera. Ex: "Ok Google, show me the kitchen camera".

## LEGAL & WARRANTY

To see Warranty information and Certification Legal warnings, please see our website. [www.energizerconnect.com](http://www.energizerconnect.com)

©2020 Energizer. Energizer, Energizer Bunny design, and certain graphic designs are trademarks of Energizer Brands, LLC, and related subsidiaries and are used under license by Jem Connected IOT, Inc. All other brand names are trademarks of their respective owners. Neither Jem Connected IOT, Inc. nor Energizer Brands, LLC is affiliated with the respective owners of their trademarks.

Apple and the Apple logo are trademarks of Apple Inc., registered in the U.S. and other countries.

App Store is a service mark of Apple Inc.

Google, Android, and Google Play are trademarks of Google LLC.

Amazon, Alexa, and all related logos are trademarks of Amazon.com, Inc. or its affiliates.

## TROUBLESHOOTING

### HAVING TROUBLE WITH SETUP?

**Don't return this product to the retailer, we're here to help**

Please call us at 888-693-4189 or visit [www.energizerconnect.com](http://www.energizerconnect.com) for video tutorials, updated manuals, and more FAQs for your device.

**My device won't connect to my network!**

1. Make sure you are connected to your 2.4 GHz networks and your device is blinking red before you start trying to connect your device.
2. You may need to reset your device if you are having trouble.  
Check out page 2 for the location of your device's reset button.
3. To allow the app to locate the network, you may need to allow permissions for location and turn on your Bluetooth
4. If you are not certain what type of network you have, contact your Internet Service Provider and ask them to create a separate, dedicated 2.4GHz network. You can also do this manually in your router's settings.
5. Try moving to a spot closer to your router for connecting.



6. You can also purchase a WiFi extender to increase your WiFi range and strength.
7. In some cases, you can try using the secondary pairing mode by clicking “Net Pairing Mode” on the Add Device screen (see bottom of page 3). Follow the on-screen instructions.

My device says it's already bound when I try to connect it!

1. When you get the ALREADY BOUND screen, click the blue link to send us an Unbind Request. We can assist you further from the in-app Help Center.

When my camera is pointed at a window at night, I can't see through the glare!

1. At night, the camera's IR LEDs will turn on automatically to provide night vision when it gets dark. IR light reflects off of the glass. So if you are trying to use your Indoor Camera through a window at night, go into the Device Settings->IR Night Vision and set it to OFF.

### **When I try to view live view, it says “Offline” or “Cannot establish encryption channel”**

1. Unplug your camera from power and plug it back in.
2. Check to make sure you have the newest firmware for your camera. Go to the device settings and scroll down to Firmware Information.
3. Contact us so we can assist you.

### **Setting up Motion Detection and Recording**

1. From the live view of the camera, click Notifications, or from the device settings click Detection Settings.  
—You can schedule when you want to receive notification of motion.
2. To save recordings, you can purchase Cloud Recording or install a microSD card (max 128GB, not included) into the camera for LOCAL recordings.  
—Recordings can be based on motion or can be All Day.  
—Please note: All Day recording will fill up a microSD card much quicker.
3. Every time a motion is detected, a screenshot is (:) saved for your review. They can be found in the Notification Center. From the Home page, click the three lines in the top left, and then click Notifications.



4. If you are using a microSD card, it will continue to record until the microSD card fills up.  
—If you are using Motion-based recording: Separate files are recorded for each detection, so when the memory fills up, it will begin to record over the oldest detections, one at a time.  
—If you are using All Day recording: One file is saved as the video is continuously recording. When the memory fills up, it will clear the entire recording and start fresh.

### **Two Way Audio**

1. By default, the camera will only use the microphone OR the speaker. When you click the microphone on the live view, you will be able to speak through the camera, and when you click the microphone again to turn it off, the speaker will automatically turn on so you can hear what's being said at the camera.
2. For some cameras, you can turn on Full Two Way Audio by going to the Device Settings -> Basic Function Settings -> Talk Mode and click on Two-Way Talk.

## Documents / Resources



[Energizer Indoor Fixed Camera EIX1-1002](#) [pdf] User Guide  
Energizer, Indoor Fixed Camera, EIX1-1002