



ENCELIUM WPLCM Wireless Control Module Instruction Manual

[Home](#) » [ENCELIUM](#) » ENCELIUM WPLCM Wireless Control Module Instruction Manual 

ENCELIUM WPLCM Wireless Control Module Instruction Manual



Contents

- [1 PRODUCT SAFETY](#)
- [2 GETTING STARTED](#)
- [3 WIRELESS SYSTEM OVERVIEW](#)
- [4 INSTALLATION](#)
- [5 MOUNTING OPTION](#)
- [6 ELECTRICAL CONNECTIONS](#)
- [7 HARDWARE BARCODE](#)
- [LOGBOOK](#)
- [8 TROUBLESHOOTING](#)
- [9 Documents / Resources](#)
- [10 Related Posts](#)

PRODUCT SAFETY

When using electrical equipment, basic safety precautions should always be followed, including the following:

⚠️ READ THESE INSTRUCTIONS BEFORE USING THIS PRODUCT.

⚠️ Do not let power supply cords touch hot surfaces.

⚠️ Do not mount near gas or electric heaters.

⚠️ Equipment should be mounted in locations and at heights where it will not readily be subjected to tampering by unauthorized personnel

⚠️ The use of accessory equipment is not recommended by Encelium as it may cause an unsafe condition.

⚠️ Do not use this equipment for other than the intended use.

⚠️ SAVE THESE INSTRUCTIONS.

GETTING STARTED

Overview

The Wireless Plug Load Control Module (WPLCM) is an individually addressable device that controls loads up to 20A by switching an integrated high current relay rated for 120 — 347 VAC. WPLCM is ASHRAE 90.1-2016 and Title 24 2016 code-compliant and utilizes a mesh network based on Zigbee® standards.

WIRELESS SYSTEM OVERVIEW

This illustration shows how each component is easily integrated into the Encelium X Lighting Control System.

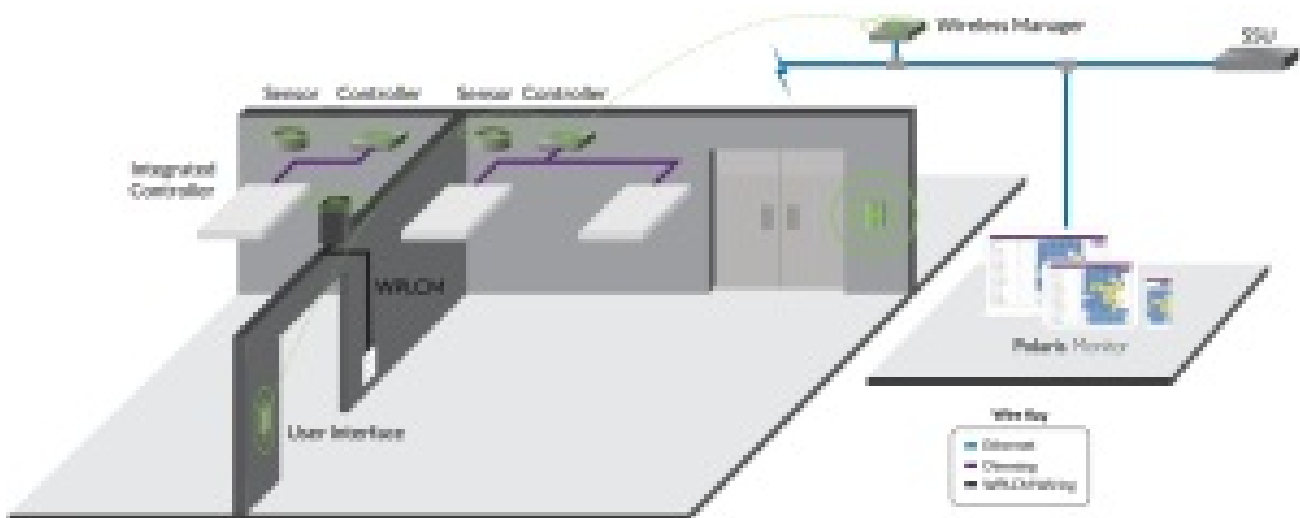

INSTALLATION

Typical Installation

The WPLCM module connects to any electrical plug loads up to 20A 120—347 VAC ratings to make each individual device controllable by the Encelium X or Encelium Edge Lighting Control Systems.

Notes: The WPLCM is to be installed in dry, indoor locations ONLY. It is NOT rated for damp installations.

MOUNTING OPTION

WPCLM module installations must utilize a junction box. It is recommended to securely mount the WPCLM module to the junction box using an available 0.5 inch trade size knock-out and retainer nut.

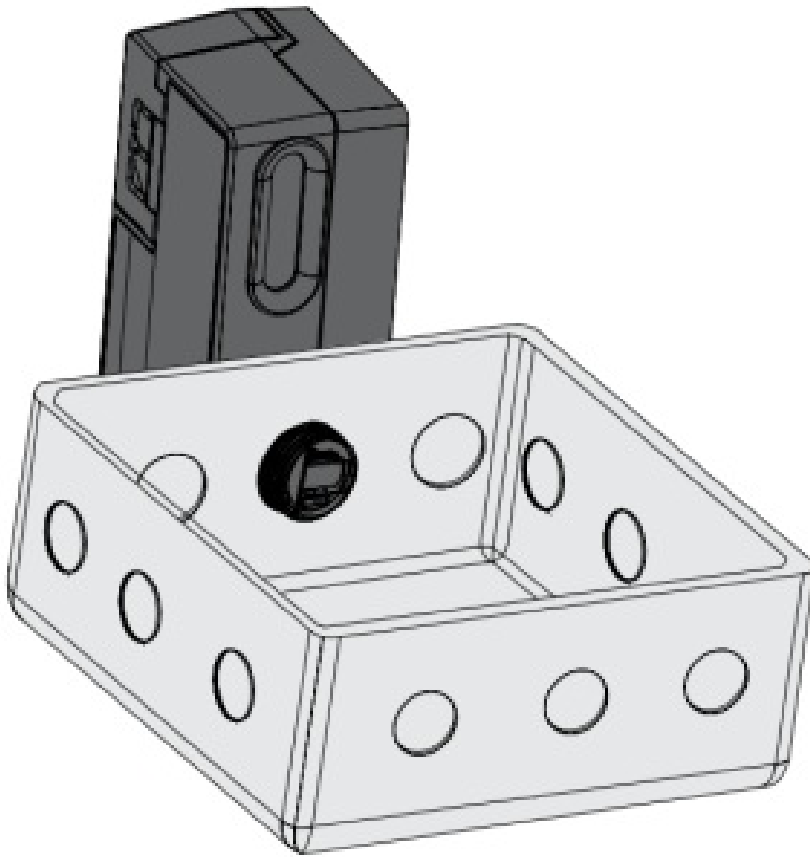

ELECTRICAL CONNECTIONS

1. Plug Load Control Wiring

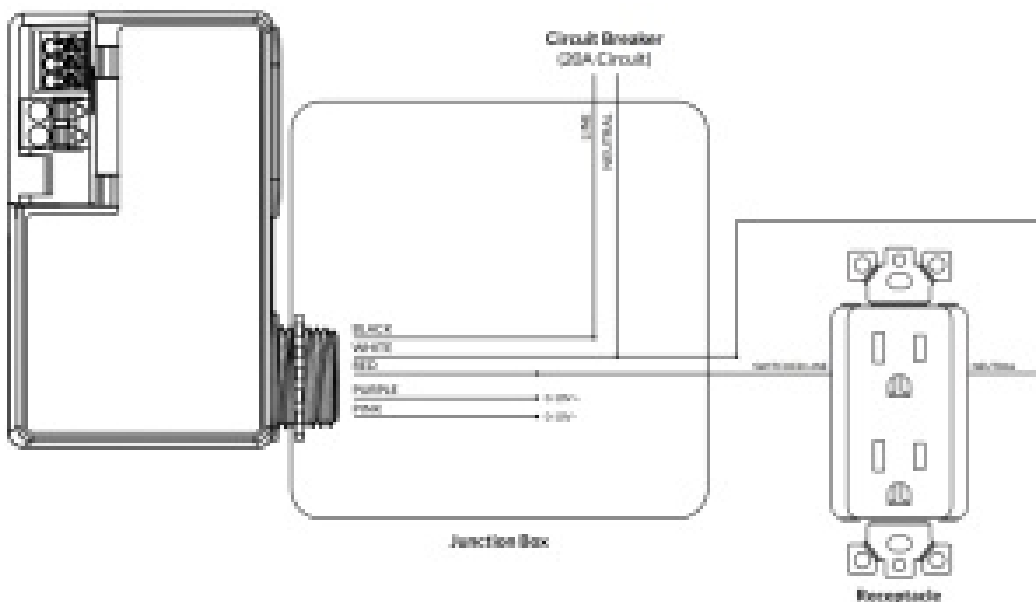

2. WPLCM Wiring

GreenBus wiring is still accessible from the outside of the luminaire, while all necessary wiring to the electronic dimming ballast is available on the inside. The WPLCM dimming interface (purple and pink wires) is a galvanically isolated 0-10V circuit such that it may be wired as NEC Class 1 or 2.

The module has been tested in accordance to UL2043 and is suitable to be used in plenum or “plenum rated” areas. All wiring is rated 600V, 221°F (105°C) for use in luminaires. The black and red wires connect to the internal relay and allow the WPLCM to interrupt power to the load for complete shutoff. Refer to local electrical code, etc.

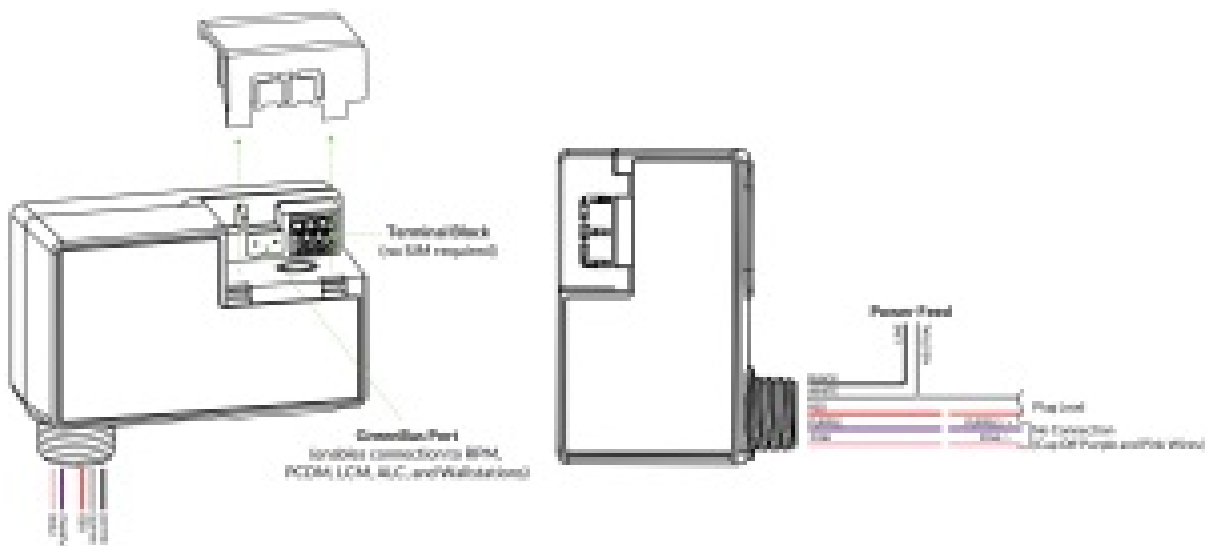

Control & Power Wires

⚠ Recommended branch circuit, 120-347V, 20A maximum.

⚠ Due to the internal relay, power feed to the plug loads may be live even if lights are off. Turn off power at circuit breaker or fuse before installing or servicing the WPLCM. Observe lockout procedures.

3. Class 1 and Class 2 Wiring

The WPLCM may be wired as a Class 1 or a Class 2 device on the purple and pink wires. If these wires are connected to a Class 1 signal, ensure to install the black cap.

- **GreenBus Cap Installed**

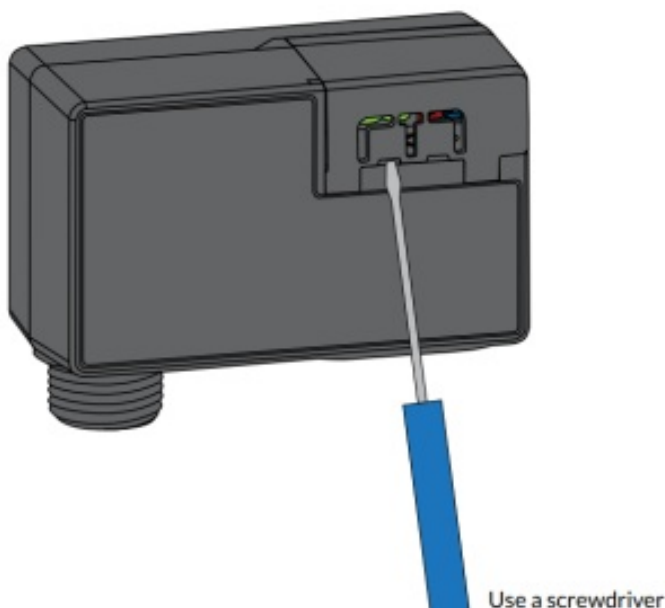

- **GreenBus Cap Removed**

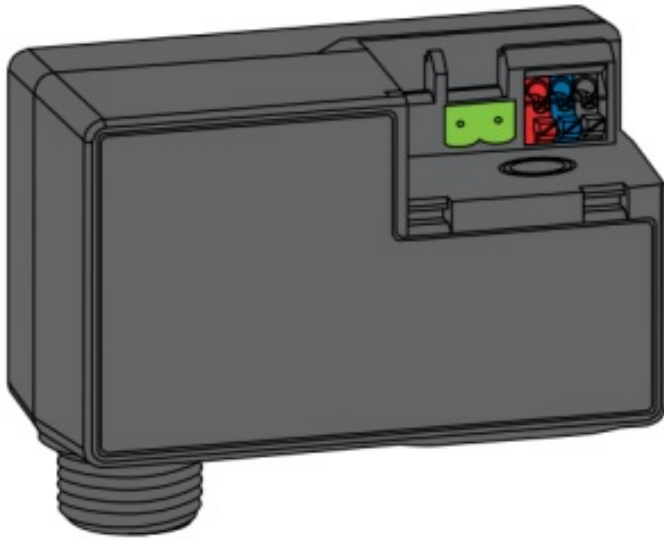

 Failure to install black cap for Class 1 wiring schemes may result in exposed hazardous voltages at the GreenBus port.

4. **GreenBus**

GreenBus is a low-cost, high reliability communication means to report information back to the Encelium X Lighting Control Systems.

When tethering the GreenBus wiring can originate from a GB port on a Wireless Area Lighting Control Module (WALC) or a Wireless Control Module (WCM).

The GreenBus wires must be used with a proprietary connector supplied. Insert the connector to the WPLCM GB ports.

 GreenBus must be laid out as per supplied system layout drawing. If changes are required, determine an optimum wiring path utilizing the supplied cables, based on the position of the devices.

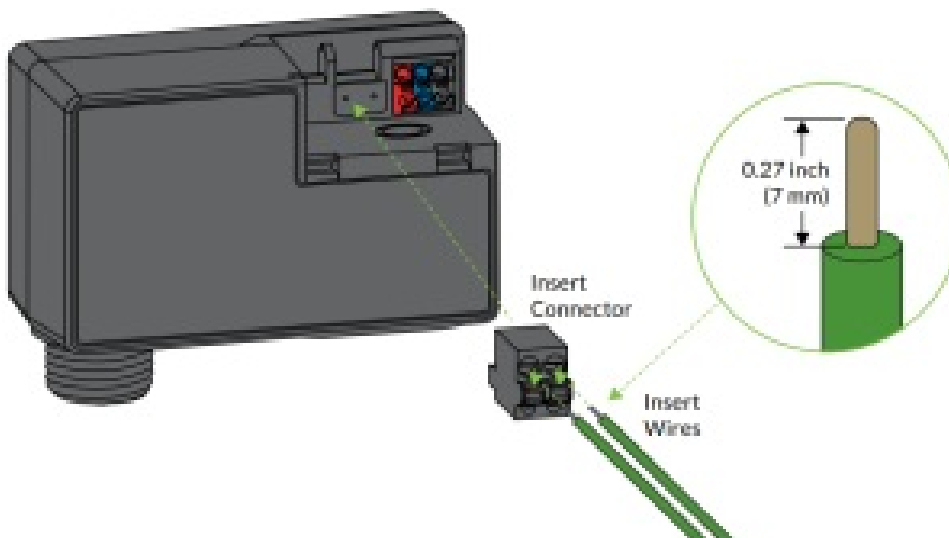

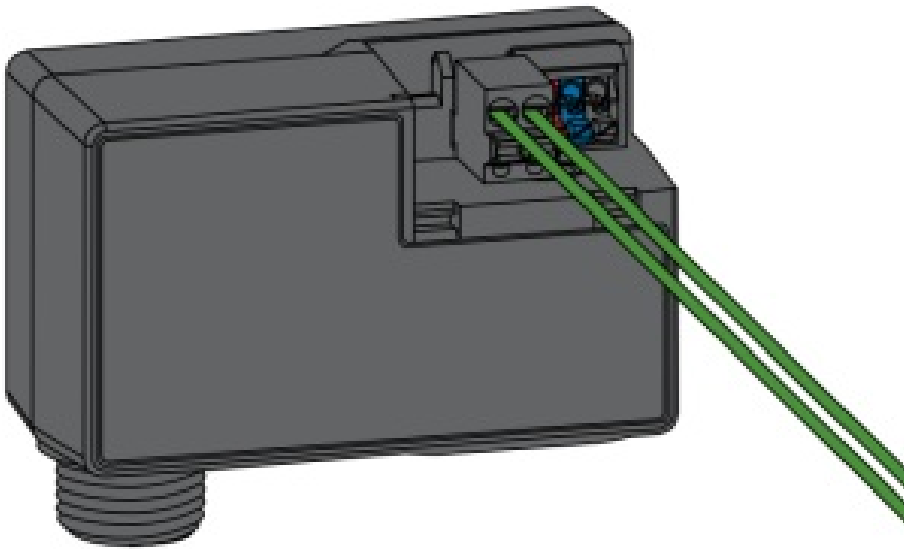

To remove the wires, use a flat head screwdriver to release the wires from the terminal blocks.

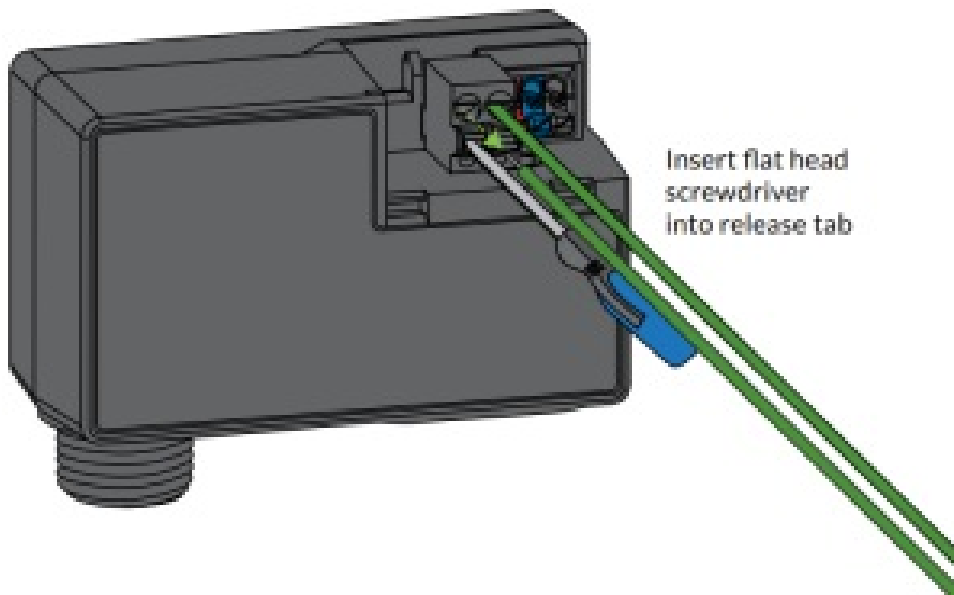

Notes: Relay Contact; recommended relay switching capacity 120 VAC, 450 W or 277 VAC, 900 W maximum. If the devices are connected with a method other than daisy-chain, this must be indicated to an Encelium Representative for approval before wiring.

 GreenBus uses proprietary connectors and jacks for ease of installation only. GreenBus is a proprietary standard. Connect to Encelium Lighting Control System only. Do not connect to other circuits.

HARDWARE BARCODE LOGBOOK

For Encelium Edge installations, remove the bar code sticker from the transparent bag that is supplied in the product packaging and place the sticker in the supplied handbook.

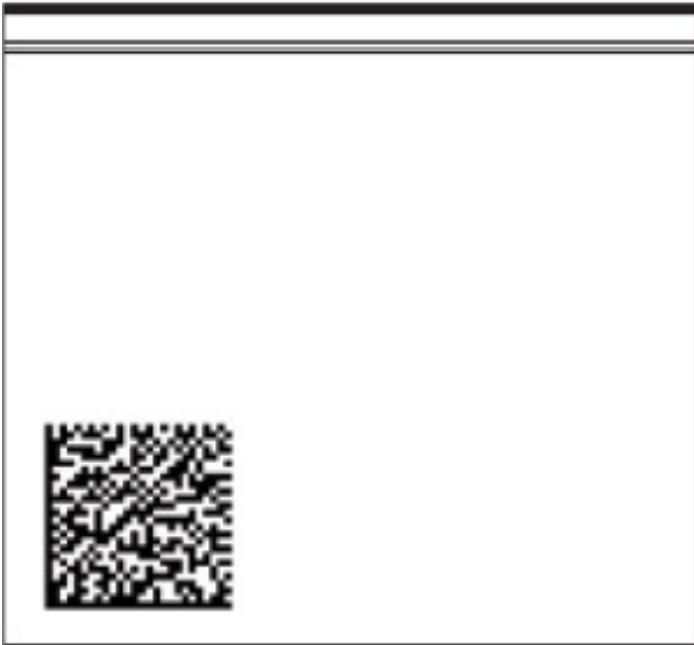



Product Barcode Sticker

Encelium Edge Hardware Barcode Logbook

Encelium Edge Controller Number:

Installed Area: Lobby

			<div>Place sticker here</div>
<div>Place sticker here</div>	<div>Place sticker here</div>	<div>Place sticker here</div>	<div>Place sticker here</div>
<div>Place sticker here</div>	<div>Place sticker here</div>	<div>Place sticker here</div>	<div>Place sticker here</div>

TROUBLESHOOTING

There are no user-serviceable parts inside. For detailed information about how to set-up, install, use, and maintain Encelium hardware and software, please visit: help.encelium.com

Generate Facility Wellness, SiteWorx, LightRules, Lightelligence, Encelium, the Encelium logo, Polaris, GreenBus and any other trademark, service mark, or tradename (collectively “the Marks”) are either trademarks or registered trademarks of Digital Lumens, Inc. in the United States and/or other countries, or remain the property of their respective owners that have granted Digital Lumens, Inc. the right and license to use such Marks and/or are used herein as nominative fair use. Due to continuous improvements and innovations, specifications may change without notice.

DOC-000432-00 Rev A 11-21

encelium.com



Documents / Resources

The thumbnail shows the cover of the 'WPLCM Wireless Control Module' instruction manual. It features the Encelium logo at the bottom and a list of topics on the left side, including 'PRODUCT SAFETY', 'INSTALLATION INSTRUCTIONS', 'WIRELESS CONTROL MODULE', and 'WPLCM WIRELESS CONTROL MODULE'. The cover is white with green and black text.	<p>ENCELIUM WPLCM Wireless Control Module [pdf] Instruction Manual</p> <p>WPLCM, Wireless Control Module, WPLCM Wireless Control Module</p>
--	---