

ENCELIUM WPBC Wireless Push Button Coupler Instruction Manual

[Home](#) » [ENCELIUM](#) » ENCELIUM WPBC Wireless Push Button Coupler Instruction Manual 

Contents

- 1 User Interfaces | Installation Instructions
- 2 WPBC
 - 2.1 Wireless Push Button Coupler
 - 2.2 GETTING STARTED
 - 2.2.1 OVERVIEW
 - 2.3 PRODUCT SAFETY
 - 2.3.1 READ THESE INSTRUCTIONS BEFORE USING THE PRODUCT
 - 2.4 WIRELESS SYSTEM OVERVIEW
 - 2.5 STEP 1
 - 2.5.1 WALL BOX MOUNT
 - 2.6 STEP 2
 - 2.6.1 MAKE ELECTRICAL CONNECTIONS
 - 2.7 FEATURES
 - 2.7.1 LED Indicator States
 - 2.8 FACTORY DEFAULT SETTINGS
 - 2.9 VISIT OUR HELP CENTER
- 3 Documents / Resources
 - 3.1 References
- 4 Related Posts

User Interfaces | Installation Instructions

WPBC

Wireless Push Button Coupler

GETTING STARTED

OVERVIEW





The Encelium **Wireless Push Button Coupler (WPBC)** enables convenient control of light levels and allows use of any standard push button or switch as an input device to the Encelium X Lighting Control System. The WPBC gives you the flexibility to select the brand, shape, color and size push button or switch preferred for your lighting design. Simply install the WPBC in any standard flush-mount junction box, connect it to mains power, and your selected wall switch. For more information on product specifications and design tools visit encelium.com.



PRODUCT SAFETY

READ THESE INSTRUCTIONS BEFORE USING THE PRODUCT

When using electrical equipment, basic safety precautions should always be followed, including the following:

-  Do not mount near gas or electric heaters or let power supply cords touch hot surfaces.
-  Equipment should be mounted in locations and at heights where it will not readily be subjected to tampering by unauthorized personnel.
-  The use of accessory equipment is not recommended by Encelium as it may cause an unsafe condition.
-  Do not use this equipment for other than the intended use.

SAVE THESE INSTRUCTIONS.

WIRELESS SYSTEM OVERVIEW

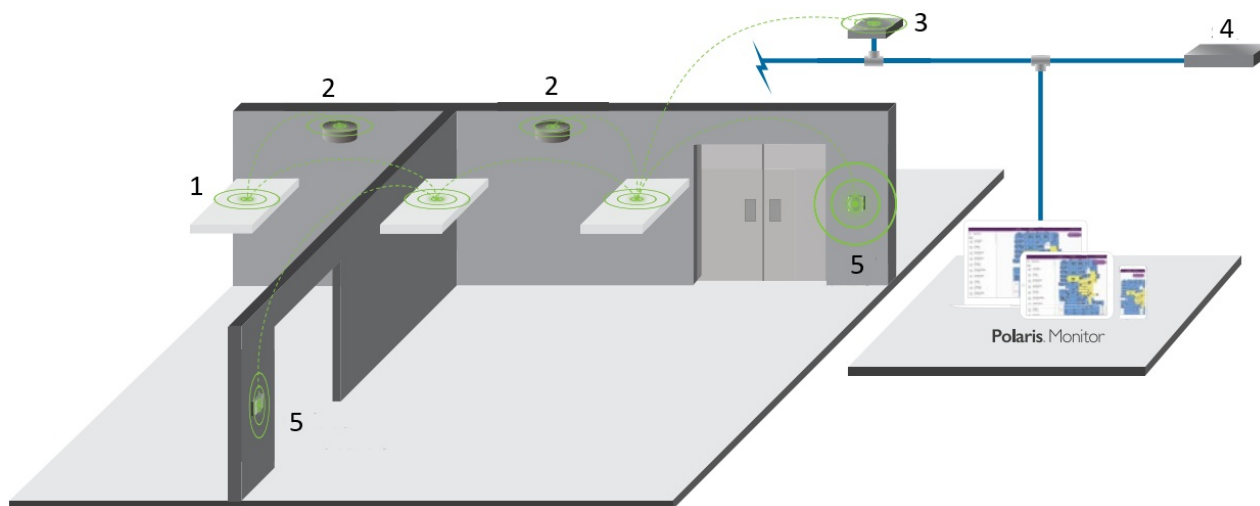

1. DALI -Controlled Luminaire
2. Sensor
3. Wireless Manager
4. SSU
5. Push-Button Device with a WPBC

Wire Key

- Ethernet
- - - Wireless

This illustration shows how each component is easily integrated into the Encelium X Lighting Control System.

STEP 1

WALL BOX MOUNT

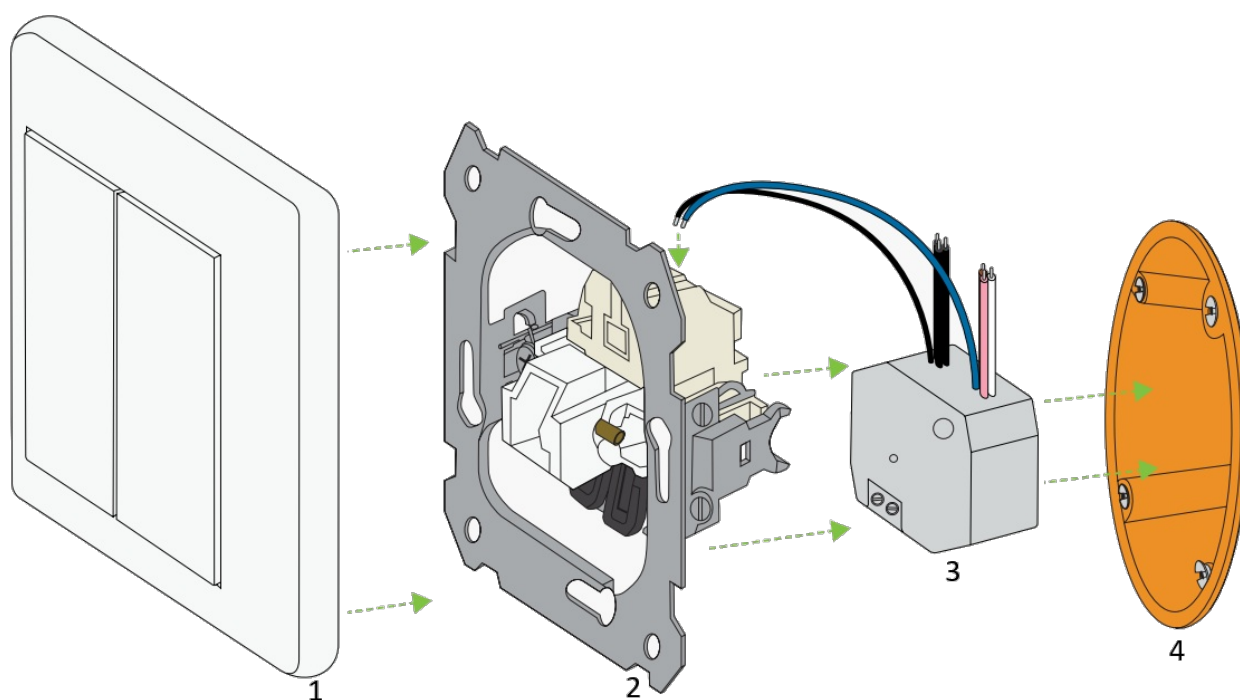

1. Faceplate
2. Wall Switch

3. WPBC
4. Wall Box

Note: Matching European style face plates are available upon request. Please ask your Encelium Representative for details.

STEP 2

MAKE ELECTRICAL CONNECTIONS

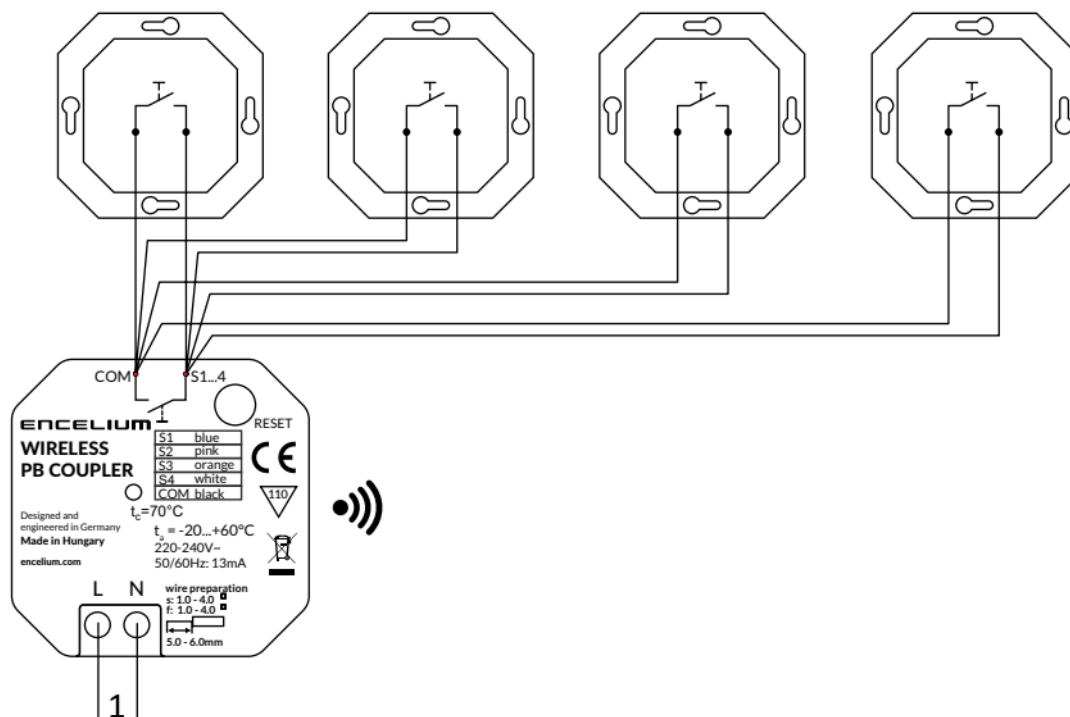

1. Power Supply

Place the WPBC inside the wall box for your pushbutton or switch input device. Connect mains power to the WPBC terminals labeled L and N. The WPBC comes with color coded wiring for connecting up to 4 input devices, S1-S4. Connect these wires to your input device(s), connecting one black/COM wire and one colored wire (BLUE/PINK/ ORANGE/WHITE) to each switch input device.

FEATURES

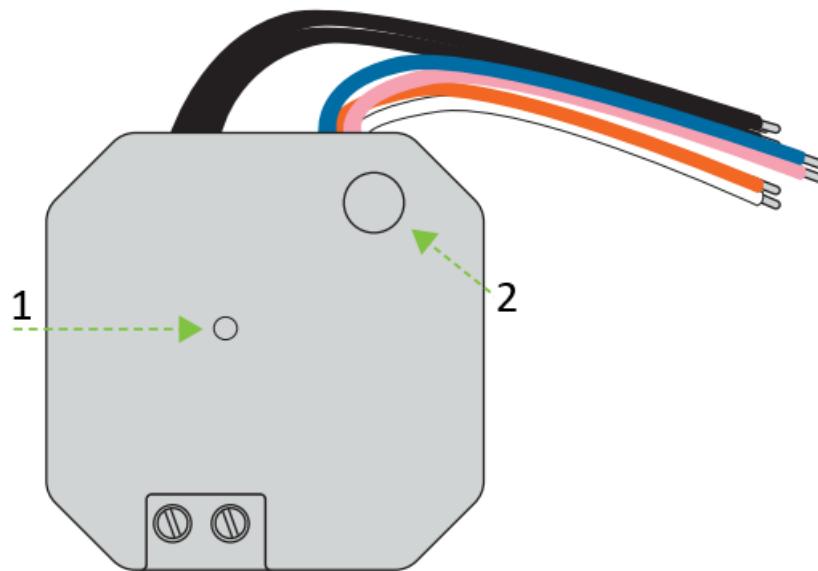

1. LED Indicator
2. SELECT Button

The WPBC features a SELECT Button and LED Indicator. The SELECT Button enables you to identify a device and reset to factory default settings. The LED Indicator has 4 states (see the WPBC Indicator details below).

LED Indicator States

State No.	LED Status	Meaning	Remark
1	OFF	Device is without mains power	–
2	Slowly Blinking (~ 1 Hz)	Device is not yet / No longer part of a mesh network	Indication of RESET / Out-of-the-box state
3	Rapidly Flashing (~ 10 Hz)	RESET successfully completed	After 3 seconds LED shall change to State No. 2
4	Permanently ON	Device is part of a mesh network	–

FACTORY DEFAULT SETTINGS

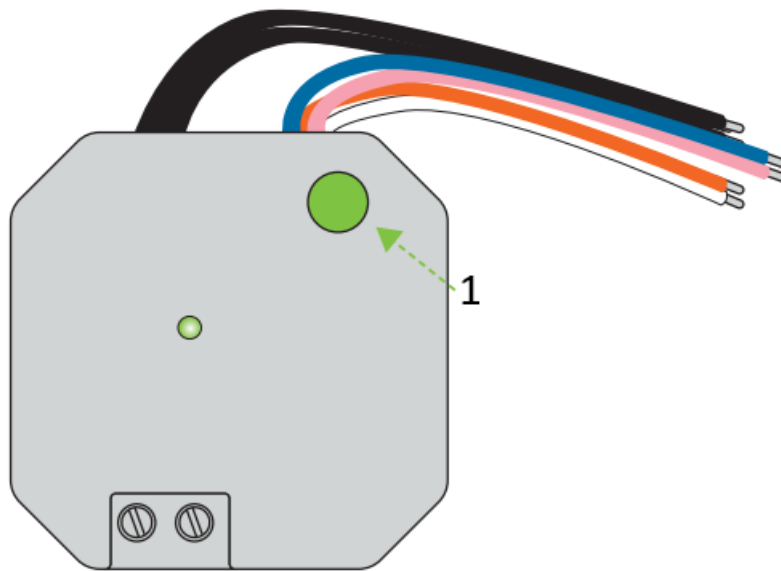

1. SELECT Button

Press and hold the SELECT button for approximately 10 seconds. The LED Indicator will blink for 2 seconds and the WPBC is reset to factory default settings.

Notes: This will delete the DALI short address and require the device to be re-commissioned. This needs to be done before securing the faceplate onto the switch.

[encelium.com](https://www.encelium.com)

VISIT OUR HELP CENTER



For instructions to install, configure, test, or use Encelium products or systems, or to contact an Encelium Technical Support Specialist, please scan the QR code or visit help.encelium.com.

Copyright © 2022 Digital Lumens, Incorporated. All rights reserved. Digital Lumens, the Digital Lumens logo, We Generate Facility Wellness, SiteWorx, LightRules, Lightelligence, Encelium, the Encelium logo, Polaris, GreenBus and any other trademark, service mark, or tradename (collectively “the Marks”) are either trademarks or registered trademarks of Digital Lumens, Inc. in the United States and/or other countries, or remain the property of their respective owners that have granted Digital Lumens, Inc. the right and license to use such Marks and/or are used herein as nominative fair use. Due to continuous improvements and innovations, specifications may change without notice.

DOC-000460-00 Rev A 11-22

ENCELIUM

Documents / Resources

	<p>ENCELIUM WPBC Wireless Push Button Coupler [pdf] Instruction Manual WPBC Wireless Push Button Coupler, WPBC, Wireless Push Button Coupler, Push Button Coupler, Button Coupler, Coupler</p>
---	---

References

- [E ENcelium - Exceptional Lighting Management](#)
- [E ENcelium Help Center](#)

Manuals+,