



EnCELLum Dry Contact Input Interface Instruction Manual

[Home](#) » [ENCELLIUM](#) » EnCELLum Dry Contact Input Interface Instruction Manual

EnCELLum Dry Contact Input Interface Instruction Manual



Contents [[hide](#)]

- [1 PRODUCT SAFETY](#)
- [2 GETTING STARTED](#)
- [3 SYSTEM OVERVIEW](#)
- [4 MOUNTING OPTIONS](#)
- [5 ELECTRICAL CONNECTIONS](#)
- [6 TROUBLESHOOTING](#)
- [7 Documents / Resources](#)
- [8 Related Posts](#)

PRODUCT SAFETY

When using electrical equipment, basic safety precautions should always be followed, including the following.



READ THESE INSTRUCTIONS BEFORE USING THIS PRODUCT.



Do not let power supply cords touch hot surfaces.



The 6 dry contacts should not be applied with any voltage as it will damage the device permanently.



Do not mount near gas or electric heaters.



Equipment should be mounted in locations and at heights where it will not readily be subjected to tampering by unauthorized personnel.



Do not use this equipment for other than the intended use.



The device is to be installed in dry, indoor locations ONLY. Do not install the device in damp locations.



SAVE THESE INSTRUCTIONS.

GETTING STARTED

Overview

The Dry Contact Input Interface (DCII) is designed to deliver an enhanced occupant experience in a space by enabling integrations between Encelium Light Management System and third-party systems.

SYSTEM OVERVIEW

1. Wired Installation

The DCII is a GreenBus device and is wired using the 2-wire input/output cables in a daisy chain wiring scheme. It can be located in a ceiling or in AV closets depending on the application.

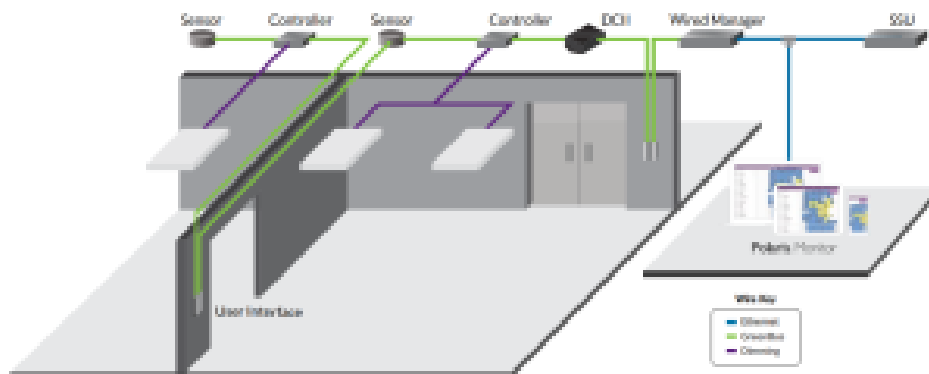

2. Wireless Installation

In a wireless system, the DCII is tethered from the GreenBus ports on the load controllers (WCM or WALC).

MOUNTING OPTIONS

The DCII can be mounted in three different ways.

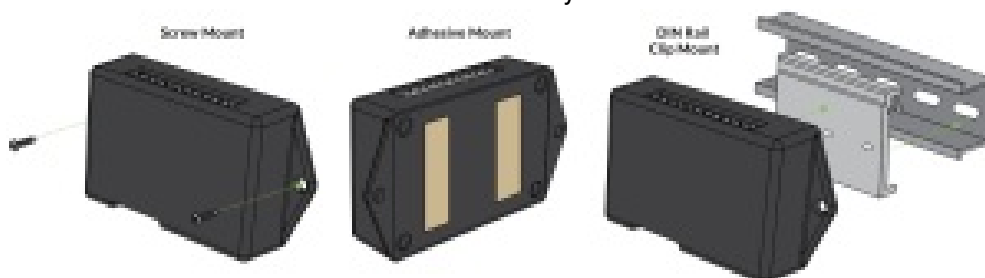

1. Screw Mount

The Dry Contact Input Interface may be screwed directly to a wall surface.

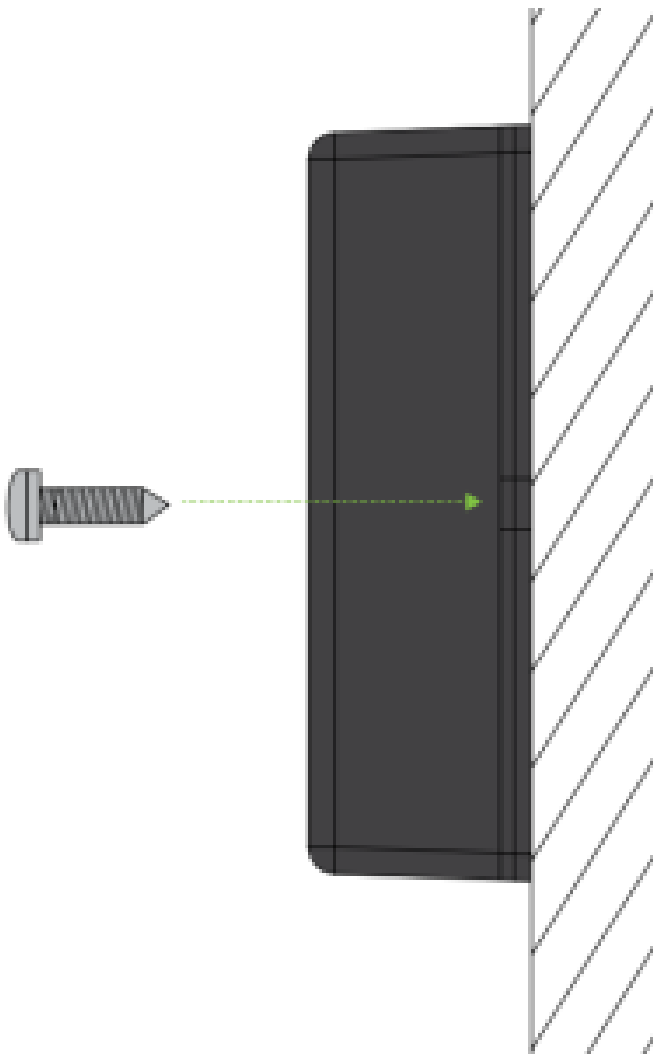

Note: Screws are not provided and to be sourced by the installer.

2. **Adhesive Mount**

Attach the adhesive to the back of the device by removing adhesive backing from both adhesives and press device on the flat, clean surface with pressure for 30 seconds.

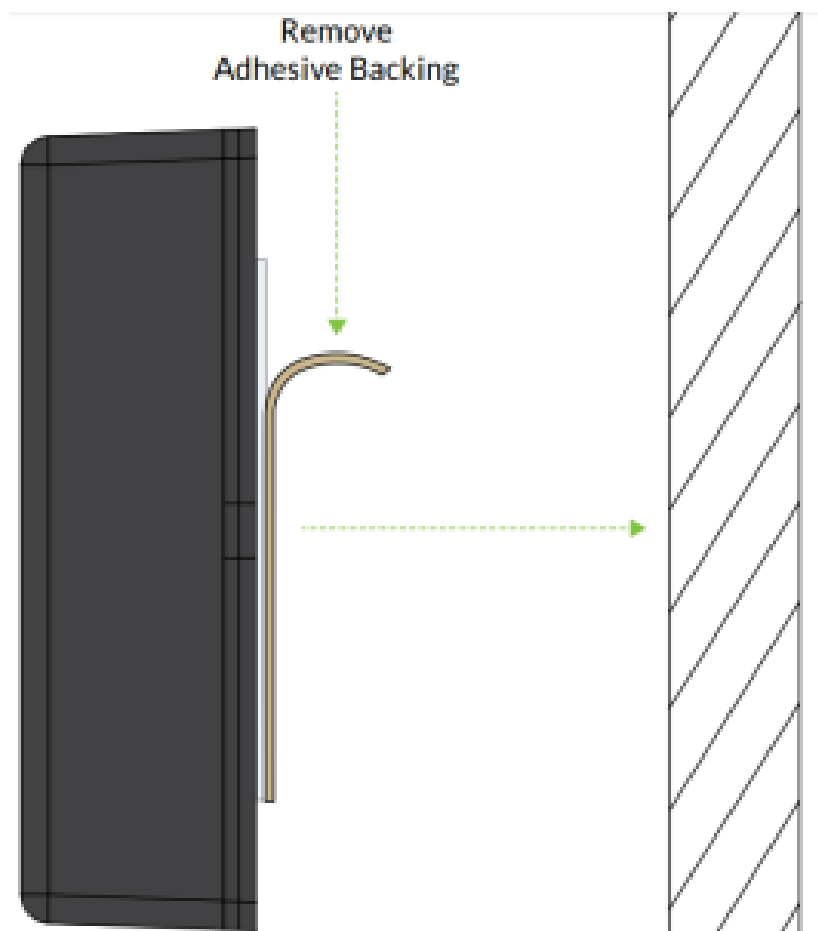

3. Clip Mount

Remove one liner from both adhesive strips and press on to the DIN rail clip for 30 seconds. Then mount the DIN rail clip to the DIN rail.

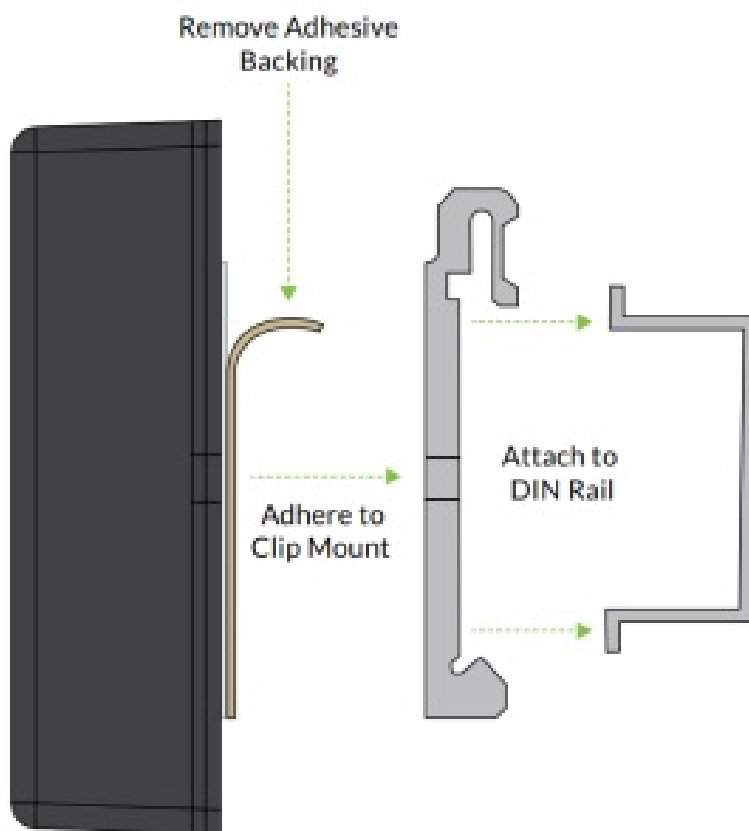

ELECTRICAL CONNECTIONS

1. GreenBus

The GreenBus wires must be used with proprietary connectors supplied. Insert the connectors to the DCII GB ports.

⚠ GreenBus must be laid out as per supplied system layout drawing. If changes are required, determine an optimum wiring path utilizing the supplied cables, based on the position of the devices

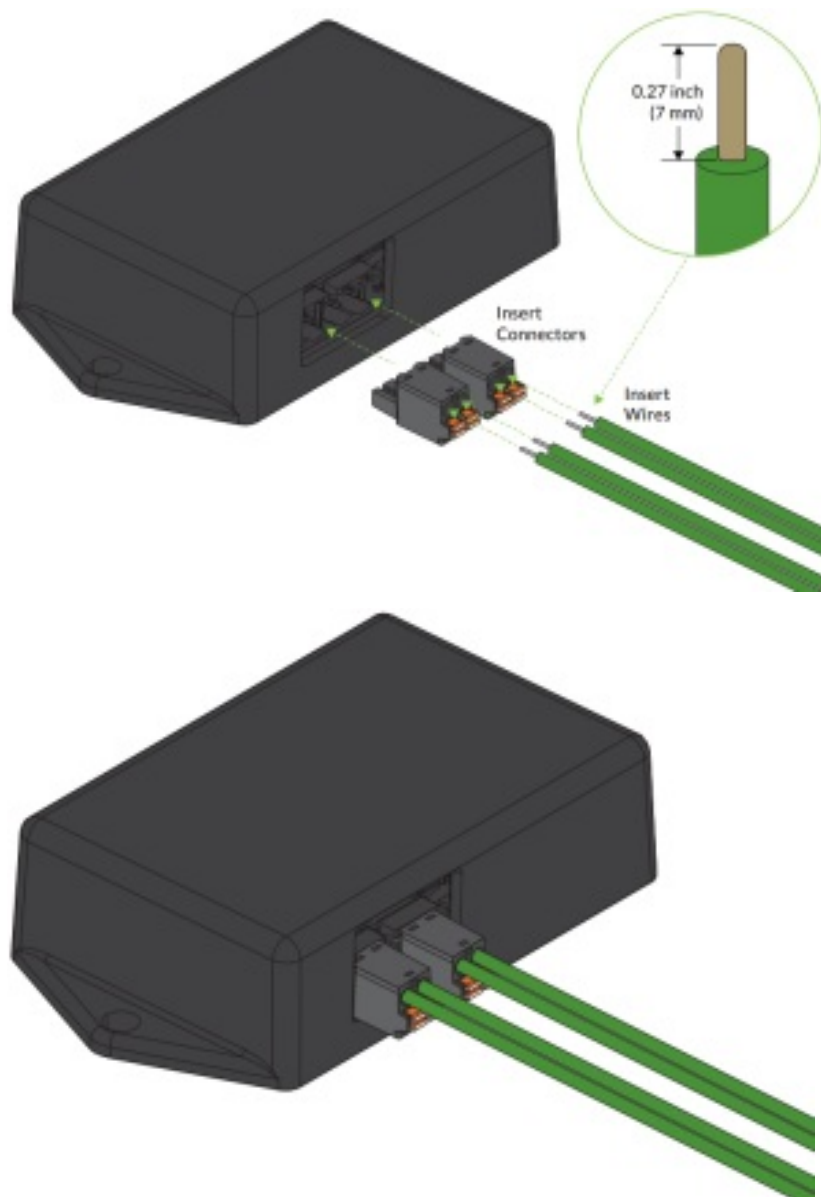

2. Third-Party to the DCII

Connect the wires from the third-party system to the DCII using solid core wire with recommended strip length of 0.2 inch (5 mm). Push the wires in the terminal blocks for full engagement.

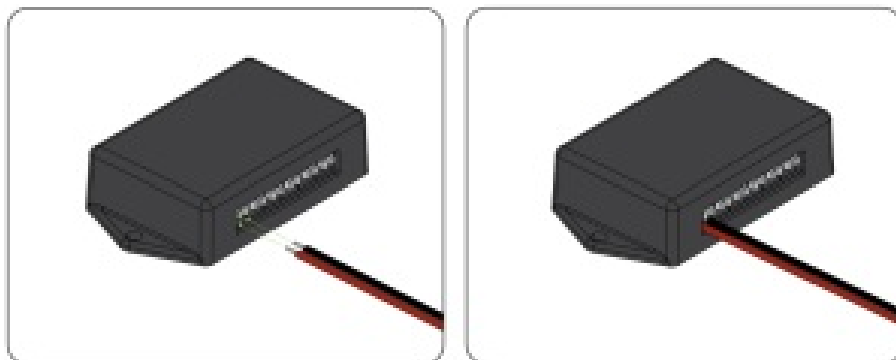

To remove the wires, use a flat head screwdriver to release the wires from the terminal blocks.

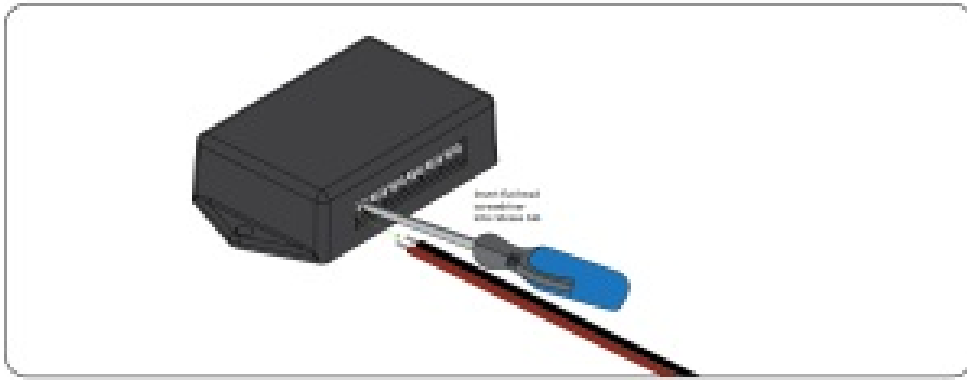

TROUBLESHOOTING

There are no user-serviceable parts inside. For detailed information about how to set-up, install, use, and maintain Encelium hardware and software, please visit: help.encelium.com

Copyright © 2021 Digital Lumens, Incorporated. All rights reserved. Digital Lumens, the Digital Lumens logo, We Generate Facility Wellness, SiteWorx, LightRules, Lightelligence, Encelium, the Encelium logo, Polaris, GreenBus and any other trademark, service mark, or tradename (collectively “the Marks”) are either trademarks or registered trademarks of Digital Lumens, Inc. in the United States and/or other countries, or remain the property of their respective owners that have granted Digital Lumens, Inc. the right and license to use such Marks and/or are used herein as nominative fair use. Due to continuous improvements and innovations, specifications may change without notice. DOC-000423-00 Rev B 11-21.

Documents / Resources

	<p>EnCELLium Dry Contact Input Interface [pdf] Instruction Manual</p> <p>DCII, Dry Contact Input Interface, 000423</p>
--	--