

[Skip to content](#)

Manuals+

User Manuals Simplified.



ENCELIUM DALI LS PD LI Osram Sensor for Luminaire Instruction Manual

[Home](#) » [ENCELIUM](#) » ENCELIUM DALI LS PD LI Osram Sensor for Luminaire Instruction Manual

ENCELIUM

Sensors Installation

Instructions

DALI LS PD LI



DALI LS PD Luminaire Integration

Contents [hide](#)

[1 OVERVIEW](#)

[2 PRODUCT SAFETY](#)

[3 WIRED SYSTEM OVERVIEW](#)

[4 LUMINAIRE INTEGRATION OPTION 1](#)

[5 FEATURES](#)

[6 SENSOR SETTINGS](#)

[7 SENSOR DETECTION RANGE](#)

[8 Documents / Resources](#)

[8.1 References](#)

[9 Related Posts](#)

OVERVIEW

The DALI LS PD LI is a compact light and presence sensor that is easily attached to a luminaire. The sensor communicates to the Encelium Wired Manager — DALI via directly connect DALI bus. For more information on product specifications and design tools visit encelium.com.

PRODUCT SAFETY

READ THESE INSTRUCTIONS BEFORE USING THE PRODUCT

When using electrical equipment, basic safety precautions should always be followed, including the following:



Do not mount near gas or electric heaters or let powersupply cords touch hot surfaces.



Equipment should be mounted in locations and at heights where it will not readily be subjected to tampering by unauthorized personnel.



The use of accessory equipment is not recommended by Encelium as it may cause an unsafe condition.



All DALI channels are internally connected together to the control unit. Make sure to consider this when installing.



Do not use this equipment for other than the intended use.

SAVE THESE INSTRUCTIONS.

WIRED SYSTEM OVERVIEW

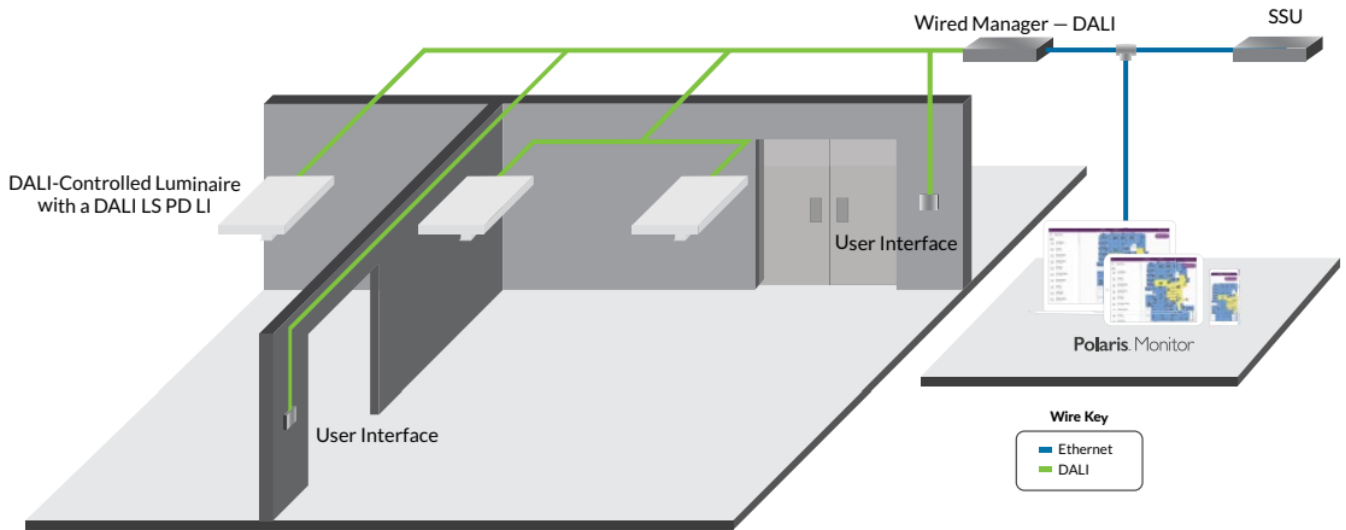

Encelium X enables you to control DALI devices. With any Encelium wired design, you get a reliable, lighting control system that can be installed quickly and easily.

STEP 1

LUMINAIRE INTEGRATION OPTION 1

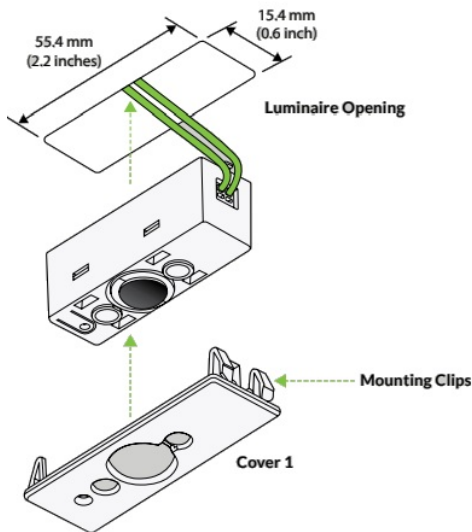

Proceed to Luminaire Integratiton option 2 if not using option 1.

A 15.4 x 55.4 mm (0.6 x 2.2 inches) hole must be cut prior to installing the DALI LS PD LI. Install Cover 1 on the DALI LS PD LI and connect the sensor cable to the DALI Line. Then place the DALI LS PD LI into the luminaire hole.

Secure the DALI LS PD LI by snapping the cover mounting clips into the luminaire. The raised surface of the cover sits outside the luminaire opening.

Note: The DALI LS PD LI is supplied from DALI Voltage as per DALI standard EN 62386. Power consumption approximately 6 mA.

LUMINAIRE INTEGRATION OPTION 2

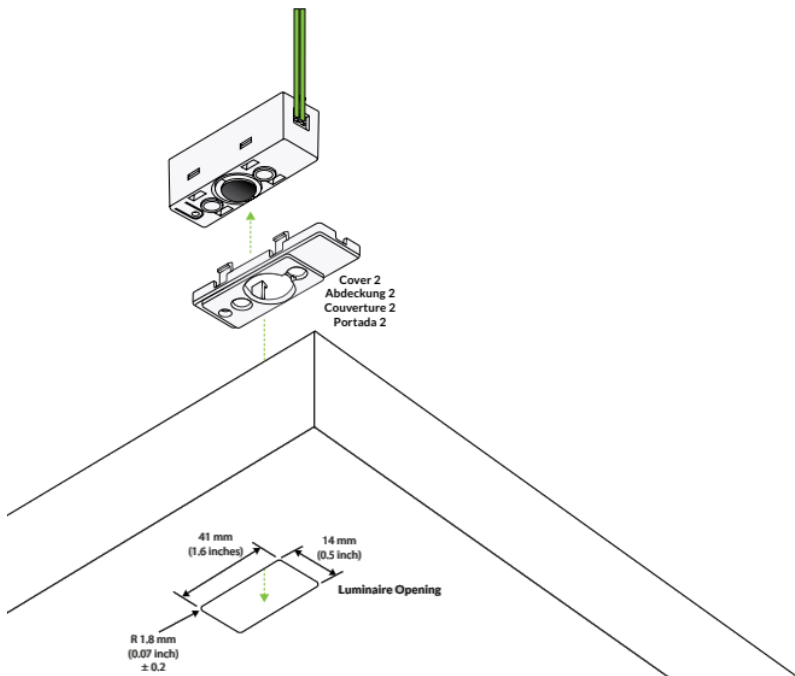

Proceed to Luminaire Integration option 3 if not using option 2.

A 14 x 41 mm (0.5 x 1.6 inches) hole must be cut prior to installing the DALI LS PD LI. Install Cover 2 on the DALI LS PD LI and connect the sensor cable to the DALI Line. Then place the DALI LS PD LI into the luminaire hole. Secure the DALI LS PD LI by snapping the cover mounting clips into the luminaire. The raised surface of the cover sits flush within the luminaire opening.

Note: The DALI LS PD LI is supplied from DALI Voltage as per DALI standard EN 62386. Power consumption approximately 6 mA.

LUMINAIRE INTEGRATION OPTION 3

Proceed to Step 2 if you are not using Luminaire Integration option 3.

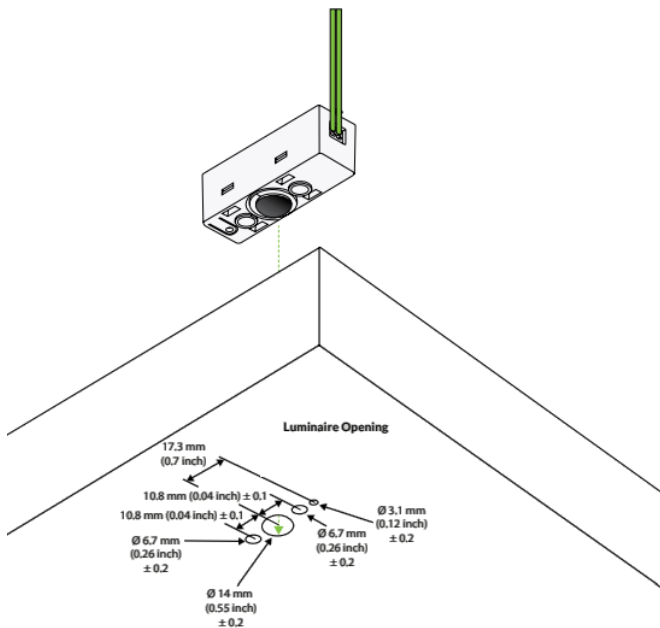

Holes must be cut prior to installing the DALI LS PD LI. Connect the DALI LS PD LI sensor cable to the DALI Line. Then place the DALI LS PD LI into the luminaire holes. If the sensor is in the correct mounting position, the raised surface of the sensor sits flush within the luminaire opening.

Note: The DALI LS PD LI is supplied from DALI Voltage as per DALI standard EN 62386. Power consumption approximately 6 mA.

STEP 2

CONCRETE CEILING INTEGRATION (Optional)

The Surface Mount LS PD AP KIT (purchased separately) is used to install the DALI LS PD LI onto a concrete ceiling. Screw the LS PD AP KIT base into the concrete ceiling. Place Cover 1 (included with sensor) onto the DALI LS PD LI Sensor, connect the sensor wires, and snap into the LS PD AP KIT cover opening. Snap the LS PD AP KIT cover into the base.

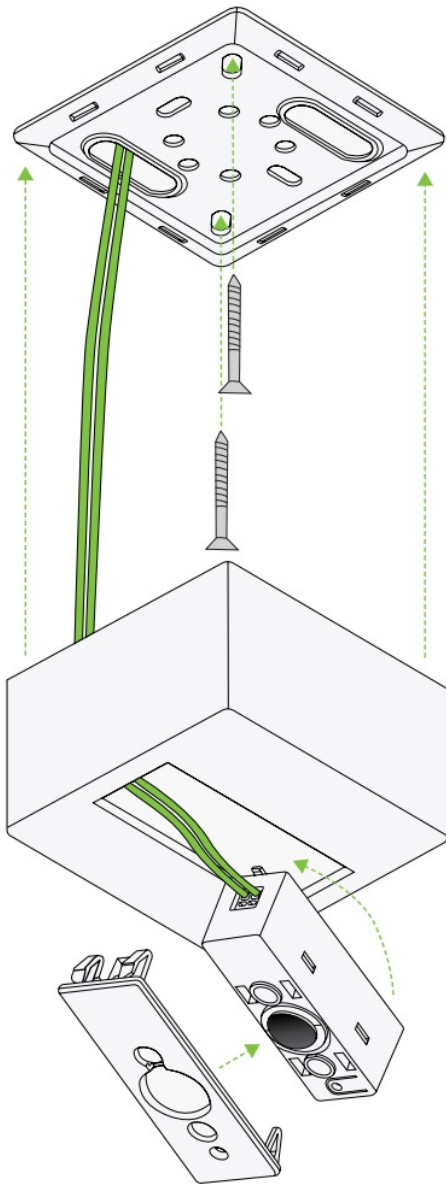

Proceed to Step 3 if you are not using Concrete Ceiling Integration.
WIRING MULTIPLE DALI LS PD Lis

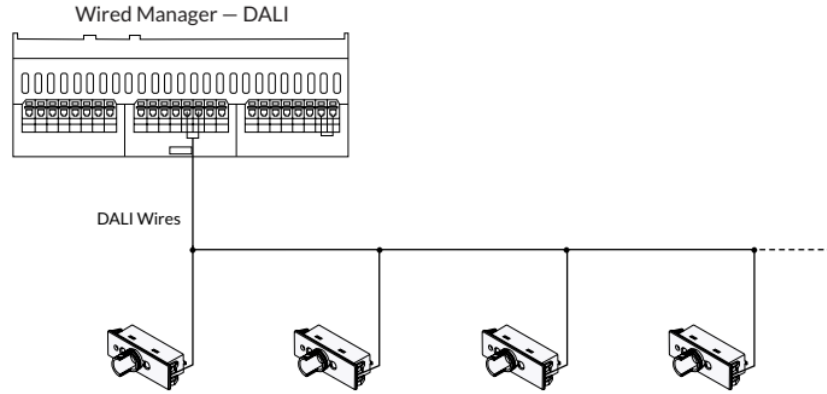

If multiple DALI LS PD Lis are used see how to connect them to the Wired Manager — DALI above.

FEATURES

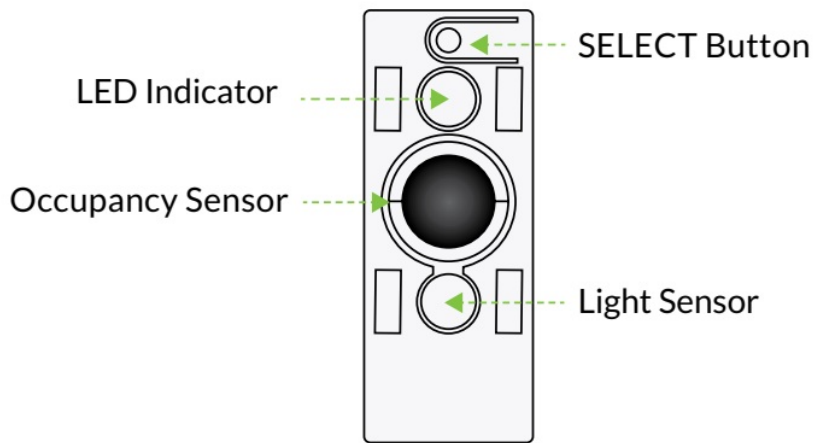

DALI LS PD LI features an Occupancy and Light Sensors, SELECT Button, and LED Indicator. The SELECT Button enables you to identify a device and reset to factory default settings. The LED Indicator displays green or red lights (see the DALI LS PD LI LED Indicator details below).

DALI LS PD LI LED Indicator Lights

- Green LED Indicator Flashes: Motion is detected.
- Green LED Indicator Illuminates Continuously: Motion detection is temporarily deactivated.
- Red LED Indicator Flashes 3 Times: IR Signal of remote control has been received.
- Red LED Indicator Flashes 1 Time: Vibration has been detected.
- Red LED Indicator Illuminates Continuously: 100h burn-in is active.

SENSOR SETTINGS

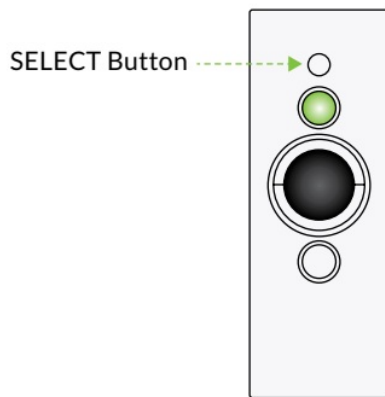

The SELECT Button executes different functions depending on the duration of activation.

- Press the SELECT Button to test the DALI connection — 1 press LED ON, another press LED OFF.
- Press and hold the SELECT Button to start the reset. The LED flashes for approximately 10 seconds. The DALI LS PD LI is set back to the factory settings and all addresses are deleted.

ADJUSTING THE SENSOR SHUTTER

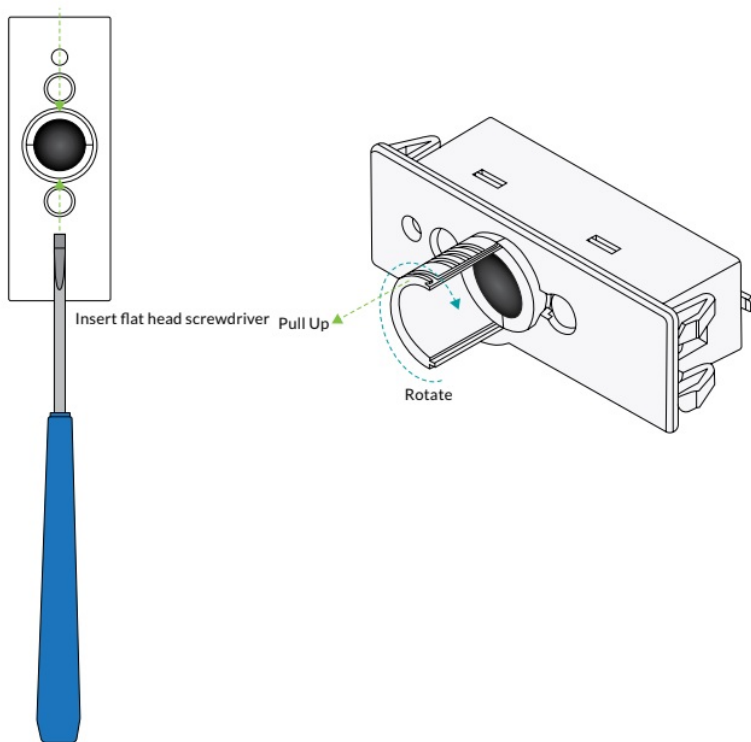

Using a small screwdriver pull up on the shutter sides. Remove, insert, or rotate one or both shutters where necessary.

SENSOR DETECTION RANGE

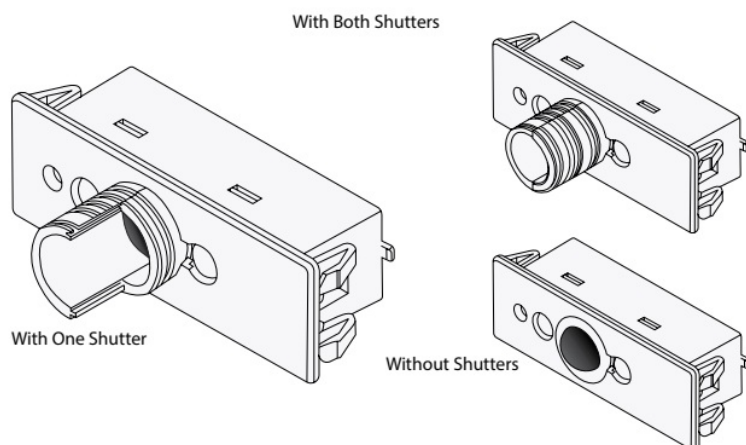

The detection range of the DALI LS PD LI sensor is determined by the shutter position.

SENSOR DETECTION RANGE

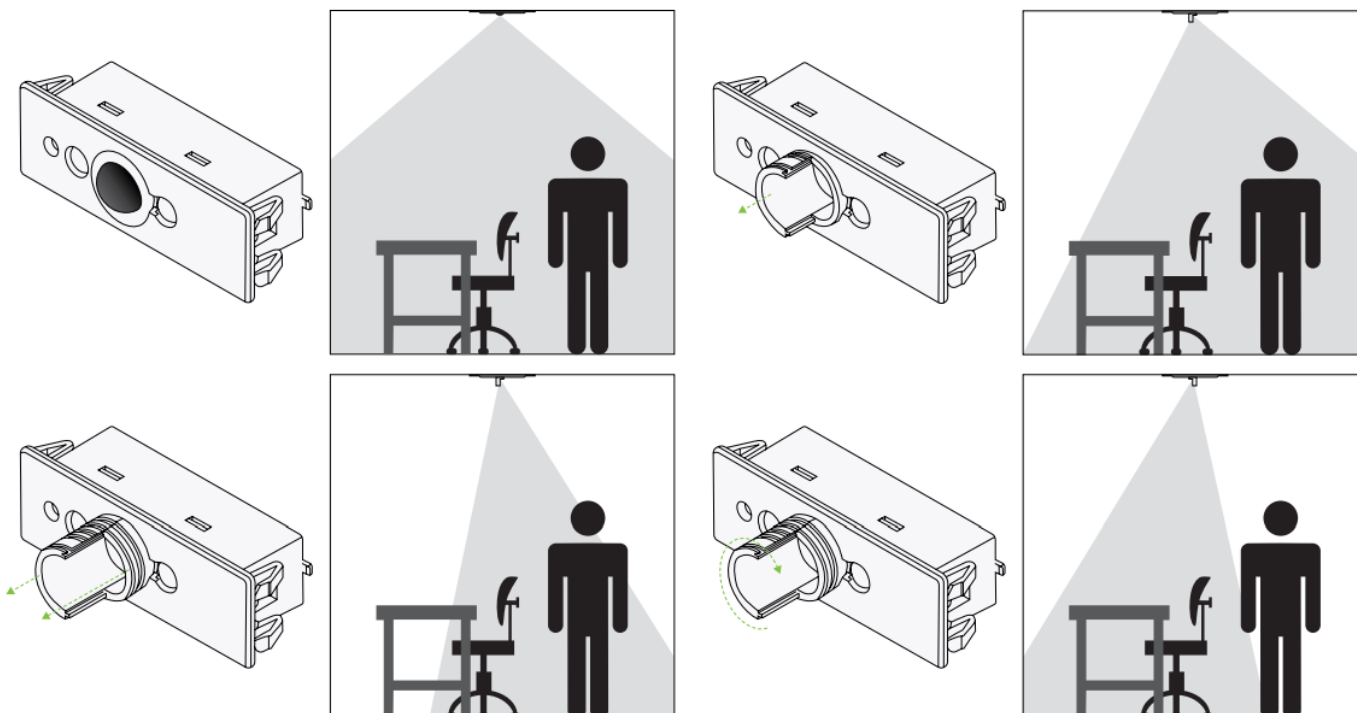

By changing the shutter position, you can influence the detection range of the sensor directionally and avoid undesired presence detection.

VISIT OUR HELP CENTER



<https://help.encelium.com/category/zo5v0jr3ss-installation-and-site-readiness>

For instructions to install, configure, test, or use Encelium products or systems, or to contact an Encelium Technical Support Specialist, please scan the QR code or visit help.encelium.com.

Copyright © 2022 Digital Lumens, Incorporated. All rights reserved. Digital Lumens, the Digital Lumens logo, We Generate Facility Wellness, SiteWorx, LightRules, Lightelligence, Encelium, the Encelium logo, Polaris, GreenBus and any other trademark, service mark, or tradename (collectively "the Marks") are either trademarks or registered trademarks of Digital Lumens, Inc. in the United States and/or other countries, or remain the property of their respective owners that have granted Digital Lumens, Inc. the right and license to use such Marks and/or are used herein as nominative fair use. Due to continuous improvements and innovations, specifications may change without notice. DOC-000458-00 Rev A 11-22

ENCELIUM

Documents / Resources



[ENCELIUM DALI LS PD LI Osram Sensor for Luminaire](#) [pdf] Instruction Manual

DALI LS PD LI Osram Sensor for Luminaire, DALI LS PD LI, Osram Sensor for Luminaire, Sensor for Luminaire

encelium

References

- [Encelium - Exceptional Lighting Management](#)
- [Encelium Help Center](#)

Manuals+,

- [home](#)
- [privacy](#)