



enbrighten 61749 Color Changing LED Pop-Up Lantern User Guide

[Home](#) » [enbrighten](#) » enbrighten 61749 Color Changing LED Pop-Up Lantern User Guide 

enbrighten®



**Battery Powered
Pop-up Lantern
Quick Start Guide**

Congratulations on your Enbrighten Battery Powered Pop-up Lantern! Be sure to hold onto these instructions for later use.

Contents

- [1 GET TO KNOW YOUR LANTERN!](#)
- [2 BATTERY INSTALLATION](#)
- [3 Troubleshooting:](#)
- [4 THANK YOU FOR YOUR PURCHASE!](#)
- [5 Documents / Resources](#)
- [6 Related Posts](#)

GET TO KNOW YOUR LANTERN!

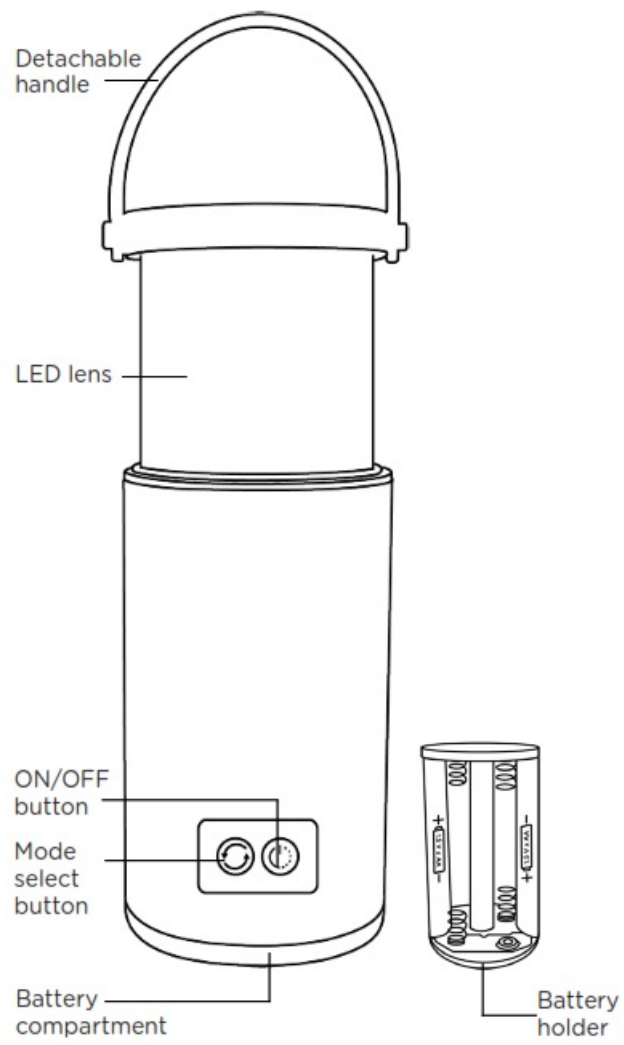

BATTERY INSTALLATION

1. Remove the battery cover.
2. Remove battery holder and insert 4 AA batteries, noting polarity.
3. Reinsert battery holder and cover, using the arrows for guidance.

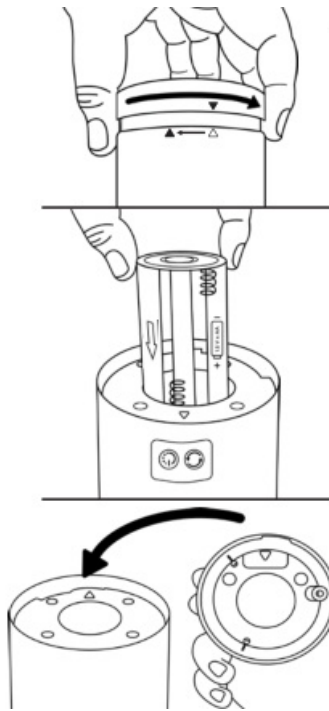

Rotate clockwise to align arrows

Note: Compartments must be properly snapped together to close.

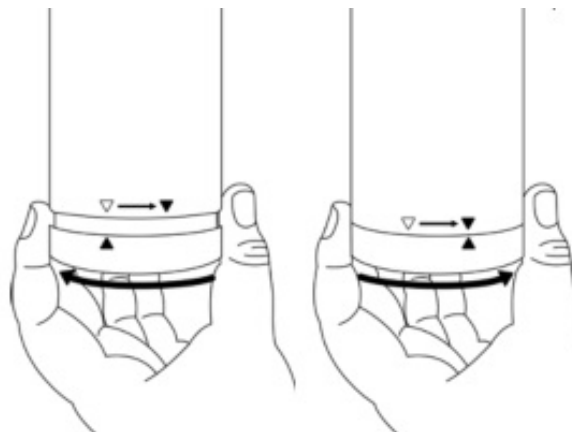

Open for a lantern, close for diffused light

Note: The lantern can be rotated 360° and the handle can easily be removed.

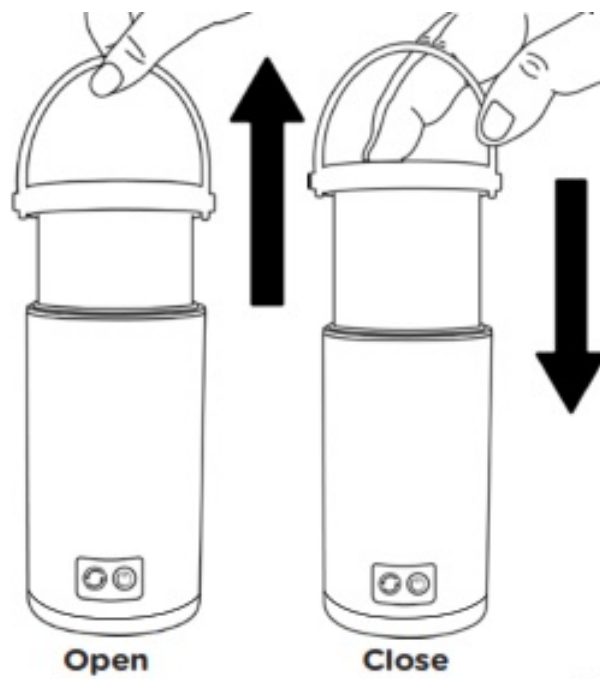

Power button

Note: The light will only turn off when the power button is pressed — not when the lantern is closed.

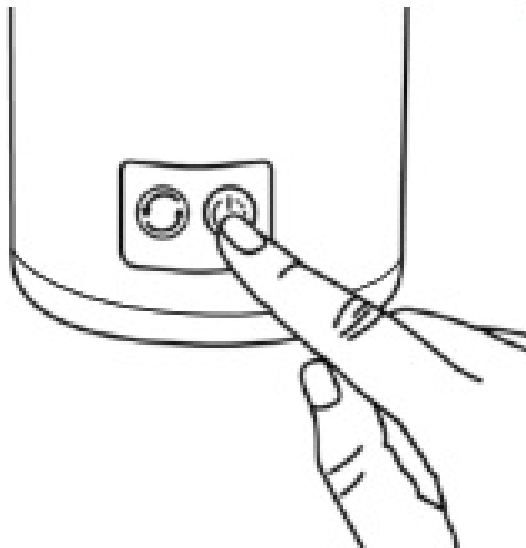

Mode-select button

- White
- Amber
- Candle flicker
- Color fade – Cycles through eight colors
- Color-Select™ – Manually choose a color
- S.O.S.

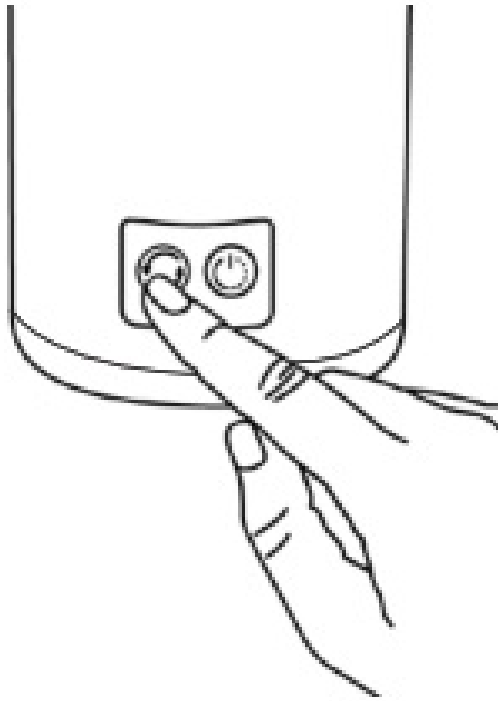

Full-range dimming

Note: Candle flicker, color fade, and S.O.S. are not dimmable.

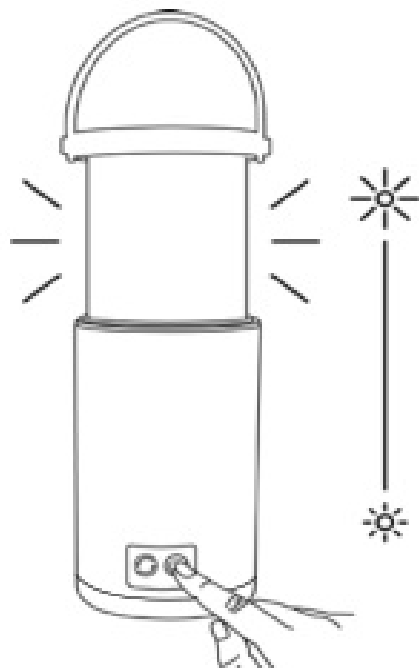

Diffused light mode

While closed, use the power and mode-select buttons to shine a diffused night-light glow through the body of the lantern — operation remains the same.

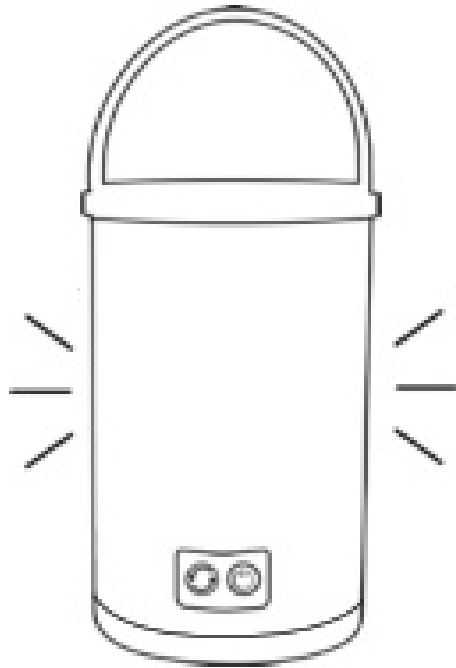

Memory feature

When turned off and on again, the lantern will return to the previously used mode and brightness level.

Troubleshooting:

Problem	Solution
Lantern flickers, output decreases, no light visible or shuts off	Replace all 4 AA batteries

IMPORTANT: READ CAREFULLY AND KEEP MANUAL FOR FUTURE USE



- DO NOT MIX OLD AND NEW OR OTHER BATTERY TYPES.
- REPLACE ALL BATTERIES AT THE SAME TIME.
- REPLACE FULLY DISCHARGED BATTERIES IMMEDIATELY.
- REMOVE BATTERIES IF THE PRODUCT IS TO BE UNUSED FOR AN EXTENDED PERIOD OF TIME.
- ALWAYS PURCHASE THE CORRECT SIZE AND GRADE OF BATTERY MOST SUITABLE FOR THE INTENDED USE.
- CLEAN THE BATTERY CONTACTS AND ALSO THOSE OF THE DEVICE PRIOR TO BATTERY INSTALLATION.
- ENSURE THE BATTERIES ARE INSTALLED CORRECTLY WITH REGARD TO POLARITY (+ AND -).

THANK YOU FOR YOUR PURCHASE!

Instructions made easy

Read instructions or watch the easy-to-follow videos.

Scan code or visit byjasco.com/61749i



<https://byjasco.com/61749i>





Exclusive deals

For deals, to register your purchase and to tell us how we’re doing, simply scan the code or visit byjasco.com/deals



Discover more innovative lighting at byjasco.com/lighting

	<p>Like our product? Leave a review on your favorite retailer website or amazon.com</p>
	<p>Having problems? Let us know how we can help. Call 1-800-654-8483 between</p>



byjasco.com/recycle

paper made from 25%
post-consumer waste

MADE IN CHINA

Distributed by Jasco Products Company LLC,
10 E. Memorial Rd., Oklahoma City, OK 73114.

This Jasco product comes with a 2-year limited warranty.

Visit www.byjasco.com for warranty details.

Questions? Contact our U.S.-based Consumer Care at
1-800-654-8483 between 7 AM-8 PM, M-F, Central Time.

61749, 61746,

61745, 61743,

61753 v1 08/21

Documents / Resources



[enbrighten 61749 Color Changing LED Pop-Up Lantern](#) [pdf] User Guide

61749, 61746, 61745, 61743, 61753, Color Changing LED Pop-Up Lantern, 61749 Color Changing LED Pop-Up Lantern, Battery Powered Pop-up Lantern