



EMTEK Sandcast Bronze Rustic Modern Rectangular Pocket Mortise Lock Keyed Function Installation Guide

[Home](#) » [Emtek](#) » EMTEK Sandcast Bronze Rustic Modern Rectangular Pocket Mortise Lock Keyed Function Installation Guide 

Contents

- [1 EMTEK Sandcast Bronze Rustic Modern Rectangular Pocket Mortise Lock Keyed Function](#)
- [2 Thread Drive Bar Cylinder](#)
- [3 Install Lock Body](#)
- [4 Install outside and inside plates](#)
- [5 Tighten Key Cylinder](#)
- [6 Install Trim Plate](#)
- [7 Install Door Jamb](#)
- [8 Documents / Resources](#)
- [9 Related Posts](#)

EMTEK®

EMTEK Sandcast Bronze Rustic Modern Rectangular Pocket Mortise Lock Keyed Function



Thread Drive Bar Cylinder

Use Cylinder Key to thread Drive Bar Cylinder clockwise on interior side of door.

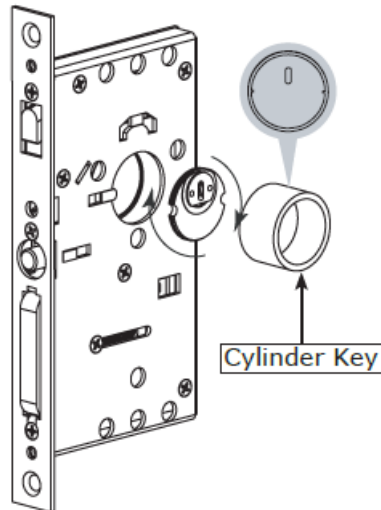

Note: Notches on cylinder must be parallel with the horizontal plane when fully screwed into lock body.

Install Lock Body

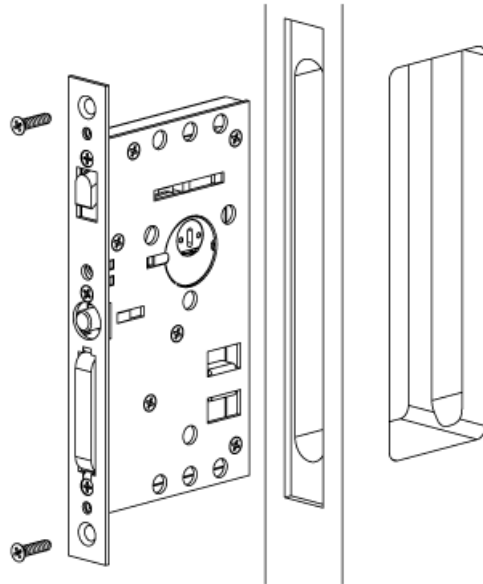

Install outside and inside plates

Outside

Inside

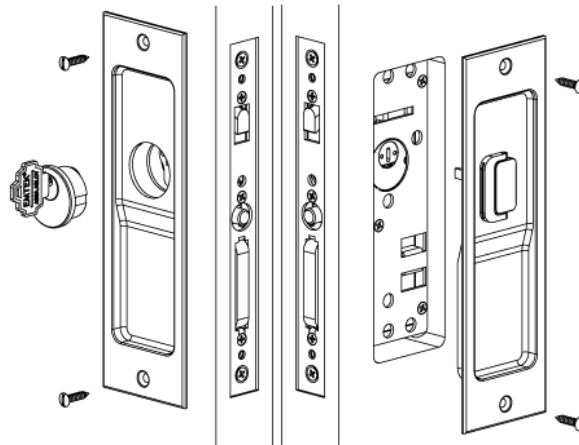

Tighten Key Cylinder

Tighten locking screw to engage notch on cylinder

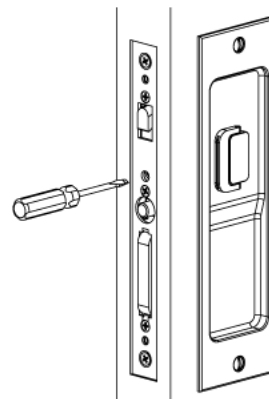

Install Trim Plate

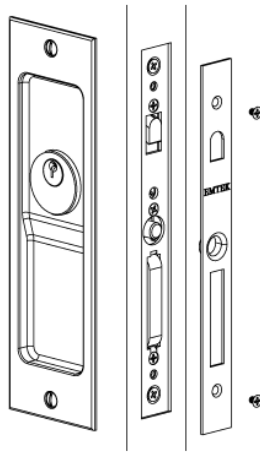

Install Door Jamb

Drill two 7/64"
pilot holes

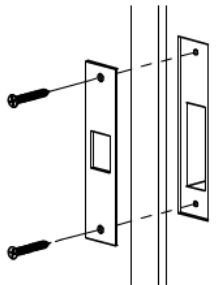

See template for door
jamb prep specifications

Documents / Resources

| | |
|--|---|
| | <p>EMTEK Sandcast Bronze Rustic Modern Rectangular Pocket Mortise Lock Keyed Function [pdf] Installation Guide</p> <p>Sandcast Bronze Rustic Modern Rectangular Pocket Mortise Lock Keyed Function, Sandcast Bronze Rustic Modern Rectangular Pocket Mortise Lock, Modern Rectangular Pocket Mortise Lock, Rectangular Pocket Mortise Lock, Pocket Mortise Lock, Mortise Lock, Lock</p> |
|--|---|