



## EMTEK Modern Style and Classic Style Electronic Keypad Lever Locksets Installation Guide

[Home](#) » [Emtek](#) » EMTEK Modern Style and Classic Style Electronic Keypad Lever Locksets Installation Guide



# EMTEK®

### Installation & Programming Guide

Modern Style & Classic Style Electronic Keypad Lever Locksets



Modern Style Keypad

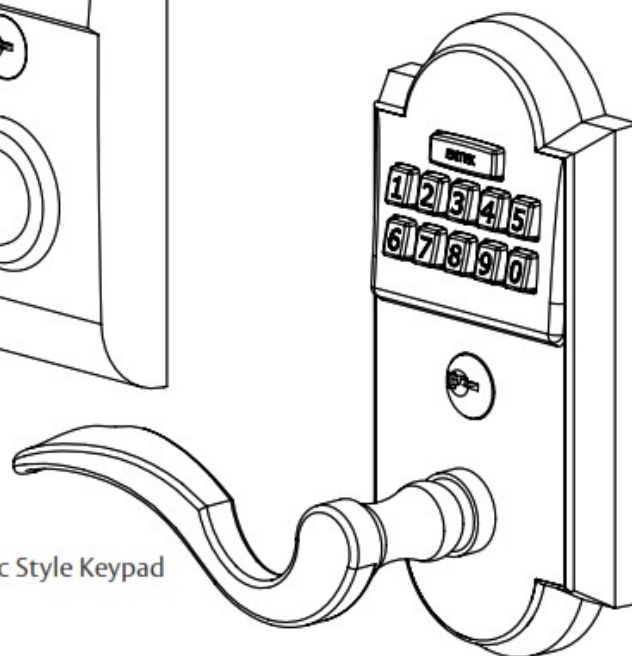

Classic Style Keypad

## Contents

- [1 What's in the Box](#)
- [2 Preparation](#)
- [3 How to Install](#)
- [4 How to Use](#)
- [5 How to Program](#)
- [6 Restoring the Lock to Factory Default Setting](#)
- [7 Documents / Resources](#)
  - [7.1 References](#)
- [8 Related Posts](#)

## What's in the Box

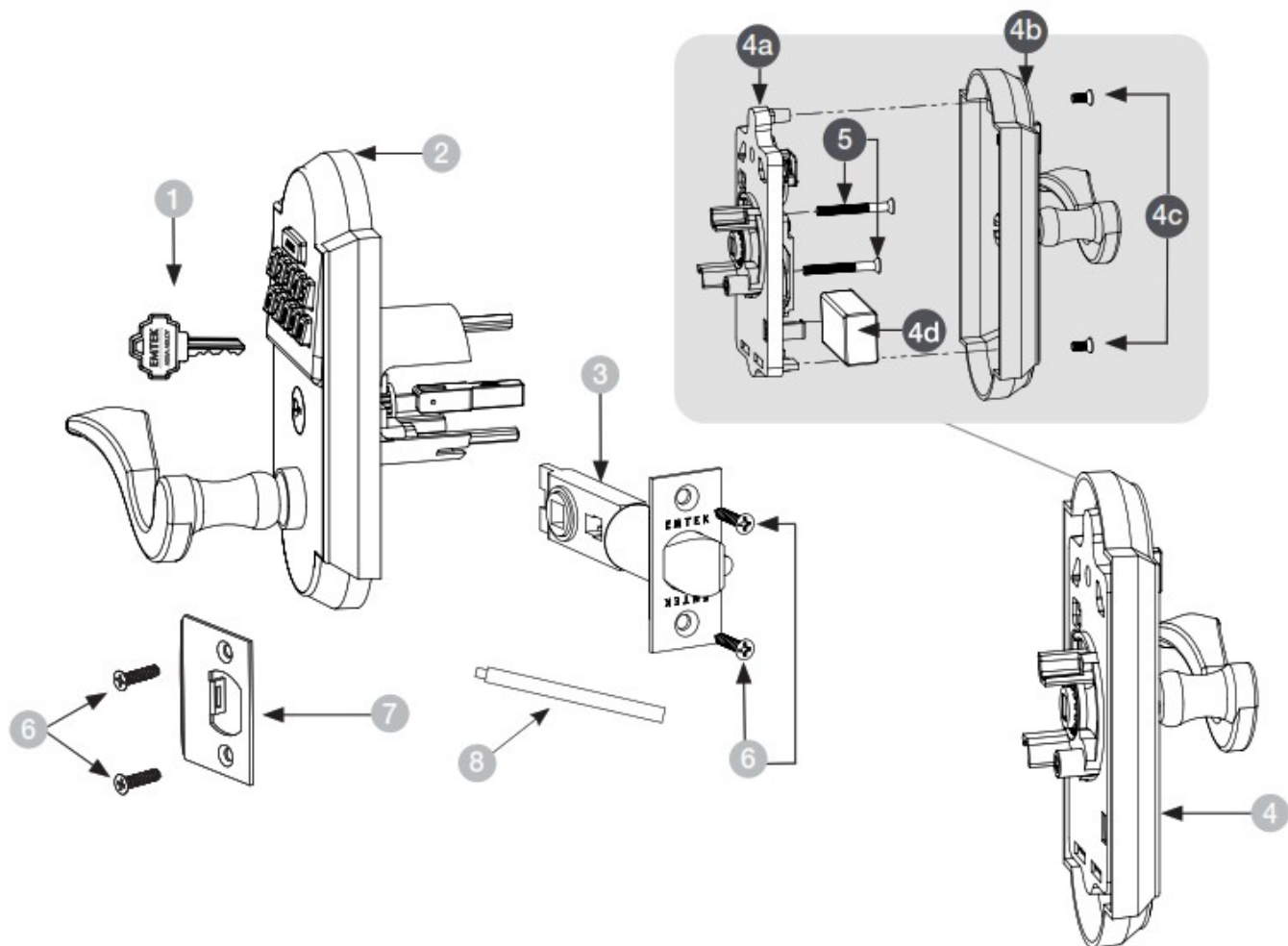

ITEM NO.	DESCRIPTION	QTY.
1	Key	2
2	Outside Trim Plate Assembly	1
3	Latch for 23/8" or 23/4" Backset	1
4	Inside Trim Plate Assembly	1
4a	Inside Chassis	1
4b	Inside Trim Plate	1
4c	#8-32 x 3/8" Flat Head Machine Screw	2
4d	9V Alkaline Battery	1
5	#8-32 x 1 1/2" Flat Head Machine Screw	2
6	#8 x 3/4" Wood Screw	4
7	Strike Plate	1
8	Plastic Extender	1

## Preparation

### Confirm Handing

HANDING OF DOOR IS ALWAYS DETERMINED FROM THE OUTSIDE

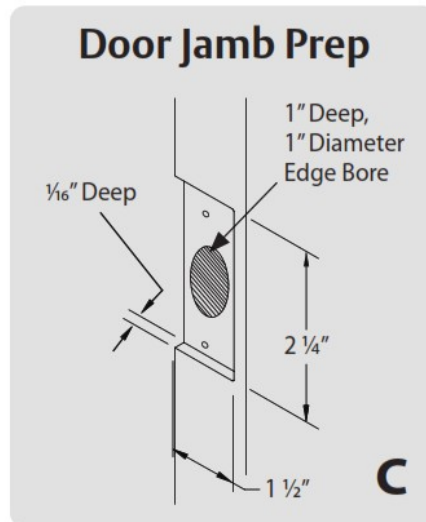
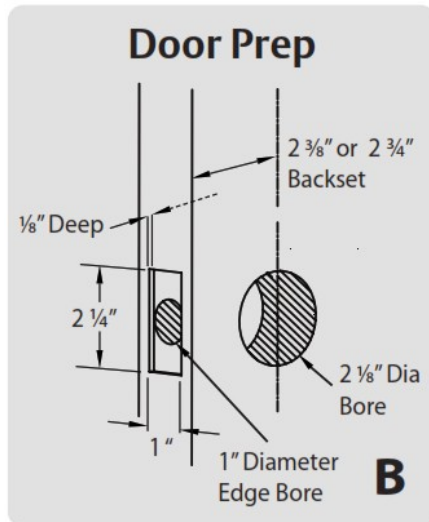
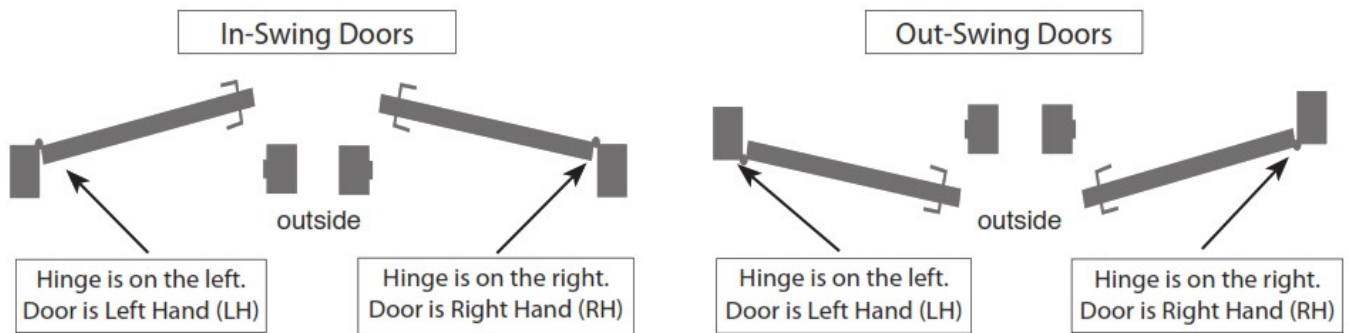

## How to Install

### 1. Install Latch

Fasten Latch using two #8 x 3/4" Wood Screws (item #6).

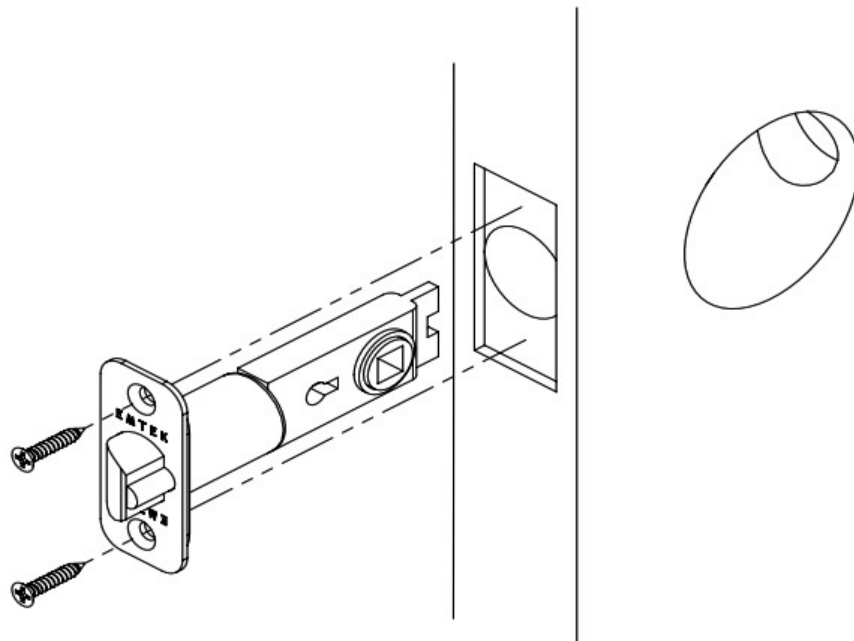

### Remove Screws from Inside Trim Plate

Use a Phillips head screwdriver to remove screws (item #4c) shown below and detach Inside Trim Plate from the Inside Chassis.



Remove inside chassis from trim plate before installing the outside trim. Thumbturn must be in neutral position.

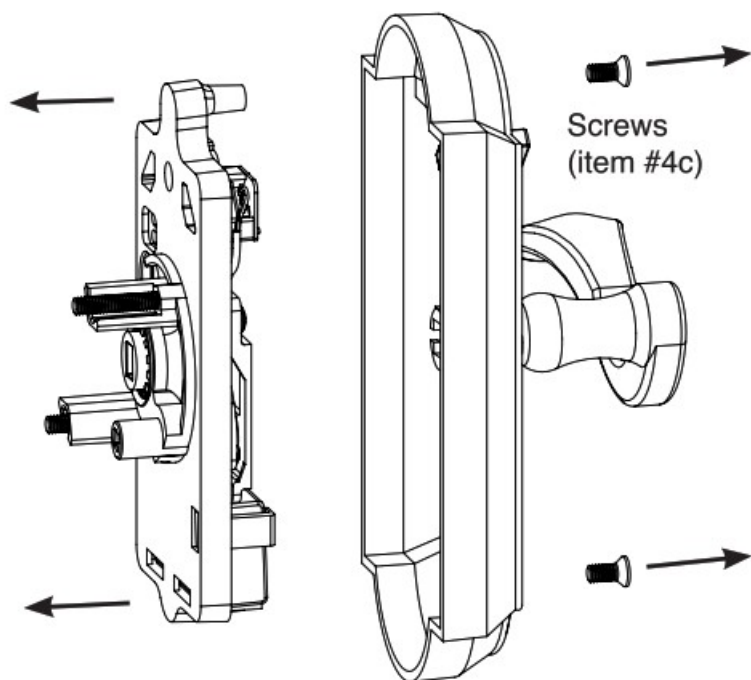

### Install Outside Trim Plate Assembly

**STEP1** While holding Outside Trim

Plate Assembly, Press the Plastic Extender (A) into end of Spindle Shaft (B). The Shaft is properly aligned when the marking 'TOP' can be seen from an overhead view.

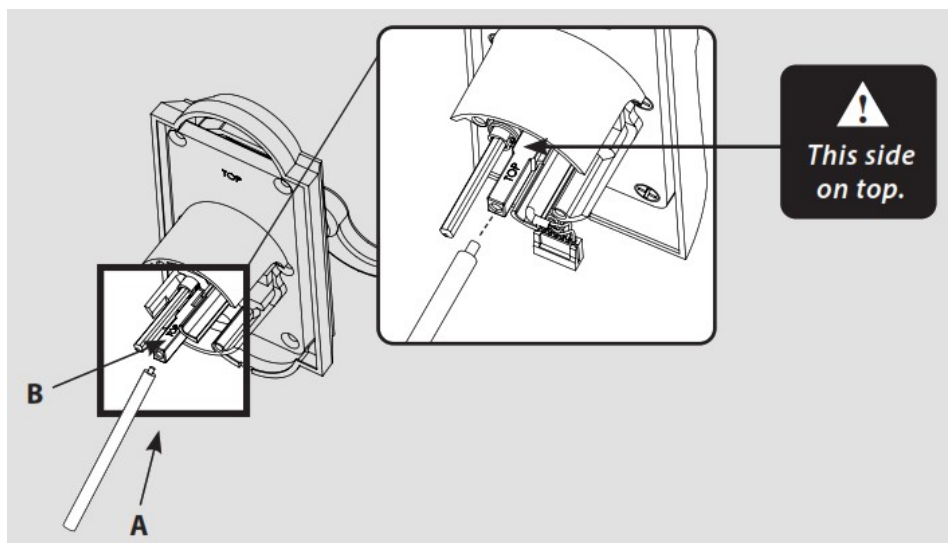

**STEP 2** Position the Outside Trim Plate Assembly through the bore hole.



Once positioned, outside trim plate assembly requires support.

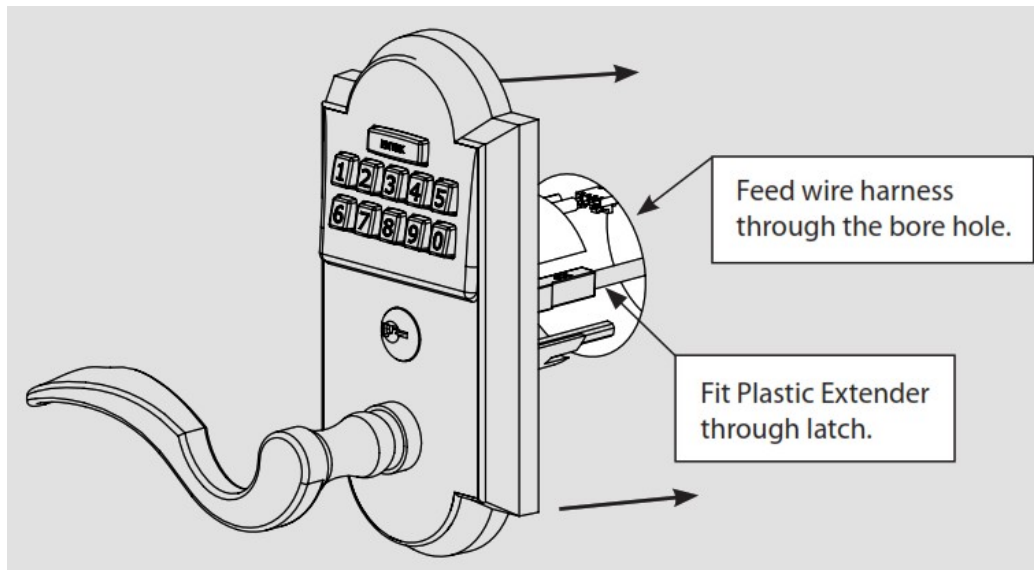

**STEP 3** With the Outside Trim Plate Assembly flush to the door, **REMOVE** the Plastic Extender.

### Install Inside Chassis

#### STEP 1

Confirm the position of Cam Link.

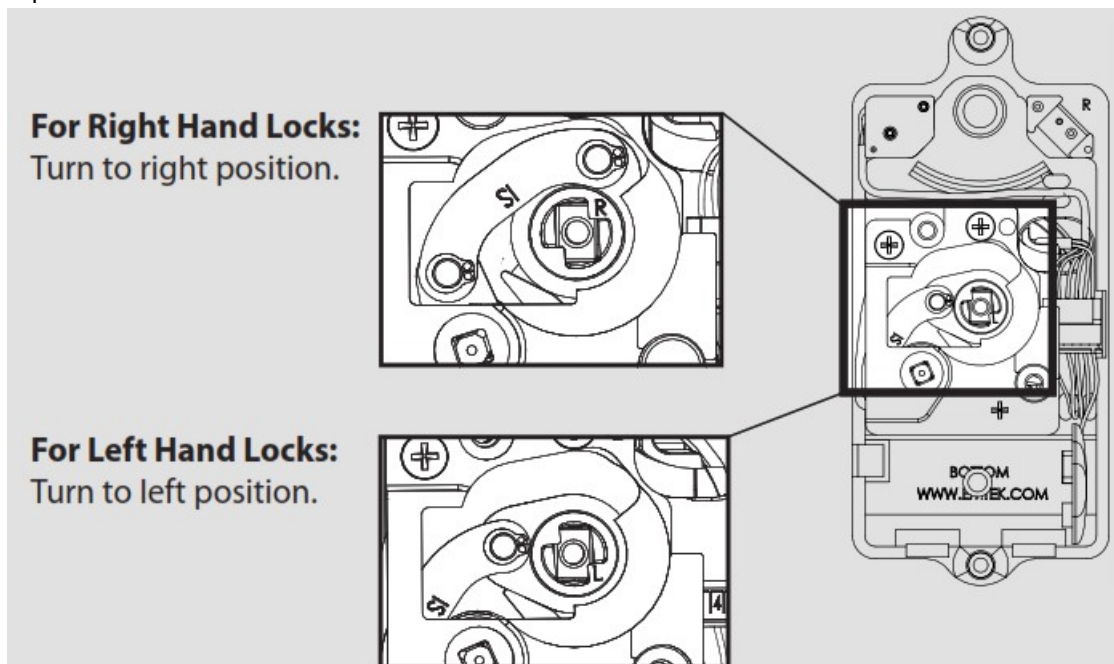

Cam link must remain in the correct position during installation.

#### STEP 2

Feed the Wire Harness through Inside Chassis.

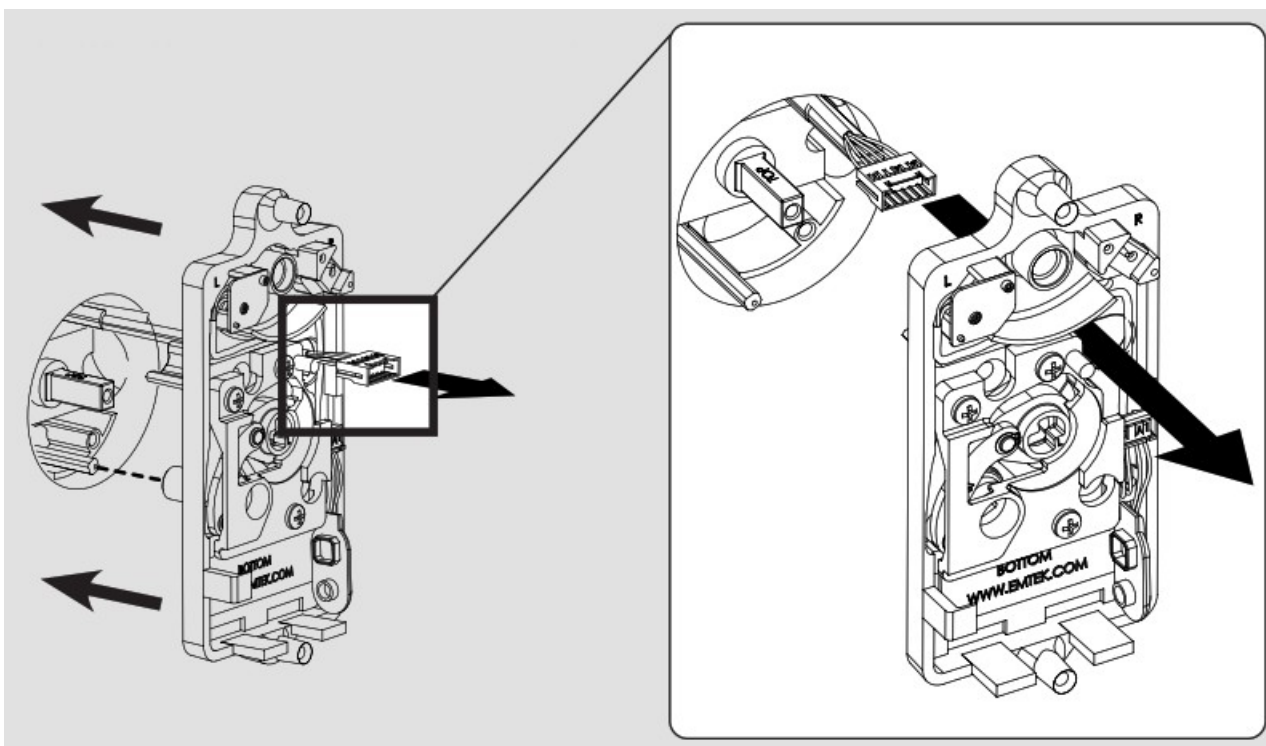

### STEP 3

Fasten Inside Chassis using two #8-32 x 11/2" Flat Head Machine Screw (item #5).

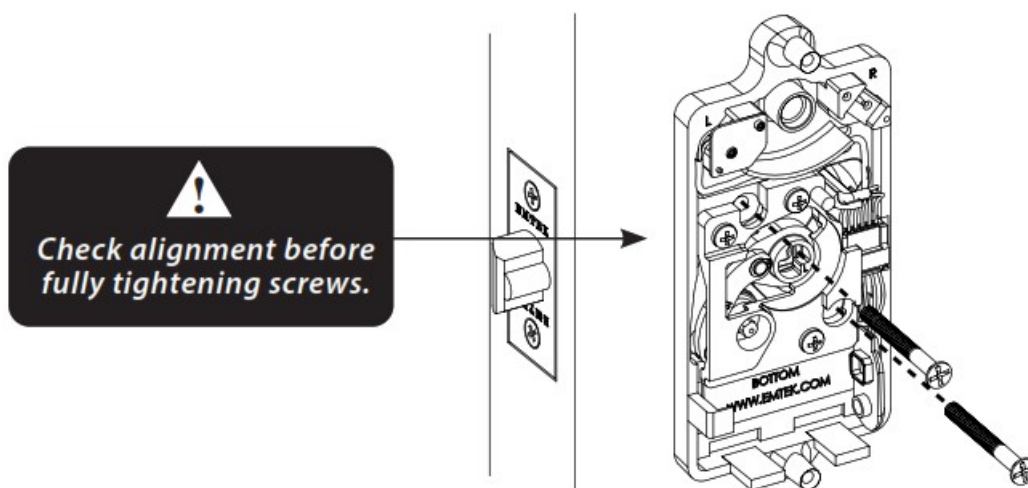

### STEP 4

Connect Wire Harness (A) and tuck Connectors as shown (B).



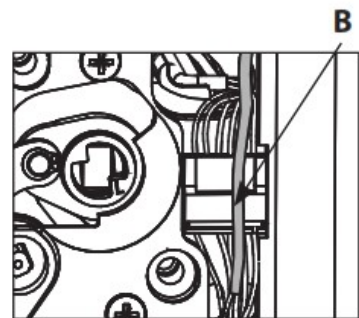
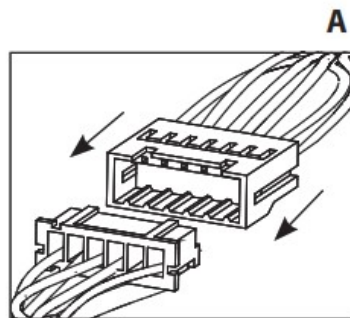
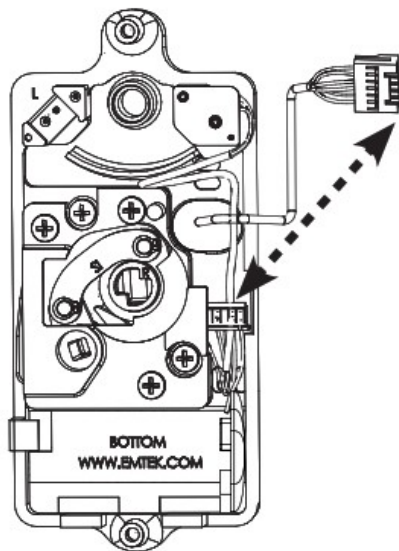

## STEP 5

Install Battery.

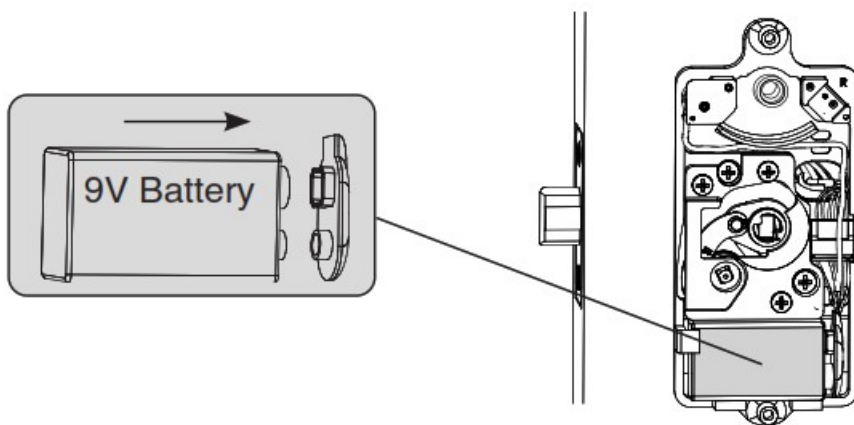

*For optimal performance, always use a good quality battery.*

## Install Inside Trim Plate

Fasten Inside Trim Plate using two #8-32 x 3/8" Flat Head Machine Screws (item #4c).

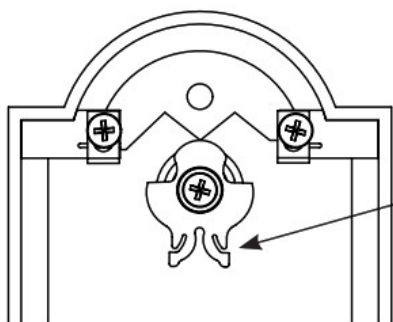

**!**  
User codes are located on the inside trim plate & back cover page.

**!**  
Correct position for installation. Thumbcam must be positioned as shown (Neutral Position)\*

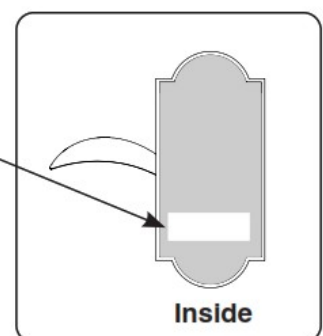

\*Neutral position is required for installation and removal of the Inside Trim Plate Assembly.  
(Does not apply to Keypad Storeroom/Gate product)



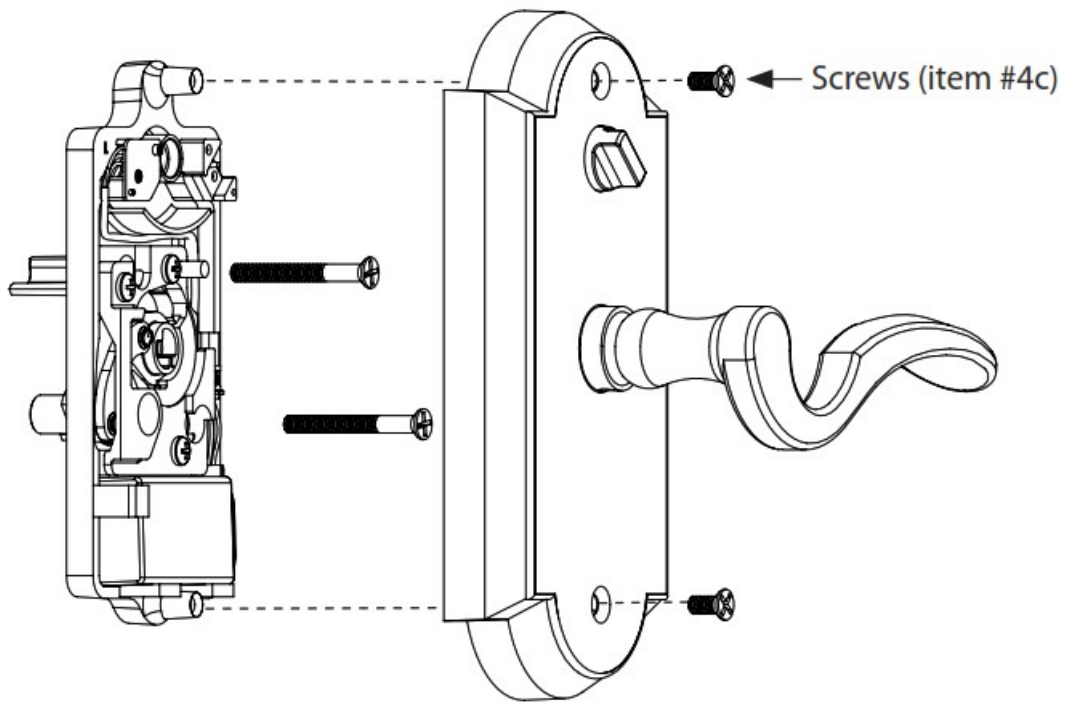

## How to Use

### Your Lock is Ready to Use

Your Emttek lock is shipped with two 4-digit user codes and a 6-digit programming code. These codes are randomly generated at the factory.  
(Turn to next page for Programming Instructions.)

### To Unlock:

1. Enter 4-digit user codes.  
(See sticker located on the inside trim plate or back cover page).
2. Turn Handle.

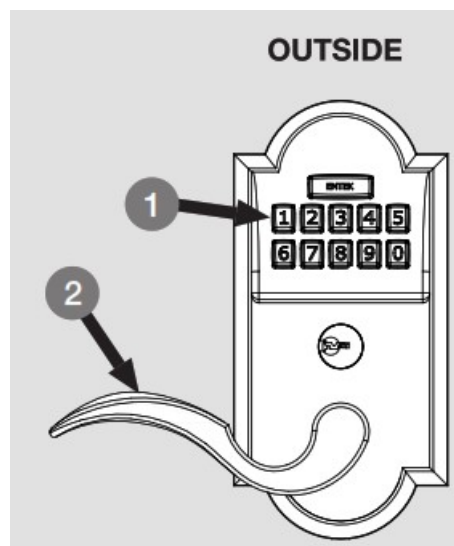

### Passage Feature

(Does not apply to Keypad Storeroom/Gate product)

Activate by turning the inside thumbturn to the unlocked position. This will engage the outside lever so a code is not required to enter.

### To Lock

1. Rotate Thumbturn from inside.

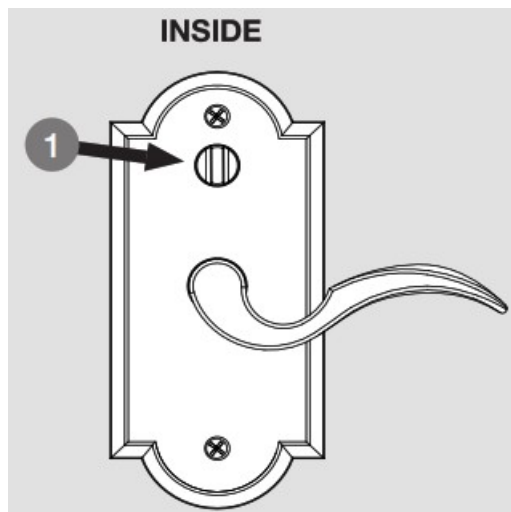
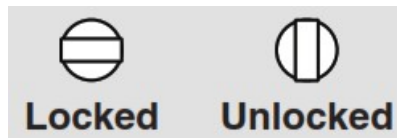

## How to Program

### Programming Your Lock

In order to perform each of the following six functions, the lock must first be placed in Programming Mode:

1. Press and hold EMTEK button for 3 seconds
2. Yellow LED flashes, then remains solid\*
3. Enter Programming Code
4. Green LED flashes, then 2 beeps
5. Yellow LED remains solid (awaiting button press; see following table)

If You Wish To	Press Button	Actions		Indicators
Change Programming Code (6 digits)	1	Enter New Programming Code (6 digits)	Re-Enter New Programming Code (6 digits)	<ul style="list-style-type: none"> <li>•1 Green LED flash</li> <li>•1 beep</li> <li>•1 Green LED flash</li> <li>•1 beep</li> <li>•2 Green LED flashes</li> <li>•2 beeps</li> </ul>
Add User Code (4 digits) (Store up to 20 User Codes)	2	Enter New User Code (4 digits)	Re-Enter New User Code (4 digits)	<ul style="list-style-type: none"> <li>•1 Green LED flash</li> <li>•1 beep</li> <li>•1 Green LED flash</li> <li>•1 beep</li> <li>•2 Green LED flashes</li> <li>•2 beeps</li> </ul>
Delete User Code	3	Enter User Code to be Deleted	Re-Enter User Code to be Deleted	<ul style="list-style-type: none"> <li>•1 Green LED flash</li> <li>•1 beep</li> <li>•1 Green LED flash</li> <li>•1 beep</li> <li>•2 Green LED flashes</li> <li>•2 beeps</li> </ul>
**Enable/Disable All User Codes	4	Entering '4' disables all Users (enables all if disabled)		<ul style="list-style-type: none"> <li>•2 Green LED flashes</li> <li>•2 beeps</li> </ul>
Delete All User Codes	5	Re-Enter Programming Code		<ul style="list-style-type: none"> <li>•1 Green LED flash</li> <li>•1 beep</li> <li>•2 Green LED flashes</li> <li>•2 beeps</li> </ul>
Turn Beeper On/Off	6	Entering '6' turns Off (or ON)		<ul style="list-style-type: none"> <li>•1 Green LED flash</li> <li>•1 beep</li> <li>•2 Green LED flashes</li> <li>•2 beeps</li> </ul>

\*If no input within 10 seconds, Yellow LED goes out, Red LED flashes and lock exits Programming Mode.

\*\*Also referred to as “vacation mode”. This command temporarily disables all user codes (metal key override will still work).

### Keypad Operation – Beeper & LED Indicators

Function	Indicators
Valid Code	<ul style="list-style-type: none"> <li>• 1 short beep, EMTEK button flashes Green.</li> </ul>
Invalid Code/Access Denied*	<ul style="list-style-type: none"> <li>• 1 Red LED flash</li> <li>• 2 short beeps</li> </ul>
Lock-Out Mode Error	<ul style="list-style-type: none"> <li>• 2 short beeps</li> <li>• 1 short beep per second for duration</li> </ul>
Access Accepted	<ul style="list-style-type: none"> <li>• 1 short beep</li> <li>• 1 Green LED flash</li> </ul>
Low Battery	<ul style="list-style-type: none"> <li>• 4 Red LED flashes</li> <li>• 4 short beeps</li> </ul>
Blackout Battery**	<ul style="list-style-type: none"> <li>• 1 long Red LED flash</li> <li>• 4 long beeps</li> </ul>
Button Press Accepted	<ul style="list-style-type: none"> <li>• 1 Yellow LED flash</li> <li>• 1 Short Beep</li> </ul>
Outside Thumb Turn Enabled	<ul style="list-style-type: none"> <li>• 2 Green LED flashes</li> </ul>

\* If 3 consecutive incorrect codes are entered, the lock emits 4 short beeps and a flashing Red EMTEK button. The lock will not accept additional input for 20 seconds (20 beeps). When the next valid code is entered the lock will beep quickly 3 times to alert of the incorrect codes.

\*\* Battery voltage has dropped too low; keypad will be disabled but metal key override will still work.

## Restoring the Lock to Factory Default Setting

This procedure clears the lock of all users and restores the Programming Code and 2 User Codes shipped with the lock.

- Remove power (disconnect 9V battery) from Lock.
- Press and hold EMTEK button.
- While continuing to hold EMTEK button, restore power (reconnect 9V battery).
- Continue to hold EMTEK button for 3 seconds.
- 1 Green LED flash and 2 short beeps followed by 1 Green LED Flash and 2 short beeps indicates the lock has been successfully restored

U.S. patents: **8,176,761 8,141,400**

Canadian patents: **2,698,041 2,789,278 2,789,280**

# EMTEK®

**Emtek Products**

Tel: 800-356-2741 • 626-961-0413  
Fax: 800-577-5771 • 626-336-2812  
[emtek.com](http://emtek.com)

Copyright © Emtek Products, ASSA ABLOY Residential Group Inc. DBA Emtek Products, 2021  
Reproduction in whole or in part without the express written permission of Emtek Products is prohibited.  
**IN8-KEYPADLL**

## Documents / Resources

	<p><b><a href="#">EMTEK Modern Style and Classic Style Electronic Keypad Lever Locksets</a></b> [pdf] Installation Guide</p> <p>Modern Style and Classic Style Electronic Keypad Lever Locksets, Modern Style Electronic Keypad Lever Locksets, Classic Style Electronic Keypad Lever Locksets, Electronic Keypad Lever Locksets, Electronic Lever Locksets, Keypad Lever Locksets, Lever Locksets, Keypad Locksets, Electronic Locksets, Locksets</p>
---	--

## References

- [E Home Page | Emtek](#)

[Manuals+](#)