



EMTEK Large Multi Point Dummy Function for Door Lock Installation Guide

[Home](#) » [Emtek](#) » EMTEK Large Multi Point Dummy Function for Door Lock Installation Guide 

Contents

- [1 EMTEK Large Multi Point Dummy Function for Door Lock](#)
- [2 Align Mounting Plate](#)
- [3 Install Mounting Plate](#)
- [4 Install Trim Plates](#)
- [5 Tighten Set Screw](#)
- [6 Documents / Resources](#)
- [7 Related Posts](#)

EMTEK®

EMTEK Large Multi Point Dummy Function for Door Lock



Align Mounting Plate

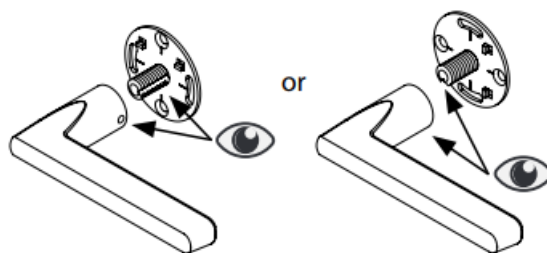

Install Mounting Plate

Adjust for level

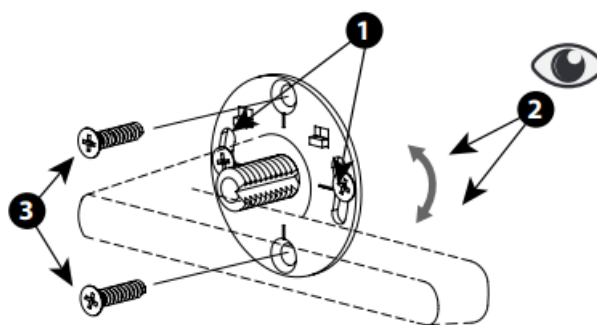

Install Trim Plates

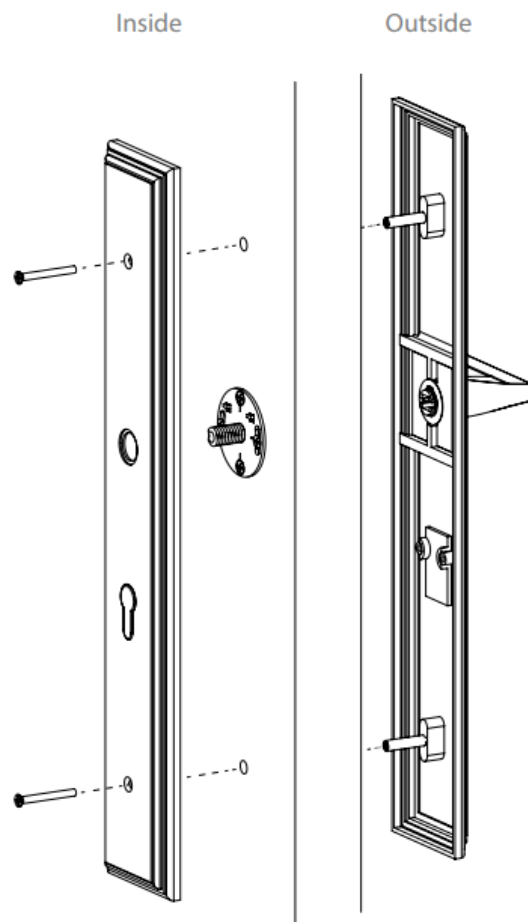

Tighten Set Screw

Note: For general info only.
Do NOT use as a drilling
template.

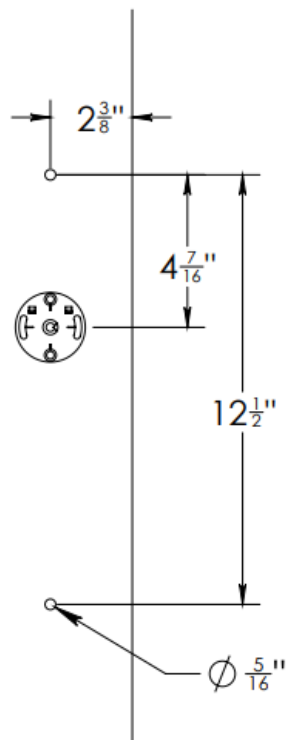

Documents / Resources

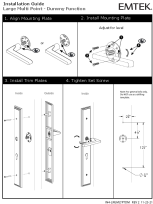
| | |
|--|---|
|  The diagram shows the installation steps for the EMTEK Large Multi Point Dummy Function for Door Lock. It includes a title 'Installation Guide' and 'EMTEK'. The steps are: 1. Mounting the Lock Body, 2. Mounting the Lock Body, 3. Mounting the Lock Body, 4. Mounting the Lock Body. The diagram shows the lock body being mounted to the door frame and the door handle being installed. | <p>EMTEK Large Multi Point Dummy Function for Door Lock [pdf] Installation Guide IN4-LRGMLTPTDM, Large Multi Point Dummy Function, Large Multi Point, Large Multi Point Du mmy Function for Door Lock</p> |
|--|---|

Manuals+.

