



[Home](#) » [EMS](#) » **EMS FCX Series FireCell Combined Sounder Detector Visual Indicator
Installation Guide** 

Contents [[hide](#)]

1 EMS FCX Series FireCell Combined Sounder Detector Visual Indicator

2 Combined Sounder/Detector/Visual Indicator

3 1. Pre installation

4 2. Components

5 3. Fix mounting plate

6 4. Power device

7 5. Device locking

8 6. Important

9 7. Configuration

10 8. Switches

10.1 Device power/volume/flash only (set on wireless module)

10.2 Sounder tone (set on wireless module)

11 Specification

12 Regulatory information

13 Specifications:

14 QUICK Usage Instructions:

14.1 1. Pre-Installation:

14.2 2. Components:

14.3 3. Fix Mounting Plate:

14.4 4. Power Device:

14.5 5. Device Locking:

14.6 6. Important!

14.7 7. Configuration:

14.8 8. Switches:

15 Frequently Asked Questions (FAQ):

15.1 Q: Can I use rechargeable batteries with this device?

15.2 Q: How do I change the sounder tone?

16 Documents / Resources

16.1 References

17 Related Posts

EMS FCX Series FireCell Combined Sounder Detector Visual Indicator



INSTALLATION GUIDE

Combined Sounder/Detector/Visual Indicator

Example shown:

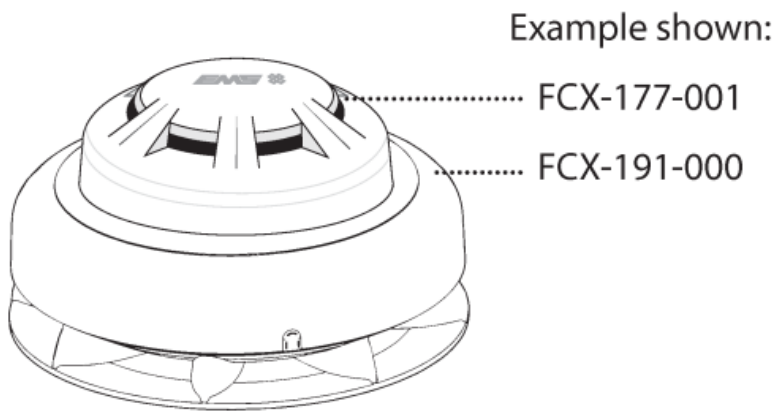

Part no	Description
FCX-174-001	Multisensor Smoke Detector Only
FCX-175-001	Heat A1R Detector Only
FCX-176-001	Heat CS Detector Only
FCX-177-001	Optical Smoke Detector Only

FCX-191-000	Sounder/Detector Base Only
FCX-191-200	Sounder/Detector/Red Visual Indicator Base Only

See the Specification section for compliance information.

1. Pre installation

Installation must conform to applicable local installation codes and should only be installed by a fully trained competent person.

- Ensure that the device is installed as per the site survey.
- The use of a non-metallic spacer should be considered if mounting the device on to a metal surface.
- Do NOT press the log on button on a pre-programmed device, as this will cause communication with the control panel to be lost. Should this happen, delete the device from the system and add it back on.
- This device contains electronics that may be susceptible to damage from Electrostatic Discharge (ESD). Take appropriate precautions when handling electronic boards.
- For pre-2024 versions of this device with a 4-way power/sounder configuration switch, refer to the legacy version of this manual.

2. Components

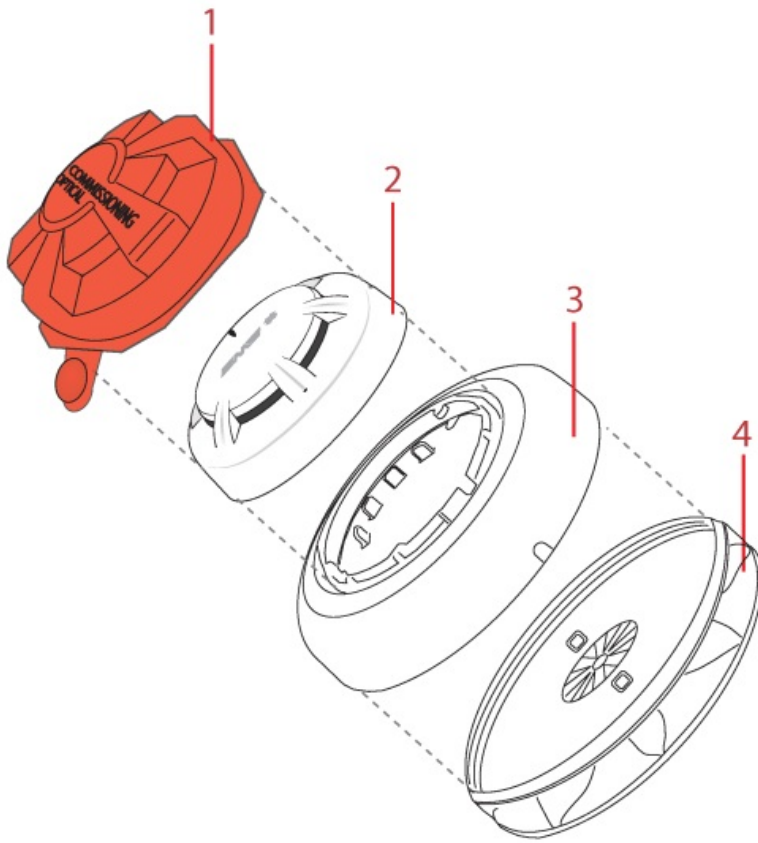

1. Dust cover,
2. Detector,
3. Wireless module,
4. Mounting plate

3. Fix mounting plate

Remove the mounting plate by turning the device **ANTICLOCKWISE**, to release it from the mounting plate.

- Use both fixing positions to ensure a firm fixing.
- Use suitable fasteners and fixings

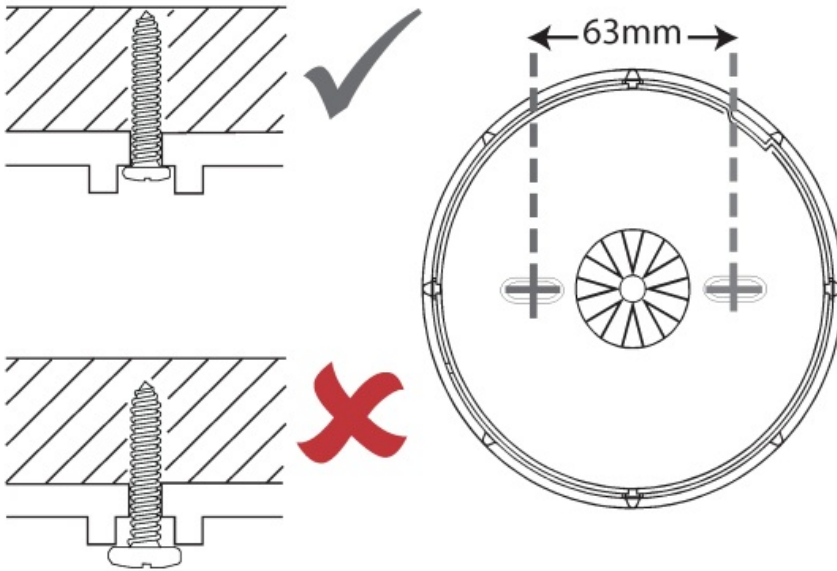

4. Power device

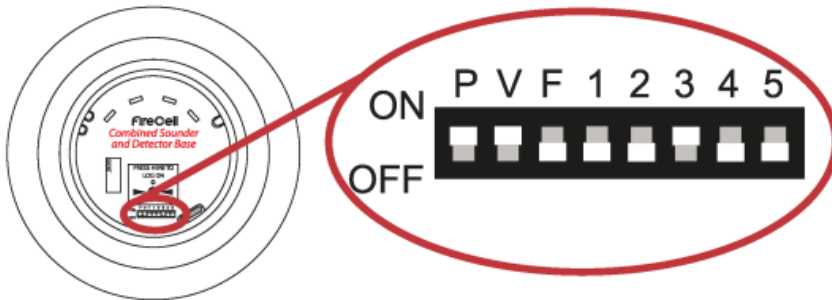

- When fitting / replacing batteries; observe correct polarity, using only specified batteries.
- Set the P (POWER) switch to the ON position to power the device. See the 'Switches' section for other available switch settings.
- Once powered, reassemble the device.

5. Device locking

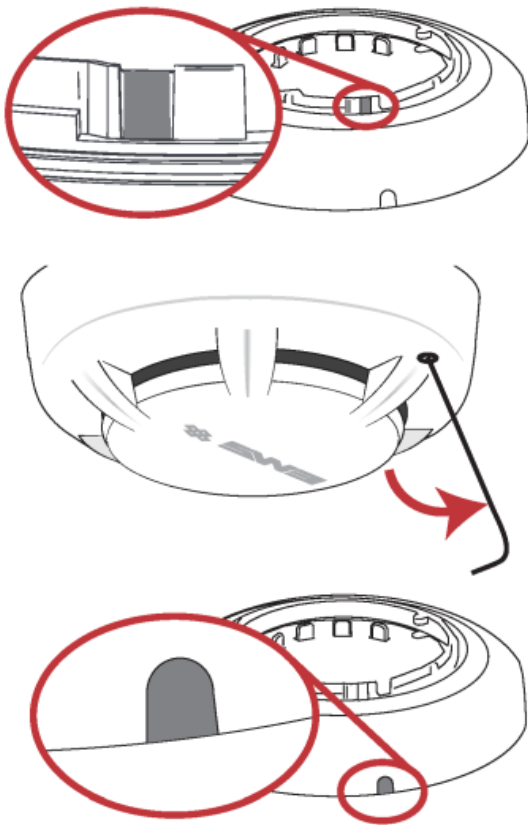

- To lock the detector into the wireless module, remove the cut out (shaded) section as shown.
- To unlock the detector, insert a 1.5 mm allen key and lever the allen key towards the outside of the device and turn the detector anticlockwise to release.
- The wireless module can also be locked into the mounting plate by removing the shaded section shown and fitting a 5/16 Phillips pan head screw.

6. Important

- Remove dust cover before use.
- The device should be tested upon installation and in accordance with local requirements.
- Testing should only be carried out by a fully trained competent person.
- The manufacturer recommends regular functional testing of at least once per annum or in accordance with local codes of practice.
- Cleaning and repairs must be undertaken by the manufacturers authorised representative.
- Do not open the case to clean inside the detector.
- When activated, the device will sound for a maximum of 30 minutes before switching

off to conserve battery life.

7. Configuration

This device is intended to form part of a wireless fire alarm system. The device's loop address is configured within the user interface's menu structure.



Refer to the programming manual for full programming details.

FireCell = MK98

Fusion = TSD062

WZM = TSD143

Free to download from www.emsgroup.co.uk

8. Switches

Device power/volume/flash only (set on wireless module)



The PVF switches control the device's power supply, adjust the sounder volume and, if necessary, initiate flash only mode (sounder off).

SWITCHES	POWER (P)	VOLUME (V)	FLASH ONLY (F)
<div>ON OFF</div> <div>P V F</div> <div>ON OFF</div>	OFF	HIGH	
<div>ON OFF</div> <div>P V F</div> <div>ON OFF</div>	ON	HIGH	
<div>ON OFF</div> <div>P V F</div> <div>ON OFF</div>	ON	LOW	
<div>ON OFF</div> <div>P V F</div> <div>ON OFF</div>	ON	LOW	*
<div>ON OFF</div> <div>P V F</div> <div>ON OFF</div>	ON	HIGH	*

= Default setting.

* Flash only mode is applicable to the FCX-191-200 model only. If selected, this is not within the scope of EN54-3.

Sounder tone (set on wireless module)

Switches 1 to 5 select the sounder tone.

= Default setting.

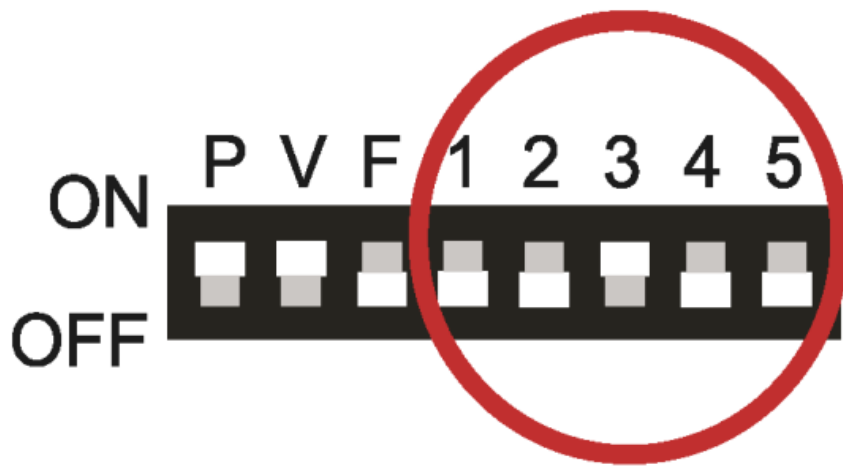





Note: Tones 1, 2, 3, 5, 6, 7, 10, 13, 21 are EN54-3 approved tones. Secondary tones and low volume settings are not approved.

SWITCHES	PRIMARY TONE	TONE TYPE	TONE DESCRIPTION / APPLICATION	SECONDARY TONE
<div>1 2 3 4 5</div> <div>ON OFF</div>	1	————	970Hz	18
<div>ON OFF</div>	2		800Hz/970Hz at 2Hz	1
<div>ON OFF</div>	3		800Hz - 970Hz at 1Hz	1
<div>ON OFF</div>	4	- - - -	970Hz 1s OFF / 1s ON	1
<div>ON OFF</div>	5		970Hz, 0.5s / 630Hz, 0.5s	4
<div>ON OFF</div>	6		554Hz, 0.1s / 440Hz, 0.4s (AFNOR NF S 32 001)	1
<div>ON OFF</div>	7		500 - 1200Hz, 3.5s / 0.5s OFF (NEN 2575:2000)	1
<div>ON OFF</div>	8	- - - -	420Hz 0.625s ON / 0.625s OFF (Australia AS1670 Alert tone)	9
<div>ON OFF</div>	9		500 - 1200Hz, 0.5s / 0.5s OFF x 3 / 1.5s OFF (AS1670 Evacuation)	1
<div>ON OFF</div>	10		550Hz / 440Hz at 0.5Hz	19
<div>ON OFF</div>	11	--- ---	970Hz, 0.5 ON / 0.5s OFF x 3 / 1.5s OFF (ISO 8201)	1
<div>ON OFF</div>	12	--- ---	2850Hz, 0.5s ON / 0.5s OFF x 3 / 1.5s OFF (ISO 8201)	1
<div>ON OFF</div>	13		1200Hz - 500Hz at 1Hz (DIN 33 404)	1
<div>ON OFF</div>	14	————	400Hz	18
<div>ON OFF</div>	15		550Hz, 0.7s / 1000Hz, 0.33s	1
<div>ON OFF</div>	16		1500Hz - 2700Hz at 3Hz	1
<div>ON OFF</div>	17	————	750Hz	1
<div>ON OFF</div>	18	————	2400Hz	1
<div>ON OFF</div>	19	————	660Hz	18
<div>ON OFF</div>	20	- - - -	660Hz 1.8s ON / 1.8s OFF	19
<div>ON OFF</div>	21	- - - -	660Hz 0.15s ON / 0.15s OFF	19
<div>ON OFF</div>	22		510Hz, 0.25s / 610Hz, 0.25s	1
<div>ON OFF</div>	23		800 / 100Hz 0.5s each (1Hz)	1
<div>ON OFF</div>	24		250Hz - 1200Hz at 12Hz	1
<div>ON OFF</div>	25		500Hz - 1200Hz at 0.33Hz	1
<div>ON OFF</div>	26		2400Hz - 2900Hz at 9Hz	18
<div>ON OFF</div>	27		2400Hz - 2900Hz at 3Hz	18
<div>ON OFF</div>	28		800Hz - 970Hz at 100Hz	8
<div>ON OFF</div>	29		800Hz - 970Hz at 9Hz	1
<div>ON OFF</div>	30		800Hz - 970Hz at 3Hz	1
<div>ON OFF</div>	31	- -	800Hz, 0.25s ON / 1s OFF	1
<div>ON OFF</div>	32		500Hz - 1200Hz, 3.75s / 0.25s OFF (AS2220)	8

Specification

Operating temperature	-10 to +55 °C
Storage temperature	5 to 30 °C
Humidity	0 to 95% non-condensing
Supply	3 x AA alkaline (<i>Panasonic LR6AD Powerline / Varta 4006 Industrial</i>) & 3 x C alkaline (<i>Panasonic LR14AD Powerline / Varta 4014 Industrial</i>)
CAUTION! Fitting of an incorrect battery type invalidates the product certification and may result in poor performance.	
IP rating	IP21
Operating voltage	3.3 to 4.5 VDC
Current consumption	120 µA
Battery life	Up to 5 years (<i>based on weekly 30 second test</i>)
Operating frequency	868 MHz
Output transmitter power	Auto adjusting 0 to 14 dBm (<i>0 to 25 mW</i>)
Signalling protocol	X
Sounder output	Up to 99.5 dB(A) at 1 m (<i>as dispatched</i>). Low setting typically reduces volume by 10 dB.
Refer to the sounder data document (<i>MK187</i>) for full details. <i>Free to download from www.emsgroup.co.uk</i>	
Dimensions (Ø x D)	146 x 53 mm (<i>without detector</i>) 146 x 89 mm (<i>with smoke detector</i>) 146 x 94 mm (<i>with heat detector</i>) 146 x 100 mm (<i>with multisensor detector</i>)
Weight	0.70 kg (<i>with detector</i>)
Location	Type A: For indoor use
Intended use	Fire safety for fire detection and fire alarm systems with components using RF links.

Regulatory information

Manufacturing location	Carrier Manufacturing Poland Sp. z o.o. Ul. Kolejowa 24. 39-100 Ropczyce, Poland
Placed on the market by	EMS Ltd. Technology House, Sea Street, Herne Bay, Kent, CT6 8JZ
Year of manufacture	See devices serial number label
Certification	 0905 [1]  0905 [2][3]  2821 [4]  0359 [1][2][3]  0843 [4]
CPR DoP	See part listing for associated products: [1]0905-CPR-202126, [2]0359-CPR-0015, [3]0359-CPR-0017 & [4]DoP0012
Approved to	See part listing for associated products: EN54-5:2017+A1:2018. Incorporating Amendment No. 1. Fire detection and fire alarm systems. Part 5: Heat detectors - Point Detectors. [2] EN54-7:2018. Incorporating Amendment No. 1. Fire detection and fire alarm systems. Part 7: Smoke detectors - Point detectors using scattered light, transmitted light or ionization. [1][3] EN54-25:2008. Incorporating corrigenda September 2010 and March 2012. Fire detection and fire alarm systems. Part 25: Components using radio links. [4]
European Union Directives	EMS declares that this device is in compliance with Directive 2014/53/EU. The full text of the EU declaration of conformity is available at the following internet address: www.emsgroup.co.uk



2012/19/EU (WEEE directive). For more information see www.recyclethis.info
Dispose of your batteries in an environmentally friendly manner according to your local regulations.

Additional approvals



ULeu Certified to EN 54-3:2014+A1:2019. This is an accredited certification scheme run by UL Solutions and is in addition to EU regulatory requirements [4]

BOSEC Certification to EN 54-13:2017 system Certification. This component is approved by ANPi for the BOSEC mark when used with FireCell Fusion, HUB and RCC combinations.

Specifications:

- Operating temperature: 0°C to 50°C
- Storage temperature: -20°C to 60°C
- Humidity: 0 to 95% non-condensing
- Power Supply: 3 x AA alkaline batteries (Panasonic LR6AD Powerline / Varta 4006 Industrial)

QUICK Usage Instructions:

1. Pre-Installation:

Ensure that the installation complies with local installation codes and is carried out by a trained individual.

2. Components:

The package includes a dust cover, detector, wireless module, and mounting plate.

3. Fix Mounting Plate:

To fix the mounting plate, turn the device ANTICLOCKWISE to release it from the mounting plate.

4. Power Device:

Insert 3 x AA alkaline batteries into the designated compartment to power the device.

5. Device Locking:

Ensure the device is securely locked in place after installation.

6. Important!

This device is part of a wireless fire alarm system and should be configured within the user interface's menu structure.

7. Configuration:

The loop address of the device can be configured using the user interface menu.

8. Switches:

The switches control power/volume/flash settings. Refer to the user manual for detailed switch settings based on the model.

Frequently Asked Questions (FAQ):

Q: Can I use rechargeable batteries with this device?

A: It is recommended to use AA alkaline batteries for optimal performance. Rechargeable batteries may not provide the same level of reliability.

Q: How do I change the sounder tone?

A: The sounder tone can be changed using the switches on the wireless module. Refer to the provided tone chart in the user manual for approved tones and their descriptions.

Documents / Resources

	<p>EMS FCX Series FireCell Combined Sounder Detector Visual Indicator [pdf] Installation Guide</p> <p>FCX-174-001, FCX-175-001, FCX-176-001, FCX-177-001, FCX-191-000, FCX-191-200, FCX Series FireCell Combined Sounder Detector Visual Indicator, FireCell Combined Sounder Detector Visual Indicator, Sounder Detector Visual Indicator, Detector Visual Indicator, Visual Indicator</p>
---	---

References

- [User Manual](#)

Related Posts

[firecell FCX-191 Combined Sounder Detector Visual Indicator User Manual](#)

| Combined Sounder Detector Visual Indicator Pre-installation Installation must conform to applicable local installation codes and should...



EMS
3-0230-0001-99
Information White Sounder and Ceiling Visual Indicator



[EMS SC-33-0230-0001-99 Information White Sounder and Ceiling Visual Indicator Owner's Manual](#)

EMS SC-33-0230-0001-99 Information White Sounder and Ceiling Visual Indicator Product Usage Instructions

Installation The SmartCell Information Sounder and...

AS
-0200-0001
ual Smoke
Detector
combined
der



[EMS SC-22-0200-0001-99 Dual Smoke Heat Detector and Combined Sounder Owner's Manual](#)

EMS SC-22-0200-0001-99 Dual Smoke Heat Detector and Combined Sounder Specifications Product:

SmartCell Dual Smoke/Heat Detector and Combined Sounder...



[EXTECH ET20 Dual Indicator Voltage Detector User Manual](#)

EXTECH ET20 Dual Indicator Voltage Detector Model ET20 Dual Indicator Voltage Detector 2-Way AC/DC

Voltage Tester (100-250V) OPERATION...

EMS

Detector Visual Indicator, EMS, FCX Series FireCell Combined Sounder Detector Visual Indicator, FCX-174-001, FCX-175-001, FCX-176-001, FCX-177-001, FCX-191-000, FCX-191-200, FireCell Combined Sounder Detector Visual Indicator, Sounder Detector Visual Indicator, Visual Indicator

Leave a comment

Your email address will not be published. Required fields are marked *

Comment *

Name

Email

Website

☐ Save my name, email, and website in this browser for the next time I comment.

Post Comment

Search:

e.g. whirlpool wrf535swhz

Search

[Manuals+](#) | [Upload](#) | [Deep Search](#) | [Privacy Policy](#) | [@manuals.plus](#) | [YouTube](#)

This website is an independent publication and is neither affiliated with nor endorsed by any of the trademark owners. The "Bluetooth®" word mark and logos are registered trademarks owned by Bluetooth SIG, Inc. The "Wi-Fi®" word mark and logos are registered trademarks owned by the Wi-Fi Alliance. Any use of these marks on this website does not imply any affiliation with or endorsement.