



## emotn C1 Multimedia Projector User Manual

[Home](#) » [emotn](#) » emotn C1 Multimedia Projector User Manual 

### Contents

- 1 emotn C1 Multimedia Projector
- 2 PACKING LIST
- 3 FUNCTION OVERVIEW
- 4 QUICK START
- 5 INPUT SOURCE
  - 5.1 Media Connection
  - 5.2 HDMI Connection
  - 5.3 VGA Connection
  - 5.4 AV Connection
  - 5.5 TV Stick Connection
  - 5.6 Chromecast Connection
- 6 SCREEN MIRRORING
  - 6.1 For iOS Devices
  - 6.2 For Android Devices
- 7 PROJECTION CONNECTION
  - 7.1 Wired Connection
  - 7.2 Bluetooth Speaker Connection
- 8 PLACING THE PROJECTOR
- 9 PROJECTION DISTANCE & SIZE
- 10 SPECIFICATION
- 11 ATTENTION
- 12 WARNINGS AND PRECAUTIONS
- 13 TROUBLESHOOTING
- 14 NOTICE
  - 14.1 FCC STATEMENT
- 15 Documents / Resources
- 16 Related Posts

# emotn

## emotn C1 Multimedia Projector



## PACKING LIST

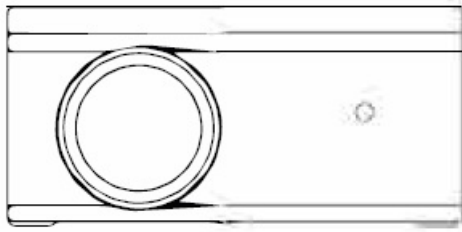

Projector

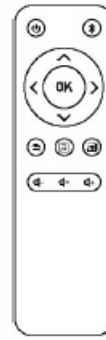

Remote Controller

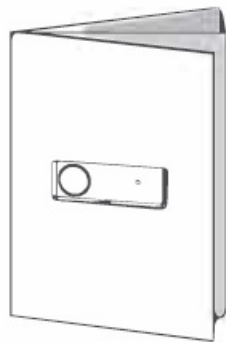

User Manual

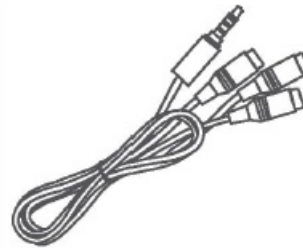

AV Cable

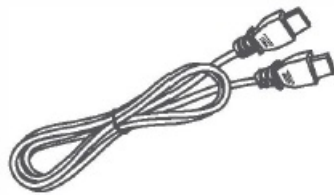

HDMI Cable

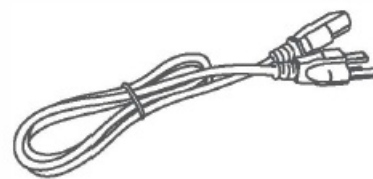

Power Cable

## FUNCTION OVERVIEW

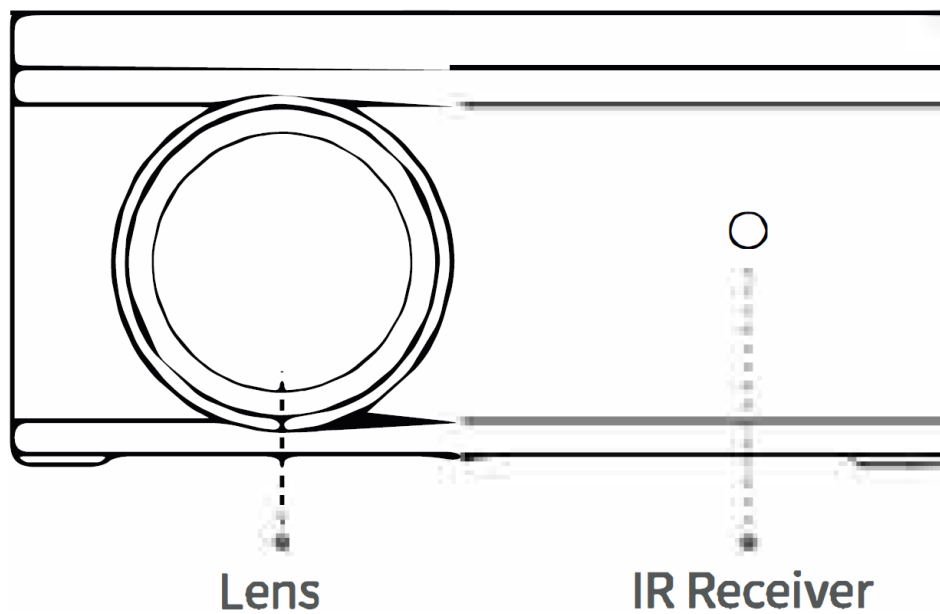
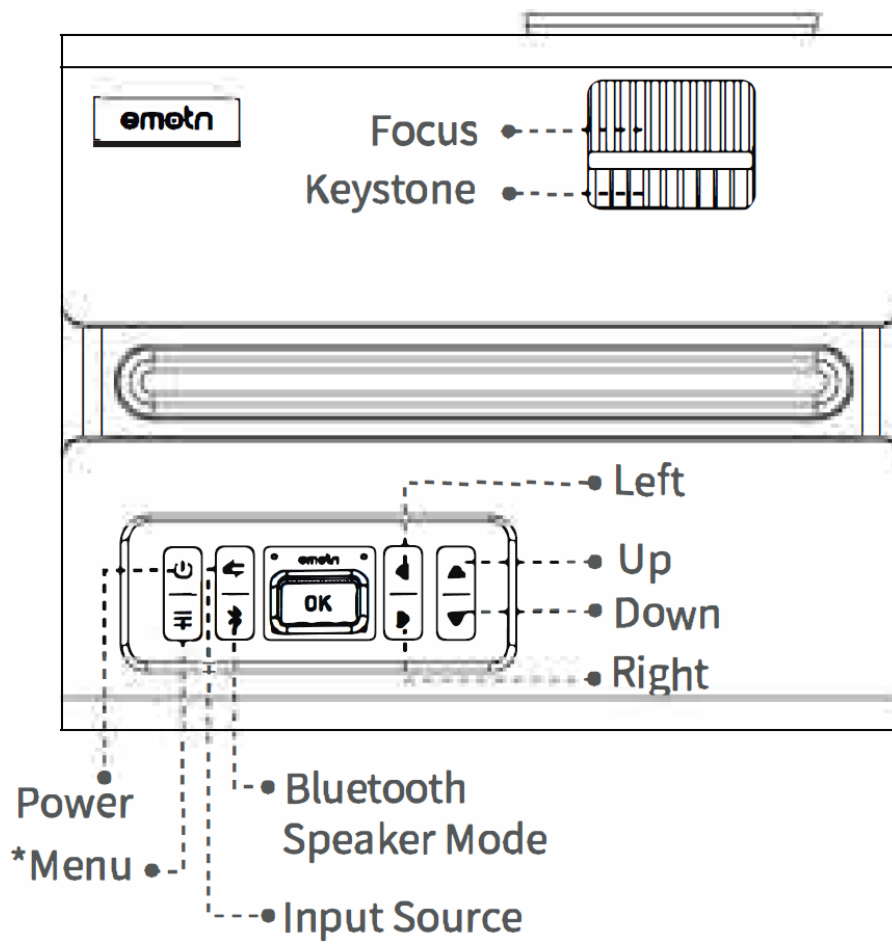

**\*Menu:** Return to the previous page via short press, or open the menu settings via long press.

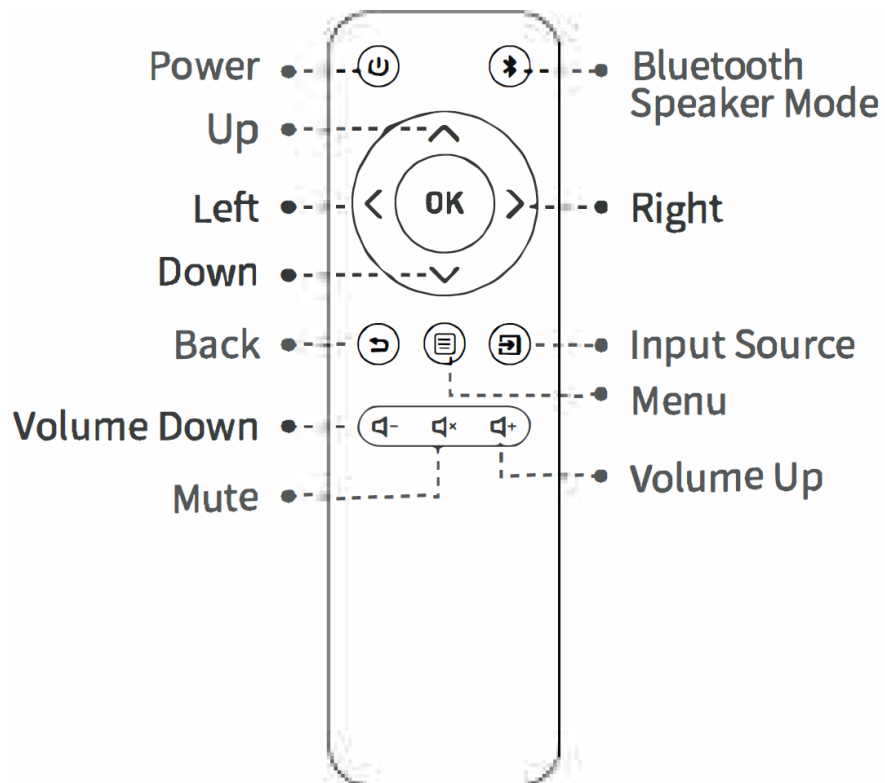
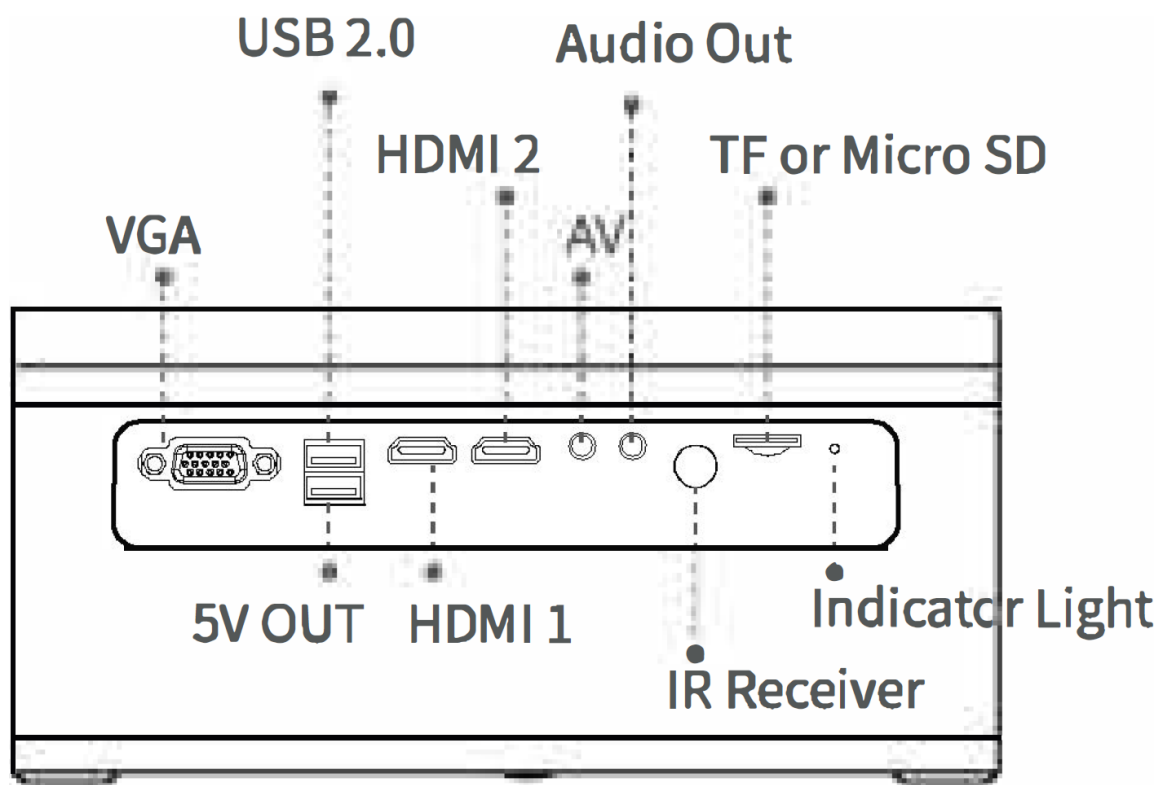

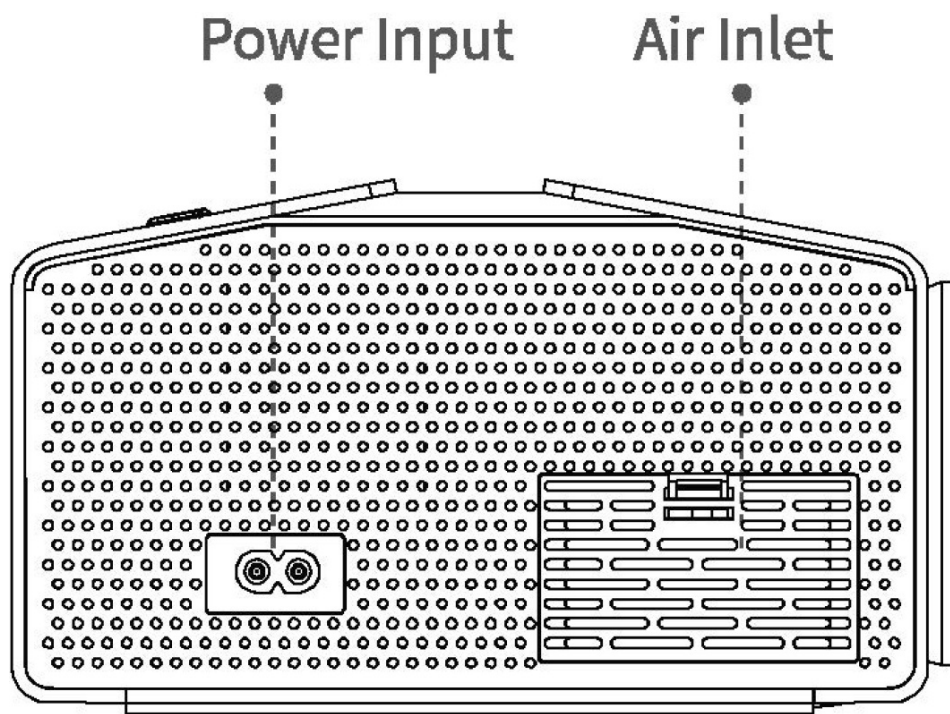

## QUICK START

1. Connect the power cable to the projector.

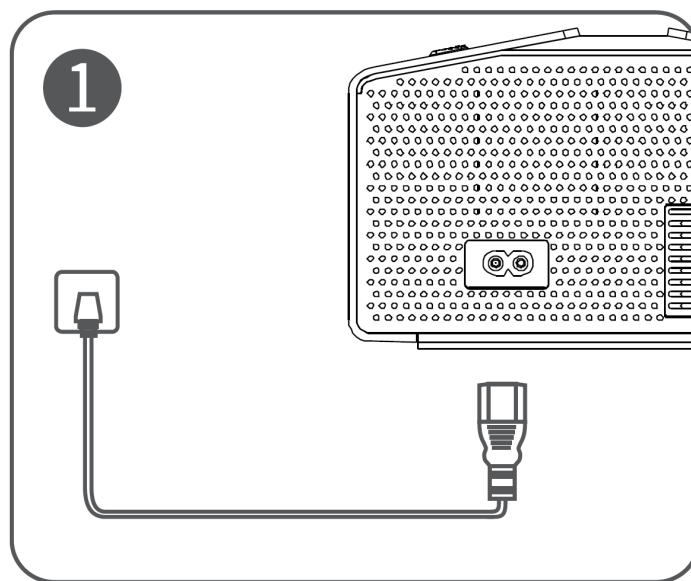

2. Take off the lens cover.

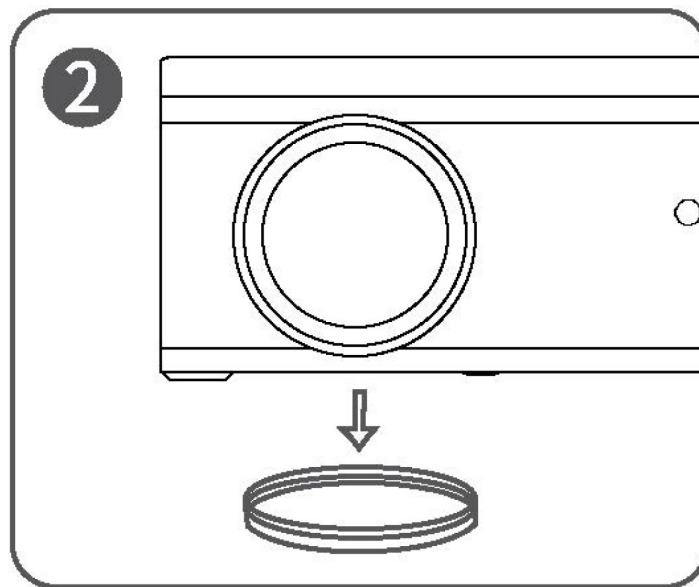

3. Connect your device to the projector correctly.

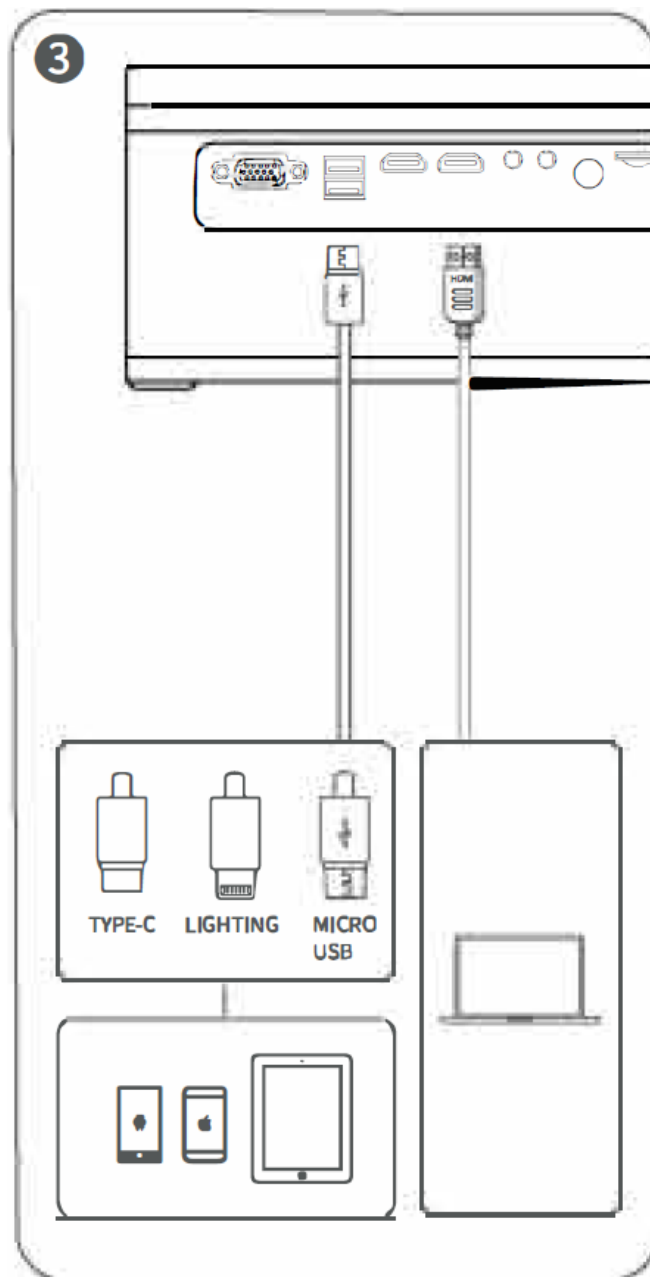

4. Press the power button to turn on the projector.

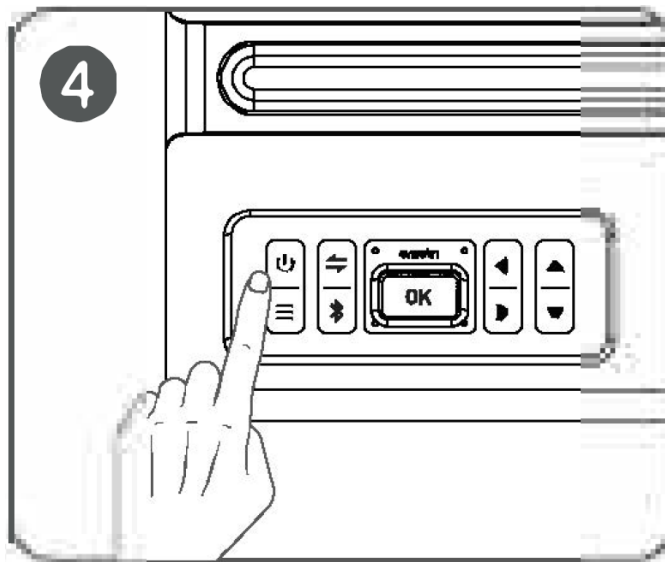

5. Choose the right type of program to play.

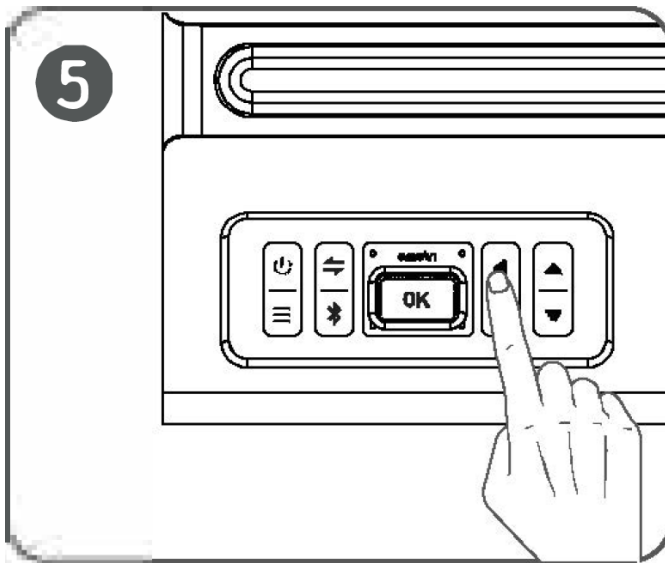

6. Adjust the keystone and focus ring to get best image performance.

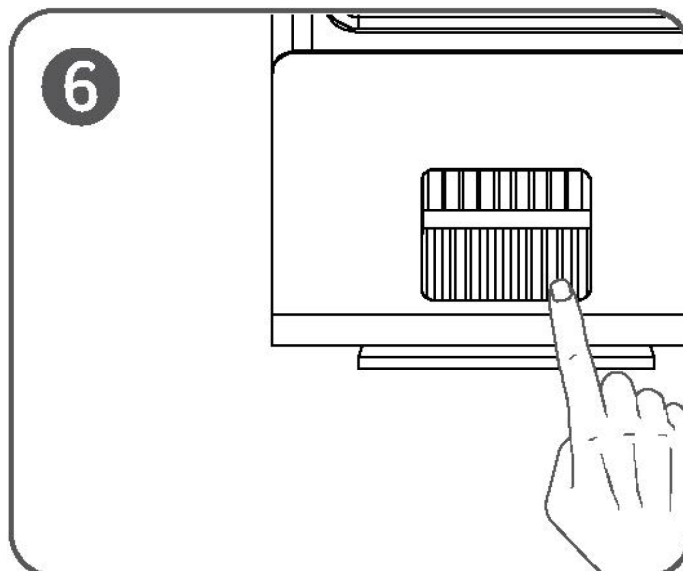

7. Press the power button to turn off the projector.



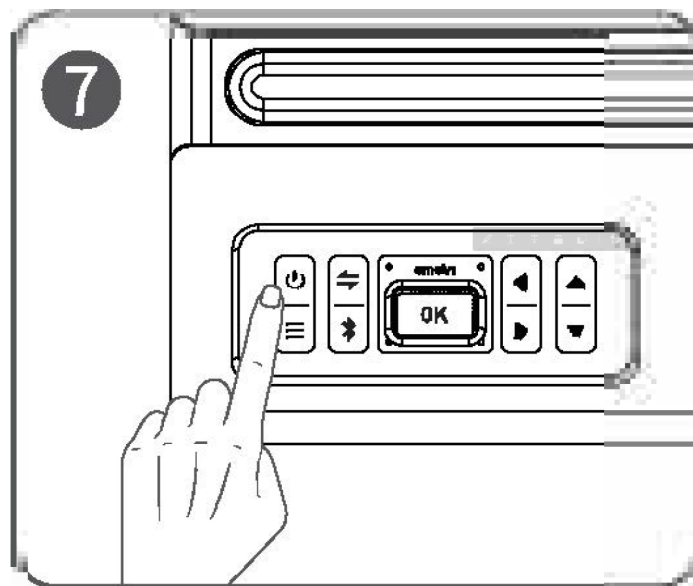

## INPUT SOURCE

### Media Connection

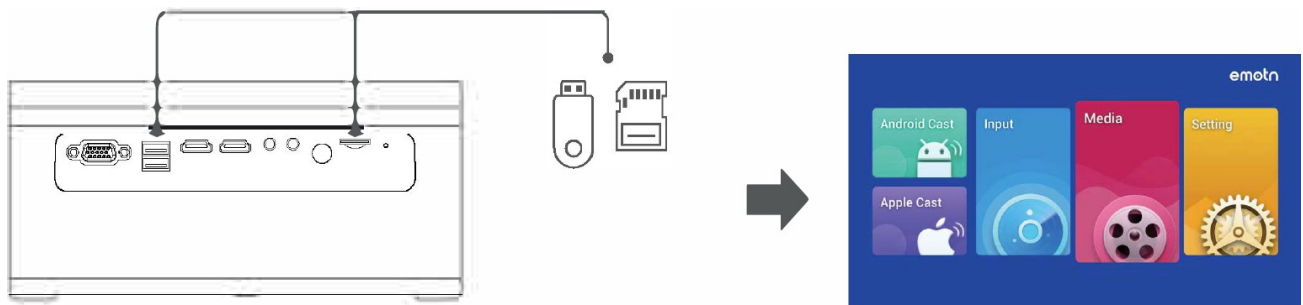

### HDMI Connection

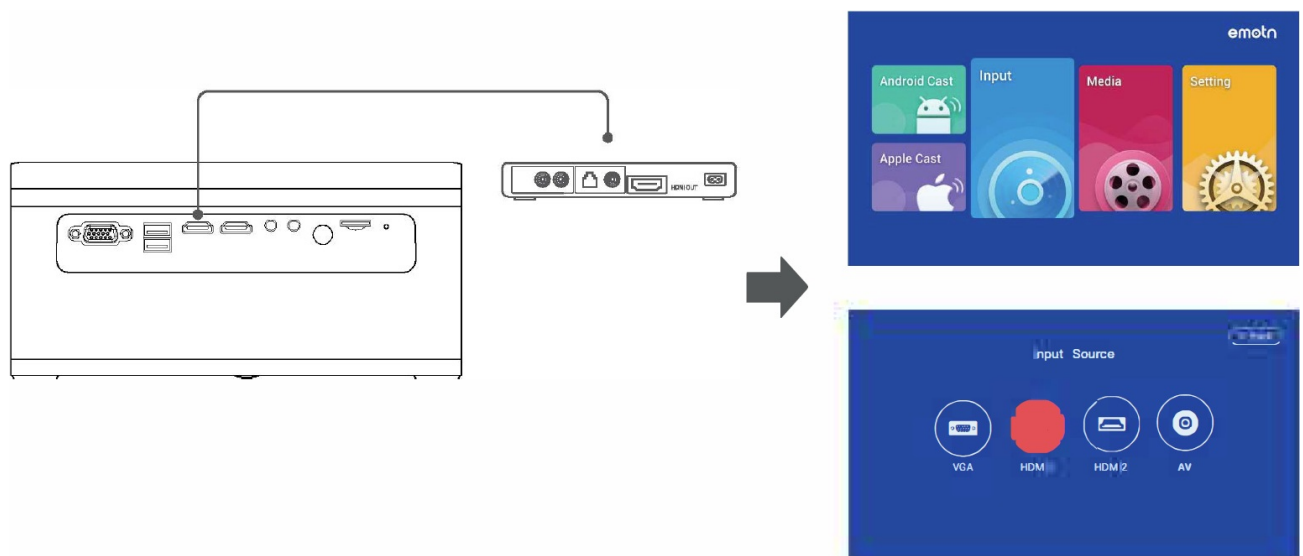

### VGA Connection

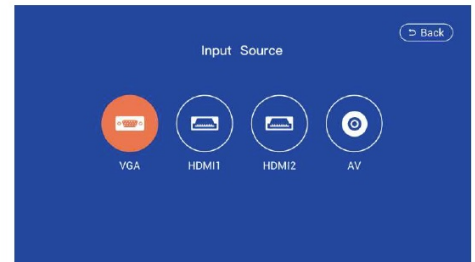
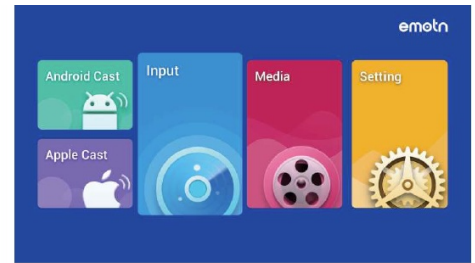
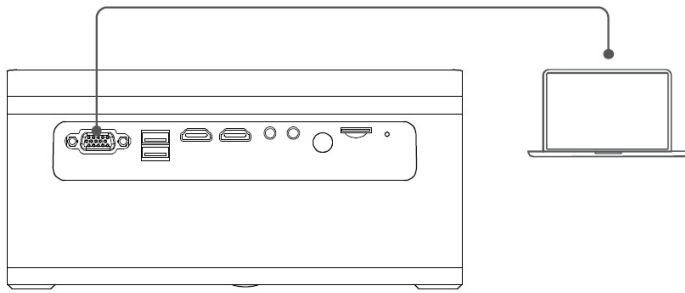

## AV Connection

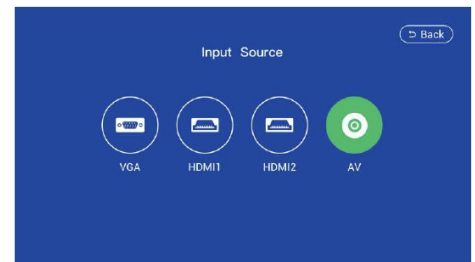
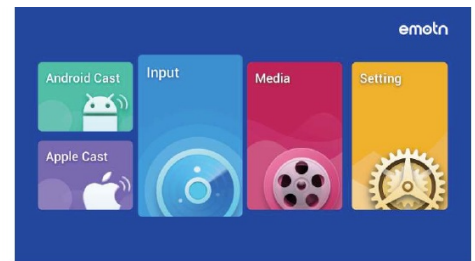
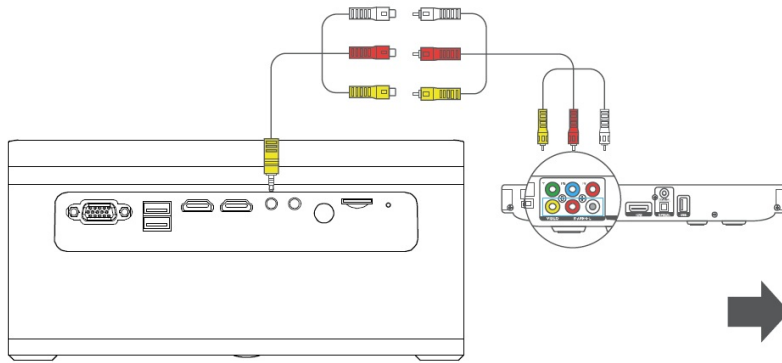

## TV Stick Connection

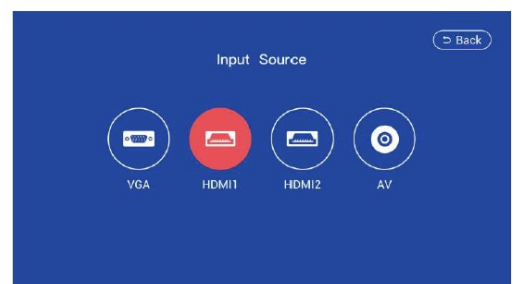
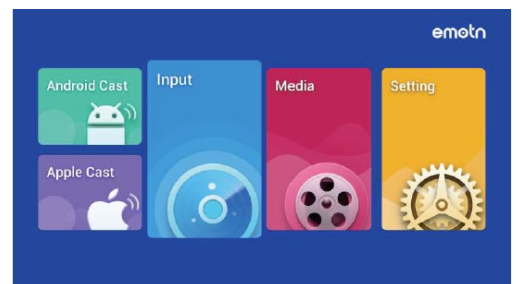
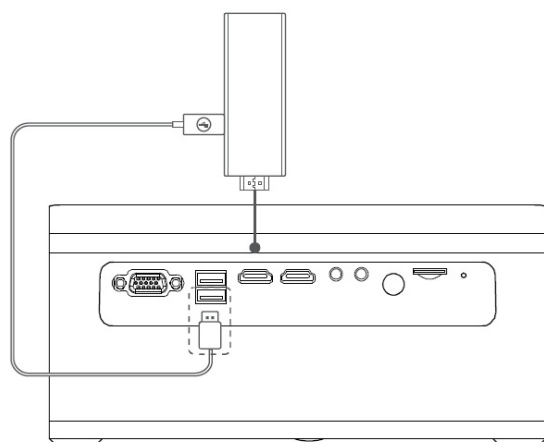

## Chromecast Connection

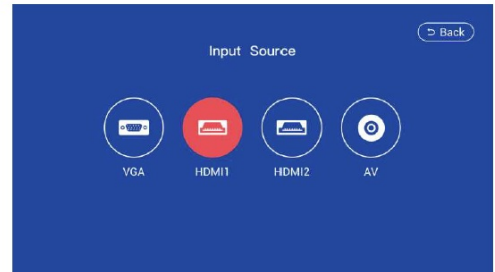
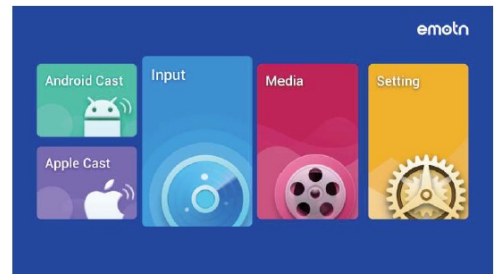
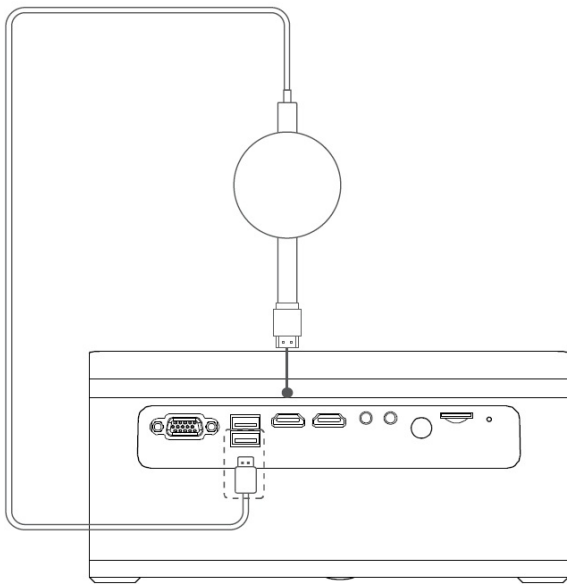

## SCREEN MIRRORING

### For iOS Devices

#### Wired Mirroring

1. Enter Apple Cast Screen.
2. Connect iOS devices to the projector via the USB cable (the slot marked USB +).

#### Wi-Fi Display

1. Connect Wi-Fi via 2 methods:
  - Open the mobile device Wi-Fi setting and connect the projector Wi-Fi.  
**DEVICE: emotn-\*\*\*\*\* PIN: 12345678**
  - Make sure mobile device and projector connected under the same Wi-Fi.  
For example, connect the home or office Wi-Fi.
2. Find the screen mirroring settings on the mobile device, click and search projector.
3. Select the projector device: emotn-\*\*\*\*\* , click and connect.

### For Android Devices

#### Wired Mirroring

1. Enter Android Cast Screen.
2. Connect mobile device to the projector via the USB cable (the slot marked USB+).
3. Download and install the projection software APK according to the prompts.

#### Wi-Fi Display

1. Find the screen mirroring settings on the mobile device, click and search projector.
2. Select the projector device: emotn-\*\*\*\*\* , click and connect.

## PROJECTION CONNECTION

### Wired Connection

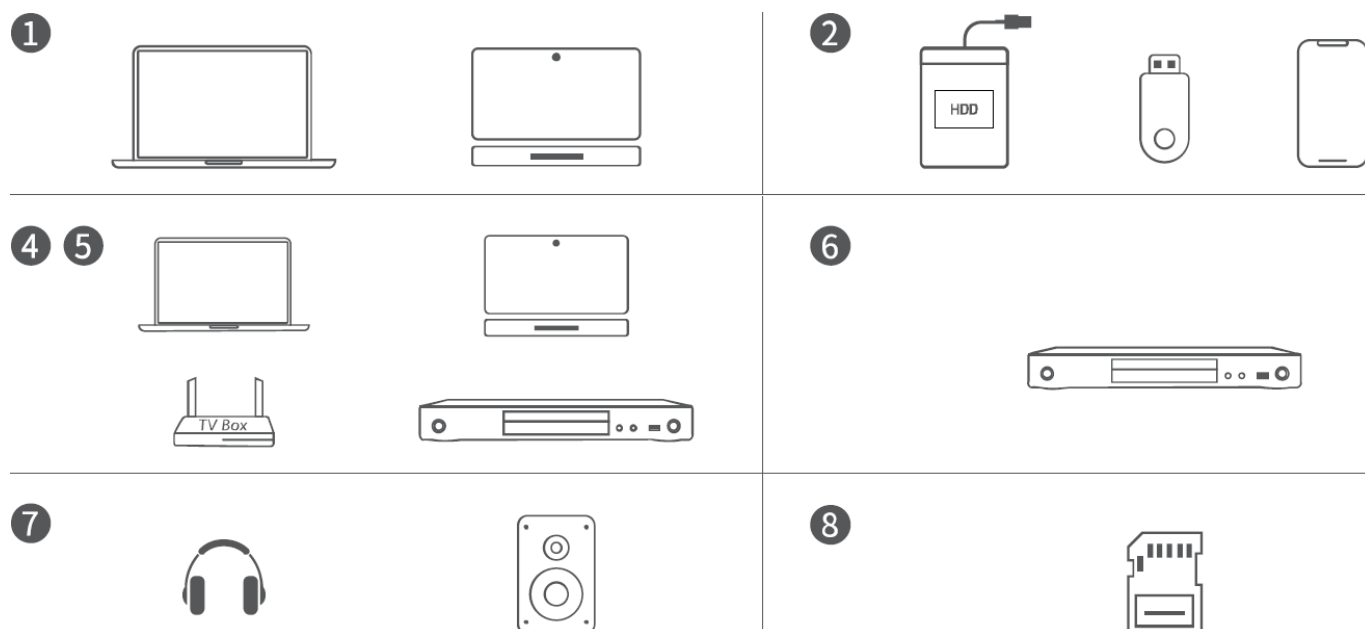
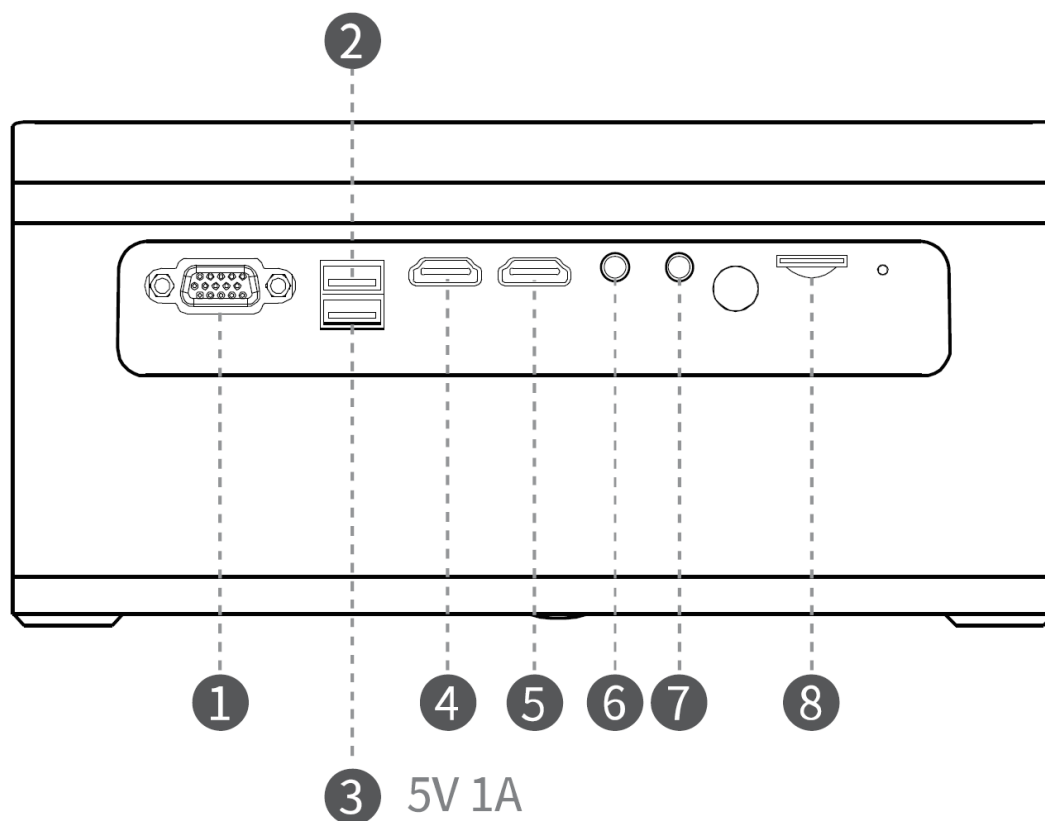

### Bluetooth Speaker Connection

1. Enter "Bluetooth Speaker Mode" via the remote control or projector Bluetooth button. The Bluetooth name of the projector: **C1\_Speaker**.
2. Open your devices Bluetooth settings, search and pair the projector.
3. You can reset Bluetooth connection via long press for 2 seconds of remote control or projector Bluetooth

button.

## PLACING THE PROJECTOR

The projector can be used to project onto a wall or screen, mounted from the ceiling or on a table. When projecting from the rear position, a special screen will be needed (not included) to display the image. Be sure to aim the remote at the sensor on the front or rear of the projector.



Front Table



Rear Table

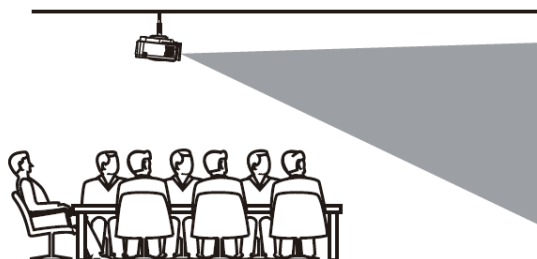

Front Ceiling



Rear Ceiling

## PROJECTION DISTANCE & SIZE

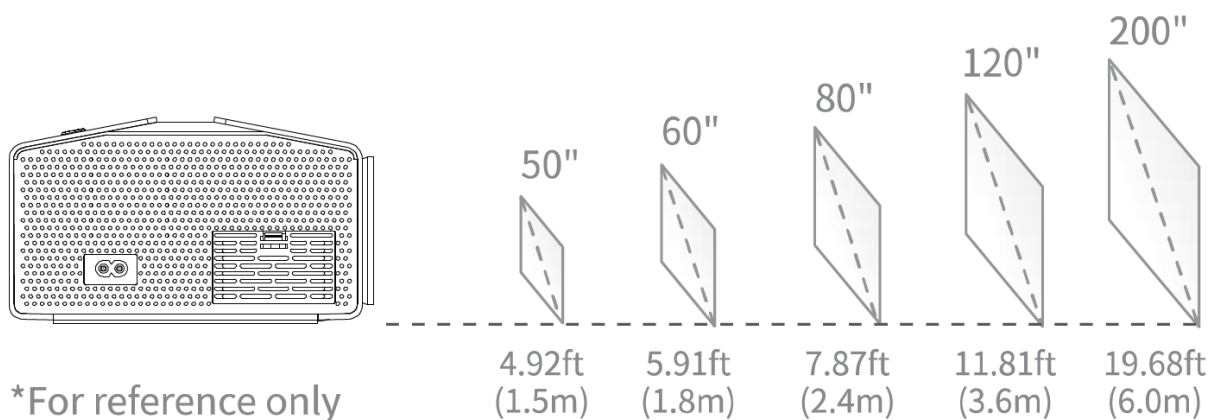

## SPECIFICATION

Display Technology	Light Source	Native Resolution	Projection Distance
LCD	LCD	1280 X 720	1.35-6m





Projection Size	Focus	Keystone	Aspect Ratio
45-200 inches	Manual	Manual Correction ±15	4:3 / 16:9

Installation Type	Power Supply	Integrated Watt	Net Weight
Front/Rear/Ceiling	AC 100-240V 50/60Hz	65W	1.69KG

Video Format Supported	Photo Format Supported	Audio Format Supported	Text Format Supported
AVI/MP4/M-KV/MOV/MPEG/MP-G/3GP/ASF/TS/VOB/FLV	BMP/JPG/JPEG/PNG	MP3/OGG/AAC/M4A-WAV/FLAC	TXT

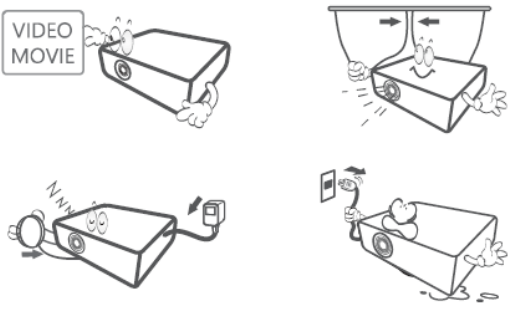
Speaker	Ports	Bluetooth Speaker Name
5Wx1	VGAx1/ HDMI x2/ USSx1 / 5V DC Outx1/ AV Inx1 / Audio Outx1 /TF Card slotx1	C1_Speaker

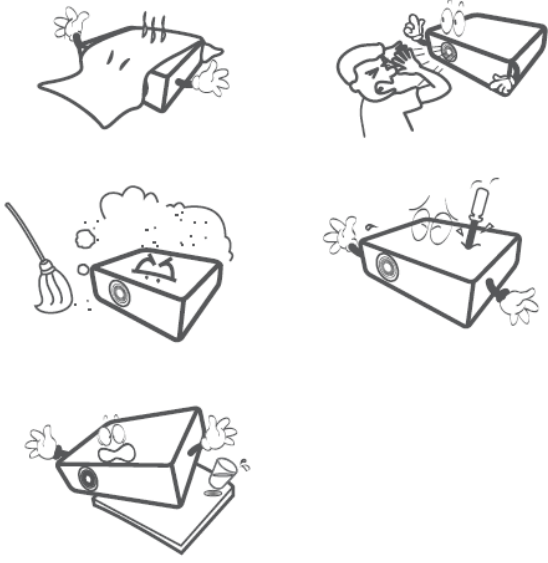
## ATTENTION

	 Recommended
	 NOT Recommended

## WARNINGS AND PRECAUTIONS

1. Do not look directly into the projector light.
2. Don't touch the projector lens.
3. Use of controls or adjustments or performance of procedures other than those specified may result in hazardous radiation exposure.
4. Changes or modified to this unit not expressly approved by the party responsible for compliance could void the user's authority to operate the equipment.
5. Use of this unit near fluorescent lighting may cause interference regarding use of the remote. If the unit is displaying erratic behavior move away from any fluorescent lighting, as it may be the cause.
6. Shock hazard – Please do not dismantle the projector without permission.
7. To reduce the risk of fire or electric shock, do not expose this apparatus to rain, moisture, dripping, or splashing.
8. Objects fill with liquids, such as vases, shall not be placed on the apparatus.

## TROUBLESHOOTING

### 1. Blurry Image

- Adjust focus ring or keystone.

Projector and screen/wall must be in effective distance.

## 2. Remote Control Unresponsive

- Make sure remote control points at IR receiver directly.
- Do not cover IR receiver window.
- Check the battery.

## 3. USB/TF Unrecognized

- Make sure your USB stick/TF card is not over 64GB.

## 4. No Sound

- Turn off Dolby Audio in your device.
- If a movie's audio number is "ac3" (Dolby Digital), then the sound may not be played (this kind of movie is very rare).

## 5. The projector can't screen mirroring?

- Firstly, please kindly check whether the projector selects the Screen Mirroring input source and whether the device is connected to the projector Wi-Fi.  
Please make sure the device and projector connect to the same Wi-Fi if the projector features Wi-Fi function.
- Please unplug the power and re-apply it again if the Screen Mirroring input source is selected and the Wi-Fi is connected while the projector still can't screen mirroring.
- Please reset the projector if it still can't work after unplugging the power.
- Please feel free to contact us.

## 6. Fail to connect the "Bluetooth Speaker Mode"?

- Please open the projector "Bluetooth Speaker Mode" and device Bluetooth setting.
- Long press for 2 seconds of remote control or projector \* button to reset.
- Please check if the device pair with the projector successfully.
- If the projector can't work if paired, please unplug the power and re-apply it again.
- Please feel free to contact us.

## NOTICE

Without the prior written permission of Super Creativity Limited or its subsidiaries (the "Company"), no part of this Manual shall be used in any form or by any method, including copying, transmitting, translating, storing in a retrieval system or translating into any text or computer language by electronic, mechanical, optical, chemical, handwritten or any such method.

If the user or a third party suffers any damage, loss, cost or expense as a result of accident, improper use, or violation of the operating procedures of the machine, or any modification, overhaul without authorization, or replacement of the product in any form, or failure to strictly follow this Manual or the operating and maintenance manual provided by the Company during operation and maintenance, the Company shall not be held liable.

To the maximum extent permitted by law, this Manual and the Product described (including its hardware, software, firmware, etc.) are provided "as is", which may have some defects or errors.

The Company provides no warranty of any kind, express or implied, including but not limited to merchantability, quality satisfaction, fitness for a particular purpose, nor shall it indemnify any special, incidental, accidental or consequential damages arising from the use of this Manual or the Product, including but not limited to loss of business profit, system failure, loss of data or documents.



The description and images involved in this Manual may differ from actual products, please refer to actual products.due to product version upgrade or other needs, the Company reserves the right to update this Manual at any time.

FCC STATEMENT

This device complies with Part 15 of the FCC Rules. Operation is subject to the following two conditions:

- 1. This device may not cause harmful interference, and
- 2. This device must accept any interference received, including interference that may cause undesired operation.

Documents / Resources

	<a href="#">emotn C1 Multimedia Projector</a> [pdf] User Manual C1, 2A273-C1, 2A273C1, C1, Multimedia Projector
---	--