



## Contents [ [hide](#) ]

- [1 ELTA SJMF Mixed Flow Circular Fan](#)
- [2 Installation Instructions](#)
- [3 DIMENSION](#)
- [4 Start Up](#)
- [5 Fan Maintenance](#)
- [6 Storage](#)
- [7 Guarantee](#)
- [8 Wiring Diagrams](#)
- [9 CONTACT INFORMATION](#)
- [10 FAQs](#)
- [11 Documents / Resources](#)
  - [11.1 References](#)

# ELTA

## ELTA SJMF Mixed Flow Circular Fan



## Installation Instructions

**WARNIN** — IG Insulation Resistance Testing. Before performing insulation resistance testing, it is crucial to disconnect all EC products from the circuit. Failure to do this can damage the sensitive electronics within these products and is not covered by warranty.

### General

- It is important these Installation and Maintenance Instructions are fully adhered to.
- Full details of the unit supplied are shown on the product nameplate. If in doubt about any detail contact Elta-UK Ltd or its agents for clarification.
- All electrical installations must be carried out by suitably qualified and competent personnel in accordance with all current statutory requirements.
- These instructions cover only the Elta-UK Ltd product and do not include the supply or installation of any safety equipment that may be required e.g. adequate guarding or protection from rotating parts and proper electrical isolation.
- Any declarations made by Elta-UK Ltd about product installation and safety, are dependent on the fan equipment being used within installations that themselves meet the requirements of the relevant Standards and Directives of your region.
- The fan is designed for use in an ambient temperature of -10°C up to a maximum of

+60°C and up to 90% relative humidity. The fan is not suitable for corrosive or explosive atmospheres.

- The installer should provide easy access to the fan to facilitate future maintenance.
- The installer should ensure the fan is adequately supported.
- This product is not intended for use by persons (including children) with reduced physical, sensory, or mental capabilities, or lack of experience and knowledge, unless they have been given supervision or instruction concerning use of the product by a person responsible for their safety. Children should be supervised to ensure that they do not play with the product.
- At end-of-life, the unit must be disposed of in an environmentally friendly manner by suitably qualified and competent personnel in accordance with the requirements of applicable Standards and Directives.

## **Installation**

**WARNING** – The fan must be isolated from the power supply during installation and maintenance.

- The fan must be earthed in accordance with the local regulations.
- The appliance can only be used indoors.
- Upon receipt, the fan equipment should be visually inspected to check for any damage. Ensure that the impeller is free to rotate.
- If there are any queries concerning the fan equipment, Elta-UK Ltd should be contacted prior to the installation.
- The fan must be securely mounted in the desired position to suit the application. The fan can be mounted at any angle.
- Check the details on the motor rating plate to ensure that the correct power supply (voltage, frequency, and phase) is available. An incorrect power supply will lead to permanent damage to the fan motor.
- Refer to the appropriate wiring diagram. Ensure that all earth connections are made.
- Means for electrical disconnection must be incorporated in the wiring installation in accordance with the relevant wiring and electrical regulations.
- Precaution must be taken to locate the exhaust discharge terminal to avoid the backflow of gases into the room from the open flue of gas or other fuel burning

appliances.

- Minimum Installation Space

## DIMENSION

### Dimensions & Mounting

#### SJMF100

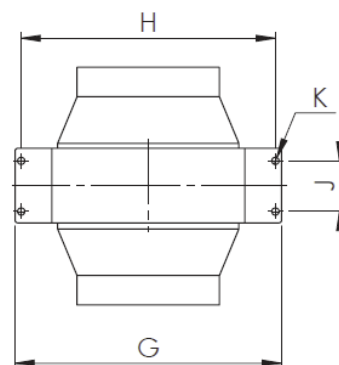
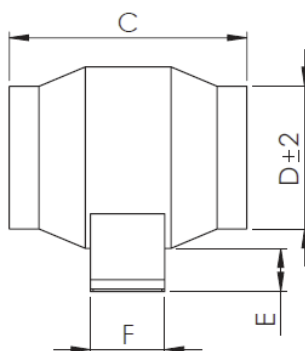
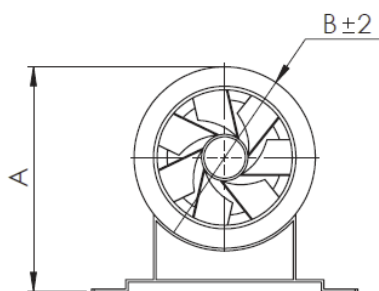

#### SJMF125

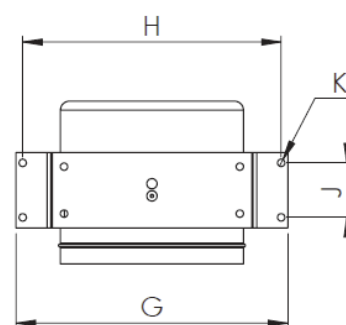
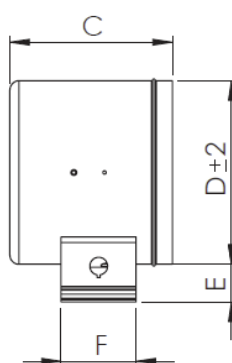
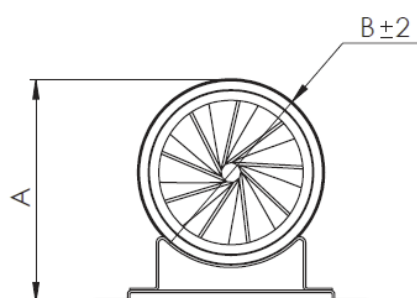

#### SJMF150-SJMF355

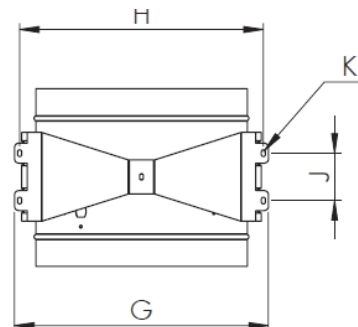
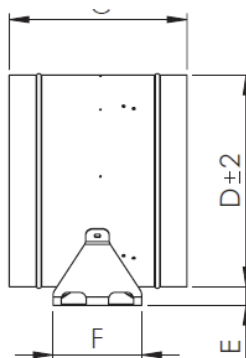
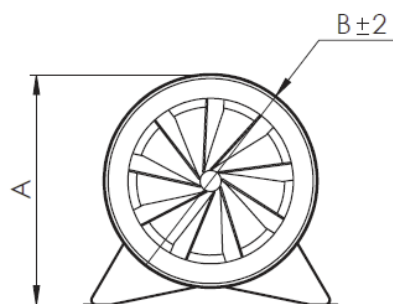

<b>Pro duct Cod e</b>	<b>A</b>	<b>B</b>	<b>C</b>	<b>D</b>	<b>E</b>	<b>F</b>	<b>G</b>	<b>H</b>	<b>J</b>	<b>K</b>	<b>Wei ght kg</b>
<b>SJM F10 0</b>	150	125	159	98	25	51	184	175	37	5	1.1
<b>SJM F12 5</b>	151	126	110	124	26	51	184	175	37	5	1.1
<b>SJM F15 0</b>	173	153	165	150	21	80	187	175	37	5 x 8 SLO T	1.6
<b>SJM F20 0</b>	223	203	220	200	22	105	221	210	39	5 x 8 SLO T	2.6
<b>SJM F25 0</b>	274	254	210	250	22	105	300	288	56	5 x 8 SLO T	3.7
<b>SJM F31 5</b>	356	317	290	313	39	164	360	336	68	9 x 1 4 SL OT	8.5
<b>SJM F35 5</b>	401	358	330	353	45	184	405	380	77	9 x 1 4 SL OT	12.0

**Dimensions are in mm.**

Elta-UK Limited has a policy of continuous product development and improvement and therefore reserves the right to supply products which may differ from those illustrated and described in this publication. Confirmation of dimensions and data will be supplied on request.

**SJMF150-S – SJMF315-S**

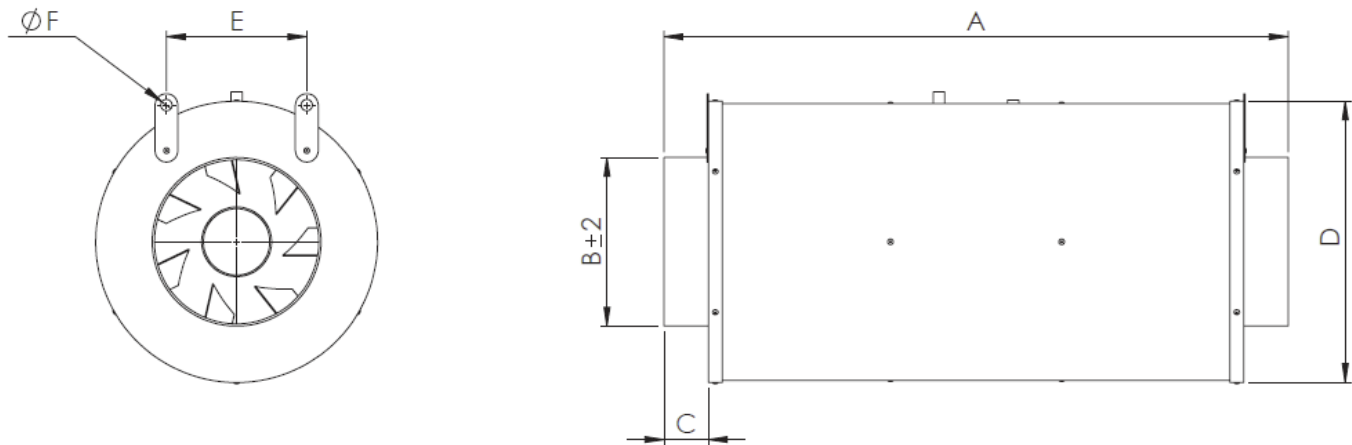

Product Code	A	B	C	D	E	F	Weight kg
SJMF150-S	547	148	39	243	123	10	5.0
SJMF200-S	699	198	40	304	174	10	7.5
SJMF250-S	859	248	45	353	221	10	13.7
SJMF315-S	940	313	46	415	268	10	20.0

**SJMF Models**

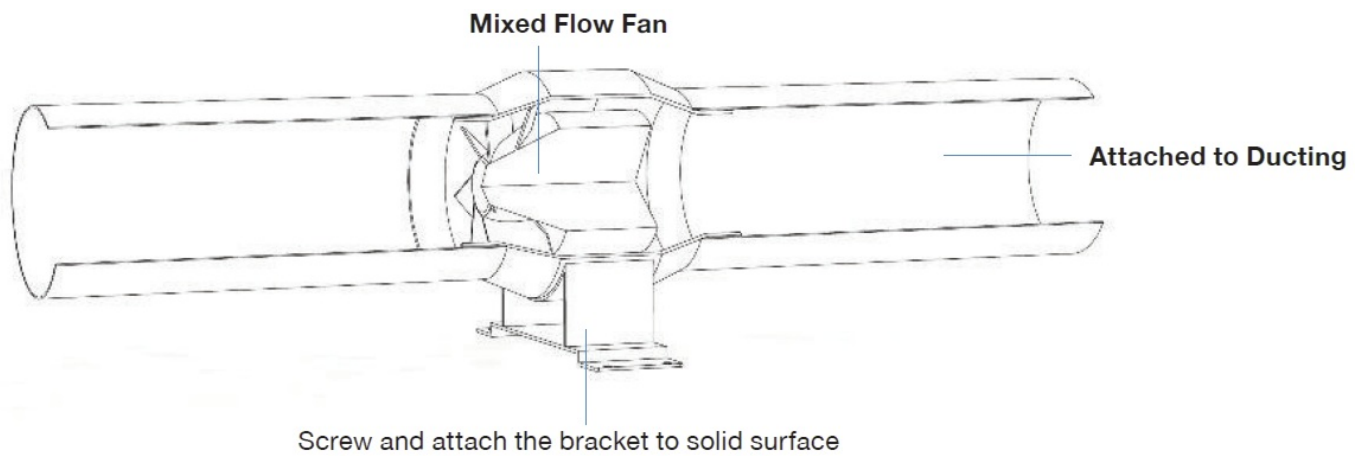

The use of Fast Clamps or Flexible Connectors is recommended for connection to duct, making it very easy for future maintenance, repair, or replacement. Silencers are recommended on the inlet and outlet sides of the fan to reduce noise. Sizes 150/200/250 and 315mm have a detachable mounting bracket.

### **SJMF-S Models**

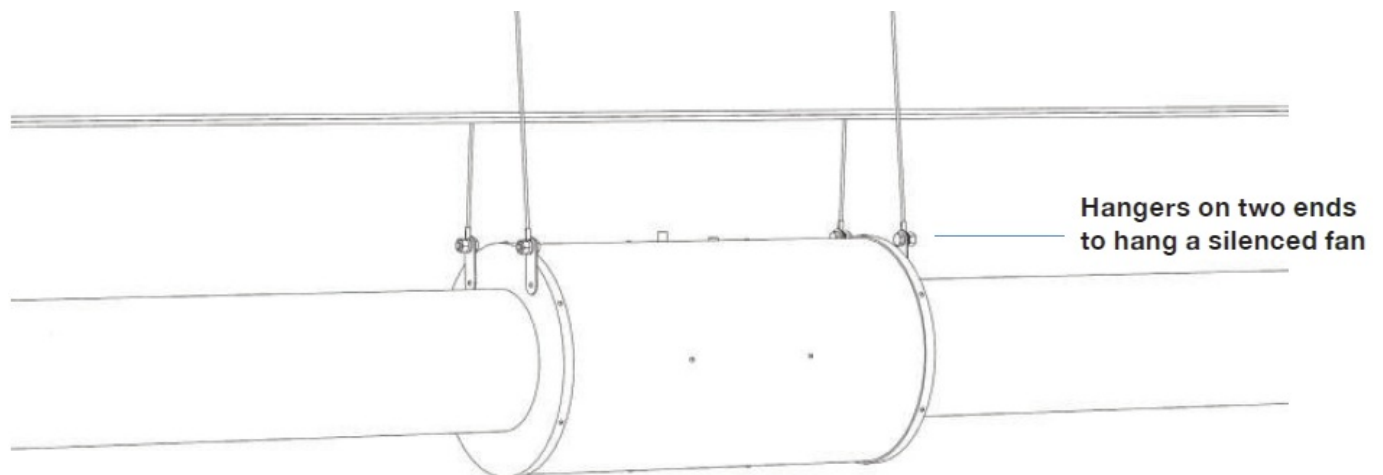

### **Start Up**

- Before power is supplied to the unit, check that the wiring is correct as per the fan connection diagram.
- At initial start-up, check that the impeller rotation and airflow direction are correct.
- Check that the motor amperage drawn does not exceed the nameplate rating.

### **Fan Maintenance**

- Inspection of the fan at least once every 12 months is recommended to ensure that the motor, fan blades, and supporting guards, are clean. Any build-up of dust and

deposits on the blades or guards should be removed using a non abrasive cleaner.

- All fastenings should be checked for tightness. In addition, all rotating items should be checked.
- Bearings are of the 'sealed for life' type and will not need a detailed inspection.
- IMPORTANT – The EC fan has internal electronic overload protection, which switches the fan off in the event of a fault condition. Once the motor cools down the fan may start unexpectedly.
- CAUTION – In order to avoid a hazard due to inadvertent resetting of the thermal cutout, this appliance must not be supplied through an external switching device, such as a timer or connected to a circuit that is regularly switched on and off by the utility.
- Only a suitably qualified and competent person may carry out maintenance after the electrical supply has been isolated.

## **Storage**

- If the fan is not to be used immediately, then it should be stored in a clean, dry, vibration free and lockable location.
- The impeller must be spun by hand (ensuring that it does not come to rest in the same position) monthly to prevent hardening of the grease and possible damage to the bearings.
- All items to be stored on pallets that afford adequate protection from damage, dust, and high humidity.
- If storage periods of longer than 1 month are anticipated then Elta (or their Agent) should be contacted prior to storage taking place, to ensure the storage area provisions will not be detrimental to the wellbeing of Elta products.

## **Guarantee**

- Elta-UK Ltd will, free of charge, within a period of 1 year from the date of dispatch from their works, repair or at its option replace any goods which are proved to have defects as a result of defective materials or workmanship. The goods MUST be returned to Elta-UK Ltd carriage paid for examination.

## **Recycling**



- Elta use components, when possible, that are suitable for recycling at the end of the product's life, Components can be segregated as stated below and processed in accordance with local regulations. Metallic items can be segregated and recycled; Electrical and Electronic equipment such as motors, cables and control devices, can be segregated for WEEE recycling; Cardboard, wood, packaging, and plastic components can be widely recycled. Items not listed should be segregated in accordance with local authority's zero waste hierarchy recommendations.

## Wiring Diagrams

Mains connection is by 1.5 metre Mains lead complete with BS1363-1 UK 3-pin plug, BS1361 fuse 3A. Fan is supplied for FIXED SPEED Operation, for speed control remove the 3.5mm jack plug and connect the supplied cable connecting speed control circuit as diagrams below to cable.

MAX. SPEED

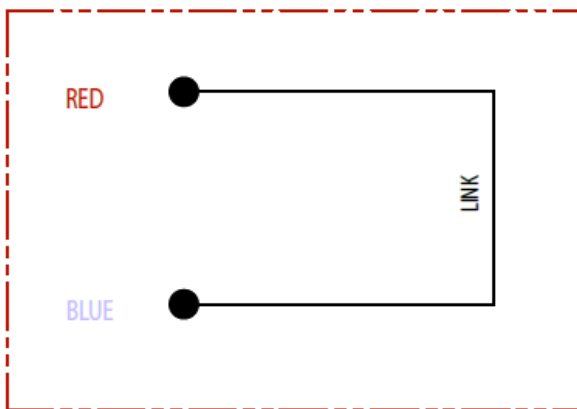

SPEED CONTROL VIA 0-10V

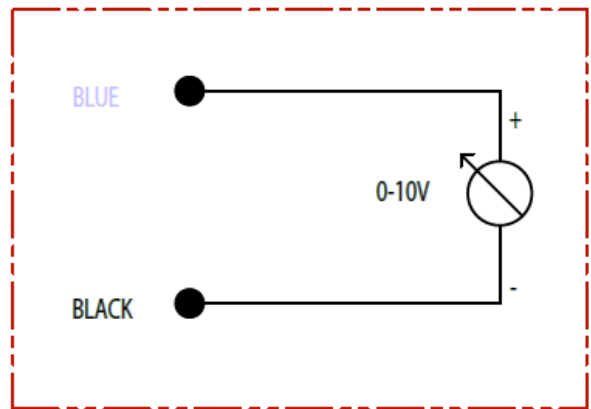

SPEED CONTROL VIA PWM

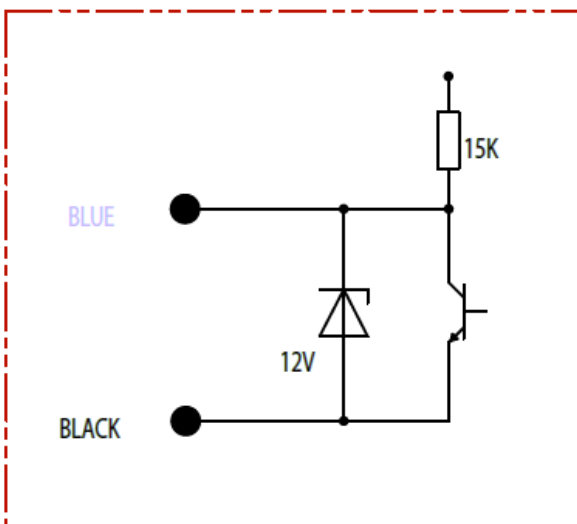

SPEED CONTROL VIA 149-POT-10-\*

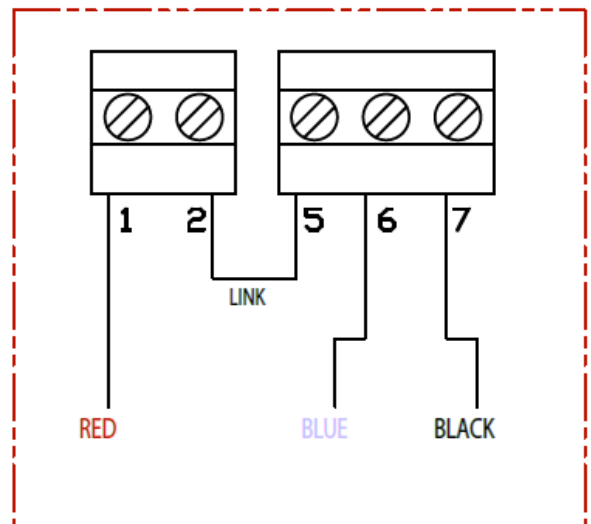

Wire Colour	Purpose	Description
RED	1OVDC Output	1OVDC source output
BLUE	O-1OVDC Input	DC control voltage input (O – 1OVDC or PWM)
BLACK	GND/ Common	DC Common
YELLOW	Tacho Output	Speed Reference

**PLEASE NOTE:** Wire colours relate to the motor control wires provided by the 3.5mm jack plug/lead provided with the unit.

**All wiring and control equipment must comply to the latest IEE regulations, in particular part 552-01-02/03. MK-152-553 Issue B: 26.10.2021**

Check the individual product accessories table for fan controller compatibility.

## CONTACT INFORMATION

- **Tel** +44 (0) 1384 275800
- **Email** [info@eltauk.com](mailto:info@eltauk.com)
- [eltauk.com](http://eltauk.com)
- 535-IOM0081 Issue E

## FAQs

- **Q: Can this product be used in corrosive environments?**
  - A: No, this product is not suitable for corrosive or explosive atmospheres as per the manufacturer's instructions.
- **Q: What should I do if I encounter damaged fan equipment upon receipt?**
  - A: Contact Elta-UK Ltd immediately for guidance on how to proceed with the damaged equipment.
- **Q: How should I dispose of this product at end-of-life?**
  - A: The unit must be disposed of in an environmentally friendly manner by

qualified personnel following applicable Standards and Directives.

# Documents / Resources

	<a href="#">ELTA SJMF Mixed Flow Circular Fan [pdf]</a> Installation Guide SJMF, SJMF Mixed Flow Circular Fan, Mixed Flow Circular Fan, Flow Circular Fan, Circular Fan
---	--

## References

- [User Manual](#)

🔍 Circular Fan, elta, Flow Circular Fan, Mixed Flow Circular Fan, SJMF, SJMF Mixed Flow Circular Fan

—Previous Post  
[elta BGT-2000.2 Electric Table Grill User Manual](#)

## Leave a comment

Your email address will not be published. Required fields are marked \*

Comment \*

Name

Email

Website

☐ Save my name, email, and website in this browser for the next time I comment.

**Post Comment**

[Manuals+](#), [Privacy Policy](#) | [@manuals.plus](#) | [YouTube](#)

This website is an independent publication and is neither affiliated with nor endorsed by any of the trademark owners. The "Bluetooth®" word mark and logos are registered trademarks owned by Bluetooth SIG, Inc. The "Wi-Fi®" word mark and logos are registered trademarks owned by the Wi-Fi Alliance. Any use of these marks on this website does not imply any affiliation with or endorsement.