



Elmo PX-30E Visual Presenter User Guide

[Home](#) » [ELMO](#) » Elmo PX-30E Visual Presenter User Guide 

Contents

- [1 Elmo PX-30E Visual Presenter](#)
- [2 Product Usage Instructions](#)
- [3 IMPORTANT SAFEGUARDS](#)
- [4 BEFORE YOU USE](#)
- [5 FEATURES](#)
- [6 HANDLING PRECAUTIONS](#)
- [7 PREPARATION](#)
- [8 PREPARATION OF SUPPLIED ACCESSORIES](#)
- [9 USING THE PRODUCT](#)
- [10 VARIOUS USAGE](#)
- [11 OVERSEAS SUBSIDIARY COMPANIES](#)
- [12 Documents / Resources](#)
 - [12.1 References](#)
- [13 Related Posts](#)

Elmo

Elmo PX-30E Visual Presenter



Product Specifications:

- Model: PX-30E / PX-10E
- Resolution: 4K
- CMOS Sensor: 12M
- Frame Rate: 60fps
- Connectivity: HDMI, USB, SD
- Power Input: AC100V 50Hz-60Hz
- Interface: USB 3.0, HDMI, RGB, HDBaseT, LAN

Product Usage Instructions

Important Safeguards:

- Read all safety and operating instructions before use.
- Retain instructions for future reference.
- Adhere to all warnings and instructions provided.
- Follow proper cleaning procedures using a damp cloth.
- Avoid using attachments not recommended by the manufacturer.
- Avoid placing the product near water or in unstable locations.

Placement and Ventilation:

Avoid placing the product on an unstable surface. Use recommended carts, stands, or tripods to prevent falls. Ensure proper ventilation by not blocking slots and openings.

Power and Connectivity:

Connect the product to an AC power source using the provided adapter. Utilize HDMI, USB, and SD connections for data transfer and display purposes.

Zoom and Display:

Use the zoom-in and zoom-out features for detailed visuals. Adjust settings for optimal display on A4 or A3 formats.

Frequently Asked Questions (FAQ):**1. Q: What is the resolution of the Visual Presenter?**

A: The Visual Presenter has a 4K resolution for high-quality imaging.

2. Q: How should I clean the Visual Presenter?

A: Unplug the device before cleaning. Use a damp cloth and avoid liquid or aerosol cleaners.

3. Q: Can I use attachments not recommended by the manufacturer?

A: It is advised not to use attachments that are not recommended as they may pose hazards.

Quick Start Guide

Make sure to read the "IMPORTANT SAFEGUARDS" in this guide before using this product. For details about specifications and instruction manual of the product, refer to the following official website.

<https://www.elmousa.com>

<https://www.elmoeurope.com>

IMPORTANT SAFEGUARDS

- Read Instructions

All the safety and operating instructions should be read before the appliance is operated.

- Retain Instructions

The safety and operating instructions should be retained for future reference.

- Heed Warnings

All warnings on the product and in the operating instructions should be adhered to.

- Follow Instructions

All operating and use instructions should be followed.

- Cleaning

Unplug this product from the wall outlet before cleaning. Do not use liquid cleaners or aerosol cleaners. Use a damp cloth for cleaning.

- Attachments

Do not use attachments not recommended by the product manufacturer as they may cause hazards.

- Water and Moisture

Do not use this product near water – for example, near a bath tub, wash bowl, kitchen sink, or laundry tub, in a wet basement, or near a swimming pool, and the like.

- Placement

Do not place this product on an unstable cart, stand, tripod, bracket, or table. The product may fall, causing serious injury to a child or adult, and serious damage to the product. Use only with a cart, stand, tripod, bracket, or table recommended by the manufacturer, or sold with the product. Any mounting of the product should follow the manufacturer's instructions, and should use a mounting accessory recommended by the manufacturer.

- Ventilation

Slots and openings in the cabinet are provided for ventilation and to ensure reliable operation of the product and to protect it from overheating, and these openings must not be blocked or covered. The openings should never be blocked by placing the product on a bed, sofa, rug, or other similar surface. This product should not be placed in a built-in installation such as a bookcase or rack unless proper ventilation is provided or the manufacturer's instructions have been adhered to.

- **Power Sources**

This product should be operated only from the type of power source indicated on the marking label. If you are not sure of the type of power supply to your home consult your appliance dealer or local power company. For products intended to operate from battery power, or other sources, refer to the operating instructions.

- **Grounding or Polarization**

This product may be equipped with either a polarized 2-wire AC line plug (a plug having one blade wider than the other) or a 3-wire grounding type plug, a plug having a third (grounding) pin. If the 2-Wire polarized plug will not fit in the outlet, try reversing the plug. If the plug still fails to fit, contact your electrician to replace your obsolete outlet. Do not defeat the safety purpose of the polarized plug. The 3-wire grounding type plug will fit into a grounding type power outlet.

This is a safety feature. If you are unable to insert the plug into the outlet, contact your electrician to replace your obsolete outlet. Do not defeat the safety purpose of the grounding type plug.

- **Power-Cord Protection**

Power-supply cords should be routed so that they are not likely to be walked on or pinched by items placed upon or against them, paying particular attention to cords at plugs, convenience receptacles, and the point where they exit from the product.

- **Lightning**

For added protection for this product during a lightning storm, or when it is left unattended and unused for long periods of time, unplug it from the wall outlet and disconnect the antenna or cable system. This will prevent damage to the product due to lightning and power-line surges.

- **Overloading**

Do not overload wall outlets, extension cords, or integral convenience receptacles as this can result in a risk of fire or electric shock.

- **A product and cart combination should be moved with care. Quick stops, excessive force, and uneven surfaces may cause the product and cart combination to overturn.**



- **Object and Liquid Entry**

Never push objects of any kind into this product through openings as they may touch dangerous voltage points or short-out parts that could result in a fire or electric shock. Never spill liquid of any kind on the product.

- **Servicing**

Do not attempt to service this product yourself as opening or removing covers may expose you to dangerous voltage or other hazards. Refer all servicing to qualified service personnel.

- **Damage Requiring Service**

Unplug this product from the wall outlet and refer servicing to qualified service personnel under the following conditions:

- When the power-supply cord or plug is damaged.
 - If liquid has been spilled, or objects have fallen into the product.
 - If the product has been exposed to rain or water.
 - If the product does not operate normally by following the operating instructions. Adjust only those controls that are covered by the operating instructions as an improper adjustment of other controls may result in damage and will often require extensive work by a qualified technician to restore the product to its normal operation.
 - If the product has been dropped or damaged in any way.
 - When the product exhibits a distinct change in performance – this indicates a need for service.
- Replacement Parts
When replacement parts are required, be sure the service technician has used replacement parts specified by the manufacturer or have the same characteristics as the original part. Unauthorized substitutions may result in fire, electric shock or other hazards.
 - Safety Check
Upon completion of any service or repairs to this product, ask the service technician to perform safety checks to determine that the product is in proper operating condition.
 - Heat
The product should be situated away from heat sources such as radiators, heat registers, stoves, or other products (including amplifiers) that produce heat.



CAUTION:

TO REDUCE THE RISK OF ELECTRIC SHOCK, DO NOT REMOVE COVER (OR BACK).
NO USER-SERVICEABLE PARTS INSIDE.
REFER SERVICING TO QUALIFIED SERVICE PERSONNEL.



SA 1965 The lightning flash with arrowhead symbol, within an equilateral triangle, is intended to alert the user to the presence of uninsulated “dangerous voltage” within the product’s enclosure that may be of sufficient magnitude to constitute a risk of electric shock to persons.



SA 1966 The exclamation point within an equilateral triangle is intended to alert the user to the presence of important operating and maintenance (servicing) instructions in the literature accompanying the product.



■ This symbol [crossed-out wheeled bin WEEE Annex IV] indicates separate collection of waste electrical and electronic equipment in the EU countries.

Please do not throw the equipment into the domestic refuse.

Please use the return and collection systems available in your country for the disposal of this product.

WARNING

TO REDUCE THE RISK OF FIRE OR ELECTRIC SHOCK, DO NOT EXPOSE THIS PRODUCT TO RAIN OR MOISTURE.

The connection of a non-shielded equipment interface cable to this equipment will invalidate the FCC Certification or Declaration of this device and may cause interference levels which exceed the limits established by the FCC for this equipment. It is the responsibility of the user to obtain and use a shielded equipment interface cable with this device. If this equipment has more than one interface connector, do not leave cables connected to unused interfaces. Changes or modifications not expressly approved by the manufacturer could void the user's authority to operate the equipment.

FOR UNITED STATES USERS: INFORMATION

This equipment has been tested and found to comply with the limits for a Class A digital device, pursuant to Part 15 of the FCC Rules. These limits are designed to provide reasonable protection against harmful interference when the equipment is operated in a commercial environment.

This equipment generates, uses, and can radiate radio frequency energy and, if not installed and used in accordance with the instruction manual, may cause harmful interference to radio communications. Operation of this equipment in a residential area is likely to cause harmful interference in which case the user will be required to correct the interference at his own expense.

USER-INSTALLER

CAUTION:

Your authority to operate this FCC verified equipment could be voided if you make changes or modifications not expressly approved by the party responsible for compliance to Part 15 of the FCC rules.

BEFORE YOU USE

- The supplied power cord and AC adapter are designed for exclusive use with this product. Do not use them with other products.
- Be sure to use the power cord applicable to your local power specifications. If the product was sold in Japan, use the AC adapter sold with the product with 100 VAC and 50 or 60 Hz.
- When storing the product, do not leave it under direct sunlight or by heaters. It may be discolored, deformed, or damaged.
- Do not place this product in any humid, dusty, salt bearing wind, or vibrating locations.

Use it under the following environmental conditions:

Temperature 0°C 40°C

Humidity 30 85 (No condensation)

- Do not put your finger between the arms when moving the arm. You may pinch your finger and result in injury. It is recommended to attach the supplied caution sticker to the product.
- Use a soft, dry cloth for cleaning.
Do not use any volatile solvent such as thinner or benzene.
- Do not point the lens directly to the sun. It could degrade the imaging capability.
- Luminescent and Black Spots

There may be some pixels that do not properly operate due to the use of CMOS Area Image Sensors made-up of many pixels.

Though luminescent or black spots may be found on the screen, it is a phenomenon peculiar to the CMOS Area Image Sensors and is not a malfunction.

- A protection sheet is attached to the touchscreen at the factory to avoid damage during transportation. Remove the sheet before use.

Do not strongly press the touchscreen or press it with sharp objects. This may result in damage or malfunction to the touchscreen.

- Follow the guidelines below to prevent the unit from dropping or overturning.
 - Use the product on a stable base, desk, or table. Do not place the product on an unstable base or slanted location.
 - Place or wire the product so as to prevent the cables from being pulled or drawn.
- Never hold the product by the arm or the camera head. Carry the product by holding the lower part of the main unit in both hands after folding the arm and the camera head.
- Pay careful attention when using (including setting-up and storing) or carrying the product to prevent the camera head from receiving any shocks.
- After folding the product, do not place heavy object on the arm.
- Do not look directly into the LED light. If you look directly into it at pointblank range, your eyes may be injured.
- The LED may get hot after using it for long hours. Do not touch it directly.

It is recommended to attach the supplied caution sticker to the product.

- Depending on the type of the SD card or USB flash drive, it may not be used with the product.
- Transfer the data from the SD card or USB flash drive onto a device such as a PC to save a backup copy. Malfunction of the product or repairs to it may cause the data saved in the SD card or USB flash drive to be deleted.
- If this product is used for longer than the warranty period, its performance and quality may deteriorate due to the lifetime of its parts. For parts replacement (on chargeable basis), consult the dealer from whom you purchased this product or our branch/office near your location.
- Battery precautions:
 - Remove the battery from the remote control when not in use for an extended period of time.
 - Do not use a rechargeable battery.
 - Do not charge or short-circuit the battery.
 - Follow the regulations of the city or town when disposing of the battery.
 - Pay attention to the polarity (+ / –) of the battery.
 - Children may ingest small batteries; always keep batteries safe and out of reach. If a battery is swallowed, consult a doctor immediately as this could result in asphyxiation or be an obstacle to digestion, etc.
 - If any liquid from a battery leaks onto your skin or clothes, flush the area with clean water immediately. If it gets into your eye, flush immediately with clean water and then contact a doctor.

- Microphone

Connecting a microphone other than an electret condenser microphone (a microphone for a computer) may cause malfunction.

- Audio input port

The power is supplied to the Audio input port (dedicated for the microphone input) when the Audio Selector in the menu is set to “External Mic-input”. Do not connect any audio line-output devices such as a CD player to the Audio input port in this condition.

- Menu and Icons

Some functions of this product may not be set or used depending on the operation mode or menu settings.

- Recording / Playback

- Before recording an important scene, make sure to do a test recording to confirm that the camera is working properly.
- The recording time varies depending on the resolution setting, recording quality setting or type of SD card.
- Video files that are recorded with this product or converted by the proprietary software can only be played with this product.
- Be careful not to operate the touchscreen or touch any buttons during the recording. The operation noise may be recorded.
- **Whiteboard Sheet**
 - Use a proper whiteboard marker. If you use a permanent marker on the board, you may not be able to erase it.
 - When writing, write on the whiteboard sheet. If you write directly on the stage, You may not be able to erase it.

It is recommended to attach the supplied caution sticker to the product.

 - Do not leave writing or drawings on the writing surface for an extended period of time. It may stick to the surface and will be difficult to erase.
 - It may be difficult to erase writing or drawings on the surface with a whiteboard eraser. We recommend you used a melamine sponge.
- **Remote control**

The receivable range may be reduced when the product is placed in direct sunlight or near an inverter fluorescent light.

Depending on the surrounding environment, the receivable range may be shorter or the sensor may fail to receive any infrared light. In such cases, relocate the product or shield the light source.
- **Network Function (For PX-30E only)**

We do not guarantee the performance when the product is connected to the Internet directly. For details of the network settings, consult with your network administrator.
- **Copyright**

Unless used for personal use, it is prohibited strictly under copyright law to use any photo files without the prior consent of the copyright holder. Even if using for personal use, be careful that there could be a situation where video or audio recording is restricted or illegal.

FEATURES

- **High-Definition 4K Image**

Max 4K

With the 12Mega pixels CMOS sensor, the PX series can produce high-definition images with max. 4K resolution.

※ The PX-10E cannot output 4K images. The max output resolution is 2K (Full HD).
- **Natural, Smooth Image**

The PX series can output 2K images at 60fps.

High definition and smooth video images can be fully displayed without degrading the image quality.
- **Maximum excitement generated by state-of-the-art zoom –Optical zoom, Digital zoom, Sensor zoom**

The PX series are equipped with 12x Optical zoom and 2x Sensor zoom. 24x zooming without image

degradation is possible.

(Total 288x zooming together with 12x digital zoom.)

- Both A4 portrait image and A3 landscape image can be captured, respectively, in HDMI output mode
By changing the settings of the angle of view and resolution of the output image, you can capture full A4 portrait image and A3 landscape image respectively.
- **Other useful features**
5" LCD touchscreen, Zoom jog dial for easier operation, External source input feature.

HANDLING PRECAUTIONS

The followings are special precautions against mishandling of the product. Pay close attention to them.

1. Installation

Do not place the product on an unstable place or slanted surface.



2. Carrying the product

To avoid malfunction of the camera, fold the arm before carrying the product.

Never hold the product by the arm or the camera head when carrying the product.

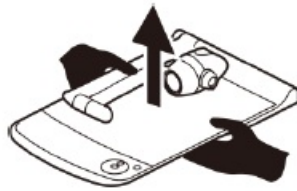

3. Setting Up

When setting up the product, pay attention not to pinch fingers between moving parts.

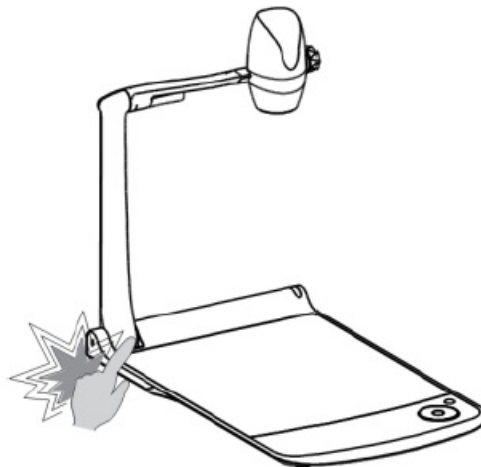

4. Cabling of the AC adapter

Do not wrap the power cable tightly around the AC adapter. By doing so may cause cable disconnection.

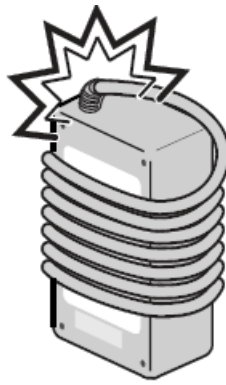

PREPARATION

PACKAGE CONTENTS

The items below are included with this product. If any item is missing, contact the dealer from whom you purchased this product.

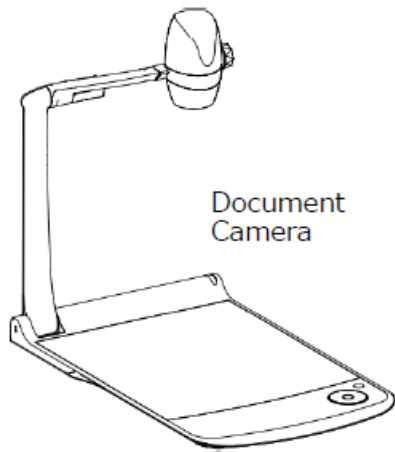

Document
Camera

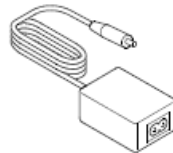

AC adapter

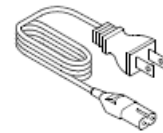

AC power cord
(The shape of the plug differs
according to the region in which
the product is sold.)

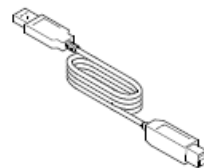

USB3.0 cable
(1.5m)



Lithium coin battery for
remote control (CR2025)



Remote control



Whiteboard sheet



Melamine sponge
(For Whiteboard sheet)



Cable tie ×3



Screw ×3



HDMI cable fixture ×3

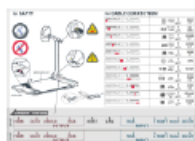

Caution sticker

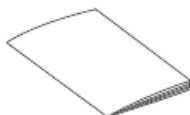

Quick Start Guide
(This manual)

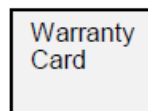

Warranty Card
(For Japan
/ North America only)

SETTING UP

Place the product on an even, flat surface. Then set up the product as shown in the figures below. When storing the product, follow the opposite procedure.

STEP1

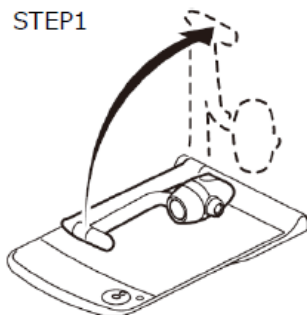

STEP2



STEP3



STEP4

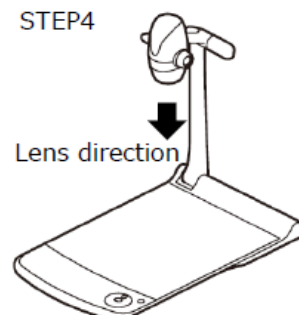

CONNECTING TO A PROJECTOR OR MONITOR

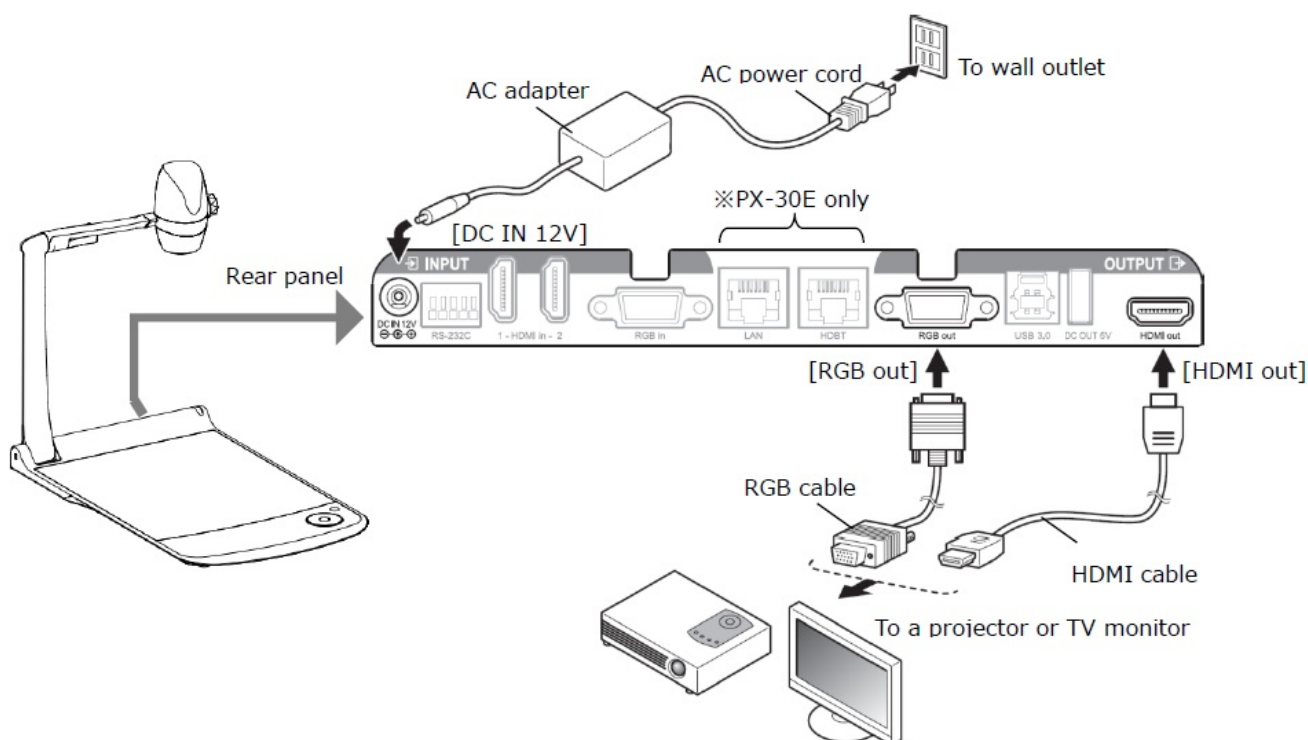

PREPARATION OF SUPPLIED ACCESSORIES

Remote control

Remove the battery case by squeezing the release lock. Insert the coin battery into the battery case, so you see the positive (+) side facing up.

Then insert the battery case into the remote control.

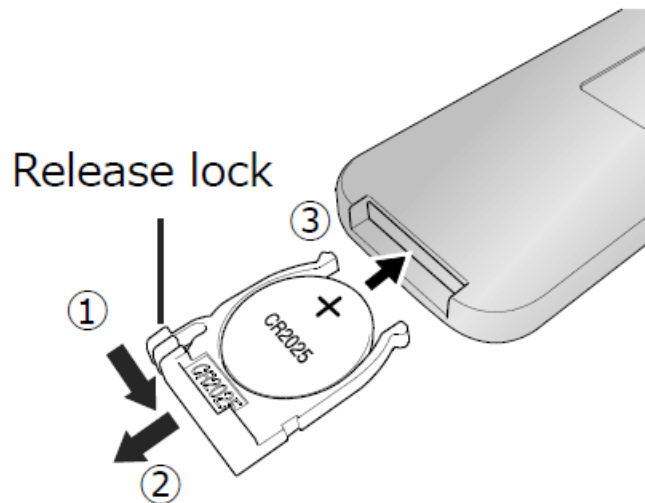

WARNING

Children may ingest small batteries; always keep batteries safe and out of reach.

If a battery is swallowed, consult a doctor immediately as this could result in asphyxiation or be an obstacle to digestion, etc.

USING THE PRODUCT

TURNING THE POWER ON/OFF

Press the [] button to turn the power ON. (The LED turns blue.)

Press the [] button for long to turn the power OFF.

<Operating Panel>

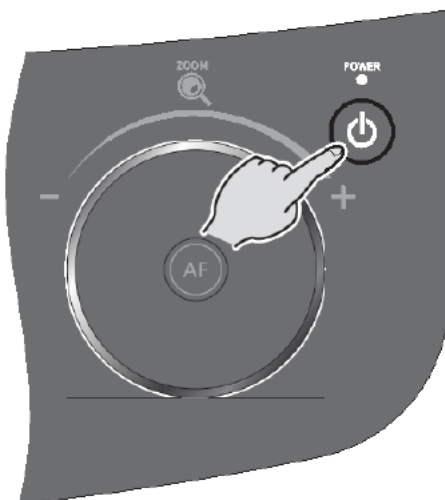

<Remote control>

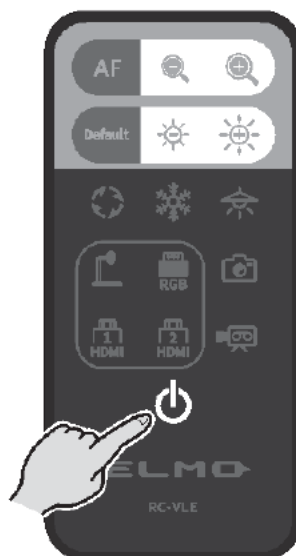

Power OFF
(Red lamp)

↓
Power ON
(Blue lamp)



ZOOM CONTROL / FOCUS ADJUSTMENT

<Zoom jog dial>

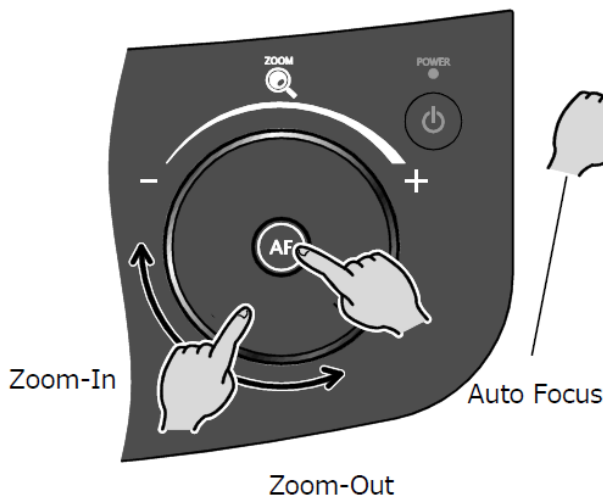



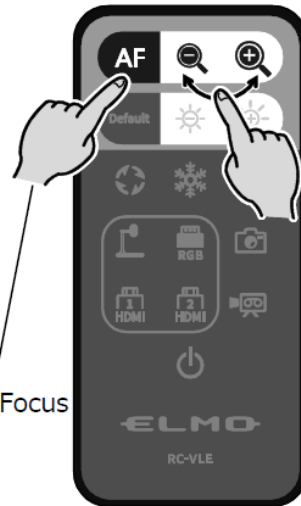

<Remote control>

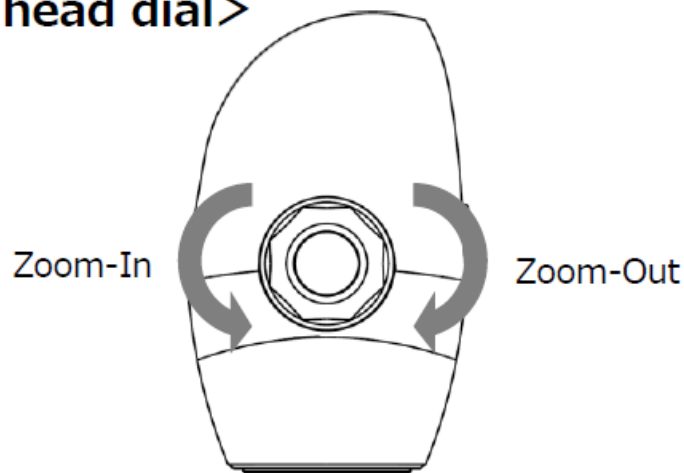

<Zoom head dial>

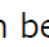

ADJUSTING THE BRIGHTNESS

Press the [] button on the operating panel to adjust the image brightness. The image brightness can be adjusted by sliding the [] button to the right or left. Press the [ / ] buttons on the remote control to adjust the image brightness. Press the [ / Default] button to return to the factory settings.

<Operating Panel>

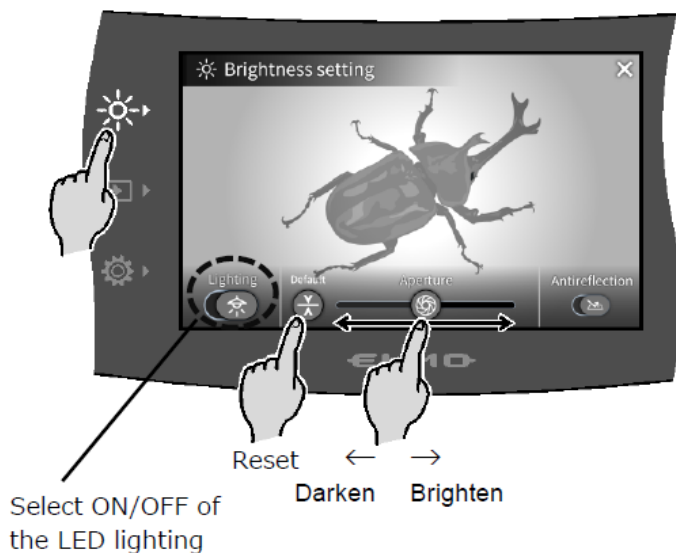



<Remote control>



SAVING A STILL PICTURE / RECORDING A VIDEO

Insert the SD card into the SD card slot in the side of the product.

Press the [] button to save a still picture.

Press the [] button to start or stop the video recording.

<Operating Panel>

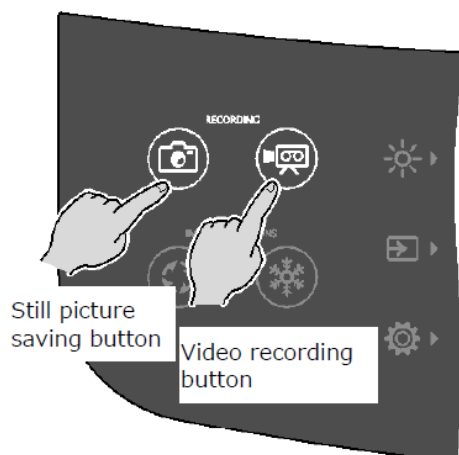

<Remote control>

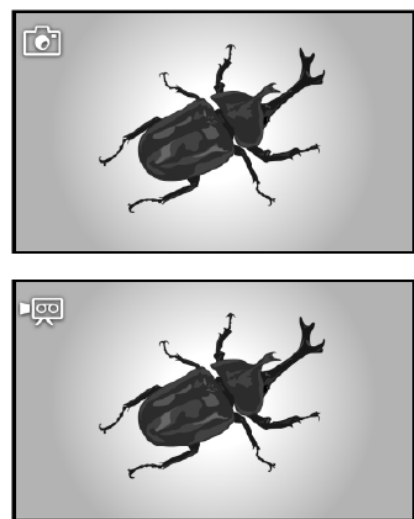
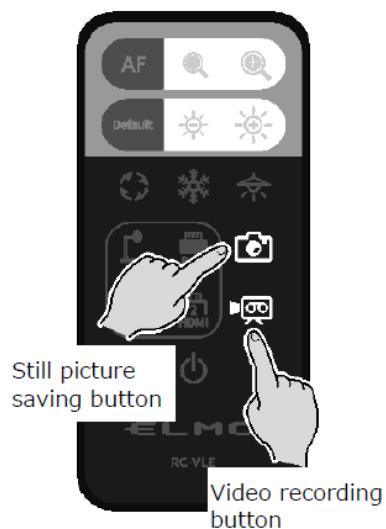

NOTE

The maximum recording time is 29minutes 50seconds.

The video recording will stop automatically when the recording time exceeds this limit.

ROTATING THE IMAGE

Press the [] button to rotate the camera image. The default rotation angle is 180°. The rotation angle can also be set to 90°.

<Operating Panel>

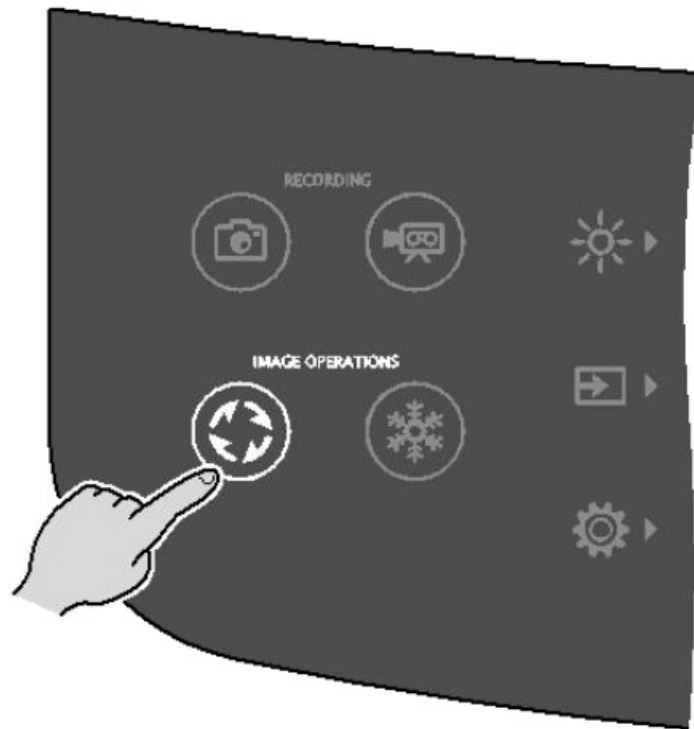

Remote control

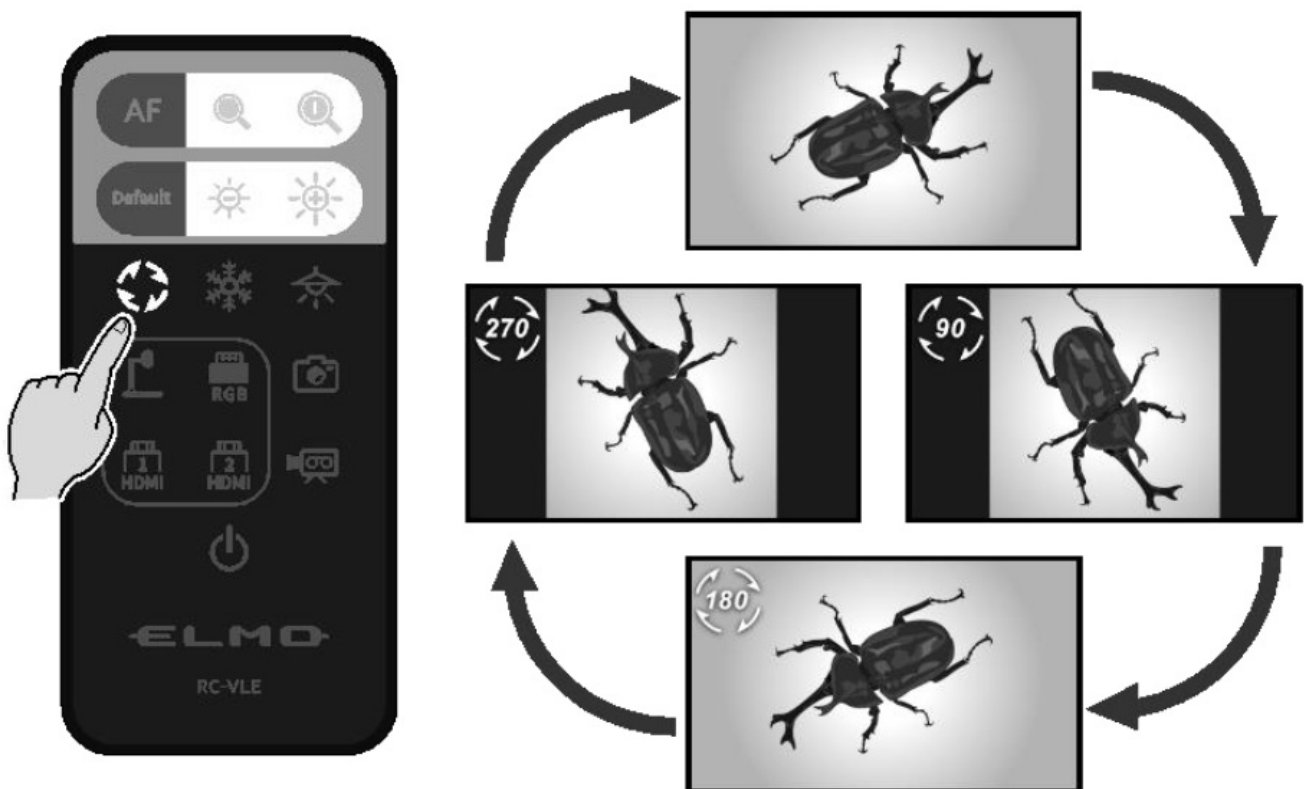

PAUSING THE IMAGE

Press the [] button to pause or restart the camera image.

<Operating Panel>



Remote control



VARIOUS USAGE

USING WITH THE WHITEBOARD SHEET

Place the whiteboard sheet on the stage.

You can directly draw on the whiteboard with a whiteboard marker. It may be difficult to erase writing or drawings on the surface with a whiteboard eraser. We recommend you used a melamine sponge. The melamine sponge is consumable. When the supplied melamine sponge needs to be replaced, purchase a commercially available melamine sponge.

CAUTION

When writing, write on the whiteboard sheet. If you write directly on the stage, you may not be able to erase it. It is recommended to attach the supplied caution sticker to the product.

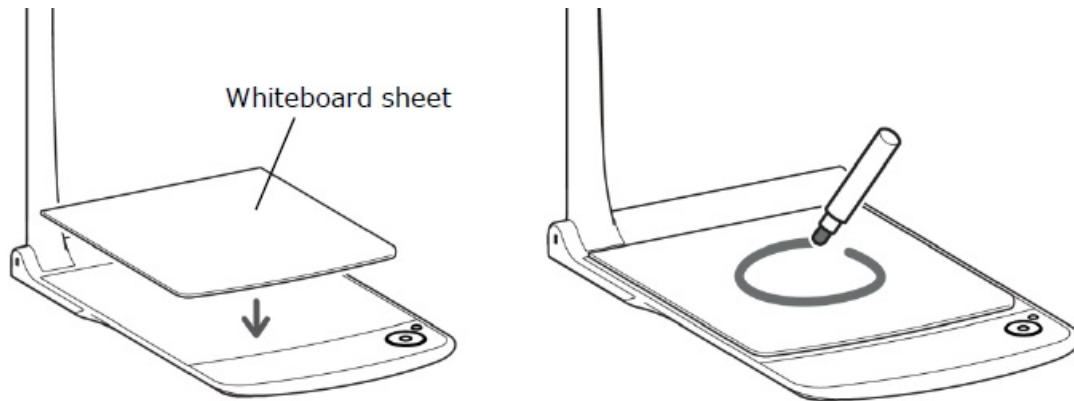

SIMULTANEOUS IMAGE OUTPUT

The camera image can be simultaneously output from HDMI port, HDBT port, USB3.0 port and RGB port.

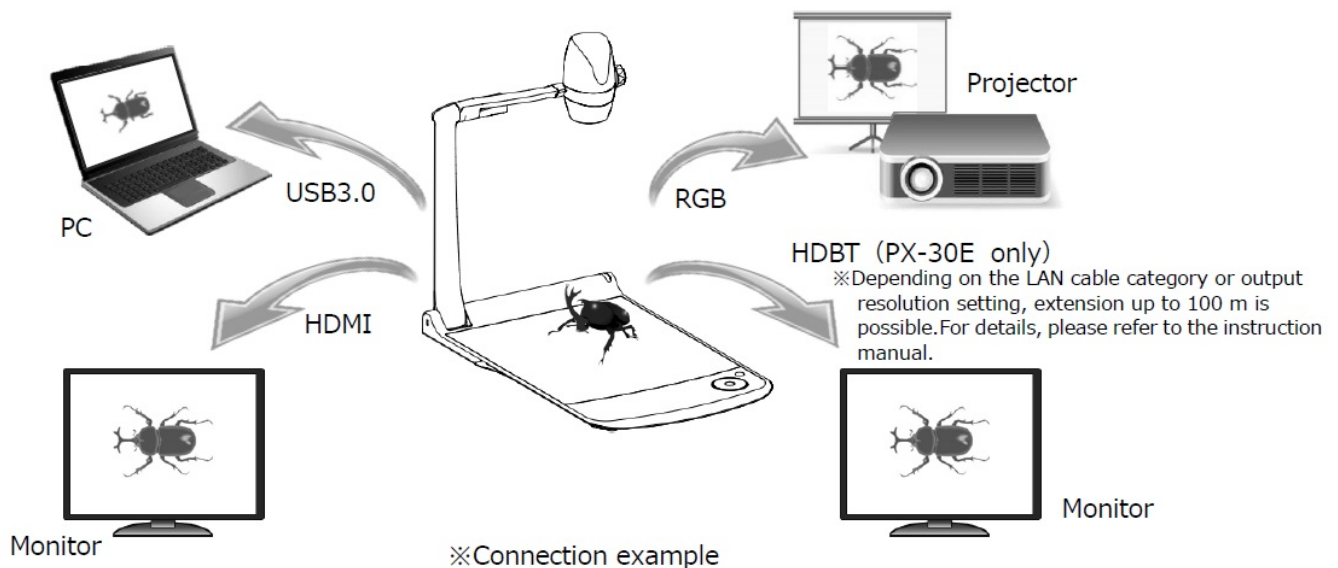

TRADEMARKS AND LICENSES

ELMO is the registered trademark of ELMO Co., Ltd.
HDMI, **HDMI**™ logo and High-Definition Multimedia interface are trademarks or registered trademarks of HDMI Licensing LLC.
SD, **SD** logo are trademarks of SD-3C, LLC.
HDBaseT and **HDBT** logo are trademarks of HDBaseT Alliance.

All other company/product names described in this manual are trademarks or registered trademarks of their respective companies.

This product is licensed under the AVC Visual Patent Portfolio License (AVC Video) for the personal and non-

commercial use of a consumer to

1. play AVC Video that was recorded by a consumer engaged in a personal and a non-commercial activity and/or,
2. play AVC Video that was obtained from a video provider licensed from MPEG-LA, LLC.

Additional information including that relating to promotional and commercial uses may be obtained from MPEG-LA, LLC.

CAUTION

- Unless used for personal use, it is prohibited by copyright law to record slides, books and photos without the prior consent of copyright holder.
- This product is designed to be used in industrial environment. If it is used in a residential area or in an adjacent area thereto, harmful interference to radio or television reception may occur.
- Repair parts
Repair parts are the items which are needed to maintain product functionality. The holding period of such repair parts is 5 years after the product discontinuation, which is equal to the repair period we will accept.
- Any image, which is obtained by this product, and which can be identified, is considered to be private information. Be forewarned that the person who makes use of such images shall be liable for disclosing of such images.

OVERSEAS SUBSIDIARY COMPANIES

ELMO USA CORP.

Headquarters 6851 Jericho Turnpike Suite 145
Syosset, NY 11791

Tel. [516-501-1400](tel:516-501-1400)

Fax. [516-501-0429](tel:516-501-0429)

E-mail: elmo@elmousa.com

Web: <https://www.elmousa.com/>

ELMO Europe SAS

Headquater
Tour Voltaire
1 Place des Degrés 92800 Puteaux FRANCE

Tel: +33 (0)1 74 54 49 81

E-mail: info@elmoeurope.com

Web: <https://www.elmoeurope.com/>

German Branch
Monschauerstr. 1
40549 Düsseldorf
GERMANY

Tel. +49 (0) 211 544756 40

E-mail: info@elmo-germany.de

ELMO CO., LTD.

1-3-4, Shioya-cho, Minami-ku Nagoya, 457-0078, Japan

Documents / Resources



[Elmo PX-30E Visual Presenter \[pdf\] User Guide](#)

PX-30E, PX-10E, PX-30E Visual Presenter, PX-30E, Visual Presenter, Presenter

References

- [ELMO EUROPE SAS](#)
- [S Sens – Največja izbira poslovnih, maturantskih in svečanih moških oblek](#)
- [ELMO EUROPE SAS](#)
- [ELMO EUROPE SAS](#)
- [ELMO EUROPE SAS](#)
- [ELMO EUROPE SAS](#)
- [User Manual](#)

[Manuals+](#), [Privacy Policy](#)

This website is an independent publication and is neither affiliated with nor endorsed by any of the trademark owners. The "Bluetooth®" word mark and logos are registered trademarks owned by Bluetooth SIG, Inc. The "Wi-Fi®" word mark and logos are registered trademarks owned by the Wi-Fi Alliance. Any use of these marks on this website does not imply any affiliation with or endorsement.