



ELKO ep RFWB-20-G On-Wall Button Controller User Manual

[Home](#) » [ELKO ep](#) » ELKO ep RFWB-20-G On-Wall Button Controller User Manual 

Contents

- [1 ELKO ep RFWB-20-G On-Wall Button Controller](#)
- [2 Product Information](#)
- [3 Product Usage Instructions](#)
- [4 Insertion and replacement of a battery](#)
- [5 Safe handling](#)
- [6 Technical parameters](#)
- [7 Indicators settings](#)
- [8 Documents / Resources](#)
 - [8.1 References](#)
- [9 Related Posts](#)



ELKO ep RFWB-20-G On-Wall Button Controller



Product Information

The RFWB-20/G and RFWB-40/G are on-wall button controllers that can control the following:

- RFRP-20
- 60 – 90% wooden structures with plasterboards
- 80 – 95% reinforced concrete
- 20 – 60% common glass
- 0 – 10%

The controllers operate on a transmission frequency of 866 MHz, 868 MHz, and 916 MHz, with a range of up to 200m in free space. The operating temperature range is not specified, and the controllers have an IP20 protection rating. They come with a plastic frame and weigh 55g (RFWB-20/G) and 56g (RFWB-40/G).

Product Usage Instructions

1. Using a screwdriver, carefully pry off the device from the frame.
2. Gently pull to remove the cover.
3. Slide the CR2032 battery into the battery holder while observing the polarity.
4. Snap on the cover, ensuring that the LED opening is located in the upper part (for the RFWB-40/G, observe the positioning of the left and right cover).
5. Place the frame on the rear part.
6. Snap the device with the cover into the prepared frame.

When handling the device, avoid contact with liquids and never place it on conductive pads or objects. Also, avoid unnecessary contact with the components of the device. To switch between RFIO2 mode and compatibility mode, insert the battery and hold buttons 1 and 2 simultaneously until the LED starts to signal the changed mode (double flash or rapid flash). The selected function mode is stored in memory and will continue to operate in the same mode after replacing the battery.

Characteristics

- The wireless controller is used to control switches and dimmers (lights, gates, garage doors, blinds, etc.).
-
- FWB-20/G: two buttons enable control of two units independently.
- FWB-40/G: four buttons enable control of four units independently.
- The flat design with a level base makes it ideal for fast installation on any surface (fixation with adhesive or screws in the installation box).
- When pressing the button, it sends a set signal (ON / OFF, dimming, time switching OFF / ON, blinds up / down).
- Sending a command is indicated by a red LED.
- In LOGUS90 switch frame design (plastic, glass, wood, metal, stone).
- Option of setting light scenes, where with a single press, you can control units of iNELS RF Control.
- Battery power supply (3V/CR2032 – included in the supply) with a battery life of around 5 years based on the frequency of use.
- Range up to 200 m (in open space), if the signal is insufficient between the controller and unit, use the signal repeater RFRP-20 or protocol component RFIO2 that supports this feature.
- Communication frequency with bidirectional protocol iNELS RF Control.





Control options

RF controllers can control:

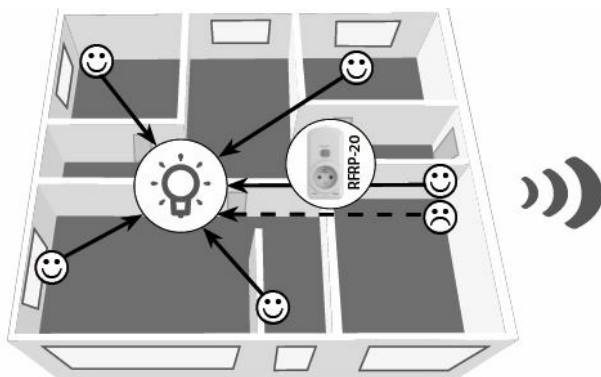
- **switches** RFSA-11B, RFSA-61B, RFSA-62B, RFSA-61M, RFSA-66M, RFSAI-61B, RFSC-11, RFSC-61, RFUS-11, RFUS-61, RFJA-12B
- **dimmers** RFDA-73/RGB, RFDA-11B, RFDA-71B, RFDEL-71B, RFDEL-71M, RFDSC-11, RFDSC-71, RFDAC-71B
- **lighting** RF-RGB-LED-550, RF-White-LED-675

Radio frequency signal penetration through various construction materials



				
60 - 90 %	80 - 95 %	20 - 60 %	0 - 10 %	80- 90 %
brick walls	wooden structures with plaster boards	reinforced concrete	metal partitions	common glass
tehlové steny	drevené konštrukcie so sádkokart. doskami	vystužený betón	kovové prepážky	bežné sklo

Insertion and replacement of a battery

RFWB-20 / RFWB-40

1. Using a screwdriver, carefully pry off the device from the frame.

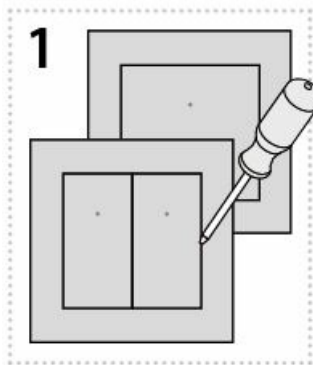

2. Gently pull to remove the cover.

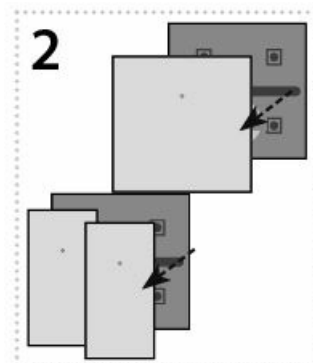

3. Slide the CR2032 battery into the battery holder. Observe the polarity.

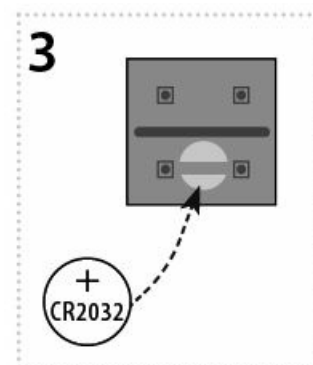

4. Snap on the cover. The LED opening must be located in the upper part (for the RFWB-40, observe the positioning of the left and right cover).

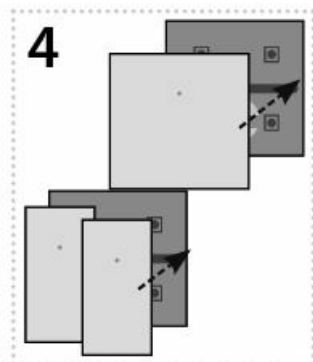

5. Place the frame on the rear part.

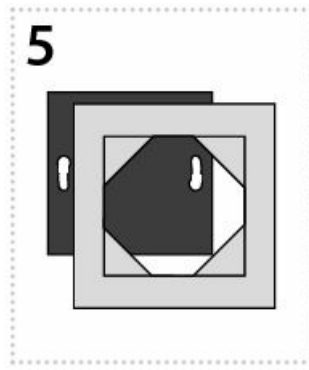

6. Snap the device with the cover into the prepared frame.

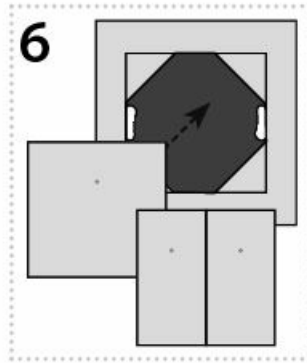

Safe handling



When handling a device unboxed it is important to avoid contact with liquids. Never place the device on the conductive pads or objects, and avoid unnecessary contact with the components of the device.

Technical parameters



Supply voltage:	3 V battery / batéria CR 2032	
Transmission indication:	red	
Number of buttons:	2	4
Transmitter frequency:	866 MHz, 868 MHz, 916 MHz	
Signal transmission method:	unidirectionally addressed message	
Range in free space:	up to / až 200 m	
<u>Other data</u>		
Operating temperature:	-10 ... +50 °C	
Operating position:	any / ľubovoľná	
Mounting:	glue, screws	
Protection:	IP20	
Contamination degree:	2	
Dimensions:		
LOGUS90 frame – plastic:	85 x 85 x 16 mm	
LOGUS90 frame – metal, glass, wood, granite:	94 x 94 x 16 mm	
Weight:	55g *	56g *
Related standards:	EN 60730, EN 63044, EN 300 220, EN 301 489	

- Comes with plastic frame. No installation into multi-frames.

Attention:

When you install the iNELS RF Control system, you have to keep a minimal distance 1 cm between each unit. Between the individual commands must be an interval of at least 1s.

Indicators settings

After inserting the battery, the red LED lights up continuously for 3 seconds and then for 5 seconds, the selected controller function is indicated by flashing LED

- double flash – standard RFIO2 operating mode
- rapid flashing – mode of compatibility with older actuators

If you do not want to change the function of the controller, you must not press any buttons during this time

To switch between RFIO mode and compatibility mode:

- If you need to change the operating mode of the controller, after inserting the battery, when the LED is constantly lit. Press buttons 1 and 2 simultaneously and hold until the LED starts to signal the changed mode (double flash or rapid flash). Then the buttons must be released. The selected function mode is stored in memory and after replacing the battery, the controller continues to operate in the same mode.
- If the controller is used in RFIO mode, then it is necessary to instruct the controller and link to the actuators to switch to learn mode not only the actuator (according to the instructions for the actuator), but also the controller in the following way: Remove the battery from the controller, press some of the buttons several times to discharge the internal capacitors and replace the battery. When the LED lights up, press button 1 and keep it pressed until the controller starts signaling the learning mode with short flashing LEDs. Then release the button and the button now works in RFIO learning mode. To end the learning mode, remove the battery, and press some of the buttons several times. and then replace the battery. Now we press any button and the controller will start again in RFIO operating mode.
- Use a suitable tool (paper clip, screwdriver) to push on the control pin. The batteries are raised and the programming button is released
- After removing the control flaps, the programming button is accessible.
- The programming button is operated with a suitable thin tool.

Warning

The instruction manual is designated for mounting and also for user of the device. It is always a part of its packing. Installation and connection can be carried out only by a person with adequate professional qualification upon understanding this instruction manual and functions of the device, and while observing all valid regulations. The trouble-free function of the device also depends on transportation, storing, and handling. In case you notice any sign of damage, deformation, malfunction or missing part, do not install this device and return it to its seller. It is necessary to treat this product and its parts as electronic waste after its lifetime is terminated. Before starting the installation, make sure that all wires, connected parts or terminals are de-energized. While mounting and servicing observe safety regulations, norms, directives, and professional, and export regulations for working with electrical devices. Do not touch parts of the device that are energized – life threat. Due to the transmissivity of RF signals, observe the correct location of RF components in the building where the installation is taking place. RF Control is designated only for mounting in interiors. Devices are not designated for installation in exteriors and humid spaces. They must not be installed into metal switchboards and into plastic switchboards with metal doors – transmissivity of RF signal is then impossible. RF Control is not recommended for pulleys etc. The radiofrequency signal can be shielded by an obstruction, interfered, a battery of the transceiver can get flat, etc., and thus disable

the remote control. ELKO EP declares that the RFOWB-20 type of equipment complies with Directives 2014/30/EU, 2011/65/EU, 2015/863/EU, and 2014/35/EU. The full EU Declaration of Conformity is available at: 3

ELKO EP declares that the RFWB type of equipment complies with Directives 2014/30/EU, 2011/65/EU, 2015/863/EU and 2014/35/EU.

www.elkoep.com/on-wall-button-controller—2-buttons-rfwb-20g

www.elkoep.com/on-wall-button-controller—4-buttons—rfwb-40g

ELKO EP, s.r.o., Palackého 493, 769 01 Holešov, Všetuly, Czech Republic

Tel.: +420 573 514 211, e-mail: elko@elkoep.com, www.elkoep.com

ELKO EP declares that the RFWB type of equipment complies with Directives 2014/30/EU, 2011/65/EU, 2015/863/EU and 2014/35/EU.

www.elkoep.sk/bezdrotov-y-ovladac-rfwb-40g

ELKO EP, s.r.o., Palackého 493, 769 01 Holešov, Všetuly, Czech Republic

Tel.: +420 573 514 211, e-mail: elko@elkoep.com, www.elkoep.com

ELKO EP, s.r.o.

Palackého 493

769 01 Holešov, Všetuly

Czech Republic

e-mail: elko@elkoep.com

Support: +420 778 427 366

ELKO EP SLOVAKIA, s.r.o.

Fraňa Mojtu 18, 949 01 Nitra

Telefón: +421 37 6586 731

E-mail: elkoep@elkoep.sk

www.elkoep.com

www.elkoep.sk

Documents / Resources

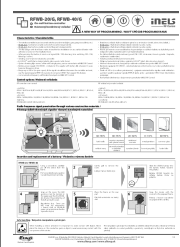
	<p>ELKO ep RFWB-20-G On-Wall Button Controller [pdf] User Manual</p> <p>RFWB-20-G, RFWB-40-G, RFWB-20-G On-Wall Button Controller, RFWB-20-G, On-Wall Button Controller, Button Controller, Controller</p>
---	--

References

- [ELKO EP - Global relay manufacturer • ELKO EP](#)
- [On-wall button controller - 2 buttons - RFWB-20G • ELKO EP](#)
- [On-wall button controller - 4 buttons - RFWB-40/G • ELKO EP](#)
- [ELKO EP - Výrobca elektronických prístrojov • ELKO EP](#)
- [Nástenný bezdrôtový ovládač - 2 tlačítka - RFWB-20/G • ELKO EP](#)
- [Nástenný bezdrôtový ovládač - 4 tlačítka - RFWB-40/G • ELKO EP](#)