



ELKO ep 8322 Wireless Switch Socket Instruction Manual

[Home](#) » [ELKO ep](#) » ELKO ep 8322 Wireless Switch Socket Instruction Manual 

Contents

- 1 [ELKO ep 8322 Wireless Switch Socket](#)
- 2 [Glass touch controller – 4 buttons, SHARP/ROUND, RFGB-40/RFGB-240](#)
 - 2.1 [Replacement of a battery in 3 steps](#)
- 3 [Assembly](#)
 - 3.1 [Adhesive](#)
 - 3.2 [Technical parameters](#)
- 4 [Switching socket-plug RFSC-61N \(Schuko, French, British\)](#)
 - 4.1 [Assembly](#)
 - 4.2 [Technical parameters](#)
- 5 [Warning](#)
- 6 [Documents / Resources](#)
 - 6.1 [References](#)
- 7 [Related Posts](#)



ELKO ep 8322 Wireless Switch Socket



Content

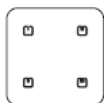
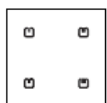

Glass touch controller - 4 buttons, SHARP RFGB-40/W, RFGB-40/B
Glass touch controller - 4 buttons, ROUND RFGB-240/W, RFGB-240/B



Switching socket-plug
RFSC-61N

Schuko

British

French

- EAN 8595188183222 (Glass touch controller – 4 buttons, BLACK SHARP + Switching socket-plug “French”)
- EAN 8595188183420 (Glass touch controller – 4 buttons, BLACK SHARP + Switching socket-plug “Schuko”)
- EAN 8595188183321 (Glass touch controller – 4 buttons, BLACK SHARP + Switching socket-plug “British”)
- EAN 8595188183239 (Glass touch controller – 4 buttons, WHITE SHARP + Switching socket-plug “French”)
- EAN 8595188183437 (Glass touch controller – 4 buttons, WHITE SHARP + Switching socket-plug “Schuko”)
- EAN 8595188183338 (Glass touch controller – 4 buttons, WHITE SHARP + Switching socket-plug “British”)
- EAN 8595188183246 (Glass touch controller – 4 buttons, BLACK ROUND + Switching socket-plug “French”)
- EAN 8595188183444 (Glass touch controller – 4 buttons, BLACK ROUND + Switching socket-plug “Schuko”)
- EAN 8595188183345 (Glass touch controller – 4 buttons, BLACK ROUND + Switching socket-plug “British”)
- EAN 8595188183253 (Glass touch controller – 4 buttons, WHITE ROUND + Switching socket-plug “French”)
- EAN 8595188183451 (Glass touch controller – 4 buttons, WHITE ROUND + Switching socket-plug “Schuko”)
- EAN 8595188183352 (Glass touch controller – 4 buttons, WHITE ROUND + Switching socket-plug “British”)

Schema

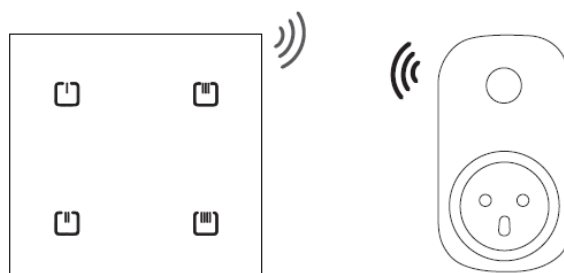

The individual elements in the iNELS set are paired and their functions are preset.

iNELS Wireless switch socket enables the basic function of controlling electrical appliances – ON / OFF.

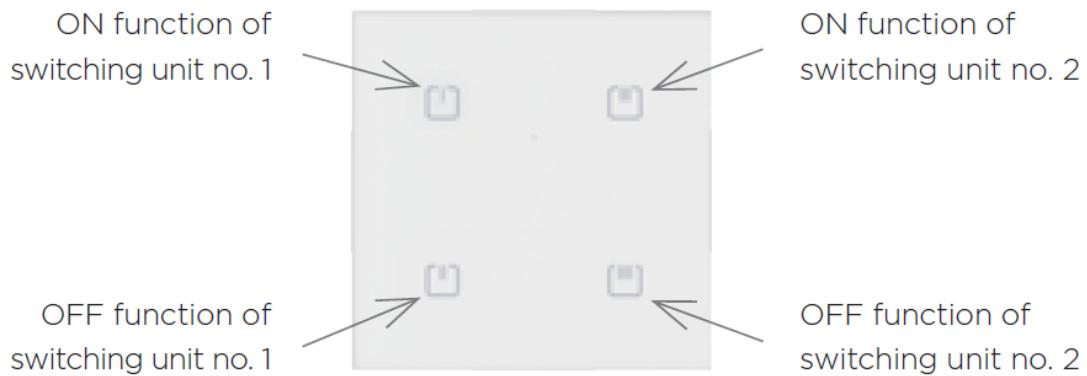

The settings of the wall controllers can be changed – see detailed manuals of iNELS elements.

Glass touch controller – 4 buttons, SHARP/ROUND, RFGB-40/RFGB-240

RFGB-40/B – glass touch controller, SHARP – black, 4-buttons RFGB-40/W – glass touch controller, SHARP – white, 4-buttons RFGB-240/B – glass touch controller, ROUND – black, 4-buttons RFGB-240/W – glass touch controller, ROUND – white, 4-buttons

Characteristics

- The wireless control – used to control, lights, gate, garage door, shutters, etc.
- Thickness only 8 mm.
- 4 capacitive buttons allow you to control 2/4 components.
- Fast installation on any surface – the rear base allows screwing to the walls, gluing with double-sided tape or just laying on the table

Detailed manual



RFGB-40

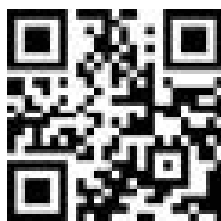

RFGB-240

Replacement of a battery in 3 steps

- Press to open the plug-in battery holder (you can use a flat-blade screwdriver to open it)..

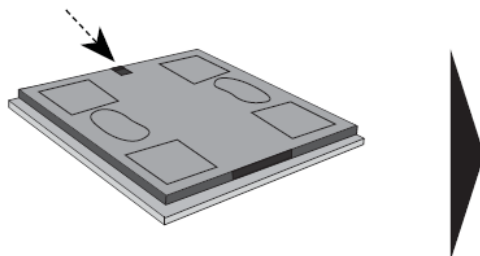

- Insert the CR2032 battery into Battery holder. Watch out for polarity.

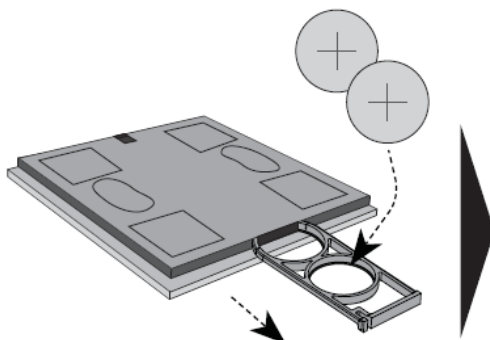

- Insert the holder into the device.

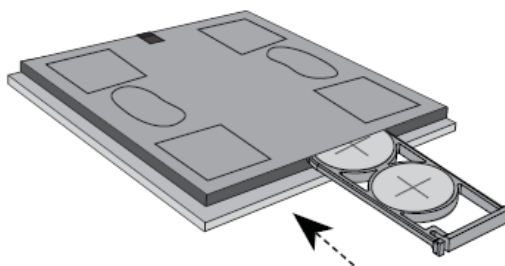

Assembly

Adhesive

- Peel off one protective layer on the double-sided adhesive sheets and stick them to the marked places on the controller.

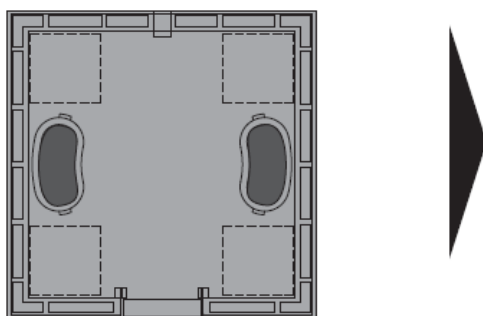

- Peel off the second protective layer on the double-sided adhesive sheets and place the control in the prepared place.

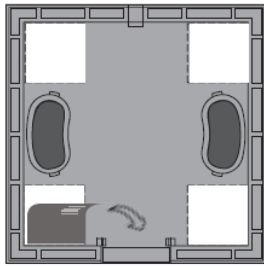

- If the device is installed on glass, cover it with a cover foil.

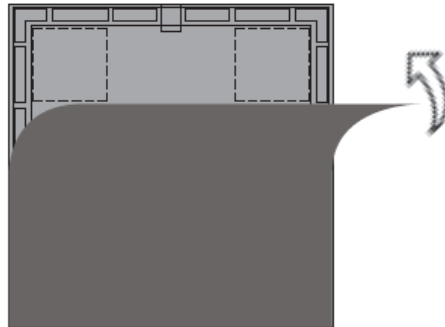

In the installation box or on the wall

- Mount the snap bar on the controller into the installation box or on the wall

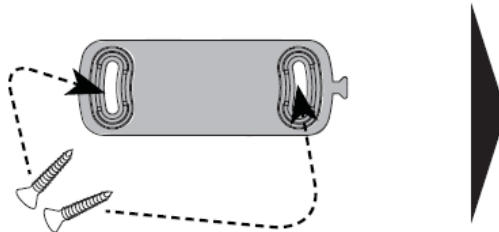

- Place the mounting jig on the KU box and screw it on

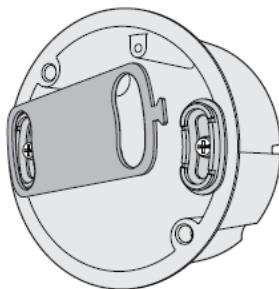

- Snap on the controller.

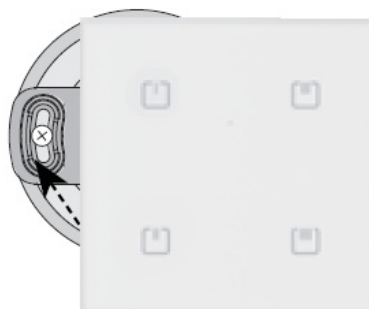

Technical parameters

RFGB-40/RFGB-240

Power voltage:	2x 3 V battery CR 2032
Battery life:	about 2 years depending on the frequency of use
Transmission indication	Red LED
Number of capacitive buttons:	4
Communication Protocol:	RFIO2
Frequency:	868.5 MHz
Signal transmission method:	one-way addressed message
Range:	in the open up to 200 m
Material:	Glass
Other data	
Operating Temperature:	-10 ... +50 °C (14 ... 122 °F)
Working Position	any
Mounting:	adhesive, screw
Protection	IP20
Pollution degree:	2
Dimension:	SHARP 94 x 94 x 8 mm (3.7" x 3.7" x 0.3") / ROUND 100 x 100 x 8 mm (3.9" x 3.9" x 0.3")
Weight:	SHARP 107 g/ ROUND 108 g
Related standards:	EN 60669, EN 300 220, EN 301 489

Switching socket-plug RFSC-61N (Schuko, French, British)

Detailed manual

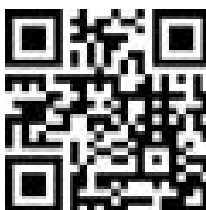

Characteristics

- The switched socket with 1 output channel is used to control fans, lamps, heaters and appliances, which are connected by a power cord.
- They can be combined with detectors, controllers, iNELS RF Control system components.
- Thanks to the socket design, installation is simple by direct insertion into the existing socket.
- It enables connection of the switched load up to 16A (4.000 W).
- Multi-function design – button, impulse relay and time function of delayed ON or OFF with time setting of 2 s – 60 min.
- The switched socket may be controlled by up to 32 channels (1 channel represents 1 button on the controller).
- The programming button on the socket is also used for manual control of the output.
- Memory status can be pre-set in the event of a power failure.
- Range up to 200 m (in open space), if the signal is insufficient between the controller and unit, use the signal repeater RFRP-20 or protocol component RFIO2 that support this feature.
- Communication frequency with bidirectional protocol iNELS RF Control2 (RFIO2).
- Produced in 3 designs of sockets and plugs.

Assembly

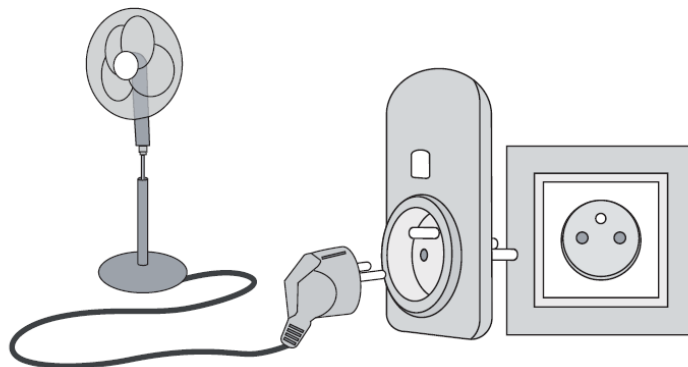

Technical parameters

RFSC-61 N/230V

Supply voltage:	230 V / 50-60Hz
Apparent power:	7 VA
Dissipated power:	0.7 W
Supply voltage tolerance:	+10 %; -15 %
Output:	
Number of contacts:	1x switching (AgSnO ₂)
Rated current:	16 A / AC1
Switching power:	4000 VA / AC1, 384 W / DC
Peak current:	30 A / < 3 s
Switching voltage:	250 V AC1 / 24 V DC
Min. switching power DC:	500 mW
Mechanical service life:	3×10 ⁷
Electrical service life (AC1):	0.7×10 ⁵
Control:	
Manual control:	button PROG (ON/OFF)
Other data:	
Operating temperature:	-15 ... + 50 °C (5 ... +122 °F)
Working position:	any
Protection:	IP30
Overvoltage category:	III.
Contamination degree:	2
Dimensions:	63 x 110 x 74 mm
Weight:	129 g
Related standards:	EN 60730, EN 63044, EN 300 220, EN 301 489

Compatibility

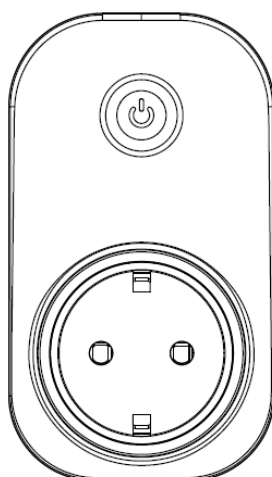

The detector can be assigned an iNELS RF Control2 (RFIO2) communication protocol.

Range up to 200 m (2 inch) in open space,



Designed & Manufactured by:

ELKO EP, s.r.o. Palackého 493, 769 01 Holešov, Všetuly,

Czech republic, www.elkoep.com,

Hotline: +420 800 100 671

Documents / Resources



References

-  [ELKO EP - Global relay manufacturer • ELKO EP](#)