

ELITE SCREENS
TripodTT_CLR2
Tripod Tab
Tension Portable
Screen



ELITE SCREENS TripodTT_CLR2 Tripod Tab Tension Portable Screen User Guide

[Home](#) » [ELITE SCREENS](#) » ELITE SCREENS TripodTT_CLR2 Tripod Tab Tension Portable Screen User Guide 

Contents

- [1 ELITE SCREENS TripodTT_CLR2 Tripod Tab Tension Portable Screen](#)
- [2 Tripod Screen Parts Identification](#)
- [3 Notice to Installer](#)
- [4 Documents / Resources](#)
 - [4.1 References](#)



ELITE SCREENS TripodTT_CLR2 Tripod Tab Tension Portable Screen



Thank you for choosing the Tripod Tab-Tension CLR® 2 projection screen! This tab-tensioned tripod pull-up screen is best for rooms with minimal control of overhead room lighting. It utilizes our ISF Certified CLR® 2 front projection ceiling ambient light rejecting material. It is precisely formulated to increase brightness, produce accurate colors, and improve contrast. The CLR® 2 is best for family rooms, educational facilities, conference rooms, house of worship or any applications in which incident light is a factor.

Compatible only with ultra-short and short-throw projectors.

In order for the CLR® 2 to maintain its projection qualities and optimum performance please refer to the list below for proper maintenance and cleaning.

- Use a dry microfiber cloth to remove dust from the screen's surface.
- When cleaning, use a damp microfiber cloth with warm water to remove any marks.
- Never rub or apply pressure when cleaning the surface.
- Never attempt to use any solutions, chemicals, or abrasive cleaners on the screen surface.
- To avoid damaging the screen, avoid touching it directly with your fingers, pens/pencils or any other sharp or abrasive objects.

Please be sure to read the precautions and operating instructions carefully before operating the screen. Proper maintenance and handling will ensure a longer lifespan for the product.

Tripod Screen Parts Identification

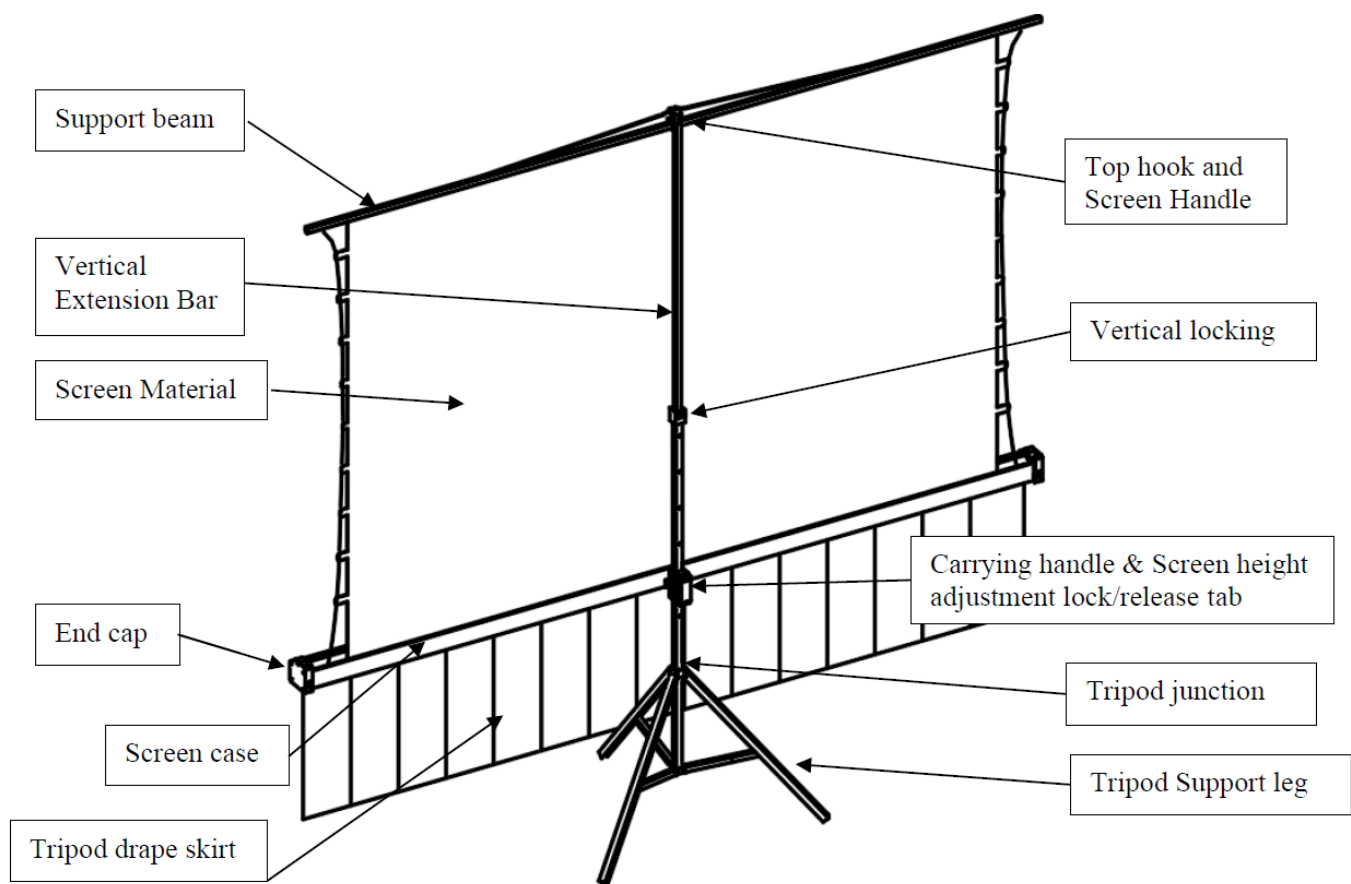

A. Tripod Screen Housing Installation and Setup:

Follow the steps below and Fig.1.

1. Place the tripod screen in an upright position with the legs toward the ground.
2. Deploy the tripod support legs by pushing down on the tripod junction.
3. Extend the legs as much as possible so they are stable and position them away from objects that may interfere with their balance. DO NOT stand on unstable platforms to avoid an injury should the tripod screen collapse or tip over.
4. Attach the screen housing to the tripod stand by inserting the back peg on the locking latch.

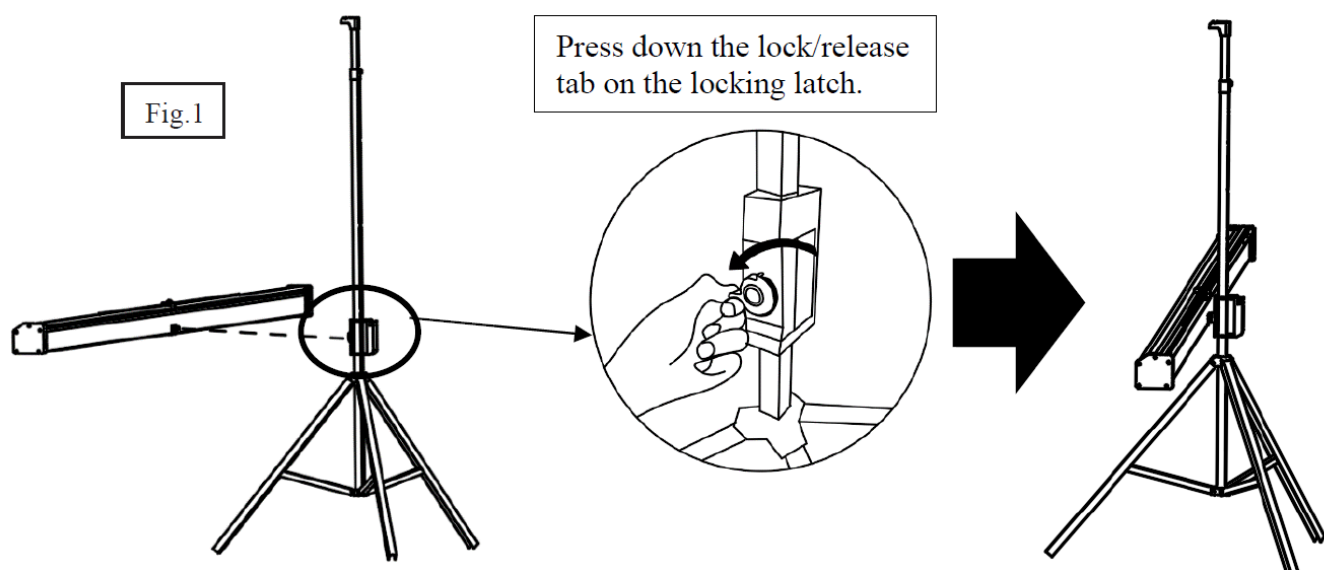

B. Preparing the tripod screen for projection:

Follow the steps below and Fig. 2.

1. Pull the screen handle up vertically and hook the screen handle on the Top Hook.
2. Push/press the Vertical Locking Tab to unlock the current position of the Vertical Extension Bar and raise it with another hand. Remain pushing on the button until you reach the desired height and let go until you hear a click sound which indicates it is locked in place.
3. Push/press the Screen Height Adjustment Lock/Release located just above the Carrying Handle to raise or lower the bottom of the screen. Once the desired height has been set, let go of the tab to lock the position in place.

Fig.2

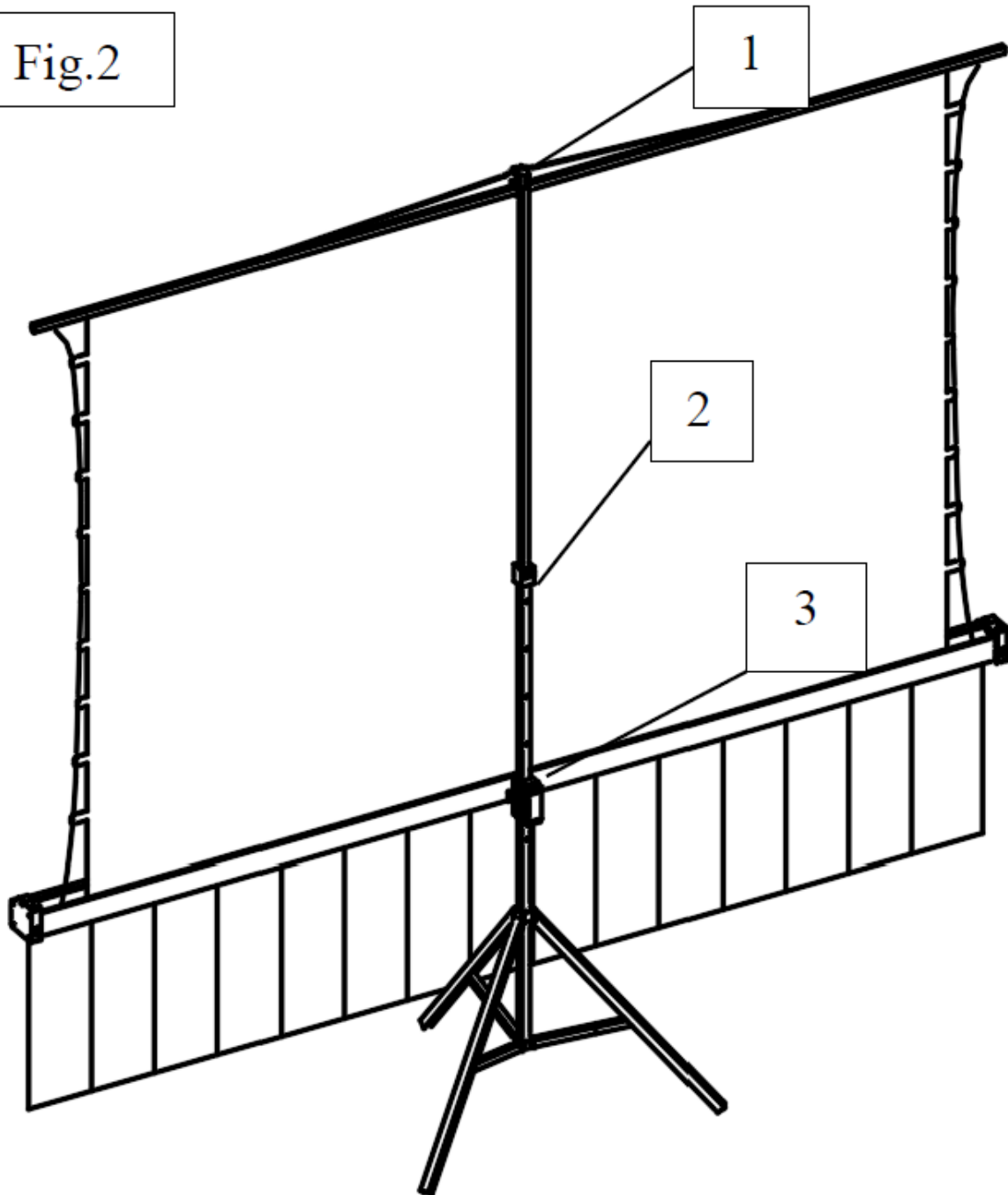

Tripod Skirt Installation

4. Unfold the tripod skirt in a clean area. Use the hook and loop fastener to attach it to the tripod case.

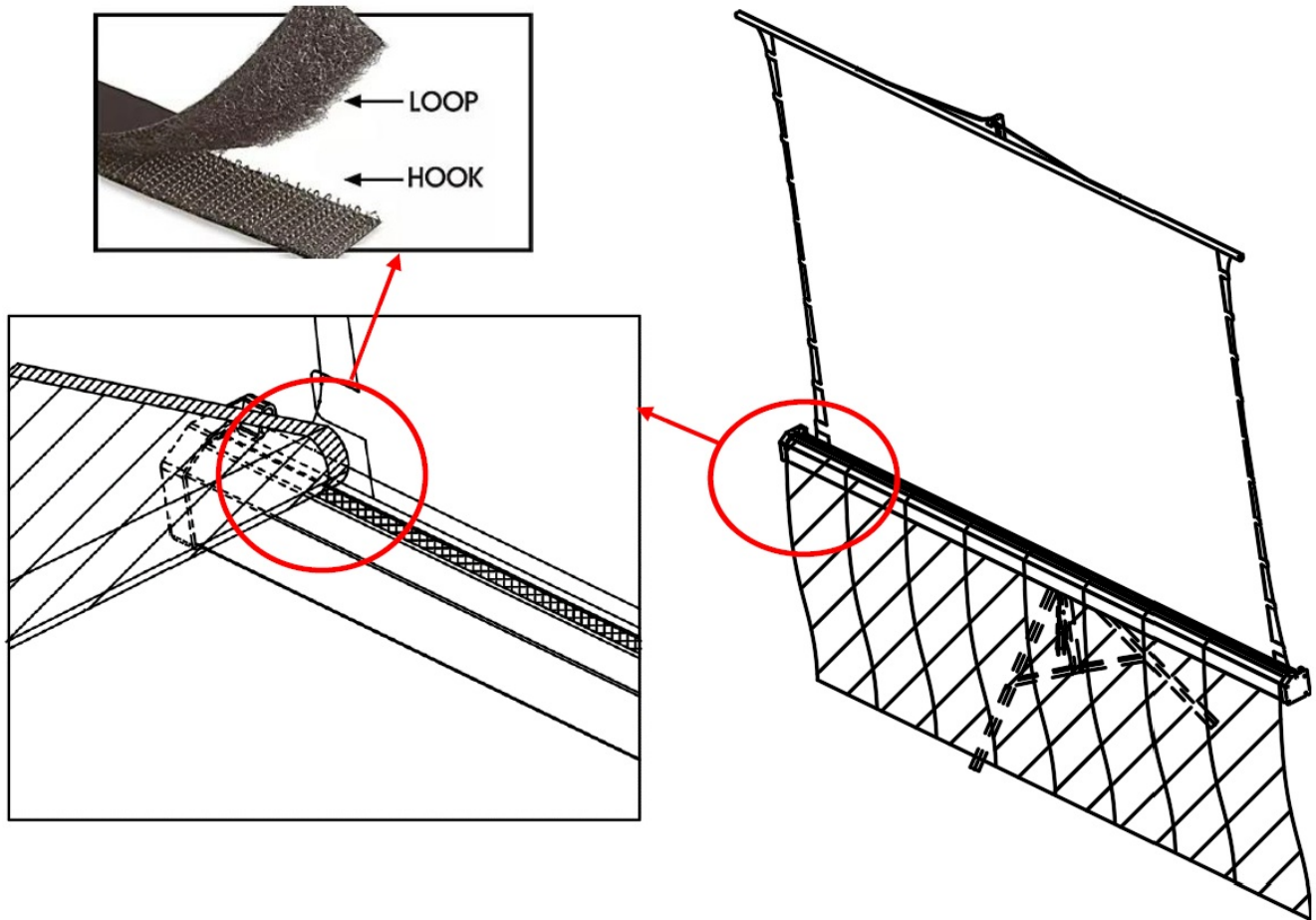

C. Collapsing the screen:

Follow the steps below and Fig. 3.

1. Push/press the Screen Height Adjustment Lock/Release Tab to unlock and slowly slide the handle up (NOT all the way) to slowly retract the screen into its case.
2. Press the Vertical Adjustment Lock/Release Tab to unlock and slowly bring the extension bar down to lower the position of the screen's top hook.

Note: It is very important to remember to hold the extension bar first and then unlock the adjustment tab to prevent the extension bar from slamming and causing injury or damaging the screen.

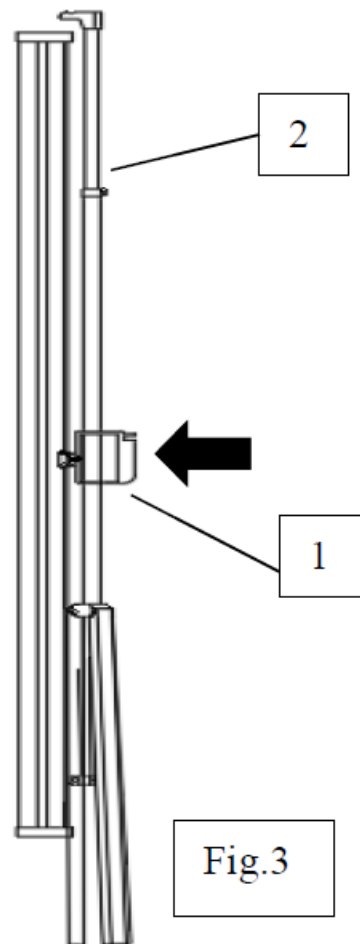

3. Unhook the screen material from the Top Hook and slowly retract the screen back into the case.
4. Hold the Extension Bar and Push/press the Vertical Locking tab to unlock and release the position of the extension bar. Bring the extension bar all the way down.
5. Close the tripod legs by pushing them in.
6. Pack the tripod screen in the carry bag included for protection and storage.

Note

- To ensure the screen is stable, extend the tripod's legs as much as possible.
- Do not fold the screen or allow any sharp objects to touch the screen's surface.
- Clean the screen surface often when needed.
- Careful use will extend the lifetime of this product.

Notice to Installer

Material Tip: Proper Projector Placement for CLR@2

CORRECT

The CLR@2 is exclusively for tabletop/bottom mounted ultra and short throw projectors.

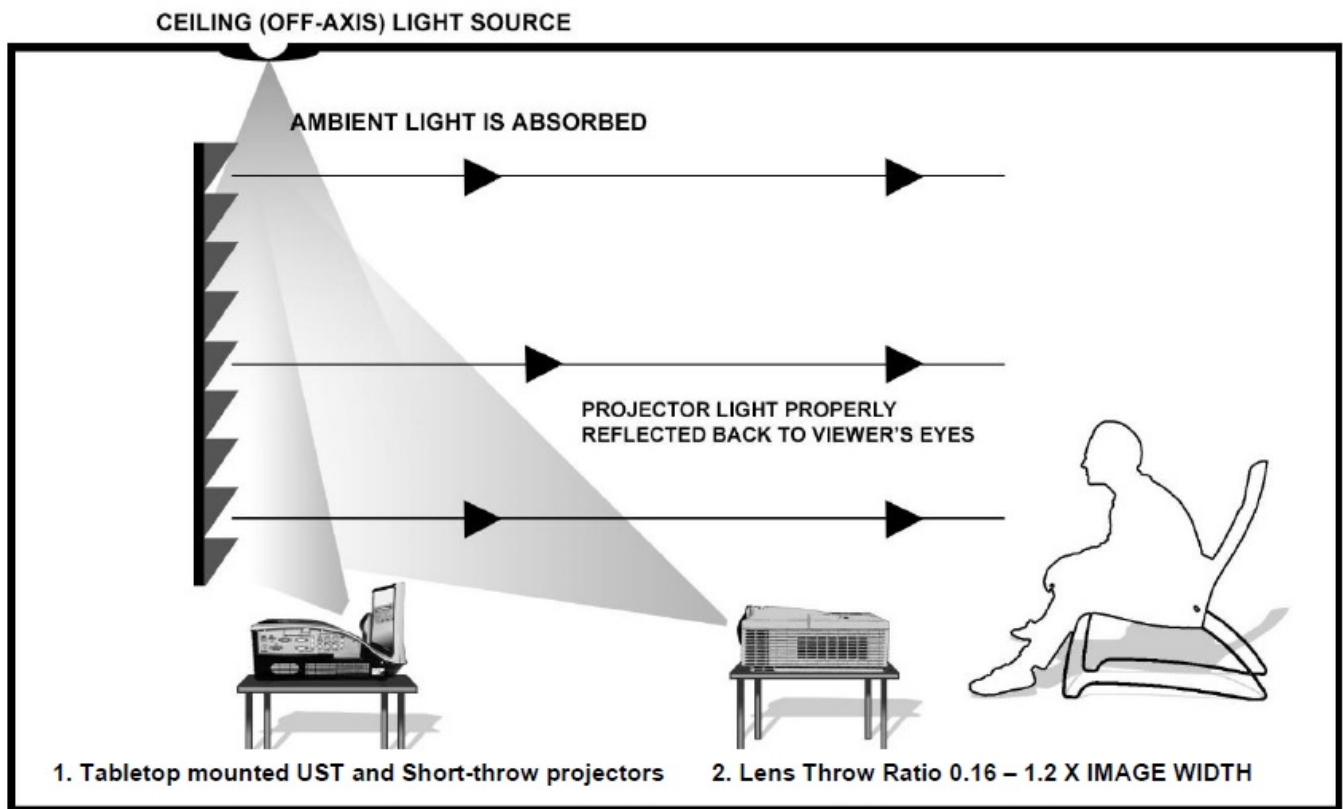

ULTRA SHORT THROW (UST) & SHORT THROW PROJECTOR ILLUSTRATION

INCORRECT

Overhead placement or a standard projector will make the image very dark, on account of the screen's absorbent layer deflecting light that is not aligned with its reflective angle.

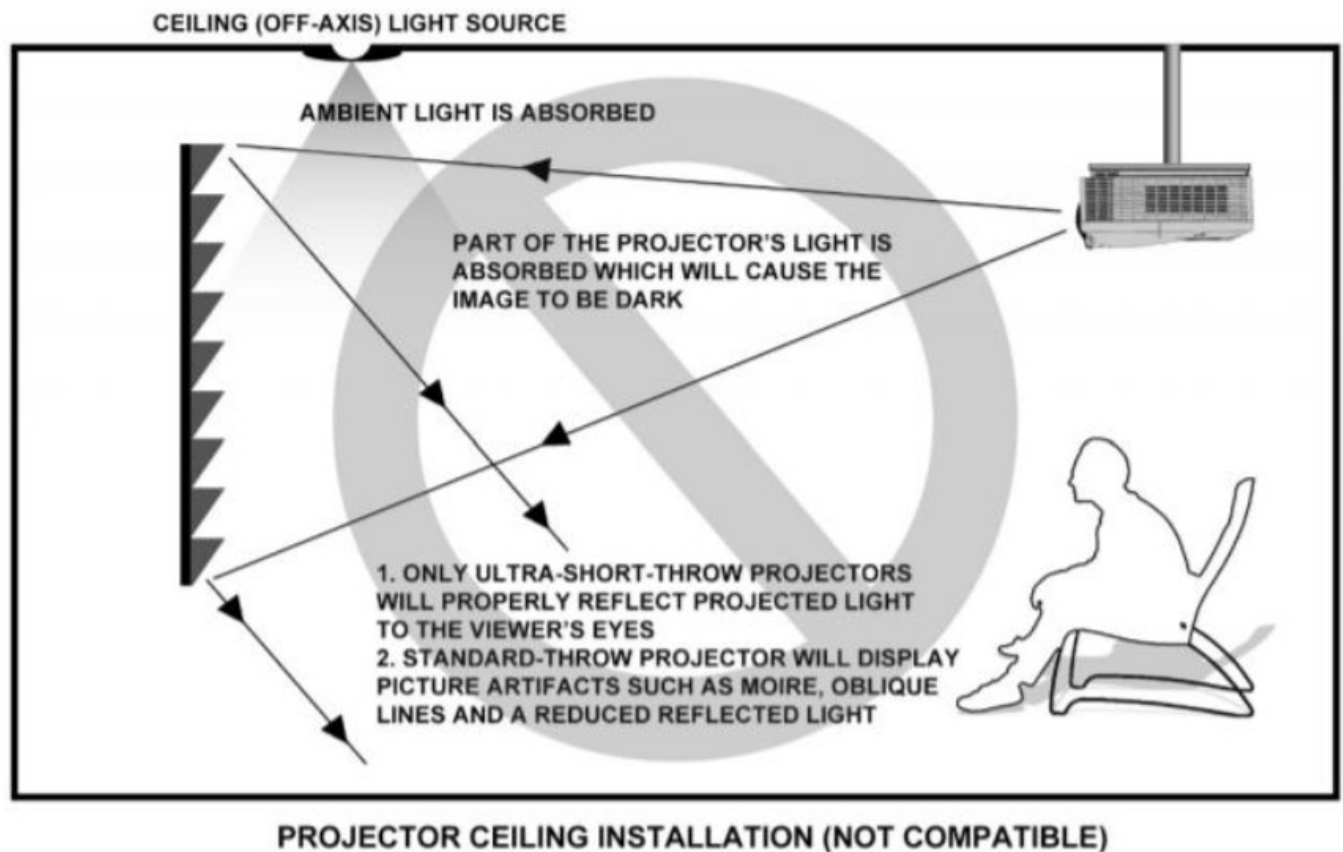

Documents / Resources

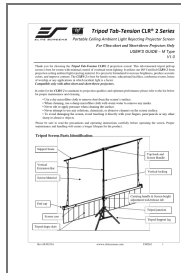

[ELITE SCREENS TripodTT_CLR2 Tripod Tab Tension Portable Screen](#) [pdf] User Guide
TripodTT_CLR2 Tripod Tab Tension Portable Screen, TripodTT_CLR2, Tripod Tab Tension Portable Screen, Tension Portable Screen, Portable Screen, Screen

References

- [Elite Screens 4K/ 8K Cinema Quality Projector Screens | Elite Screens](#)
- [Elite Screens 4K/ 8K Cinema Quality Projector Screens | Elite Screens](#)
- [User Manual](#)

[Manuals](#), [Privacy Policy](#)

This website is an independent publication and is neither affiliated with nor endorsed by any of the trademark owners. The "Bluetooth®" word mark and logos are registered trademarks owned by Bluetooth SIG, Inc. The "Wi-Fi®" word mark and logos are registered trademarks owned by the Wi-Fi Alliance. Any use of these marks on this website does not imply any affiliation with or endorsement.