



ELEKTROBOCK ZSD15 Digital Timer Owner's Manual

[Home](#) » [ELEKTROBOCK](#) » ELEKTROBOCK ZSD15 Digital Timer Owner's Manual 

Contents

- [1 ELEKTROBOCK ZSD15 Digital Timer](#)
- [2 Product Information](#)
- [3 Product Usage Instructions](#)
- [4 DIDIGITGITAALL TIM TIMERER](#)
- [5 CURRENT TIME SETTINGS](#)
- [6 MANUAL ON/OFF](#)
- [7 PROGRAM SETTINGS](#)
- [8 COUNTDOWN FUNCTION](#)
- [9 RANDOM FUNCTION](#)
- [10 TECHNICAL PARAMETERS](#)
- [11 Documents / Resources](#)
 - [11.1 References](#)
- [12 Related Posts](#)

ELEKTROBOCK ZSD15 Digital Timer



**Specifications:**

- Input: 230 V AC/ 50 Hz
- Max Load: 15 (2) A, 3500 W
- Clock Accuracy: < 1 W
- Battery: NiMH 2.4V, >1500 hours
- Protection Rating: IP20

Product Information

The ZSD15 Digital Timer is designed for time switching of household appliances. It features manual switching, countdown, and a random function for random switching. After initial connection, the timer needs to be charged for a minimum of 6 hours before pressing the “RESET” button.

Product Usage Instructions**Important Safety Instructions:**

- Do not connect two or more timers together.
- For internal use only.
- Avoid placing the timer in a location that makes it difficult to disconnect from the power supply.
- Ensure that connected appliances do not exceed a load of 15 A.

Cleaning and Power Saving:

If the timer needs cleaning, always unplug it first and then wipe it with a dry cloth. To save power when not in use for an extended period, press the “CLEAR” and “ENTER” buttons simultaneously to put the device in power-saving mode. The LCD will turn off, conserving battery. To exit this mode, press the “RESET” button.

Current Time Settings:

Follow the instructions displayed on the timer's screen to set the current time and program your desired schedules.

FAQ:

- **Q: How do I program the timer for specific appliance schedules?**

A: To program specific schedules, navigate through the menu options using the designated buttons and set the desired timings accordingly.

- **Q: What should I do if the timer is not functioning correctly?**

A: If you encounter any issues with the timer's functionality, first try resetting it by pressing the "RESET" button. If problems persist, refer to the user manual for troubleshooting tips or contact customer support.

DIDIGITGITAALL TIM TIMERER

ZSD15 is used for time switching of household appliances. It also has the functions of manual switching on, countdown and random function for random switching. After the first connection, let the timer charge for min. 6 hours and then press „RESET“ button.

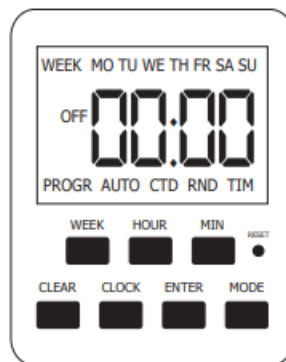

Please read the following instructions carefully before connecting this timer to electrical appliances.

- Do not connect two or more timers together!
- For internal use only!
- Do not place the timer in such a way that it is difficult to disconnect it from the power supply!

IMPORTANT:

Do not connect an appliance whose load exceeds 15 A. Always ensure that the plug of any appliance is fully inserted into the timer socket. If the timer needs to be cleaned, unplug it and wipe it with a dry cloth. If you do not use the timer for a long time, put the device in power saving mode by pressing „CLEAR+ENTER“ buttons, the LCD is off, saving battery. To wake up from this mode, press „RESET“ button.

CURRENT TIME SETTINGS

-



Press the „MODE“ button to select „TIM“



- Press „CLOCK“ data fl ashes

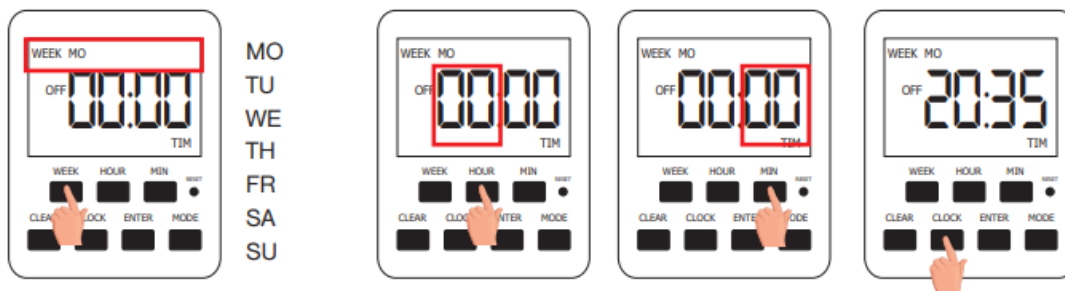

- Set the current day (WEEK), hour (HOUR) and minute (MIN) and end the setting by pressing CLOCK.

MANUAL ON/OFF

Press the „MODE“ button to select „TIM“. By pressing „ENTER“ the timer can be turned on or off. ON to turn on or OFF to turn off will appear on the LCD.

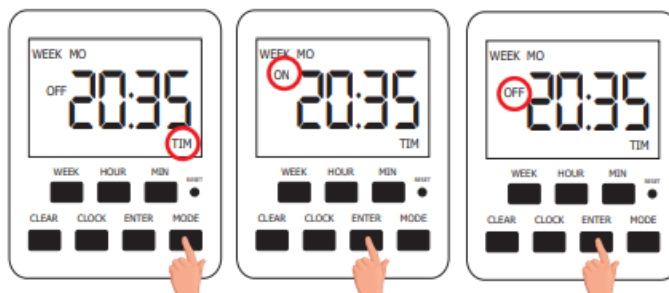

PROGRAM SETTINGS

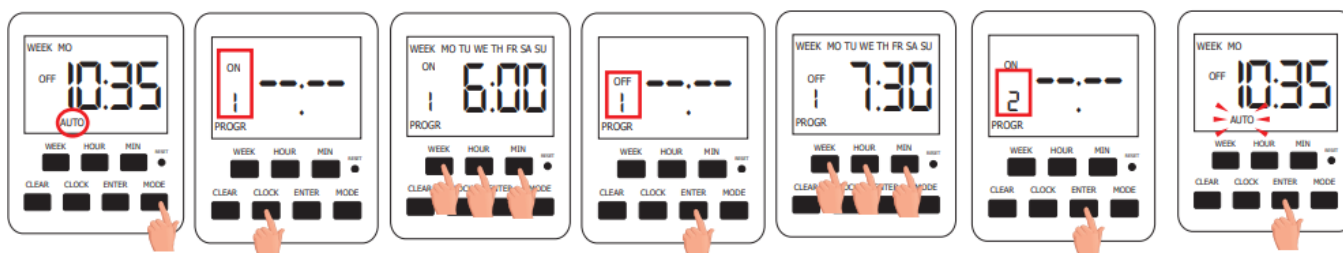

- Press the „MODE“ button to select „AUTO“ mode
- Press „CLOCK“ to set the 1st program. By pressing WEEK button select a day or block of days, by pressing HOUR and MIN buttons set the 1st switch-on time (1_ON) and confirm by pressing ENTER button. The 1st switch off setting (1_OFF) appears.
- Proceed in the same way as for 1_ON and confirm by pressing ENTER button. In this way, up to 16 time programs can be set.

Exit programming by pressing „MODE“. Press „ENTER“ to start the program, the inscription „AUTO“ flashes.

COUNTDOWN FUNCTION



- Press the „MODE“ button to select „CTD“ mode
- Press the „HOUR and MIN“ button to set the countdown time Start the countdown by pressing „ENTER“ (from 0 to 99h99min)

RANDOM FUNCTION

•

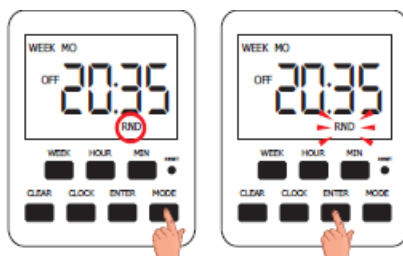

Press the “MODE” button to select the “RND” mode Confirm by pressing

- „ENTER“ button, the inscription „RND“ flashes

The connected appliance is randomly switched on between 19:00 and 06:00. To cancel the function, select another mode by pressing „MODE“.

Note: If you make a mistake during the setting, press CLEAR button.

TECHNICAL PARAMETERS

Power supply	230 V AC/ 50 Hz
Maximum load	15 (2) A, 3500 W
Minimum adjustable time	1 min.
Clock accuracy	+/- 1 min per month
Own consumption	< 1 W
Backup battery	NiMH 2.4V >1500 hours
Degree of protection	IP20
Working temperature	-10°C to +40°C (< 93% RH)

The warranty period is 2 years.

In the case of warranty and post-warranty service, send the product to the address of the distributor or importer.

Importer:

ELEKTROBOCK MTF s.r.o. Blanenská 1763 Kuřim 664 34 Czech Republic

www.elbock.cz

Documents / Resources

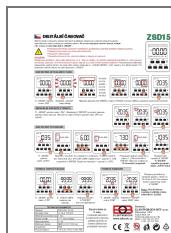

[ELEKTROBOCK ZSD15 Digital Timer](#) [pdf] Owner's Manual
ZSD15 Digital Timer, ZSD15, Digital Timer, Timer

References

- [🌐 Systémy pro inteligentní dům - ELEKTROBOCK MTF s.r.o.](#)
- [EEB Elektrobock SK - Systémy pro inteligentní dům](#)
- [User Manual](#)

[Manuals+](#), [Privacy Policy](#)

This website is an independent publication and is neither affiliated with nor endorsed by any of the trademark owners. The "Bluetooth®" word mark and logos are registered trademarks owned by Bluetooth SIG, Inc. The "Wi-Fi®" word mark and logos are registered trademarks owned by the Wi-Fi Alliance. Any use of these marks on this website does not imply any affiliation with or endorsement.