



Electronics TS29A Smart Bracelet User Manual

[Home](#) » [Electronics](#) » Electronics TS29A Smart Bracelet User Manual 

Electronics TS29A Smart Bracelet User Manual



Contents

- 1 [Downloading the App](#)
- 2 [Appearance Introduction](#)
- 3 [How to remove the strap](#)
- 4 [Charging and Active](#)
- 5 [Pairing](#)
- 6 [Compatible device description](#)
- 7 [Smart Watch Features](#)
- 8 [General Info & Specifications](#)
- 9 [Documents / Resources](#)
- 10 [Related Posts](#)

Downloading the App

Scan the following QR code, download and install the App.



Scan QR code and Download

Appearance Introduction

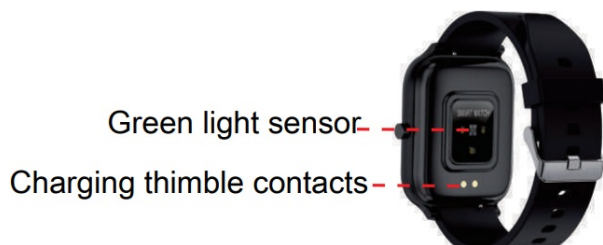

How to remove the strap



Charging requirements and battery specifications

Operating Voltage	3.7V
Battery capacity	230mA
Battery Type	Lithium polymer battery
Battery Type	Contact charging
Charging method	≤12Hour 25°C constant temperature

Charging and Active

Charging the device to active before the first time using; To charge your device, plug the charging cable into the adapter or USB port on your computer.

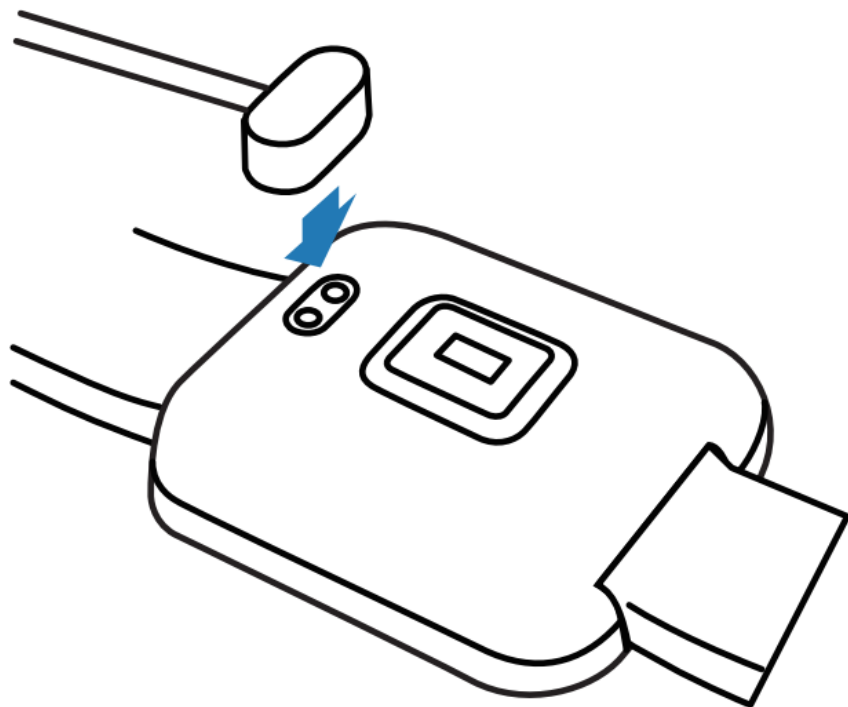

If watch is out of power, please charge it, and wait for 5~10 seconds to light up the screen.

Pairing

- Open the App and set up your profile
- Go to the rDevicej , Click rAdd a Device j
- Choose your device on the scanning list
- Finish

The MAC address on the 'Setting' About' page could help you identify your device on the scanning list.

Compatible device description

Use the Touch Screen

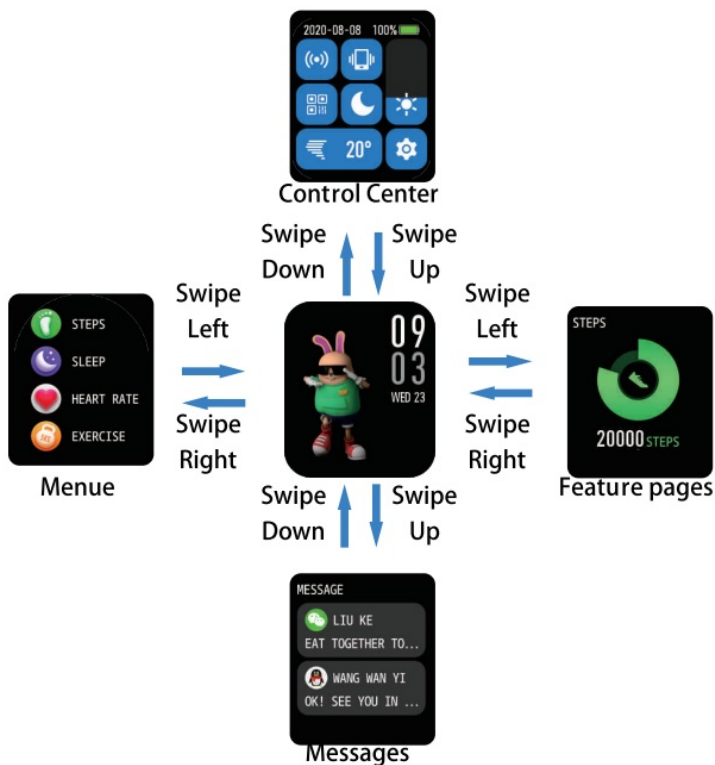

Smart Watch Features

Sleep

If you keep wearing Smart Watch in your sleep, it can provide the hours slept and quality of sleep stats on both the screen and the APR **NOTE:** Sleep stars reset to zero at 10:00 Pm.

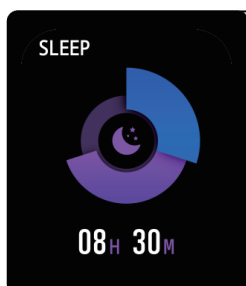

Heart Rate Test

The Smart Watch could record your heart rate all day . You also could tap on the page to start measuring heart rate. Click to start to test,It will vibrate after testing.

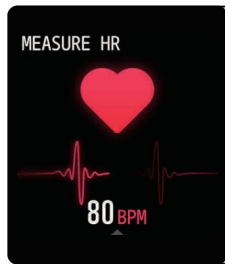

Sports

Smart Watch automatically tracks Steps taken on the screen.

NOTE: Your movement stets reset to zero at midnight.

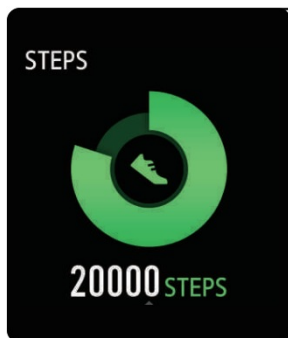

Training

Tap the training Icon on the menu to start a new training measure recording, there are tzsport modes to be chosen. The last training recording will be shown on the training page.

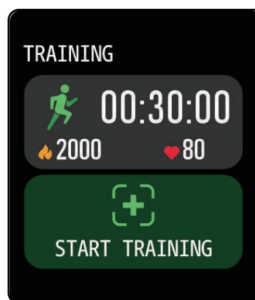

Blood Pressure Test

Tap on the blood pressure page to start measuring your blood pressure. On the blood pressure page, It can show the blood pressure measured data of the last times.

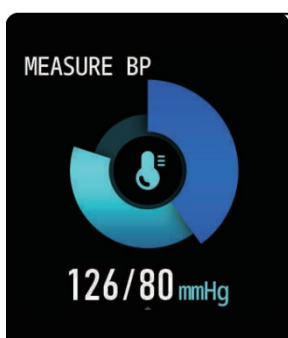

SpO2 Test

Tap the SpO2 page to start measuring your SpO2. On the SpO2 page, It can show the SpO2 measured data of the last times.

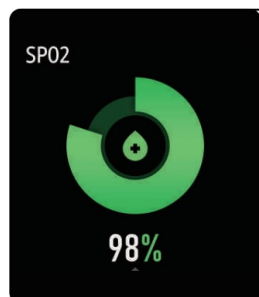

Weather

It could show the weather info of current and tomorrow on the weather page. Weather info is synced after connecting with the APP, it will not be updated after a long disconnected.



Messages Reminder

The device can sync incoming notifications from Twitter, Facebook, Whatsapp, Instagram etc. Recently 5 messages can be stored.

Note: You can switch of/off the incoming notification in the APP.

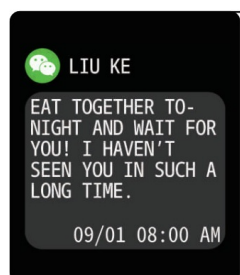

Remote Shutter

After connecting the device, you can remote control the camera on your phone.



Player Shutter

After connecting the device, you can remote control the music play on your phone.



Other Features

Other features Include stopwatch, alarm, timer, brightness auto on/off, theater mode factory reset power off ,app and about.

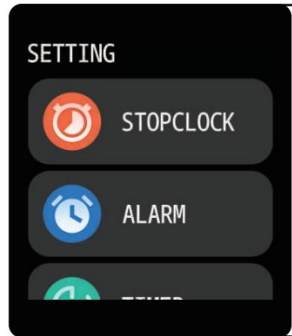

Stop Watch

Tap the start button on stopwatch page to start timing, and tap the stop button to stop timing.

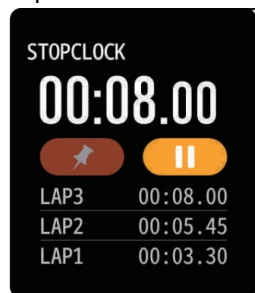

Silent Alarms

Set up the alarm on the APP, the device will vibrate to remind on time.

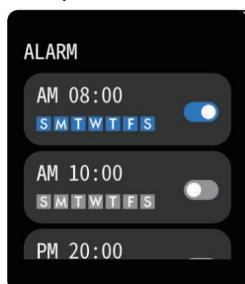

Modallt a non disturbo

Select MENU VIEW In SETTING b switch between two styles, LIST VIEW and GRID VIEW



Remind to Move

The device will vibrate to remind you to make a relax after 1 hour sittling.

Note: You can switch on/off the feature in the APP.

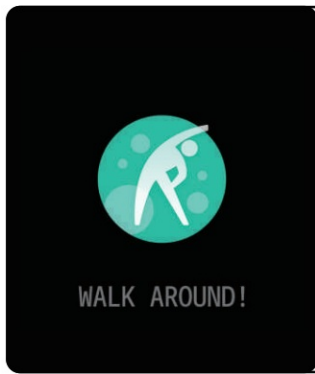

Remind to Drink

The smart watch will remind you Time to Drink Some Water at the planned drinking lime.

Note: You can set the feature in tht APP.

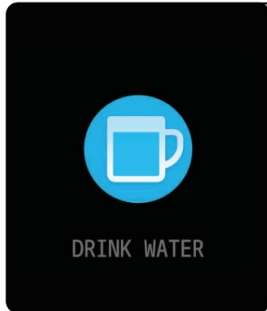

Getting to Know Your Device

1. Using in Wet Conditions

Your device is water-resistant, which means it is rain-proof and splash-proof and can stand up to even the sweatiest workout.

NOTE: Do not swim with your Smart Bracelet. We also don't recommend showering with your wristband; though the water won't hurt the device, wearing it 24/7 does not give your skin a chance to breathe. Whenever you get your bracelet wet, dry it thoroughly before putting it back on.

2. Using Quick View

With Quick View you can check the time or the message form your phone on your Smart Bracelet without taping. Just turn your wrist towards you and the time screen will appear for a few seconds.

General Info & Specifications

1. Environmental Conditions

Operating temperature: 14°F to 121°F (-10°C to 50°C) Non-operating temperature: -4°F to 140°F (-20°C to 60°C)

2. Size

Fits a wrist between 5.5 and 7.7 inches in circumference.

3. Disposal and Recycling

Please kindly be aware that it is the consumer's responsibility to properly dispose and recycle Smart Bracelet and accompanying components. Do not dispose of Smart Bracelet with common household waste, the Smart Bracelet unit is considered electronic waste and should be disposed of at your local electronic equipment collection facility. For more information, please contact your local electronic equipment waste management authority or the retailer where you bought the product.

Documents / Resources

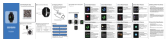

[Electronics TS29A Smart Bracelet](#) [pdf] User Manual
TS29A Smart Bracelet, TS29A, TS29A Bracelet, Smart Bracelet, Bracelet