



Electrohome EB20 Berkeley Powered Bookshelf Speakers User Guide

[Home](#) » [ELECTROHOME](#) » Electrohome EB20 Berkeley Powered Bookshelf Speakers User Guide 

Contents

- [1 Electrohome EB20 Berkeley Powered Bookshelf Speakers](#)
- [2 INTRODUCTION](#)
- [3 WHAT'S INCLUDED](#)
- [4 PRODUCT INFORMATION](#)
- [5 Front](#)
- [6 Back](#)
- [7 FIRST TIME SETUP](#)
- [8 BLUETOOTH® PAIRING](#)
- [9 AUX INPUT](#)
- [10 FREQUENTLY ASKED QUESTIONS](#)
- [11 IMPORTANT SAFETY INSTRUCTIONS](#)
- [12 WARRANTY INFORMATION](#)
- [13 FCC STATEMENT](#)
- [14 Documents / Resources](#)
 - [14.1 References](#)
- [15 Related Posts](#)

Electrohome®

Electrohome EB20 Berkeley Powered Bookshelf Speakers



INTRODUCTION

Since 1907 Electrohome has been developing high fidelity audio products & has been welcomed into homes for generations. One thing that remains the same in our more than 100 year history is our unmatched dedication to design and premium craftsmanship. Thank you for your purchase of this Electrohome® product. We hope you enjoy your experience.

BREAK-IN PERIOD

Our speakers have a butyl rubber ring surrounding the cone. The break-in period allows the rubber to loosen and stretch, allowing the cone a larger range of movement, which gives a better sound reproduction. We recommend 10-12 hours of play at moderate volume to achieve this.

WHAT'S INCLUDED



Bookshelf Speakers

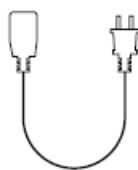

Power Cord



8 ft. Speaker Wire

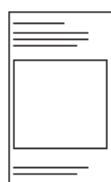

Quick Start Guide



Lifetime Customer
Support



1 Year Warranty

PRODUCT INFORMATION

Front

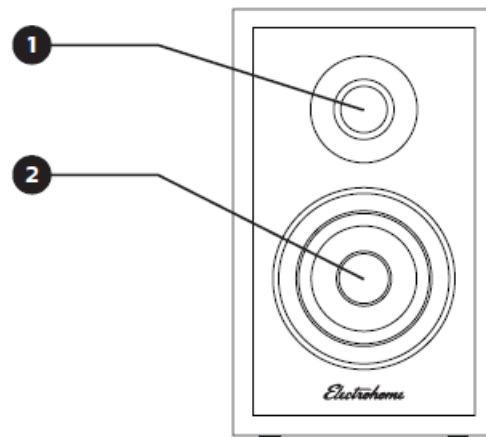

- Tweeter
- Woofer

Back

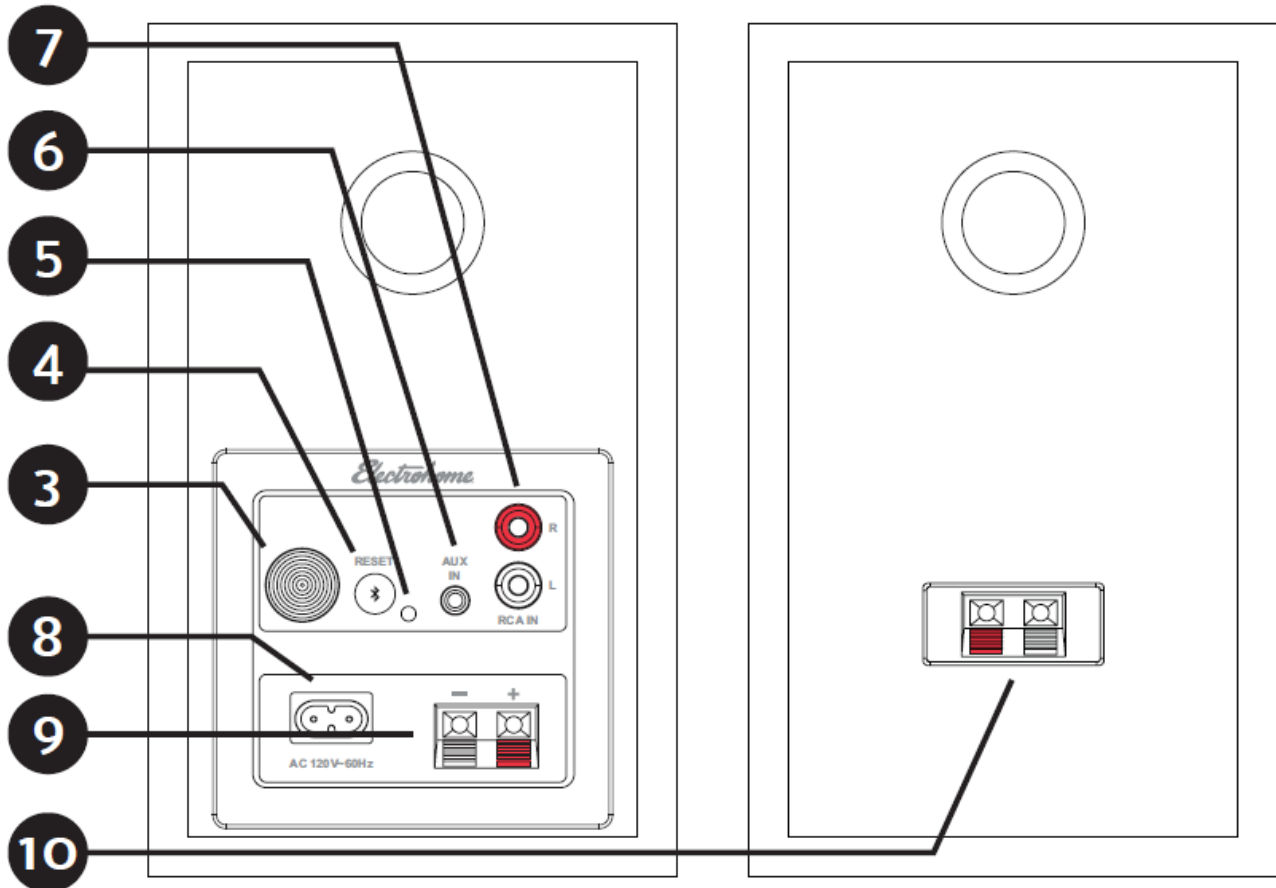

- Control Knob
- Bluetooth® Pairing Reset
- LED Indicator
- Aux In
- RCA In
- Power Input
- Speaker Wire Output

- Speaker Wire Input

LED Indicator

Color	Meaning
Flashing BLUE	Bluetooth® Pairing Mode
Solid BLUE	Bluetooth® Paired
Solid YELLOW	AUX Source
Solid GREEN	RCA Source
Solid RED	Standby

FIRST TIME SETUP

- Position the speakers with the Active Speaker on the right and the Passive Speaker on the left

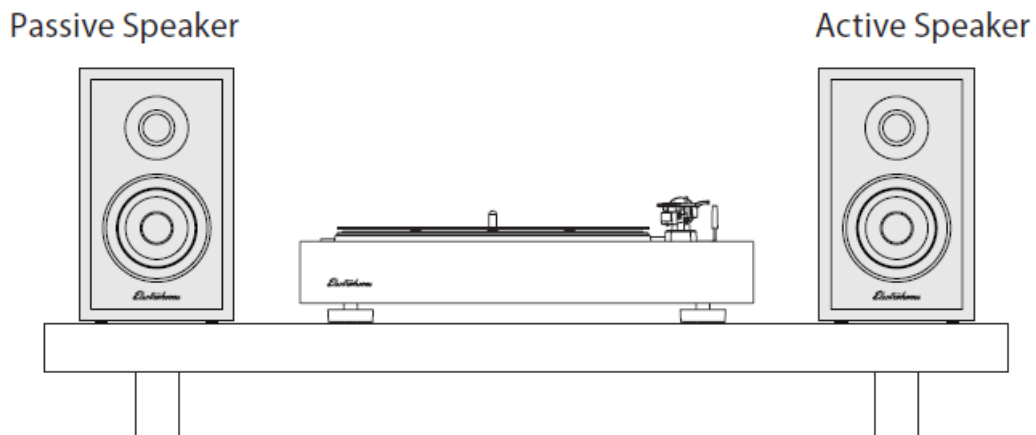

NOTE: If placing the speakers in a cabinet or on a shelf, position the front of the speakers as close as possible to the front edge of the shelf for optimum audio performance

- Connect the speaker wire to the spring clips on the back of the Active Speaker and connect the other end of speaker wire to the spring clips on the back of the Passive Speaker. **IMPORTANT:** Ensure each wire is connected to the same color binding post on each speaker. Red to red and black to black.

NOTE: The included speaker wire is 8ft. If placing your speakers further than 8ft apart it is recommended to use standard 22 gauge speaker wire to connect the speakers over the longer distance.

- Connect the power cable to the back of the Active Speaker and connect the other end to a power outlet.

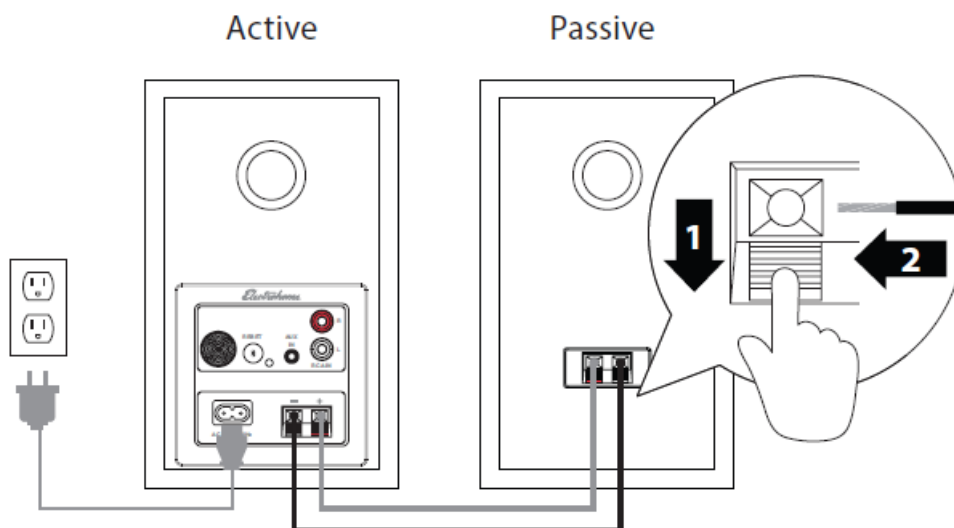

TURNING ON/OFF UNIT

Press the Control Knob to turn on the unit. Hold to turn off the unit

RCA INPUT

- Connect an RCA cable to your source device (Turntable, Smartphone, Computer...).
- Connect the other end of the RCA cable to the back of the Active Speaker

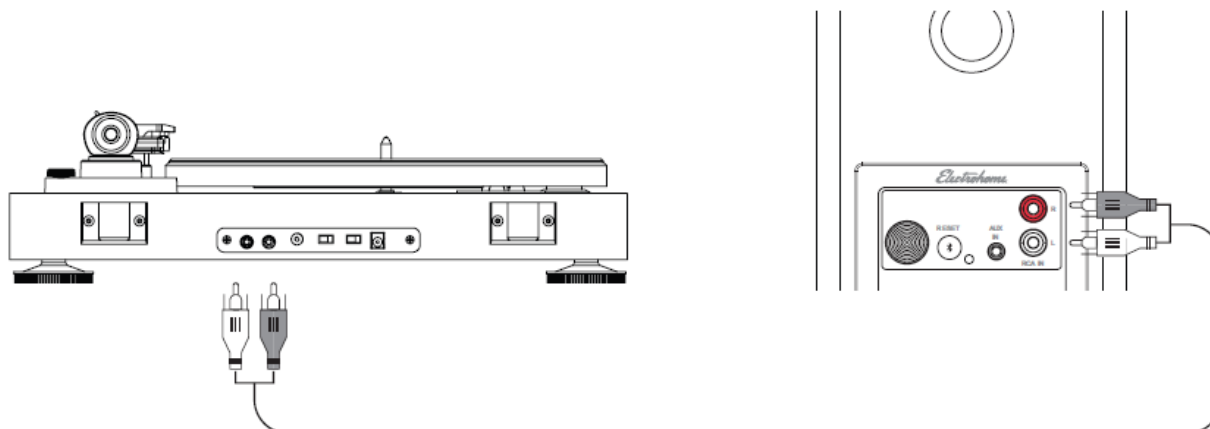

Note: Cable not included

- Press the Control Knob to select the RCA input (Green LED).
- Adjust volume on EB20 as well as source device.

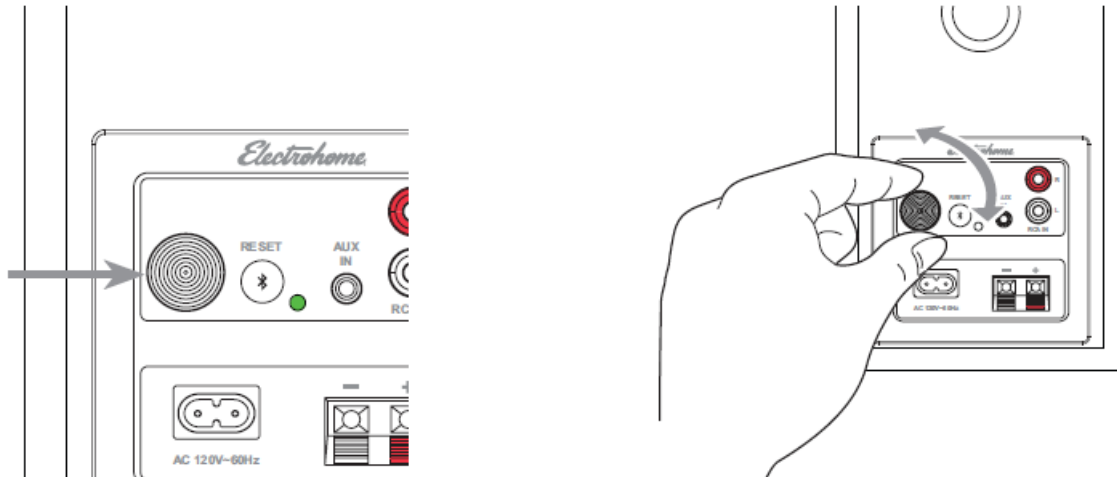

IMPORTANT: When connecting a turntable, a phono preamp must be used. Preamps are often built into turntables but can also be standalone devices. If your turntable has extremely low volume, a preamp may be needed. Note: Cable not included

BLUETOOTH® PAIRING

- Press the Control Knob to select the Bluetooth® input (Blue LED).

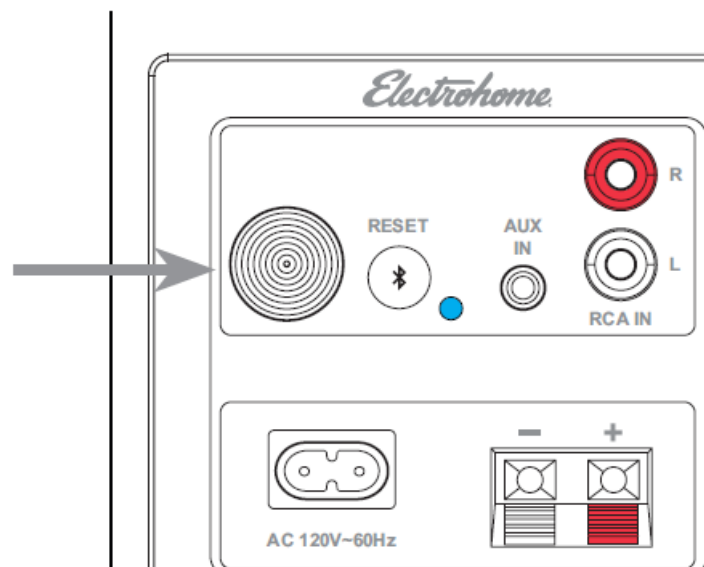

- Pair to "Electrohome EB20" on your source device.

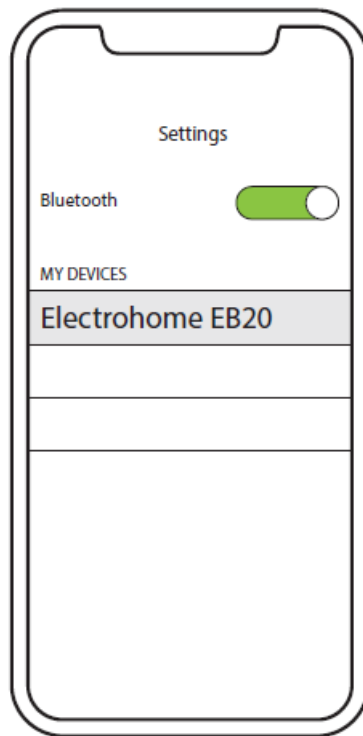

- Use the Control Knob to adjust volume on the EB20. Note: Adjust Volume on the source device as well as the EB20.

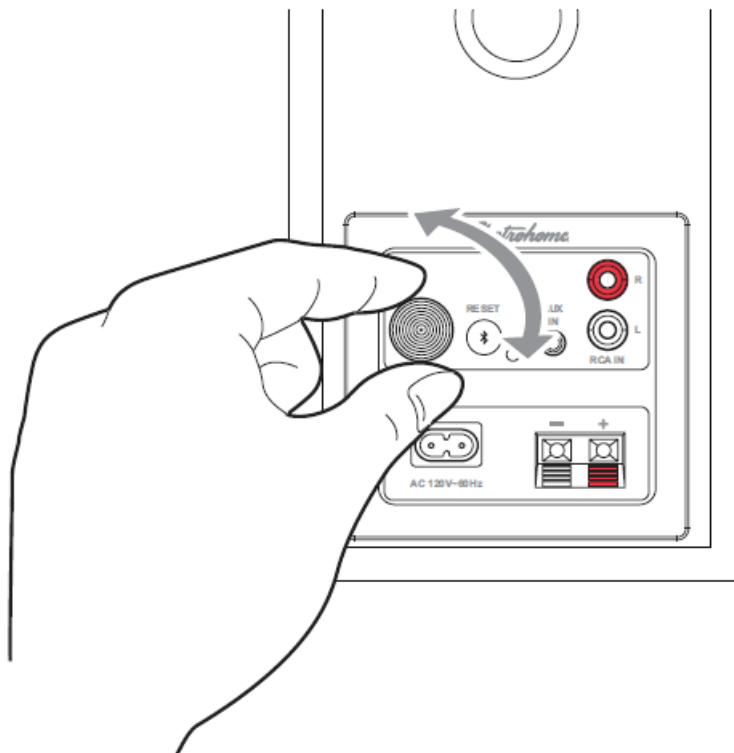

- If your device cannot find "Electrohome EB20", you can reset Bluetooth® pairing: Press and hold the Bluetooth® Pairing Reset Button on the back of the unit.

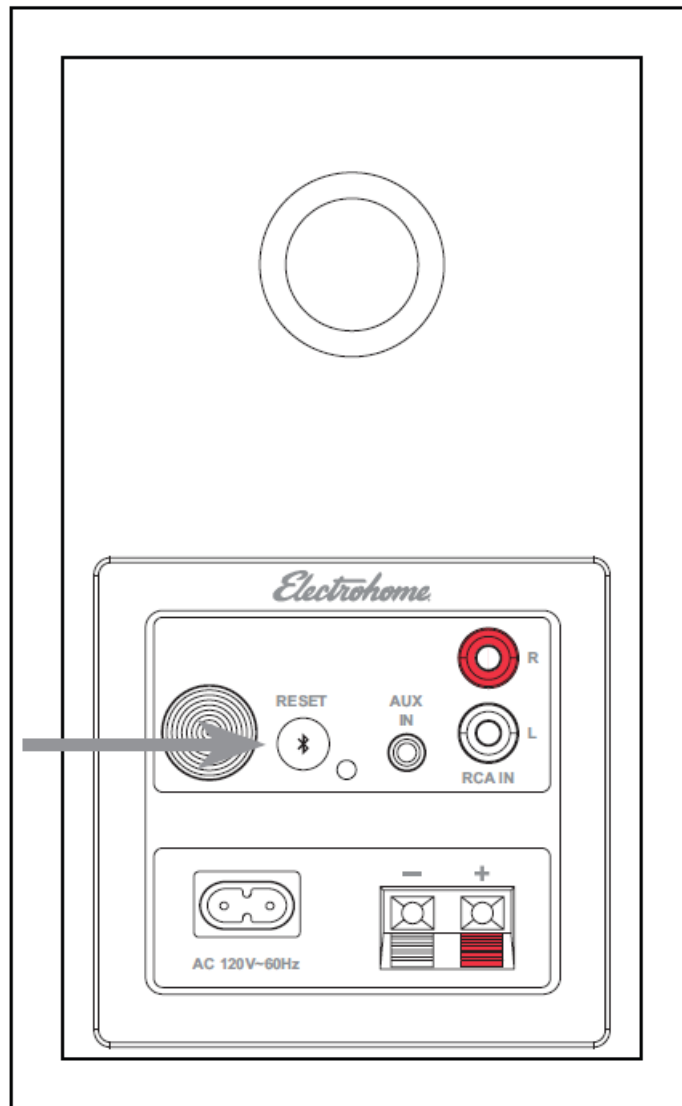

Note: How you access your device's Bluetooth® settings may vary from one manufacturer to another. Maximum line of sight for Power Class 2 Bluetooth® range is 33ft. Obstacles may decrease transmission distance.

AUX INPUT

- Connect the AUX cable to your source device (Smartphone, Computer...).
- Connect the other end of the AUX cable to back of the Active Speaker.

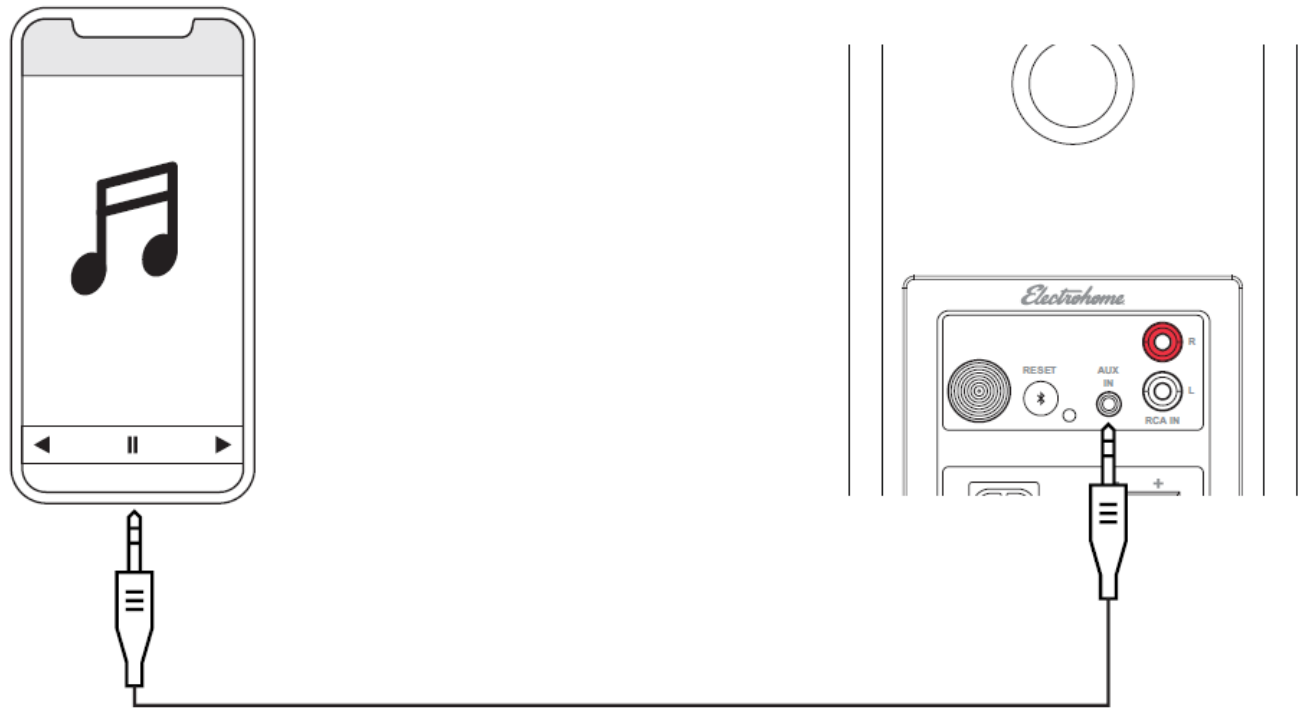

Note: Cable not included.

- Press the Control Knob to select the AUX input (Yellow LED).

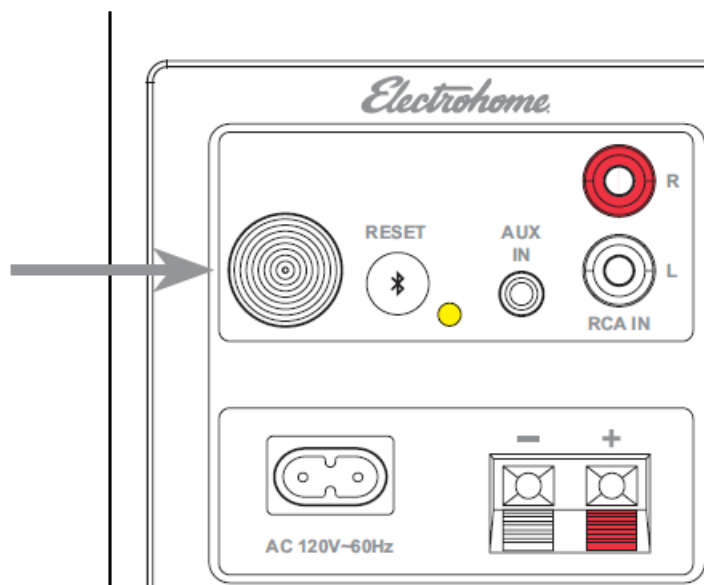

- Adjust volume on EB20 as well as source device.

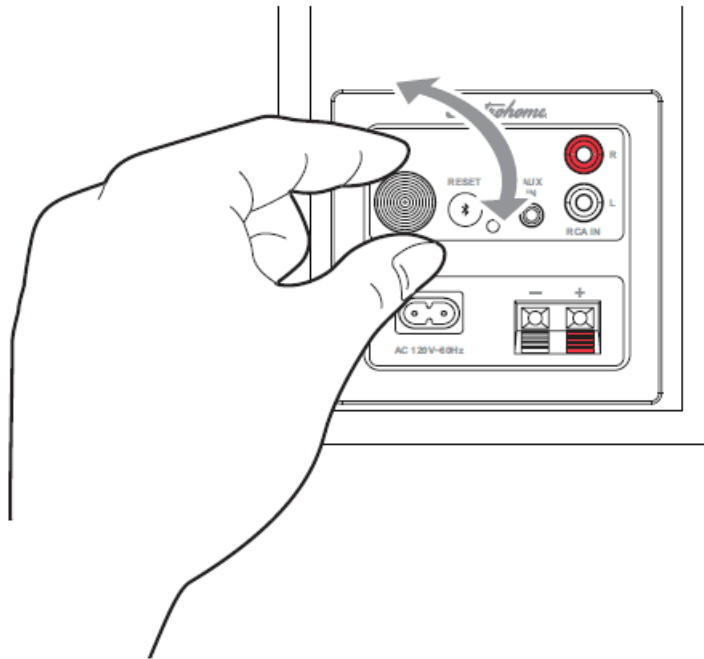

FREQUENTLY ASKED QUESTIONS

What is “auto-pairing” and how does it work?

Auto-pairing is a convenient connection feature. If the connected Bluetooth®-enabled device leaves the connection range of the EB20 and returns at a later time, the device will automatically connect. If the device's Bluetooth® function is disabled and then enabled at a later time, the device will automatically connect as well.

Note: The Electrohome EB20 will only auto-pair to the last device that it was connected to.

How do I change the source on my Electrohome EB20?

Press the Control Knob. The LED will change to the Source LED color (Blue/Green/Yellow).

Why is there no audio from the passive (left) speaker?

Confirm the speaker wire is properly connected between the active and the passive speakers. Ensure the metal wire is in contact with the spring clips. Additional insulation can be stripped from the wire if necessary to make contact.

Why are my speakers quiet?

Ensure the EQ settings on your source device and app are set to flat. Also ensure Volume Normalization is disabled. If using the EB20 with a turntable, confirm a preamp is enabled or added.

Another device is connected to my Electrohome EB20 and I want to connect my device.

You can reset any Bluetooth® connection by pressing the Bluetooth® Pairing Reset button on the back of the Active Speaker.

IMPORTANT SAFETY INSTRUCTIONS

TO PREVENT FIRE OR SHOCK HAZARD, DO NOT USE THIS PLUG WITH AN EXTENSION CORD, RECEPTACLE OR OTHER OUTLET UNLESS THE BLADES CAN BE FULLY INSERTED TO PREVENT BLADE EXPOSURE. TO PREVENT FIRE OR SHOCK HAZARD, DO NOT EXPOSE THIS APPLIANCE TO RAIN OR MOISTURE.

WARNING: TO REDUCE THE RISK OF ELECTRIC SHOCK DO NOT REMOVE COVER (OR BACK), NO USER SERVICEABLE PARTS INSIDE REFER SERVICING TO QUALIFIED SERVICE PERSONNEL

The lightning flash with arrowhead symbol within an equilateral triangle is intended to alert the user to the presence of uninsulated dangerous voltage within the product's enclosure that may be of sufficient magnitude to constitute a risk of electric shock to persons.

The exclamation point within an equilateral triangle is intended to alert the user to the presence of important operating and maintenance (servicing) instructions in the literature accompanying the appliance

1. Read these instructions.
2. Keep these instructions.
3. Heed all warnings.
4. Follow all instructions.
5. Do not use this apparatus near water.
6. Clean only with dry cloth.
7. Do not block any ventilation openings. Install in accordance with the manufacturer's instructions.
8. Do not install near any heat sources such as radiators, heat registers, stoves, or other apparatus (including amplifiers) that produce heat.
9. Do not defeat the safety purpose of the polarized or grounding type plug. A polarized plug has two blades with one wider than the other. A grounding type plug has two blades and a third grounding prong. The wide blade or the third prong is provided for your safety. If the provided plug does not fit into your outlet, consult an electrician for replacement of the obsolete outlet.
10. Protect the power cord from being walked on or pinched particularly at plugs, convenience receptacles, and point where they exit from the apparatus.
11. Only use attachments / accessories specified by the manufacturer.
12. Use only with the cart, stand, tripod, bracket, or table specified by the manufacturer, or sold with the apparatus.
When a cart is used, use caution when moving the cart/apparatus combination to avoid injury from tip-over.
13. Unplug this apparatus during lightning storms or when unused for long periods of time.
14. Refer all servicing to qualified service personnel. Servicing is required when the apparatus has been damaged in any way, such as power-supply cord or plug is damaged, liquid has been spilled or objects have fallen into the apparatus, the apparatus has been exposed to rain or moisture, does not operate normally, or has been dropped.
15. This appliance shall not be exposed to dripping or splashing water and no object filled with liquids such as vases shall be placed on the apparatus.
16. Do not overload wall outlet. Use only power source as indicated.
17. Use replacement parts as specified by the manufacturer.
18. The product may be mounted to a wall only if recommended by the manufacturer.
19. Upon completion of any service or repairs to this product, ask the service technician to perform safety checks.
20. Correct Disposal of this product. This marking indicates that this product should not be disposed with other household wastes throughout the EU. To prevent possible harm to the environment or human health from uncontrolled waste disposal, recycle it responsibly to promote the sustainable reuse of material resources. To return your used device, please use the return and collection systems or contact the retailer where the product was purchased. They can take this product for environmental safe recycling.

21. No naked flame sources, such as lighted candles, should be placed on the apparatus.
22. Attention should be drawn to environmental aspects of battery disposal.
23. Use of the apparatus in moderate climates.
24. WARNING: The appliance coupler is used as disconnect device, the disconnect device shall remain readily operable.
25. CAUTION: These servicing instructions are for use by qualified service personnel only. To reduce the risk of electric shock, do not perform any servicing other than that contained in the operating instructions unless you are qualified to do so.
26. Do not install this equipment in a confined or building-in space such as a book case or similar unit, and remain a well ventilation conditions at open site. The ventilation should not be impeded by covering the ventilation openings with items such as newspaper, table-cloths, curtains etc.

RISK OF ELECTRIC SHOCK

DO NOT OPENCAUTION

WARNING: TO REDUCE THE RISK OF ELECTRIC SHOCK DO NOT REMOVE COVER (OR BACK), NO USER SERVICEABLE PARTS INSIDE REFER

SERVICING TO QUALIFIED SERVICE PERSONNEL.

The lightning flash with arrowhead symbol within an equilateral triangle is intended to alert the user to the presence of uninsulated dangerous voltage within the product's enclosure that may be of sufficient magnitude to constitute a risk of electric shock to persons.

The exclamation point within an equilateral triangle is intended to alert the user to the presence of important operating and maintenance (servicing) instructions in the literature accompanying the appliance.

This equipment is a Class II or double insulated electrical appliance. It has been designed in such a way that it does not require a safety connection to electrical earth.

WARRANTY INFORMATION

Thank you for choosing Electrohome! We guarantee your investment in our products is a solid one. Our products come with a complete one-year parts and labor warranty. High performance components combined with quality craftsmanship allow us to maintain the highest possible production standards. All items are guaranteed against defects in materials and craftsmanship. Electrohome has outstanding quality control; if something should go wrong with any of our products, we will repair it free of charge within the warranty period. If the product cannot be repaired, we will replace the product. In the event that Electrohome replaces a product under warranty, the replacement would only carry the original warranty from the original date of purchase.

Warranty Exclusions

Electrohome products are warrantied for parts and labor for one year from date of original purchase, and are subject to the terms and conditions of the warranty. Any refurbished products that are discontinued hold a 90 day warranty from the date of original purchase. Electrohome warranties are valid for the original owner and are non-transferable

- Any defects caused or repairs required as a result of abusive operation, negligence, accident, improper installation or inappropriate use as outlined in the owner's manual.
- Any Electrohome product tampered with, modified, adjusted, or repaired by any party other than Electrohome.
- Any cosmetic damage to the surface or exterior that has been defaced or caused by normal wear and tear.
- Any damage caused by external or environmental conditions, including but not limited to, transmission

line/power line voltage or liquid spillage.

- Any product received without an appropriate model and serial number.
- Any products used for rental or commercial purposes.
- Any installation, set up and/or programming charges.
- Defect or damage as a result of connecting a product to an outlet with the incorrect voltage. Voltage converters must be used where applicable.
- Consumable parts including, but not limited to, batteries, styli, and rubber belts.

To Obtain Warranty Service

Should your product require warranty service, please contact us at www.electrohome.com/contact to set up a Return Authorization. Products returned without a valid Return Authorization number will be refused. Electrohome products must be returned in their original packaging. Our products are packaged specially to protect them from any damage during shipping, and without this packaging the return shipment could get damaged. This warranty does not cover the shipping cost, insurance, or any other incidental charges. Products shipped for warranty service must be pre-paid by the customer, and Electrohome will cover the cost to ship the repaired or replaced product back to the customer.

FCC STATEMENT

This device complies with Part 15 of the FCC Rules. Operation is subject to the following two conditions: (1) This device may not cause harmful interference, and (2) This device must accept any interference received, including interference that may cause undesired operation. 2. Changes or modifications not expressly approved by the party responsible for compliance could void the user's authority to operate the equipment.

NOTE: This equipment has been tested and found to comply with the limits for a Class B digital device, pursuant to Part 15 of the FCC Rules. These limits are designed to provide reasonable protection against harmful interference in a residential installation. This equipment generates uses and can radiate radio frequency energy and, if not installed and used in accordance with the instructions, may cause harmful interference to radio communications. However, there is no guarantee that interference will not occur in a particular installation. If this equipment does cause harmful interference to radio or television reception, which can be determined by turning the equipment off and on, the user is encouraged to try to correct the interference by one or more of the following measures: Reorient or relocate the receiving antenna

- Increase the separation between the equipment and receiver.
- Connect the equipment into an outlet on a circuit different from that to which the receiver is connected. Consult the dealer or an experienced radio/TV technician for help.
- The device must not be co-located or operating in conjunction with any other antenna or transmitter.

Radiation Exposure Statement







This equipment complies with FCC/IC radiation exposure limits set forth for an uncontrolled environment. This equipment should be installed and operated with minimum distance 20cm between the radiator & your body.

Don't forget to register your product with us! Electrohome.com/registration

Documents / Resources

 <p>Electrohome Berkeley Powered Bookshelf Speakers (Model) EB20</p> <p>EB20 Berkeley Powered Bookshelf Speakers</p>	<p>Electrohome EB20 Berkeley Powered Bookshelf Speakers [pdf] User Guide</p> <p>EB20 Berkeley Powered Bookshelf Speakers, EB20, Berkeley Powered Bookshelf Speakers, P owered Bookshelf Speakers, Bookshelf Speakers, Speakers</p>
---	--

References

-  [Electrohome Support Center](#)
-  [Register Your product | Electrohome](#)
-  [Electrohome](#)
-  [Electrohome Support Center](#)
-  [Electrohome Support Center](#)
-  [Electrohome Support Center](#)