



## ELECTRA ATM0S403ELB Door Entry System Terminals User Manual

[Home](#) » [Electra](#) » ELECTRA ATM0S403ELB Door Entry System Terminals User Manual 

**ELECTRA ATM0S403ELB Door Entry System Terminals**

**ELECTRA**

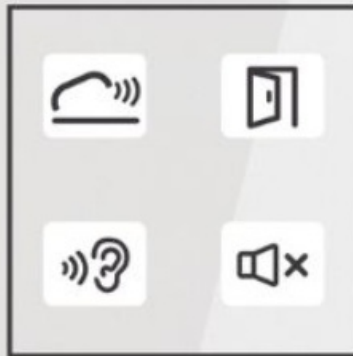

**smart**

## Contents

- [1 Specifications](#)
- [2 Safety Instructions](#)
- [3 Cables](#)
- [4 Installation](#)
- [5 Programming](#)
- [6 Use](#)
- [7 Settings](#)
- [8 Outdoor panels](#)
- [9 Warranty](#)
- [10 CUSTOMER SUPPORT](#)
- [11 Documents / Resources](#)
  - [11.1 References](#)

## Specifications

smart AUDIO ATM.0S403.ELB(W)04	
	
ABS case + Secured Glass	
170x96x22 mm	0.3 kg
IP31	0 C... + 45 C
Operating voltage: 11 ... 14 Vd.c.	
Stand-by current: 14 mAd.c.	
Operating current: 70 mAd.c	

smart 4.3"VIDEO VTM.4S083.ELB(W)TL

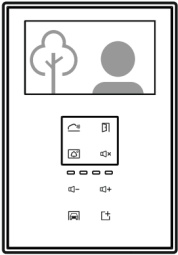

4,3" LCD,TFT, 480 x 3(RGB) x 272

ABS case + Secured Glass

180x125x21 mm

0.4 kg

IP31

0 C... + 45 C

Operating voltage: 11 ... 14 Vd.c.

Stand-by current: 15 mAd.c.

Operating current: 240 mAd.c.

smart 7"VIDEO VTM.7S403.ELB(W)04

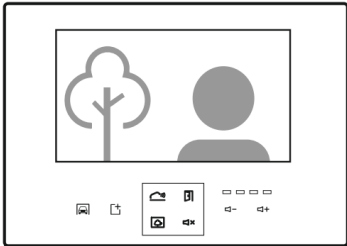

7" LCD,TFT, 800 x 3(RGB) x 480

ABS case + Secured Glass

162x227x20 mm

0.8 kg

IP31

0 C... + 45 C

Operating voltage: 11 ... 14 Vd.c.

Stand-by current: 11 mAd.c.

Operating current: 250 mAd.c.

extra 7"VIDEO VTE.7S903.ELB(W)04

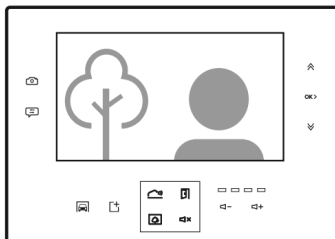

7" LCD,TFT, 800 x 3(RGB) x 480

ABS case + Secured Glass

162x227x20 mm

0.8 kg

IP31

0 C... + 45 C

Operating voltage: 11 ... 14 Vd.c.

Stand-by current: 12 mAd.c.

Operating current: 300 mAd.c.

## Safety Instructions

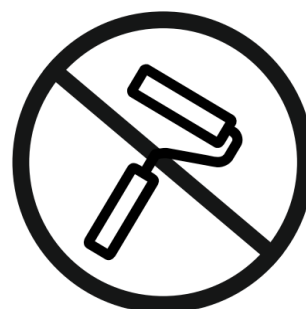

## Cables

Standard 4 Wire: 4 x 0.5 mm (max. 60m); 4 x 0.75 mm (max. 100m); TCYY – 2x2x0.5-24 AWG (max. **30m**); TCYY – 3x2x0.5-24 AWG (max. **50m**); TCYY – 4x2x0.5-24 AWG (max. **50m**)

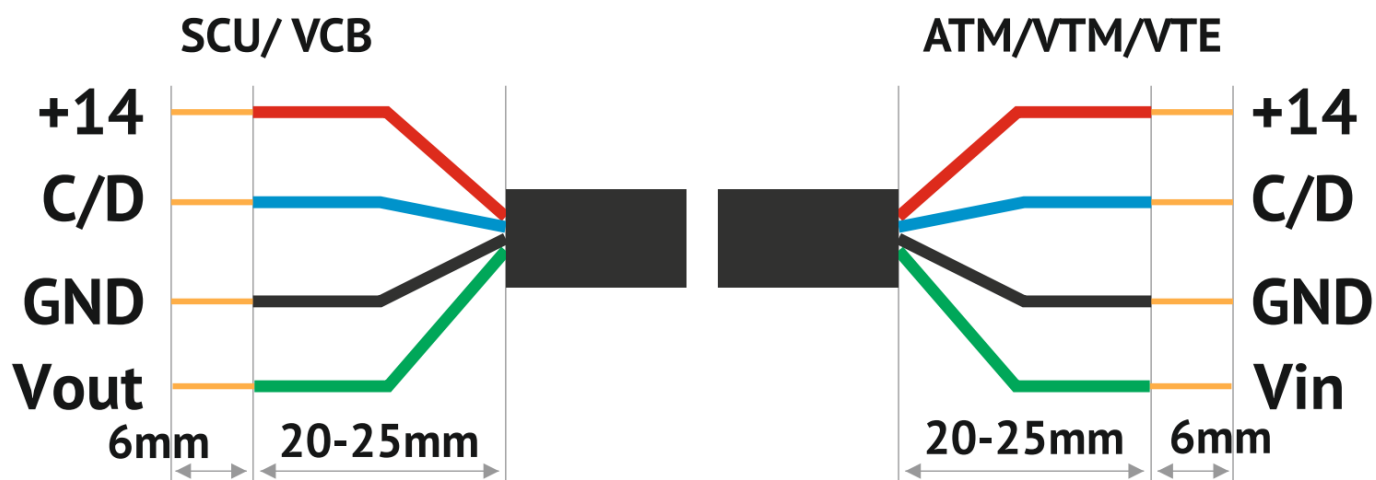

UTP/FTP cat5e (AWG24) / cat6 (AWG23)

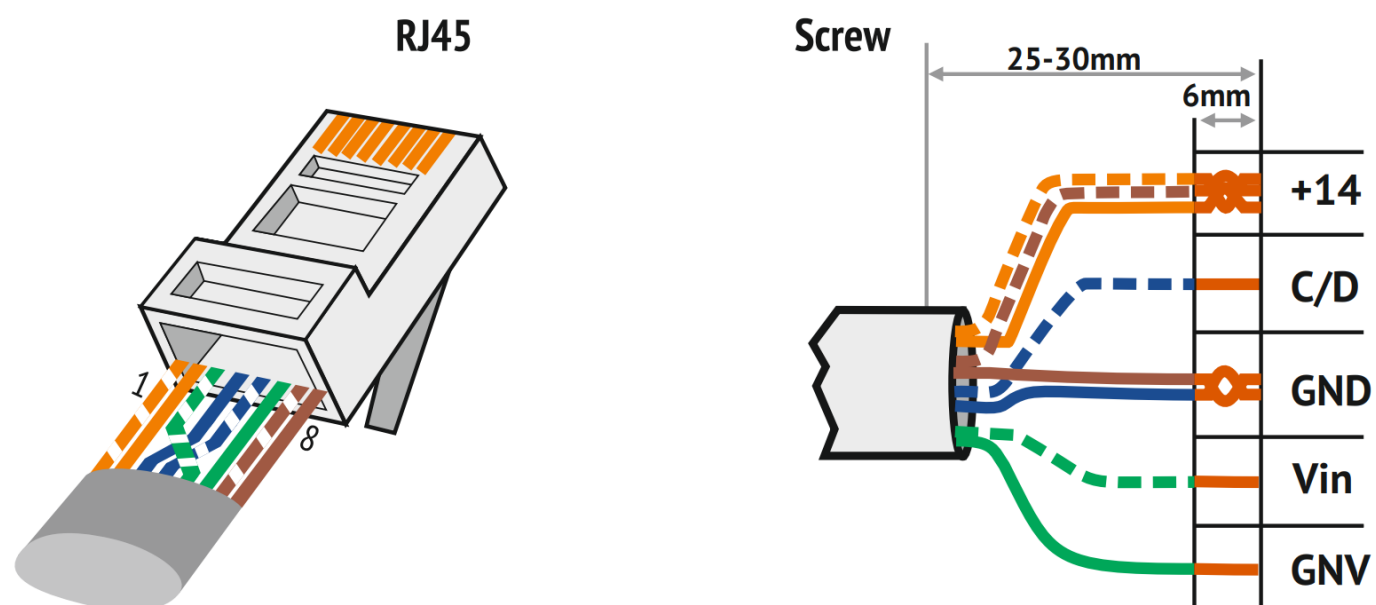

Installation

smart AUDIO

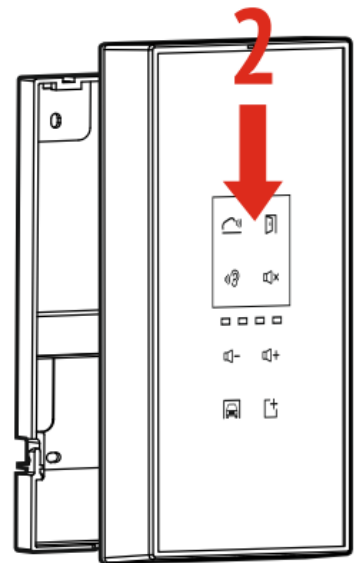
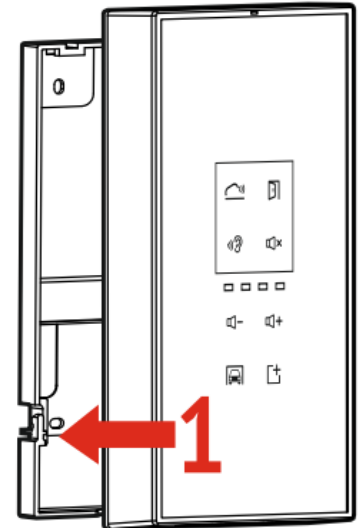
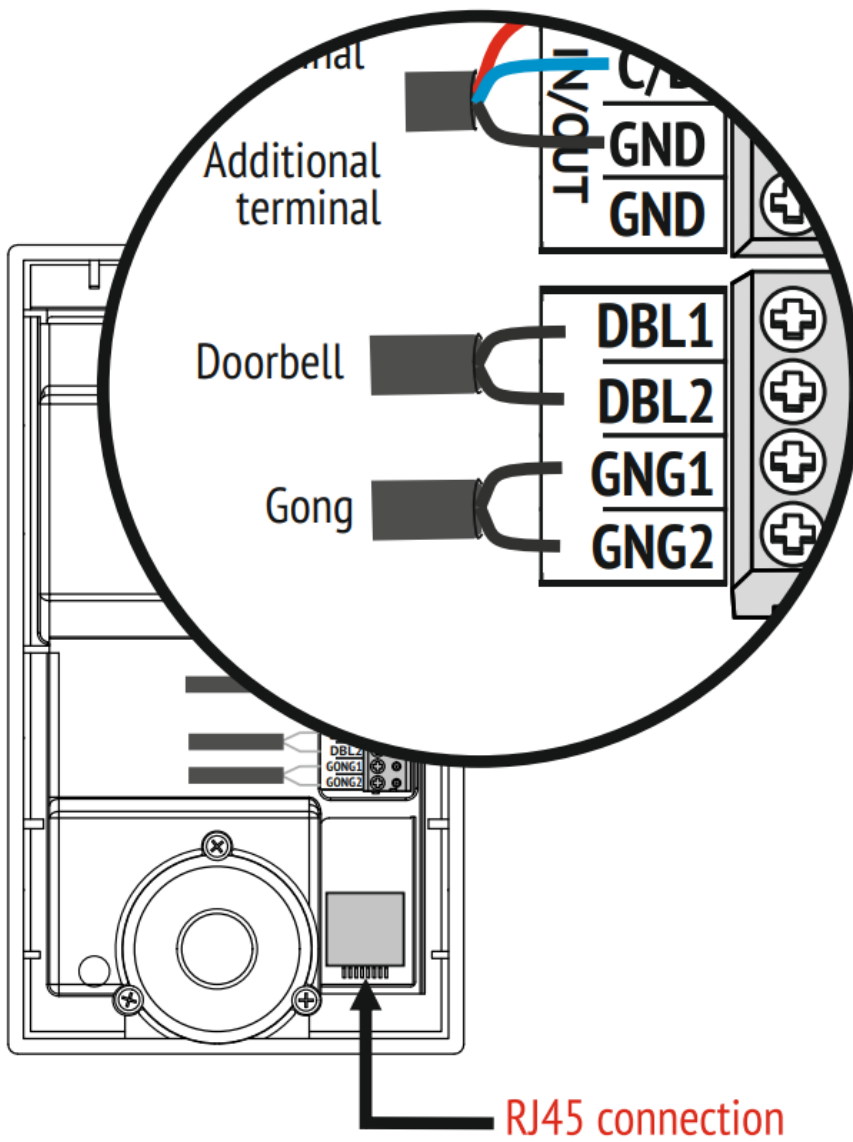

smart 4.3" VIDEO

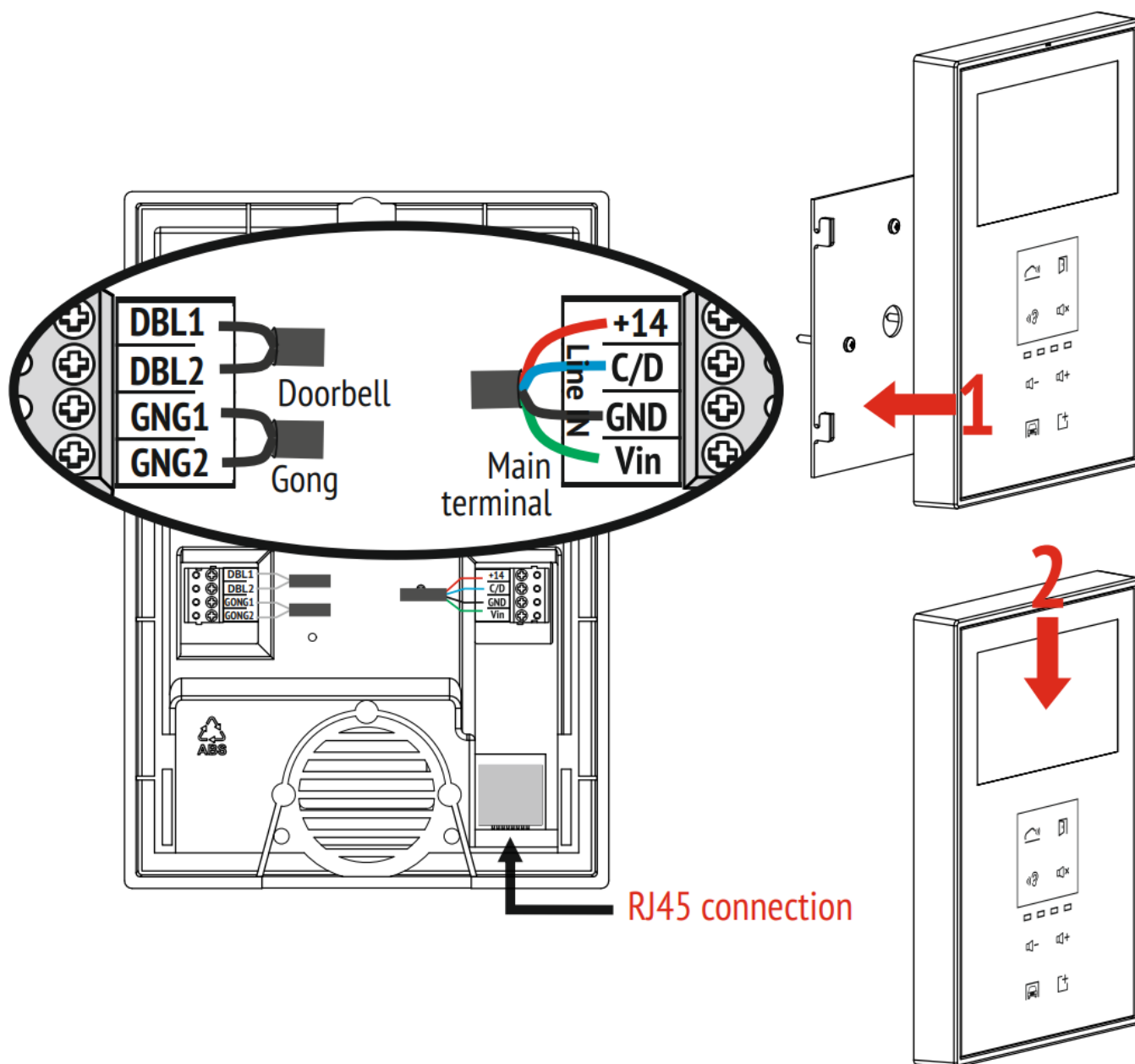

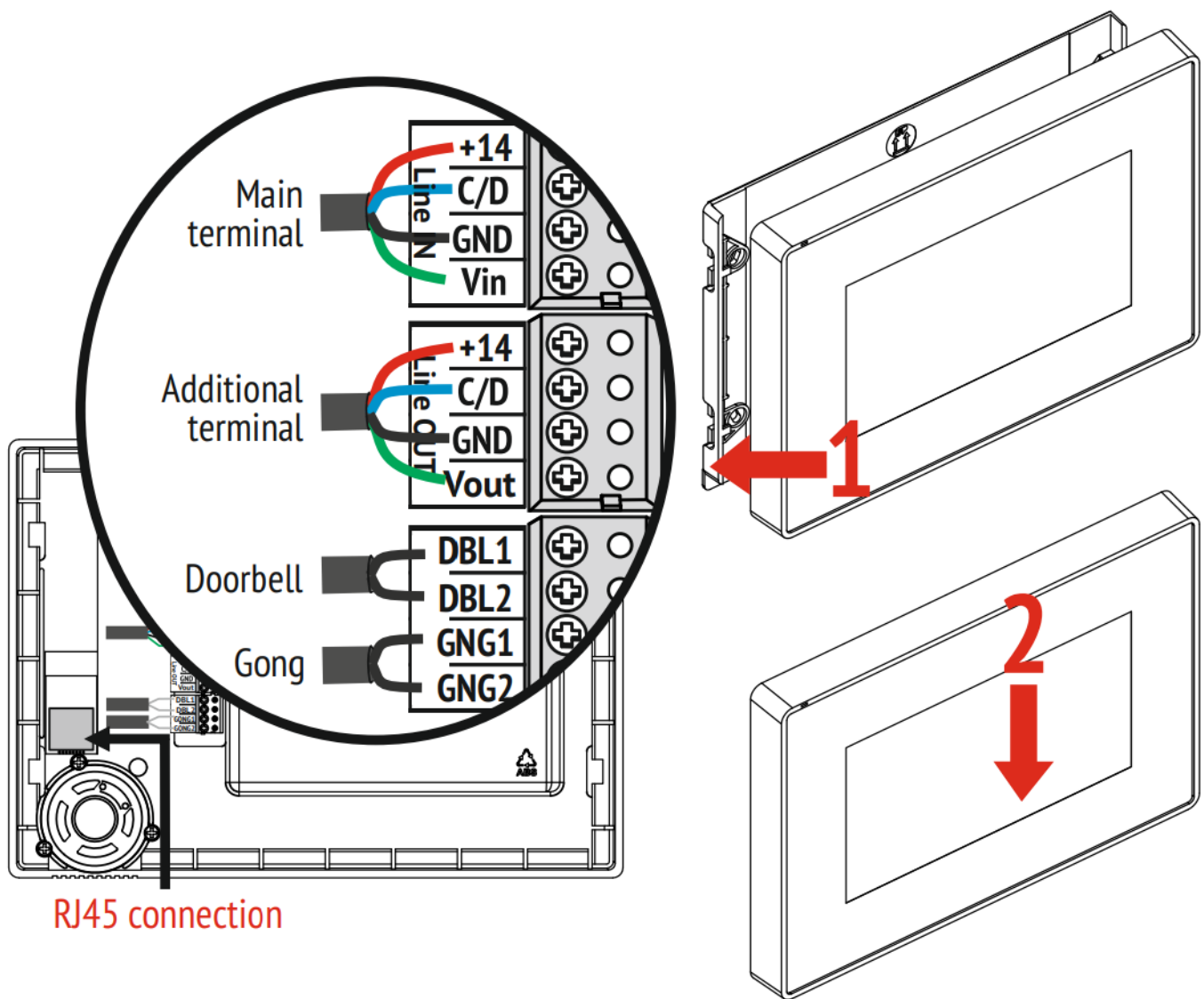

smart / extra 7" VIDEO



## Programming





The terminals are programmed from the factory with **Address 1** = number of the first terminal in the system. In multi-family systems, the terminals will be programmed with the number (address) of each family:

1. The system is set under tension.
2. Long press the PROG button from the SCU central unit.
  - At the terminal, long press the  key long beep.
3. **Short touch of the  key:**
  - 2 touches** = Address 2 – 2 beeps
  - 3 touches** = Address 3 – 3 beeps
  - n touches** = Address n – n beeps
4. After completion, briefly press the PROG button from the SCU central unit.







## Use

	Answering the call = starting the hands-free conversation
	Access granting
	Audio monitoring (audio terminals)
	Audio-video-monitoring (video terminals)
	Mute
	Talk volume adjustment
	Auxiliary commands – AUX1, AUX2
	Intercommunication
	Picture taking
	Menu access, scrolling and settings: video image, time-date, view/ delete pictures

## Settings

	<b>Factory settings:</b> <ol style="list-style-type: none"> <li>1. Ringtone: 1 (out of 5)</li> <li>2. Call duration: 2 calls</li> <li>3. Call volume: level 3 (out of 4)</li> </ol>
	Long press the two keys simultaneously long beep = settings mode activated.
	Ringtone setting: touch the key successively to listen to the 5 versions. The last played ringtone remains stored.
	Call duration setting: touch the key successively, to select 1/2/3 calls or 1 min. The last played version remains stored.
	Call volume setting: short touch the keys, to get the desired volume between 1 and 4. The last played version remains stored.

## Outdoor panels

	LEDs signaling status during use: call – talk – access granting
 <b>Name</b>	Call key and the name of the family
	RFID reader for the access cards
	Electronic display of residents list and status during use
<b>1 2 3</b>	Numeric keyboard for dialing apartment number
	Accessing the residents list and searching for names
	RFID reader for the access cards

## Warranty

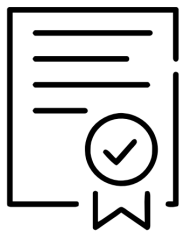

1. A 24-month warranty is granted, according to the existing legislation, based on the purchase document.
2. Warranty is granted for non-conformity and/or hidden defects.
3. Warranty is NOT granted for: incorrect installation and/ or operation, noncompliant with this manual; broken glass, blows, mechanical shocks; theft, fire, floods, natural disasters; unprotected products during renovation activities; the RFID access cards (tags), which are considered consumables.

## CUSTOMER SUPPORT



**MADE in EU by: ELECTRA s.r.l**

Parc Industrial Miroslava Str. Principala 33, 707307, Jud. Iași – RO



+40 232 214.370



[sales@electra.ro](mailto:sales@electra.ro)



[www.electra.ro](http://www.electra.ro)

## SUPPORT

**ELECTRA Building Communications GmbH**

Gadnergasse 71, Stockwerk 1, Büro Top 132 1110 Wien – AT



+43 1 810 20 99



[sales@electra-automation.at](mailto:sales@electra-automation.at)



[www.electra-automation.at](http://www.electra-automation.at)

**ELECTRA**

## Documents / Resources

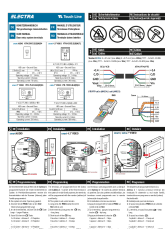

**[ELECTRA ATM0S403ELB Door Entry System Terminals](#)** [pdf] User Manual  
ATM.0S403.ELB W 04, VTM.4S083.ELB W TL, VTM.7S403.ELB W 04, VTE.7S903.ELB W 04,  
ATM0S403ELB Door Entry System Terminals, ATM0S403ELB, Door Entry System Terminals, Entry System Terminals, System Terminals, Terminals

## References

- [User Manual](#)

[Manuals+](#), [Privacy Policy](#)

This website is an independent publication and is neither affiliated with nor endorsed by any of the trademark owners. The "Bluetooth®" word mark and logos are registered trademarks owned by Bluetooth SIG, Inc. The "Wi-Fi®" word mark and logos are registered trademarks owned by the Wi-Fi Alliance. Any use of these marks on this website does not imply any affiliation with or endorsement.