

ELECOM MRT1D-1 Wireless Trackball Mouse



# ELECOM MRT1D-1 Wireless Trackball Mouse Instruction Manual

[Home](#) » [ELECOM](#) » ELECOM MRT1D-1 Wireless Trackball Mouse Instruction Manual 

## Contents

- [1 ELECOM MRT1D-1 Wireless Trackball Mouse](#)
- [2 Name and function of each part](#)
- [3 How to clean the trackball](#)
- [4 Specifications](#)
- [5 Precautions on wireless](#)
- [6 Documents / Resources](#)
  - [6.1 References](#)

# ELECOM

**ELECOM MRT1D-1 Wireless Trackball Mouse**



## Name and function of each part

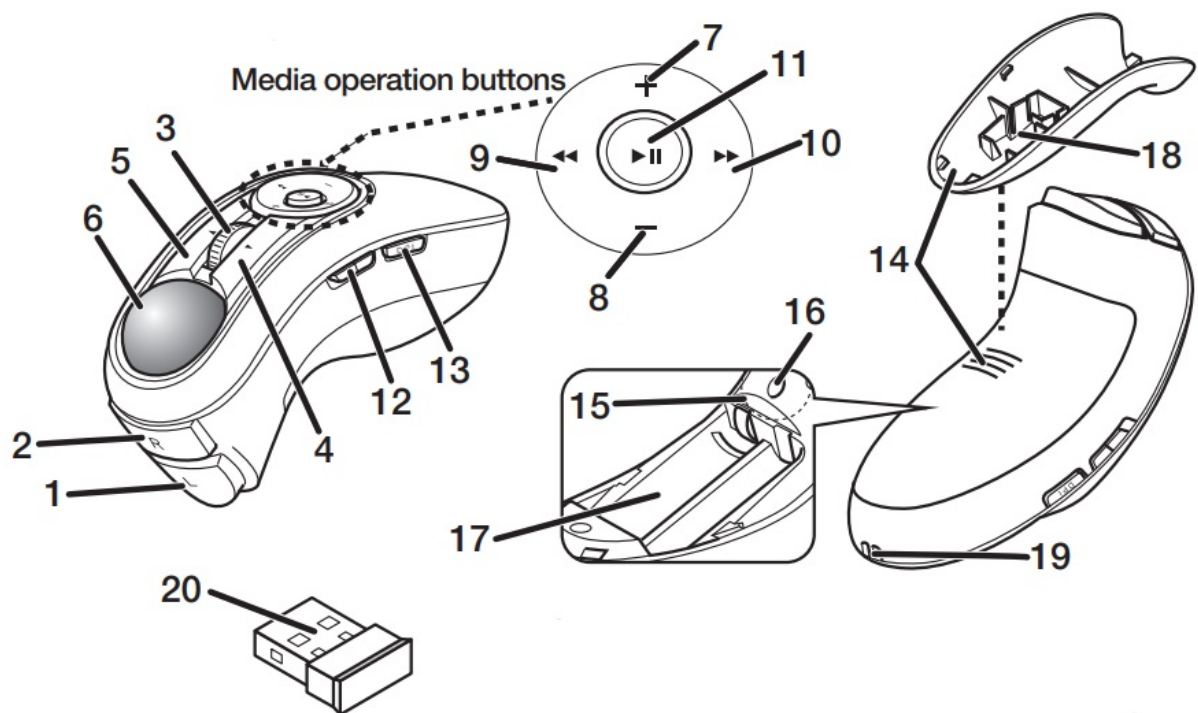

## Receiver unit

1. Left button
2. Right button
3. Wheel/Power indicator light
  - The LED blinks red when the battery level is low.
4. "Back" button
  - Operates the "Back" button on the Web browser.
5. "Forward" button
  - Operates the "Forward" button on the Web browser.
6. Trackball
  - Rotate using your fingertips to move the cursor.

7. Volume up
8. Battery cover
9. Volume down
10. Optical sensor
11. Previous track (reverse side of
12. Next trackball)
13. Play/pause
14. Ball removal hole
15. Power Switch
  - Remove the ball to
16. Push the change button and clean the inside of the compartment.
  - pressed, the count number (movement speed of the cursor)
17. The storage compartment switches between three stages.
18. Receiver When the count number is changed, the current count storage number is shown by the compartment
19. Strap hole number of times the LED light
20. USB connector blinks. (male)
  - one blink 500 dpi
  - two blinks 1000 dpi
  - three blinks 1000 dpi

### **Insert the batteries**

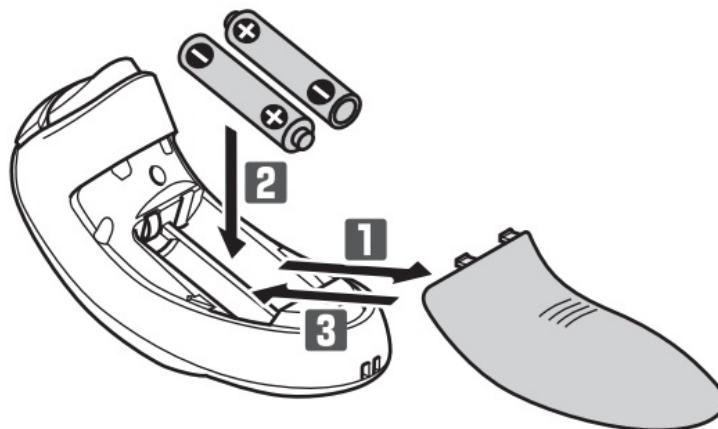

1. Remove the battery cover.
2. Insert the batteries as instructed.
3. Insert with the correct battery plus and minus orientation.
4. Re-attach the battery cover to its original state.

### **Turning the Power On**

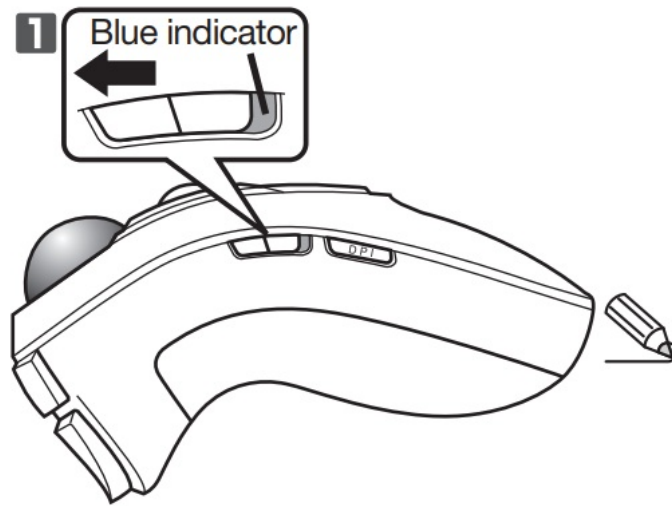

1. Slide the power switch on the side of the product to the ON position.
2. Slide the switch to the left to reveal the blue indicator.
3. The power indicator light will light up red for some time.
4. When the remaining battery is low, the LED blinks red for a fixed time.

### Connecting to a PC

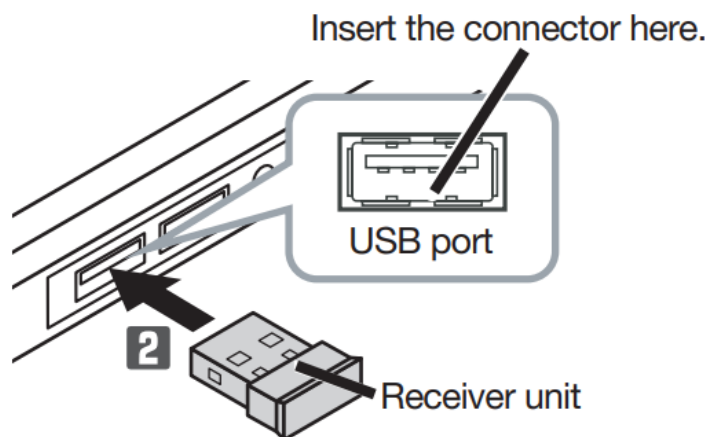

1. Start the PC.
2. Insert the receiver unit into the PC's USB port.
3. The driver will be automatically installed, and you will then be able to use the mouse.
  - Ensure the correct orientation and insertion location of the connector.
  - If you feel a strong resistance when inserting the USB connector, check that the shape and orientation of the connector are correct. Using excessive force may damage the connector and cause injury.
  - Do not directly touch the terminal area of the USB connector

### MouseAssistant

<https://www.elecom.co.jp/r/132.html>



Mac <https://www.elecom.co.jp/r/133.html>

Download “ELECOM Mouse Assistant” from the ELECOM website to use its button assignment and high-speed scrolling functions.

### Power-saving mode

When the mouse is left untouched for a fixed period while the power is ON, it automatically shifts to power-saving mode. The mouse is released from the power-saving mode when it is touched. Mouse operation may be unstable for a few seconds after returning from the power-saving mode.

### How to clean the trackball

1. Remove the battery cover.

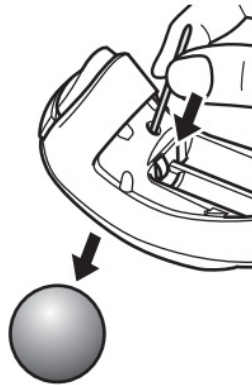

2. Use a thin rounded stick to push the ball from behind. Do not use a sharp and pointed end.
3. Use a cotton bud or similar to remove the dust accumulated on the three contact surfaces of the red ball.

Contact surface

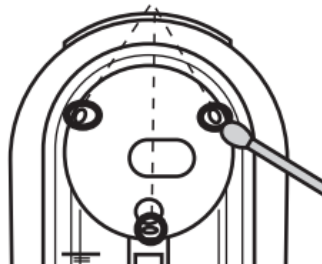

4. When cleaning around the optical sensor, take care not to damage the sensor.

### Specifications

Supported OS	Windows® 10, Windows® 8.1, Windows® RT8.1, Windows® 7, macOS Mojave(10.14) (Updating the OS or installing a service pack may be necessary.) * Compatibility information was retrieved during operation confirmation in our verification environment. There is no guarantee of complete compatibility with all devices, OS versions, and applications.
Resolution	500/1000/1500 dpi (switchable)
Interface	USB
Radio frequency	2.4 GHz band
Radio wave method	GFSK
Radio wave range	Non-magnetic materials (such as wooden desks): approx. 10m/33ft Magnetic materials (such as iron desks): approx. 3m/10ft * These are test values in company environment and are not guaranteed.
Read method	Optical sensor method
Dimensions (W × D × H)	Mouse : Approx. 41 x 112 x 57 mm/1.61 x 4.41 x 2.24 inch. Stand :Approx. 65 x 65 x 37 mm/2.56 x 2.56 x 1.46 inch. Receiver unit : Approx. 15 x 18 x 6 mm/0.6 x 0.71 x 0.24 inch.
Operational temperature/ humidity	Temperature: 5 °C to 40 °C / 41 °C to 104 °C, humidity: up to 90 % RH (without condensation)
Storage temperature/ humidity	Temperature: -10 °C to 60 °C / 14 °C to 140 °C, humidity: up to 90 % RH (without condensation)
Supported battery	Any two of AAA alkaline batteries, AAA manganese batteries, AAA type nickel-metal hydride batteries
Operational time	Estimate when using alkaline battery Continuous operation time: Approximately 113 hours Continuous standby time: Approximately 416 days Estimated usage time: Approximately 233 days (The above is assuming the computer is used for eight hours a day with 5% of that time spent operating the mouse.)

## Safety Precautions

1. Prohibited action
2. The situation that needs attention
3. Mandatory action

### WARNING

If a foreign object (such as water and a metal chip) enters the product, immediately stop using the product, remove the receiver unit from the PC, and remove the battery from the product. Continuing to use the product under these conditions may cause a fire or electric shock. If the product is behaving abnormally, such as by generating heat, smoke, or a strange smell, immediately stop using the product, shut down the PC, and then sufficiently check whether the product is generating heat while being careful to avoid being burnt.

Then, remove the receiver unit from the PC and remove the battery from the product. After that, contact the retailer from whom you purchased the product. Continuing to use the product under these conditions may cause a fire or electric shock. Do not drop the product, nor subject it to strong physical shocks. In the event of the product becoming damaged, immediately stop using the product, remove the receiver unit from the PC, and remove the battery from the product. After doing so, contact the retailer from whom you purchased the product. If you continue to use the product under these conditions, it may cause a fire or electric shock. Do not attempt to disassemble, modify or repair this product by yourself, as this may cause a fire, electric shock or product damage.

Do not put this product on fire, as the product may burst, resulting in a fire or injury. Do not insert or remove the receiver unit with wet hands. Also, do not make alternations to or forcefully bend the receiver unit. Doing so may cause a fire or electric shock. The receiver unit presents a swallowing hazard for children, so be sure to store it in

a place out of the reach of children.

## **CAUTION**

- Do not place this product in any of the following environments:
- In a car exposed to sunlight, a place exposed to dire sunlight, or a place that becomes hot (such as around a heater)
- In a moist place or a place where condensation may occur.
- In an uneven place or a place exposed to vibration
- In a place where a magnetic field is generated (such as near a magnet)

### **In a dusty place**

This product does not have a waterproof structure. Use and store this product in a place where the product body will be splashed with water or other liquid. Rain, water mist, jui coffee, steam or sweat may also cause product damage. Only use this product with PCs and video game systems Do not use this product with any device that may significantly be affected in the case of this product malfunctioning. If this mouse is not going to be used for one month or longer, remove the receiver unit from the PC. When you no longer need to use this product and the battery, be sure to dispose of them in accordance with the local ordinances and laws of your area.

### **Batteries**

For this product, use AAA alkaline battery, AAA manganese battery, or AAA-type nickel-metal hydride rechargeable battery. When not using this product for long periods, remove the battery. This may cause fluid leaks or malfunction. Do not mix different types of batteries or old batteries with fresh ones. Doing so may cause battery leakage and failure.

### **Cleaning the Product**

If the product's body becomes dirty, wipe it with a soft, dry cloth. The use of a volatile liquid (such as paint thinner, benzene, or alcohol) may affect the material quality and colour of the product.

## **Precautions on wireless**

This product is a wireless device that can use the entire 2.4 GHz band and can avoid the mobile entity identification device range. TheGFSK method is adopted as the radio wave method, and the interference distance is 10m. The 2.4 GHz band is also used in medical devices, Bluetooth® and wireless LAN devices of the IEEE 802.11b/11g/11n standards.

- Before using this product, check whether “other wireless stations\*” are not operating nearby.
- In the unlikely event that radio interference occurs between this product and “other wireless stations\*”, change the location of use or stop using this product.
- “Other wireless stations” refer to industrial, scientific, and medical instruments that use the same 2.4 GHz as this product, as well as other wireless stations of the same type, such as in-house mobile entity identification wireless stations requiring a license, specific low-power wireless stations and amateur wireless stations not requiring a license, used in plant production lines.

## **WARNING**

- Do not use equipment that may cause serious effects due to its malfunction. In rare cases, it may be affected by radio waves of the same frequency or radio waves of mobile phones from outside, causing a malfunction, deterioration in operation, or stop working

- Do not use this product in places where radio wave usage is prohibited, such as in hospitals. Radio waves of this product may affect electronic devices and medical devices (for example pacemakers).
- Due to the possibility of hindering the safe navigation of aircraft, the use of wireless mice in aircraft is prohibited by the Civil Aeronautics Act.
- Turn off the power of the wireless mice before boarding and do not ever use them after boarding.
- Please note that we can not assume any responsibility, even if events such as an accident or social damage occur due to a failure of this product.

### **Limitation of Liability**

- In no event will ELECOM Co., Ltd be liable for any lost profits or special, consequential, indirect, or punitive damages arising out of the use of this product.
- ELECOM Co., Ltd will have no liability for any loss of data, damages, or any other problems that may occur to any devices connected to this product.

### **Compliance status**

<https://www.elecom.co.jp/global/certification/>

### **FCC ID: YWO-MRT1D-1**

Thus earn mere-rente and this decide miss. Accept any interference tile, in ting interpreters. that may cause not

### **FCC ID: YWO-ELECOM01A**

**NOTE;** This equipment has been tested and found to comply with the limits for a Class B Digital Device, under part 15 of the FCC Rules. These limits are designed to provide reasonable protection against harmful interference in a residential installation. This equipment generates, uses and can radiate radio frequency energy and, if not installed and used by the instruction, may cause harmful interference to radio communication. However, there is no guarantee that interference will not occur in a particular installation. If this equipment does cause harmful interference to radio or television reception, which can be determined by turning the equipment off and on, the user is encouraged to try to correct the interference by one or more of the following measures:

- Reorient or relocate the receiving antenna.
- Increase the separation between the equipment and the receiver.
- Connect the equipment to an outlet on a circuit different from that to which the receiver is connected.
- Consult the dealer or an experienced radio/TV technician for help.

**NOTICE:** The manufacturer is not responsible for any radio or TV interference caused by unauthorized modification to this equipment. Such modifications could void the user's authority to operate the equipment. To make improvements to this product, the design and specifications are subject to change without prior notice.

### **FCC Radiation Exposure Statement**

This equipment complies with FCC RF radiation exposure limits set forth for an uncontrolled environment. This equipment should be installed and operated with a minimum distance of 0.5 cm between the radiator and your body. This transmitter must not be co-located or operating in conjunction.

Responsible party  
ELECOM USA, Inc.  
4041 MacArthur Blvd Suite 400,  
Newport Beach, CA 92660 USA  
[elecomusa.com](http://elecomusa.com)

with any other antenna or transmitter. The antennas used for this transmitter must be installed to provide a



separation distance of at least 0.5 cm from all persons and must not be co-located or operating in conjunction with any other antenna or transmitter. Xin tham khảo theo hiện trạng tuân thủ RoHS:

[www.elecom.co.jp/global/certification/](http://www.elecom.co.jp/global/certification/)

### WEEE Disposal and Recycling Information

This symbol means that waste of electrical and electronic equipment (WEEE) should not be disposed of as general household waste. WEEE should be treated separately to prevent possible harm to the environment or human health. Consult your retailer or local municipal office for collection, return, recycling or reuse of WEEE.

European Authorized Representative :

VISHTEC Ltd

3rd floor oce 5, Plovdiv 2 Liuben Karavelov bul,

4002 Bulgaria

[compliance@vish-tec.com](mailto:compliance@vish-tec.com)

Trademark and name of the manufacturer: ELECOM CO., LTD.

Fushimimachi 4-1-1, Chuo-ku, Osaka City [www.elecom.co.jp/global](http://www.elecom.co.jp/global)

- Unauthorised copying and/or reproducing of all or part of this manual is prohibited.
- The specifications and appearance of this product may be changed without prior notice for product improvement purposes.
- When exporting this product, check the export regulations for the country of origin.
- Windows is a trademark of the Microsoft Corporation.
- macOS Movaje and Macintosh are trademarks of Apple Inc., registered in the U.S. and other countries.
- Company names, product names, and other names in this manual are either trademarks or registered trademarks.

A customer who purchases outside Japan should contact the local retailer in the country Global Support of purchase for enquiries. In “ELECOM CO., LTD. (Japan)”, no customer support is available for enquiries about purchases or usage in/from any countries other than Japan. Also, no language other than Japanese is available. Replacements will be made under the stipulation of the Elecom warranty.

### Wireless Trackball Mouse

Manual, Safety Precautions, and Compliance with Regulations 2nd edition, February 14, 2024

2024 ELECOM Co., Ltd. All Rights Reserved.

<https://www.elecom.co.jp/r/s536>

MSC-M-RT1DR ver.212

---

## Documents / Resources







[ELECOM MRT1D-1 Wireless Trackball Mouse](#) [pdf] Instruction Manual

MRT1D-1, ELECOM01A, MRT1D-1 Wireless Trackball Mouse, Wireless Trackball Mouse, Track ball Mouse, Mouse

## References

-  [ELECOM USA](#)

-  [\*\*TEC - Residential and Business Internet and Voice\*\*](#)
-  [\*\*ELECOM GLOBAL\*\*](#)
-  [\\_\\_\\_\\_\\_](#)
-  [\\_\\_\\_\\_\\_](#)
-  [\\_\\_\\_\\_\\_](#)
- [\*\*User Manual\*\*](#)

**Manuals+.** [Privacy Policy](#)

This website is an independent publication and is neither affiliated with nor endorsed by any of the trademark owners. The "Bluetooth®" word mark and logos are registered trademarks owned by Bluetooth SIG, Inc. The "Wi-Fi®" word mark and logos are registered trademarks owned by the Wi-Fi Alliance. Any use of these marks on this website does not imply any affiliation with or endorsement.