



# ELECOM M-XT3DRBK Wireless Trackball Mouse Instruction Manual

[Home](#) » [ELECOM](#) » ELECOM M-XT3DRBK Wireless Trackball Mouse Instruction Manual 

## Contents

- [1 ELECOM M-XT3DRBK Wireless Trackball Mouse](#)
- [2 Functions Of Each Part](#)
- [3 Installing a battery](#)
- [4 Connecting to a PC](#)
- [5 Specifications](#)
- [6 Documents / Resources](#)
  - [6.1 References](#)

# ELECOM

## ELECOM M-XT3DRBK Wireless Trackball Mouse



## Functions Of Each Part

Names and functions of each part

- Trackball mouse

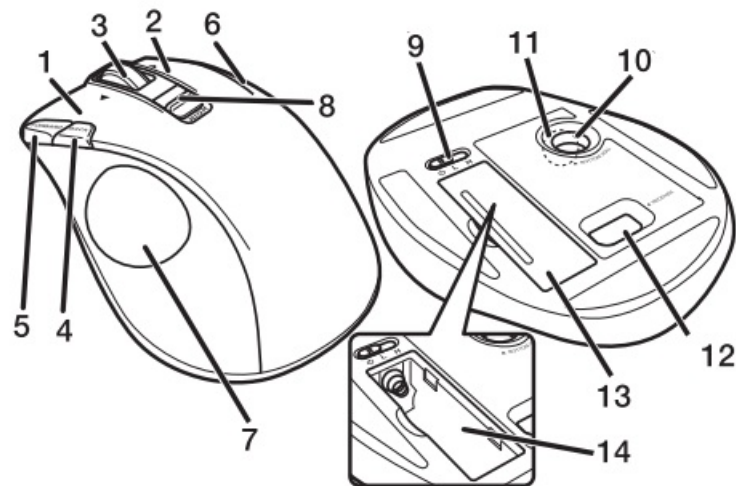

1. Left button
2. Right button
3. Tilt wheel/pointer speed indicator light
4. "Back" button You can perform the "Back" operation in a web browser.
5. "Forward" button You can perform the "Forward" operation in a web browser.
6. Function buttons No function is assigned at the time of purchase. Download "ELECOM Mouse Assistant" from the ELECOM website to use its button assignment function.
7. Trackball
8. Pointer speed selector Sliding the selector left and right switches the resolution (pointer speed) between LOW and HIGH.

The current resolution will be indicated by the blinking pointer speed indicator light.

- **Blinks once:** 750 dpi
- **Blinks twice:** 1500 dpi

9. Operation mode switch

-  Power off
- **L** (Low Power Mode)
- **H** (High Speed Mode)

10. Ball removal hole Remove the ball for cleaning

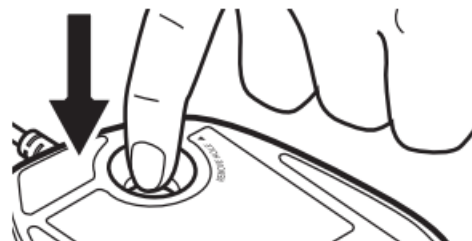

11. Optical sensor (under the ball)
12. Receiver unit storage
13. Battery cover
14. Battery compartment
15. USB connector (male)

## Installing a battery

1. Remove the battery cover. Insert a battery.
2. Insert the battery making sure the positive and negative © polarity is correct.
3. Attach the battery cover back in its original position.

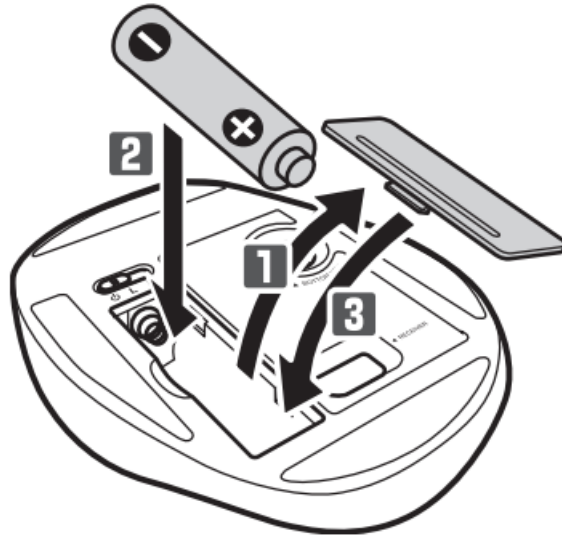

## Turning on the trackball

1. Slide the operation mode selection switch to H (High Speed Mode) or L (Low Power Mode).
  - When using the High Speed Mode, the tracking performance of faster ball movements becomes better but the battery life gets shorter.
  - The light behind the tilt wheel illuminates in red for a few seconds.
  - When the remaining battery capacity is low, it blinks in red for a few seconds.

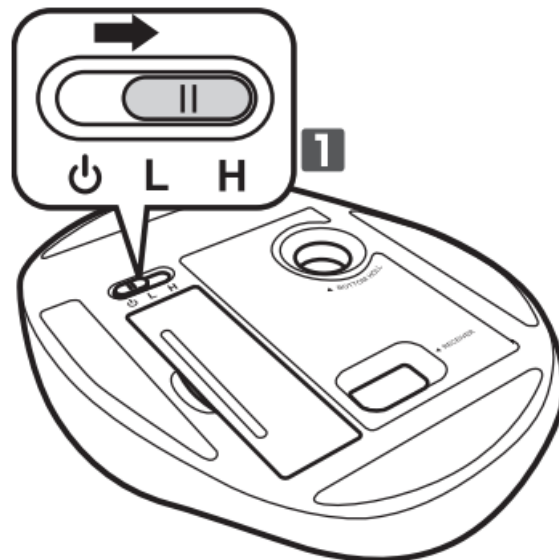

## Connecting to a PC

1. Start the PC.
2. Insert the receiver unit into a USB port on the PC.
  - Be sure to sufficiently check the connector orientation and the insertion location.
  - If you feel a strong resistance when inserting the USB connector, check that the shape and orientation of the connector is correct. Using excessive force may damage the connector and cause injury.

- Do not directly touch the terminal area of the USB connector.
3. The driver will be automatically installed, and you will then be able to use the trackball.

### **Cleaning the trackball**

1. Push the ball out from behind with your finger or a pen.
2. Remove dust from the areas where the three red support balls contact the trackball using a cotton swab.

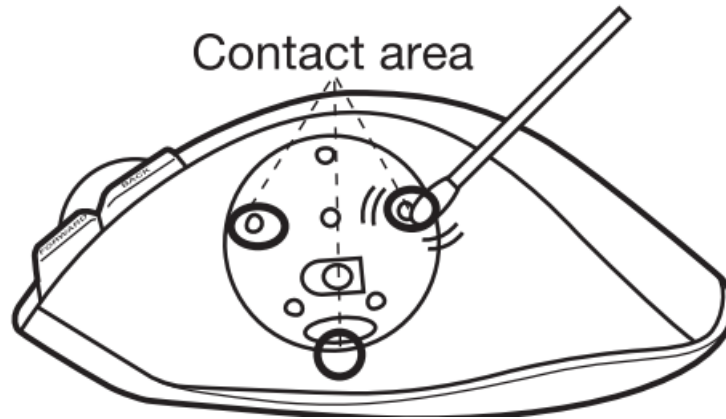

Take care not to damage the optical sensor when cleaning the area.

### **Specifications**

Supported OS	Windows®10, Windows®8.1, Windows®RIB.1, Windows®7, Windows Vista®, Macintosh OS X 10.1-10.11 (UJX! dating the OS or installing a service pack may be necessary.)  * Compatibility information varies; retrieval during operation is confirmation in our verification environment. There is no guarantee of complete compatibility with all OS licenses, OS versions, and 8.1+ locations.
Resolution	750/1500 dpi (switchable)
Interface	USB
Radio frequency	2.4 GHz band
Radio wave method	GFSK modulation
Radio wave outreach	approx. 10 m on non-magnetic surfaces (wooden desks, etc.), approx. 3 m on magnetic surfaces (steel desks, etc.)  *These values are based on Elecom's tests and are not for guaranteed performance.
Dimensions (W x D x H)	Trackball mouse: approx. 95 x 125 x 48 mm Receiver unit: approx. 14 x 19 x 5 mm
Operating temperature/ humidity	5°C to 40°C/90%RH or less (without condensation)
Storage temperature/humidity	-10°C to 60°C/90%RH or less (without condensation)
Batteries	AA alkaline dry battery, AA manganese dry battery or AA nickel-metal hydride rechargeable battery
Continuous operating time*	Low Power Mode: approx. 125 hours High-Speed Mode: approx. 76 hours
Continuous standby time*	Low Power Mode/High Speed Mode: approx. 694 days
Estimated battery life *	Low Power Mode: approx. 273 days High-Speed Mode: approx. 176 days

When the computer is used for 8 hours a day, 5% of that time is spent operating the mouse using alkaline batteries.

- **Win**

- <https://www.elecom.co.jp/r/1.32.html>

- **Mac**

- <https://www.elecom.co.jp/r/133.html>

Download "ELECOM Mouse Assistant" from the ELECOM website to use its button assignment and high-speed scrolling functions. Wireless Trackball Mouse

Documents / Resources



[ELECOM M-XT3DRBK Wireless Trackball Mouse](#) [pdf] Instruction Manual

M-XT3DRBK Wireless Trackball Mouse, M-XT3DRBK, Wireless Trackball Mouse, Trackball Mouse, Mouse

References

- [User Manual](#)