



# ELECOM M-SH10DBS Wireless Mouse Ergonomic Shape User Manual

[Home](#) » [ELECOM](#) » ELECOM M-SH10DBS Wireless Mouse Ergonomic Shape User Manual 

## Contents

- 1 ELECOM M-SH10DBS Wireless Mouse Ergonomic Shape
- 2 Product Information
- 3 Precautions
- 4 How to use
  - 4.1 Items included in this package
  - 4.2 Name and function of each part
  - 4.3 Mouse
  - 4.4 Connecting and setting up the mouse
  - 4.5 Windows®
  - 4.6 Mac
  - 4.7 Change the mouse pointer speed
  - 4.8 ChromeOS
- 5 Specifications
- 6 Troubleshooting
- 7 Compliance status
- 8 Intellectual property rights
- 9 Support information
- 10 Documents / Resources
  - 10.1 References
- 11 Related Posts

# ELECOM

**ELECOM M-SH10DBS Wireless Mouse Ergonomic Shape**



## Product Information

- **Product Name:** Wireless Mouse
- **Model:** M-SH10DB series
- **Compliant Models:** M-SH10DBS, M-SH20DBS, ELECOM01B

## Precautions:

This manual describes important precautions to ensure safe operation of the product. Please read and follow these precautions carefully to avoid personal injury, damage, fire, and other problems.

## Meaning of Symbols:

- **WARNING:** Failure to observe precautions may result in serious personal injury or death due to fire, electric shock, or other causes.
- **CAUTION:** Failure to observe precautions may result in personal injury due to electric shock or other causes, and may damage other equipment.

**Prohibited Actions:**

Prohibited Action	Mandatory Action	Situation that Needs Attention	Notes and Reference Information
If a foreign object (water, metal chips) enters the product	Stop using the product immediately, remove the receiver unit from the PC, and remove the battery from the mouse	Continuing to use the product as it is may cause a fire or electric shock	—
If the product is behaving abnormally (e.g. generating heat, smoke, strange smell)	Stop using the product immediately, shut down the PC, and then check for heat without being burned. Remove the receiver unit from the PC and remove the battery from the mouse. Contact your dealer.	Continuing to use the product as it is may cause a fire or electric shock	—
Do not drop or hit the product	Stop using the product immediately, remove the receiver unit from the PC, and remove the battery from the mouse. Contact your dealer.	Fires or electric shocks may occur if used when damaged	—
Do not attempt to disassemble, modify, or repair the product	—	Doing so may cause a fire, electric shock, or product damage. Malfunctions are not covered under warranty.	—
Do not put the product in fire	—	Breakage may cause fire or injury.	—
<b>CAUTION:</b>			
Do not place the product in the following environments:	—	In a car exposed to sunlight or a place exposed to direct sunlight. In a hot place (e.g. around a heater). In a moist place or a place where condensation may occur. In an uneven place or a place exposed to vibration. In a place where a magnetic field is generated (e.g. near a magnet). In a dusty place.	—

This product does not have a waterproof structure.	—	Use or store in a place not exposed to liquids such as water. Any liquid such as rain, water spray, juice, coffee, steam, and sweat may cause the product to breakdown.	—
--	---	---	---

### Battery:

- **CAUTION:** Please use either an AA alkaline battery, an AA manganese battery, or an AA nickel-metal hydride rechargeable battery.
- Remove the battery when not using the product for long periods of time to prevent leakage or malfunction.

### Cleaning the Product:

- If the body of the product becomes dirty, wipe it with a soft, dry cloth.
- Using volatile liquids such as paint thinner, benzene, or alcohol may affect the material quality and/or discolor the product.
- For disinfection, gently soak a cleaning cloth (e.g. microfiber cloth) in a disinfectant solution. Ensure there are no loose droplets and gently wipe the product using the cloth. After wiping, dry thoroughly and wipe off any residual liquid. *Do not spray any liquid directly onto the product as it can cause electric malfunctions.*

### Precautions

This manual describes the important precautions you should take for safe operation of this product. Observe these precautions carefully to avoid personal injury, damage, fire, and other problems.

### Meaning of symbols

#### WARNING

Failure to observe precautions carries the possibility of serious personal injury or death due to fire, electric shock, or other causes.

#### CAUTION

Failure to observe precautions may result in personal injury due to electric shock or other causes, and may damage other equipment.

Prohibited action

Mandatory action

Situation that needs attention

Notes and reference information

#### WARNING

If a foreign object (water, metal chips) enters the product, stop using the product immediately, remove the receiver unit from the PC, and remove the battery from the mouse.

Continuing to use the product as it is may cause a fire or electric shock.

If the product is behaving abnormally, such as by generating heat, smoke, or giving off a strange smell, stop using the product immediately, shut down the PC, and then after sufficiently checking for whether the product is

generating heat without being burned, remove the receiver unit from the PC, and remove the battery from the mouse. Afterwards, please contact your dealer.

Continuing to use the product as it is may cause a fire or electric shock.

Please do not drop or hit this product.

In the unlikely event that this product is damaged, stop using the product immediately, remove the receiver unit from the PC, and remove the battery from the mouse. Afterwards, please contact your dealer.

Fires or electric shocks may occur if this product is used when damaged.

Do not attempt to disassemble, modify or repair this product.

Doing so may cause a fire, electric shock, or product damage. Malfunctions are not covered under warranty.

Do not put this product in fire.

Breakage may cause fire or injury.

## **CAUTION**

Do not place this product in any of the following environments:

- In a car exposed to sunlight or a place exposed to direct sunlight.
- In a place that becomes hot, such as around a heater.
- In a moist place or a place where condensation may occur.
- In an uneven place or a place exposed to vibration.
- In a place where a magnetic field is generated (such as near a magnet.) In a dusty place.

This product does not have a waterproof structure. Use or store in a place not exposed to liquids such as water. Any liquid such as rain, water spray, juice, coffee, steam, and sweat, may cause this product to breakdown.

Only use this mouse with PCs, smartphones, tablets, and video game systems.

Do not use this product with any device that may significantly be affected in the case of this product malfunctioning.

If this product is used on a transparent surface such as glass or a highly reflective surface such as a mirror, the optical sensor will not function correctly and the mouse cursor movement will become unstable.

Although the sensor light is not visible, please note that looking directly into the sensor may hurt your eyes.

When you no longer need to use this product and the battery, be sure to dispose of them in accordance with the local ordinances and laws of your area.

## **Battery**

### **CAUTION**

Please use either an AA alkaline battery, an AA manganese battery or an AA nickel-metal hydride rechargeable battery.

Remove the battery when you are not using this product for long periods of time.

Otherwise, this may cause leakage or malfunction.

## **Cleaning the Product**

If the body of this product becomes dirty, wipe with a soft, dry cloth.

Using a volatile liquid such as paint thinner, benzene or alcohol may affect the material quality and/or discolor this product.

Please note the following for disinfection.

Gently soak a cleaning cloth, such as a microfiber cloth, in the disinfectant solution. Make sure there are no loose droplets and gently wipe the product using the cloth.

After wiping, dry thoroughly and wipe off any residual liquid.

\* Do not spray any liquid onto the product directly. Doing so can cause electric malfunctions.

## **IMPORTANT**

Do not spray any liquid onto the product directly.  
Doing so can cause electric malfunctions.

Do not use organic solvents or ultraviolet lights.  
Usage can result in deterioration of the housing components or paints, which can cause damage to the exterior.

We recommend the usage of disposable gloves.

Please unplug the USB connector from the PC.

When using any alcohol-based products, please check that it is appropriate for the specific purpose and that it is used properly.

Please note that in the event that damage or abnormal operation to the product is caused by the cleaning process, the customer will be fully responsible for the cost of repair.

We recommend that you disinfect your hands before and after using PCs and peripheral devices that are used by multiple people in order to prevent the spread of infection through the equipment.

Please turn off any connected devices.

- Please turn off connected devices when in sleep or hibernation mode.
- Please unplug the AC adapter and power cable from the power outlet.

## **Cautions for Wireless Equipment**

This product is a wireless device that can use the entire 2.4 GHz band, and is able to avoid the mobile entity identification device range. The GFSK method is adopted as the radio wave method, and the interference distance is 10 m. The 2.4 GHz band is also used in medical devices, Bluetooth, and wireless LAN devices of the IEEE 802.11b/11g/11n standards. Before using this product, check that there are no other “radio stations”<sup>\*</sup> operating nearby.

If electromagnetic interference occurs between this product and other “radio stations”<sup>\*</sup>, move this product to another location or stop using this product.

<sup>\*</sup> Other “radio stations” refer to industrial, scientific and medical devices using the 2.4 GHz band, the same as this product, other radio stations of this type, licensed radio station premises for a mobile object identification system that is used in factory production lines, certain non-licensed low power radio stations, and amateur radio stations.

## **WARNING**

Do not use in equipment which may cause serious effects due to it malfunctioning. There are rare cases in which an external radio wave at the same frequency, or the radio wave emitted from a mobile phone, causes this product to malfunction, slow down, or fail to operate.

Do not use this product in places where radio wave usage is prohibited, such as hospitals. Radio waves of this product may affect electronic devices and medical devices (for example pacemakers).

Due to the possibility of hindering safe navigation of aircraft, use of wireless mouse in aircraft is prohibited by the Civil Aeronautics Act. Turn off the power of the wireless mouse before boarding and do not use after boarding.

<sup>\*</sup> ELECOM is not liable for any accidents or any indirect or consequential damage incurred due to the failure of this product.

## How to use

### Items included in this package

The following are included in this package. Verify the package to ensure all items are accounted for prior to using this product. While every effort has been made to ensure proper packaging, in the event that any shortage or damage is discovered, please contact the retailer where the product was purchased.

- Mouse × 1
- Receiver unit × 1

At the time of shipment, it is stored in the mouse. Please remove before use.

- AA alkaline battery for confirming operability × 1

It is pre-inserted in the mouse body. Please remove the battery insulating pull tab before use.

### Name and function of each part

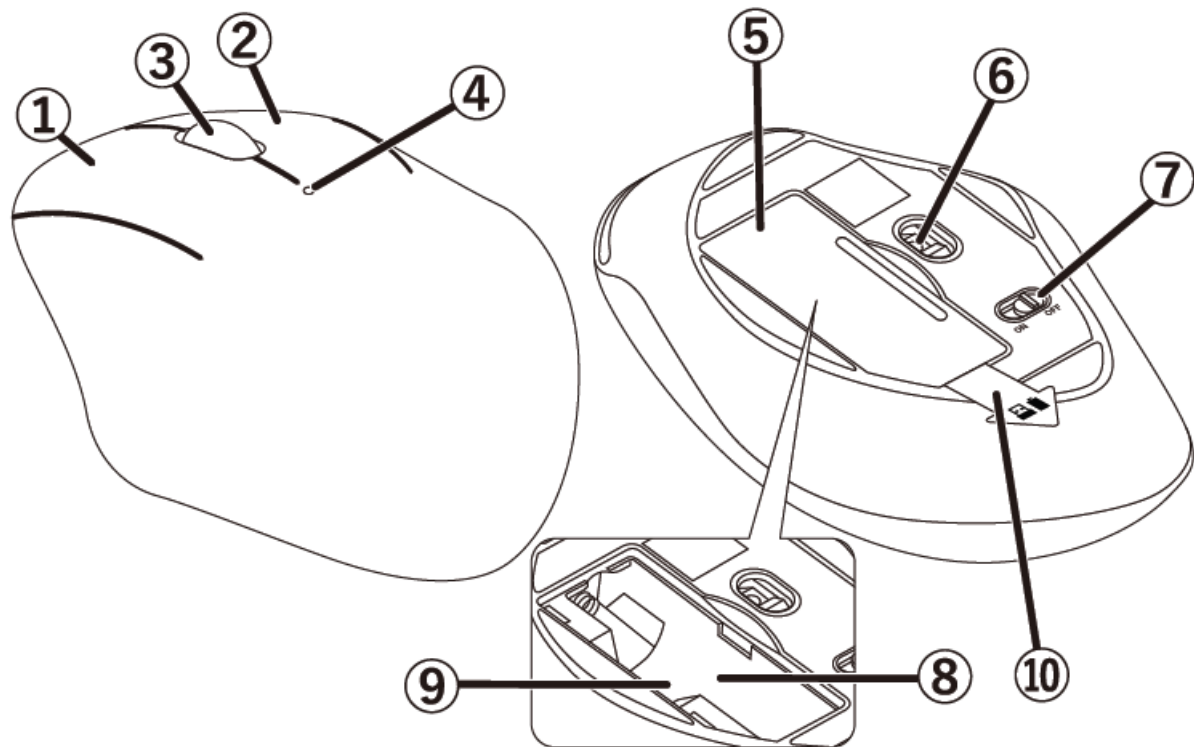

### Mouse

#### 1. Left button

To left click on your PC.

#### 2. Right button

To right click on your PC.

#### 3. Wheel

Rotate forward and backward or click like a button to operate your PC.

#### 4. LED light

The LED will light up white for a period of time when the mouse is switched ON. The LED will blink white during use when the battery level is low.

#### 5. **Battery cover**

Remove this cover to replace the battery.

#### 6. **Optical sensor**

The LED will light up blue when the power is on.

This sensor will detect mouse movements when you move the mouse.

\* Please note that looking directly into the sensor light may hurt your eyes.

#### 7. **Power switch**

Turn the mouse power on (ON) and off (OFF).

#### 8. **Battery storage compartment**

Holds the battery.

#### 9. **Receiver unit storage compartment**

The receiver unit can be stored here when the mouse is not in use.

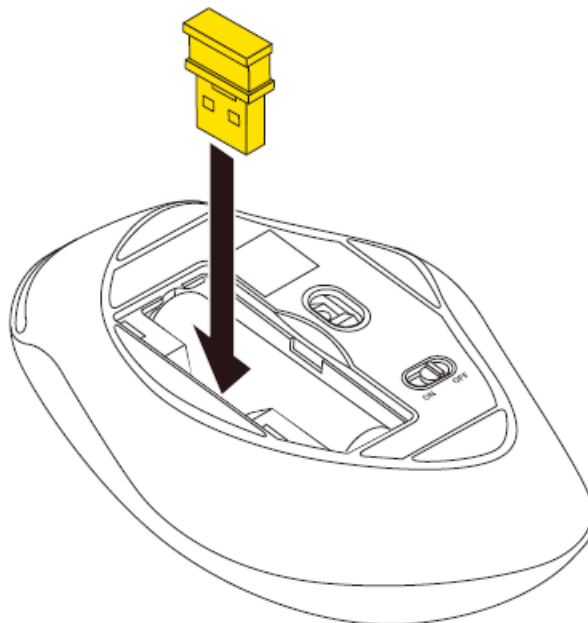

#### 10. **Battery insulating tab**

Remove this tab before using.

**Receiver unit**

#### 11. **USB connector (male)**

Connects to the PC USB-A port

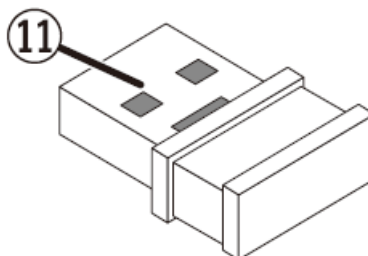

### **Connecting and setting up the mouse**

#### **Windows®**

1. Turn the power ON



1. Remove the battery cover.

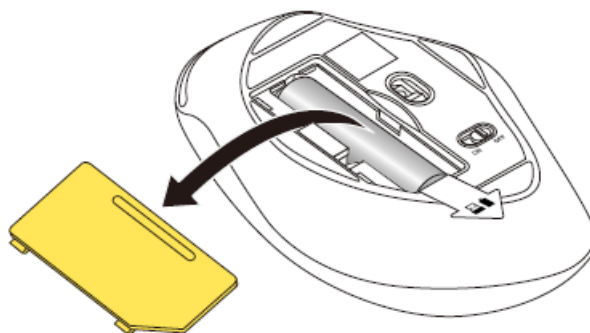

2. Remove the battery insulating tab.

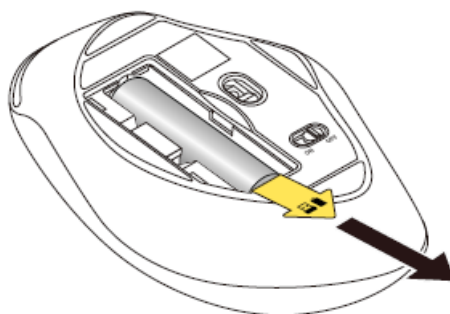

3. Remove the receiver unit.

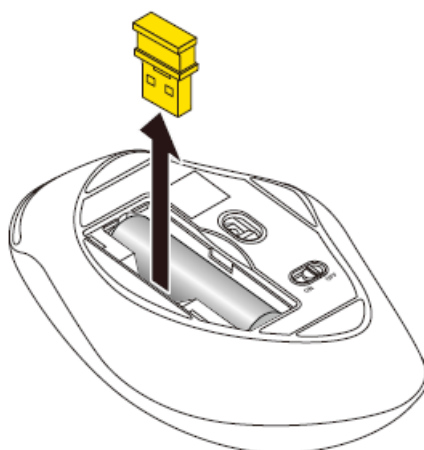

4. Put the battery cover back on.

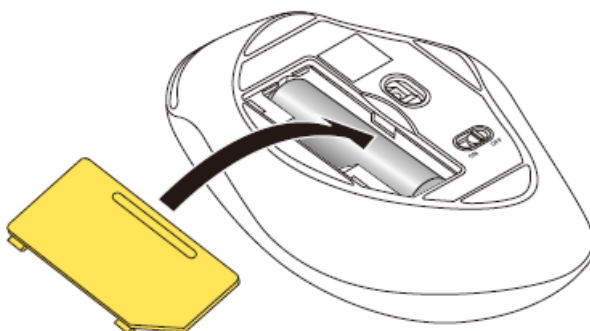

5. Slide the power switch on the underside of the product to the ON position.

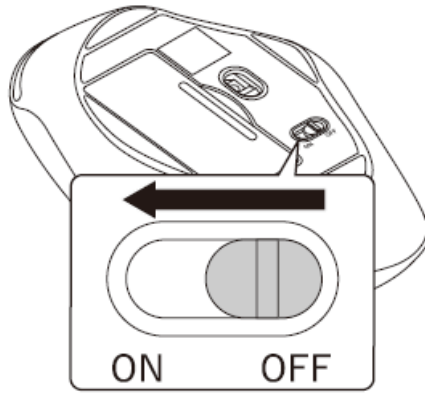

The LED will light up white for a period of time.

\* When the battery level is running low, the LED will blink white for a period of time.

### **Power-saving mode**

When the mouse is left untouched for a fixed period of time while the power is ON, it automatically shifts to power-saving mode.

The mouse returns from power-saving mode when it is moved.

\* Mouse operation may be unstable for 2-3 seconds after returning from the power-saving mode.

### **Replacing the battery...**

1. Remove the battery cover.

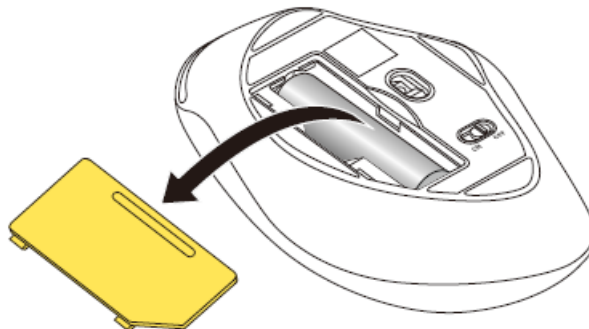

2. Remove the battery.

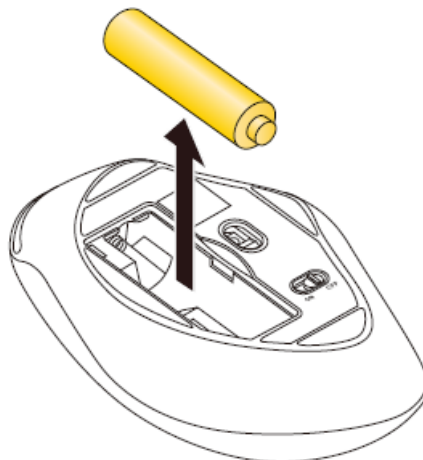

3. Insert the battery according to the instructions on the battery compartment.

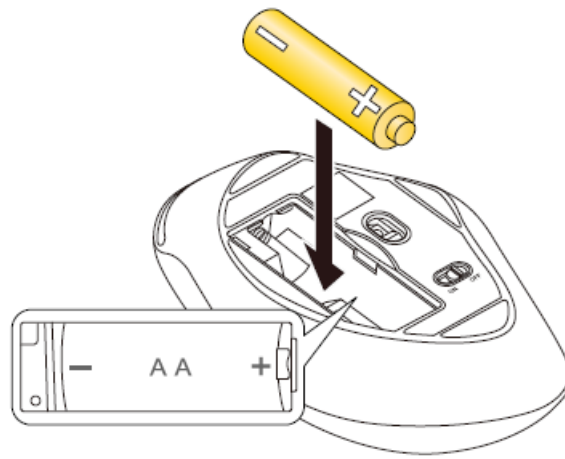

Ensure that the battery is inserted with the positive (+) and negative (-) terminals oriented correctly.

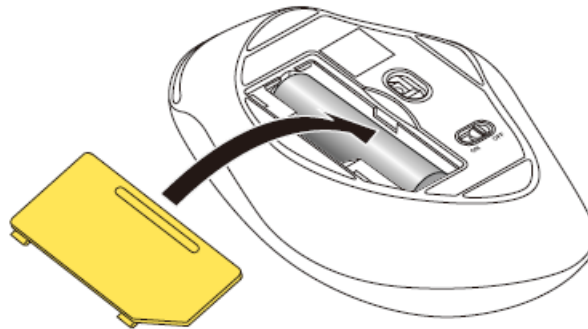

4. Put the battery cover back on.

## 2. Connect to a PC

1. Start up your PC.

Please wait until your PC has started up and can be operated.

2. Insert the receiver unit into the PC's USB-A port.

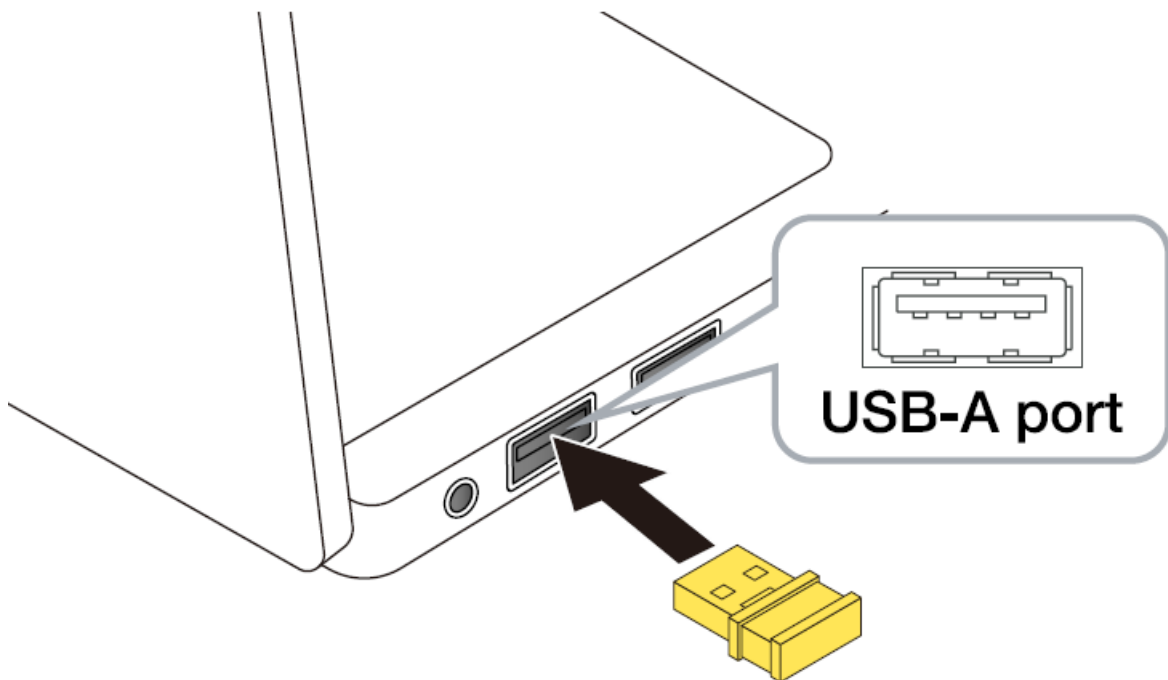

You may use any USB-A port.

Ensure that the connector is correctly oriented to the port.

If there is strong resistance when inserting, check the shape and orientation of the connector. Forcibly inserting the connector may damage the connector, and there is a risk of injury.

Do not touch the terminal portion of the USB connector.

### When removing the receiver unit

This product supports hot plugging. The receiver unit can be removed while the PC is on.

3. The driver will be automatically installed, and you will then be able to use the mouse.

You can now use the mouse.

## Change the mouse pointer speed

Adjust the mouse pointer movement speed on your PC if the mouse pointer moves too fast or too slow.

### For Windows 11

1. Click on “Start” on the bottom of the screen and click on “Settings”. The “Settings” page will appear.
2. Click on “Bluetooth & devices” and then “Mouse”.

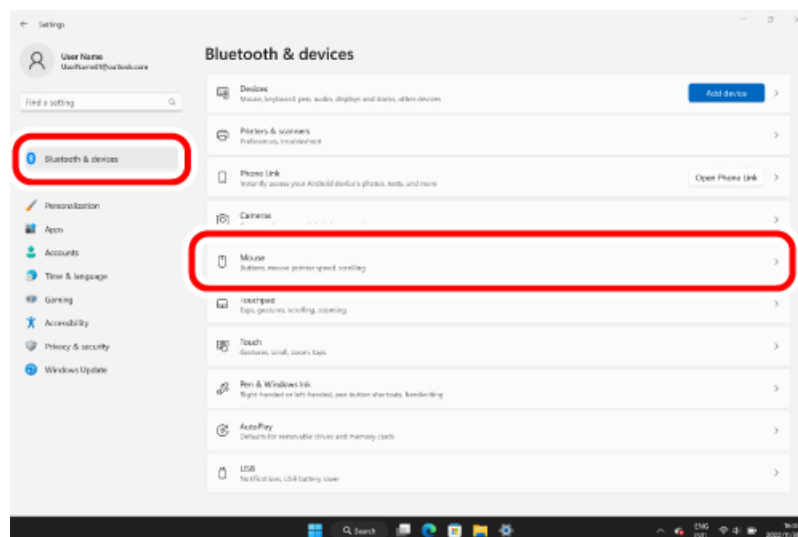

3. Adjust the “Mouse pointer speed” slider bar to adjust the mouse pointer movement speed.

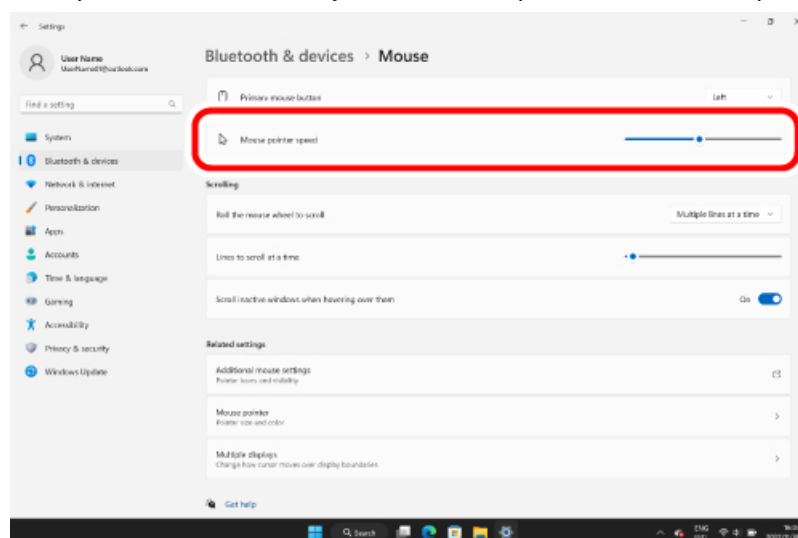

### For Windows 10

1. Open “Mouse” properties.

From the Start menu, click the Settings icon, select “Devices” → “Mouse”, then click “Additional mouse options”

under “Related Settings”.

2. Select the “Pointer Options” tab.

3. Adjust the “Select a pointer speed” slider bar to adjust the mouse pointer movement speed.

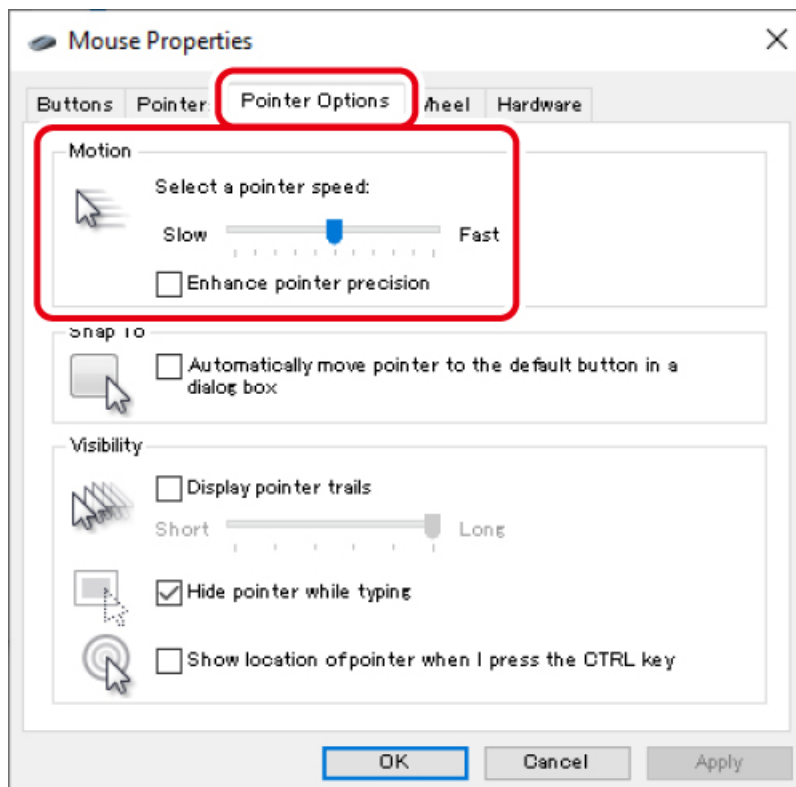

## Change the number of lines scrolled in one wheel turn

### For Windows 11

1. Click on “Start” on the bottom of the screen and click on “Settings”. The “Settings” page will appear.

2. Click on “Bluetooth & devices” and then “Mouse”.

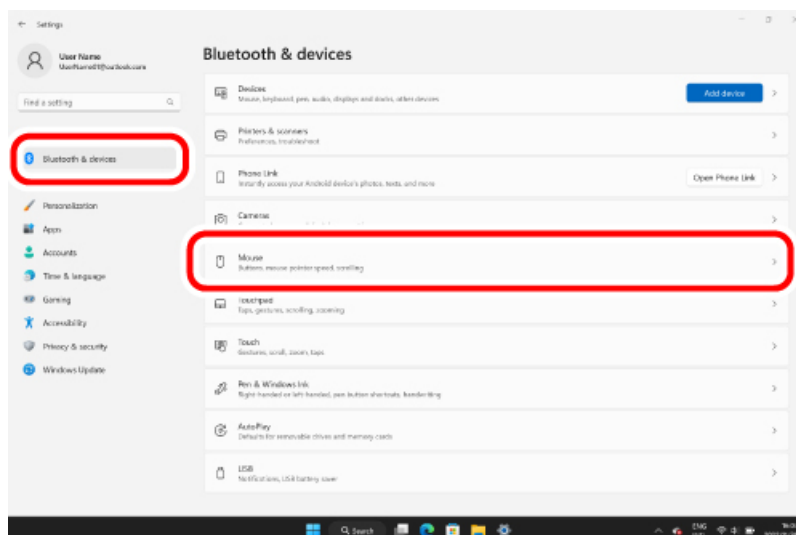

3. Adjust the “Lines to scroll at a time” slider bar to adjust the number of lines per scroll.

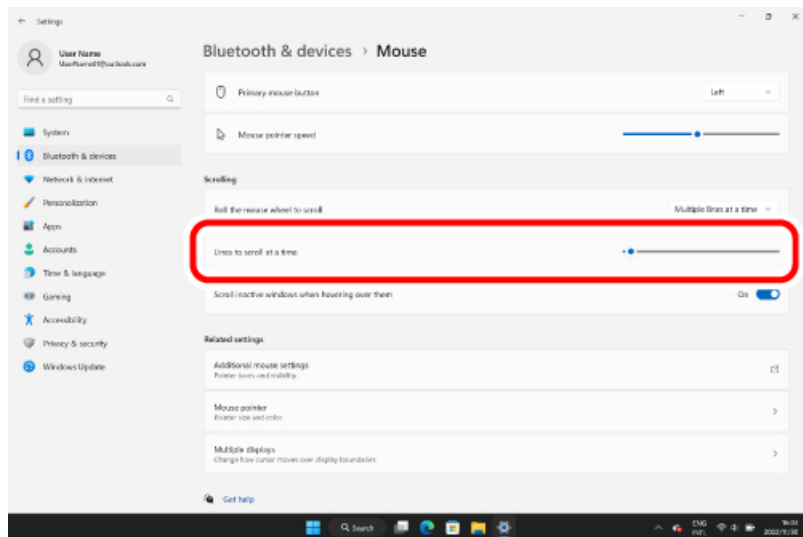

## For Windows 10

1. Open "Mouse" properties.

From the Start menu, click the Settings icon, select "Devices" → "Mouse", then click "Additional mouse options" under "Related Settings".

2. Select the "Wheel" tab.

3. Change the value of "The following number of lines at a time" under "Roll the wheel one notch to scroll"

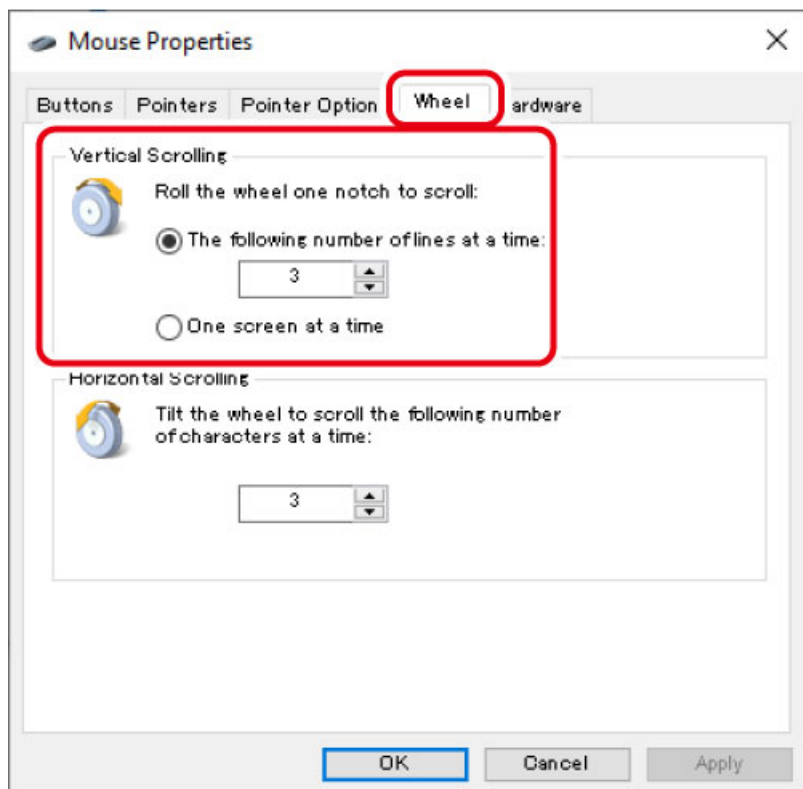

## Mac

1. Turn the power ON

1. Remove the battery cover.

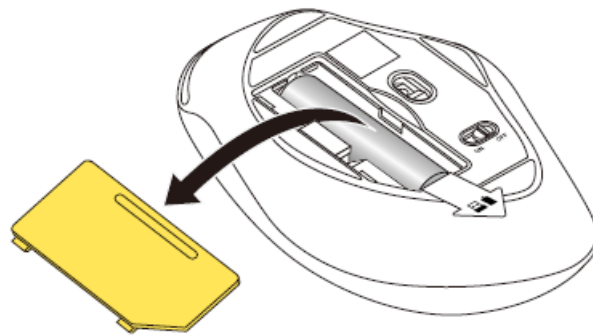

2. Remove the battery insulating tab.

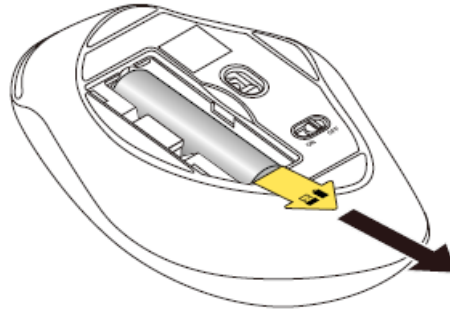

3. Remove the receiver unit.

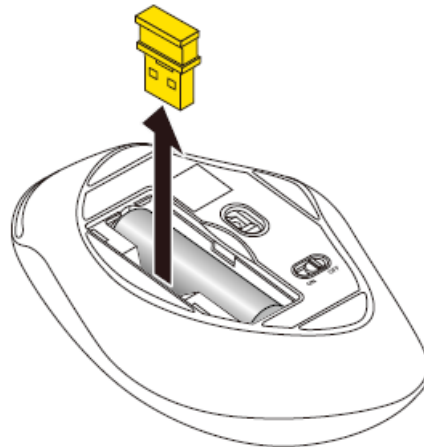

4. Put the battery cover back on.

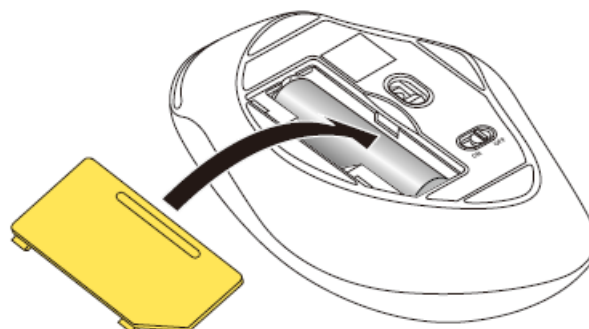

5. Slide the power switch on the underside of the product to the ON position.

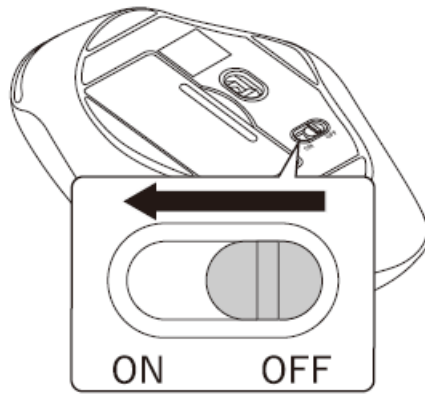

The LED will light up white for a period of time.

\* When the battery level is running low, the LED will blink white for a period of time.

### **Power-saving mode**

When the mouse is left untouched for a fixed period of time while the power is ON, it automatically shifts to power-saving mode.

The mouse returns from power-saving mode when it is moved.

\* Mouse operation may be unstable for 2-3 seconds after returning from the power-saving mode.

### **Replacing the battery...**

1. Remove the battery cover.

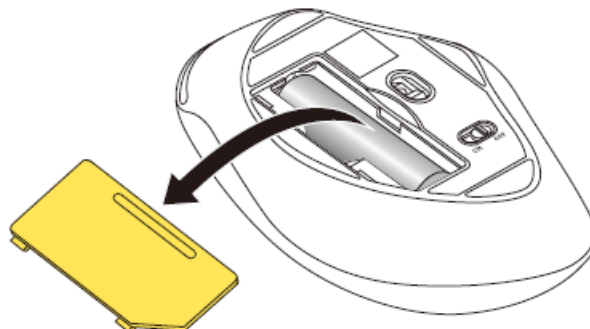

2. Remove the battery.

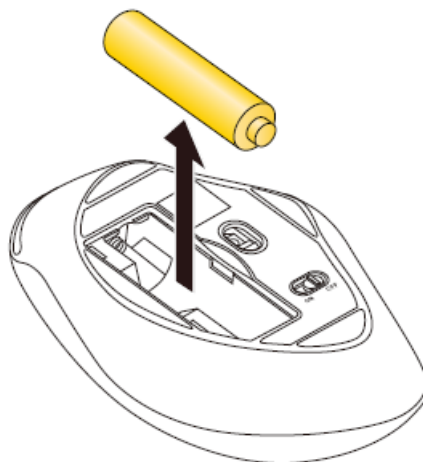

3. Insert the battery according to the instructions on the battery compartment.



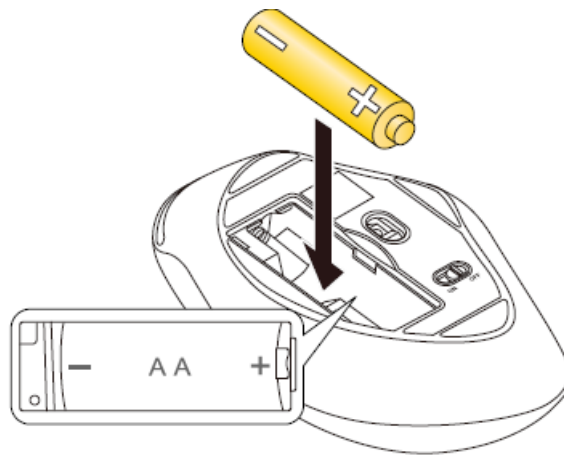

Ensure that the battery is inserted with the positive (+) and negative (-) terminals oriented correctly.

4. Put the battery cover back on.

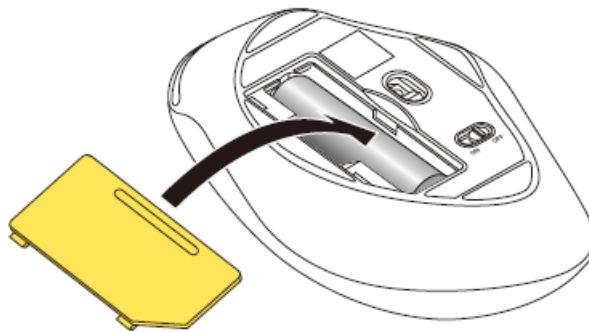

## 2. Connect to a PC

1. Start up your PC.

Please wait until your PC has started up and can be operated.

2. Insert the receiver unit into the PC's USB-A port.

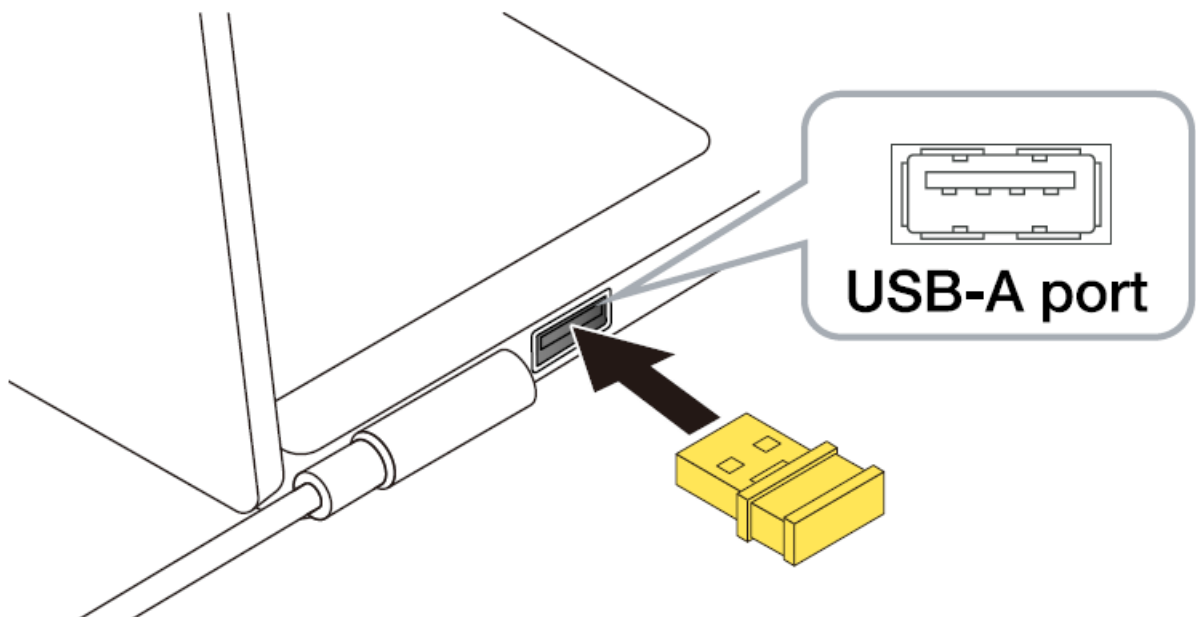

You may use any USB-A port.

For terminals that do not have a USB-A port, such as a MacBook, use a USB Type-C® hub.

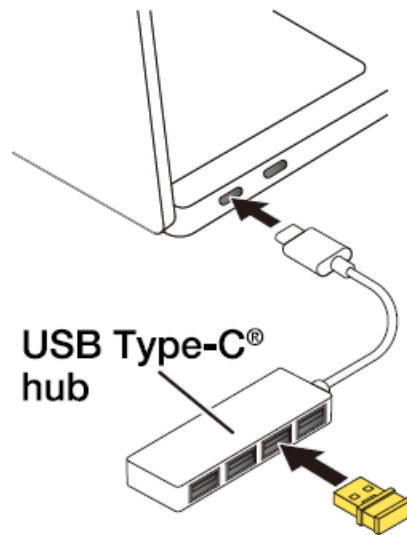

Ensure that the connector is correctly oriented to the port.

If there is strong resistance when inserting, check the shape and orientation of the connector. Forcibly inserting the connector may damage the connector, and there is a risk of injury.

Do not touch the terminal portion of the USB connector.

#### **When removing the receiver unit**

This product supports hot plugging. The receiver unit can be removed while the PC is on.

3. The driver will be automatically installed, and you will then be able to use the mouse.

You can now use the mouse.

#### **Change the mouse pointer speed**

Adjust the mouse pointer movement speed on your PC if the mouse pointer moves too fast or too slow.

1. Click on “Mouse” under “System Settings”.

The “Mouse” settings page will load up.

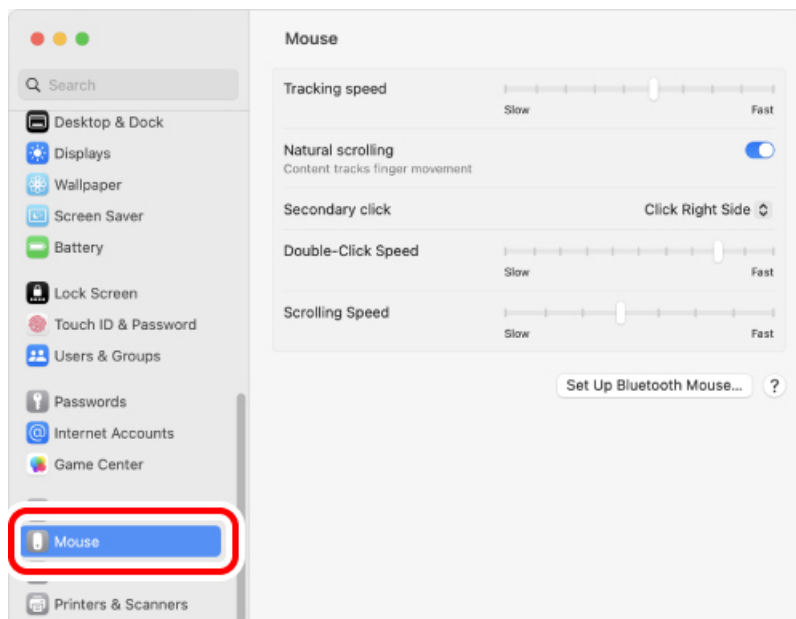

2. Adjust the “Tracking speed” slider to adjust the speed of the mouse pointer.

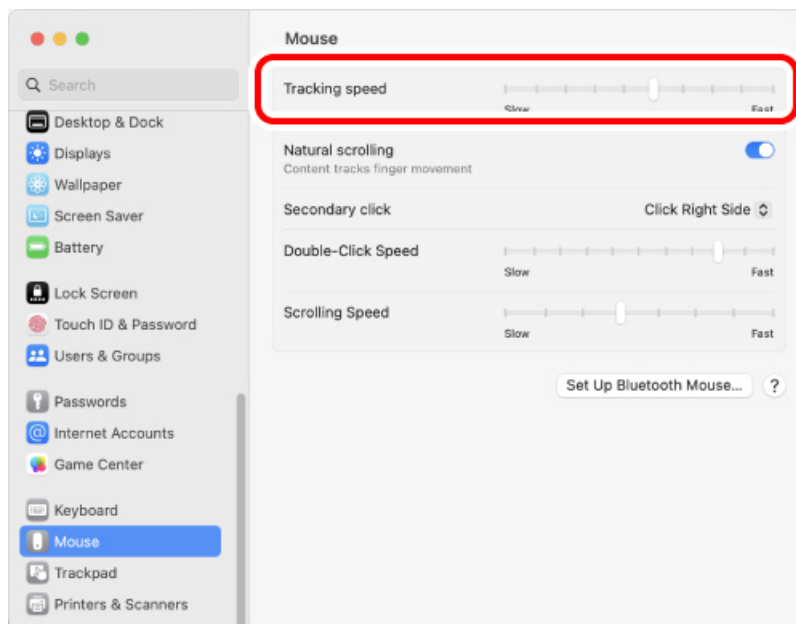

Unchecking “Natural scrolling” will cause the scroll direction to be reversed.

## ChromeOS

### 1. Turn the power ON

1. Remove the battery cover.

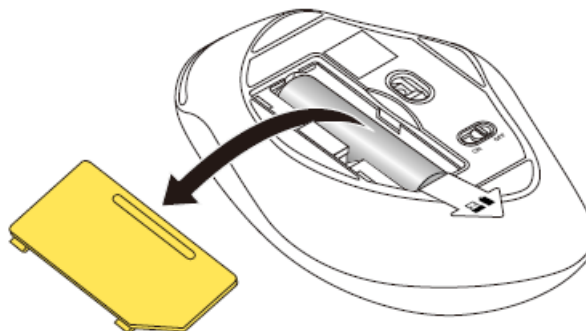

2. Remove the battery insulating tab.

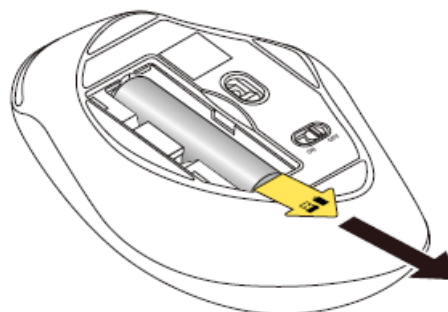

3. Remove the receiver unit.

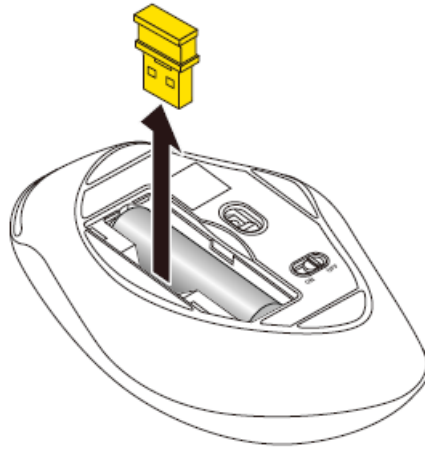

4. Put the battery cover back on.

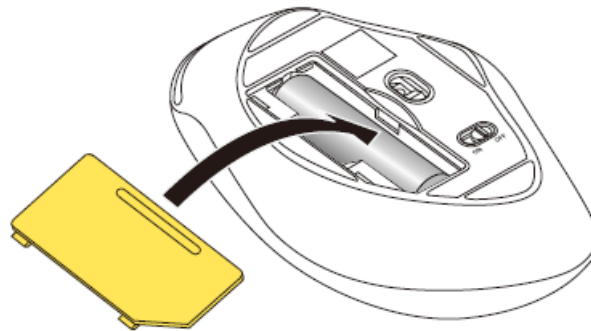

5. Slide the power switch on the underside of the product to the ON position.

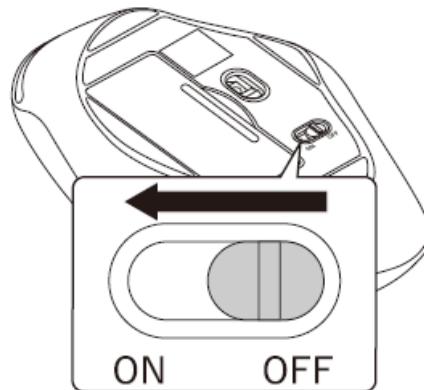

The LED will light up white for a period of time.

\* When the battery level is running low, the LED will blink white for a period of time.

### **Power-saving mode**

When the mouse is left untouched for a fixed period of time while the power is ON, it automatically shifts to power-saving mode.

The mouse returns from power-saving mode when it is moved.

\* Mouse operation may be unstable for 2-3 seconds after returning from the power-saving mode.

### **Replacing the battery...**

1. Remove the battery cover.

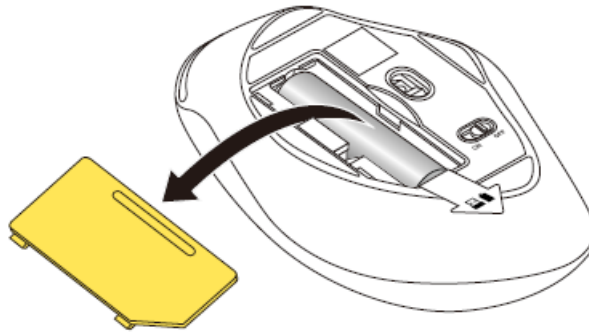

2. Remove the battery.

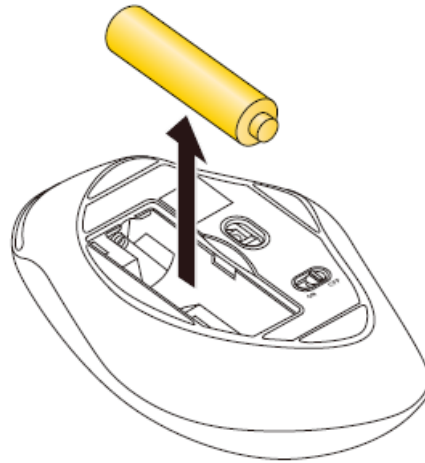

3. Insert the battery according to the instructions on the battery compartment.

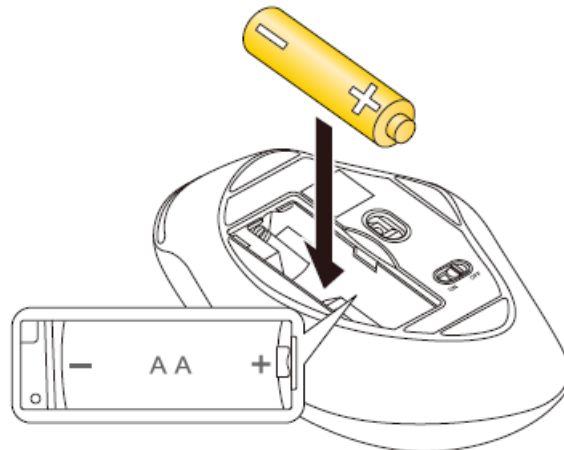

Ensure that the battery is inserted with the positive (+) and negative (-) terminals oriented correctly.

4. Put the battery cover back on.

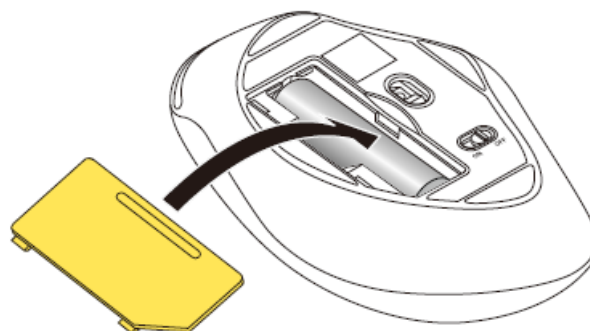

## 2. Connect to a PC

1. Start up your PC.

Please wait until your PC has started up and can be operated.

2. Insert the receiver unit into the PC's USB-A port.

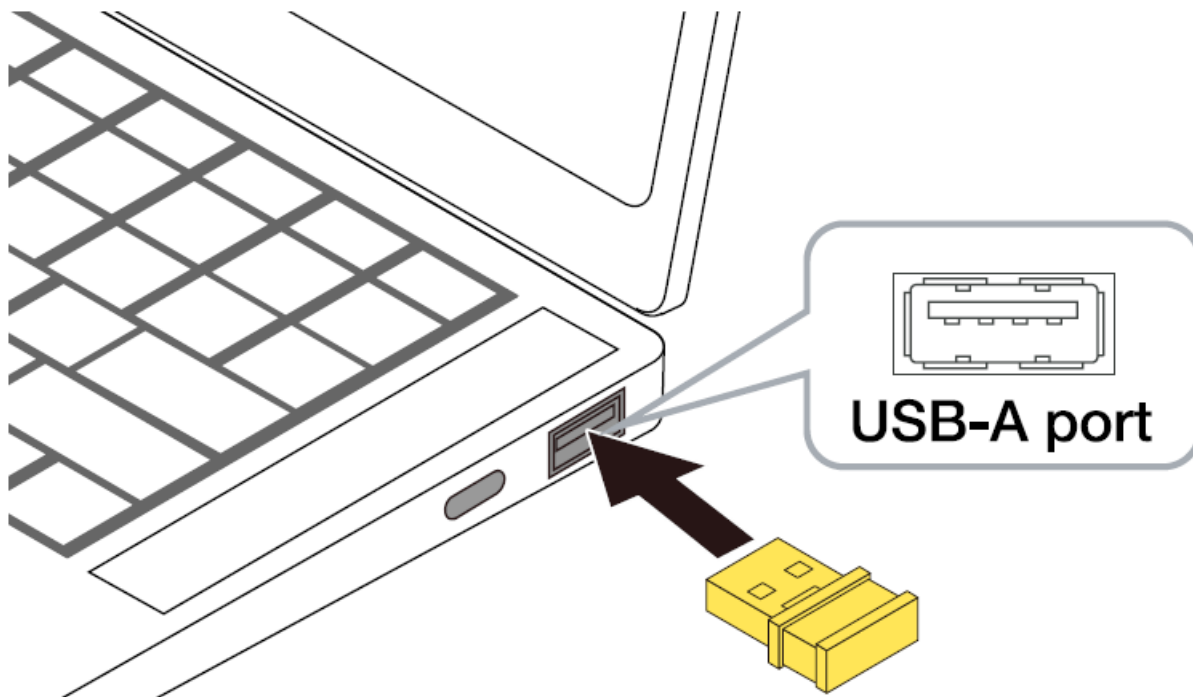

You may use any USB-A port.

For devices that do not have a USB-A port, please use a USB Type-C® hub.

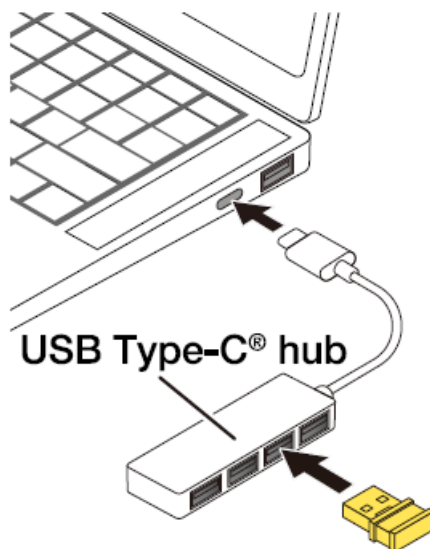

Ensure that the connector is correctly oriented to the port.

If there is strong resistance when inserting, check the shape and orientation of the connector. Forcibly inserting the connector may damage the connector, and there is a risk of injury.

Do not touch the terminal portion of the USB connector.

#### **When removing the receiver unit**

This product supports hot plugging. The receiver unit can be removed while the PC is on.

3. The driver will be automatically installed, and you will then be able to use the mouse.

You can now use the mouse.

#### **Change the mouse pointer speed**

Adjust the mouse pointer movement speed on your PC if the mouse pointer moves too fast or too slow.

1. Click on the quick settings panel on the bottom right.
2. Click on “Settings”.

The settings page will appear.

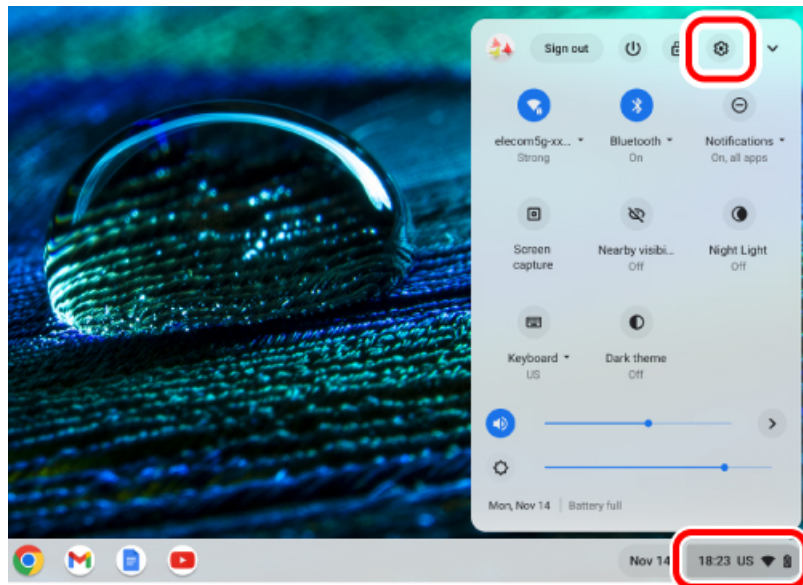

3. Click on “Mouse and touchpad” under “Device”.

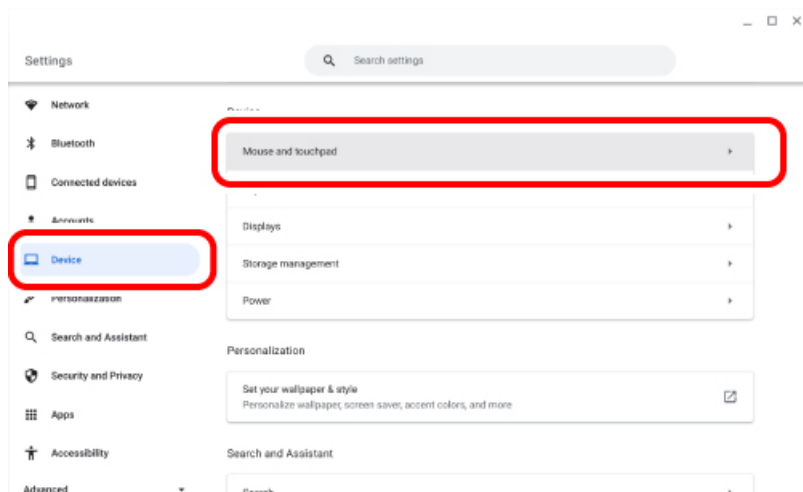

4. Adjust the “Mouse speed” slider to adjust the speed of the mouse pointer.

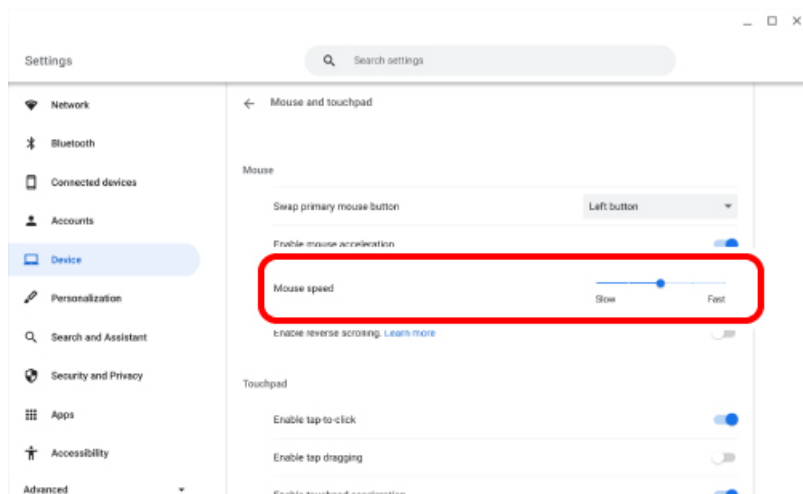

## Specifications

Compatible models	USB port-equipped Windows OS, macOS, and ChromeOS devices
Supported OS	<p>Windows 11, Windows 10, macOS Ventura (13), ChromeOS</p> <p>* Update for each new version of the OS or the installation of a service pack might be required.</p> <p>* Please see the table of supported devices for the latest information.</p>
Resolution	2000 DPI
Communication method	GFSK
Radio frequency	2.4 GHz
Radio wave range	<p>When used on magnetic surfaces such as metal desks: 3 m, When used on non-magnetic surfaces such as wooden desks: 10 m</p> <p>* These values were obtained in ELECOM's test environment and are not guaranteed.</p>
Sensor type	IR optical sensor
LED color	Blue



Buttons	3 * including wheel button
Number of wheels	1
Continuous operating time:	Approximately 657 hours
Continuous standby time	Approximately 833 days
Projected battery lifespan	Maximum duration approximately 20 months (estimated operating time when using alkaline battery)  * May vary depending on the usage conditions.
Power source	Any 1 of AA alkaline battery, AA manganese battery or AA nickel- metal hydride rechargeable battery
Rated voltage	1.5 V
External dimensions (main unit)	Approximately W 80 × L 113 × H 48 mm (Approximately W 3.1 × L 4.4 × H 1.9 inch)
External dimensions (receiver)	Approximately W 16 × D 20 × H 7 mm (Approximately W 0.6 × D 0.8 × H 0.3 inch)
Weight (main unit)	Approximately 96 g / approximately 3.4 oz (* including battery) Approximately 74 g / approximately 2.6 oz (* excluding battery)
Mass (receiver unit)	Approximately 2 g / approximately 0.07 oz
Operating environment conditions	Temperature: 5 °C to 40 °C / 41 °F to 104 °F, humidity: 90 % RH (without condensation)
Storage environment conditions	Temperature: -10 °C to 60 °C / 14 °F to 140 °F, humidity: 90 % RH (without condensation)
Accessories	AA alkaline battery for confirming operability × 1

## Troubleshooting

### When disinfecting the mouse

#### IMPORTANT

Do not spray any liquid onto the product directly.  
Doing so can cause electric malfunctions.

Never apply hot water.  
Doing so can cause electric malfunctions.

Do not use organic solvents or ultraviolet lights.  
Usage can result in deterioration of the housing components or paints, which can cause damage to the exterior.

We recommend the usage of disposable gloves.  
Please unplug the USB connector from this product and the PC.  
When using any alcohol-based products, please check that it is appropriate for the specific purpose and that it is used properly.  
Please note that in the event that damage or abnormal operation to the product is caused by the cleaning

process, the customer will be fully responsible for the cost of repair.

We recommend that you disinfect your hands before and after using PCs and peripheral devices that are used by multiple people in order to prevent the spread of infection through the equipment.

Gently soak a cleaning cloth, such as a microfiber cloth, in the disinfectant solution. Make sure there are no loose droplets and gently wipe the product using the cloth. After wiping, dry thoroughly and wipe off any residual liquid.

\* Do not spray any liquid onto the product directly. Doing so can cause electric malfunctions.

## **When the mouse is not working properly**

Try the following if the mouse operates abnormally.

### **1. Check that the mouse is turned ON.**

### **2. Check that the battery is inserted correctly or that the battery is not depleted.**

The protective film may have been left on the battery. Remove the protective film from the battery before reinserting the battery.

Ensure that the battery is inserted with the terminals in the right orientation.

The mouse operation will become unstable when the battery is low. Refer to “Replacing the battery...” and replace with a new battery as soon as possible.

The battery included with this product is only for confirming operability. The alkaline battery will discharge naturally during the distribution process of the product.

\* Turning off the power when the mouse is not used for a long period of time can extend the battery life

### **3. Change the positions of the PC and the mouse.**

This wireless device uses the 2.4 GHz band. Please use the mouse within range of the PC.

Average radio wave range

Non-magnetic surface (such as wooden desks): approximately 10 m

Magnetic surface (such as steel desks): approximately 3 m

\* These values were obtained in ELECOM's test environment and are not guaranteed. The 2.4 GHz band signal may be shorter depending on the environment you use it in.

### **4. Please reboot the PC.**

The mouse may become unstable depending on the PC. Please restart the PC.

### **5. Please update your PC's OS to the latest version.**

The mouse may become unstable when the PC version is old. Please update your PC's OS to the latest version.

### **6. Please change the connection of the receiver unit.**

Depending on the specifications of the PC's USB port or USB hub, other USB 3.0 devices used simultaneously with the mouse may generate noise that can worsen the 2.4 GHz signal in the vicinity.

Examples of USB devices that may degrade the 2.4 GHz band signal

- USB memory
- Hard disk or SSD
- Optical disk drive
- Card reader / writer
- LAN adapter
- Others, all devices communicating data with a PC via USB 3.0.

You may be able to improve the situation with the following method.

Connect the mouse receiver unit to another USB port away from other USB 3.0 devices that are simultaneously in use.



Connect the mouse receiver unit to a USB 2.0 USB hub or extension cable.

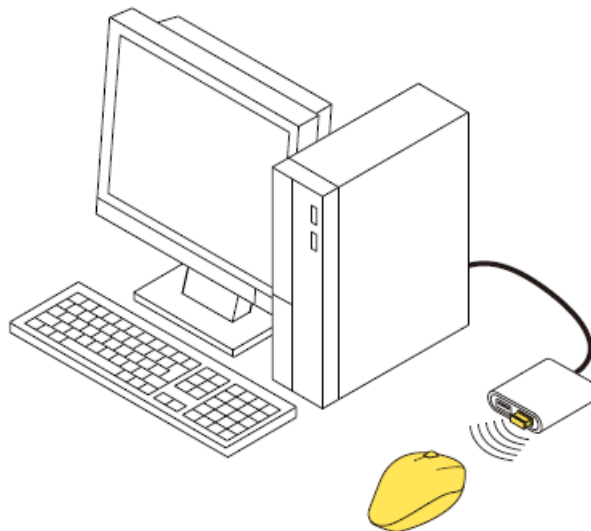

7. Check the energy saver settings on the connected device. (When using Windows® PC)

On Windows, in order to reduce power consumption depending on the PC, the power of the USB-connected product is set to turn off automatically.

You can change the settings in the following ways:

**For Windows 11**

1. Click the “Start” button at the bottom of the screen.

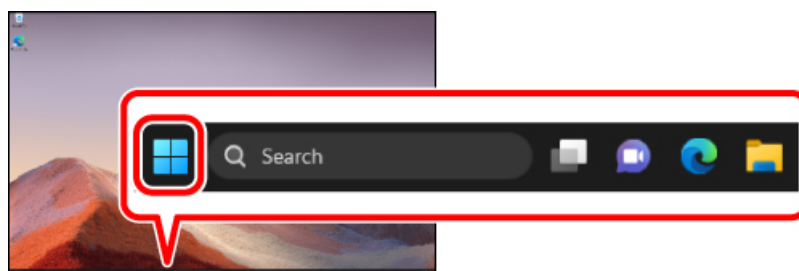

2. Click "All apps".

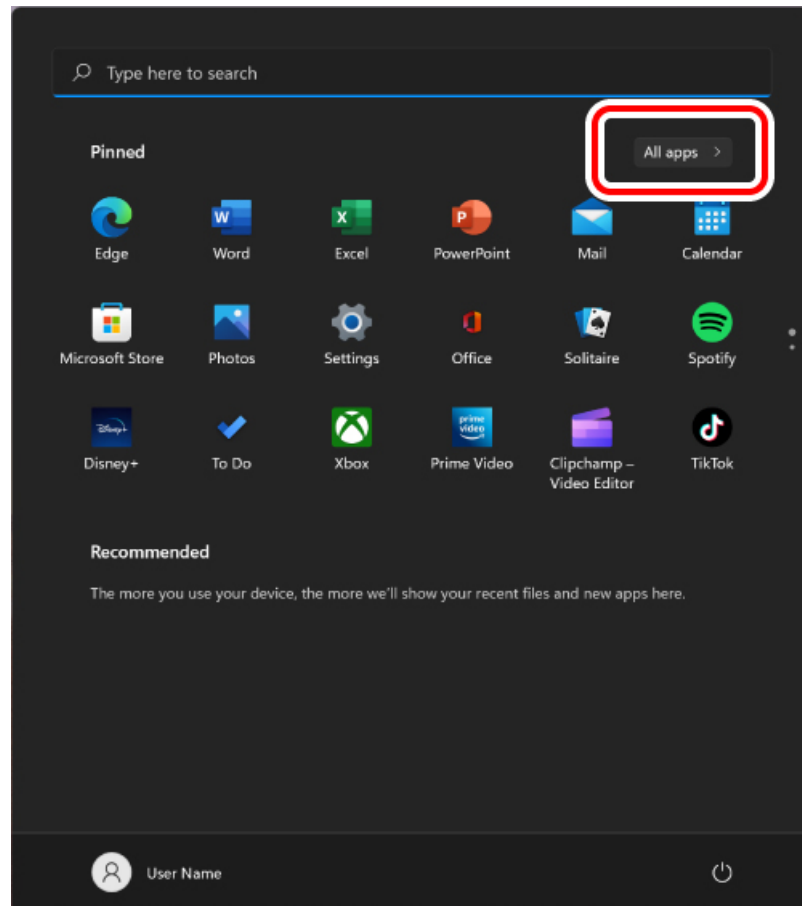

3. Click "Windows Tools".

The "Windows Tools" screen will appear.

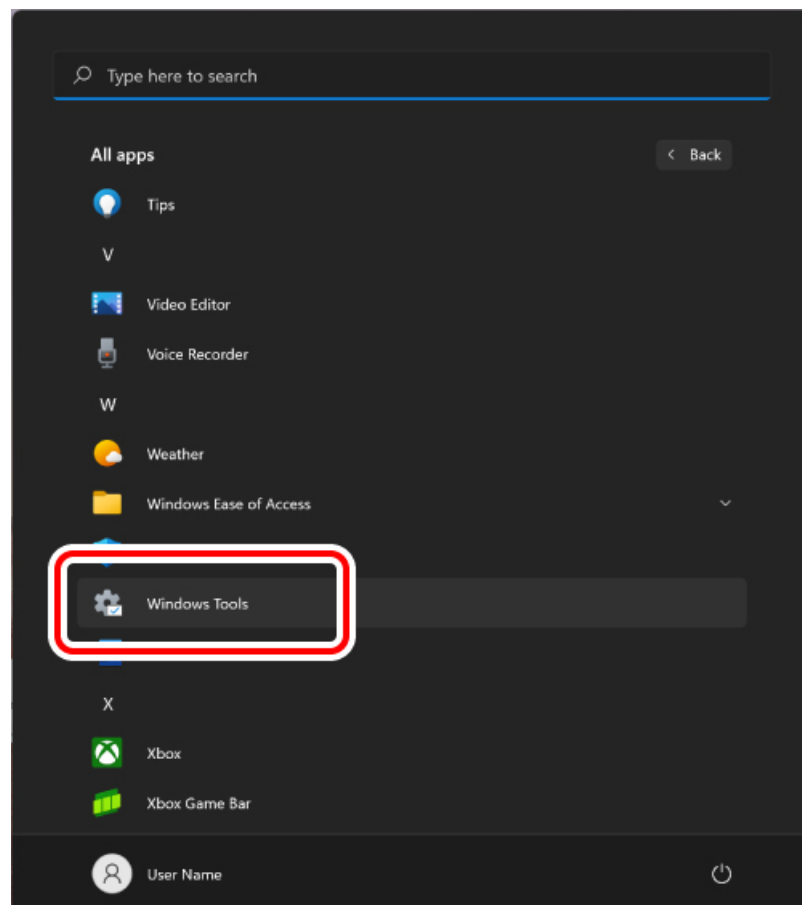

4. Double-click "Control Panel".

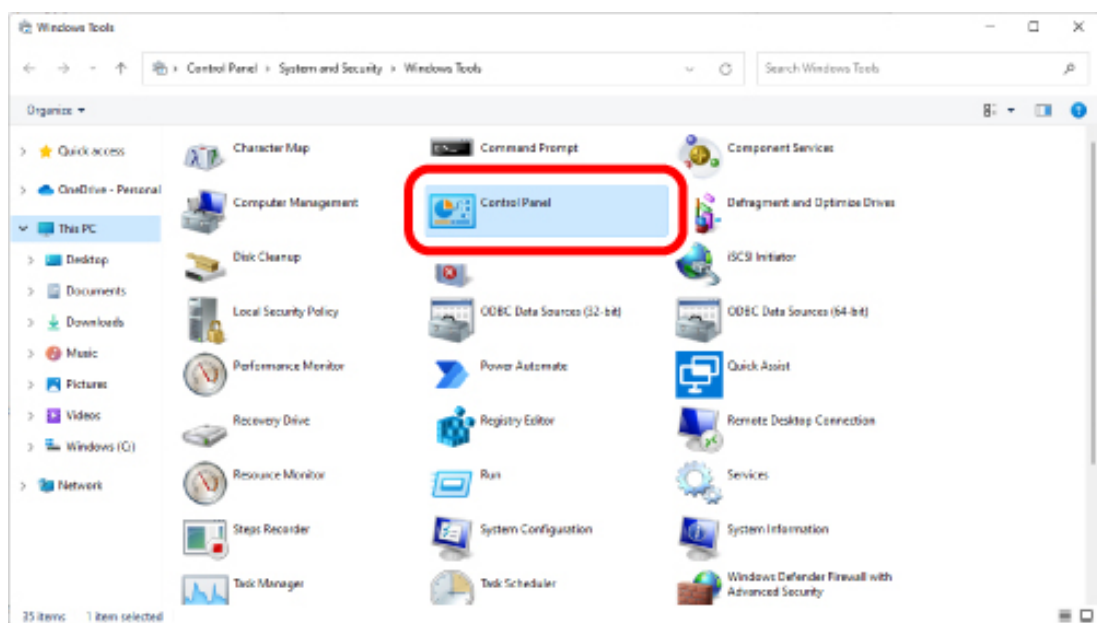

5. Click "System and Security".

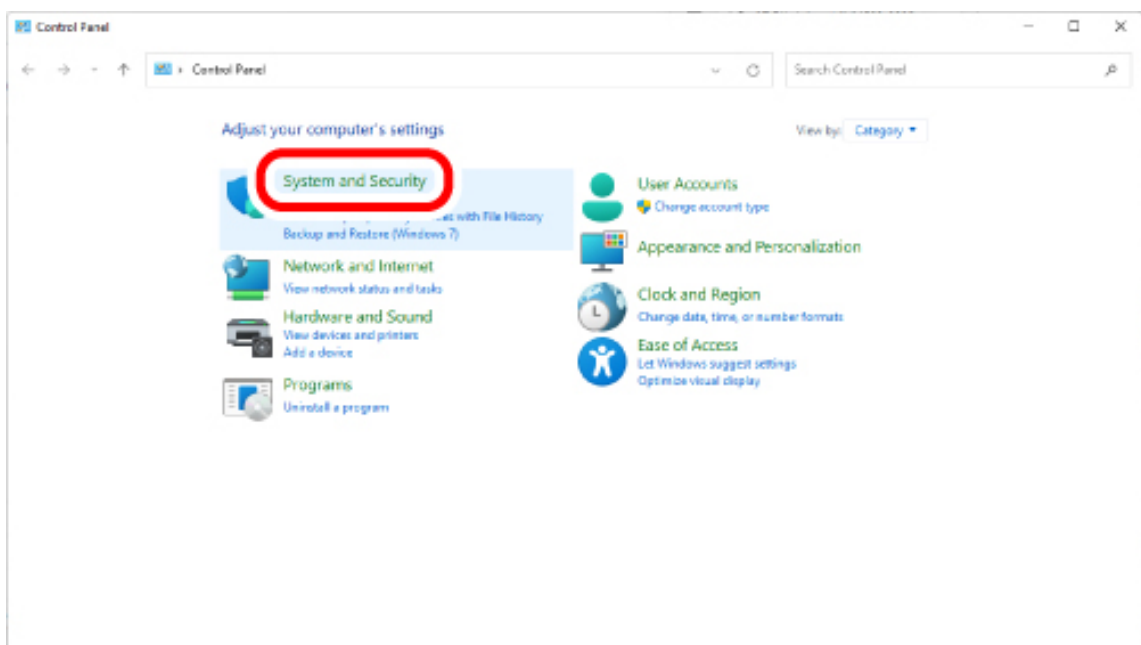

6. Click "Power Options".

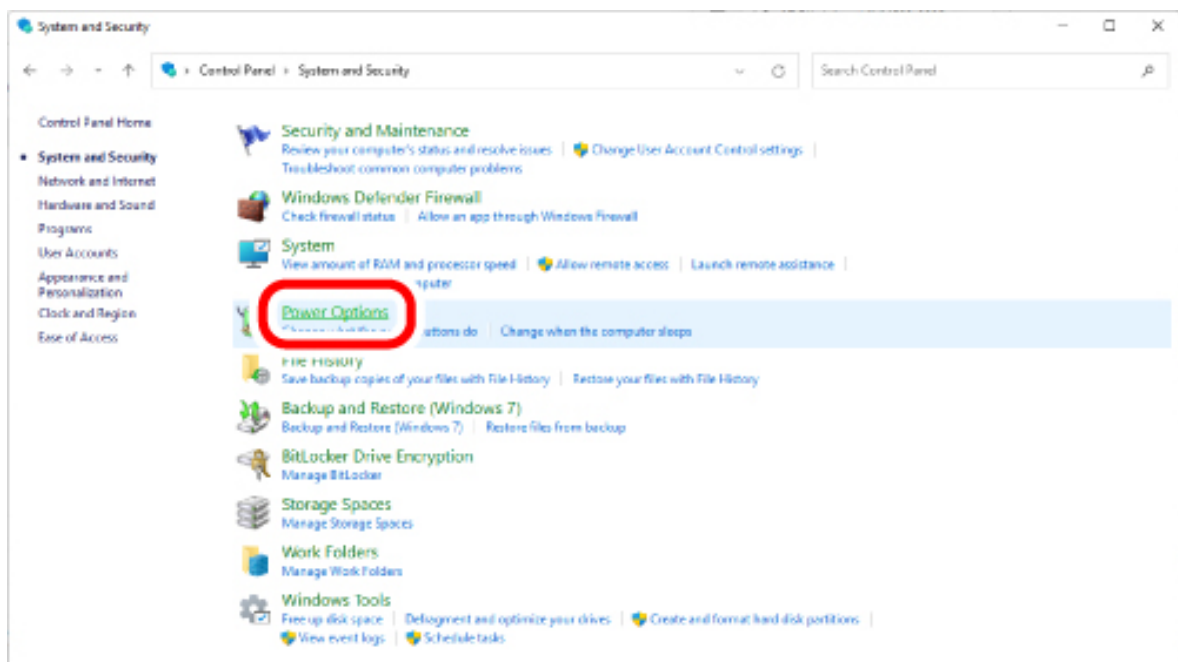

7. Click "Change plan settings" to the right of the item selected in "Power Plan".

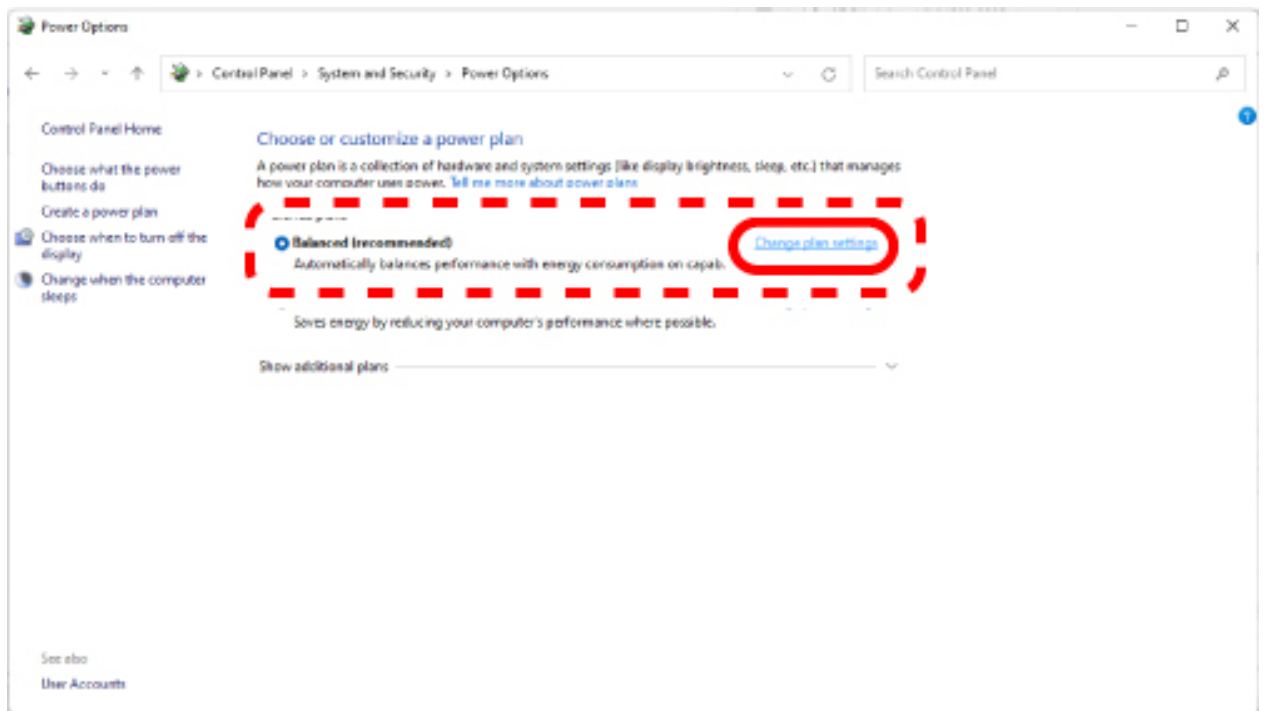

8. On the “Edit Plan Settings” screen, click “Change advanced power settings”.

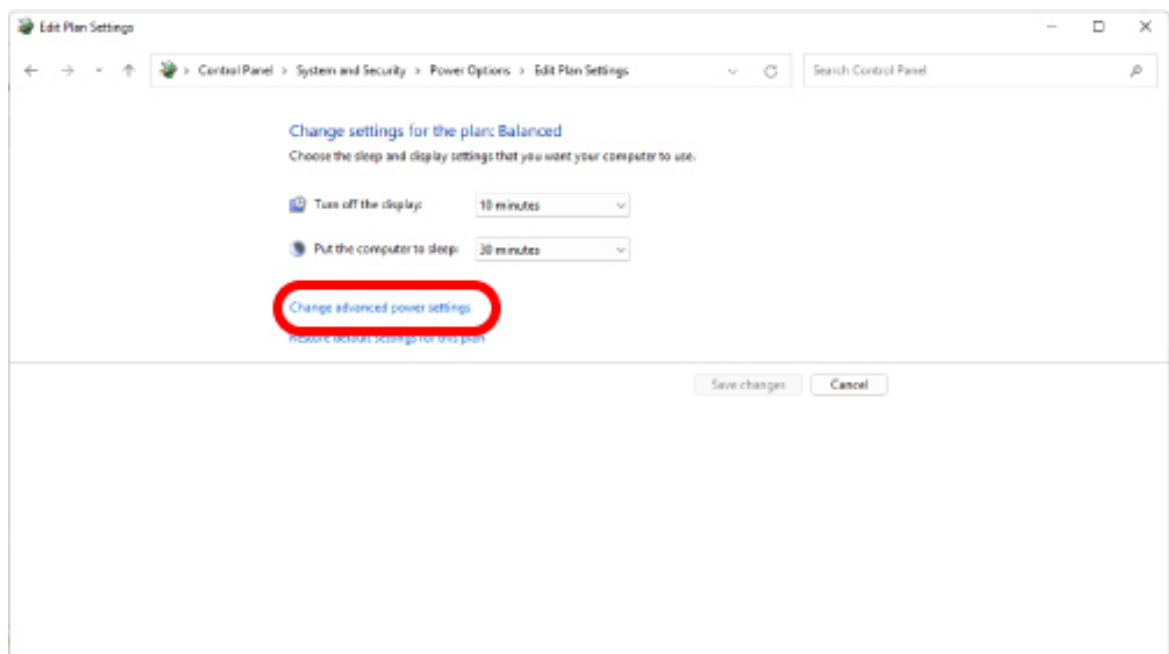

9. On the “Power Options” screen, click the “+” mark in “USB settings” from the list, and then click the “+” mark in “USB selective suspend setting”.

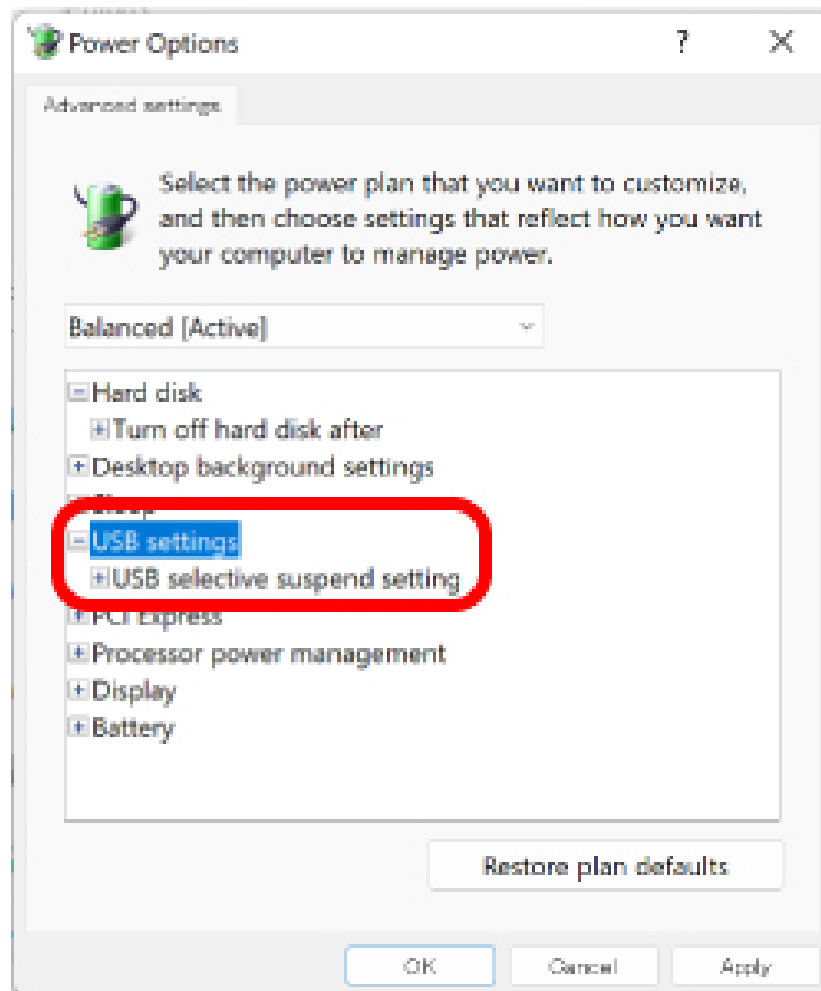

10. In the drop box next to “Setting”, select “Disabled”.

If you are using a laptop, there are two items instead of “Setting”: “On battery” and “Plugged in”. In that case, please set the “Plugged in” setting to “Disabled”.

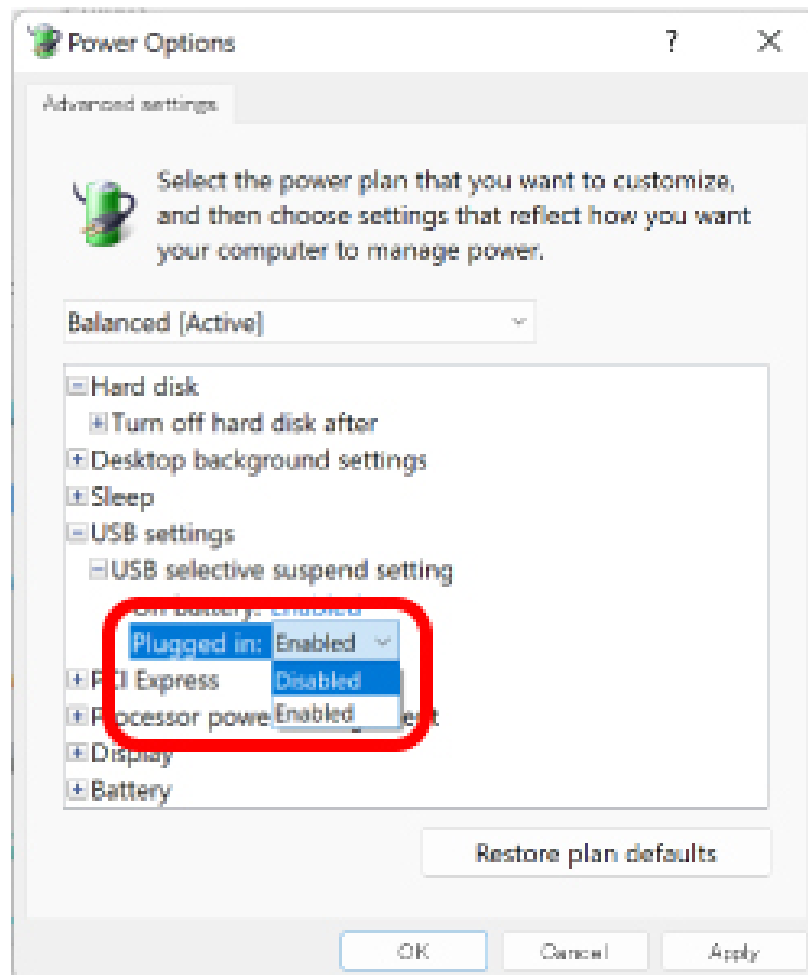

11. Click “OK” to confirm the settings.
12. Click the “X” (close) in the upper right corner to close “Edit Plan Settings”.

## For Windows 10

1. Right-click the Start button at the bottom left of the screen, click “Power Options”, and then click “Additional power settings” under “Related settings” on the right side of the “Power & sleep” screen.
2. Click “Change plan settings” on the right side of the item selected in “Power Plan”.

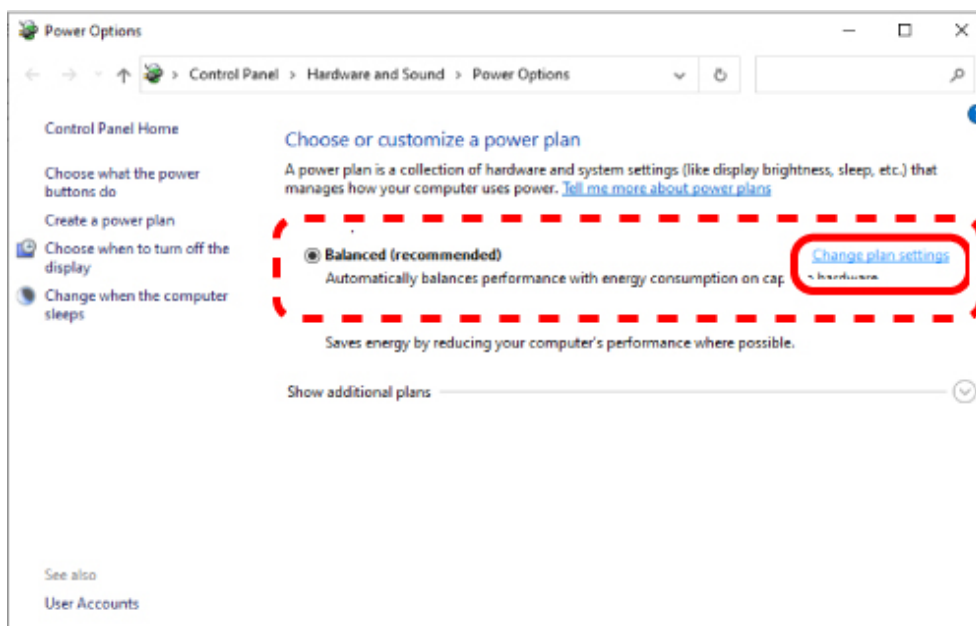

3. On the “Edit Plan Settings” screen, click “Change advanced power settings”.



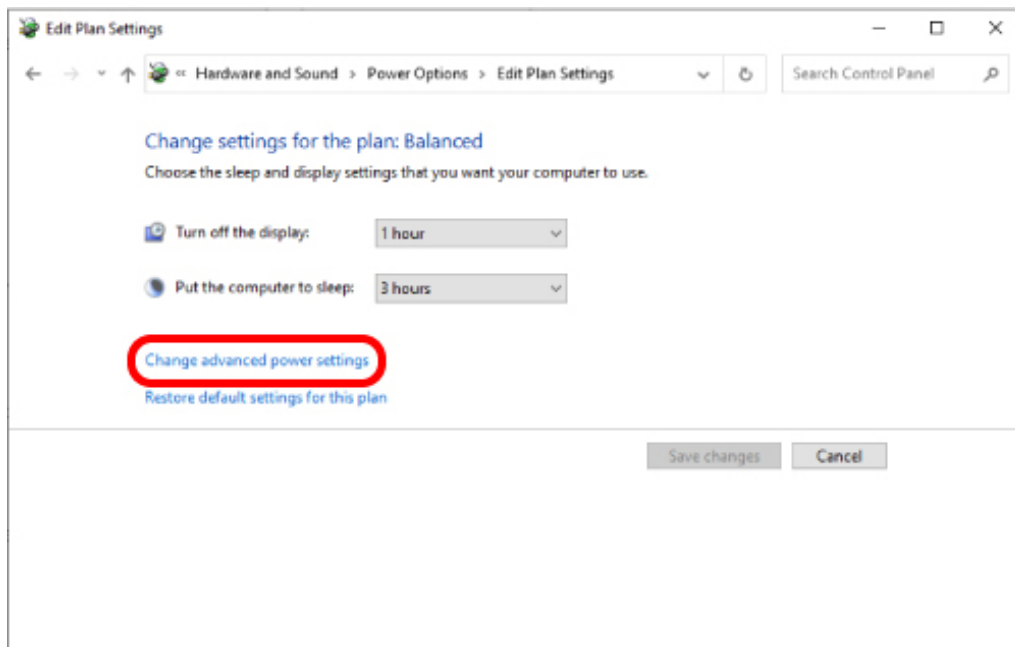

4. On the “Power Options” screen, click the “+” mark in “USB settings” from the list, and then click the “+” mark in “USB selective suspend setting”.

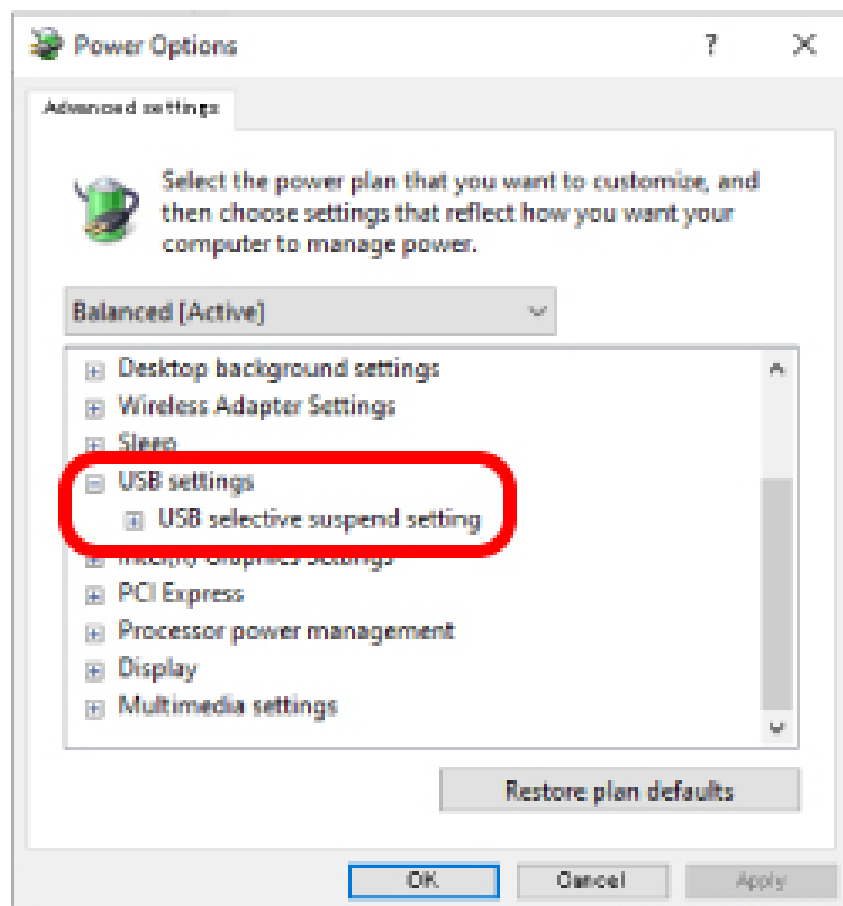

5. In the drop box next to “Setting”, select “Disabled”.  
If you are using a laptop, there are two items instead of “Setting”: “On battery” and “Plugged in”. In that case, please set the “Plugged in” setting to “Disabled”.

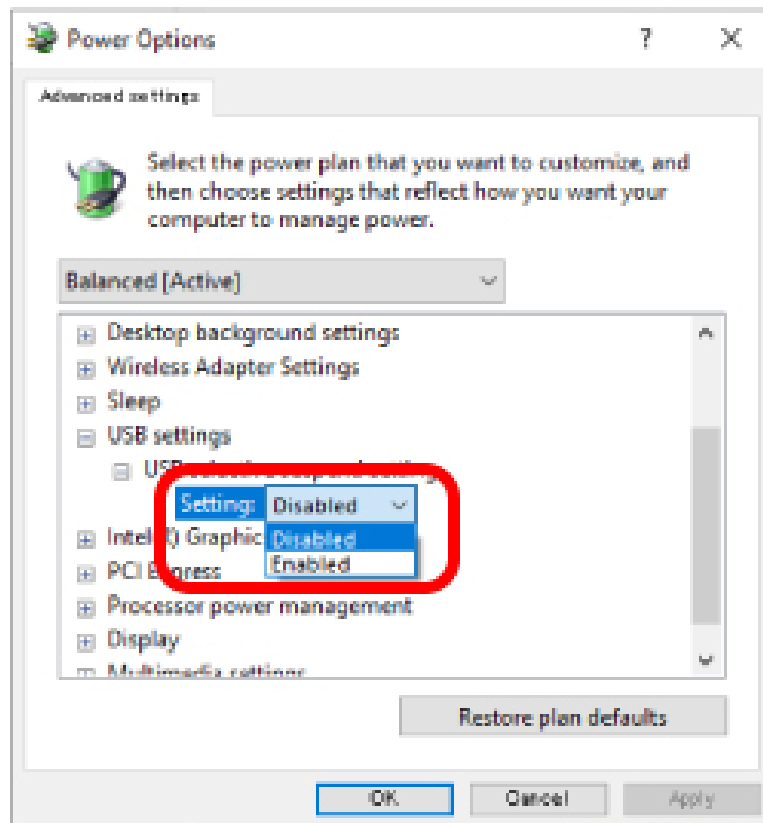

6. Click "OK" to confirm the settings.
7. Click the "X" (close) in the upper right corner to close "Edit Plan Settings".

## Compliance status

### Model

[www.elecom.co.jp/global/certification/](http://www.elecom.co.jp/global/certification/)

## Intellectual property rights

ELECOM CO., LTD. owns the copyright to this manual.

All products and company names on this product and the package are trademarks or registered trademarks of their respective owners.

Duplicating and transferring this document in part or whole is prohibited.

Windows is a registered trademark or trademark of Microsoft Corporation in the United States and/or other countries.

macOS and macOS Ventura are trademarks of Apple Inc., registered in the U.S. and other countries and regions.

Chrome and ChromeOS are trademarks of Google LLC.

## Support information

### ELECOM CO., LTD.

Fushimimachi 4-1-1, Chuo-ku, Osaka City

### Go to Global Site

### Global Support

Please contact the shop where you purchased this product if you have any feedback or questions about the contents of this manual.

Specifications and external appearance of this product may be changed without prior notice for the purpose of product improvement.

ELECOM is not responsible for any damages to, or failure of other devices caused by using this product.

The images are for illustration purposes only and may differ from your actual product.

When exporting this product, check the export regulations for the country of origin.

A customer who purchases outside Japan should contact the local retailer in the country of purchase for enquiries. In “ELECOM CO., LTD. (Japan)”, no customer support is available for enquiries about purchases or usage in/from any countries other than Japan. Also, no foreign language other than Japanese is available. Replacements will be made under stipulation of the ELECOM warranty.

Documents / Resources



[ELECOM M-SH10DBS Wireless Mouse Ergonomic Shape](#) [pdf] User Manual  
M-SH10DBS, M-SH20DBS, ELECOM01B, M-SH10DBS Wireless Mouse Ergonomic Shape, W  
ireless Mouse Ergonomic Shape, Mouse Ergonomic Shape, Ergonomic Shape

References

- [ELECOM GLOBAL](#)
- [Standards Certification - ELECOM Global |](#)
- [Support| ELECOM GLOBAL](#)
- [User Manual](#)