



ELECOM M-RT1DRBK Relaçon Handheld Trackball Mouse Instruction Manual

[Home](#) » [ELECOM](#) » ELECOM M-RT1DRBK Relaçon Handheld Trackball Mouse Instruction Manual 

ELECOM

Model: M-RT1DR/elecon9
User Manual
Wireless Trackball Mouse

Contents

- [1 Name and function of each part](#)
- [2 Documents / Resources](#)
 - [2.1 References](#)
- [3 Related Posts](#)

Name and function of each part

■ Trackball Mouse

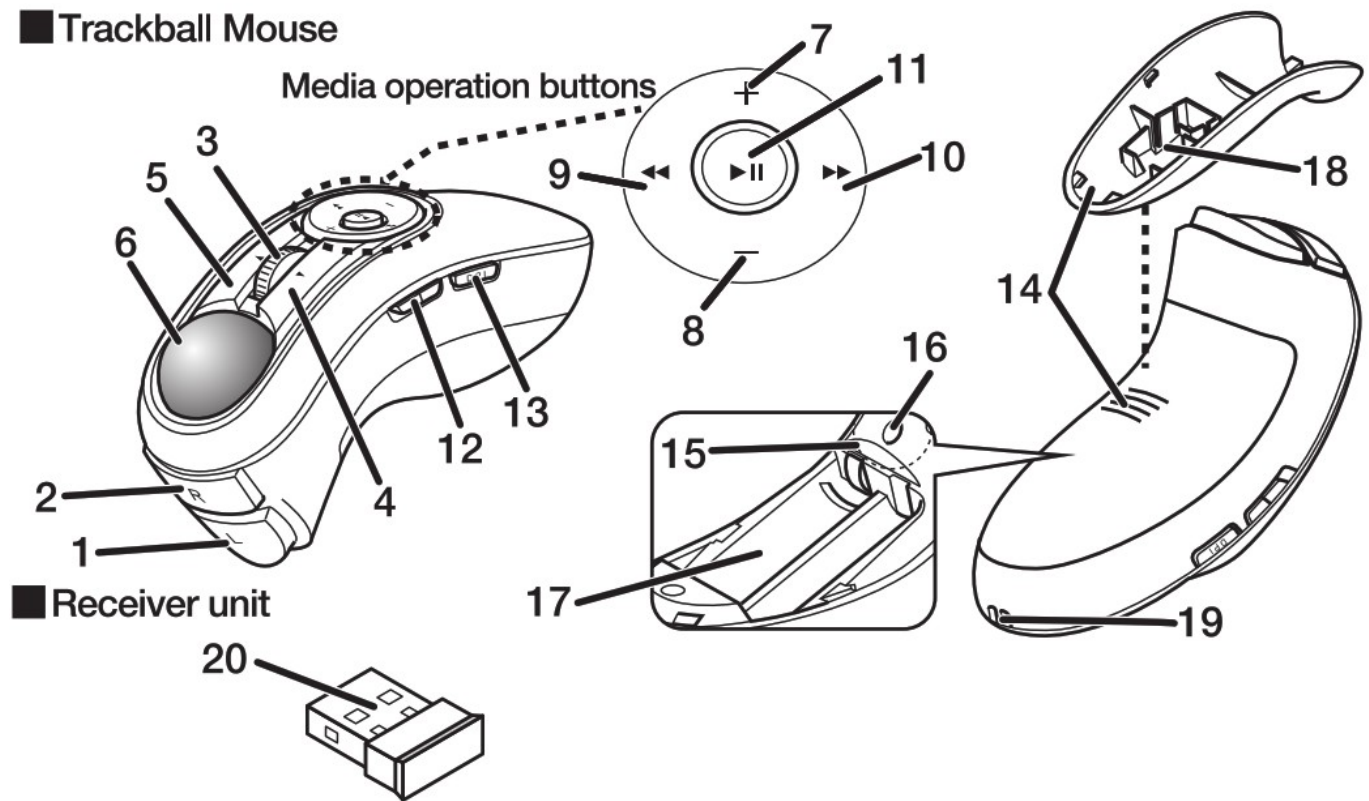

1. Left button

2. Right button

3. Wheel/Power indicator light

The LED blinks red when the battery level is low.

4. "Back" button

Operates the "Back" button on the Web browser.

5. "Forward" button

Operates the "Forward" button on the Web browser.

6. Trackball

Rotate using your fingertips to move the cursor.

7. Volume up

8. Volume down

9. Previous track

10. Next track

11. Play/pause

12. Power Switch

13. Pointer speed change button

Each time the button is pressed, the count number (movement speed of the cursor) switches between three stages.

When the count number is changed, the current count number is shown by the number of times the LED light blinks.

one blink	500 dpi
two blinks	1000 dpi
three blinks	1500 dpi

14. Battery cover
15. Optical sensor (reverse side of ball)
16. Ball removal hole
- Remove the ball to Clean the inside of the compartment.
17. Battery-storage compartment
18. Receiver unit- storage compartment
19. Strap hole
20. USB connector (male)

1. Insert the batteries

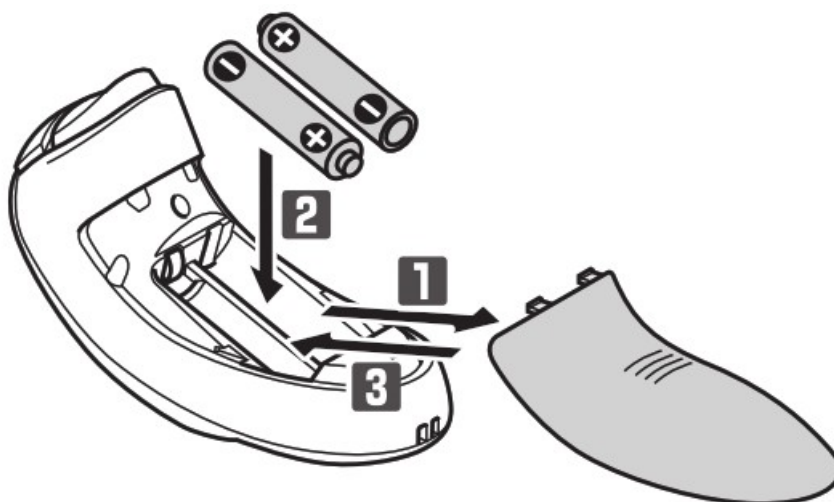

1. Remove the battery cover.
2. Insert the batteries as instructed.
- ⚠ Insert with the correct battery plus and minus orientation.
3. Re-attach the battery cover to its Original state.

2. Turning the Power On

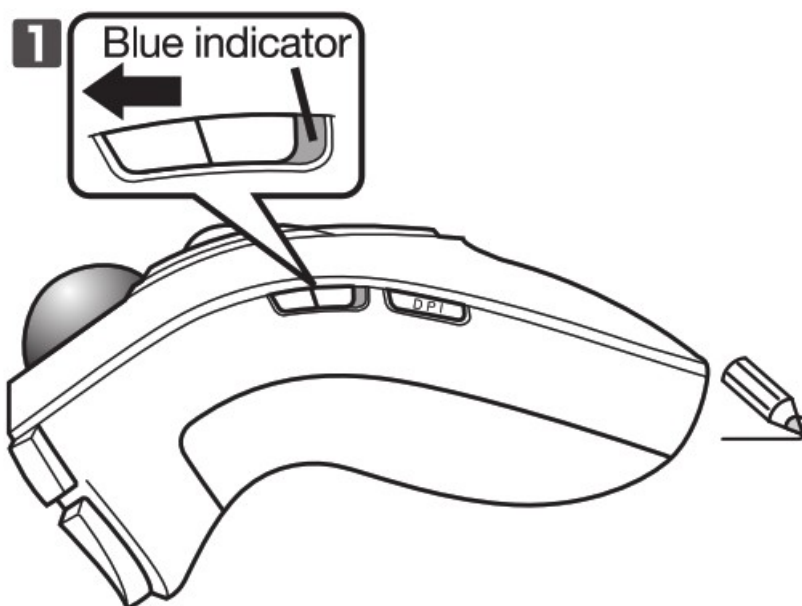

1. Slide the power switch on the side of the product to the ON position.
- Slide the switch to the left to reveal the blue indicator.
- The power indicator light will light up red for a period of time.
- * When remaining battery is low, the LED blinks red for a fixed time.

Power-saving mode

When the mouse is left untouched for a fixed period of time while the power is ON, it automatically shifts to power-saving mode. The mouse is released from the power-saving mode when it is touched.

* Mouse operation may be unstable for a few seconds after returning from the power-saving mode.

3. Connection to a PC

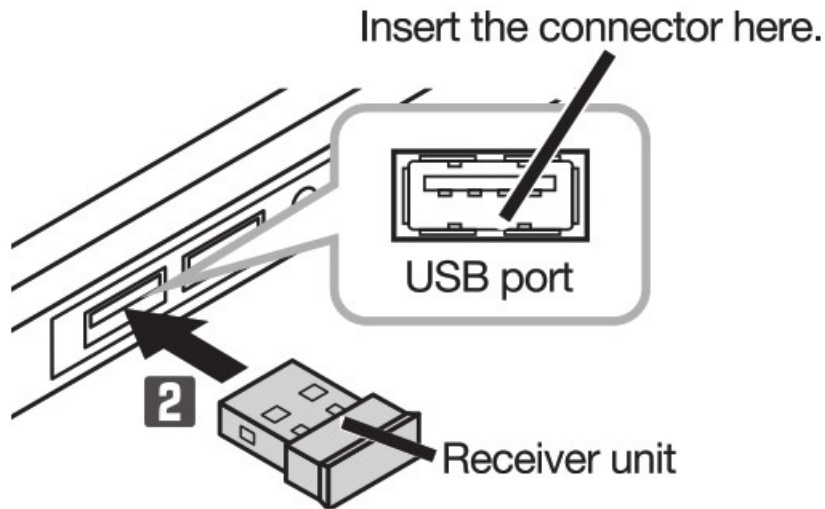

1. Start the PC.
2. Insert the receiver unit into the PC's USB port.
3. The driver will be automatically installed, and you will then be able to use the mouse.



- Ensure the correct orientation and insertion location of the connector.
- If you feel a strong resistance when inserting the USB connector, check that the shape and orientation of the connector is correct. Using excessive force may damage the connector and cause injury.
- Do not directly touch the terminal area of the USB connector.

MouseAssistant

Win <https://Awww.elecom.co.jp/1/132.htm>

Mac <https://Avwww.elecom.co.jp/1/133.html>

Download "ELECOM Mouse Assistant" from the ELECOM website to use its button assignment and high-speed scrolling functions.

ELECOM

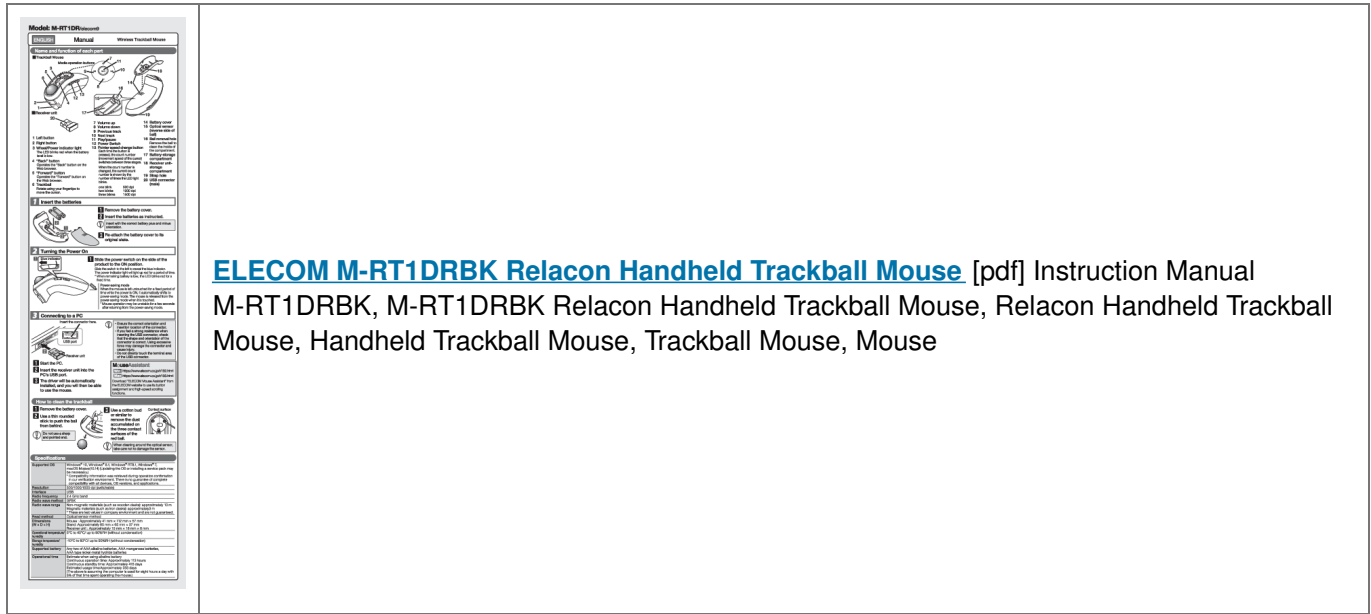

[ELECOM M-RT1DRBK Relacon Handheld Trackball Mouse](#) [pdf] Instruction Manual M-RT1DRBK, M-RT1DRBK Relacon Handheld Trackball Mouse, Relacon Handheld Trackball Mouse, Handheld Trackball Mouse, Trackball Mouse, Mouse

References

- [User Manual](#)