

ELECOM M-RT1BR Wireless Trackball Mouse



ELECOM M-RT1BR Wireless Trackball Mouse User Manual

[Home](#) » [ELECOM](#) » ELECOM M-RT1BR Wireless Trackball Mouse User Manual 

Contents

- [1 ELECOM M-RT1BR Wireless Trackball Mouse](#)
- [2 Name and function of each part](#)
- [3 Insert the batteries](#)
- [4 Turning the Power On](#)
- [5 Pairing with a PC](#)
- [6 macOS Mojave \(10.14\)](#)
- [7 Android](#)
- [8 How to clean the trackball](#)
- [9 Specifications](#)
- [10 Safety Precautions](#)
- [11 Precautions on wireless](#)
- [12 Limitation of Liability](#)
- [13 Global Support](#)
- [14 Documents / Resources](#)
 - [14.1 References](#)
- [15 Related Posts](#)

ELECOM

ELECOM M-RT1BR Wireless Trackball Mouse



Specifications

- Model: M-RT1BR
- Type: Wireless Trackball Mouse
- Resolution: 500/1000/1500 dpi
- Compatibility: Windows, macOS, Android
- Connectivity: Bluetooth

Product Usage Instructions

Inserting Batteries:

1. **Remove the battery** cover from the compartment.
2. Insert the batteries with the correct polarity.
3. Re-attach the battery cover securely.

Turning the Power On:

1. Slide the power switch on the side of the mouse to the ON position.
2. The power indicator light will turn red briefly indicating power is on.
3. The LED will blink red if battery level is low.

Pairing with a PC

For Windows

1. Click on Start, then Settings, and select Devices.
2. Select Bluetooth & other devices, then Add Bluetooth or other device.
3. Choose Bluetooth and select ELECOM Relacon from Available devices to start pairing.

For macOS

1. Go to Apple menu, System Preferences, then Bluetooth & other devices.
2. Select Add Bluetooth or other device, choose Bluetooth and pair with ELECOM Relacon.

For Android

1. Open Settings, click on Connected devices, then Pair new device.
2. Hold down the pairing button on the mouse for 5 seconds until the battery light blinks red.
3. Select ELECOM Relacon to pair with your Android device.

Frequently Asked Questions (FAQ)

Q: How do I clean the trackball?

A: To clean the trackball, remove it using the ball removal hole and clean the inside of the compartment gently with a soft cloth.

Model: M-RT1BR

Name and function of each part

1. Left button
2. Right button
3. Wheel/Power indicator light
The LED blinks red when the battery level is low.
4. "Back" button
Operates the "Back" button on the Web browser.
5. "Forward" button
Operates the "Forward" button on the Web browser.
6. Trackball
Rotate using your fingertips to move the cursor.
7. Volume up
8. Volume down
9. Previous track
10. Next track
11. Play/pause
12. Power Switch
13. Pointer speed change button/Pairing button
Each time the button is pressed, the count number (movement speed of the cursor) switches between three stages.
When the count number is changed, the current count number is shown by the number of times the LED light

blinks.

- one blink 500 dpi
- two blinks 1000 dpi
- three blinks 1500 dpi
- Pair the mouse with your device's Bluetooth® module or a Bluetooth® adapter.

14. Battery cover

15. Optical sensor (reverse side of ball)

16. Ball removal hole Remove the ball to clean the inside of the compartment.

17. Battery-storage compartment

18. Strap hole

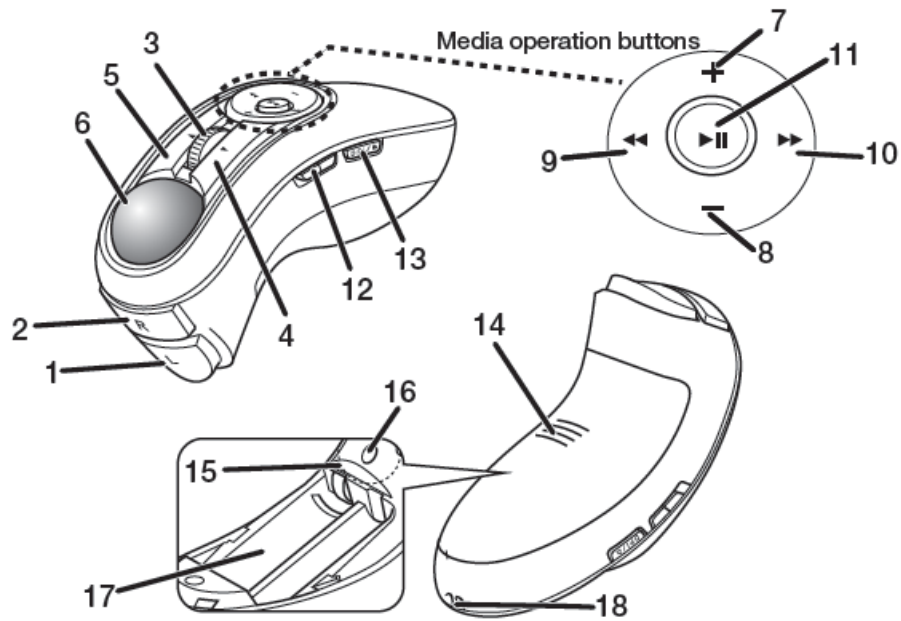

MouseAssistant



Win <https://www.elecom.co.jp/r/132.html>

Mac <https://www.elecom.co.jp/r/133.html>

Download "ELECOM Mouse Assistant" from the ELECOM website to use its button assignment and high-speed scrolling functions.

* Windows® RT 8.1 and Andriod are not supported by the "ELECOM Mouse Assistant".

Win <https://www.elecom.co.jp/r/132.html>

Mac <https://www.elecom.co.jp/r/133.html>

Insert the batteries

1.

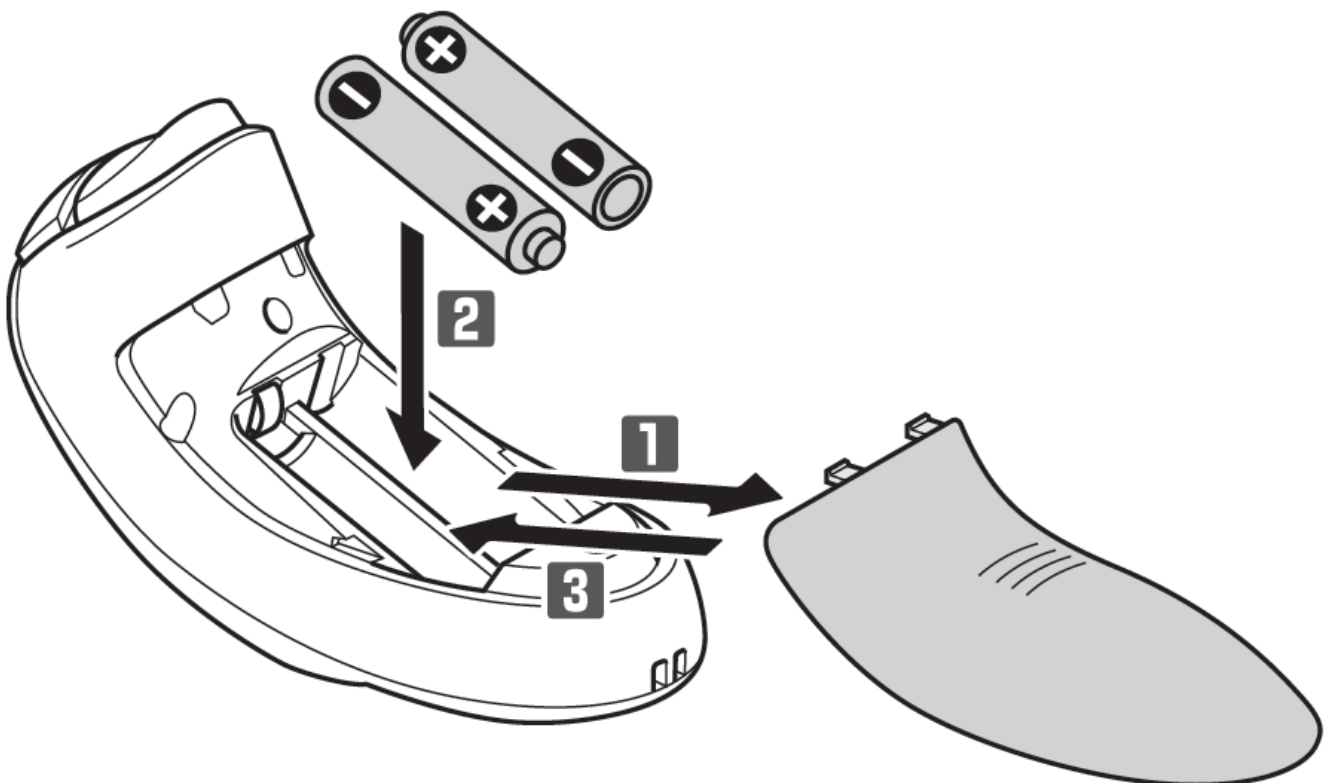

Remove the battery cover.

2. Insert the batteries as instructed.



Insert with the correct battery plus and minus orientation.

3. Re-attach the battery cover to its original state.

Turning the Power On

1. Slide the power switch on the side of the product to the ON position.
 - Slide the switch to the left to reveal the blue indicator.
 - The power indicator light will light up red for a period of time.
 - When remaining battery is low, the LED blinks red for a fixed time.

Power-saving mode

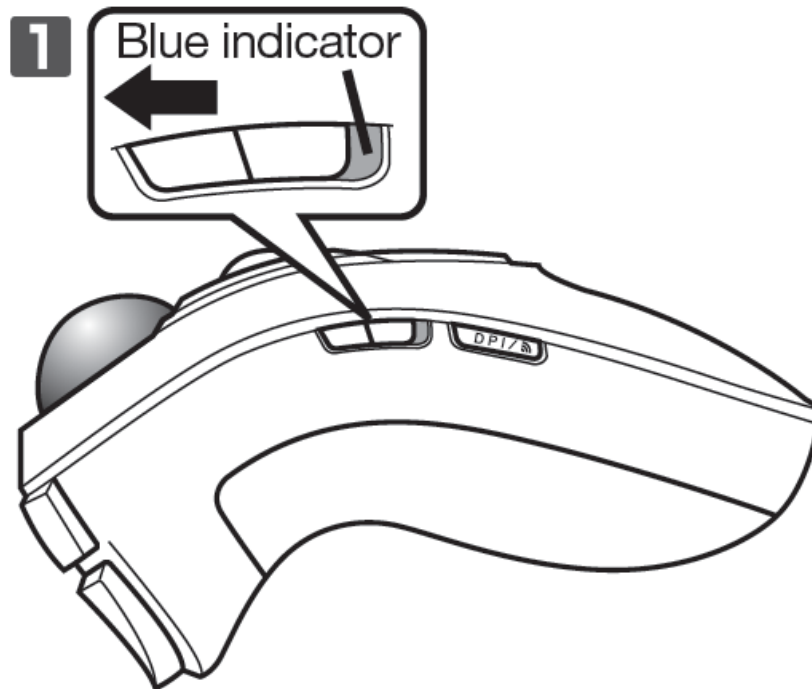

When the mouse is left untouched for a fixed period of time while the power is ON, it automatically shifts to power-saving mode. The mouse is released from the power-saving mode when it is touched.

- Mouse operation may be unstable for a few seconds after returning from the power-saving mode.



Pairing with a PC

- Pairing involves registering Bluetooth® devices (in this case, this product and your device) with each other, and authorizing a connection between them.
- This section covers Windows® and Macintosh standard Bluetooth functions. Depending on your device or Bluetooth® adaptor, unique Bluetooth® functions may be used. Please read the respective manuals for each function. Please carry out the pairing operation using your current mouse or touchpad on your device.

Windows® 10



If your computer does not support Bluetooth® 4.0 or if you have upgraded from Windows® 8.1 or Windows® 7, please use a Bluetooth® adapter compatible with Bluetooth® 4.0

1. Click on the “Start”  button on the lower left of the screen, and click on the “Settings”  icon.



Click on “Devices” on the “Windows Settings” screen.

2. **Click on “Devices”.**

The “Devices” page will appear.

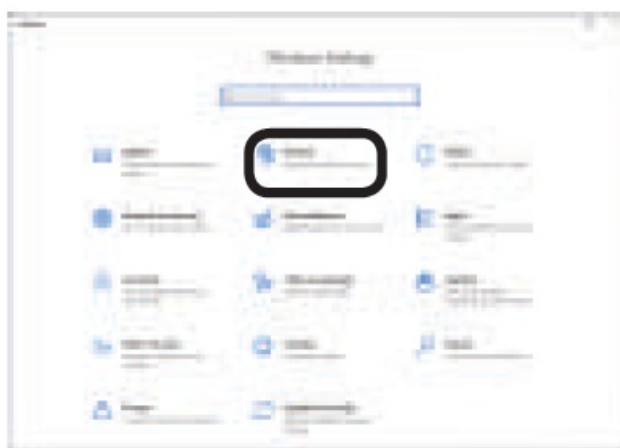

3. Click on “Bluetooth & other devices”, and click on “Add Bluetooth or other device”.

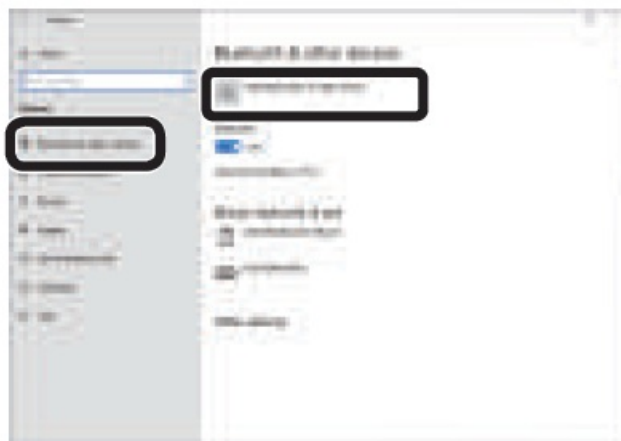

4. Click “Bluetooth”.

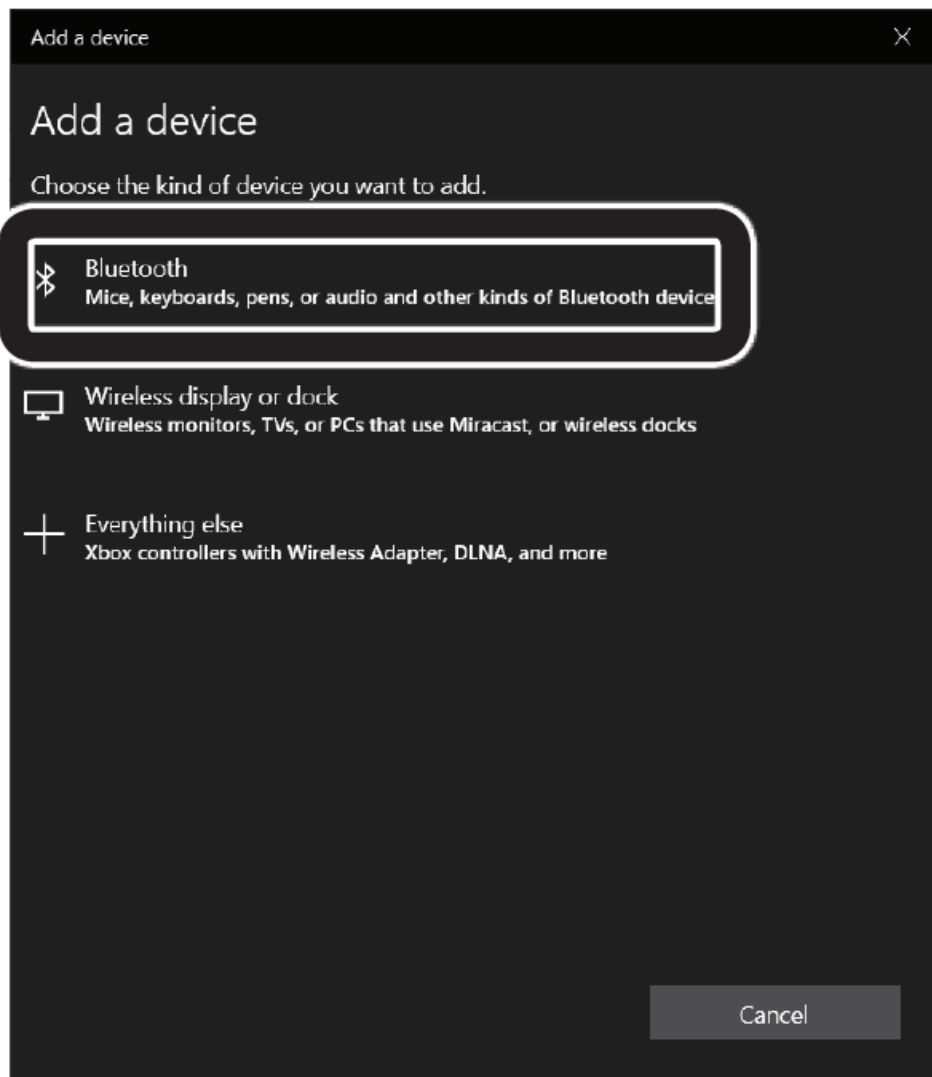

5. When the “Add a Pairing button device” page appears, hold down the pairing button on the side of the product for] around 5 seconds, and then release.

Pairing button

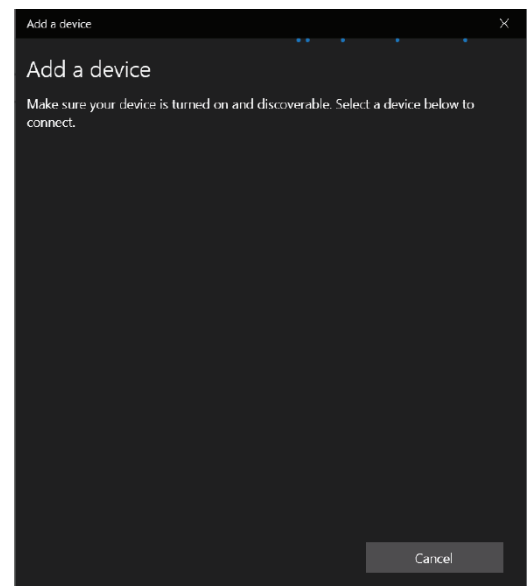
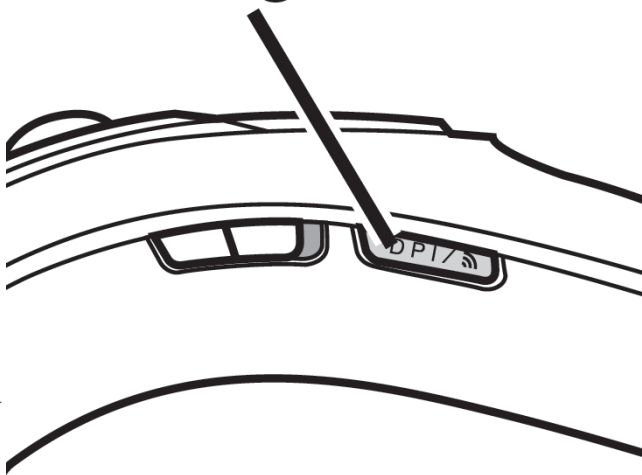

The product will be in pairing mode and the battery indicator light will blink red.

6. Click “ELECOM Relacon”.

Start pairing.

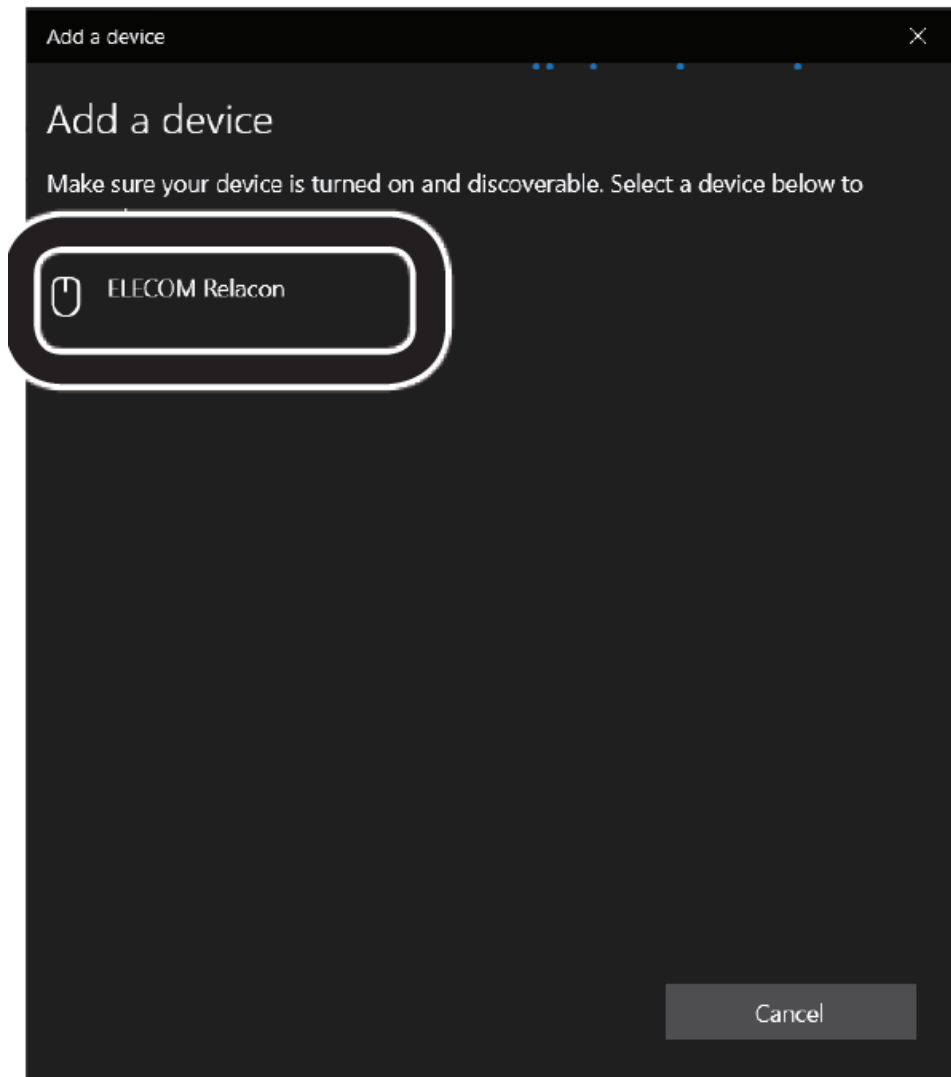

7. When it changes to "Connected", click on "Done".

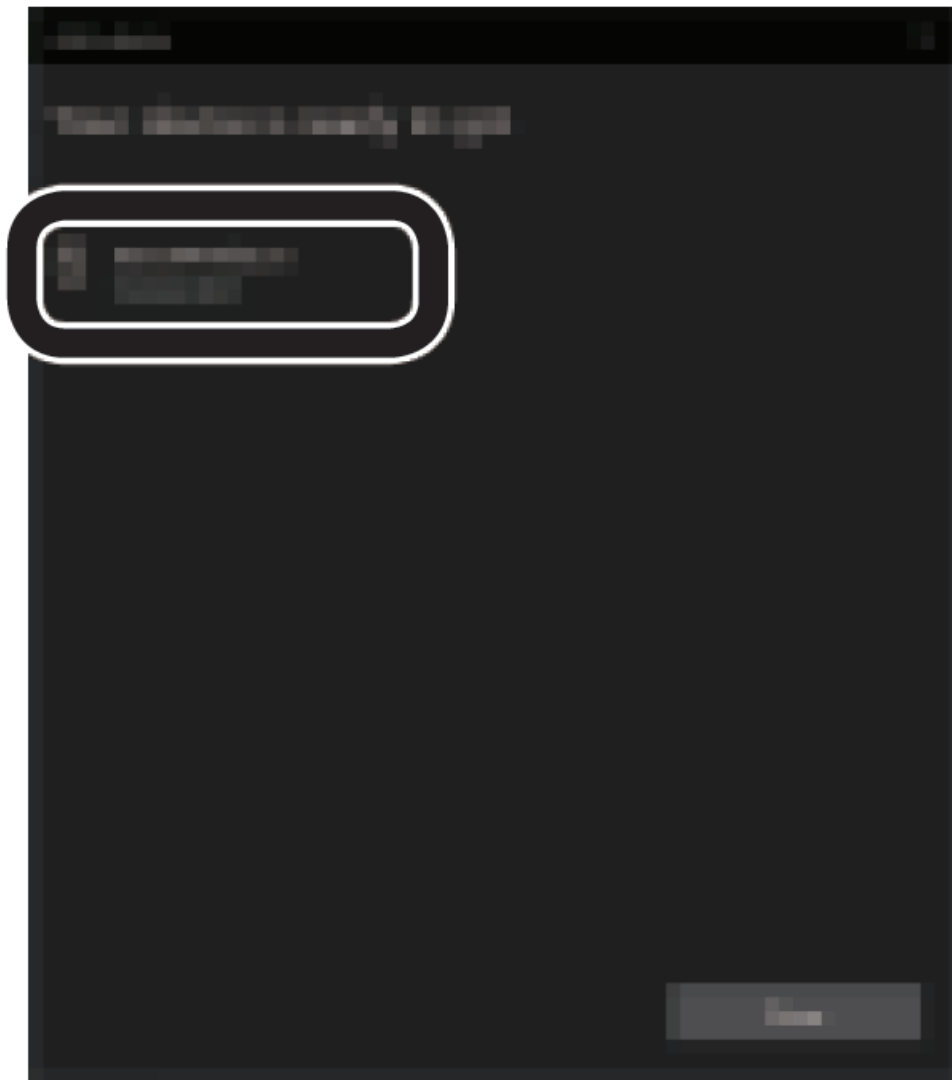

8. This product is added to "Mouse, keyboard, & pen", displays "Connected " and pairing is complete.

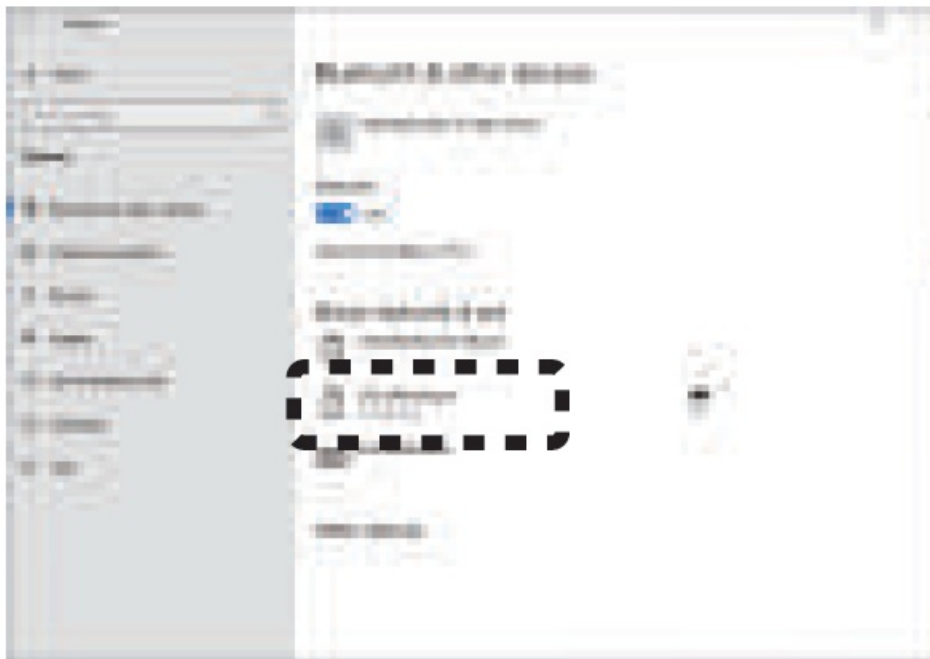

Windows® 7

Please purchase an adapter compatible with Bluetooth 4.0 compatible with Windows 7 that you can purchase in your region. For the pairing method, please refer to the instruction manual for the Bluetooth® adapter compatible with Bluetooth 4.0.(* We cannot take responsibility for its operation)

Hint for pairing

Select “ELECOM Relacon” from the list of devices.

macOS Mojave (10.14)

Can only be used for Macintosh compatible with Bluetooth 4.0.

1. From the Apple menu, click “System Preferences...” to display the system environment settings screen.

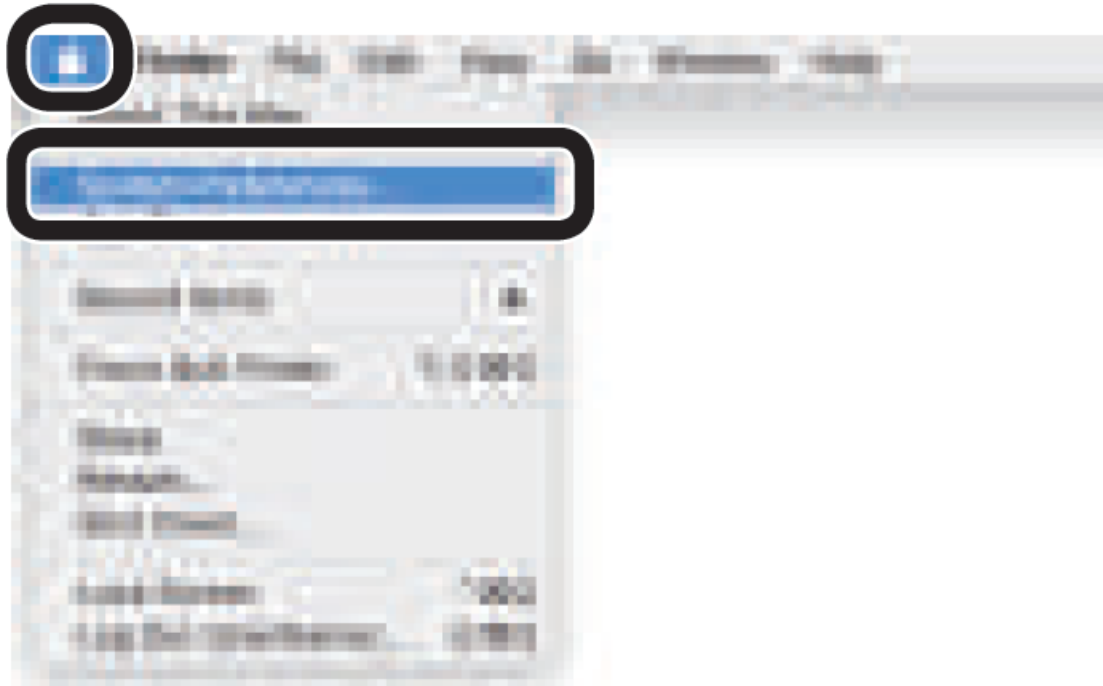

2. Click “Bluetooth” to display the “Bluetooth” environment settings screen.

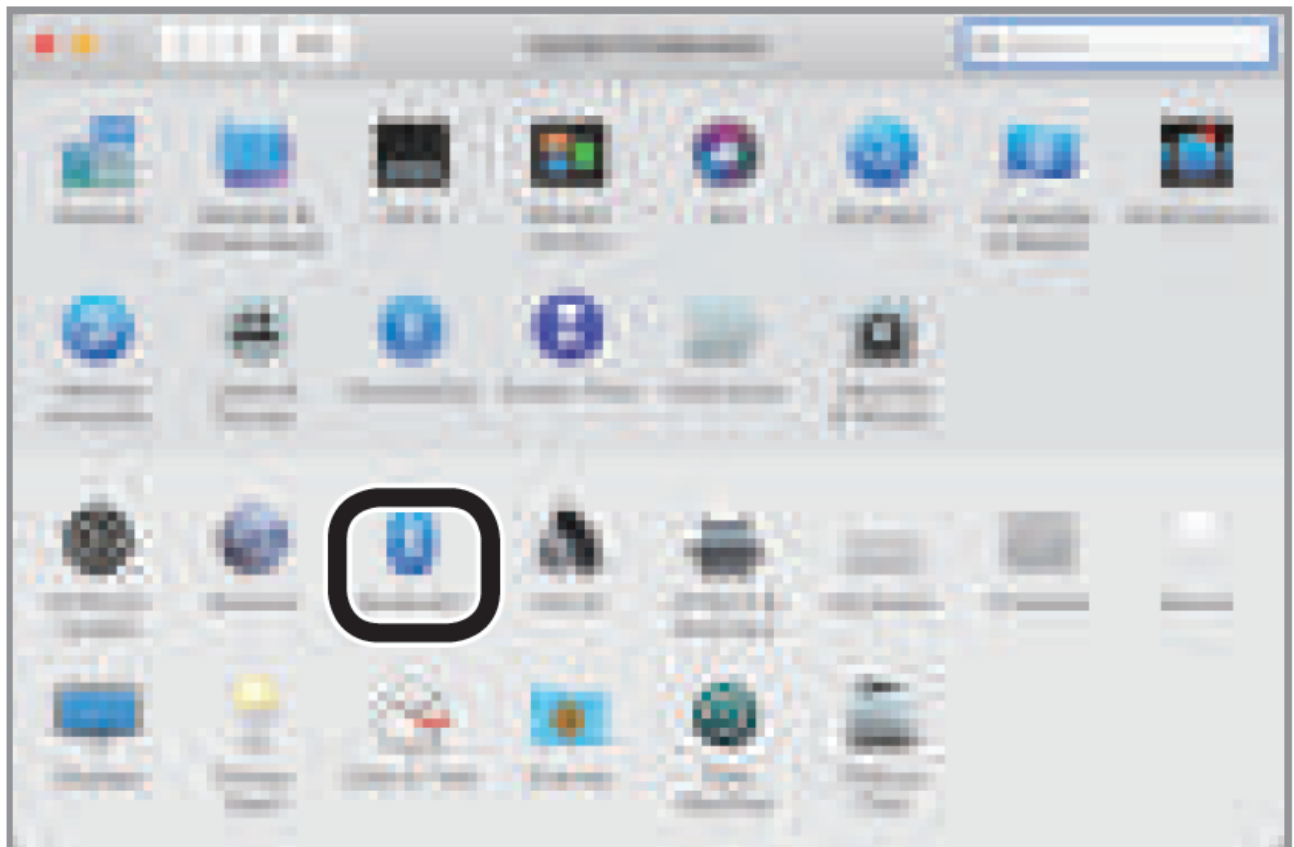

3. During device search, hold down the pairing button on the side of the product for around 5 seconds, and then release.

Pairing button

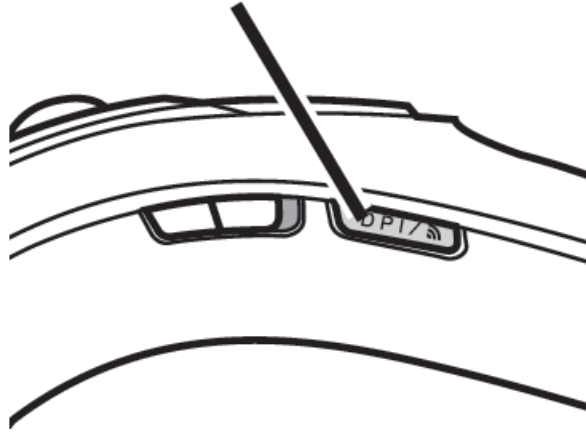

The product will be in pairing mode and the battery indicator light will blink red.

4. Select "ELECOM Relacon", and click "Connect" to start pairing.



5. When it changes to "Connected", pairing is completed.



Android

Instructions for Pixel 3 (Android 9) are as follows.

1. Open “Settings” on your device.

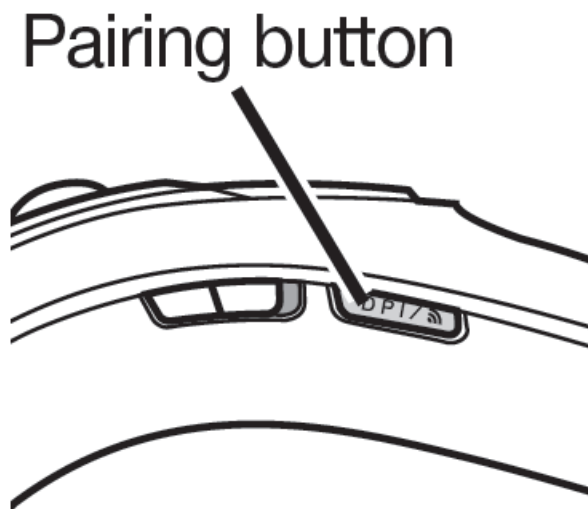

2. Hold down the pairing button on the side of the product for around 5 seconds, and then release.
The product will be in pairing mode and the battery indicator light will blink red.
3. Tap on “Connected devices”

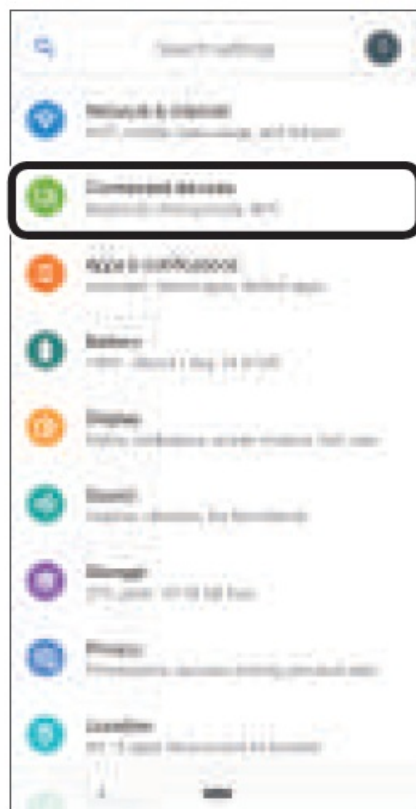

4. Tap on “Pair new device”

The Bluetooth will turn ON automatically if it is OFF.

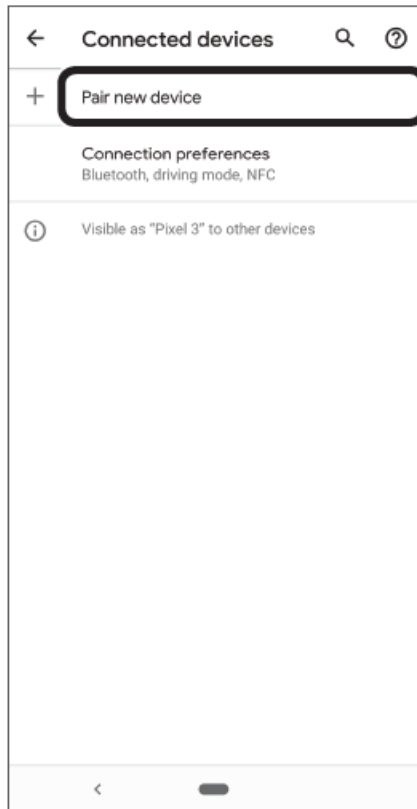

5. Select "ELECOM Relacon" from "Available devices" and tap on the display. Pairing will begin automatically.

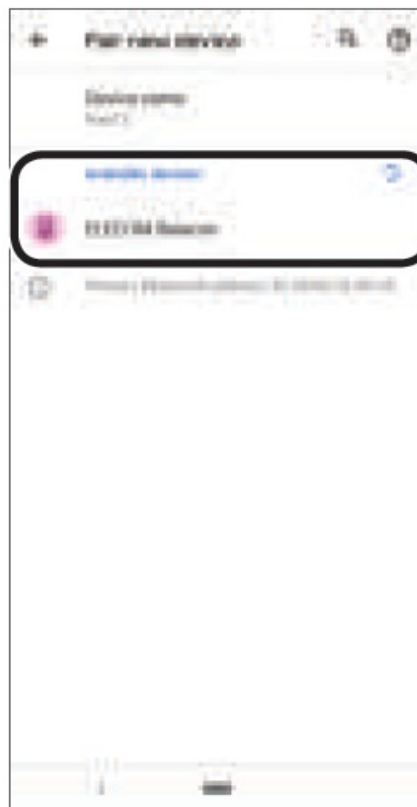

6. When pairing is complete, "ELECOM Relacon" will appear under "Connected devices".



If pairing fails, delete “ELECOM Relacon” from “Available devices”. Turn OFF the Bluetooth on your device and switch off the power on this product before attempting the pairing again.

How to clean the trackball

1. Remove the battery cover.
2. Use a thin rounded stick to push the ball from behind.



Do not use a sharp and pointed end.

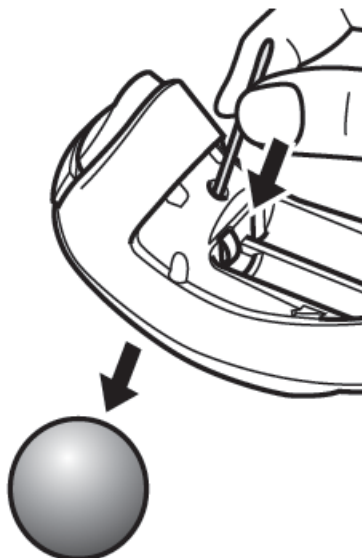

3. Use a cotton bud or similar to remove the dust accumulated on the three contact surfaces of the red ball.

Contact surface

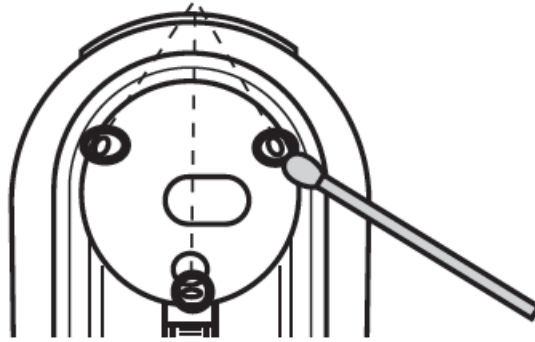

When cleaning around the optical sensor, take care not to damage the sensor.

Specifications

Supported OS	Windows® 11, Windows® 10, Windows® 8.1, Windows® RT8.1, Windows® 7, macOS Mojave(10.14), Android 6.0 or above (Updating the OS or installing a service pack may be necessary.) * Compatibility information was retrieved during operation confirmation in our verification environment. There is no guarantee of complete compatibility with all devices, OS versions, and applications.
Resolution	500/1000/1500 dpi (switchable)
Compatible Bluetooth versions	Bluetooth®4.0 (Bluetooth® low energy)
Compatible standard	Bluetooth 4.0 Class2
Supported Profile	HOGP (HID Over GATT Profile)
Radio frequency	2.4 GHz band
Radio wave method	GFSK
Radio wave range	Non-magnetic materials (such as wooden desks): approx. 10m/33ft Magnetic materials (such as iron desks): approx. 3m/10ft * These are test values in company environment and are not guaranteed.

Read method	Optical sensor method
Dimensions (W × D × H)	Mouse : <ul style="list-style-type: none"> • Approx. 41 x 112 x 57 mm/1.61 x 4.41 x 2.24 in Stand : <ul style="list-style-type: none"> • Approx. 65 x 65 x 37 mm/2.56 x 2.56 x 1.46 in
Operational temperature/humidity	Temperature: 5 °C to 40 °C / 41 °F to 104 °F, humidity: up to 90 % RH (without condensation)
Storage temperature/ humidity	Temperature: -10 °C to 60 °C / 14 °F to 140 °F, humidity: up to 90 % RH (without condensation)
Supported battery	Any two of AAA alkaline batteries, AAA manganese batteries, AAA type nickel-metal hydride batteries
Operational time	<ul style="list-style-type: none"> • Estimate when using alkaline battery Continuous operation time: Approximately 107 hours Continuous standby time: Approximately 76 days • Estimated usage time: <ul style="list-style-type: none"> • Approximately 127 days • (The above is assuming the computer is used for eight hours a day with 5% of that time spent operating the mouse.)

Safety Precautions

- Prohibited action
- Mandatory action
- Situation that needs attention

WARNING

If a foreign object (such as water or a metal chip) enters the product, immediately stop using the product and remove the battery. If you continue to use the product under these conditions, it may cause a fire or electric shock. If this product behaves abnormally, such as by generating heat or smoke, or giving off strange smells, cease usage immediately and shut down the connected device. After confirming that the product is not generating heat that will cause burns, remove the batteries from the product. After doing so, contact the retailer from whom you purchased the product. If you continue to use the product under these conditions, it may cause a fire or electric shock.

Please do not drop or hit the product. In the event that the product is damaged, cease usage immediately. Turn OFF the power and remove the batteries. Please contact your dealer after that. Fires or electric shocks may occur if the product is used when damaged.

- Do not attempt to disassemble, modify or repair this product by yourself, as this may cause a fire, electric shock or product damage.
- Do not put this product in fire, as the product may burst, resulting in a fire or injury.

CAUTION

- Do not place this product in any of the following environments:

- In a car exposed to sunlight, a place exposed to direct sunlight, or a place that becomes hot (such as around a heater)
- In a moist place or a place where condensation may occur
- In an uneven place or a place exposed to vibration
- In a place where a magnetic field is generated (such as near a magnet)
- In a dusty place
- This product does not have a waterproof structure. Use and store this product in a place where the product body will not be splashed with water or other liquid. Rain, water mist, juice, coffee, steam or sweat may also cause product damage.
- Only use this product with PCs and video game systems.
- Do not use this product with any device that may significantly be affected in the case of this product malfunctioning.
- When you no longer need to use this product and the battery, be sure to dispose of them in accordance with the local ordinances and laws of your area.

Batteries

- For this product, use AAA alkaline battery, AAA manganese battery, or AAA type nickel-metal hydride rechargeable battery.
- When not using this product for long periods of time, remove the battery. This may cause fluid leak or malfunction.
- Do not mix different types of batteries together or old batteries with fresh ones. Doing so may cause battery leakage and failure.

Cleaning the Product

- If the product body becomes dirty, wipe it with a soft, dry cloth.
Use of a volatile liquid (such as paint thinner, benzene, alcohol) may affect the material quality and color of the product.V

Precautions on wireless

- This product is a wireless device that can use the entire 2.4 GHz band, and is able to avoid the mobile entity identification device range. The GFSK method is adopted as the radio wave method, and the interference distance is 10m.

The 2.4 GHz band is also used in medical devices, Bluetooth® and wireless LAN devices of the IEEE 802.11b/11g/11n standards.

Before using this product, check whether “other wireless stations*” are not operating nearby.

In the unlikely event that radio interference occurs between this product and “other wireless stations*”, change the location of use or stop using this product.

Other wireless stations” refer to industrial, scientific, medical instruments which use the same 2.4 GHz as this product, as well as other wireless stations of the same type, such as in-house mobile entity identification wireless stations requiring a license, specific low power wireless stations and amateur wireless stations not

requiring a license, used in plant production lines.

WARNING

- Do not use in equipment which may cause serious effects due to it malfunctioning. In rare cases, it may be affected by radio waves of the same frequency or radio waves of mobile phones from outside, causing a malfunction, deterioration in operation, or stop working.
- Do not use this product in places where radio wave usage is prohibited, such as hospitals. Radio waves of this product may affect electronic devices and medical devices (for example pacemakers).
- Due to the possibility of hindering safe navigation of aircraft, use of wireless mice in aircraft is prohibited by the Civil Aeronautics Act. Turn off the power of the wireless mice before boarding and do not ever use after boarding.
- Please note that we can not assume any responsibility, even if events such as an accident or social damage occur due to a failure of this product.

Limitation of Liability

In no event will ELECOM Co., Ltd be liable for any lost profits or special, consequential, indirect, punitive damages arising out of the use of this product.

ELECOM Co., Ltd will have no liability for any loss of data, damages, or any other problems that may occur to any devices connected to this product.

Compliance status <https://www.elecom.co.jp/global/certification/>

FCC ID: YWO-M-RT1BR

This device complies with Part 15 of the FCC Rules. Operation is subject to the following two conditions:

1. this device may not cause harmful interference, and
2. this device must accept any interference received, including interference that may cause undesired operation.

NOTE; This equipment has been tested and found to comply with the limits for a Class B Digital Device, pursuant to part 15 of the FCC Rules. These limits are designed to provide reasonable protection against harmful interference in a residential installation. This equipment generates, uses and can radiated radio frequency energy and, if not installed and used in accordance with the instruction, may cause harmful interference to radio communication. However, there is no grantee that interference will not occur in a particular installation. If this equipment does cause harmful interference to radio or television reception, which can be determined by tuning the equipment off and on, the user is encouraged to try to correct the interference by one or more of the following measures:

- Reorient or relocate the receiving antenna.
- Increase the separation between the equipment and receiver.
- Connect the equipment into an outlet on a circuit different from that to which the receiver is connected.
- Consult the dealer or an experienced radio/TV technician for help.

NOTICE: The manufacture is not responsible for any radio or TV interference caused by unauthorized modification to this equipment. Such modifications could void the user's authority to operate the equipment. In order to make improvements to this product, the design and specifications are subject to change without prior notice.

Responsible party

ELECOM USA, Inc.
4041 MacArthur Blvd Suite 400,
Newport Beach, CA 92660 USA elecomusa.com

Xin tham khảo theo hiện trạng tuân thủ RoHS: www.elecom.co.jp/global/certification/

**WEEE Disposal and Recycling Information**

This symbol means that waste of electrical and electronic equipment (WEEE) should not be disposed as general household waste. WEEE should be treated separately to prevent possible harm to the environment or human health. Consult your retailer or local municipal office for collection, return, recycle or reuse of WEEE.

European Authorized
Representative :

VISHTEC Ltd

3rd floor office 5, Plovdiv 2 Liuben
Karavelov bul, 4002 Bulgaria
compliance@vish-tec.com

**Trademark and name of the manufacturer:**

ELECOM CO., LTD.
Fushimimachi 4-1-1, Chuo-ku, Osaka City www.elecom.co.jp/global/

- Unauthorised copying and/or reproducing of all or part of this manual is prohibited.
- The specifications and appearance of this product may be changed without prior notice for product improvement purposes. When exporting this product, check the export regulations for the country of origin.
- The Bluetooth® word mark and logos are registered trademarks owned by Bluetooth SIG, Inc. and any use of such marks by ELECOM CO., LTD. is under license.
- Windows is a trademark of the Microsoft Corporation.
- macOS, Mojave, and Macintosh are trademarks of Apple Inc., registered in the U.S. and other countries.
- Company names, product names, and other names in this manual are either trademarks or registered trademarks.

Global Support



<https://www.elecom.co.jp/r/s536>

A customer who purchases outside Japan should contact the local retailer in the country of purchase for enquiries. In “ELECOM CO., LTD. (Japan)”, no customer support is available for enquiries about purchases or usage in/from any countries other than Japan. Also, no language other than Japanese is available. Replacements will be made under stipulation of the Elecom warranty.

Wireless Trackball Mouse

Manual, Safety precautions, and Compliance with regulations 2nd edition, February 27, 2024

©2024 ELECOM Co., Ltd. All Rights Reserved.

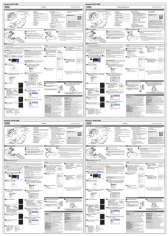

Documents / Resources

	<p>ELECOM M-RT1BR Wireless Trackball Mouse [pdf] User Manual</p> <p>M-RT1BR Wireless Trackball Mouse, M-RT1BR, Wireless Trackball Mouse, Trackball Mouse, Mouse</p>
---	---

References

- [E ELECOM USA](#)
- [TEC - Residential and Business Internet and Voice](#)
- [ELECOM GLOBAL](#)
- [E ELECOM USA](#)
- [ELECOM GLOBAL](#)
- [Standards Certification - ELECOM Global | _____](#)
- [_____](#)
- [_____](#)
- [_____](#)
- [User Manual](#)

Manuals+. Privacy Policy

This website is an independent publication and is neither affiliated with nor endorsed by any of the trademark owners. The "Bluetooth®" word mark and logos are registered trademarks owned by Bluetooth SIG, Inc. The "Wi-Fi®" word mark and logos are registered trademarks owned by the Wi-Fi Alliance. Any use of these marks on this website does not imply any affiliation with or endorsement.