



ELECOM M-CC2BRS Bluetooth Mouse Instruction Manual

[Home](#) » [ELECOM](#) » ELECOM M-CC2BRS Bluetooth Mouse Instruction Manual 

ELECOM

M-CC2BRS Bluetooth Mouse
Instruction Manual

Contents

- 1 Names and functions of each part
- 2 Using the mouse
- 3 Storing the mouse
- 4 Specifications
- 5 Safety Precautions
- 6 Cautions for Wireless Equipment
- 7 Limitation of Liability
- 8 Documents / Resources
 - 8.1 References
- 9 Related Posts

Names and functions of each part

Mouse

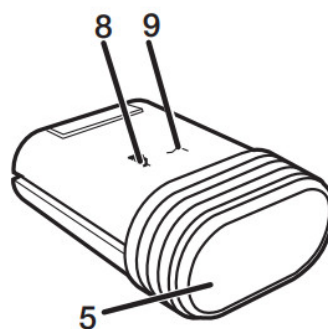
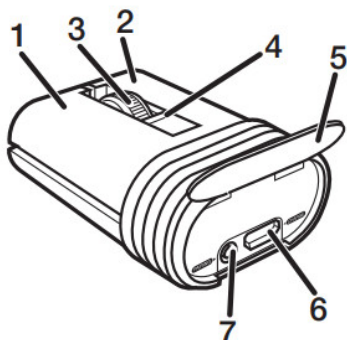

Cap with clip

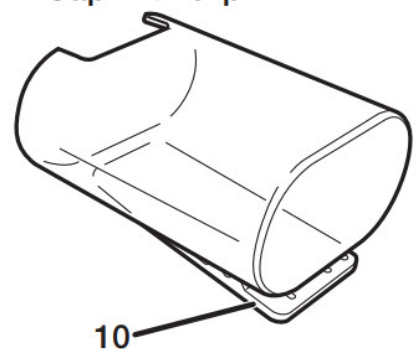

<p>1 Left button 2 Right button 3 Wheel 4 LED light</p> <ul style="list-style-type: none"> • Blinks in red when in pairing standby mode • Turns on in red when charging • Turns on in red for a fixed period of time when the power turns on 	<ul style="list-style-type: none"> • Blinks in red when the remaining battery charge is low <p>7 Pairing button 6 Micro USB connector for charging 5 Connector cover 8 Power switch 9 Optical sensor 10 Clip</p>
---	---

Using the mouse

1. Attach the cap to the rubber part on the rear of the mouse.

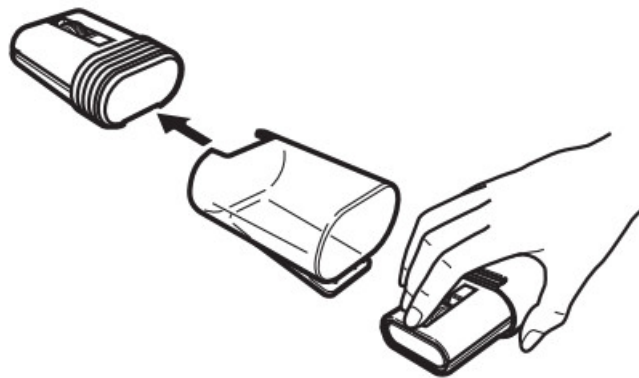

Storing the mouse

1. Store the mouse in the cap.

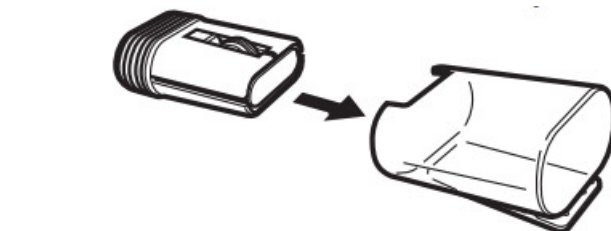

You can carry the mouse around with you by clipping it onto an item such as a bag, a breast pocket, or a PC.

Charging

1. Open the connector cover.
2. Connect the USB [micro-B] connector of the included USB charger cable to the charging micro USB connector of the product.
The USB connector of the product.
3. Connect the USB [A] connector of the USB charger cable to the USB port on a PC.
Be sure to sufficiently check the connector orientation and the insertion location.

4. If the PC is not on, turn it on.

The LED light turns on in red, and charging begins.

When charging is finished, this light will turn off.

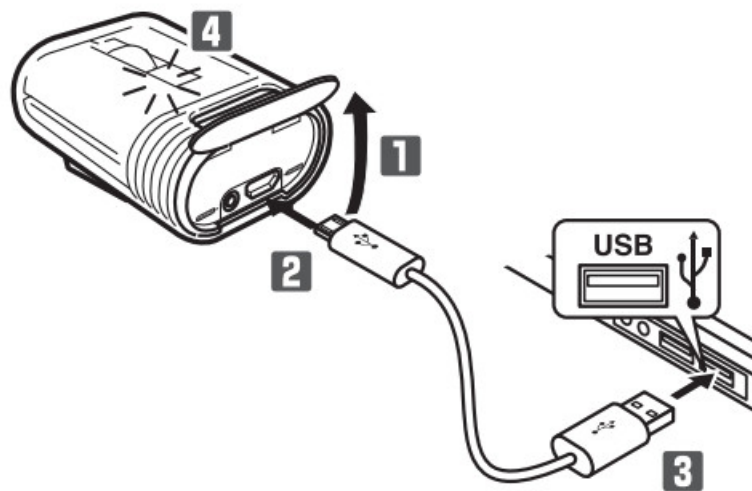

Turning the Power On

1. **Slide the power switch to the on position (the green side of the label).**

The LED light turns on in red for a fixed period of time.

* When the remaining battery charge is low, this will blink in red for a fixed period of time.



Low-energy mode

When a fixed period of time elapses with the power switch in the on position and with no operations performed, the mouse will automatically switch to low-energy mode.

Move the mouse to return from low-energy mode.

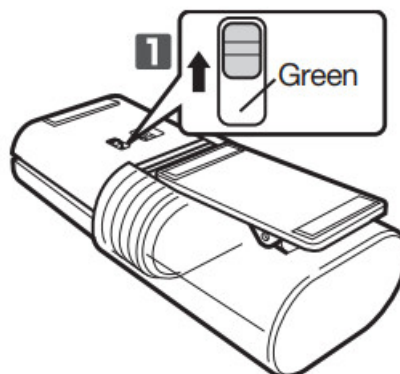

Pairing with a PC

The pairing method may vary depending on the PC that you are using. This manual only shows the basic Bluetooth® instructions for Windows® and Macintosh. For more details please see the PC's instruction manual. Use your mouse or a touchpad for operating the PC to finish the pairing.

Windows® (Windows® 10)

1. Click the "Action Center" in the lower-right part of the screen, and then click "Windows Settings."
2. Tap "Devices", and then select "Bluetooth and other devices settings." Click [+] of "Add Bluetooth or another

device.”

3. Open the connector cover, and then use an item with a pointed tip to hold down the pairing button for 2 to 3 seconds. The mouse will switch to pairing mode, and the LED light will blink in red.

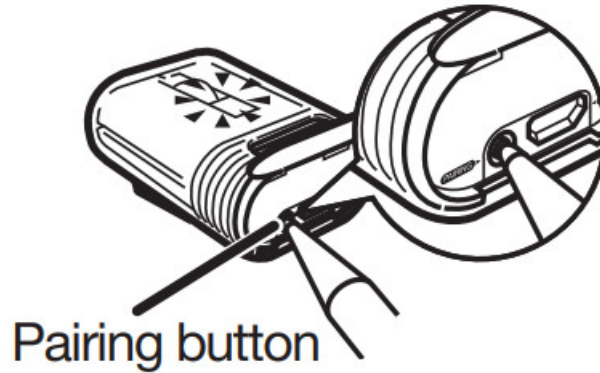

4. Click “Bluetooth” in the “Add Device” section, and then click “ELECOM IR Optical Mouse.” The pairing is started. The pairing is completed when the LED light is turned off.
5. You can use the mouse when “ELECOM IR Optical Mouse” is added to the “Bluetooth and other devices settings” display.

Macintosh (macOS Sierra(10.12))

1. Open “System Preferences” from the Apple menu.
Click “Mouse”, then select “Bluetooth mouse settings.”
2. Open the connector cover, and then use an item with a pointed tip to hold down the pairing button for 2 to 3 seconds. The mouse will switch to pairing mode, and the LED light will blink in red.

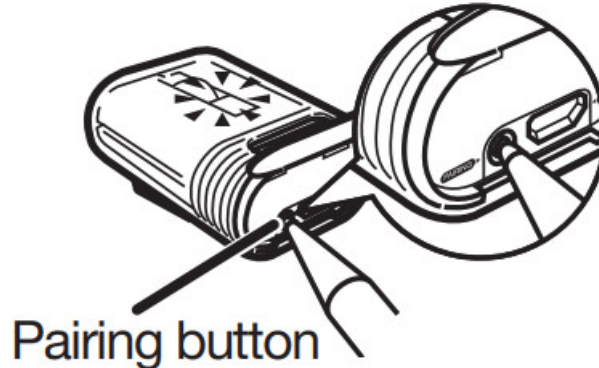

3. Select “ELECOM IR Optical Mouse”, then click “Pairing.” The pairing is completed when the LED light is turned off.
4. “Connected” will be shown on your display, and then the status of “ELECOM IR Optical Mouse” will be changed to “Connected.” Click “Finish” to start using the mouse.

Specifications

Resolution		1200 dpi
Connection method		Wireless Bluetooth-P connection
Compatible standard		Bluetoothe 3.0 Class 2
Profile		HID (Human Interface Device)
Radiofrequency		2.4 GHz band
Radio wave method		GFSK
Operation distance		Non-magnetic surface (e.g. wooden desk) approx. 10 m Magnetic surface (e.g. steel desk) approx. 3 m *These values were obtained in ELECOM's test environment and are not guar anteed.
Dimensions (W x D x H)	When in use	approx. 1.6' x 3.4' x 1.22'
	When stored	approx. 1.6' x 2.0' x 1.22'
Operating temperature nature/ humidity		41°F to 104°F/90%RH or less (without condensation)
Storage temperature/humidity		14°F to 140°F/90%RH or less (without condensation)
Battery		Built-in lithium-ion rechargeable battery (the battery cannot be removed or repl aced)
Operating time		Guidelines when used with a fully charged battery Continuous operation time: Approx. 18 hours Continuous standby time: Approx. 36 days Estimated usage time: Approx. 32 days (The usage time is estimated given a mouse operation percentage of 5% of th e 8 hours per day spent operating a PC.)
Supported OS		Windows° 10, Windows® 8.1, Windows' RT8.1, Windows® 7, Windows XP, m acOS Sierra (10.12) (Updating the OS or installing a service pack may be necessary.)

Safety Precautions



Prohibited action



Mandatory action



Situation that needs attention

DANGER



Please use the included charging cable, and perform the charging operation as directed by ELECOM. Using a charging cable other than the one provided, or not properly following the charging operation directions, may result in overheating, leakage, or explosion.



Do not tamper with or attempt to take apart the product. This may result in fire or electric shock.



Do not use this product if it is leaking.

If the internal battery is leaking, immediately stop use of the product. This can pose a risk of overheating and/or damage.



Immediately stop using this product if you notice anything unusual.

Do not use this product if you notice a leaking battery, odd color changes, warping, or any other abnormalities. Continuing to use the product under these conditions may result in overheating or explosion.



If a liquid substance from this product comes into contact with any part of your body or clothing, immediately use and wash the contacted area with clean water. Contact between your skin and any liquid inside the internal battery may result in skin damage.



Only use this product at the specified rated voltage.



Using this product outside of the specified rated voltage range may result in overheating, electric shock, or injury.



WARNING



If a foreign object (water, metal chip, etc.) enters the product, immediately stop using the product, and then turn the product off. Continuing to use the product under these conditions may cause a fire or electric shock.



If an abnormality is found with this product (such as smoke or an unexpected smell from the product), immediately stop using it and turn the power off. When charging, disconnect the included cable from the USB power supply, such as a USB AC adapter. After doing this, contact the retailer from whom you purchased the product.



Do not drop or hit this product.

If this product is damaged, immediately stop using the product and turn the mouse body off. If you continue to use the product under these conditions, it may cause a fire or electric shock.



Do not attempt to disassemble, modify or repair this product by yourself, as this may cause a fire, electric shock or product damage.

If you continue to use the product under these conditions, it may cause a fire or electric shock.



Do not put this product in fire, as the product may burst, resulting in a fire or injury.

CAUTION



Do not place this product in any of the following environments:

- In a car exposed to sunlight, a place exposed to direct sunlight, or a place that becomes hot (around a heater, etc.)
- In a moist place or a place where condensation may occur
- In an uneven place or a place exposed to vibration
- In a place where a magnetic field is generated (near a magnet, etc.)
- In a dusty place



This product does not have a waterproof structure. Use and store this product in a place where the product body will not be splashed with water or other liquids. Rain, water mist, juice, coffee, steam or sweat may also cause product damage.



Do not look directly at the light from the optical sensor.

Doing so may lead to eye damage.



Only use this mouse with PCs and video game systems.



Do not use this product with any device that may significantly be affected if the product were to malfunction.



If this product is used on a transparent surface, such as glass, or a highly reflective surface, such as a mirror, the optical sensor will not function correctly and mouse cursor movement will become unstable.



When you no longer need to use this product and the battery, be sure to dispose of it in accordance with the local ordinances and laws of your area.

Cautions for Wireless Equipment

This product is wireless equipment using the entire range of the 2.4 GHz band and it is possible to avoid the band of mobile object identification systems. FHSS is used for the radio wave method. The interference distance is 10 m. The 2.4 GHz band is also used by medical equipment, Bluetooth, and wireless LAN equipment conforming to the IEEE802.11b/11g /11n standard. Before using this product, check that there are no other “radio stations”* operating nearby. If electromagnetic interference occurs between this product and other “radio stations”, move this product to another location or stop using this product. * Other “radio stations” refer to industrial, scientific, and medical devices using the 2.4 GHz band, as this product does, other radio stations of this type, licensed radio station premises for a mobile object identification system that is used in factory production lines, certain non-licensed low power radio stations and amateur radio stations.



WARNING



Do not use this product with a device that may have a serious function or influence. There are rare cases where an external radio wave at the same frequency or the radio wave emitted from a mobile phone causes this product to malfunction, slow down or fail to operate

- Do not use this product in a hospital or other locations where the use of radio waves is prohibited. The radio waves of this product may affect electronic and medical devices (e.g. pacemakers).
- The use of a wireless mouse in an aircraft is prohibited by aviation law because doing so may interfere with flight safety. Turn off the power of the mouse body before boarding an aircraft and do not use it in the aircraft
- ELECOM is not liable for any accident or any indirect or consequential damage incurred due to the failure of this product.

Limitation of Liability

- In no event will ELECOM Co., Ltd be liable for any lost profits or special, consequential, indirect, punitive damages arising out of the use of this product.
- ELECOM Co., Ltd will have no liability for any loss of data, damages, or any other problems that may occur to any devices connected to this product.

Compliance status

www.elecom.co.jp/global/certification/

FCC ID:

YWO-M-CC2BRS

This device complies with Part 15 of the FCC Rules. Operation is subject to the following two conditions:

(1) this device may not cause harmful interference, and (2) this device must accept any interference received, including interference that may cause undesired operation.

NOTE; This equipment has been tested and found to comply with the limits for a Class B Digital Device, pursuant to part 15 of the FCC Rules. These limits are designed to provide reasonable protection against harmful interference in a residential installation. This equipment generates, uses, and can radiate radio frequency energy and, if not installed and used in accordance with the instruction, may cause harmful interference to radio communication. However, there is no guarantee that interference will not occur in a particular installation. If this equipment does cause harmful interference to radio or television reception, which can be determined by turning the equipment off and on, the user is encouraged to try to correct the interference by one or more of the following measures:

- Reorient or relocate the receiving antenna
- Increase the separation between the equipment and receiver
- Connect the equipment into an outlet on a circuit different from that to which the receiver is connected
- Consult the dealer or an experienced radio/TV technician for help

NOTICE: The manufacturer is not responsible for any radio or TV interference caused by unauthorized modification to this equipment. Such modifications could void the user's authority to operate the equipment. In order to make improvements to this product, the design and specifications are subject to change without prior notice.

Responsible party

(For FCC matters only)

Around The World Trading Inc.,

7636 Miramar Rd #1300,

San Diego, CA 92126

elecomus.com

CONTACT US
elecomus.com



FOLLOW US
facebook.com/elecomus



- Unauthorized copying and/or reproducing of all or part of this manual is prohibited.
- The specifications and appearance of this product may be changed without prior notice for product improvement purposes.
- When exporting this product, check the export regulations for the country of origin.
- The Bluetooth ® word mark and logos are registered trademarks owned by Bluetooth SIG, Inc. and any use of such marks by ELECOM CO.LTD. is under license.
- Windows and the Windows logo are trademarks of the Microsoft group of companies.
- macOS Sierra and Macintosh are trademarks of Apple Inc., registered in the U.S. and other countries.
- Company names, product names, and other names in this manual are either trademarks or registered trademarks.

A customer who purchases outside Japan should contact the local retailer in the country of purchase for inquiries. In "ELECOM CO., LTD. (Japan)", no customer support is available for inquiries about purchases or usage in/from any countries other than Japan. Also, no foreign language other than Japanese is available. Replacements will be made under the stipulation of the Elecom warranty, but are not available from outside of Japan.

Bluetooth ® Mouse
Manual, Safety precautions, and Compliance with regulations
2nd edition, June 28, 2022

ELECOM

©2022 ELECOM Co., Ltd. All Rights Reserved.

Documents / Resources



[ELECOM M-CC2BRS Bluetooth Mouse](#) [pdf] Instruction Manual
M-CC2BRS Bluetooth Mouse, M-CC2BRS, Bluetooth Mouse

References

-  [Elecom-shop](#)
-  [Standards Certification - ELECOM Global](#) | _____

Manuals+.