



## **ELECOM M-CAD01UB Wired Mouse For 3D CAD (3 Buttons) User Manual**

[Home](#) » [ELECOM](#) » ELECOM M-CAD01UB Wired Mouse For 3D CAD (3 Buttons) User Manual 

# **ELECOM**

**Model: M-CAD01UB  
Wired Mouse  
Manual**

### **Contents**

- [1 Name and function of each part](#)
- [2 How to use the mouse](#)
- [3 Safety Precautions](#)
- [4 Limitation of Liability](#)
- [5 Documents / Resources](#)
  - [5.1 References](#)
- [6 Related Posts](#)

### **Name and function of each part**

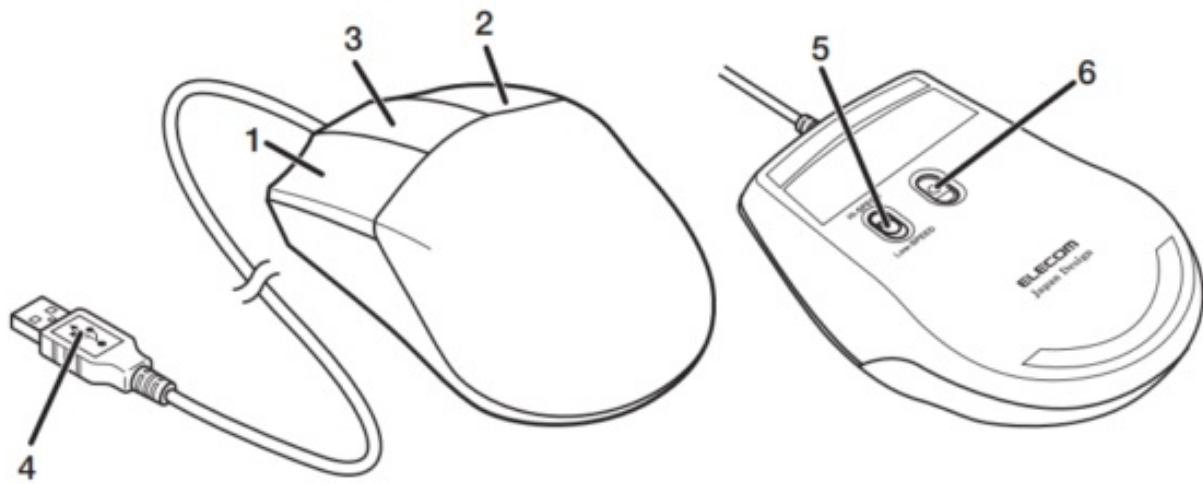

1. Left button  
To left-click on your PC.
2. Right button  
To right-click on your PC.
3. Middle button  
To middle click on your PC.
4. USB connector (male)
5. Pointer speed change switch  
To change the pointer speed.



: 1200 dpi

: 600 dpi

6. Optical sensor



Please note that looking directly into the sensor light may hurt your eyes.

### Removing this product from your PC

This product supports hot plugging. The USB connector may be removed while the PC is operating.

## How to use the mouse

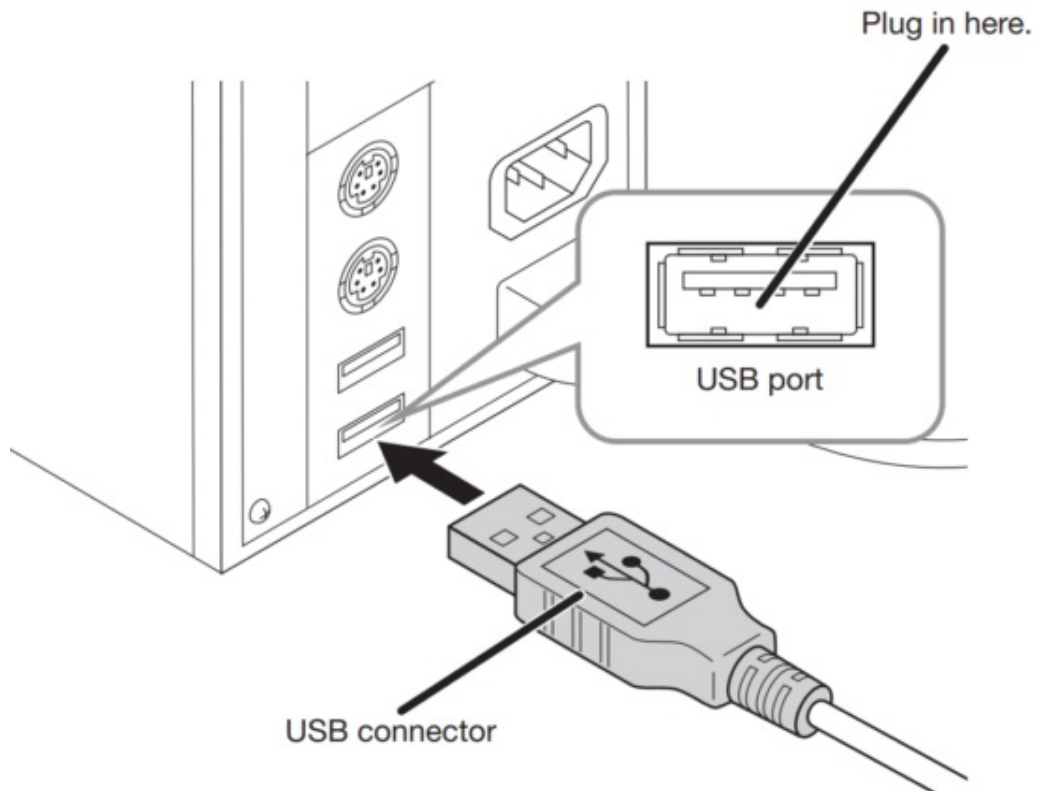

### Start the PC.

Start the PC, and then wait for it to be ready to perform operations.  
Insert the USB connector of the product into a USB port on the PC.  
Any USB port may be used.

- Be sure to sufficiently check the connector orientation and the insertion location.
- If you feel strong resistance when inserting the USB connector, check that the shape and orientation of the connector is correct. Using excessive force may damage the connector and cause injury.
- Do not directly touch the terminal area of the USB connector.

The driver will be automatically installed, and you will then be able to use the mouse.

Supported OS	® Windows 10, Windows ® 8.1, Windows ® 7, Windows ® XP (Updating the OS or installing a service pack may be necessary.) * Compatibility information was retrieved during operation confirmation in our verification environment. There is no guarantee of complete compatibility with all devices, OS versions, and applications.
Resolution	600/1200 dpi (switchable)
Interface	USB
Read method	Optical sensor method
LED	Blue
Dimensions (W × D × H)	approx. 71 × 110 × 38 (mm) * excluding cable
Cable length	approx. 1.5 m
Operational temperature/humidity	5°C to 40°C/ up to 90%RH (without condensation)
Storage temperature/humidity	-10°C to 60°C/ up to 90%RH (without condensation)

## Safety Precautions



Prohibited action



Mandatory action



The situation that needs attention



### WARNING



If a foreign object (water, metal chip, etc.) enters the product, immediately stop using the product, and remove the product from the PC. If you continue to use the product under these conditions, it may cause a fire or electric shock.



If the product is behaving abnormally, such as by generating heat, smoke, or a strange smell, immediately stop using the product, shut down the PC, and then sufficiently check whether the product is generating heat while being careful to avoid being burned. Then, remove the product from the PC. After that, contact the retailer from whom you purchased the product. Continuing to use the product under these conditions may cause a fire or electric shock.



Do not drop the product or otherwise subject it to impacts. If this product is damaged, immediately stop using it, remove the product from the PC. After that, contact the retailer from whom you purchased the product. Continuing to use the product while it is damaged may cause a fire or electric shock.



Do not attempt to disassemble, modify or repair this product by yourself, as this may cause a fire, electric shock or product damage.



Do not put this product in fire, as the product may burst, resulting in a fire or injury.



Do not insert or remove the connector with wet hands. Also, do not make alternations to or forcefully bend the connector. Doing so may cause a fire or electric shock.



## CAUTION



Do not place this product in any of the following environments:

- In a car exposed to sunlight, a place exposed to direct sunlight, or a place that becomes hot (around a heater, etc.)
- In a moist place or a place where condensation may occur
- In an uneven place or a place exposed to vibration
- In a place where a magnetic field is generated (near a magnet, etc.)
- In a dusty place



This product does not have a waterproof structure.

Use and store this product in a place where the product body will not be splashed with water or other liquid. Rain, water mist, juice, coffee, steam, or sweat may also cause product damage.



Do not use this mouse for any purpose other than for use with your computer.



Do not use this product with any device that may significantly be affected in the case of this product malfunctioning.



If this product is used on a transparent surface such as glass or a highly reflective surface such as a mirror, the optical sensor will not function correctly and the mouse pointer movement will become unstable.



If this product is not going to be used for one month or longer, remove the connector from the PC.



Avoid looking directly at the light of the optical sensor as doing so may cause eye damage.



When you no longer need to use this product, be sure to dispose of them in accordance with the local ordinances and laws of your area.

## Cleaning the Product

If the product body becomes dirty, wipe it with a soft, dry cloth.

The use of a volatile liquid (paint thinner, benzene, alcohol, etc.) may affect the material quality and color of the product.

## Limitation of Liability

In no event will ELECOM Co., Ltd be liable for any lost profits or special, consequential, indirect, punitive damages arising out of the use of this product.

ELECOM Co., Ltd will have no liability for any loss of data, damages, or any other problems that may occur to any devices connected to this product.

## Compliance status

[www.elecom.co.jp/global/certification/](http://www.elecom.co.jp/global/certification/)

This device complies with Part 15 of the FCC Rules. Operation is subject to the following two conditions: (1) this device may not cause harmful interference, and (2) this device must accept any interference received, including interference that may cause undesired operation.

In order to make an irresponsible party (For FCC matters only)

Around The World Trading Inc.,

7636 Miramar Rd #1300, San Diego, CA 92126

telecoms. movements to this product, the design and specifications are subject to change without prior notice.

Wired Mouse: M-CADOIUB Equipment name Type designation (Type)						
Unit	Restricted substances and its chemical symbols					
	Lead (Pb)	Mercury (Hg)	Cadmium (Cd)	Hexavalent chromium (Cr +6)	Polybrominated biphenyls (PBB)	Polybrominated diphenyl ethers (PBDE)
				0		
	0	0	0	0	0	0
	0	0	0	0	0	0
	0	0	0	0	0	0
Note 1: "Exceeding 0.1 wt %" and "exceed 0.01 wt %" indicates that the percentage content of the restricted substance exceeds the reference percentage value of present condition. Note 2: "C" indicates that the percentage content of the restricted substance does not exceed the percentage of reference value of presence. Note 3 : The "-" indicates that the restricted substance corresponds to the exemption.						



**ELECOM CO., LTD.**

[www.elecom.co.jp/global/](http://www.elecom.co.jp/global/)

ELECOM Korea Co., Ltd. Dome-Bldg 5F, 60, Nambusunhwan-ro 347-gil, Seochogu, Seoul, 06730, South Korea TEL : +82 (0) 2 – 1588 – 9514 FAX : +82 (0) 2 – 3472 – 5533 <a href="http://www.elecom.co.kr">www.elecom.co.kr</a>	ELECOM Sales Hong Kong Ltd. 2/F, Block A, 2-8 Watson Road, Causeway Bay, Hong Kong TEL : +852 2806 – 3600 FAX : +852 2806 – 3300 email: <a href="mailto:info@elecom.asia">info@elecom.asia</a>
ELECOM (SHANGHAI) TRADING Co., Ltd Room 208-A21, 2nd floor, 1602 Zhongshanxi Road, Xuhui District, Shanghai, China, 200235 TEL : +86 021-33680011 FAX : +86 755 83698064	ELECOM Singapore Pte. Ltd Blk 10, Kaki Bukit Avenue 1, #02-04 Kaki Bukit Industrial Estate, Singapore 417942 TEL : +65 6347 – 7747 FAX : +65 6753 – 1791

- Unauthorized copying and/or reproducing of all or part of this manual is prohibited.
- The specifications and appearance of this product may be changed without prior notice for product

improvement purposes.

- When exporting this product, check the export regulations for the country of origin.
- Windows and Windows Vista are either registered trademarks or trademarks of Microsoft Corporation in the United States and/or other countries.
- Mac OS and Macintosh are trademarks of Apple Inc., registered in the U.S. and other countries.
- Company names, product names, and other names in this manual are either trademarks or registered trademarks.

A customer who purchases outside Japan should contact the local retailer in the country of purchase for inquiries. In "ELECOM CO., LTD. (Japan)", no customer support is available for inquiries about purchases or usage in/from any countries other than Japan. Also, no foreign language other than Japanese is available. Replacements will be made under the stipulation of the Elecom warranty, but are not available from outside of Japan.

#### Wired Mouse

Manual, Safety precautions, and Compliance with regulations

2nd edition, February 8, 2022

©2020 ELECOM Co., Ltd. All Rights Reserved.

**MSC-M-CAD01UB ver.112**

## Documents / Resources

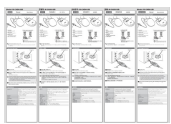

[ELECOM M-CAD01UB Wired Mouse For 3D CAD \(3 Buttons\)](#) [pdf] User Manual  
M-CAD01UB, Wired Mouse For 3D CAD 3 Buttons

## References

- [E Elecom-shop](#)
- [ELECOM GLOBAL](#)
- [Standards Certification - ELECOM Global |](#)
- [\(ELECOM KOREA\)](#)