



ELAC LS20 Bookshelf Speaker Stands Owner's Manual

[Home](#) » [ELAC](#) » ELAC LS20 Bookshelf Speaker Stands Owner's Manual 

Contents

- [1 ELAC LS20 Bookshelf Speaker Stands](#)
- [2 LS20 Speaker Stands](#)
- [3 LS20 Bookshelf Speaker Stands](#)
- [4 LS20-B/W SPECIFICATIONS](#)
- [5 Documents / Resources](#)
 - [5.1 References](#)
- [6 Related Posts](#)



ELAC LS20 Bookshelf Speaker Stands



LS20 Speaker Stands

The LS-20 speaker stands has been custom designed to match the our Reference Line of speakers. The 6" x 8.5" steel top plate ensures a good fit with either of these series. The included rubber bumpers further help dampen cabinet vibrations. The stand itself is constructed from an aluminum center column with a steel top plate and a substantial "H" shape steel base plate. The mass of the base plate adds extra stability to the stand. The stand comes equipped with both spikes and adjustable rubber feet allowing use on either carpet or solid floors.

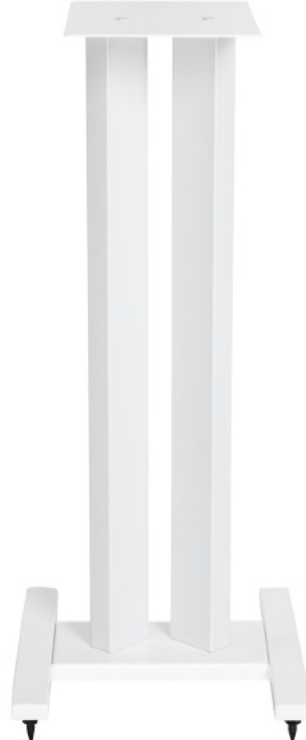

LS20 Bookshelf Speaker Stands

Proper speaker height is key in getting maximum performance out of any speaker. The LS20 speaker stands height is designed to keep the tweeter at near ear level as well as optimizing the coupling of the woofer into the room. The center posts are fillable for even further dampening.

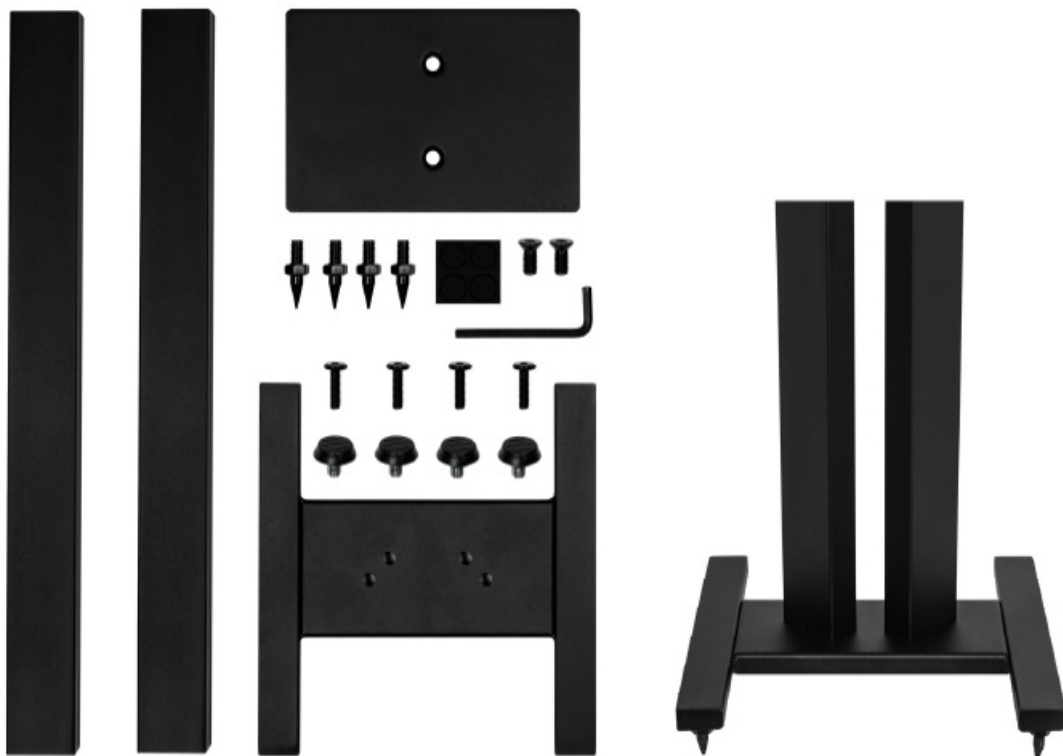

LS20-B/W SPECIFICATIONS

- Color: Gloss Black and Glass White

- Stand Height: 23" (With Spikes or Rubber Feet)
- Top Plate Dimensions: 6" x 8.5"
- Bottom Base Dimensions: 9.65" x 10.63"
- Materials: Top Plate (Steel), Center Column (Aluminum), Base (Steel)
- Included Accessories: Floor Spikes, Rubber Feet, Rubber Bumpers Quantity: Pair
- Gross Weight: 15.33lbs
- Net Weight: 6.6lbs Each

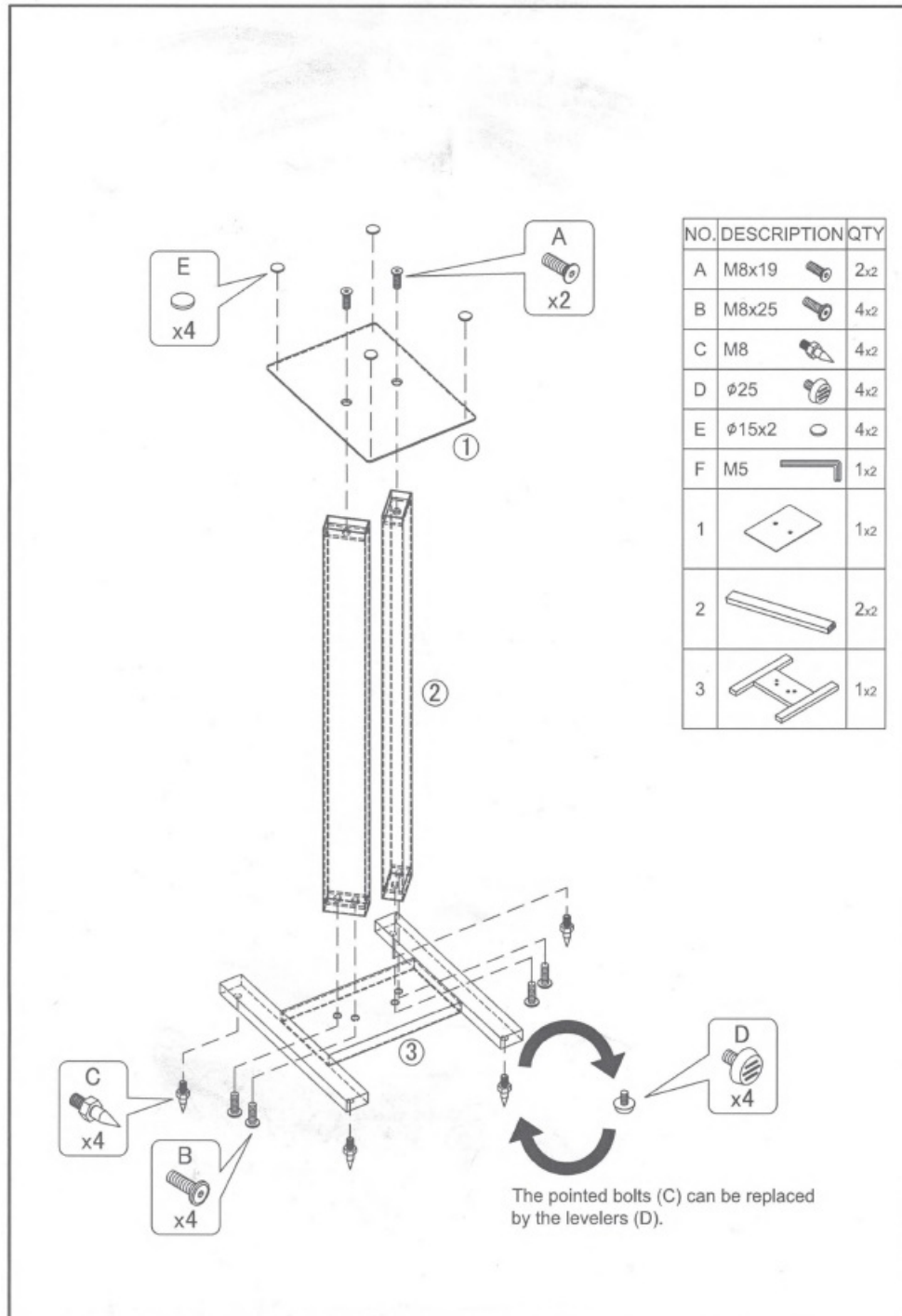

ELAC.COM

©2021 ELAC Americas, Inc. All rights reserved. Specifications and design are subject to change without notice.

Documents / Resources

	<p>ELAC LS20 Bookshelf Speaker Stands [pdf] Owner's Manual</p> <p>LS20, Bookshelf Speaker Stands, Speaker Stands, Bookshelf Stands, LS20, Stands</p>
--	--

References

- [ELAC – The life of sound | Best Audiophile Speakers](#)