



# EKSatelecom H6 Ai Powered ENC Bluetooth Headset User Manual

[Home](#) » [EKSatelecom](#) » EKSatelecom H6 Ai Powered ENC Bluetooth Headset User Manual 

## Contents

- [1 EKSatelecom H6 Ai Powered ENC Bluetooth Headset](#)
- [2 Package Contents](#)
- [3 Specifications](#)
- [4 Product Overview](#)
- [5 Operation Guide](#)
- [6 Call Functions](#)
- [7 Bluetooth Pairing](#)
- [8 Dual Pairing](#)
  - [8.1 Reset](#)
  - [8.2 charging](#)
- [9 Limited Warranty](#)
- [10 Documents / Resources](#)
- [11 Related Posts](#)



**EKSatelecom H6 Ai Powered ENC Bluetooth Headset**



## Package Contents

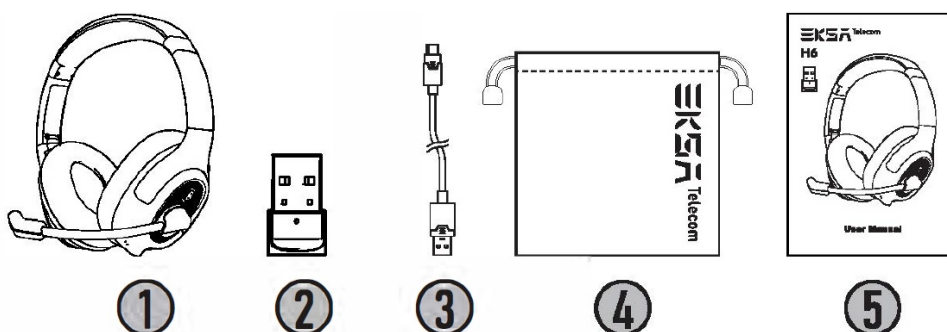

1. EKSAtelecom H6 Wireless Headset
2. EKSA PC Adapter
3. Type-C Charging Cable
4. Carry Pouch
5. User Manual

## Specifications

- **Headset Bluetooth Version:** 5.0
- **Adapter Bluetooth Version:** 5.2
- **Effective Wireless Range:** 10 m / 32 ft
- **Music Time:** .,55 hours (70% volume)
- **Talk Time:** .,30 hours (70% volume)
- **Charging Time:** “1.5 hours
- **Speaker Diameter:** 40 mm
- **Impedance:** 32  $\Omega$   $\pm$  15%
- **Sensitivity:** 114  $\pm$  3 dB
- **Frequency Response:** 20 Hz – 20 kHz
- **Size:** 2.7 mm\* 1.85 mm
- **Sensitivity:** -25  $\pm$  1 dB
- **Frequency Response:** 100 Hz – 10 kHz
- **Impedance:** 2.2 k $\Omega$
- **Polar Pattern:** Omnidirectional
- **Mic:** EKSAtelecom VoicePure Technology

## Product Overview

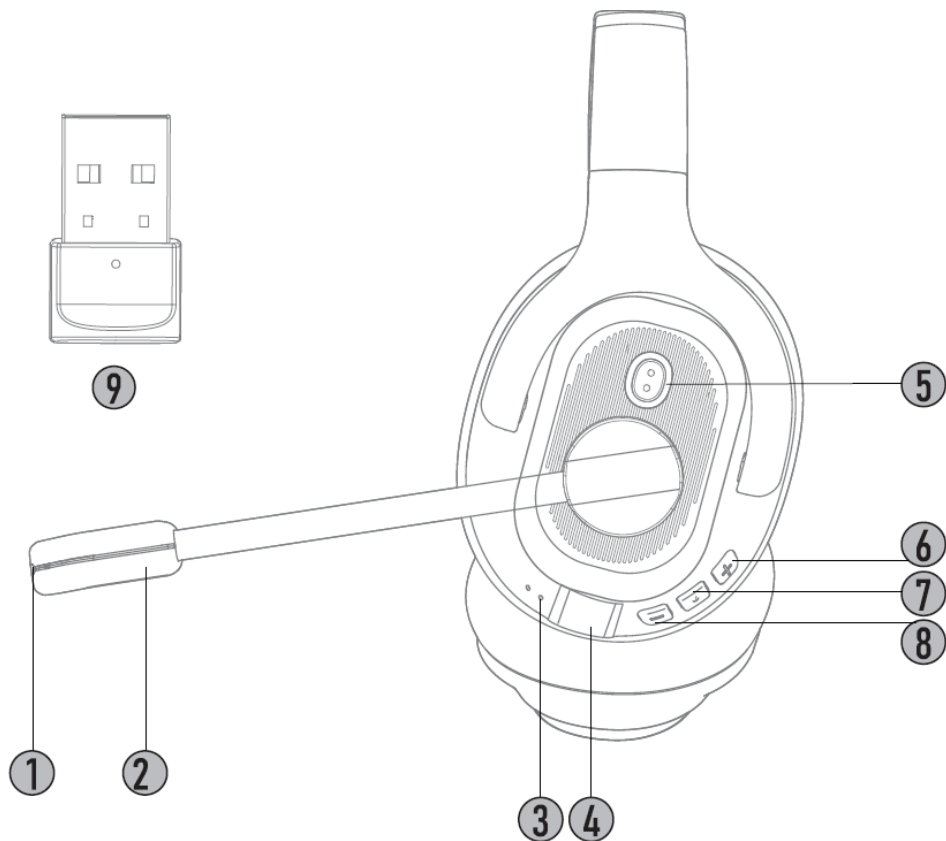

1. Call Indicator
2. EKSAtelecom VoicePure Technology
3. Bluetooth & Charging Indicator
4. Type-C Charging Port
5. I Busy Light
6. Volume+ / next track
7. G Multi-Function Button (MFB)
8. Volume – / previous track
9. EKSA PC Adapter

## Operation Guide

### Multi-Function Button:

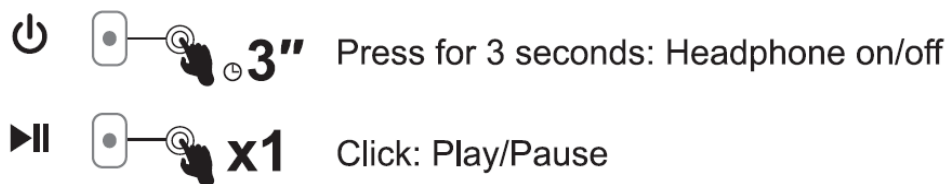

### Busy Light:

  **x1** Click: Do-Not-Disturb Mode on/off

  **x3** Triple Click: Voice Assistant/Siri

**Volume Button:**

   **x1** Click: Volume + / -

   **2"** Press for 2 seconds to next/previous track

**Swivel-to-Mute Microphone:**



Swivel upwards:  
Microphone off

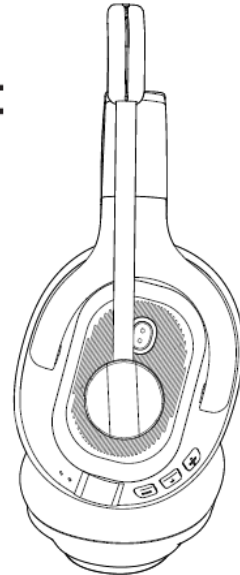

Swivel downwards:  
Microphone on



**Call Functions**

**Call Handling:**

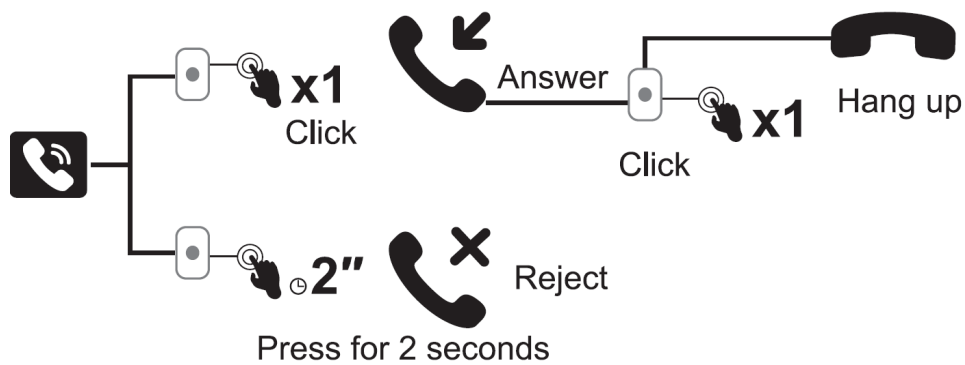

#### Redial:

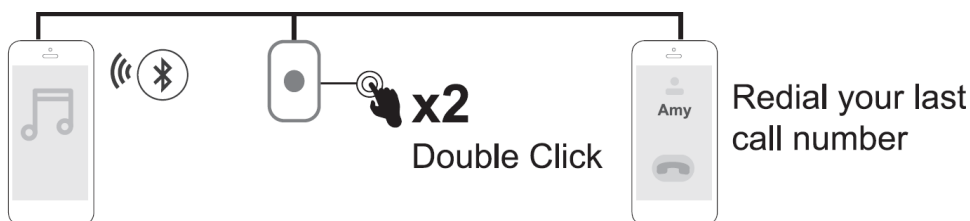

#### Audio Switching:

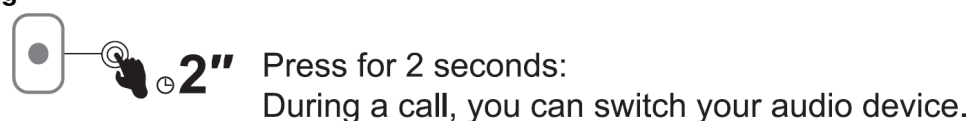

#### Three-Way Calling:

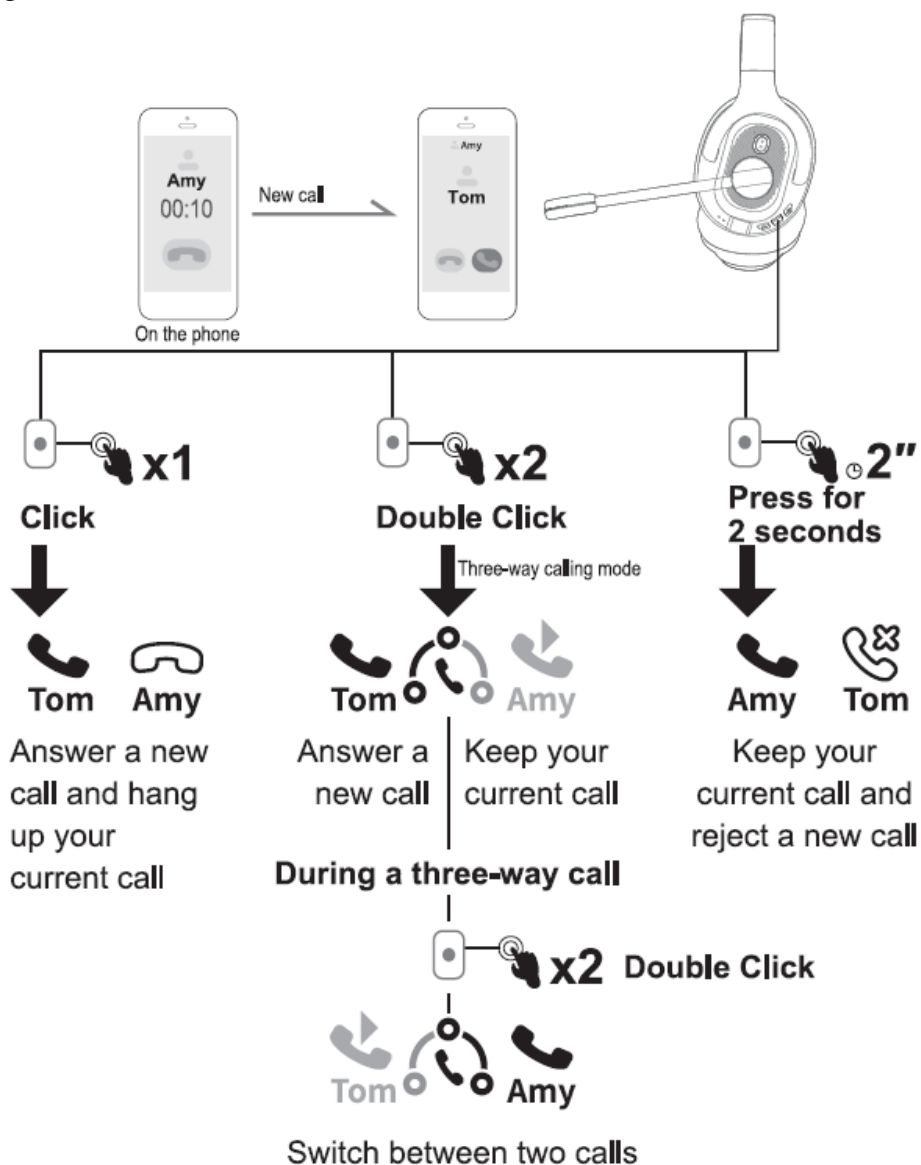

#### Bluetooth Pairing

## Mobile Phone:

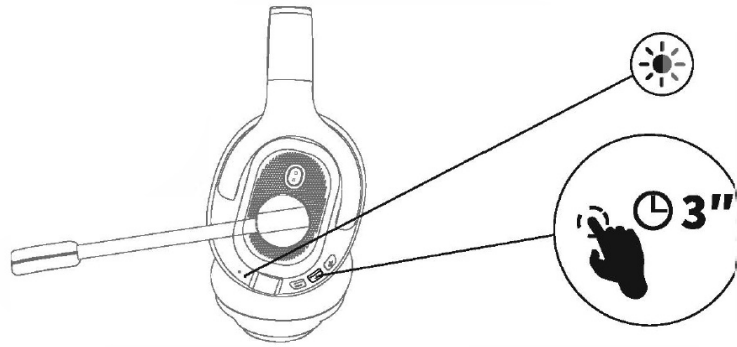

1. Turn on EKSAtelcom H6, until its Bluetooth indicator flashes alternately between red and blue, indicating that the headset is in pairing mode.
2. Turn on the Bluetooth of your device, activate the search feature, and select "EKSA-H6". After pairing, the Bluetooth indicator flashes slowly in blue light with a voice prompt "your headset is connected", confirming a successful connection.

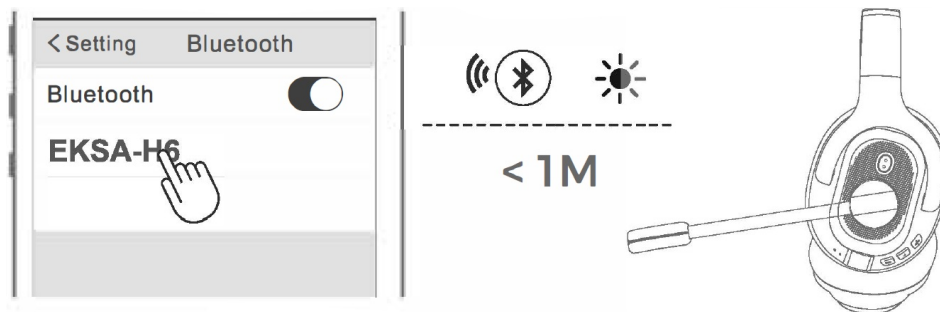

### Note:

1. Keep the distance between the EKSAtelcom H6 and your device within 1 meter.
  2. If necessary, the pin code to complete pairing is "0000".
  3. While in pairing state, if a connection cannot be established within 10 minutes, the headset will turn off automatically.
  4. When the headset is turned on again, it will connect to the last connected device automatically.
3. To connect to a new device, turn off the Bluetooth of the currently paired device and follow the above steps to connect successfully to a new device.

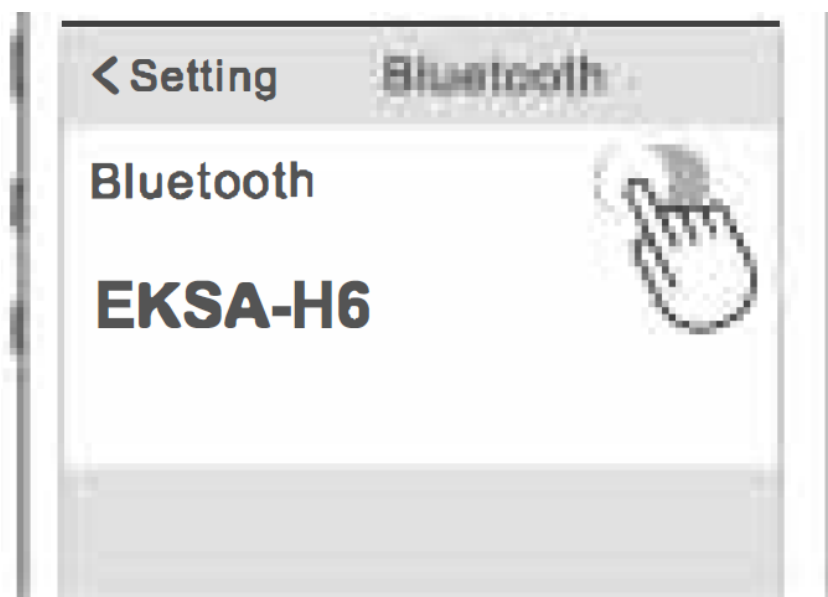

- device A

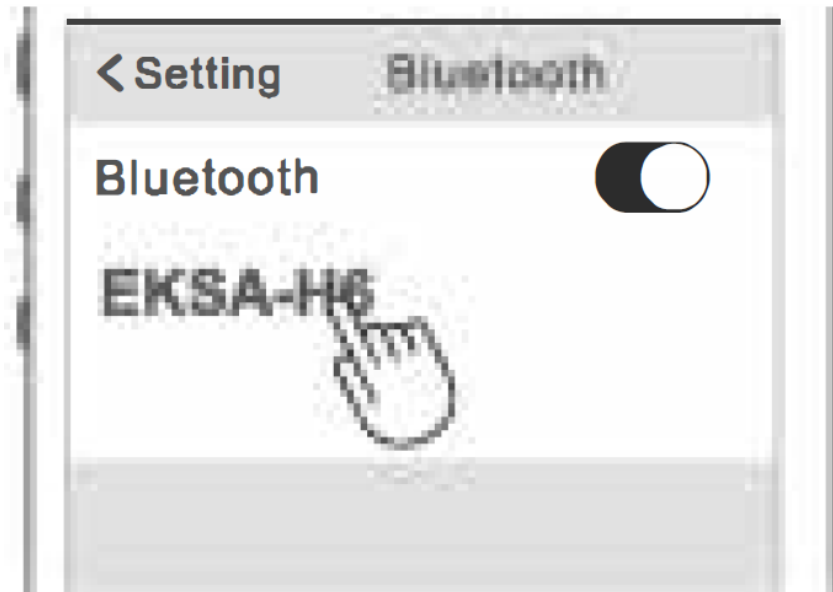

- device B

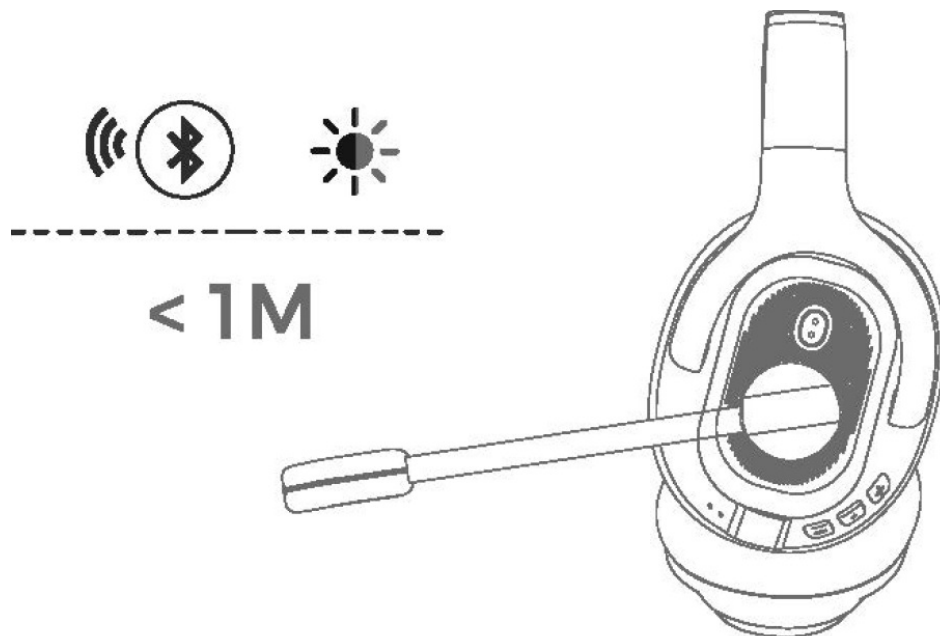

#### PC:

If you want to connect the headset to a PC, you can use the EKSA PC adapter provided in the package. Then, you can enjoy the call function and compatibility of the third-party software of the PC. Follow the steps below to get it done.

1. Plug the EKSA PC adapter into your PC's USB port. The adapter will turn on automatically with a name of "EKSA PC Adapter" displaying on your computer.

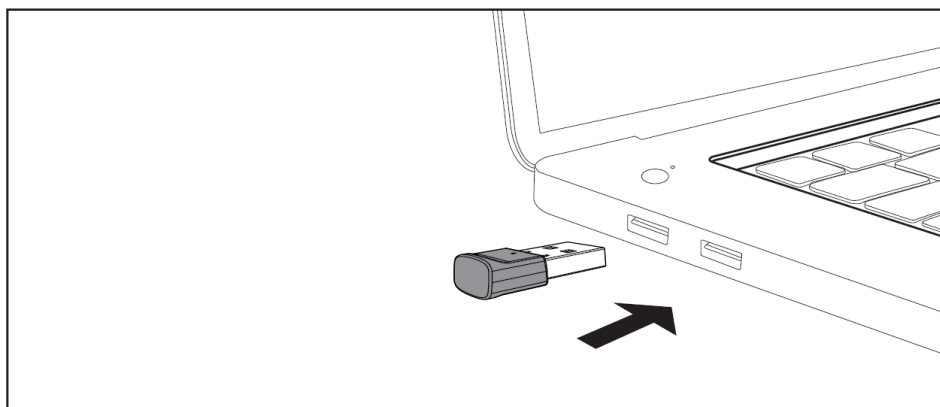

- USB-A interface

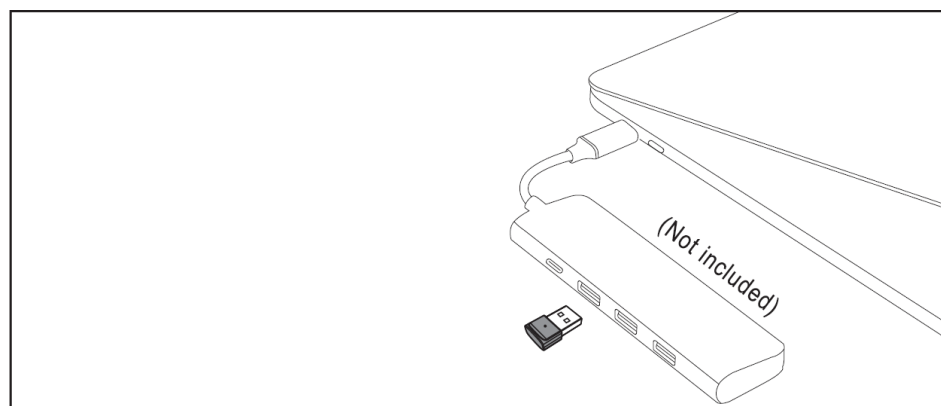

- Type-C interface

- When enabled, the indicator on the EKSA PC adapter will flash a blue light, which indicates that it is in pairing mode. Then, put the headset on pairing mode and place it as close to the EKSA PC adapter as possible (within 8 inches). The headset will automatically connect to the EKSA PC adapter.

Note: It takes about 20 seconds to establish a connection between the headset and a PC for the first time.

Suppose the connection is unsuccessful, please unplug the adapter and plug it back into the PC. Then restart the headset's pairing mode and reconnect to your computer.

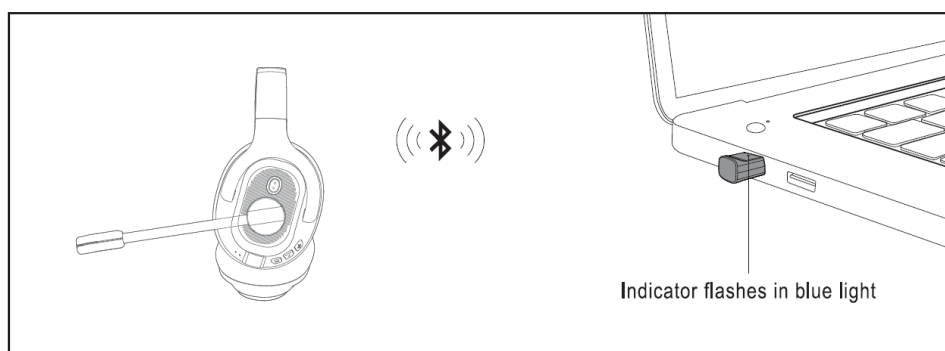

- USB-A interface

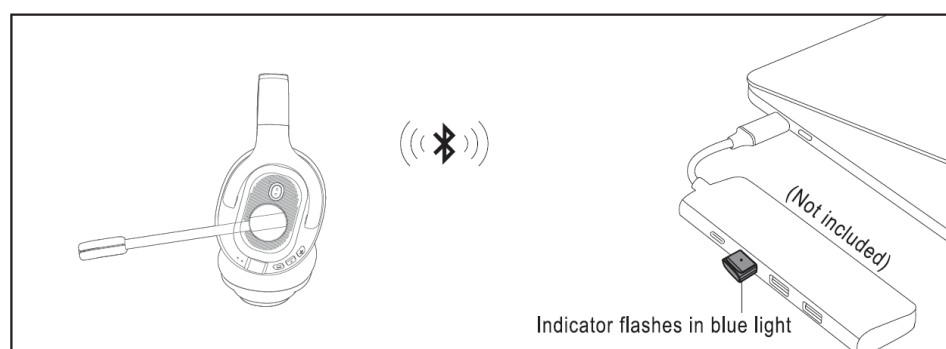

- Type-C interface

- After the headset is successfully connected, the Bluetooth indicator on the headset will slowly flash a blue light while the EKSA PC adapter's indicator will always be blue.



## Dual Pairing

1. After successfully connecting the EKSAtelecom H6 to device A, turn off the Bluetooth of device A. The headset's Bluetooth indicator flashes in red and blue alternately to signify pairing mode.

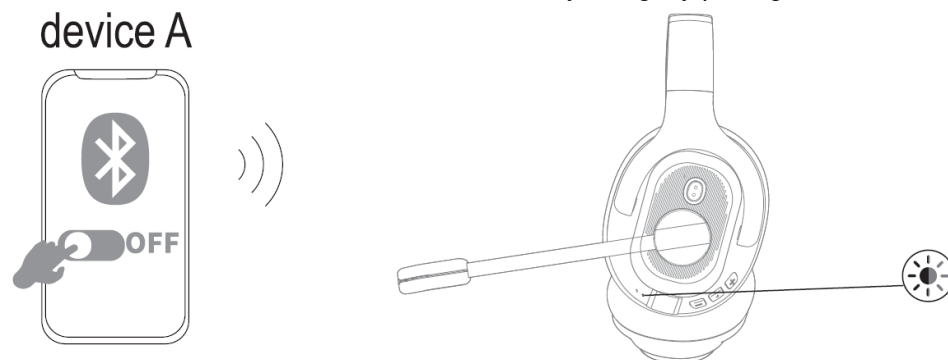

2. Turn on the Bluetooth of device B, activate search mode, and connect to "EKSA-H6".

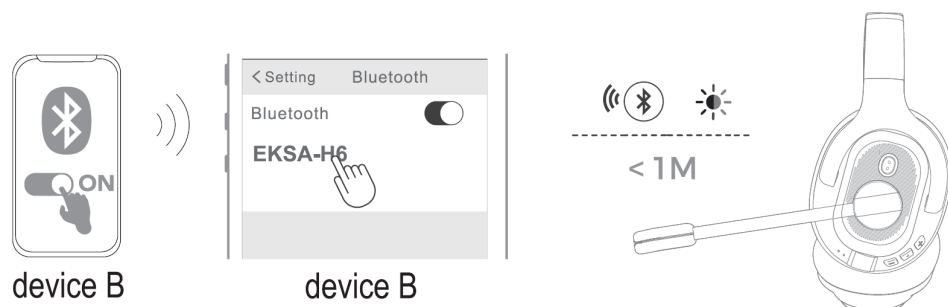

3. Turn on the Bluetooth of device A to connect with "EKSA-H6". This puts both devices A and B in a simultaneous connection with "EKSA-H6".

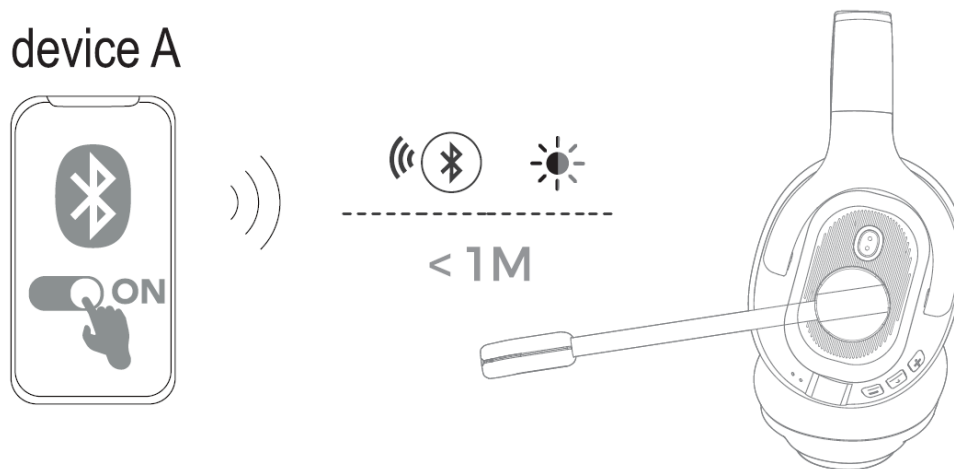

## Reset

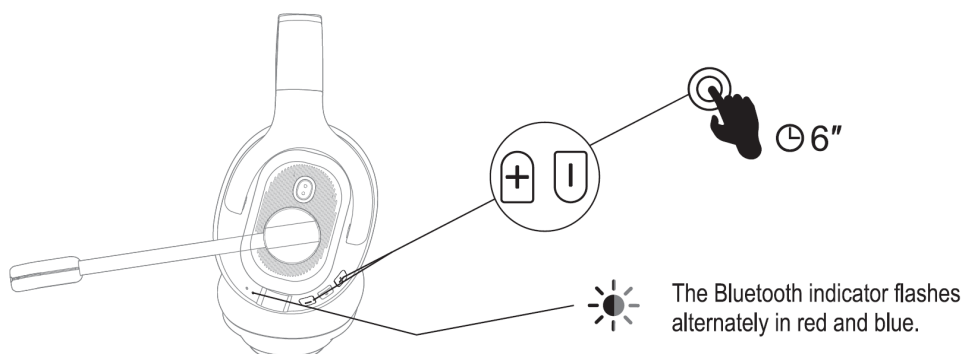

When EKSAtelecom H6 is in connected/pairing mode, press and hold the "volume +" and "volume -" buttons simultaneously for 6 seconds until the LED lights up in red and blue, indicating the pairing information is cleared.

## charging

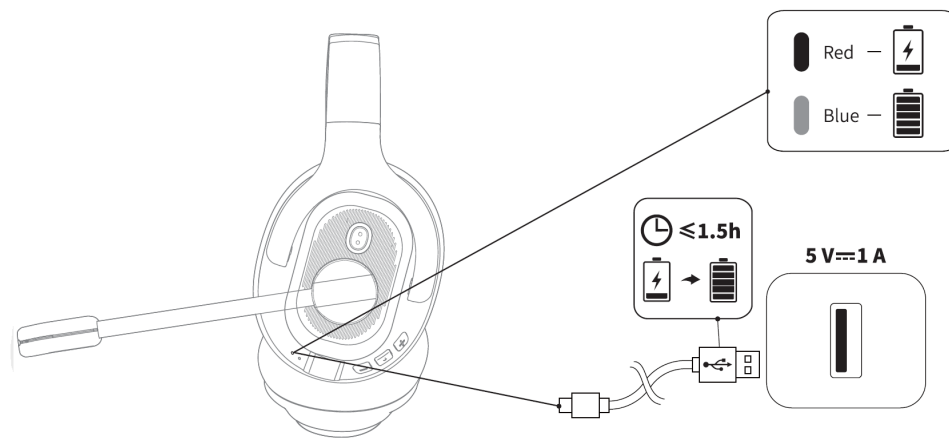

1. When the battery is less than 10%, the headset will give a voice prompt “battery low” every 3 minutes. Please charge it as soon as possible.
2. When EKSatelecom H6 is not in use, please charge it at least once every 2 months.
3. Please use the original charging cable for charging. Charging voltage can't exceed 5 V.

## Limited Warranty

GLOBAL: +852 6940 4955 (Mon to Fri 9:00 am-6:30 pm, UTC +8 HKT)

INDIA: +91-8929-369-620 (Mon to Fri 1ST 9:30 am-5:30 pm)

GLOBAL: [info@eksatelecom.com](mailto:info@eksatelecom.com)

INDIA: [support@eksatelecom.co.in](mailto:support@eksatelecom.co.in)

[www.eksatelecom.com/pages/warranty](http://www.eksatelecom.com/pages/warranty)

Manufacturer: YI ZHAO (SHENZHEN) CO., LIMITED

Add.: 6th Floor, T3 Creative Building, Shenzhen Colorful Huiwei Cultural and Creative Expo City, No.5010 Baoan Avenue, Caowei Community, Hangcheng Street, Baoan District, Shenzhen City, Guangdong Province, China

C&E Connection E-Commerce (DE) GmbH

Add.: Zurn Linnegraben 20, 65933, Frankfurt am Main, Germany Tel.: +4906927246648

Email: [info@ce-connection.de](mailto:info@ce-connection.de)

APEX CE SPECIALISTS LIMITED

Add.: 89 Princess Street, Manchester, M1 4HT, UK Tel.: +441616371080

Email: [info@apex-ce.com](mailto:info@apex-ce.com)

## Documents / Resources

	<p><b><a href="#">EKSatelecom H6 Ai Powered ENC Bluetooth Headset</a> [pdf] User Manual</b></p> <p>H6 Ai Powered ENC Bluetooth Headset, H6, H6 Bluetooth Headset, Bluetooth Headset, H6 Headset, Headset, Ai Powered ENC Bluetooth Headset, ENC Bluetooth Headset, ENC Headset, Ai Powered Headset</p>
--	--