



EJEAS[®]

Product Activation

Flow Chart

Contents [[hide](#)]

- [1 Q8 Wireless Intercom Headset System](#)
- [2 Android phone activation process](#)
- [3 Apple phone activation process](#)
- [4 Documents / Resources](#)
 - [4.1 References](#)

Q8 Wireless Intercom Headset System

Taking Q8 operation as an example other products operate the same

Note: The MESH function of the device is not activated cannot be used, the APP cannot be connected, and it can only be used as a normal Bluetooth headset.

Download the EJEAS APP in the mobile app store or the EJEAS official website.

 www.ejeas.com

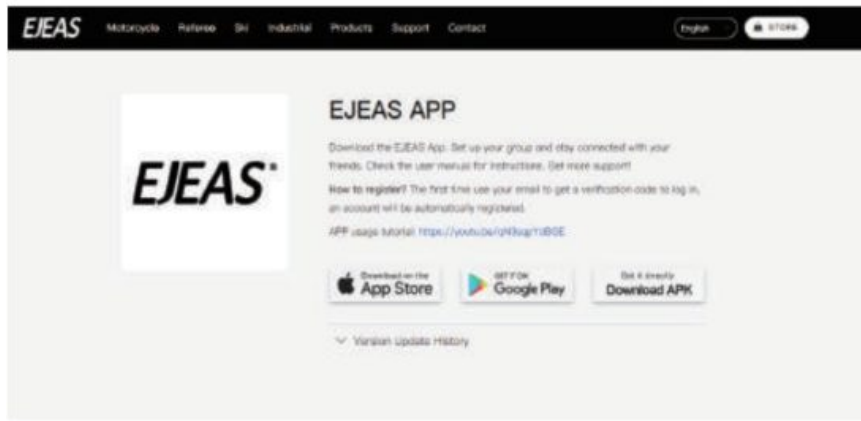

Android phone activation process

Log in to EJEAS APP > Devices > Pairing devices in the upper right corner > Click on the top search > Find the corresponding model in the list > Click Pairing > Pairing Successfully will automatically return to the device page (proves successful activation). If the pairing fails, the prompt will be: The device activation failed.

Step 1

Log in to the EJEAS APP (you need to use the email verification mode for the first login and get the verification code to verify and log in).

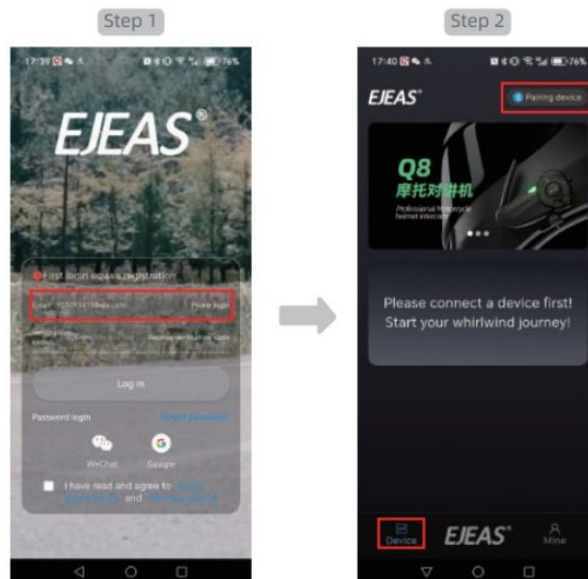

Step 2-3

The device turns on and enters Bluetooth pairing mode, please refer to the instructions for specific operating procedures.

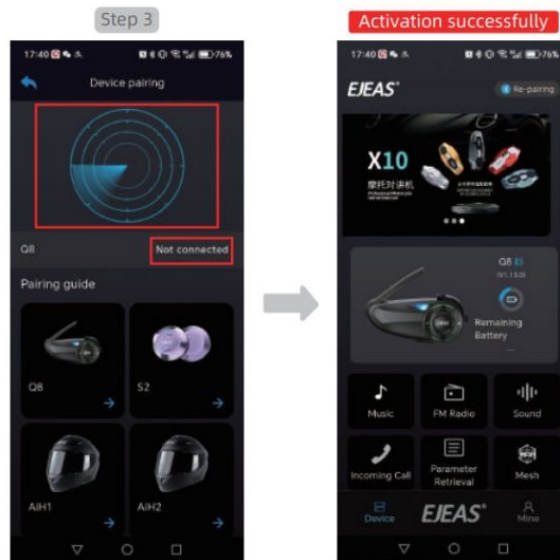

Apple phone activation process

Download the EJEAS APP in the mobile app store or the EJEAS official website.

First enter the mobile phone system > Settings > Bluetooth > Find the corresponding model and click the pairing operation.

Log in to EJEAS APP > Devices > Pairing devices in the upper right corner > Click on the top search > Find the corresponding model in the list > Click Pairing > Pairing Successfully will automatically return to the device page (proves successful activation).

Step 1-2

First enter the mobile phone system > Settings > Bluetooth > Find the corresponding model and click the pairing operation.



Step 3

Log in to the EJEAS APP (you need to use the email verification mode for the first login and get the verification code to verify and log in).

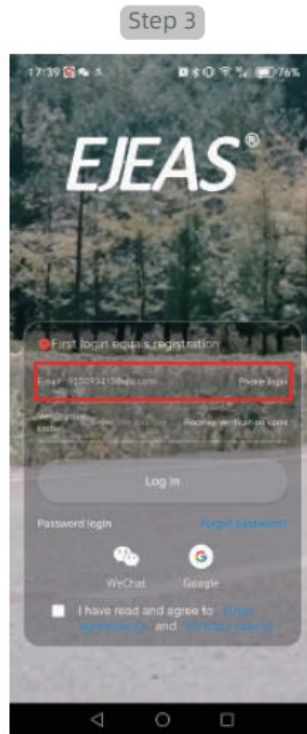

Step 4-5

The device turns on and enters Bluetooth pairing mode , please refer to the instructions for specific operating procedures.

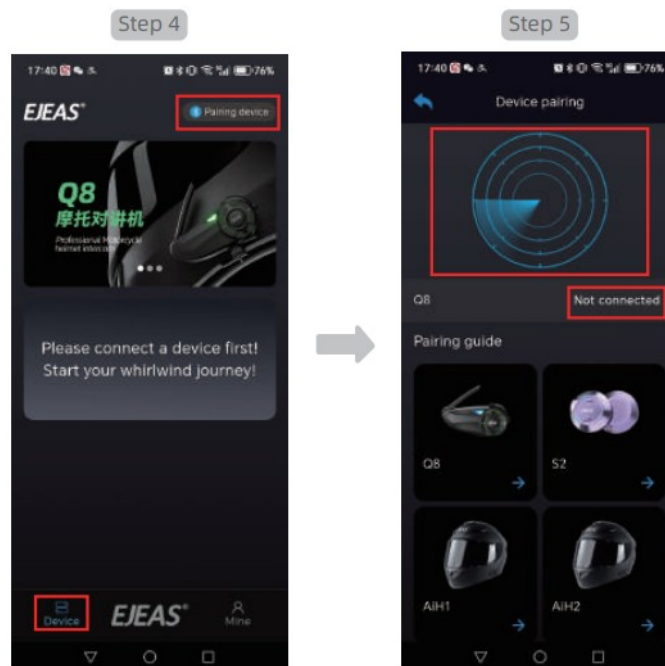

Activation successful



EJEAS[®]

Documents / Resources

	<p>EJEAS Q8 Wireless Intercom Headset System [pdf] User Guide Q8, Q8 Wireless Intercom Headset System, Wireless Intercom Headset System, Intercom Headset System, Headset System</p>
-------------------------------------------------------------------------------------	----------------------------------------------------------------------------------------------------------------------------------------------------------------------------------------------------------

References

- [User Manual](#)

■ EJEAS

◆ EJEAS, Headset System, Intercom Headset System, Q8, Q8 Wireless Intercom Headset System, Wireless Intercom Headset System

Leave a comment

Your email address will not be published. Required fields are marked *

Comment *

Name

Email

Website

Save my name, email, and website in this browser for the next time I comment.

Post Comment

Search:

e.g. whirlpool wrf535swhz

Search

[Manuals+](#) | [Upload](#) | [Deep Search](#) | [Privacy Policy](#) | [@manuals.plus](#) | [YouTube](#)

This website is an independent publication and is neither affiliated with nor endorsed by any of the trademark owners. The "Bluetooth®" word mark and logos are registered trademarks owned by Bluetooth SIG, Inc. The "Wi-Fi®" word mark and logos are registered trademarks owned by the Wi-Fi Alliance. Any use of these marks on this website does not imply any affiliation with or endorsement.