

EJEAS MS20 Bluetooth Intercom Headset



EJEAS MS20 Bluetooth Intercom Headset User Manual

[Home](#) » [EJEAS](#) » EJEAS MS20 Bluetooth Intercom Headset User Manual 

Contents

- [1 EJEAS MS20 Bluetooth Intercom Headset](#)
- [2 Product Usage Instructions](#)
- [3 Product Details](#)
- [4 Product Operation](#)
- [5 Pairing Steps as Listeners](#)
- [6 EUC Remote Controller \(Optional\)](#)
- [7 Documents / Resources](#)
 - [7.1 References](#)
- [8 Related Posts](#)

EJEAS®

EJEAS MS20 Bluetooth Intercom Headset



Product Specifications

- Mesh Group Intercom System
- Bluetooth Intercom
- Music Share
- Auto Phone Answering
- Voice Assistant
- FM Radio
- Support EUC Remote Support Mobile App
- Communication Frequency: 470-488MHz
- Maximum Communication Distance: 2 kilometers
- Maximum Intercom Participants: 20 people
- Number of Channels: 5

Product Usage Instructions

Power On/Off

To power on, long-press the **M Button** for 1 second until the blue light flashes with a voice prompt. To power off, long-press the **Volume +** and **M Button** until the voice prompt says "Power off."

Low Battery Indication

If the battery is low, the red light will flash twice with a voice prompt. When the battery is extremely low, the device will automatically power off. While charging, the red light will remain on.

Mesh Intercom

The Mesh Intercom allows for communication with up to 20 people in a multi-hop technology mesh network. It supports Bluetooth music playback simultaneously and can switch to intercom mode automatically when someone speaks. To mute/unmute the microphone, press the **M Button**. Adjust VOX voice sensitivity by pressing and holding the **Volume +**.

Frequently Asked Questions (FAQ)

- **How do I reset the device?**

The device will automatically power off while charging. To reset, ensure it is charged and power it on.

- **How can I check the battery status?**

After connecting via Bluetooth to your phone, you can see the battery icon on your phone's display.

MS20

User Manual

Mesh Group Intercom System

www.ejeas.com

Product Details

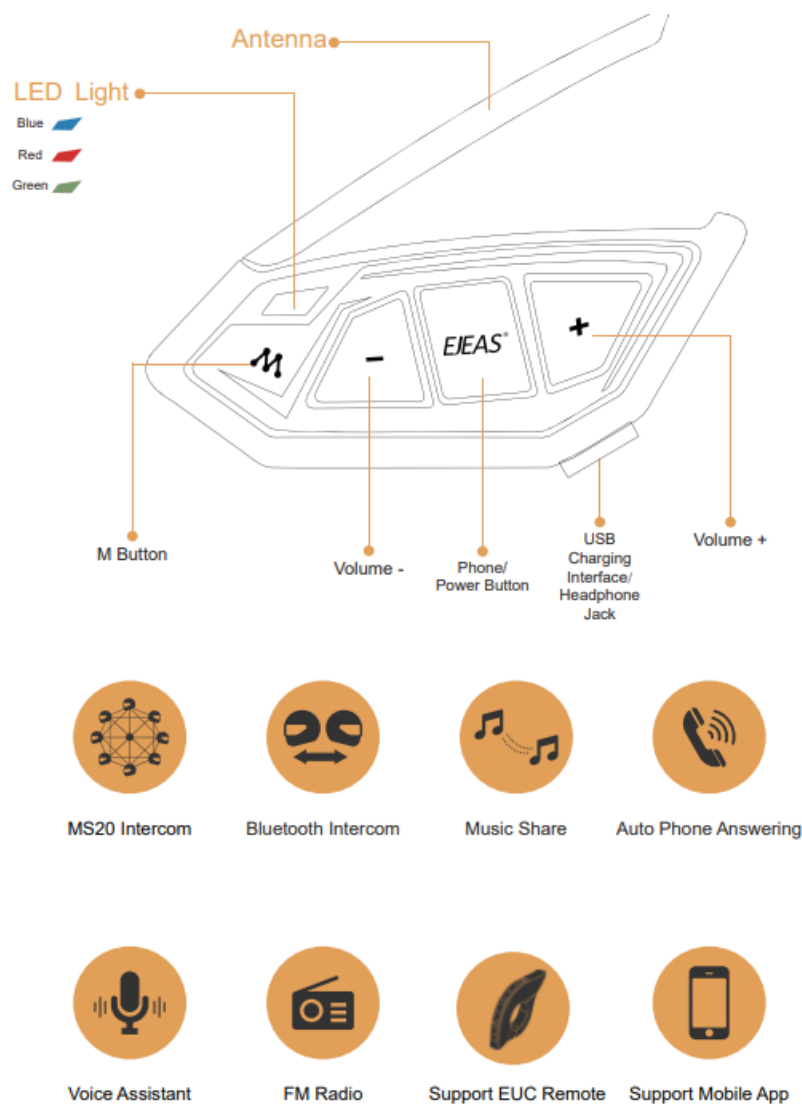

Product Operation

Operation Diagram

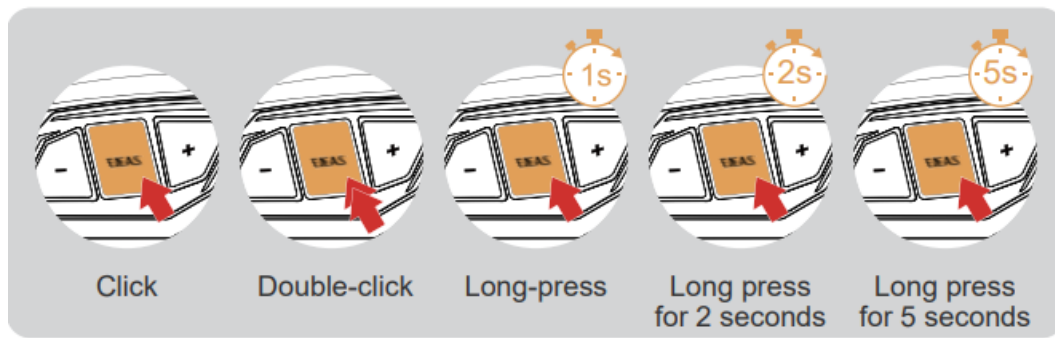

Basic Operation

Power ON/OFF Please charge it before using

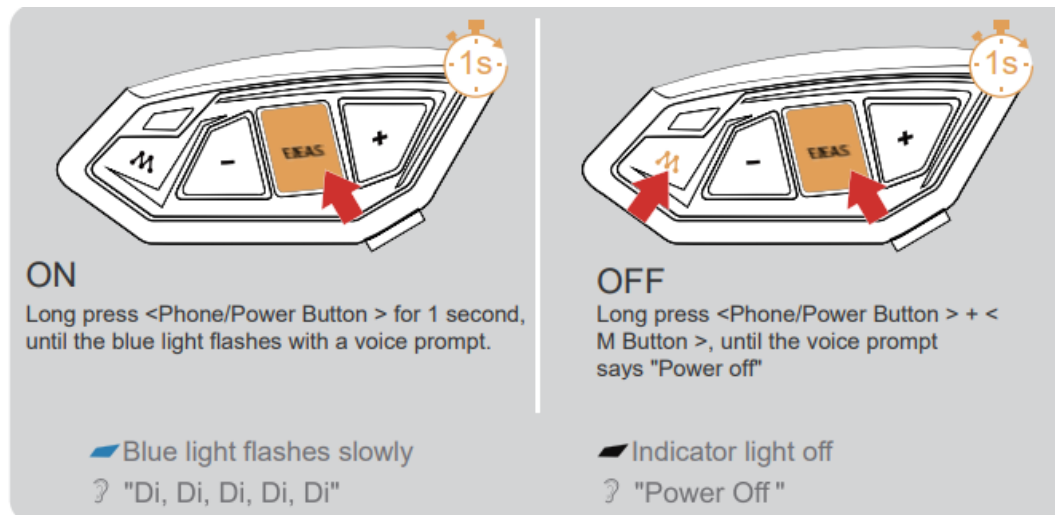

Reset: It will automatically power off while charging and can be used while charging after powering on.

Low Battery Indication

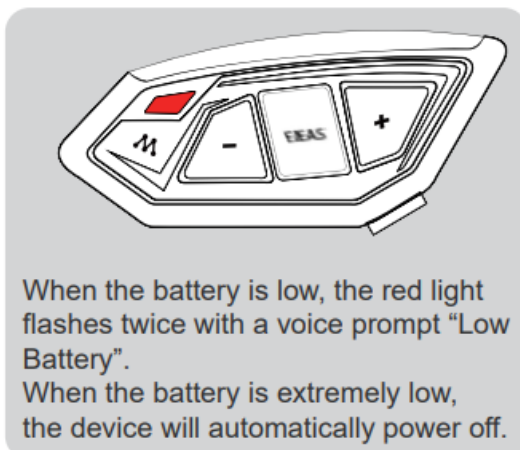

Charging Indication

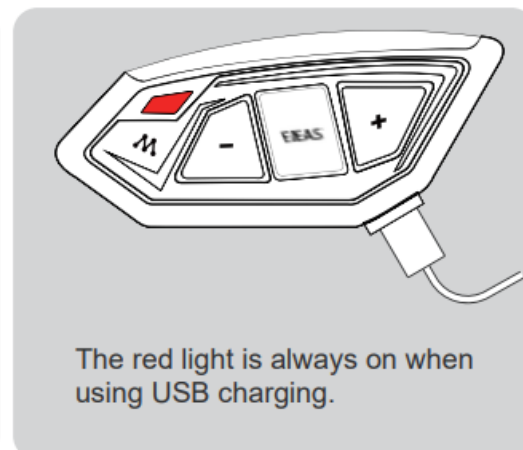

Mesh Intercom

Mesh intercom is a multi-hop technology mesh network intercom (Communication frequency 470-488MHz). On account of large number of participants and unrestricted location, people are able to move at will within the effective range. It is not only superior to the traditional Bluetooth chain intercom, but has a longer transmission distance and better anti-interference ability.

Features: Intercom with up to 20 people, 5 channels in total. Voice can be relayed and teams have a maximum communication distance of about 2 kilometers. If participating in campaign mode as a listener, there is no limit to

the number of people who can join the intercom in a listen-only manner.

When using Mesh Intercom, you can mute the microphone with a short press of the < M Button >, so that the sound of your own voice will not be sent to others.

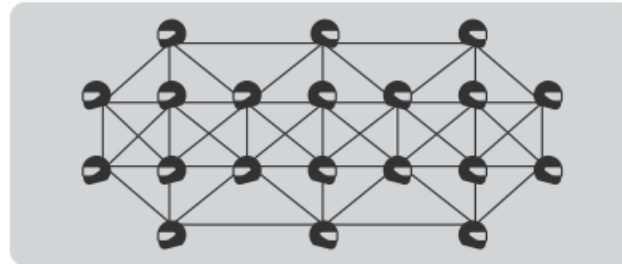
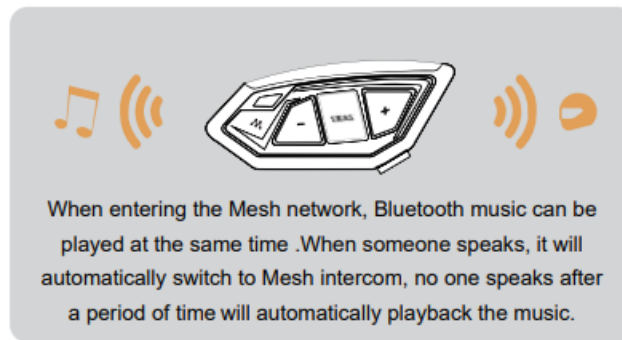

Microphone Mute

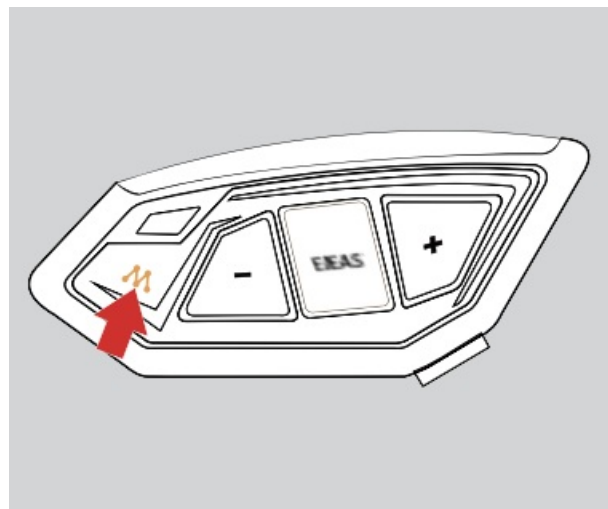

“Microphone Mute”

Press <M Button> to unmute.

“Microphone unmute”

VOX Voice Sensitivity

When using Mesh intercom, the system will enter a sleep mode when there is no speech detected. Speaking will immediately activate the system and start the intercom. Users can adjust the voice activation sensitivity to suit their own voice and avoid false activations or the need for excessively loud sounds to activate the system.

There are 5 levels of sensitivity settings, default level 3. Level 5 has the highest sensitivity and is the easiest to activate the system, level 1 has the lowest sensitivity.

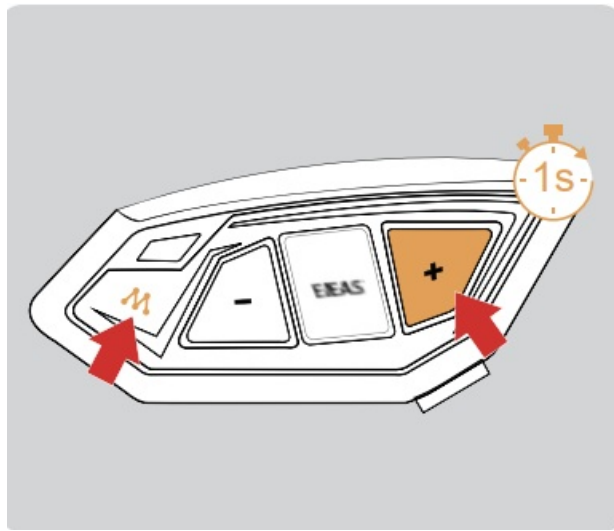

After turning on Mesh intercom, press and hold the <M Button>+<Volume +> to cycle through sensitivity.
1->5->1 cycle switching.
“{VOX n} n is 1~5, indicating 5 levels ”

Pairing Steps as Members

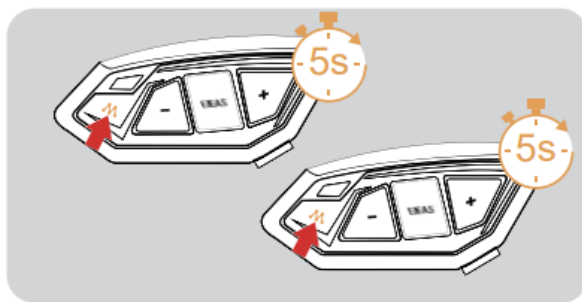

- 1 All devices first enter the intercom pairing state, long press <M Button> (about 5s) until you hear a prompt and the red light and green light flash alternately.

Red light and green light flash alternately
? “Mesh Pairing”

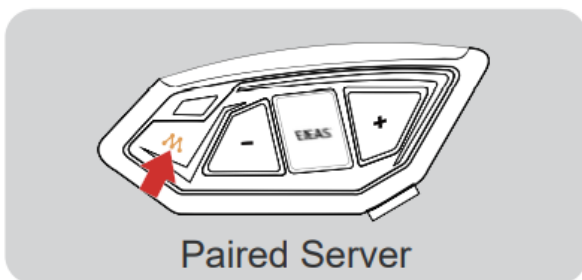

- 2 Take one of them as the paired server, press <M Button> , you will hear a beep and the red light and green light will flash alternately.

Red light and green light flash alternately
? “Bi”

Wait for a moment and hear "Pairing Successful" from all devices, which means the pairing is successful.

? “Pairing Successful”

Wait a few moments and you hear the prompt “Channel n, xxx.x megahertz” from all the intercoms, you can start communicating and hear each other’s voices.

Intercom Reconnection

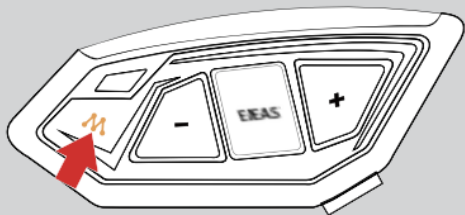

When you power on the intercom for the next use, short press the <M Button>.

You will hear the prompt "Join the Mesh." Wait for a moment, and you will hear the , prompt " Channel n, xxx.x megahertz", you can talk to each other.

Turn off MESH Intercom

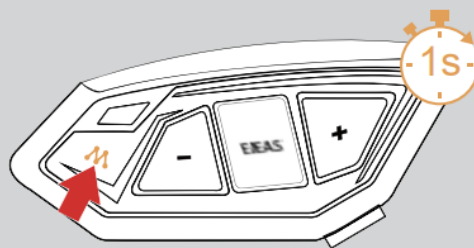

Press and hold the <M Button> (about 1s) to turn off Mesh Intercom . The voice prompts "Mesh Close".

If the device is powered off without turning the intercom off, the intercom will be automatically restored upon the next power-on.

Pairing Steps as Listeners

To become a team listening role, the prerequisite is that the other intercoms have been paired to form a team simultaneously. The pairing steps is taken as followed.

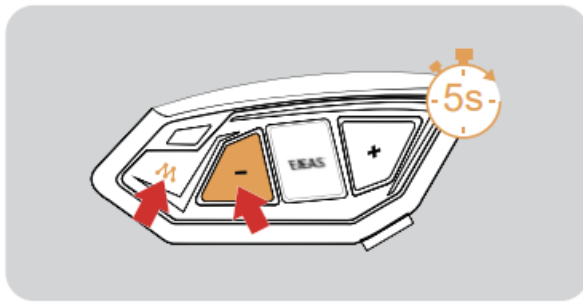

1

Take the intercom to be paired, enter listening mode pairing, long press <M Button> + <Volume -> (about 5s), and prompt "Listen Mesh Pairing", the red light and green light will flash alternately.

 Red light and green light flash alternately
? "Listen Mesh Pairing"

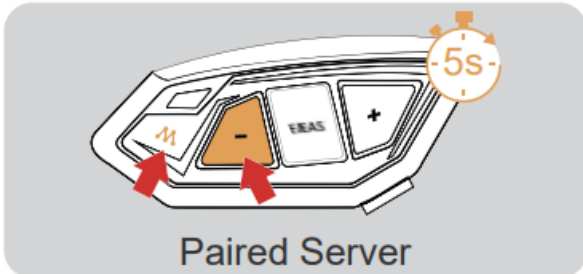

2

Take an intercom that has been paired as a paired server, entering listening mode pairing, and press and hold <M Button> + <Volume -> (about 5s) to prompt "Listen Mesh Pairing".

Note: Unjoined machines can only be joined again through the server.

? "Listen Mesh Pairing"

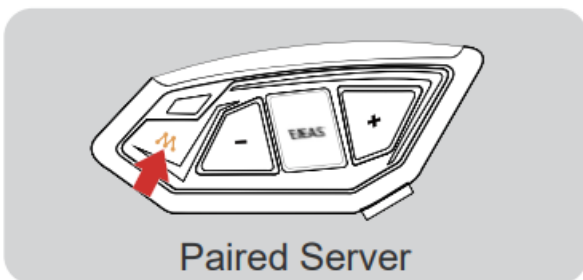

3

Short press the <M Button>, you will hear a beep and the red light and green light will flash alternately.

 Red light and green light flash alternately
? "Du"

Wait a moment and hear "Pairing Successful" from all intercoms. Wait a few more minutes and hear "Channel n, xxx.x MHz". This means that you have joined the intercom network and can communicate with others.

Intercom Channel Switching

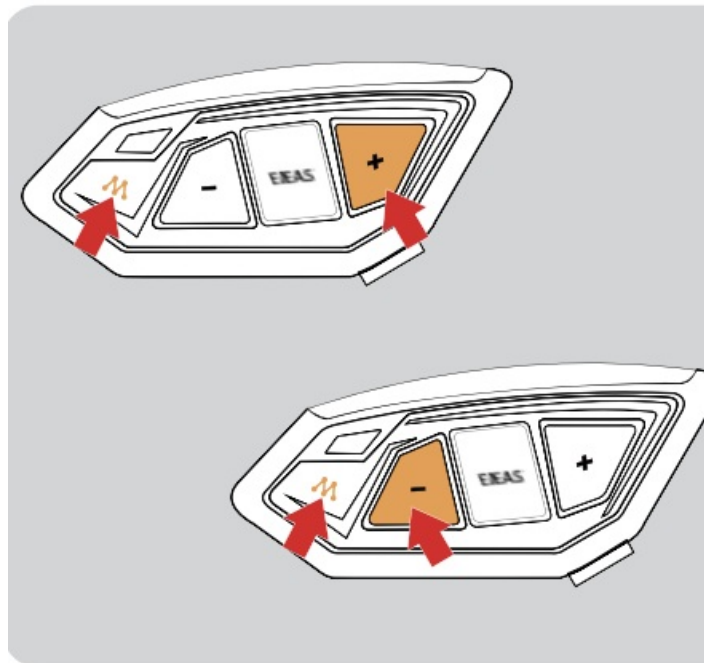

There are 5 channels in total, short press <M Button> + <Volume ->/<Volume +> to switch channels forward or backward. Note that the whole team needs to keep the same channel to talk to each other.





"Channel n xxx.x MHz"

Bluetooth Intercom

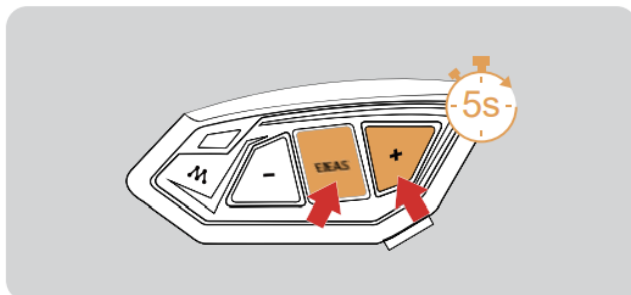
How To Pair With The Device



1 After powering on the device, press and hold <Phone/Power Button> + <Volume +> (about 5s) until the red and blue lights flash alternately, and the pairing voice prompts "Intercom Pairing". Wait for connection to other intercoms.

 Red light and blue light flash alternately
 "Intercom Pairing"

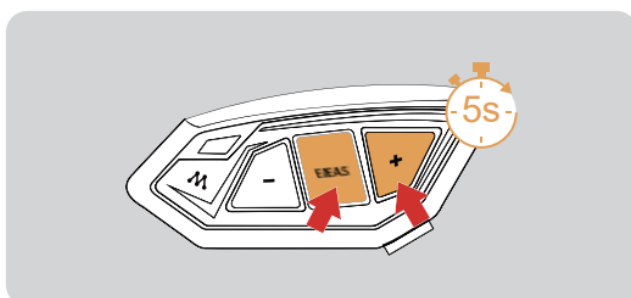

2 The other intercom enters the pairing state using the same operation. After the two intercoms discover each other, one of them will initiate the pairing connection.



The connection is successful and the intercom begins.



"Pairing Successful"

1. When both Mesh intercom and Bluetooth intercom are enabled, when no one is speaking on the Mesh network

(including oneself), it will automatically switch to Bluetooth intercom.

2. When someone is speaking on the Mesh network (excluding oneself) while in Bluetooth intercom, Mesh will automatically preempt and switch to Mesh Intercom status, Bluetooth intercom is not working.
3. When you are in Bluetooth intercom and want to speak to others on the Mesh network, simply press the <M Button> to switch to Mesh intercom.

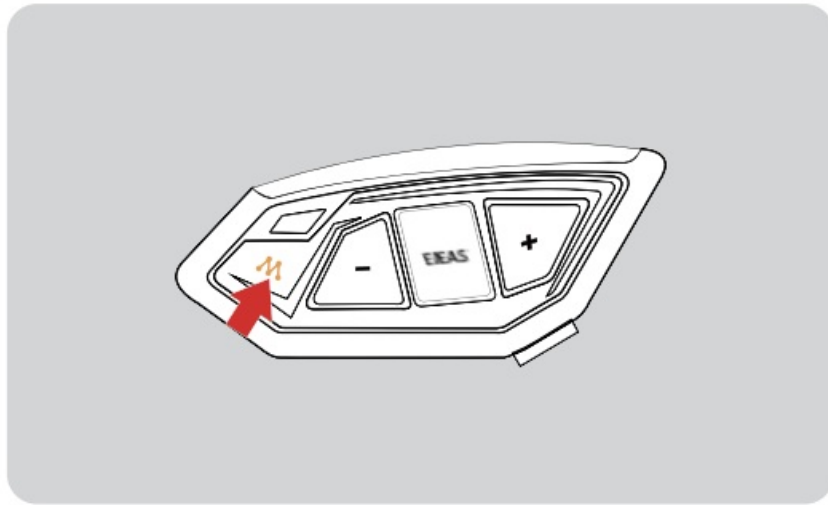

Pairing with The Old Models

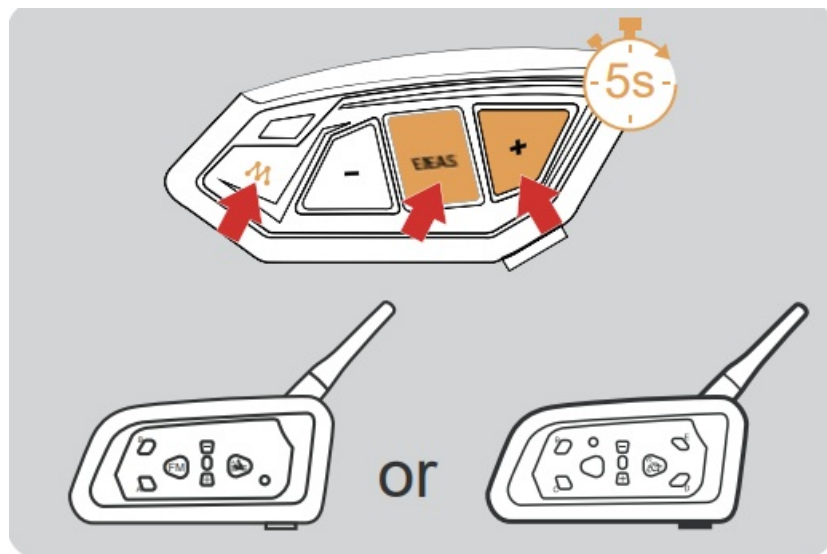

1. Simultaneously press and hold <Phone/Power Button> + <Volume +> + <M Button> for approx. 5 seconds to start pairing (red and blue lights flash alternately).



Red light and blue light flash alternately

2. For older models (V6/V4) follow the instructions to enter the search and wait for successful pairing.

Pairing With Headsets or Other Branded Bluetooth Intercoms Search

Note: It is not guaranteed to be compatible with all Bluetooth headsets or intercoms on the market.

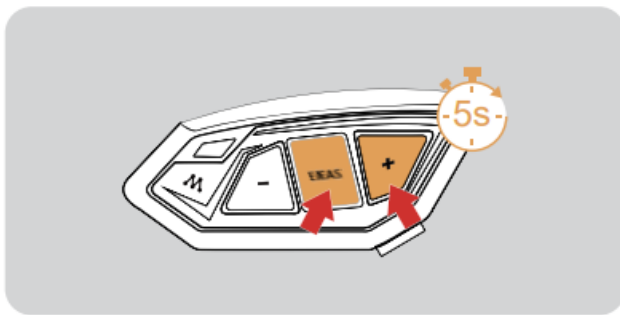

- 1 Long press <Phone/Power Button> + <Volume +> (approx. 5s) until the red and blue lights flash alternately and the prompt "Intercom pairing" is displayed.

Red light and blue light flash alternately
 ? "Intercom Pairing"

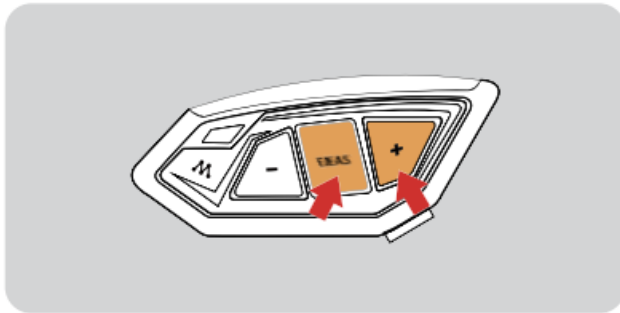

- 2 Click again on <Phone/Power Button> + <Volume +>. The voice prompts "Intercom Searching". The red and blue lights flash alternately.

Red light and blue light flash alternately
 ? "Intercom Searching"

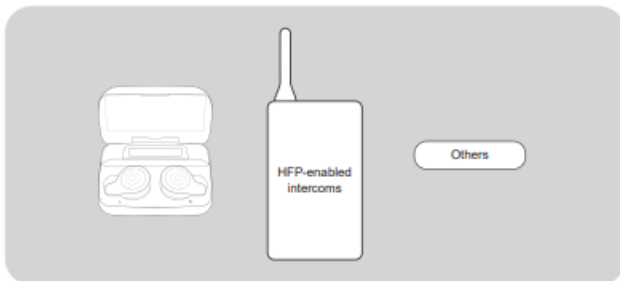

- 3 At this point the intercom is searching for other intercoms in the pairing state, and when it finds another intercom, it will initiate the pairing.

Successful Pairing ? "Pairing Successful"

Intercom Connection

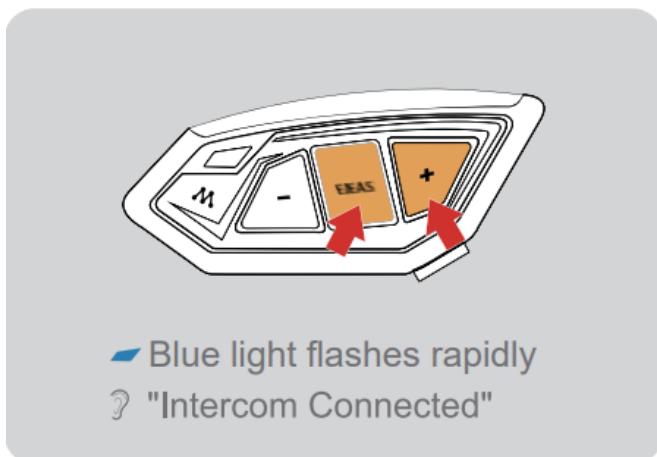

Intercom Disconnection

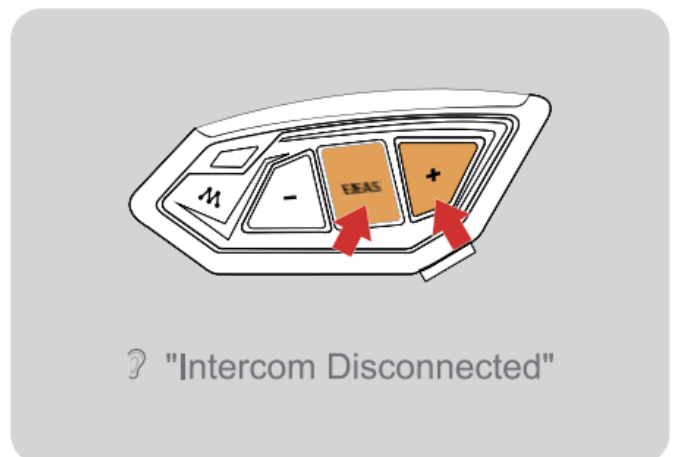

Mobile Phone Pairing

This intercom supports connection to mobile phones for playing songs ,making calls, and waking up voice assistants. Up to 2 mobile phones can be connected at the same time.

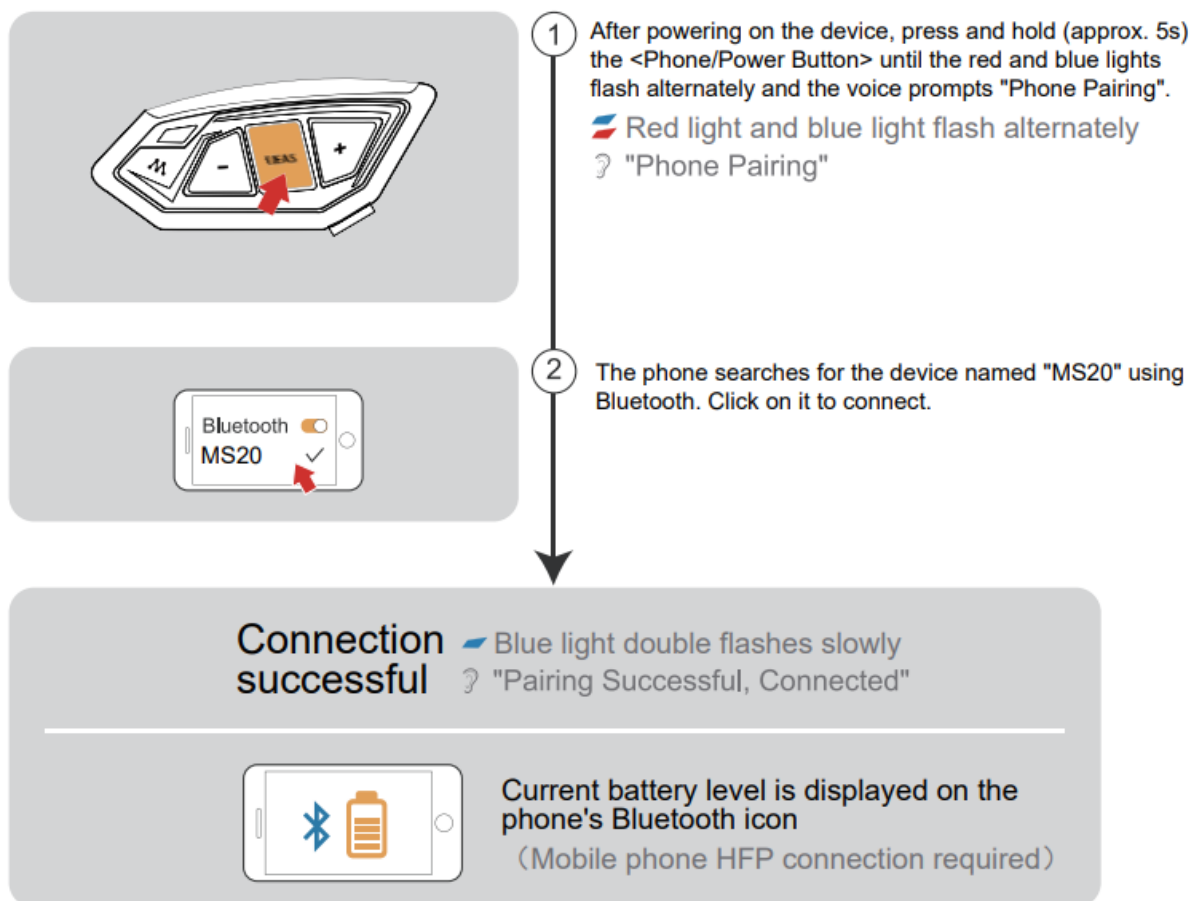

Bluetooth Reconnection With Mobile Phones

After switching on, it automatically connects back to the last connected phone Bluetooth. When there is no connection, click on the < Phone/Power Button > to reconnect with the last mobile device that was connected to Bluetooth.

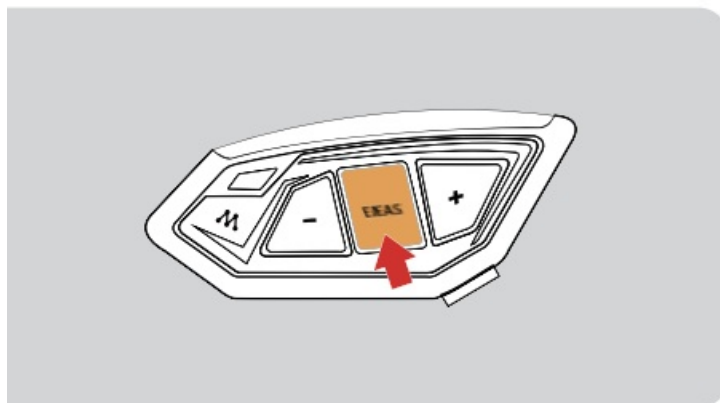

Mobile Control

Call Answering

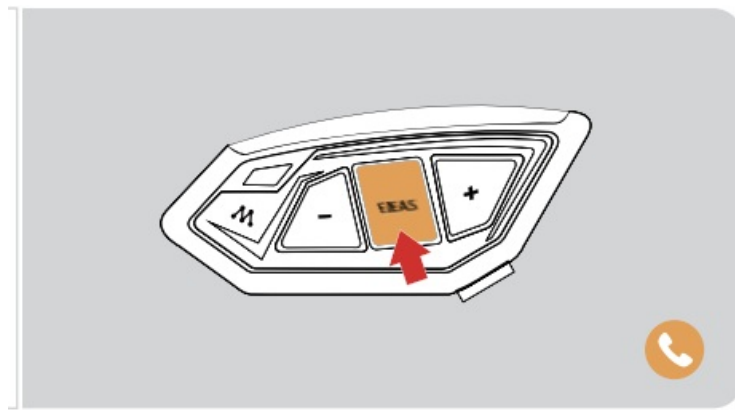

When a call comes in, click on the <Phone/Power Button>

Call Rejection



When a call come,press the <Phone/Power Button> for about 2s

Hang Up



During a call ,click on the <Phone/Power Button>

Call Redial



When standby/playing music,quickly double-click the <Phone/Power Button>.

Cancel Redial



During redial,click on <Phone/Power Button>

Phone Priority

When a call comes in, it will interrupt Bluetooth music, FM radio, intercom, and resume after hanging up.

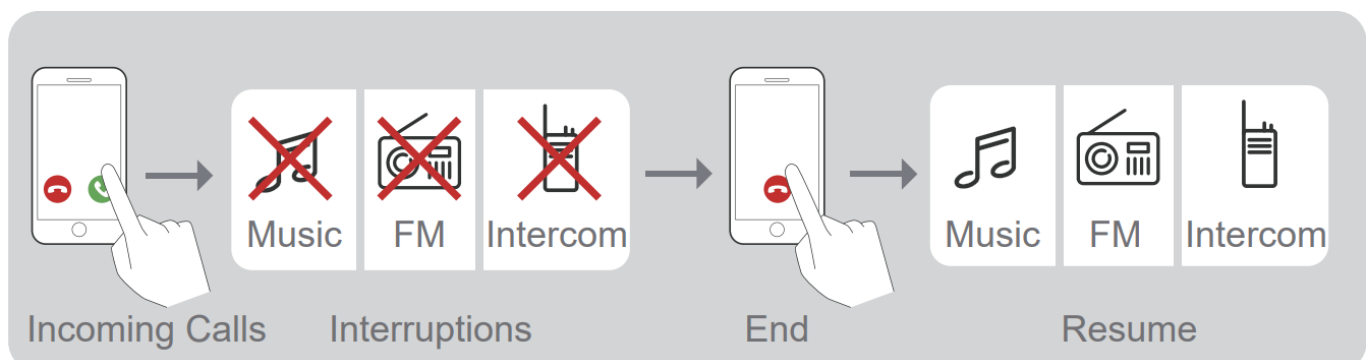

Voice Assistant

When in standby/playing music, press and hold <Phone/Power Button>, it depends on your mobile phone.

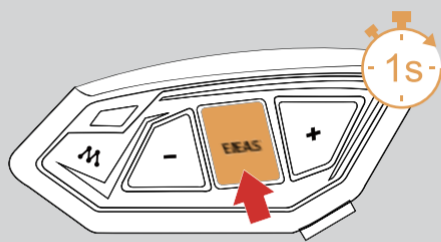

Press and hold <Phone/Power Button> to wake up voice assistant.

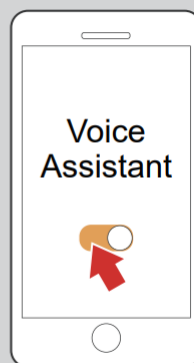

"Open Music"

"Previous Song"

"Next Song"

"Call EJEAS"

"Open Navigation"

Music Control

Play/Pause



Previous Song

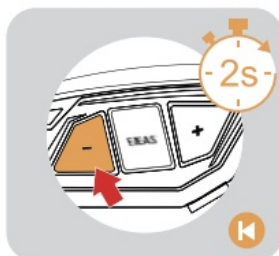

Next Song



Music Playing



Volume -

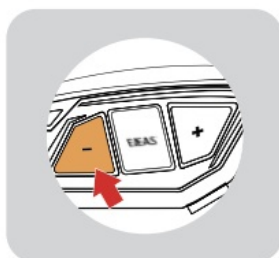

Volume +



FM Radio

FM On/Off 76-108MHZ

After turning on the FM radio, it will automatically search for stations and play the found station. FM can be turned on during the intercom, and you can listen to the radio while talking.

Switching Channels

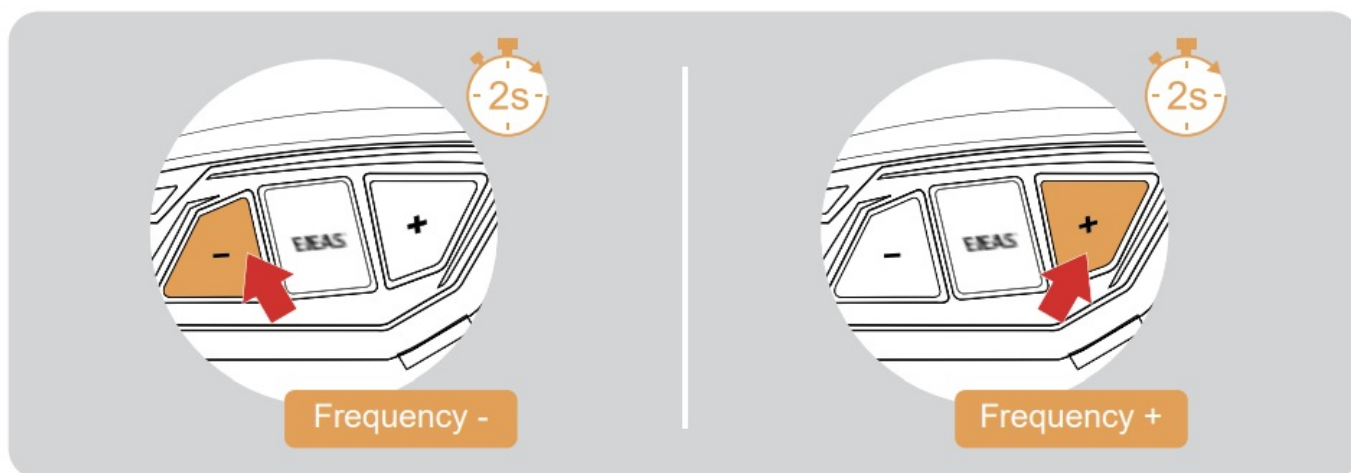

Volume Adjustment

FM with a total of 7 volume levels When using FM alone

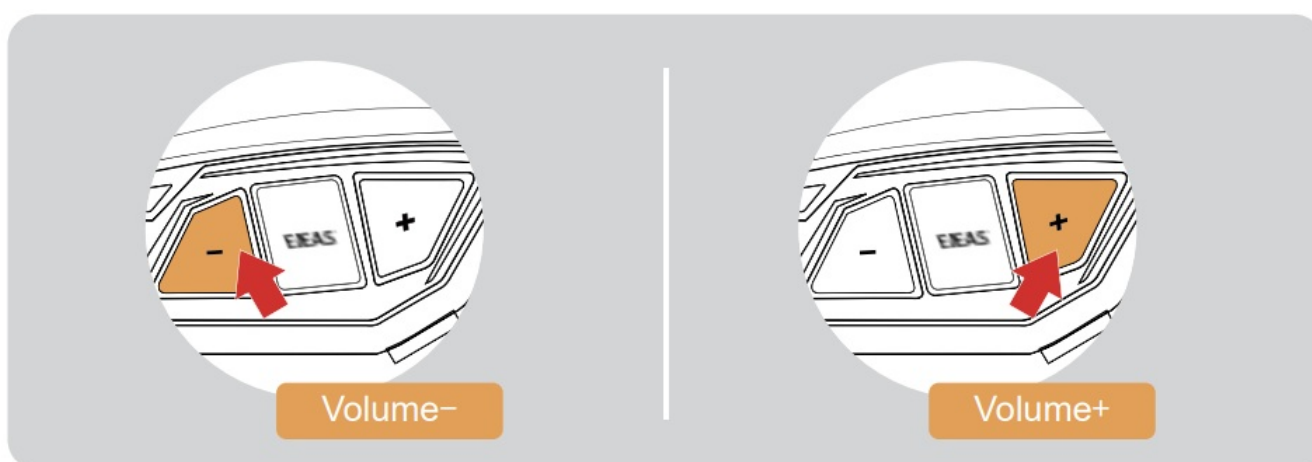

When FM + Intercom

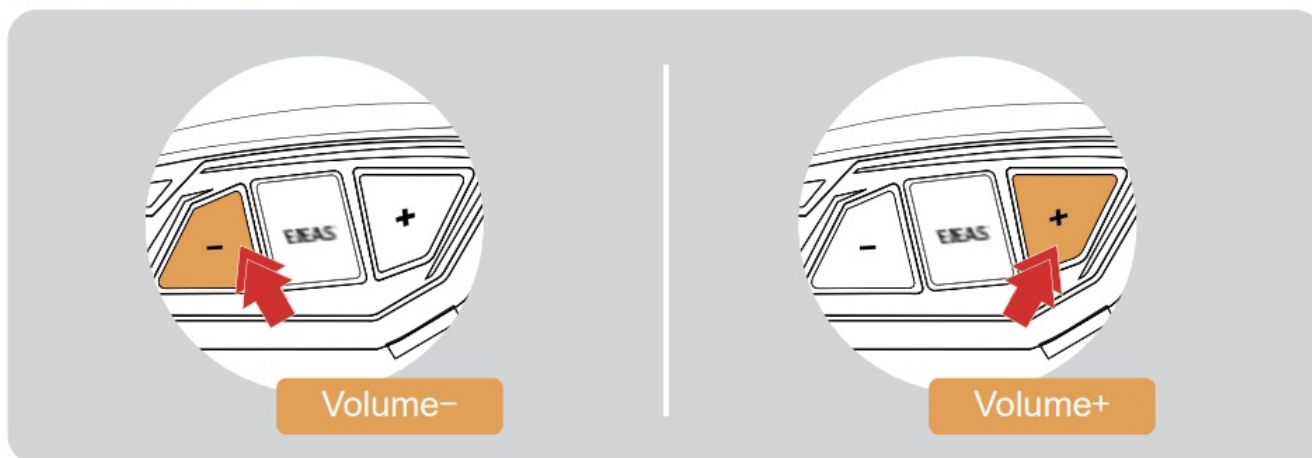

Music Share

Share the music played by Bluetooth on your phone to another device, and this function cannot be used during Bluetooth intercom.

This function cannot be used when two phones are connected simultaneously.

1. Take an intercom as the host, connect it to the phone, and the other one is the slave.
2. Press the <Phone/Power Button>+<Volume -> at the same time between the host and slave to enter the music sharing search connection state.



"Music Share"

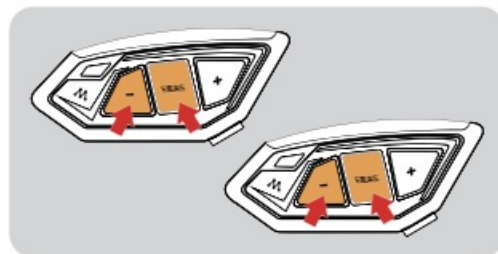
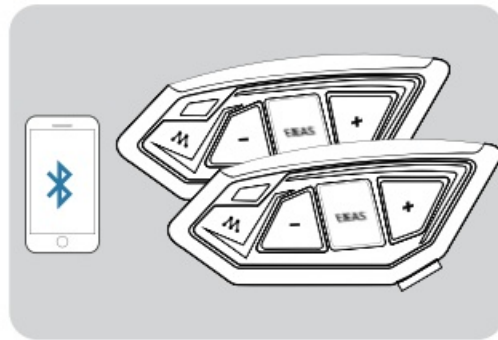

After the connection is successful, play the phone music of the host, and the music can also be played from the speaker.



"Music Share Connected"

Press the <Phone/Power Button>+<Volume -> again to exit music sharing.

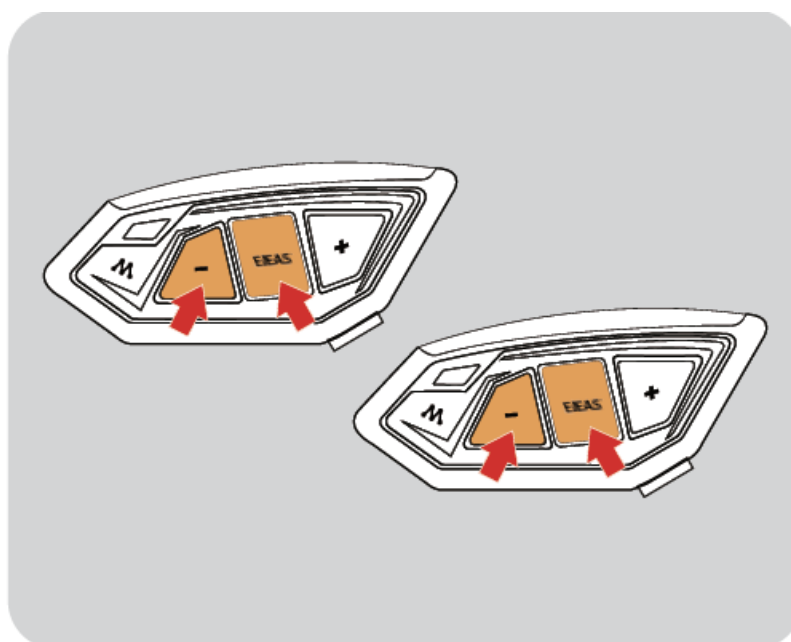

EUC Remote Controller (Optional)

Buttons Introduction

Buttons	Actions	Function
Volume +	Short press	Volume +
	Long press	Next song when music is playing. Increase the frequency when FM is on
	Double click	FM volume +
Volume –	Short press	Volume –
	Long press	<ul style="list-style-type: none"> • Previous song when music is playing. • Decrease the frequency when FM is on
	Double click	FM Volume –
Phone Button	Short press	<ol style="list-style-type: none"> 1. Answer a call when it comes in 2. On call, hang up 3. Music play/pause 4. When no mobile phone is connected Connect the last connected phone
	Long press	Reject calls Voice assistant

	Double click	Last number redial
A Button	Short press	1. Turn on mesh intercom 2. Mute/unmute microphone when mesh is connected
	Long press	Turn off Mesh Intercom
	Double click	Switch VOX sensitivity during Mesh intercom
B Button	Short press	1. Turn on mesh intercom 2. Mute/unmute microphone when mesh is connected
	Long press	Turn off Mesh Intercom
	Double click	None

Buttons	Actions	Function
C Button	Short press	Initiate Bluetooth Intercom Connection
	Long press	Disconnect the intercom
	Double click	Music sharing start/end
FM Button	Short press	Turn FM on/off
Volume – + FM Button	Super Long Press	Clear handle pairing records

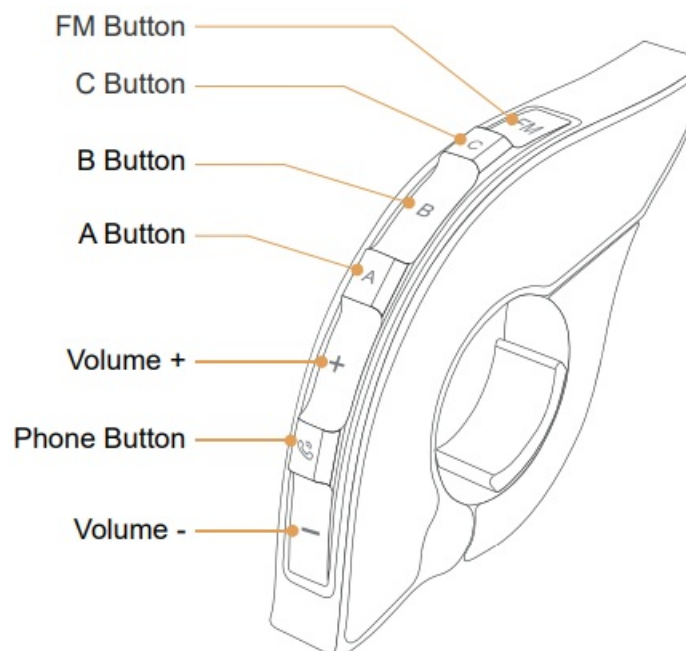

EUC Pairing

1. Press and hold the <Phone/Power Button> + <Volume -> for about 5s to enter the pairing mode, the voice prompts "Remote Control Pairing", the red and blue lights flash alternately, if the pairing is not successful within 2 minutes, exit the pairing.
Red light and blue light flash alternately
2. Press and hold the < FM Button >+ < Volume - > on the handle for about 5s to clear the record until the red and blue lights come on.
3. Click any button of EUC

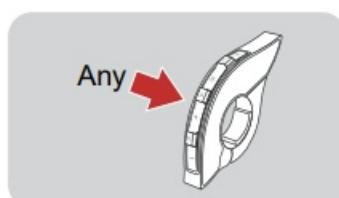
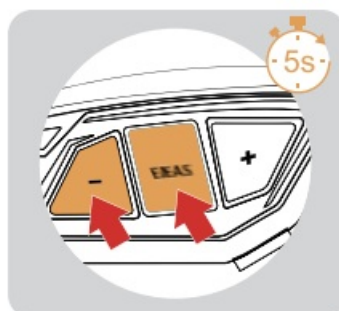

Pairing Successful

"Pairing Successful" (No successful pairing within 2 minutes, exit the pairing)

EUC Handle Operation

Mesh intercom reconnect/disconnect and mobile phone control are the same as on the machine.

Bluetooth Intercom Connection

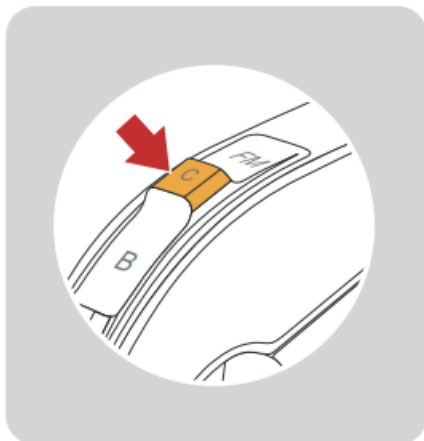

Bluetooth Intercom Disconnection

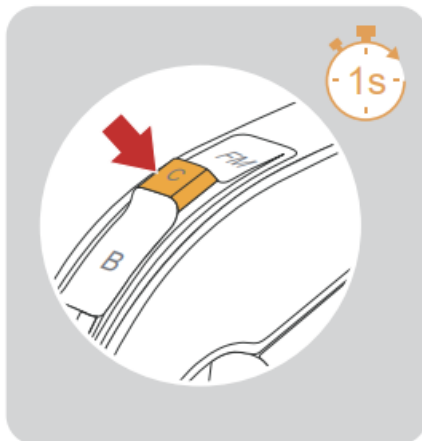

FM On/Off

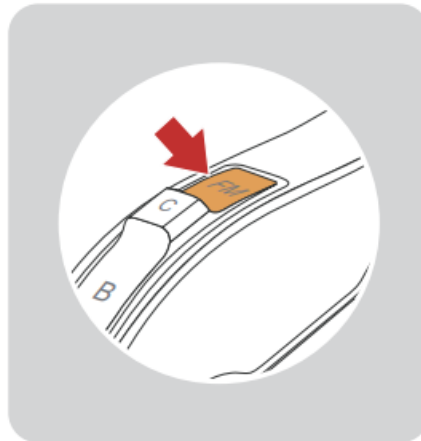

Restore Default Settings

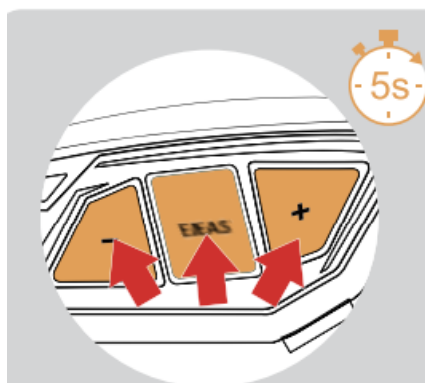

Press and hold <Phone/Power Button> + <Volume +> + <Volume -> for about 5s, the voice prompts "Restore Default Settings" to delete the pairing record, and then automatically reboot the phone.

? "Restore Default Settings"

Firmware Upgrades

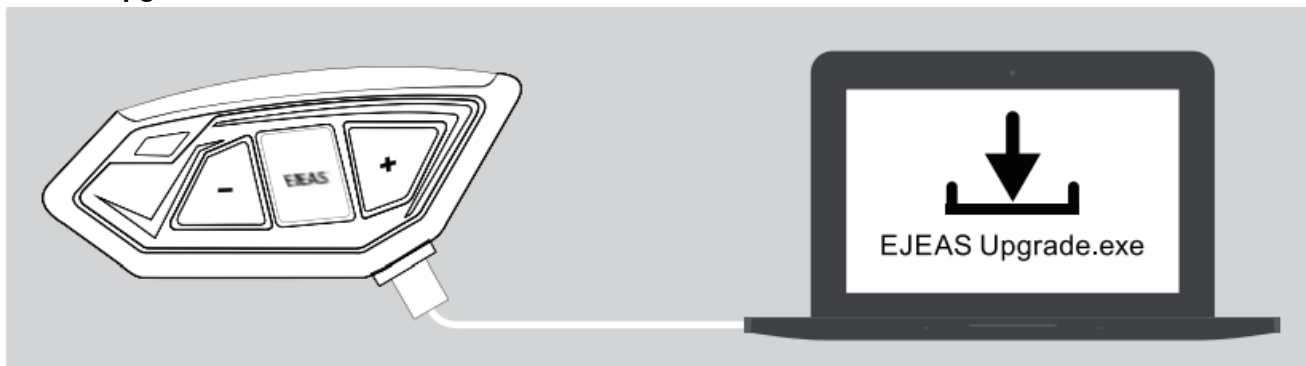

Connect to the computer with a USB data cable. Download and open the "EJEAS Upgrade.exe" upgrade software. Click on the "Upgrade" button to start and wait for the upgrade to complete.

Mobile App



iOS



Andriod

1. Download and install EJEAS SafeRiding mobile APP for the first time.
2. Press and hold (approx. 5s) <Phone/Power Button> until the red and blue lights flash alternately to enter phone pairing.
Red light and blue light flash alternately
3. Open the APP, click on the Bluetooth icon in the top right corner, the interface shows the name of the intercom device searched, select the intercom device to be connected, click to connect.
(IOS system need to enter the phone pairing again, in the system settings->Bluetooth, connect audio Bluetooth).

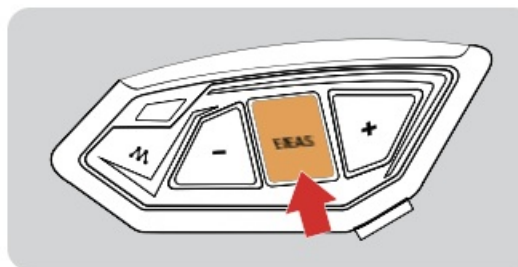

Open the APP the next time you use it. Click the Bluetooth icon in the top right corner and click to select Intercom for connection from the paired devices.

APP provides intercom group, music control, FM control, switch off, check authenticity and other functions.

Documents / Resources

	<p>EJEAS MS20 Bluetooth Intercom Headset [pdf] User Manual</p> <p>MS20 Bluetooth Intercom Headset, MS20, Bluetooth Intercom Headset, Intercom Headset, Headset</p>
---	--

References

- [User Manual](#)

Manuals+. [Privacy Policy](#)

This website is an independent publication and is neither affiliated with nor endorsed by any of the trademark owners. The "Bluetooth®" word mark and logos are registered trademarks owned by Bluetooth SIG, Inc. The "Wi-Fi®" word mark and logos are registered trademarks owned by the Wi-Fi Alliance. Any use of these marks on this website does not imply any affiliation with or endorsement.