



Einhell RTB-003 Router Table Instruction Manual

[Home](#) » [Einhell](#) » Einhell RTB-003 Router Table Instruction Manual 

Contents

- 1 Einhell RTB-003 Router Table
- 2 Safety information
- 3 Layout and items supplied
- 4 Proper use
- 5 Technical data
- 6 Assembly
- 7 Fixing the table legs and extension
 - 7.1 Attaching the switch box and plug
 - 7.2 Installing the milling machine on the table
 - 7.3 Fixing the length stop
 - 7.4 Attaching workpiece guides
- 8 Starting up
 - 8.1 ON/OFF switch (6a)
 - 8.2 Dust extractor (9)
 - 8.3 Socket for Router (6b)
- 9 Working with the router table
 - 9.1 Router without continuous operation mode
 - 9.2 Dust extraction
- 10 Cleaning and ordering replacement parts
 - 10.1 Cleaning
 - 10.2 Ordering replacement parts
- 11 Documents / Resources
 - 11.1 References
- 12 Related Posts

Einhell

Einhell RTB-003 Router Table



- **Caution** – Read the operating instructions to reduce the risk of accident.
- **Wear ear-muffs.** The impact of noise can cause damage to hearing.
- **Wear a breathing mask.** Dust which is injurious to health can be generated when working on wood and other materials. Never use the device to work on any materials containing asbestos!
- **Wear safety goggles.** Sparks generated during working or splinters, chips and dust emitted by the device can cause loss of sight.

When using equipment, a few safety precautions must be observed to avoid injuries and damage. Please read the complete operating manual with due care. Retain this manual in a safe place, so that the information is available at all times. If you give the equipment to any other person, hand over these operating instructions as well. We accept no liability for damage or accidents which arise due to non-observance of these instructions and the safety information.

Safety information

Important! The following basic safety action measures to be taken when using electric tools to protect the user from electric shocks and the risk of injury and fire.

Read all the following information before you use this electric tool and keep these safety instructions in a safe place.

1. For your own safety, read and observe this safety information for the router table and the information supplied by the manufacturer of the router.
2. The router table must always be securely fastened to a workbench in a horizontal position.
3. Keep your workplace clean and well illuminated.
4. Avoid abnormal working postures. Make sure you stand squarely and keep your balance at all times.
5. Never use the machine in the vicinity of combustible materials, liquids or gases.
6. Wear safety goggles, a visor, a breathing mask, an apron and long tight sleeves.
7. Keep children away. Do not allow other persons, particularly children, to touch the tool. Keep them out of your work area.
8. Always leave the safety devices in position and make sure that they are in good working order.
9. Check at regular intervals that all screws and nuts are fastened securely enough, as they may work loose as the result of vibrations.
10. Make sure that the power cable is a safe distance from the working area.

11. Do not use the router table with high performance electric tools that are not suitable for the accessory device.
12. Do not try to machine workpieces which are obviously too big for the router table.
13. Never leave an electric tool unattended when it is running. Always switch off your electric tool before leaving it.
14. Always pull out the power plug when not in use, before carrying out any maintenance work and before changing the tool.
15. Before using, make sure that the router is securely fastened in its holder in accordance with the instructions.
16. Do not overload your tool; allow the router to work without applying any pressure.
17. Check to see if all parts are mounted. In this connection, please read the instructions and particularly the safety information. Never use the machine if it is not fully assembled.
18. Use the accessory parts and electric tools for their intended purpose only.
19. Check the accessory parts to make sure that they are not damaged. Also make sure that moving parts, clamping devices and safety guards are working correctly.
20. Be alert at all times. Concentrate on what you are doing. Use common sense when working. Never use the electric tool when you are distracted.
21. Keep your electric tools in a safe place. When equipment is not being used it should be kept in a dry, closed place out of children's reach.
22. Wear suitable work clothes. Do not wear loose clothing or jewelry as they may get caught in moving parts. Non-slip shoes are recommended. Wear a hair net if you have long hair.
23. Always remove keys and wrenches after use. Before switching on, make sure that all keys and wrenches have been removed from the tool.
24. Before you put the router into operation, check that the routing cutter is properly seated.
25. The router table may be used only for routing work on flat wood and flat wood-based materials.
26. Provide an additional support for longer workpieces.
27. Keep your hands away from the routing cutter. Use a push stick if necessary.
28. Use the router table only when a dust extraction device is connected.
29. Always guide the workpiece against the running direction of the routing device.
30. Never reach under the router table when the machine is running.
31. Never cut over metal parts, screws, nails etc.
32. To avoid damage to the router, make sure there are no foreign objects attached to the workpiece.

Layout and items supplied

1. Longitudinal stop
2. Table width extension
3. Feet
4. Table top
5. Workpiece guides
6. a ON/OFF switch
b Socket
7. Angle stop
8. Transparent router cover
9. Connection for dust extractor

10. Table insert
11. Installation material for feet and table width extension
12. Installation material for router
13. Installation material for workpiece guides
14. Installation material for longitudinal stop
15. Clip for routers without continuous operation mode

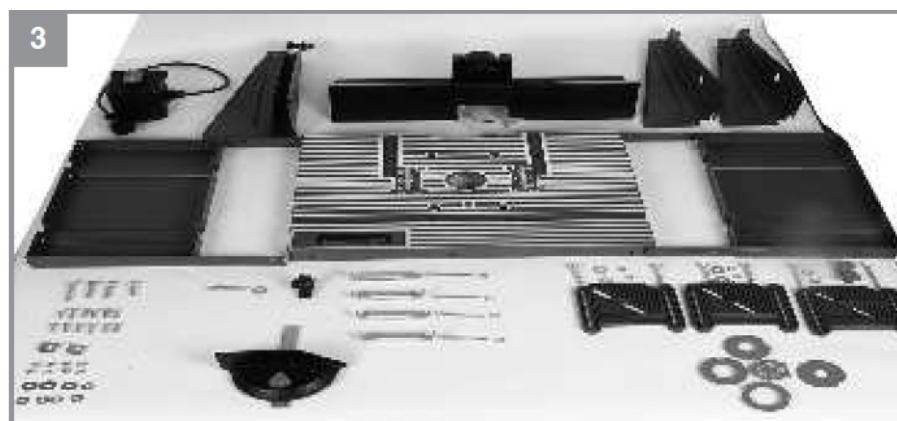
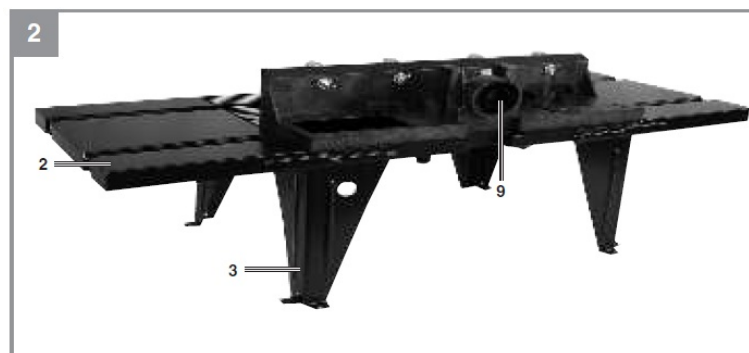
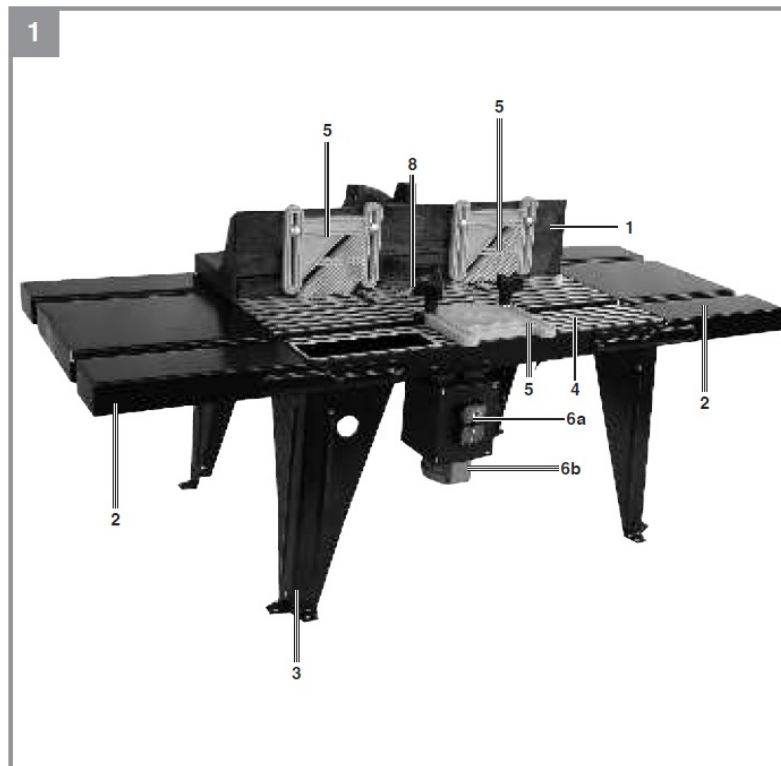

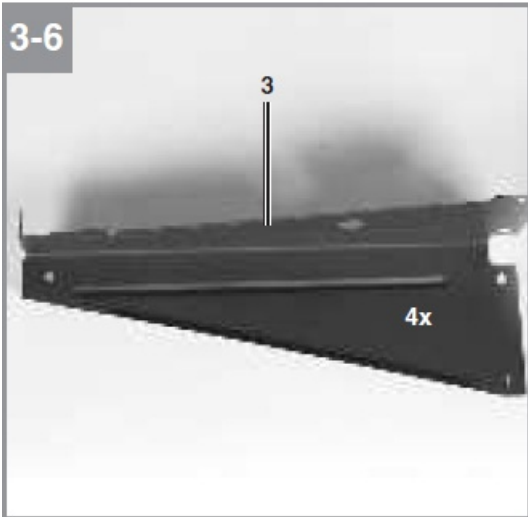
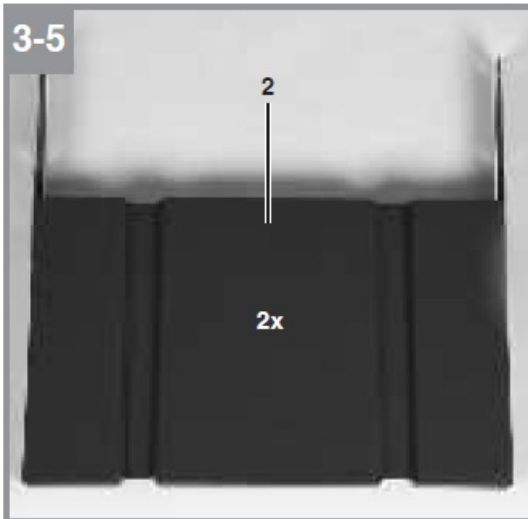
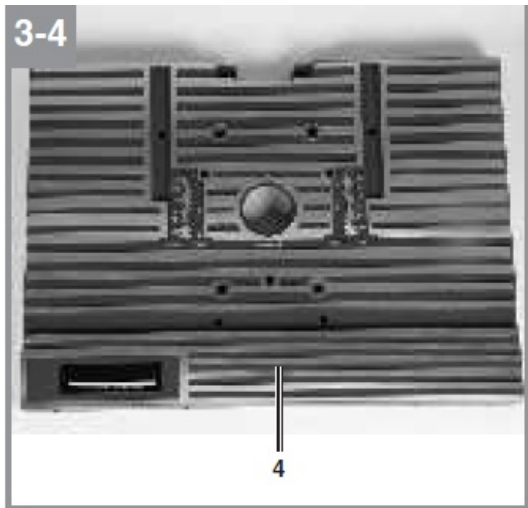

3-7

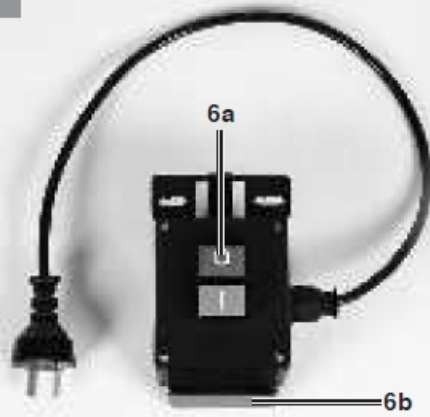

3-8



3-9



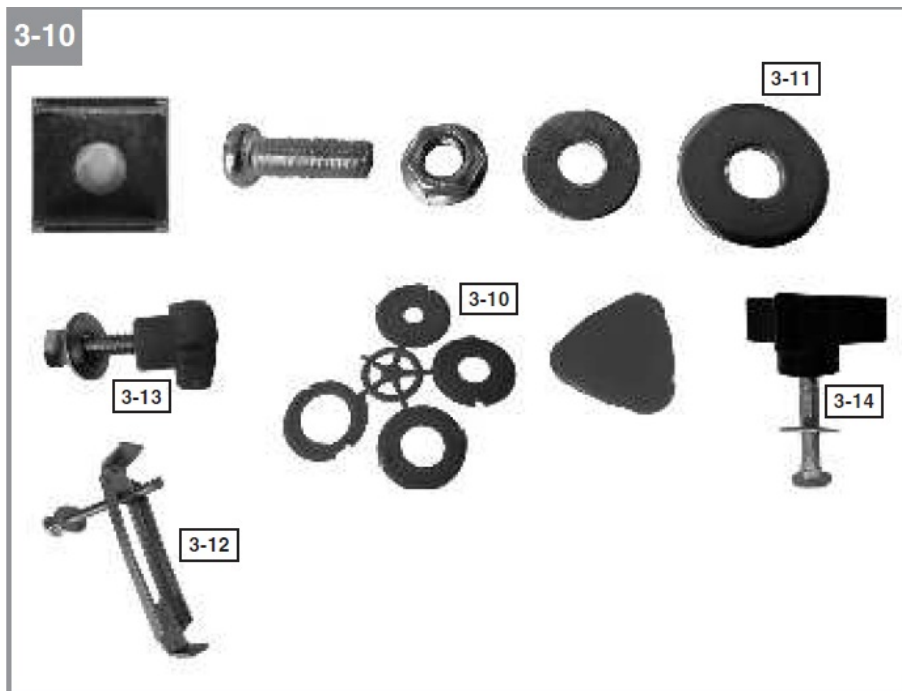

Important! There is no router supplied with the router table!

Proper use

The router table is designed for stationary jobs with a suitable router. Please observe the following information and the information supplied by the manufacturer of the router.

Technical data

See warranty card of your country.

Sound and vibration

Sound and vibration values were measured in accordance with EN 62841.

Wear ear-muffs.

The impact of noise can cause damage to hearing.

Total vibration values (vector sum of three directions) determined in accordance with EN 62841.

Warning!

The specified vibration value was established in accordance with a standardized testing method. It may change according to how the electric equipment is used and may exceed the specified value in exceptional circumstances.

The specified vibration value can be used to compare the equipment with other electric power tools.

The specified vibration value can be used for initial assessment of a harmful effect.

Keep the noise emissions and vibrations to a minimum.

- Only use appliances which are in perfect conditions.
- Service and clean the appliance regularly.
- Adapt your working style to suit the appliance.
- Do not overload the appliance.
- Have the appliance serviced whenever necessary.
- Switch the appliance off when it is not in use.
- Wear protective gloves.

Residual risks

Even if you use this electric power tool in accordance with instructions, certain residual risks cannot be ruled out. The following hazards may arise in connection with the equipment's construction and layout:

1. Lung damage if no suitable protective dust mask is used.
2. Damage to hearing if no suitable ear protection is used.
3. Health damage caused by hand-arm vibrations if the equipment is used over a prolonged period or is not properly guided and maintained.

Assembly

Fixing the table legs and extension

1. Use screws and nuts and a screwdriver.
2. With the table and a table extension upside down and on a flat surface, align the table extensions and slide the table and extensions together.
3. Place the table leg, secure in position with four screws and nuts, but do not tighten completely yet.

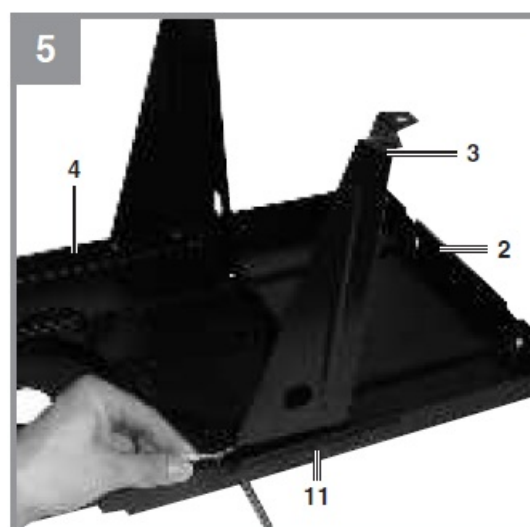
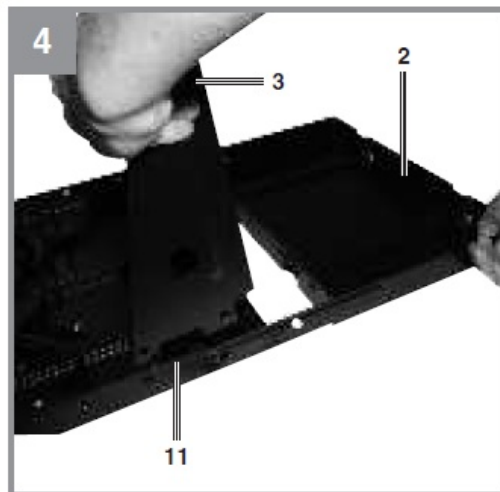

Note: The table leg fits into the table profile with fixing screws inserted from the outside.

4. Repeat step 3. for the opposite table leg.
5. Once the two table legs are approximately fixed, make sure the table and extension are perfectly flat, gently tighten all screws, working from the center outward.
6. Repeat steps 2 through 5 for the other table extension and table legs. Once all four legs are firmly tightened,

turn the assembly over and make
sure the table does not move.

Attaching the switch box and plug

1. Use screws and nuts and a screwdriver.
2. With the milling table standing on the legs, align the two holes in the connection box with the corresponding holes in the table .
3. Use screws from the front of the table and se-cure them with lock nuts.

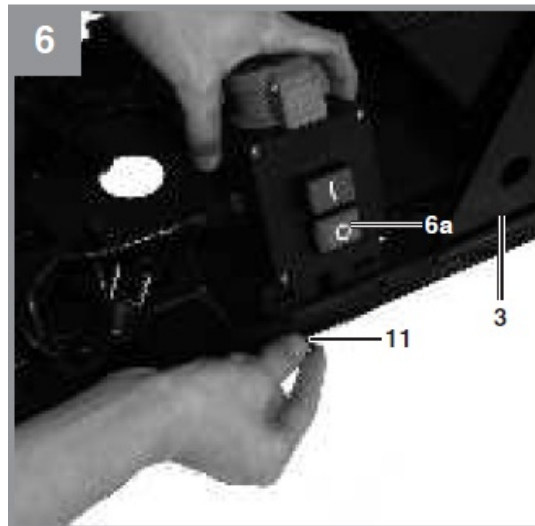

Installing the milling machine on the table

1. Use screws and nuts and a screwdriver.
2. Insert four 50 mm screws into the holes, on top of the table.
3. On the top of the table, fit the bracket, washer and flange nut. Do this for the four screws

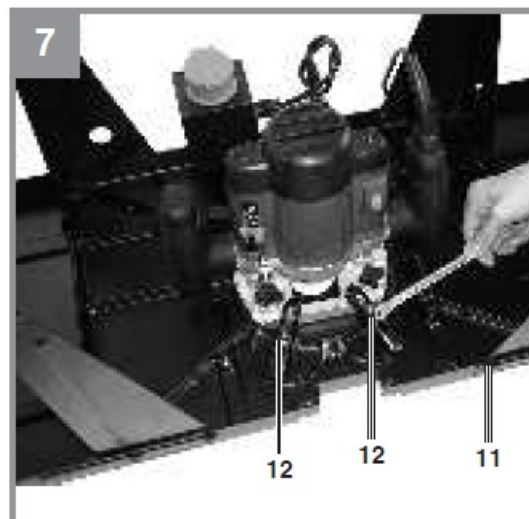

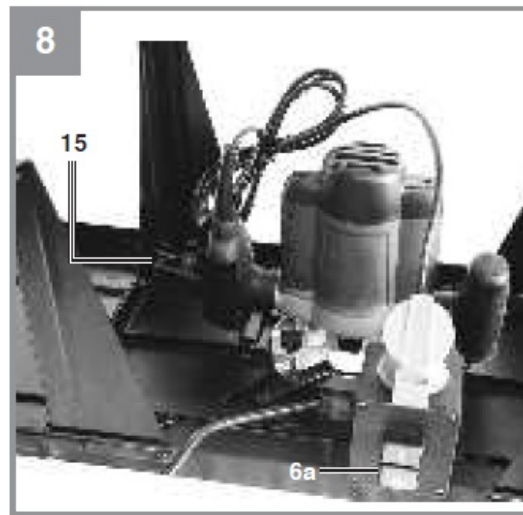

WARNING! BEFORE USING THE ROUTER, REFER TO THE ROUTER'S INSTRUCTION MANUAL FOR INFORMATION ABOUT ITS OPERATION.

WARNING! MAKE SURE THAT THE ROUTER TABLE OR THE ROUTER PLUG IS NOT CONNECTED TO THE POWER OUTLET.

4. Remove the plastic plate from the base of your router before attaching it to the table .
5. Place the router in position on the bottom of the table as centrally as possible. Secure it in position with clamps x 4.

NOTE: Make sure that the router is facing the table.

6. Once the router is in the desired position, tighten the four clamps enough to prevent it from moving while in operation.

Fixing the length stop

1. Use two 40 mm hexagonal screws, washers and locking button fastening screws
2. Insert the screws on the underside of the table through the marked holes.
3. Place the length stop over the screws and secure it in position with the washer and wing screw

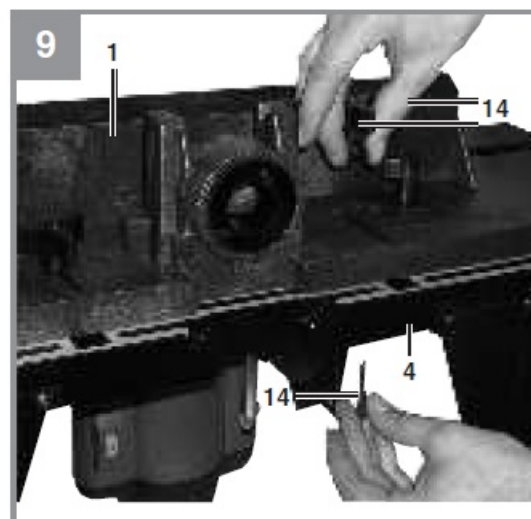

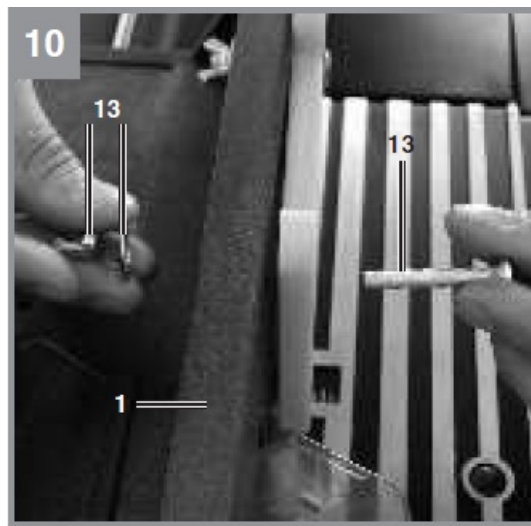

Attaching workpiece guides

1. Use 4 screws, washers and 40 mm wing nuts.
2. Install the part guides on the length stop.

Note: Pay attention to the direction of milling .

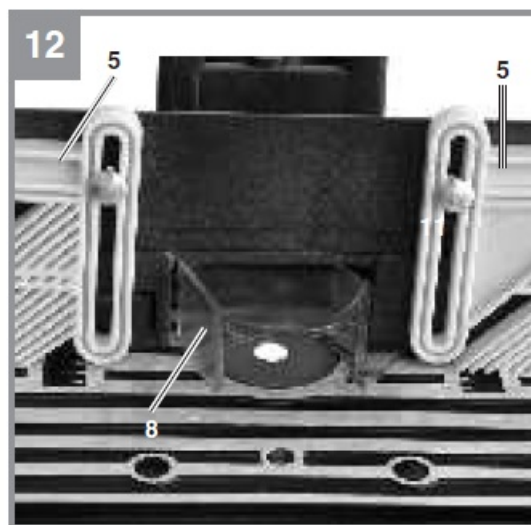
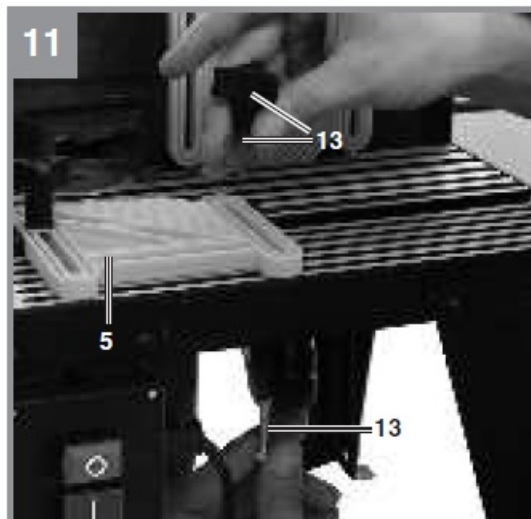

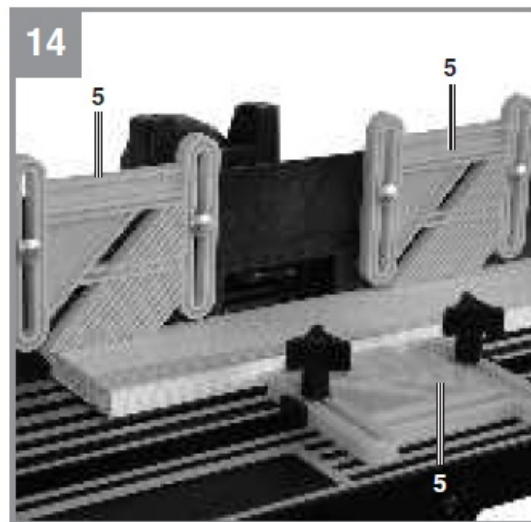
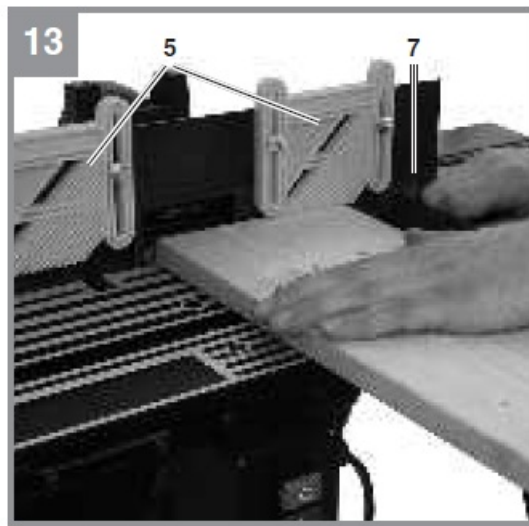

Starting up

ON/OFF switch (6a)

- To turn the machine on, press the green button.
- To turn the machine off again, press the red-button.

Dust extractor (9)

Important! For health safety reasons it is mandatory that you use a dust extractor. You can connect a dust extractor to the vacuum extractor unit adaptor (9).

Socket for Router (6b)

1. Connect plug of router to the socket.
2. Fix the power cable of router table and router in the way that this elements will not disturb a proper router table operation.

Working with the router table

- Insert the routing cutters into the router, then set the speed and routing depth. Refer to the operating

instructions of the router.

- Insert a suitable table insert into the router table.
- Select the table insert (10) so that the distance between the router and table insert is as small as possible. The router, however, must be able to turn unhindered.
- Adjust the workpiece guides (5) in accordance with the dimensions of the workpiece.
- Set the ON/OFF switch of the router to continuous operation.
- Connect the connector cable of the router to the switch (6).
- Connect the switch of the router table to the power supply with a suitable extension cable
- Turn on the router table with the switch (6a).
- After each adjustment it is imperative to carry out a test cut on a piece of scrap wood and readjust the workpiece guides if necessary.
- Push the workpiece along the workpiece guides.
- (5) and past the routing head in the direction of the spring disks.
- Exert only little thrust on the workpiece. Use a push stick in case of small workpieces.
- Important! Pull out the power plug before performing any cleaning, adjusting and maintenance work. Also, pull out the power plug when you have finished working.

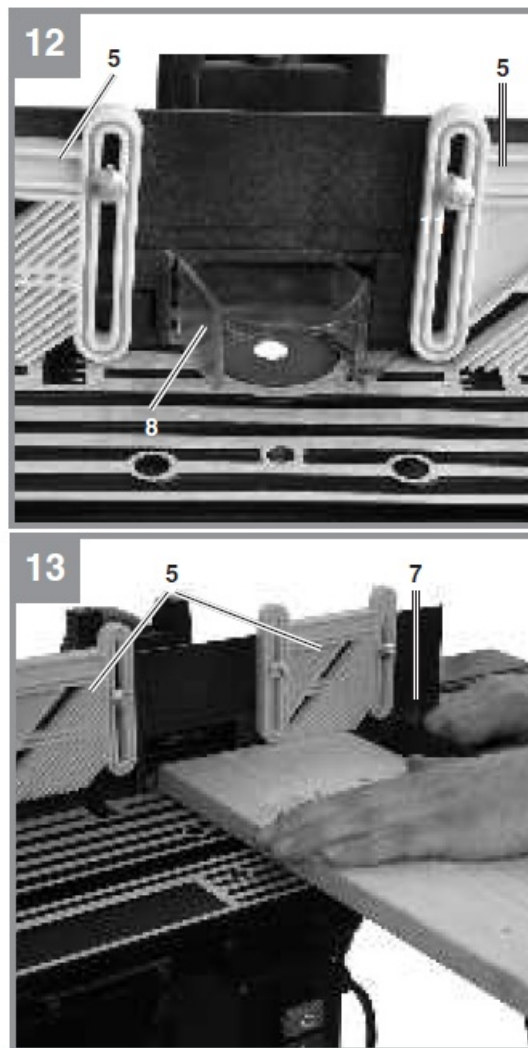

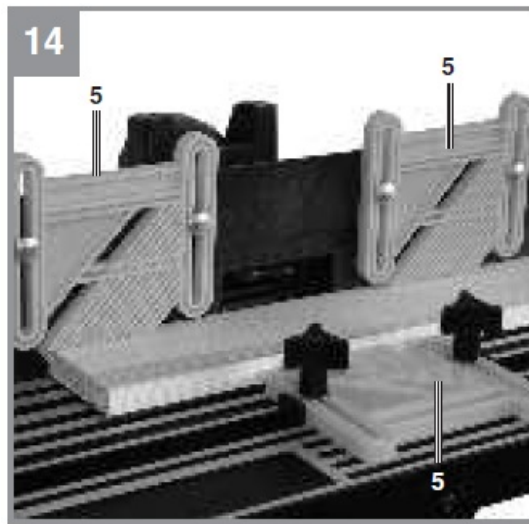

Router without continuous operation mode

- If your router is not equipped with a continuous operation mode you can use the supplied clip (15) to lock the switch.
- **Important!** Use the clip (15) only if the router is operated by way of the switch (6a).

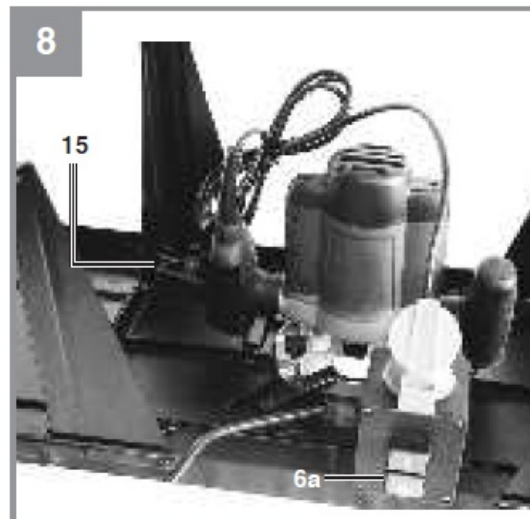

Dust extraction

The router table has an outlet for installing a dust extractor.

1. Connect the adapter of the dust extractor with the outlet.
2. Connect the dust extractor with the adapter to remove the dust during the milling process.

Cleaning and ordering replacement parts

- Always pull out the mains power plug before starting any cleaning work.

Cleaning

- Keep the safety devices free of dirt and dust as far as possible. Wipe the equipment with a clean cloth or blow it with compressed air at low pressure.
- We recommend that you clean the device immediately each time you have finished using it.

- Clean the equipment regularly with a moist cloth and some soft soap. Do not use cleaning agents or solvents; these could at-tack the plastic parts of the equipment. Ensure that no water can seep into the device.

Ordering replacement parts





Please provide the following information on all orders for spare parts:

- Model/type of machine
- Article number of the machine
- ID number of the machine
- Replacement part number of the required spare part

Documents / Resources

	<p>Einhell RTB-003 Router Table [pdf] Instruction Manual RTB-003 Router Table, RTB-003, Router Table</p>
---	--

References

-  [Home - Einhell](#)
-  [Herramientas de alta calidad para aficionados al bricolaje y la jardinería | Einhell.cl](#)
-  [Home - Einhell](#)
-  [Premium tools for DIY enthusiasts and gardeners | Einhell.nl](#)