



# Einhell GE-CT Cordless Telescopic String Trimmer Instruction Manual

[Home](#) » [Einhell](#) » Einhell GE-CT Cordless Telescopic String Trimmer Instruction Manual 



## GE-CT 18/30 Li Operating instructions Cordless Telescopic String Trimmer

### Contents

- 1 GE-CT Cordless Telescopic String Trimmer
- 2 Safety information
- 3 Layout and items supplied
- 4 Intended use
- 5 Technical data
- 6 Before starting the equipment
- 7 Operation
- 8 Cleaning and maintenance
- 9 Disposal and recycling
- 10 Storage
- 11 Faults
- 12 Documents / Resources
  - 12.1 References

## GE-CT Cordless Telescopic String Trimmer



7

**Art.-№: 3411260**  
**I.-№: 21012**

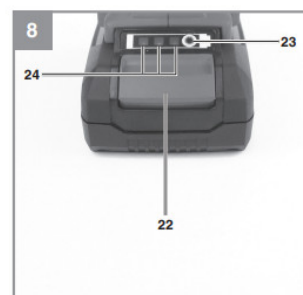
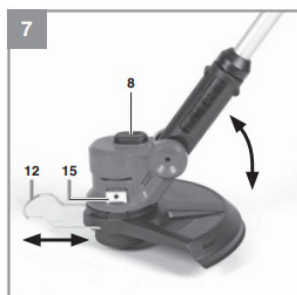
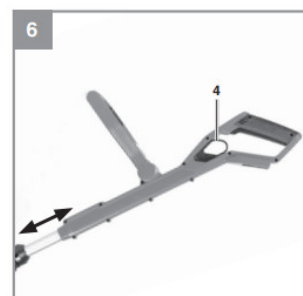
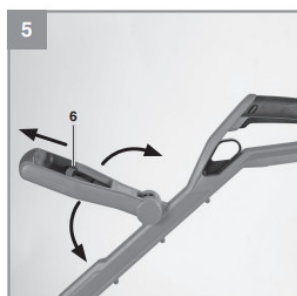
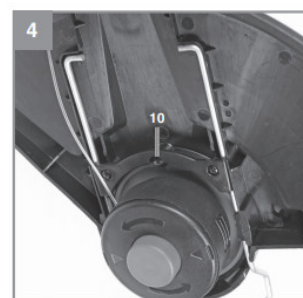
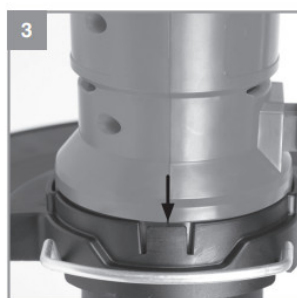
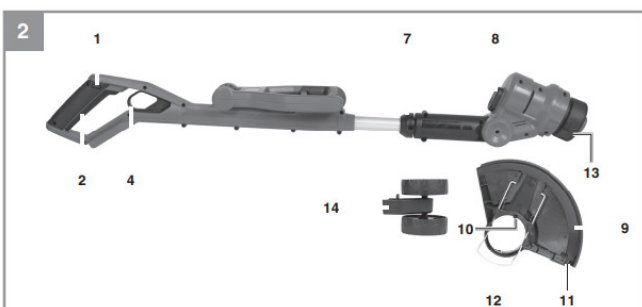
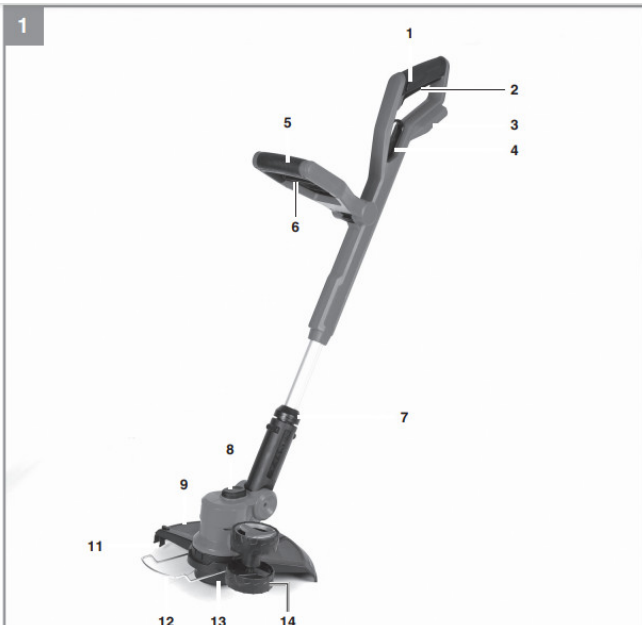

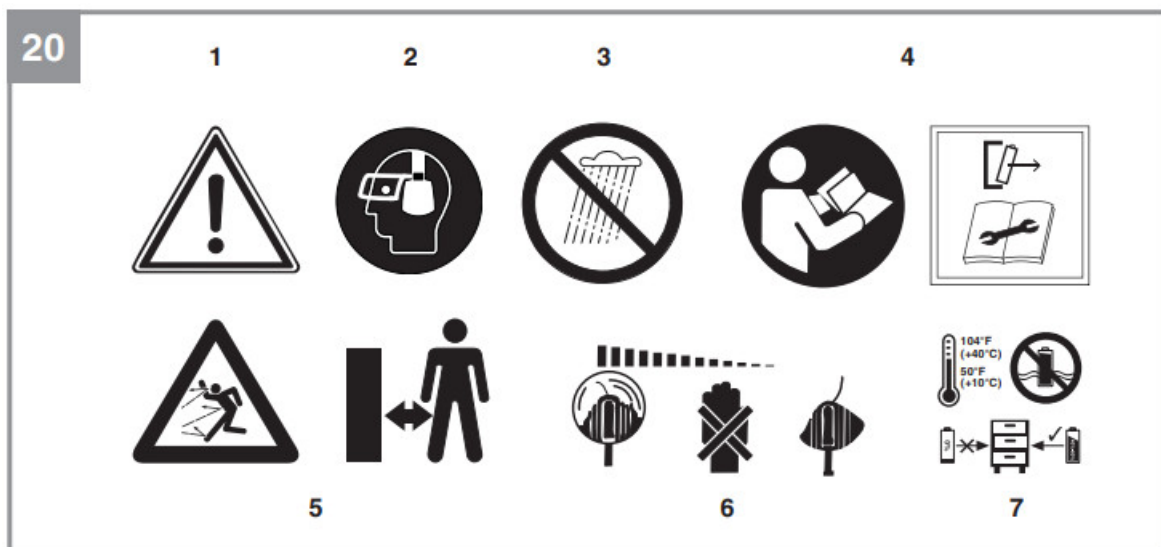
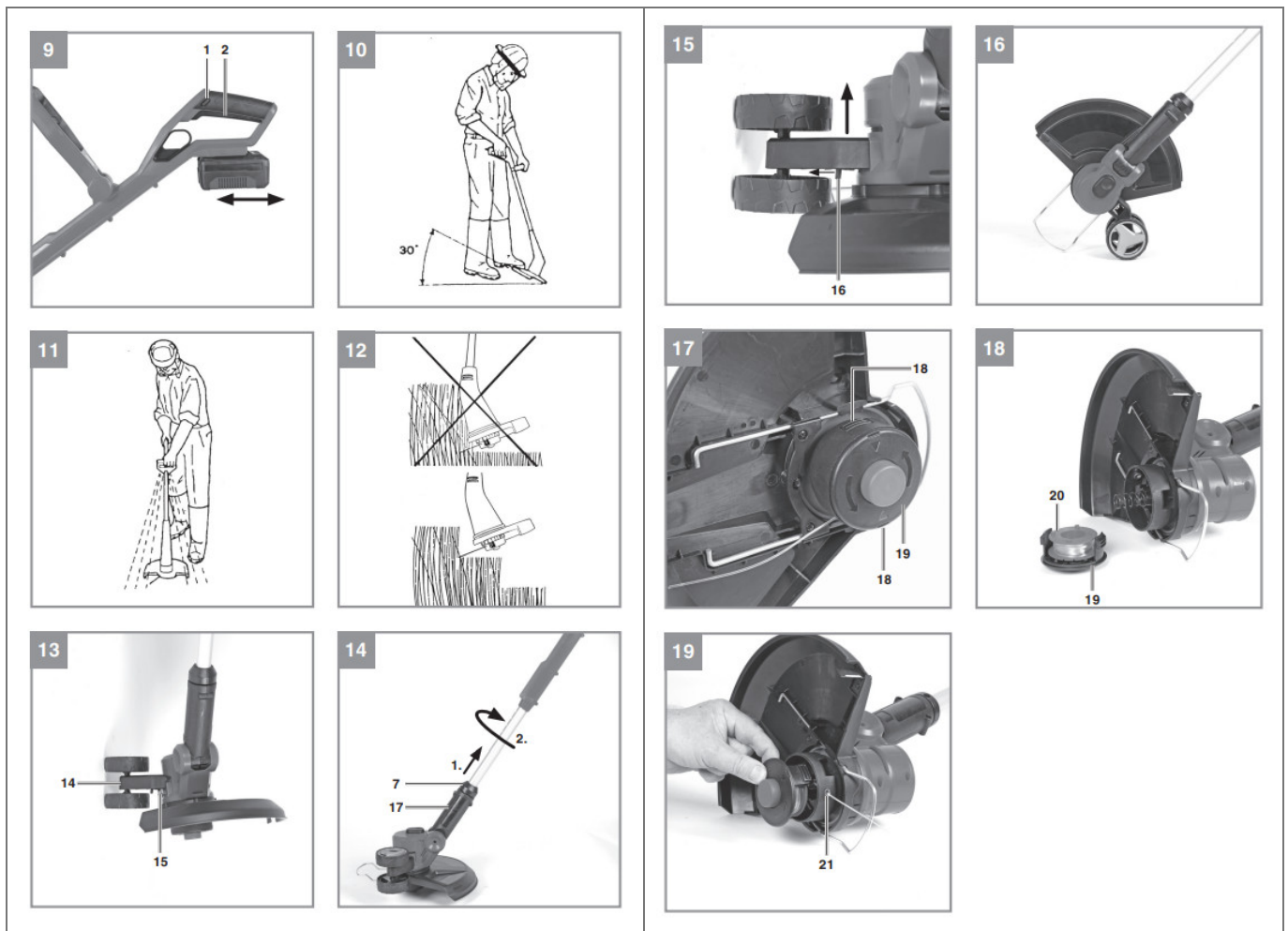

## DANGER!

When using the equipment, a number of safety precautions must be observed to avoid injuries and damage. Please read the complete operating instructions and safety information with due care. Keep these operating instructions in a safe place so that the information is available at all times. If you give the equipment to any other person, hand over these operating instructions and the safety information as well. We cannot accept any liability for damage or accidents which arise due to failure to follow these instructions and the safety information.

## Safety information



Read all the safety information and instructions. Failure to adhere to the safety information and instructions set out below may result in electric shock, fire and/or serious injury. Keep all the safety information and instructions in a safe place for future use.

### **General safety information for power tools**

The term “power tool” used in the safety regulations refers to power tools operated from the mains power supply (with a power cable) and to battery operated power tools (without a power cable).

#### **1. Work area safety**

- a) Keep work area clean and well lit. Cluttered and dark areas invite accidents.
- b) Do not operate power tools in explosive atmospheres, such as in the presence of flammable liquids, gases or dust. Power tools create sparks which may ignite the dust or fumes.
- c) Keep children and bystanders away while operating a power tool. Distractions can cause you to lose control.

#### **2. Electrical safety**

- a) Power tool plugs must match the outlet. Never modify the plug in any way. Do not use any adapter plugs with earthed (grounded) power tools. Unmodified plugs and matching outlets will reduce risk of electric shock.
- b) Avoid body contact with earthed or grounded surfaces such as pipes, radiators, ranges and refrigerators. There is an increased risk of electric shock if your body is earthed or grounded.
- c) Do not expose power tools to rain or wet conditions. Water entering a power tool will increase the risk of electric shock.
- d) Do not abuse the cord. Never use the cord for carrying, pulling or unplugging the power tool. Keep cord away from heat, oil, sharp edges or moving parts. Damaged or entangled cords increase the risk of electric shock.
- e) When operating a power tool outdoors, use an extension cord suitable for outdoor use. Use of a cord suitable for outdoor use reduces the risk of electric shock.
- f) If operating a power tool in a damp location is unavoidable, use a ground fault circuit interrupter (GFCI) protected supply. Use of an GFCI reduces the risk of electric shock.

#### **3. Personal safety**

- a) Stay alert, watch what you are doing and use common sense when operating a power tool. Do not use a power tool while you are tired or under the influence of drugs, alcohol or medication. A moment of inattention while operating power tools may result in serious personal injury.
- b) Use personal protective equipment. Always wear eye protection. Protective equipment such as dust mask, non-skid safety shoes, hard hat, or hearing protection used for appropriate conditions will reduce personal injuries.
- c) Prevent unintentional starting. Ensure the switch is in the Off -position before connecting to power source and/or BATTERY pack, picking up or carrying the tool. Carrying power tools with your finger on the switch or energizing power tools that have the switch on invites accidents.
- d) Remove any adjusting key or wrench before turning the power tool on. A wrench or a key left attached to a rotating part of the power tool may result in personal injury.
- e) Do not overreach. Keep proper footing and balance at all times. This enables better control of the power tool in unexpected situations.
- f) Dress properly. Do not wear loose clothing or jewellery. Keep your hair, clothing and gloves away from moving parts. Loose clothes, jewellery or long hair can be caught in moving parts.
- g) If devices are provided for the connection of dust extraction and collection facilities, ensure these are connected and properly used. Use of these devices can reduce dust related hazards.

h) Do not let familiarity gained from frequent use of tools allow you to become complacent and ignore tool safety principles. A careless action can cause severe injury within a fraction of a second.

#### **4. Power tool use and care**

- a) Do not force the power tool. Use the correct power tool for your application. The correct power tool will do the job better and safer at the rate for which it was designed.
- b) Do not use the power tool if the switch does not turn it on and off . Any power tool that cannot be controlled with the switch is dangerous and must be repaired.
- c) Disconnect the plug from the power source and/or remove the battery pack, if detachable, from the power tool before making any adjustments, changing accessories, or storing power tools. Such preventive safety measures reduce the risk of starting the power tool accidentally.
- d) Store idle power tools out of the reach of children and do not allow persons unfamiliar with the power tool or these instructions to operate the power tool. Power tools are dangerous in the hands of untrained users.
- e) Maintain power tools and accessories. Check for misalignment or binding of moving parts, breakage of parts and any other condition that may affect the power tool's operation. If damaged, have the power tool repaired before use. Many accidents are caused by poorly maintained power tools.
- f) Keep cutting tools sharp and clean. Properly maintained cutting tools with sharp cutting edges are less likely to bind and are easier to control.
- g) Use the power tool, accessories and tool bits etc., in accordance with these instructions and in the manner intended for the particular type of power tool, taking into account the working conditions and the work to be performed. Use of the power tool for operations different from intended could result in a hazardous situation.
- h) Keep handles and grasping surfaces dry, clean and free from oil and grease. Slippery handles and grasping surfaces do not allow for safe handling and control of the tool in unexpected situations.

#### **5. Battery tool use and care**

- a) Recharge only with the charger specified by the manufacturer. A charger that is suitable for one type of battery pack may create a risk of fire when used with another battery pack.
- b) Use power tools only with specifically designated battery packs. Use of any other battery packs may create a risk of injury and fire.
- c) When battery pack is not in use, keep it away from other metal objects, like paper clips, coins, keys, nails, screws or other small metal objects that can make a connection from one terminal to another. Shorting the battery terminals together may cause burns or a fire.
- d) Under abusive conditions, liquid may be ejected from the battery; avoid contact.  
If contact accidentally occurs, flush with water. If liquid contacts eyes, additionally seek medical help. Liquid ejected from the battery may cause irritation or burns.
- e) Do not use a BATTERY pack or tool that is damaged or modified. Damaged or modified batteries may exhibit unpredictable behavior resulting in fire, EXPLOSION or risk of injury.
- f) Do not expose a BATTERY pack or tool to fire or excessive temperature. Exposure to fire or temperature above 266°F (130°C) may cause explosion.
- g) Follow all charging instructions and do not charge the BATTERY pack or tool outside the temperature range specified in the instructions. Charging improperly or at temperatures outside the specified range may damage the BATTERY and increase the risk of fire.

#### **6. Service**

- a) Have your power tool serviced by a qualified repair person using only identical replacement parts. This will ensure that the safety of the power tool is maintained.

- b) Never service damaged BATTERY packs. Service of BATTERY packs should only be performed by the manufacturer or authorized service providers.
- c) Do not modify or attempt to repair the appliance or the battery pack (as applicable) except as indicated in the instructions for use and care.

### **1.) FOR ALL BATTERY-OPERATED APPLIANCES:**

- Do not charge appliance in rain, or in wet locations.
- Do not use battery-operated appliances in the rain. Always remove or disconnect battery pack before adjusting, cleaning, servicing or transporting the garden appliances.

### **2.) FOR ALL BATTERY-OPERATED PRODUCTS EMPLOYING A DETACHABLE OR SEPARABLE BATTERY:**

- Use only the following type and size battery:
  - 18V 1.5Ah PXC Lithium-ion battery
  - 18V 2.0Ah PXC Lithium-ion battery
  - 18V 2.5Ah PXC Lithium-ion battery
  - 18V 3.0Ah PXC Lithium-ion battery
  - 18V 4.0Ah PXC Lithium-ion battery
  - 18V 3.0Ah PXC Plus Lithium-ion battery
  - 18V 4.0Ah PXC Plus Lithium-ion battery
  - 18V 5.2Ah PXC Plus Lithium-ion battery
  - 18V 4.0Ah/6.0Ah PXC Plus Lithium-ion battery
  - 18V 5.0Ah/8.0Ah PXC Plus Lithium-ion battery
- Do not dispose of the battery in a fire. The cell may explode. Check with local codes for possible special disposal instructions.
- Do not open or mutilate the battery. Released electrolyte is corrosive and may cause damage to the eyes or skin. It may be toxic if swallowed.
- Exercise care in handling the battery in order not to short it with conducting materials such as rings, bracelets, and keys. The battery or conductor may overheat and cause burns.

### **3.) AVOID UNINTENTIONAL STARTING – DO NOT INSERT BATTERY WHILE YOUR FINGER IS ON THE SWITCH. BE SURE SWITCH IS OFF WHEN INSERTING THE BATTERY. ADDITIONAL SAFETY RULES FOR GRASS AND EDGE TRIMMERS**

- Do not use heavier lines than those recommended in this manual.
- Do not use line materials of other types – for example, metal wire, rope, and the like.

### **GENERAL SAFETY WARNINGS FOR THE BATTERY PACK**

- Dispose of used battery promptly and properly. When disposing of secondary cells or batteries, keep cells or batteries of different electrochemical systems separate from each other.
- Keep battery out of reach of children and in original package until ready to use.
- Never put batteries in one's mouth. If swallowed, contact local poison control centre immediately.

- **CAUTION** – The battery used in this device may present a risk of fire or chemical burn if mishandled. Replace battery with Einhell/ lawn master brand only. Use of another battery may present a risk of fire or explosion.
- **WARNING:** Do not use a visibly damaged battery pack or appliance.
- **WARNING:** Do not modify or attempt to repair the appliance or the battery pack.
- BATTERIES MUST BE RECYCLED.
- Do not short-circuit a cell or battery. Do not store cells or batteries haphazardly in a box or drawer where they may short-circuit each other or be short-circuited by conductive materials.
- Do not subject cells or batteries to mechanical shocks.
- Keep cells and batteries clean and dry. Wipe the cell or battery terminals with a clean dry cloth if they become dirty.
- Do not maintain secondary cells and batteries on charge when not in use.
- Retain the original cell and battery. Do not use any charger other than that specifically provided for use with the equipment. Secondary cells and batteries need to be charged before use. Always use the correct charger and refer to the manufacturer's instructions or equipment manual for proper charging instructions.
- When possible, remove the battery from the equipment when not in use.
- Under abusive conditions, liquid may be ejected from the battery; avoid contact. If contact accidentally occurs, flush with water. If liquid contacts eyes, additionally seek medical help. Liquid ejected from the battery may cause irritation or burns.
- Have servicing performed by a qualified repair person using only identical replacement parts. This will ensure that the safety of the product is maintained.
- Protect your rechargeable battery against moisture, rain and high humidity. Moisture, rain and high humidity can cause dangerous cell damage. Never charge or work with batteries which have been exposed to moisture, rain or high humidity – replace them immediately.
- If your equipment is fitted with a detachable battery, remove the battery for safety reasons after you have finished your work.

## **IMPORTANT SAFETY INSTRUCTIONS FOR CHARGER**

**WARNING:** This product may contain lead, phthalate or other chemicals known to the State of California to cause cancer, birth defects and other reproductive harm. Please wash your hands after use.

### **String trimmer and lawn edge trimmer safety warnings**

- a) Do not use the machine in bad weather conditions, especially when there is a risk of lightning. This decreases the risk of being struck by lightning.
- b) Thoroughly inspect the area for wildlife where the machine is to be used. Wildlife may be injured by the machine during operation.
- c) Thoroughly inspect the area where the machine is to be used and remove all stones, sticks, wires, bones, and other foreign objects. Thrown objects can cause personal injury.
- d) Before using the machine, always visually inspect to see that the cutter and the cutter assembly are not damaged. Damaged parts increase the risk of injury.
- e) Keep guards in place. Guards must be in working order and be properly mounted. A guard that is loose, damaged, or is not functioning correctly may result in personal injury.
- f) Keep all cooling air inlets clear of debris. Blocked air inlets and debris may result in overheating or risk of fire.
- g) Wear eye protection and ear protection. Adequate protective equipment will reduce personal injury.
- h) While operating the machine, always wear non-slip and protective footwear. Do not operate the machine when barefoot or wearing open sandals. This reduces the chance of injury to the feet from contact with the moving cutter.
- i) Always wear clothing such as trousers that covers the operator's legs while operating the machine. Contact with the moving cutter or line may cause injury.



- j) Keep bystanders away while operating the machine. Thrown debris can result in serious personal injury.
- k) Do not operate the machine above waist height. This helps prevent unintended cutter contact and enables better control of the machine in unexpected situations.
- l) Exercise caution when operating the machine in wet grass. Walk, never run. This reduces the risk of slipping and falling which may result in personal injury.
- m) Do not operate the machine on excessively steep slopes. This reduces the risk of loss of control, slipping and falling which may result in personal injury.
- n) When working on slopes, always be sure of your footing, always work across the face of slopes, never up or down and exercise extreme caution when changing direction. This reduces the risk of loss of control, slipping and falling which may result in personal injury.
- o) Keep all power cords and cables away from cutting area. Power cords or cables may be hidden in hedges or bushes and can be accidentally cut or damaged by the line or cutter.
- p) Keep all parts of the body away from the moving trimmer cutter or line. Do not clear material from the machine until it has been disconnected from the power source. The moving trimmer cutter or line may result in serious personal injury.
- q) Carry the machine with the machine switched off and away from your body. Proper handling of the machine will reduce the likelihood of accidental contact with a moving trimmer cutter or line.
- r) Only use replacement cutting heads and trimmer cutters or lines specified by the manufacturer. Do not replace the trimmer cutters or lines with metal wires or blades. Incorrect replacement parts may cause loss of control, breakage and injury.

### **Additional safety instructions**

- Before you begin your work, examine the material you want to cut. Remove any obstacles and debris. Continue to watch out for obstacles and debris while you are working. If you come across any obstacles and debris while cutting, turn off the machine and remove the items in question.
- Work only when visibility is adequate.
- Always hold the equipment firmly in both hands. Your fingers and thumbs should be wrapped around the handles.
- Make sure that the handles are clean and dry.
- When carrying out mowing work on a slope always stand at a lower level than the cutting tool. Never cut or trim on a smooth, slippery hill or slope.
- Make sure you stand squarely at all times while working. Be careful when walking backwards. Tripping hazard!
- If you stop your work in order to go to another area to work, you must make sure that the equipment is switched off while you are going there.
- Before you switch on the equipment, check that the cutting unit will not touch any stones or other objects.
- Always wear suitable working clothes to prevent injuries to the head, hands and feet. Always wear heavy, long pants, boots, gloves, and a long-sleeved shirt. Do not wear loose clothing, jewelry, short pants, sandals, or go barefoot. Secure hair so it is above shoulder level.
- When the equipment is in operation, you must always hold it away from your body!
- Do not switch on the equipment when it is turned around or when it is not in working position.
- Switch off the machine and remove the battery: when the equipment is not being used, when you leave it unsupervised, when checking the equipment, when removing or replacing the spool, or when transporting the equipment from one place to another.
- Keep the equipment away from other people, especially children, and from pets. There may be stones and other objects in the grass that is cut and thrown up.
- When you are working, keep a distance of at least 50 ft. (15 m) from other persons and pets.
- Do not cut against hard objects. This will help you to prevent causing injury to yourself and damage to the equipment.

- Use the edge of the safety guard to keep the equipment away from walls, different surfaces and fragile objects.
- Never use the equipment without the safety guard.
- This equipment is not allowed to be used by children or by persons with reduced physical, sensory or mental capacities or those with a lack of experience and knowledge. Children should be supervised so that they do not play with the equipment. Children are not allowed to carry out cleaning or maintenance.
- Risk of injury from dangerous moving parts!
- The moving parts are not allowed to be touched before the battery has been removed and all moving parts have come to a complete standstill.
- Read the directions with due care. Familiarize yourself with the operator controls and proper operation of the equipment.
- Never allow children or other persons who are not familiar with the operating instructions to use the equipment. Contact your local governmental agency for information regarding minimum age requirements for the user.
- Always keep in mind that the user of the equipment is personally responsible for accidents or hazards involving other persons or their property.
- Before use, always carry out a visual check to make sure that the safety devices or covers are not missing or damaged and that they are correctly fitted.
- Never use the equipment in bad weather conditions and particularly never when there is a risk of lightning.
- Never use the equipment with a damaged or missing cover or safety device.
- Switch on the motor only when there are no hands or feet within range of the line spool.
- Always switch off the equipment and remove the battery – when you leave the equipment unsupervised:
  - Before you remove a blockage.
  - Before you examine, clean or work on the equipment.
  - After the equipment strikes a obstacles and debris.
  - When the equipment begins to make unusual vibrations (examine immediately).

The equipment is not allowed to be put into operation again until the cause of the unusual vibrations is eliminated. If you fail to find the cause of the vibrations, contact a service center.
- Risk of injury from the line spool! Keep hands and feet away from the line spool!
- Use only spare parts and accessories which are recommended by the manufacturer.
- Examine and service the equipment regularly.

**Important! The safety guard is there to ensure your safety and the safety of others.**

**It is also essential for the equipment to work correctly. Failure to comply with this instruction will void your warranty as well as create a potential source of danger.**

- Never use your hands to try to stop the line spool.
- Always wait for it to stop by itself.
- Use only genuine line spools.
- Make sure that the air vents are free of dirt.
- Do not try to use the equipment to cut grass which is not growing on the ground; for example, do not try to cut grass growing on walls or stones, etc. The person operating the string trimmer is liable for any damages sustained by third parties within the equipment's working radius as a result of its use.
- Do not cross roads or gravel paths with the equipment switched on.
- When you are not using the equipment, keep it in a dry place out of the reach of children.
- Use the equipment only in the way described in these operating instructions and always hold it perpendicular

to the ground. Every other position is dangerous.

- Check at regular intervals that the screws are properly tightened.
- The area to be cut must always be kept cleared of cables and other objects.
- If the equipment has to be lifted for transporting, be sure to switch off the motor first and wait for the line spool to come to a standstill. Each time you leave the equipment, switch off the motor.
- Under no circumstances are you to cut against hard objects during use. This is imperative to prevent injury to yourself and damage to the equipment.
- Use only original replacement parts when repairing.
- Before starting up the equipment, and after any collision, check the equipment for signs of wear or damage and have any necessary repairs carried out.
- Always keep your hands and feet away from the line spool, especially when switching the motor on.
- Remove the rechargeable battery before checking, cleaning or doing any work on the machine and when it is not being used.
- Acquaint yourself with the controls and how to use the equipment.
- Stop using the equipment when there are people – particularly children – or pets nearby.
- Never use the machine if protective equipment is damaged or missing.
- Never mount metal line spools. Never replace the non-metal line spool with a metal line spool.

If it is used for a lengthy period, the vibrations it causes in the hands of the user may result in circulation problems (hand-arm vibration syndrome).

White finger syndrome is a vascular disease that involves seizure-like spasms of the fingers and toes. The affected areas are no longer sufficiently supplied with blood and therefore appear extremely pale.

The frequent use of vibrating equipment may trigger nerve damage in people with an impaired circulation (for example smokers, diabetics). Should you observe any unusual impairments, interrupt your work immediately and consult a doctor.

Follow these instructions in order to reduce the dangers:

- Keep your body and in particular your hands warm when working in the cold.
- Take regular breaks and move your hands to stimulate the blood circulation during the breaks.
- Ensure that the equipment makes the least possible vibration through regular maintenance and solid parts on the equipment.

### **Safety precautions for handling the line spool**

- Take note of all warnings and instructions relating to operating and fitting the line spool.
- The line spool can recoil suddenly from objects if it cannot cut or mow through them. This can cause injuries to the arms or legs. Keep bystanders and animals at least 50 ft. (15 m) away from where you are working. If the equipment strikes a foreign body, stop the engine immediately and wait for the line spool to come to a standstill. Check the line spool for signs of damage. Always replace the line spool if it is bent or cracked.
- The line spool is liable to catapult away objects with high force. This can cause blindness or injuries. Wear protection that complies with ANSI Z87.1, face and legs. Always remove objects from your working area before you use the string trimmer.
- Carefully check your machine and its fittings for signs of damage every time before use. Do not use the equipment unless the line spool is installed correctly.
- When you release the On/Off switch, the line spool will continue to rotate and will only gradually come to a standstill. A line spool which is in the process of rotating to a standstill can cause you or by-standers injuries

through cutting. Before you start any work on the line spool, switch off the motor and ensure that the line spool has come to a standstill.

- The danger zone has a radius of 50 ft. (15 m). Bystanders may suffer blindness or injuries. Keep a distance of 50 ft. (15 m) between yourself and other people or animals.

**Important:** The line spool continues to run for a few seconds after the motor is switched off .  
**The line spool continues to rotate!**



### SAVE THESE INSTRUCTIONS

Explanation of the warning signs on the equipment (see Fig. 20)

1. Warning!
2. Wear goggles and ear muffs!
3. Protect from moisture!
4. Read the instruction manual before starting!  
**WARNING** – Disconnect battery before maintenance.
5. Keep other people out of the danger area!
6. The line spool continues to rotate!
7. Store the batteries only in dry rooms with an ambient temperature of 50°F to 104°F (+10°C to +40°C). Place only fully charged batteries in storage (charged at least 40%).

## Layout and items supplied

### 2.1 Layout

1. Safety lock-off
2. On/Off switch
3. Battery mount
4. Telescopic handle release
5. Additional handle
6. Additional handle release
7. Lock for rotatable motor head
8. Locking button for motor head tilt
9. Safety guard
10. Mounting screw

11. Line cutter
12. Edge guide
13. Line spool housing
14. Guide wheels
15. Guide wheels mount
16. Guide wheels release
17. Angle adjuster
18. Ribbed push cover points
19. Spool cover
20. Line spool
21. Eyelet
22. Push-lock button
23. Battery capacity indicator button
24. Battery capacity indicator

## **2.2 Items supplied**

Please check that the article is complete as specified in the scope of delivery. If parts are missing, please contact our service center or the store where you made your purchase at the latest within 5 work days after purchasing the article and upon presentation of a valid bill of purchase.

- Open the packaging and take out the equipment with care.
- Remove the packaging material and any packaging and/or transportation braces (if present).
- Check to see if all the items are supplied.
- Inspect the equipment and accessories for transport damage.
- If possible, keep the packaging until the end of the guarantee period.

## **Danger!**

The equipment and packaging material are not toys. Do not let children play with plastic bags, plastic sheets and small parts. There is a risk of choking and suffocating!

- Cordless string trimmer with additional handle
- Safety guard
- Guide wheels
- Original operating instruction with safety information

## **Separately available accessories**

18V 1.5Ah PXC Lithium-Ion battery  
18V 2.0Ah PXC Lithium-Ion battery  
18V 2.5Ah PXC Lithium-Ion battery  
18V 3.0Ah PXC Lithium-Ion battery  
18V 4.0Ah PXC Lithium-Ion battery  
18V 3.0Ah PXC Plus Lithium-Ion battery  
18V 4.0Ah PXC Plus Lithium-Ion battery  
18V 5.2Ah PXC Plus Lithium-Ion battery  
18V 4.0Ah/6.0Ah PXC Plus Lithium-Ion battery  
18V 5.0Ah/8.0Ah PXC Plus Lithium-Ion battery  
18V PXC Dual Port Fast Charger  
18V PXC Fast Charger

Contact your local retailer for more specific models of batteries and charger available in your area. You can also explore battery + charger options at [Einhell.com](http://Einhell.com).

## Intended use

The equipment is designed for cutting lawns and small areas of grass in private and hobby gardens.

Equipment designed for use in private and hobby gardens is regarded as unsuitable for use in public facilities, parks and sports centers, along roadways, or in agriculture and forestry.

The operating instructions supplied by the manufacturer must be obeyed to ensure that the equipment is used properly.

**Important!** This equipment must not be used for composting purposes (shredding) as this could result in injury or damage to property.

The equipment is allowed to be used only for its prescribed purpose. Any other use is deemed to be a case of misuse. The user/operator and not the manufacturer will be liable for any damage or injuries of any kind resulting from such misuse.

Please note that our equipment has not been designed for use in commercial, trade or industrial applications. Our warranty will be voided if the equipment is used in commercial, trade or industrial businesses or for equivalent purposes.

## Technical data

Motor power supply: ..... 18V   
No load speed: ..... 8500 RPM  
Cutting width: ..... 12"  
Length of line spool: ..... 16.4 ft.  
Line diameter: ..... 0.065"  
Weight (tool only): ..... 4.6 lbs

## Reduce noise generation and vibration to a minimum!

- Use only equipment that is in perfect condition.
- Maintain and clean the equipment regularly.
- Adapt your way of working to the equipment.
- Do not overload the equipment.
- Have the equipment checked if necessary.
- Switch off the equipment when not in use.
- Wear gloves.

## CAUTION!

### Residual risks

Even if you use this electric power tool in accordance with the instructions, certain residual risks cannot be eliminated. The following hazards may arise in connection with the equipment's construction and layout:

1. Lung damage if no suitable protective dust mask is used.
2. Damage to hearing if no suitable ear protection is applied.
3. Health damage caused by hand-arm vibrations if the equipment is used over a longer period or is not properly guided and maintained.

## Before starting the equipment

### 5.1 Fitting the safety guard (Fig. 3-4)

Remove the screw (Fig. 2 / Item 9a) from the safety guard. Place the safety guard (Item 9) on the motor housing and have it latch onto the motor housing (see arrow). Secure the safety guard with the mounting screw (Item 10). At the bottom of the safety guard is a blade (Fig. 2 /Item 10) for automatically adapting the length of the line spool. It is provided with a safety cover. Remove the safety cover before starting work.

### 5.2 Adjusting the additional handle (Fig. 5)

Pull the release (Item 6) in the direction of the arrow and tilt the additional handle. There are 5 working positions and one storage position in which the additional handle can latch. Operation is permitted only when the additional handle is latched in place.

### 5.3 Height adjustment (Fig. 6)

Pull the release (Item 4) and set the required working height on the telescopic tube. You will hear an audible click when the telescopic tube latches in place. Operation is permitted only when the telescopic tube is latched in place.

### 5.4 Adjusting the angle of tilt of the motor head (Fig. 7)

Press the button for adjusting the angle of tilt (Item 8). Now you can set the motor head to the required angle of tilt. To fix the angle of tilt, release the button and allow the handle to lock into position. Four different locking angles are possible.

### Warning!

#### Risk of injury!

If the angle of tilt of the motor head is incorrectly set, you could injure yourself or the string trimmer could become damaged.

- Use the string trimmer only when the motor head and the button are latched in one of the four positions for the angle of tilt and when the motor head is securely seated.
- Do not use the string trimmer if the motor head is not latched in place.

### 5.5 Using the edge guide (Fig. 7)

There are 2 locking points (minimum / maximum edge guide length). To change the position of the edge guide (Item 12) after it has latched in place, pull or and push it out of the lock.

### 5.6 Fitting the battery (Fig. 8-9)

Press the push-lock button (22) of the rechargeable battery and push the rechargeable battery into the mount provided. Make sure that the push-lock button engages properly! To remove the battery, proceed in reverse order!

#### Danger!

Start up the equipment only when it is fully assembled.

## Operation

### 6.1 Charging the Lithium-Ion battery (not included)

The corresponding instructions can be found in the original operating instructions for your charger.

### 6.2 Battery capacity indicator (Fig. 8)

Press the battery capacity indicator switch (23).

The battery capacity indicator (24) shows the charge status of the battery using 3 LEDs.

#### All 3 LEDs lit:

The battery is fully charged.

#### 2 or 1 LED(s) lit:

The battery has an adequate remaining charge.

#### 1 LED flashing:

The battery is empty, recharge the battery.

#### All LEDs flashing:

The temperature of the battery is too low. Remove the battery from the device and leave it at room temperature for a day. If the error occurs again, this means that the battery has been completely depth-discharged and is defective. Remove the battery from the device. Never use or charge a defective battery.

The string trimmer has a semi-automatic line extension system. Each time you activate the semi-automatic line

extension system, the line is automatically extended to ensure that you can cut your lawn with the perfect cutting width at all times. To extend the line, run the motor and tap the line spool on the ground. This will automatically extend the line. The blade on the safety guard will cut the line to the appropriate length. Please note that the more often you activate the semi-automatic line extension system, the more the line will wear.

**Note:** If the line is too long when you use the equipment for the first time, the surplus end of it will be cut by the blade on the safety guard.

If the line is too short when you start the equipment for the first time, press the knob on the line spool and pull the line hard. When you then start the machine for the first time the line will be cut to the perfect length automatically.

**Caution!** Bits of the line catapulted out into the surroundings could cause injuries!

To obtain maximum performance from your string trimmer, please follow these instructions:

- Never use the string trimmer without the safety guard.
- Do not mow grass when it is wet. The best results are achieved on dry grass.
- To switch on your string trimmer, press the safety lock-off (Fig. 9 / Item 1) and the On/Off switch (Fig. 9 / Item 2).
- To switch off your string trimmer, let go of the On/Off switch (Fig. 9 / Item 2) again.
- Do not allow the string trimmer near the grass until the switch is pressed, i.e. the string trimmer is in operation.
- To cut properly, swing the string trimmer sideways while moving forwards. Keep the string trimmer inclined at an angle of approx. 30° while you do so (see Figs. 10 and 11).
- If the grass is long, the grass must be cut shorter in stages, starting from the tip (see Fig. 12).
- Use the edge guide and the safety guard to prevent unnecessary wear on the line.
- To avoid unnecessary wear on the line, keep the string trimmer away from hard objects.
- To use the edge guide along walls or objects, pull the edge guide forward (see section 5.5). Push it into the string guard when not in use (see section 5.5).

### Using the grass trimmer as an edge trimmer (Fig. 16)

To cut the edges of lawns alongside e.g. flower beds (vertical cutting), the string trimmer can be converted into a lawn edge trimmer.

Push the guide wheels (Fig. 13 / Item 14) from above onto the mount (Fig. 7 + 13 / pos.. 15) until

you hear the wheels latch in place (Fig. 14). To remove the guide wheels, pull the guide wheels release (Fig. 15 / Item 16) while simultaneously pulling the guide wheels up and off .

The lock (Fig. 14 / Item 7) latches in the angle adjuster (Fig. 14 / Item 17). While holding the angle adjuster in place, pull the long handle up and out of the lock and turn it clockwise through 90° until it latches home. Tilt the long handle as required (see section 5.4).

Return the motor head in reverse order to its original position in order to use it as a string trimmer.

## Cleaning and maintenance

### HAZARD!

Always take the battery out of the equipment before starting any cleaning work.

#### 7.1 Cleaning

- Keep all safety devices, air vents and the motor housing free of dirt and dust as far as possible. Wipe the equipment with a clean cloth or blow it down with compressed air at low pressure.
- We recommend cleaning the equipment immediately each time after use.
- Clean the equipment regularly with a damp cloth and some soft soap. Do not use cleaning agents or solvents; these may be aggressive to the plastic parts in the equipment. Ensure that no water can get into the interior of the equipment. The ingress of water into an electric power tool increases the risk of an electric shock.



- Use a brush to remove deposits from the safety guard.

## 7.2 Replacing the line spool (Fig. 17 – 19)

**Danger! Remove the battery!**

1. Press the line spool housing together at the opposite-lying ribbed push cover points (Item 18) and remove the spool cover (Item 19).
2. Remove the empty line spool.
3. Thread the end of the line from the new line spool (Item 20) through the eyelet (Item 21) of the spool cover and allow approx. 4" of line to project.
4. Press the spool cover back into the line spool housing.

## 7.3 Maintenance

There are no other parts inside the equipment which require maintenance.

## Disposal and recycling

The equipment is supplied in packaging to prevent it from being damaged in transit. The raw materials in this packaging can be reused or recycled. The equipment and its accessories are made of various types of material, such as metal and plastic. Never place defective equipment in your household refuse. The equipment should be taken to a suitable collection center for proper disposal. If you do not know the whereabouts of such a collection point, you should ask in your local council offices.

## Storage

Store the equipment and its accessories out of children's reach in a dark and dry place at above freezing temperature. The ideal storage temperature is between 41°F and 86°F (5°C and 30°C). Keep the electric tool in its original packaging.

## Faults

### The equipment does not work:

Check that the battery is charged and whether the charging unit is working. If the equipment will not work in spite of the voltage supply being OK, bring your string trimmer to the nearest service center.

The reprinting or reproduction by any other means, in whole or in part, of documentation and papers accompanying the products is strictly subject to the express consent of Einhell Germany AG.



Subject to technical changes.



[www.Einhell.com](http://www.Einhell.com)

	<p><b><a href="#">Einhell GE-CT Cordless Telescopic String Trimmer</a></b> [pdf] Instruction Manual GE-CT Cordless Telescopic String Trimmer, GE-CT, Cordless Telescopic String Trimmer, Telescopic String Trimmer, String Trimmer, Trimmer</p>
---	---

## References

-  [Einhell Group website | Einhell.com](#)
-  [Einhell Group website | Einhell.com](#)
- [User Manual](#)