



eimotor DKC-1A Step Motor Controller User Manual

[Home](#) » [eimotor](#) » eimotor DKC-1A Step Motor Controller User Manual



Guangzhou Meimotor Electronic Technology Co., Ltd
DKC-1A Step Motor Controller User Manual

Contents [[hide](#)]

- [1 Description](#)
- [2 Parameters](#)
- [3 Function Setting](#)
- [4 Functions](#)
- [5 Installation Size](#)
- [6 Wiring and Other Instructions](#)
- [7 Documents / Resources](#)
 - [7.1 References](#)
- [8 Related Posts](#)

Description

DKC-1A is an economical stepping motor controller. It uses an imported and high-speed intelligent chip, its software inherits the stability, reliability and strong anti-interference of the original version DKC-1, so it is applicable to all kinds of harsh environments in any factory site. At the same time, some functions are added to make the controller more practical and convenient, which is suitable for the round-trip motion control, limited function control, speed control and the like of sensors.

Parameters

- Voltage Input: DC5V – 32V

- Multiple Protection Functions: anti-connection protection, over-voltage protection, over-current protection
- Speed Regulation Performance: intelligent and automatic switch between onboard speed regulation and external speed regulation
- Acceleration and Deceleration: used S- acceleration, with the function of immediate stopping
- Output Frequency: up to 20KHz
- Input and Output: all input is optocoupler isolation, while output the negative pulse. The low-level signal is valid.

Function Setting

Operation mode: (dip switch, 1-up, 0-down)

	Automatic Round-trip Mode	Single Trigger Mode	Single Round Trip Mode	Jog Mode
S1	0	0	1	1
S2	0	1	0	1

NOTE:

- The control signal is 0-24V. The signal is valid at the falling edge. The trigger signal must be over 2.5US.
- The onboard potentiometer and the external potentiometer are automatically switched. If the interface of the external potentiometer is suspended, the on-board potentiometer will regulate the speed. If the external potentiometer (less than or equal to 10K) is connected, the control board will automatically switch to the external potentiometer to adjust the speed.
- Operation setting switch and the onboard speed-regulating potentiometer are inside the controller, please open the case to set them.

Functions

- **Automatic Round-Trip Mode:** After the controller is triggered and started, (COM and K4 connected), the motor will automatically move back and forth between the FWD limit and the REV limit until the input of the trigger is stopped.
- **Single Trigger Mode:** After the controller is triggered and started, the motor is in forward rotation until it touches the FWD limit to stop. It will be in reversal rotation if the controller is triggered and started again and will stop when it touches the REV limit. Start the motor and it will be in forward rotation again on and on.
- **Single Round Trip Mode:** After the controller is triggered and started, the motor is in Guangzhou Meimotor Electronic Technology Co., Ltd forward rotation until it touches the FWD limit to stop. Then it automatically starts to reverse and won't stop until it touches the REV limit.
- **Jog Mode:** When COM and K4 connected, the motor will be in forward rotation. When COM and K4 are disconnected, the motor will stop. When COM and K3 are connected, the motor will be in reversal rotation. When COM and K3 disconnected, the motor will stop.

Installation Size

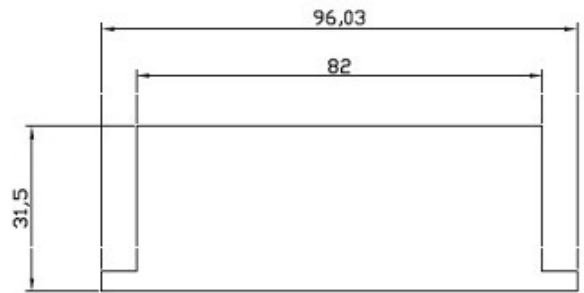
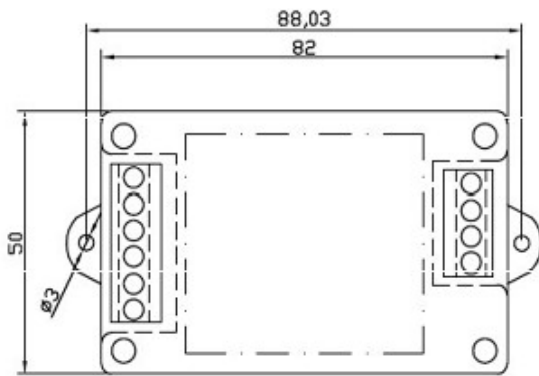

Unit:mm

Wiring and Other Instructions

1. Connection to the Driver

As a universal stepping motor, the controller serves motor controller. The general step motor drivers which serve motor drivers can be controlled and used for matching, regardless of the size of the motors.

Different motor driver ports have different marks but the same interface functions: EN=ENA=PRE Enable; PUL=PULS=CLK Pulse; DIR=CW=CCW Direction The controller uses common-anode connection: Driver "PUL+" and "DIR+" connects to VDD +24V Controller "PUL-" connects to driver Pulse input port (PUL-PULS-CLK-) Driver "DIR-" connects to driver Direction input (DIR-CW-CWW-) "En+" and "En-" are usually disconnected.

2. Limit Switch and Button Switch

Suited to use mechanical switch, button switch, limit switch, foot switch which are with normally open two-foots. One foot connects the COM, and the other is attached to the start port, stop port, forward and reverse limit ports correspondingly. Suited to use optoelectronic switches, proximity switches, Hall switches and other electronic switches which use DC24V three-wire-often-open NPN. Two of the lines are power lines, which are directly connected to the controller's power supply. Another line is a signal line directly connected to the start port, stop port, forward and reverse limit ports and other input ports correspondingly.

3. External Potentiometer

The external speed regulating potentiometer needs to be 10K-value resistance or less. Guangzhou Meimotor Electronic Technology Co., Ltd

The connection of the external potentiometer only demands its middle foot to be connected to COM and the foot at the other side the external speed controller input port.

4. Other Instructions

When debugging the controller for the first time, the controller, the driver, the motor, and the power supply must be connected properly. Then a small wire should be connected to the common port for debugging. After the power is turned on, the other port of the wire is used to connect K4 and K3 port and the like to imitate the switch functions. After making sure that every function does work by the debugging, connect each switch, the external potentiometer, and other accessories step by step.

K1,K2,K3,K4 can be replaced with various sensors. The low level signal of input is valid

K1 Forward Limit
K2 Reversal Limit
K3 Stop
K4 Start
COM Public Side

"EN-,EN+": Enable
"DIR-" Connect Controller "DIR-"
"DIR+" Connect Controller power+
"PUL-" Connect Controller "PUL-"
"PUL+" Connect Controller power+
R1,R2: Current limiting resistor
Controller voltage=5V, R1,R2 not connected
Controller voltage=12V R1,R2 connected 1K
Controller voltage=24V R1,R2 connected 2K

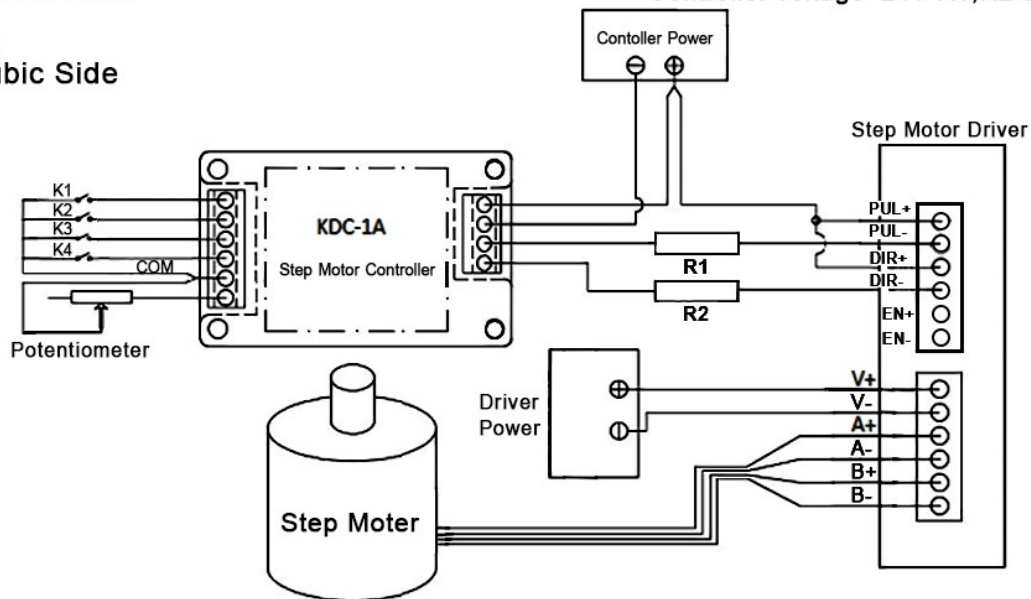

If the voltage of driver power is less than 32V, the controller and driver can share a single power supply.

Website <http://www.meimotor.com>

Documents / Resources

	<p>eimotor DKC-1A Step Motor Controller [pdf] User Manual DKC-1A Step Motor Controller</p>
--	--

References

- [Title](#)