



EIGIIS KE3 Bluetooth Call Smart Watch User Manual

[Home](#) » [EIGIIS](#) » EIGIIS KE3 Bluetooth Call Smart Watch User Manual 

EIGIIS KE3 Bluetooth Call Smart Watch User Manual



Contents

- 1 Appearance Description
- 2 Charging Instructions
- 3 Download APP and Bluetooth Pairing
- 4 Main Watch Face Selection
- 5 Operation Method
- 6 Product Parameters
- 7 APP language
- 8 The main function
- 9 Precautions
- 10 FCC Statement
- 11 Documents / Resources
- 12 Related Posts

Appearance Description



Charging Instructions

Thank you for choosing our smart health watch. Please read the manual carefully when using it for the first time. First, long press the rotating key for 5 seconds to start the machine. If the battery is low or exhausted, please charge it first. After connecting the charging cable, insert the USB interface (such as the computer host, mobile power supply, or standard power adapter) for charging. The input voltage is required to be 5V1A or 5V2A.

Download APP and Bluetooth Pairing

Install APP

Before using this device, please download the APP and install it. Scan the QR code on the right side with your mobile phone, then select the corresponding software to install according to your mobile phone system. You can also search for “FitCloudPro” in the Apple AppStore to install it. Android phones users can download it from other APP stores. For example, search for “FitCloudPro” in the Android market to download and install. (Compatible system: iOS 11.4 and above, Android 6.0 and above)



Step 1: APP Bluetooth Pairing

1. For the first time use of this device, you need to download and install the APP(FitCloudPro), launch it and register as required. After the registration is completed, enter the account and set the password to log in.
2. Turn on the Bluetooth status of the phone, and then open the APP to connect to the watch to complete the pairing.

Step 2: Call/Media Audio Settings

After completing Bluetooth pairing, you can set the audio options on your watch. (As shown in the figure below).

1. Pop up the window and click Pairing.

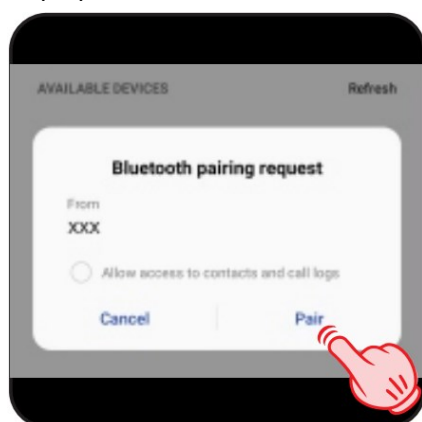

2. Set the audio options on the watch.



Main Watch Face Selection

Tap and hold the Watch screen/ rotating key to select different watch face. After connecting the watch and “FitCloudPro” APP, more watch faces can be selected in the dial Library of the APP.



Operation Method



Rotate the key: 1. Press and hold for 5 seconds to turn on/off the Watch; 2. Rotate the key to browse the list of functions.

Customized keys: 1. Short press to switch the screen on/off; 2. Long press to enter the user-defined function interface.

Tap and hold the screen: In the main dial status, tap and hold the screen for 3 seconds to select different dials.

Swiping: Swipe to the left or right to view other panels.

Swipe upwards: On the Watch screen, swipe upwards to viewing a notification.

Swipe downwards: On the Watch screen, swipe downwards to access to the settings menu.

Product Parameters

Display screen: 1.45 inch TFT display

Resolution: 360 * 360

Waterproof rating: IP67

Wrist strap material: TPU

Heart rate sensor: HX3605

Compatibility: iOS11.4+Android 8.0 or above

Main control chip: RTL8763EWE Battery

capacity: 300mAh

Working time: about 7-9 days

Synchronization mode: Bluetooth 5.2

Working temperature: – 10 °C~50 °C

Package list: *Host * Charging line* Wrist strap * Instruction manual

APP language

APP supports languages: English, German, Spanish, French, Italian, Polish, Portuguese, Russian, Simplified Chinese, Japanese, and more languages will be added in the future.

The main function

- Time



- Steps



- Distance



- Calories



- Sleep



- Multi- sport modes



- Timer



- Find the phone



- Multilingual



- Heart rate



- Calendar



- Breathe training



- Sedentary reminder



- Sedentary reminder



- Information push



- Play music



- Weather forecast



- Blood pressure



- Menstrual cycle



- Calculator



- Remote photography



- Drinking water reminder



- Payment function



- Blood oxygen



Precautions

1. Do not hit the watch body heavily.
2. Do not expose the watch to chemicals such as benzene or thinner.
3. Please keep the watch away from strong magnetic fields and electric shock stations.
4. Please keep the watch away from direct light or heat appliances.
5. Do not disassemble, repair or modify the watch by yourself.
6. Dispose of packaging, batteries, and old electronic products, please sort them properly.
7. Please do not wear the watch while swimming, bathing or diving. (Temperature should not exceed 45°C)

FCC Statement

This device complies with part 15 of the FCC rules. Operation is subject to the following two conditions: (1) this device may not cause harmful interference, and (2) this device must accept any interference received, including interference that may cause undesired operation. Changes or modifications not expressly approved by the party responsible for compliance could void the user's authority to operate the equipment.

NOTE: This equipment has been tested and found to comply with the limits for a Class B digital device, pursuant to part 15 of the FCC Rules. These limits are designed to provide reasonable protection against harmful interference in a residential installation. This equipment generates uses and can radiate radio frequency energy and, if not installed and used in accordance with the instructions, may cause harmful interference to radio communications. However, there is no guarantee that interference will not occur in a particular installation. If this equipment does cause harmful interference to radio or television reception, which can be determined by turning the equipment off and on, the user is encouraged to try to correct the interference by one or more of the following measures:

- Reorient or relocate the receiving antenna.
- Increase the separation between the equipment and receiver.
- Connect the equipment into an outlet on a circuit different from that to which the receiver is connected.
- Consult the dealer or an experienced radio/TV technician for help.

The device has been evaluated to meet general RF exposure requirement. The device can be used in portable exposure condition without restriction.

Documents / Resources

	EIGIIS KE3 Bluetooth Call Smart Watch [pdf] User Manual 2BBRH-KE3, 2BBRHKE3, KE3, KE3 Bluetooth Call Smart Watch, Bluetooth Call Smart Watch, Call Smart Watch, Smart Watch
---	--