



## EHEIM 5000 Flow Pump Instruction Manual

[Home](#) » [EHEIM](#) » EHEIM 5000 Flow Pump Instruction Manual

**EHEIM**  
compactON

5000  
9000  
12000  
16000

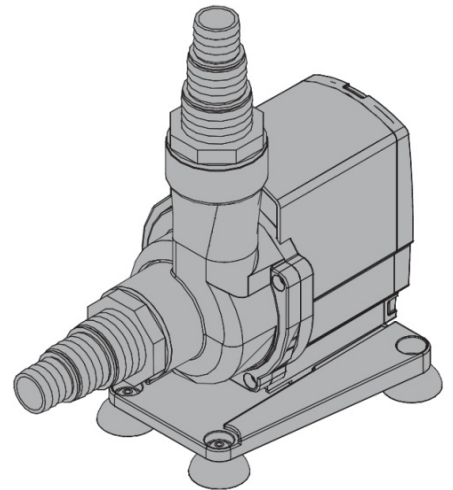
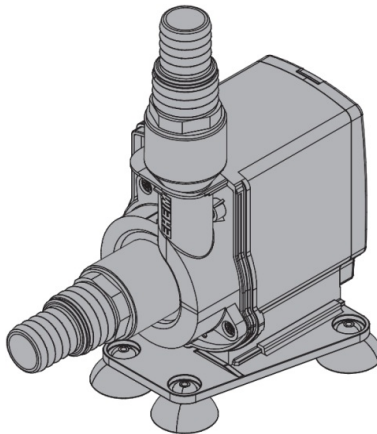

Operating instructions

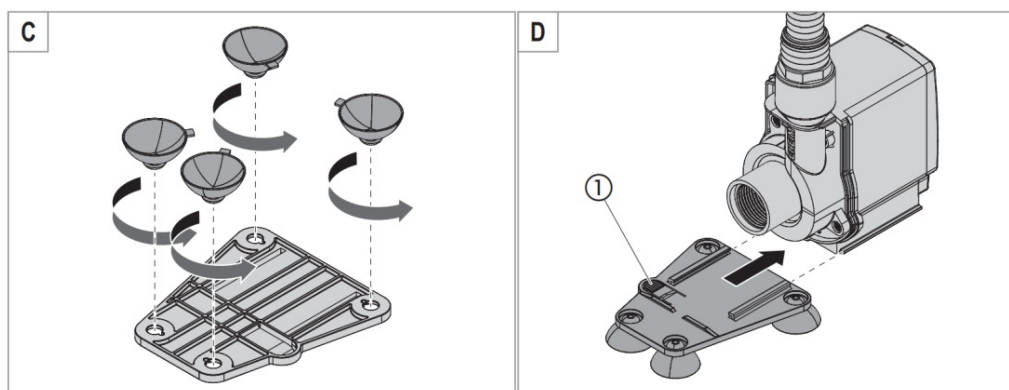
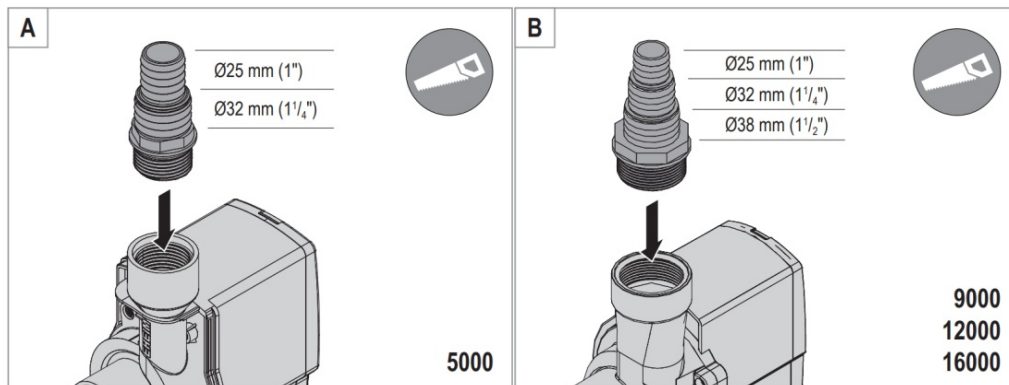
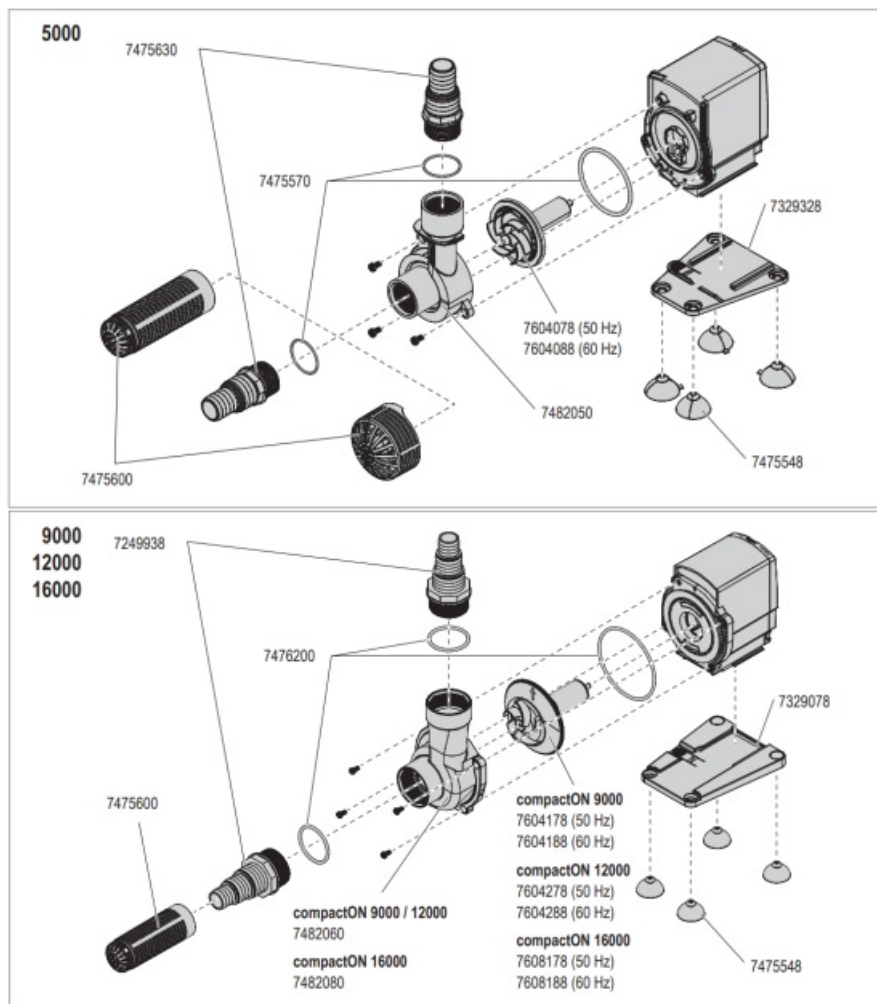

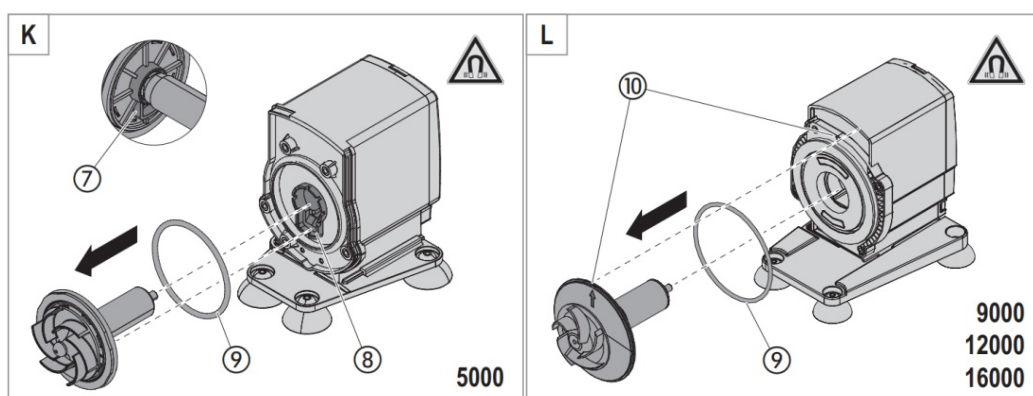
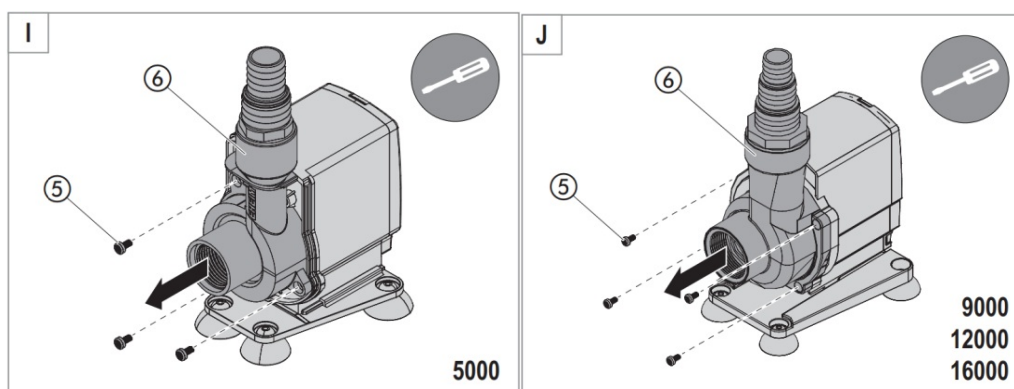
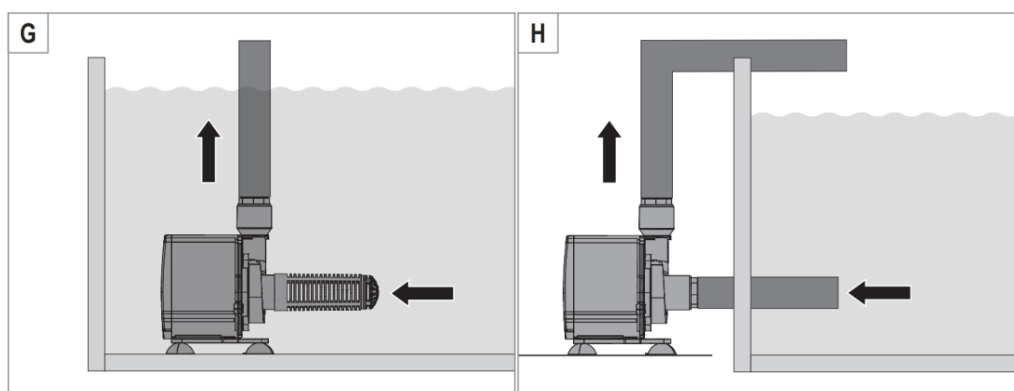
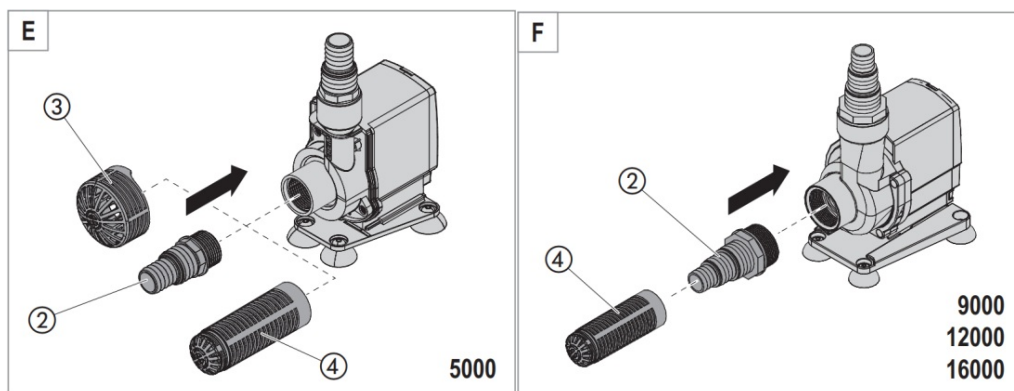

## Contents [ [hide](#) ]

1	<a href="#">Operating manual (translation) Universal pump compactON 5000 / 9000 / 12000 / 16000</a>
2	<a href="#">1. General user instructions</a>
2.1	<a href="#">Information on using the operating manual</a>
2.2	<a href="#">Symbol explanation</a>
3	<a href="#">2. Application</a>
3.1	<a href="#">VERY IMPORTANT SAFETY INSTRUCTIONS</a>
3.2	<a href="#">READ AND FOLLOW ALL SAFETY INSTRUCTIONS.</a>
3.3	<a href="#">KEEP THESE INSTRUCTIONS FOR FUTURE REFERENCE.</a>
4	<a href="#">3. Safety instructions</a>
4.1	<a href="#">For your safety</a>
5	<a href="#">4. Commissioning</a>
5.1	<a href="#">Connecting the hose</a>
5.2	<a href="#">Attaching the mounting plate</a>
5.3	<a href="#">Installing the intake nozzle for external use</a>
5.4	<a href="#">Fit compactON 5000 filter baskets</a>
5.5	<a href="#">Fit compactON 9000 / 12000 / 16000 filter baskets</a>
6	<a href="#">5. Operation</a>
6.1	<a href="#">Switching the pump on/off</a>
7	<a href="#">6. Maintenance</a>
8	<a href="#">7. Clearing faults</a>
9	<a href="#">8. Decommissioning and disposal</a>
9.1	<a href="#">Storage</a>
9.2	<a href="#">Disposal</a>
10	<a href="#">9. Technical data</a>
11	<a href="#">10. Spare parts</a>
12	<a href="#">Documents / Resources</a>
13	<a href="#">Related Posts</a>

## Operating manual (translation) Universal pump compactON 5000 / 9000 / 12000 / 16000

### 1. General user instructions

#### Information on using the operating manual



- Before using the appliance for the first time, the operating manual must be read fully and understood.
- Consider the operating manual as part of the product and keep in a safe and accessible location.
- Enclose this operating manual if passing the appliance on to a third party.

#### Symbol explanation

The following symbols are used on the appliance.



The appliance must only be used indoors, and exclusively for aquariums.



1 m

The appliance has an immersion depth of max. 1 m.



The appliance is of protection class II.

**IP68**

The symbol indicates that the appliance is protected against permanent submerging.

**CE** The appliance is certified according to the relevant national regulations and directives, and conforms to EU standards.

The following symbols and signal words are used in this operating manual:



**DANGER!**

The symbol indicates imminent danger from electric shock that can result in death or serious injury.



**DANGER!**

The symbol indicates imminent danger that can result in death or serious injury.



**Danger from magnetic fields**

The symbol denotes imminent danger causing severe personal injury or death if the corresponding measures are not taken.



**WARNING!**

The symbol indicates imminent danger that can result in moderate to minor injury or a health risk.



**CAUTION!**

The symbol indicates the danger of material damage.



Note with useful information and tips.

Typographical conventions

 **A** Reference to a figure, in this case, reference to figure A

- You are prompted for an action.

## 2. Application

The appliance and all parts included in the scope of delivery are intended for private use and must only be used:

- for aquarium-related purposes
- indoors
- in compliance with the technical data

The following limitations apply to the appliance:



- do not use for commercial or industrial purposes
- do not pump caustic, inflammable, aggressive or explosive substances, food or drinking water
- the water temperature may not exceed 35°C
- do not use in swimming ponds
- never operate without a water flow

**VERY IMPORTANT SAFETY INSTRUCTIONS**

**WARNING-** To guard against injury, basic safety precautions should be observed, including the following.

- FOR HOUSEHOLD USE ONLY
- WARNING! RISK OF ELECTRIC SHOCK!
- This pump has not been investigated for use in swimming pools areas!
- DO NOT RUN DRY!

**READ AND FOLLOW ALL SAFETY INSTRUCTIONS.**

- **DANGER.** To avoid possible electric shock, special care should be taken since water is employed in the use of aquarium equipment. For each of the following situations, do not attempt repairs by yourself; return the appliance to an authorized service facility for service or discard the appliance.
- If the appliance shows any sign of abnormal water leakage, immediately unplug it from the power source.
- Carefully examine the appliance after installation. It should not be plugged in if there is water on parts not intended to be wet.
- Do not operate any appliance if it has a damaged cord or plug, or if it is malfunctioning or if it is dropped or damaged in any manner.

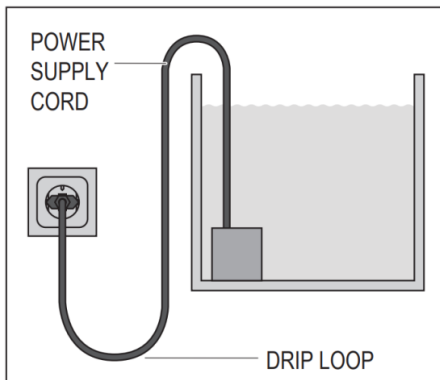

- To avoid the possibility of the appliance plug or receptacle getting wet, position aquarium stand and tank to one side of a wall mounted receptacle to prevent water from dripping onto the receptacle or plug. A “drip loop”, shown in the figure, should be arranged by the user for each cord connecting the aquarium appliance to a receptacle. The “drip loop” is that part of the cord below the level of the receptacle, to prevent water travelling along the cord and coming in contact with the receptacle. If the plug or receptacle does get wet, **DON'T** unplug the cord; disconnect the fuse or circuit breaker that supplies power to the appliance. Then unplug and examine for presence of water in the receptacle.
- Close supervision is necessary when any appliance is used by or near children.
- To avoid injury, do not contact moving parts.
- Always unplug an appliance from an outlet when not in use, before putting or taking off parts, and before cleaning.  
Never yank cord to pull plug from outlet. Grasp the plug and pull to disconnect.
- Do not use an appliance for other than intended use. The use of attachments not recommended or sold by the appliance manufacturer may cause an unsafe condition.
- Do not install or store the appliance where it will be exposed to the weather or to temperatures below freezing.
- Make sure an appliance mounted on a tank is securely installed before operating it.
- Read and observe all the important notices on the appliance and its cord.
- If an extension cord is necessary, a cord with a proper rating should be used. A cord rated for less amperes or watts than the appliance rating may overheat. Care should be taken to arrange the cord so that it will not be tripped over or pulled.
- Check that the voltage shown on the label of the unit corresponds to the voltage of the mains supply.
- Disconnect all electrical appliances from the mains before placing hands in the water.
- The line cord of this unit cannot be replaced or repaired. Should the line cord become damaged the appliance must be discarded.

KEEP THESE INSTRUCTIONS FOR FUTURE REFERENCE.

### 3. Safety instructions

Risks for persons and property can arise from this appliance if the appliance is improperly used or not used as intended or if the safety instructions are not heeded.

#### For your safety



- This appliance is not intended for use by persons (including children) with reduced physical, sensory or mental capabilities, or lack of experience and knowledge, unless they are under the supervision of someone responsible for their safety or have received instruction on usage of the appliance from said person. Children should be supervised to ensure that they do not play with the appliance.
- Only for European markets:  
This appliance can be used by children from the age of 8 and by persons with reduced physical, sensory or mental capabilities or lack of experience and/or knowledge if they are supervised and have been instructed in the safe use of the appliance and have understood the resulting dangers. Children must not play with the appliance. Cleaning and user maintenance must not be carried out by children unless they are supervised.
- Before use, carry out a visual inspection to ensure that the appliance, especially the mains cable and plug, are undamaged.
- Repairs must only be carried out by an EHEIM service centre.
- The mains cable of this appliance cannot be replaced. If the cable is damaged, the appliance must be scrapped.
- Only carry out the work described in these instructions.
- Only use original spare parts and accessories for the appliance.



- The appliance should be protected by a residual current protection device with a maximum rated residual current of 30 mA. Please contact an electrician if there are any questions or problems.
- In the event of water leakage or when the residual current protection device is triggered, immediately disconnect all devices in the aquarium from the power supply.
- If they are not being used, always disconnect all devices in the aquarium from the power supply before you install/remove any parts and before all cleaning and maintenance work.
- Protect the mains socket and mains plug against moisture and wetness. A drip loop must be formed with the mains cable. This prevents any water running along the cable to the mains socket, which would result in a short-circuit.
- The electrical data of the appliance must match the data of the power mains. This data is found on the type plate, the packaging and in these instructions.

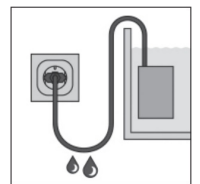

- The appliance has a magnet with a strong magnetic field that can affect pacemakers or implanted defibrillators (ICD). Maintain a distance of **at least 30 cm** between the implant and magnet.

### 4. Commissioning

#### Connecting the hose



1. Use a saw to shorten the connecting piece to the diameter of your hose (  **A/B**).
2. Screw the connecting piece onto the pump.
3. Connect your hose to the connecting piece.



- We recommend fastening the hose with a hose clamp.

#### Attaching the mounting plate

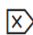
1. Screw the suction devices into the openings of the mounting plate (  **C**).
2. Move the mounting plate until it locks into the guides on the underside of the motor body (  **D**).





In order to remove the mounting plate, the release lever (1) must be pressed.

#### Installing the intake nozzle for external use

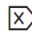

The pump can be used inside and outside of the aquarium. For example, the connecting piece (2) facilitates the connection of a hose.

1. Use a saw to shorten the intake nozzle to the diameter of your hose (  **A/B**).
2. Screw the intake nozzle onto the pump housing (  **E/F**).
3. Connect your hose to the intake nozzle.



- We recommend fastening the hose with a hose clamp.

#### Fit compactON 5000 filter baskets

1. Connect the desired filter basket (3) or (4) to the pump housing (  **E**).

#### Fit compactON 9000 / 12000 / 16000 filter baskets

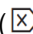
1. Fit filter basket (4) to the adapter (  **F**).

## 5. Operation



#### CAUTION! Material damage.

The pump must not run dry.

#### Switching the pump on/off

1. **Inside the aquarium:** Secure the appliance below water level at the bottom or to the inside of your aquarium (  **G**). Pay attention to the maximum pond depth (see Technical data).

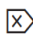
**Outside the aquarium:** Attach the appliance to a stable surface outside your aquarium (  **H**). The suction devices serve as vibration dampers.

2. Insert the mains plug in the mains socket. **Attention: The pump starts immediately!**
3. To turn it off, remove the mains plug from the mains socket.

## 6. Maintenance



**DANGER! Electrocutation!**

- All devices must be disconnected from the power supply before any maintenance work is carried out.

**CAUTION! Material damage.**

- Do not use hard objects or aggressive cleaning agents for cleaning.
- The appliance components are not dishwasher-proof! Do not clean the appliance or appliance parts in the dishwasher.





The following sections describe maintenance work necessary for optimum and fault-free operation. Regular maintenance prolongs the service life and assures functionality of the appliance over a long period.

**Cleaning the filter basket**

1. Remove the pump from the aquarium.
2. Pull the filter basket off the pump housing or off the adapter.
3. Clean the filter under running water.
4. Install the filter basket again in reverse order.

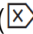
**Cleaning the pump**

1. Remove the pump from the aquarium.
2. Loosen and remove the fastening screws **(5)** (I/J).
3. Pull the pump cover **(6)** out of the motor body from the front.
4. Pull the impeller out of the motor body (K/L).
5. Remove the O-ring **(9)** from the motor housing.
6. Clean all components under running water.
7. Install the pump again in reverse order.



- **compactON 5000:** Pay attention to the installation direction of the impeller. The lug (7) in the impeller cover must engage in the recess (8) in the motor body.
- **compactON 9000 / 12000 / 16000:** When assembling, make sure that the markings (10) on the impeller and on the motor housing align with each other.

**7. Clearing faults****DANGER! Electrocutation!**

- Before clearing faults, remove the mains plug.

<b>Faults</b>	<b>Possible cause</b>	<b>Remedy</b>
<b>Pump does not start</b>	No mains voltage	<ul style="list-style-type: none"> <li>• Check the mains voltage</li> <li>• Check the supply line</li> </ul>
<b>Pump turns off</b>	The pump is provided with an electronic device for rotation control and this is also able to evaluate the functioning conditions. If there is a lack of water or the pump is blocked, the pump recognises the problem and stops. After 10 attempts to start again, in the space of 1 minute, the pump turns off completely.	<ol style="list-style-type: none"> <li>1. Remove the mains plug.</li> <li>2. Remove the cause of the problem.</li> <li>3. Reconnect the mains plug.</li> </ol>
<b>Pump does not pump</b>	Mains plug is not inserted	<ul style="list-style-type: none"> <li>• Insert the mains plug in the mains socket</li> </ul>
	Impeller is blocked	<ul style="list-style-type: none"> <li>• Clean the pump</li> </ul>
	Shortage of water	<ul style="list-style-type: none"> <li>• Add more water.</li> </ul>
<b>Pump does not pump</b>	Thermal cut-out has activated	<ol style="list-style-type: none"> <li>1. Remove the mains plug and let the pump cool down.</li> <li>2. Insert the mains plug again after approx. one hour.</li> </ol>
<b>Pump not pumping sufficiently</b>	Filter basket is dirty	<ul style="list-style-type: none"> <li>• Clean the filter basket</li> </ul>

For other faults, please contact EHEIM Service.

## 8. Decommissioning and disposal

### Storage



1. Take the appliance out of the aquarium.
2. Clean the appliance
3. Store the appliance in a frost-proof place.

### Disposal



When disposing of the appliance, pay attention to the relevant statutory regulations. Information on the disposal of electrical and electronic appliances in the European Union:  
Within the European Union, disposal of electrically operated appliances is governed by national regulations that are based on the EU Directive 2012/19/EU on waste electrical and electronic

equipment (WEEE). The appliance may no longer be disposed of with the municipal or household waste. The appliance will be accepted free of charge at municipal collection points or recycling centres. The product packaging is made up of recyclable materials. Dispose of them in an environmentally responsible manner and take them for recycling.

## 9. Technical data

compactON	5000	9000	12000	16000
Type	1032	1033	1034	1035
Rated power	70 W	80 W	110 W	160 W
Delivery rate	5000 l/h	9000 l/h	12000 l/h	15500 l/h
Max. delivery head	3.60 m	3.70 m	4.20 m	4,50 m
Max. immersion depth	1 m			
Dimensions (L × W × H)	142 × 92 × 154 mm	175 × 110 × 185 mm		180 × 110 × 185 mm
Cable length	2 m			
Water connections	Ø25 mm / Ø32 mm	Ø25 mm / Ø32 mm / Ø38 mm		
Media temperature	4 °C - 35 °C			
Mains voltage/frequency	220 – 240 V / 50 Hz			

## 10. Spare parts

See page 3.

**EHEIM**



**EHEIM GmbH & Co.KG**

Plochingen Str. 54  
73779 Deizisau  
Germany

Tel. +49 7153/7002-01  
Fax +49 7153/7002-174

[www.eheim.com](http://www.eheim.com)

© EHEIM 2020

73 78 110 / 01.2021 / C&F

## Documents / Resources

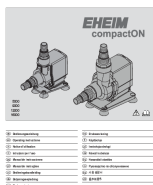

[EHEIM 5000 Flow Pump](#) [pdf] Instruction Manual  
5000, 9000, 12000, 16000, 5000 Flow Pump, 5000, Flow Pump