

EGO STX3800 Volt Lithium Ion Cordless Line Trimmer



# EGO STX3800 Volt Lithium Ion Cordless Line Trimmer Instruction Manual

[Home](#) » [EGO](#) » EGO STX3800 Volt Lithium Ion Cordless Line Trimmer Instruction Manual 

## Contents

- [1 EGO STX3800 Volt Lithium Ion Cordless Line Trimmer](#)
- [2 Specifications](#)
- [3 Product Usage Instructions](#)
- [4 PACKING LIST \(FIG.A1\)](#)
- [5 DESCRIPTION](#)
- [6 TROUBLESHOOTING](#)
- [7 WARRANTY](#)
- [8 Frequently Asked Questions \(FAQ\):](#)
- [9 Documents / Resources](#)
  - [9.1 References](#)



**EGO STX3800 Volt Lithium Ion Cordless Line Trimmer**



## **Product Information: 56 VOLT LITHIUM-ION CORDLESS LINE TRIMMER**

- STX3800

## **Specifications**

- **Voltage:** 56V
- **No-load Speed:** Up to 5800 /min
- **Cutting Mechanism:** Bump Head
- **Cutting Line Type:** 2.4mm nylon twist line
- **Cutting Width:** 38cm
- **Recommended Operating Temperature:** Not specified
- **Optimum Charging Temperature:** Not specified
- **Weight (without battery pack):** 5.8 kg
- **Measured sound power level LWA:** 95 dB(A) with K=1.1 dB(A)
- Sound pressure level at operator's ear LPA: 82 dB(A) K=2.5 dB(A)
- Guaranteed sound power level LWA (measured according to 2000/14/EC): 96 dB(A)
- **Valuation of vibration ah:**
  - Front-assist handle: 2.1 m/s<sup>2</sup> K=1,5 m/s<sup>2</sup> .
  - Rear handle: 1.8 m/s<sup>2</sup> K=1.5 m/s<sup>2</sup>

The declared vibration total value has been measured in accordance with a standard test method and may be used for comparing one tool with another; The declared vibration total value may also be used in a preliminary assessment of exposure.

**NOTICE:** The vibration emission during actual use of the power tool can differ from the declared value in which the tool is used; In order to protect the operator, user should wear gloves and ear protectors in the actual conditions of use.

## **Product Usage Instructions**



**READ OPERATOR'S MANUAL**



**Safety Alert**



**Wear Eye Protection**



**Wear Head Protection**



**Wear slip-resistant Footwear**



**Beware of Blade Thrust**

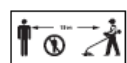

The distance between the machine and bystanders shall be at least 15 m.



Line diameter-The Diameter of the nylon cutting line



Guaranteed sound power level. Noise emission to the environment according to the European community's Directive.



Waste electrical products should not be disposed of with household waste. Take to an authorized recycler.

$n_0$

No Load Speed-Rotational speed, at no load



Direct Current

## SAFETY SYMBOLS

**WARNING:** The operation of any power tools can result in foreign objects being thrown into your eyes, which can result in severe eye damage. Before beginning power tool operation, always wear safety goggles or safety glasses with side shields and a full face shield when needed. We recommend a Wide Vision Safety Mask for use over eyeglasses or standard safety glasses with side shields.



To reduce the risk of injury, user must read the operator's manual.



**Wear Ear Protection**



**Wear Hand Protection**



Beware of thrown objects



Disconnect battery before maintenance



Cutting width-The Max. cutting width of line trimmer



This product is in accordance with applicable EC directives.



This product is in accordance with applicable UK legislation.

**v:** Voltage

**.../min:** Per Minute

**kg:** Kilogram

**IPX5:** Protection against water jets

### **Safety Precautions:**

- Always wear eye protection, ear protection, head protection, hand protection, and slip-resistant footwear.
- Beware of thrown objects and blade thrust.
- Disconnect the battery before maintenance.
- Maintain a distance of at least 15 meters between the machine and bystanders.

### **Operating the Line Trimmer:**

1. Read all instructions and the operator's manual before use.
2. Ensure the battery is fully charged before operation.
3. Attach the cutting line securely to the bump head.
4. Turn on the trimmer using the trigger.
5. Hold the rear handle firmly while operating.
6. Adjust the cutting height as needed for your trimming requirements.
7. Maintain a steady cutting motion for best results.

### **Shaft:**

The shaft is the main body of the trimmer that connects the handle to the cutting head.

### **Trigger:**

The trigger controls the power output of the trimmer. Press and hold to operate.

### **Rear Handle:**

The rear handle provides stability and control while operating the trimmer.

### Trimmer Head (Bump head):

The bump head holds and dispenses the cutting line. Refill or replace the line when needed.

### PACKING LIST (FIG.A1)

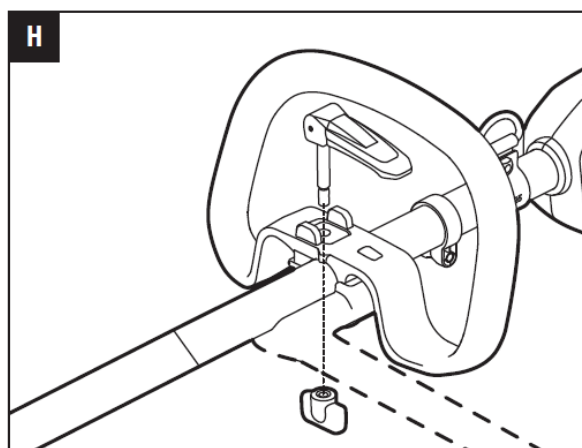
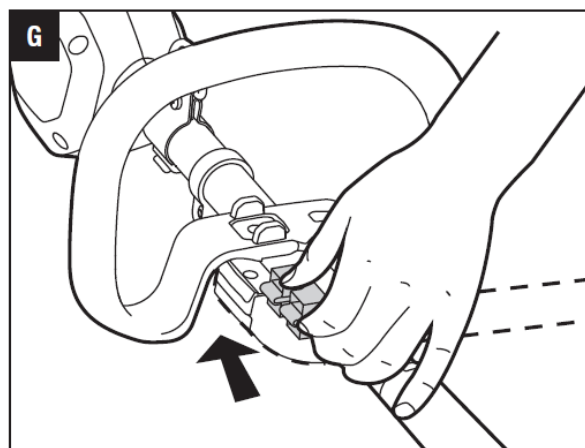
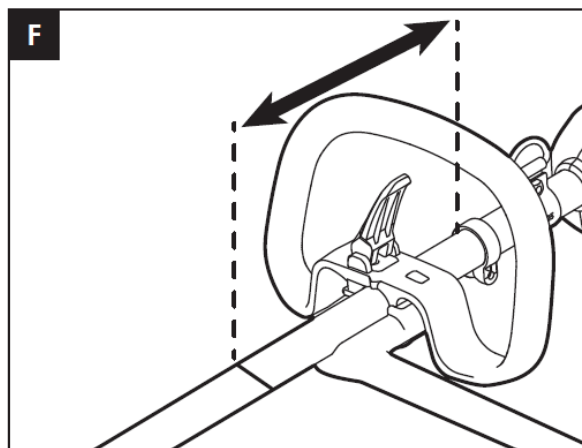
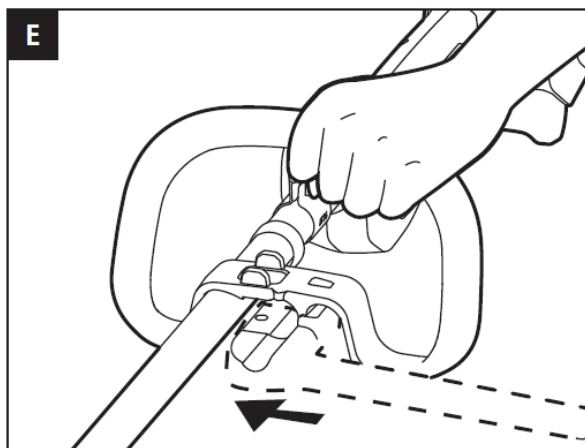
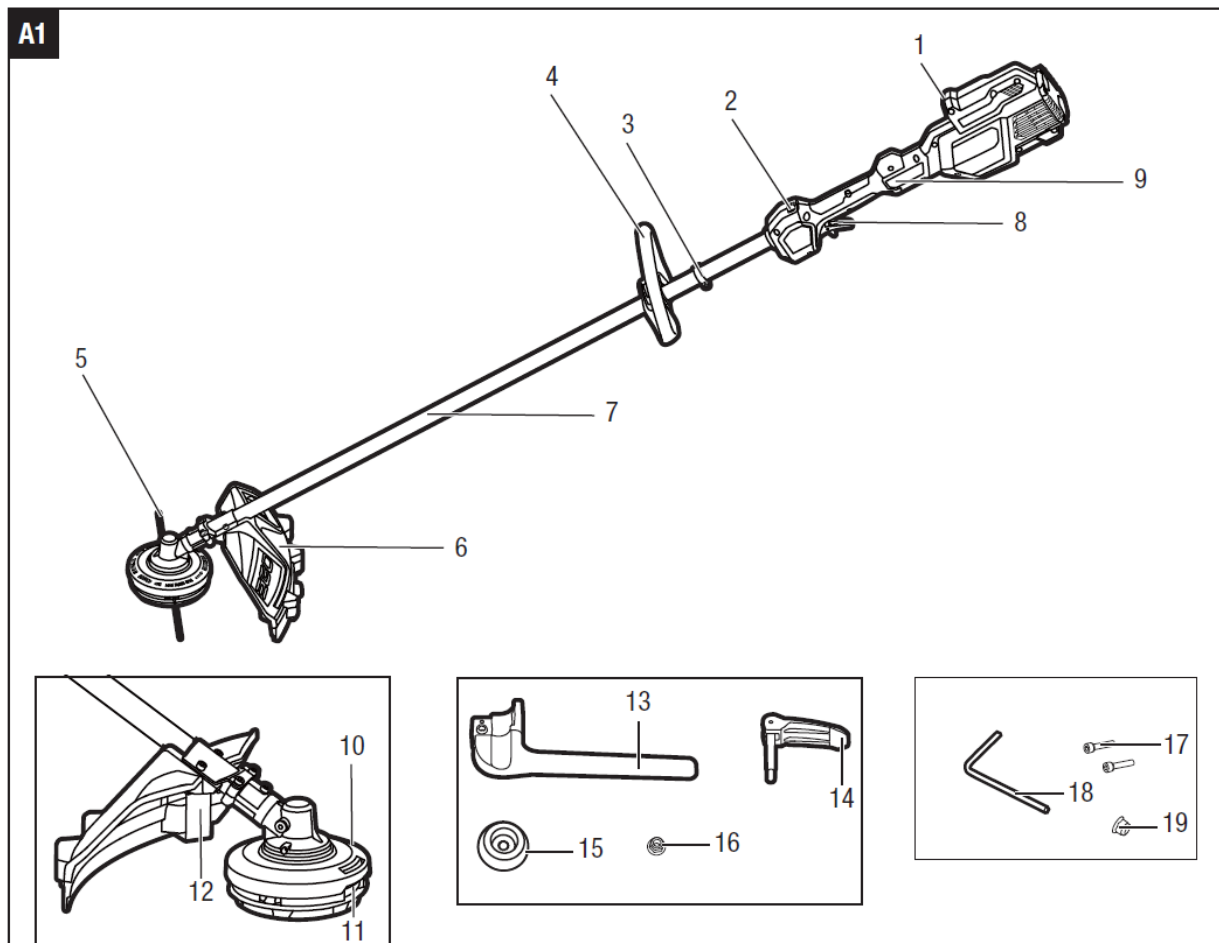

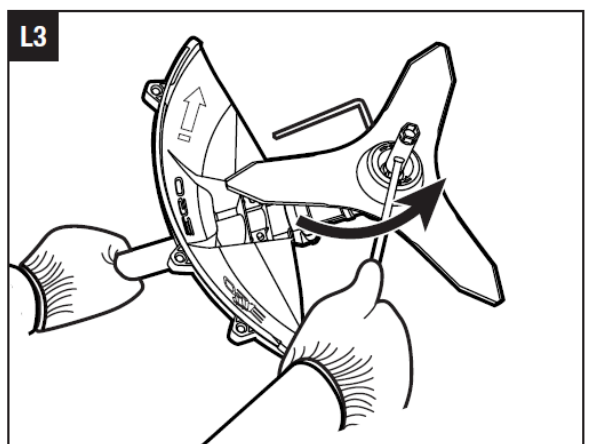
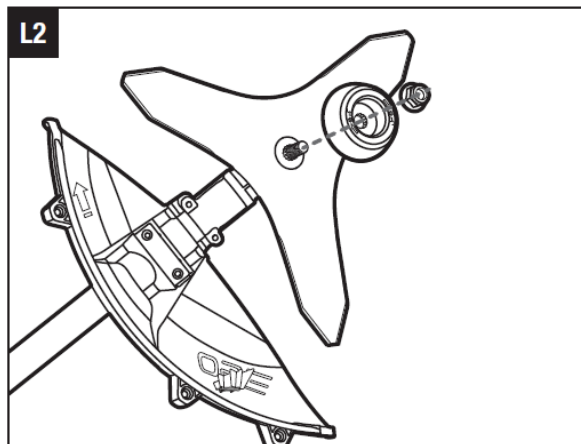
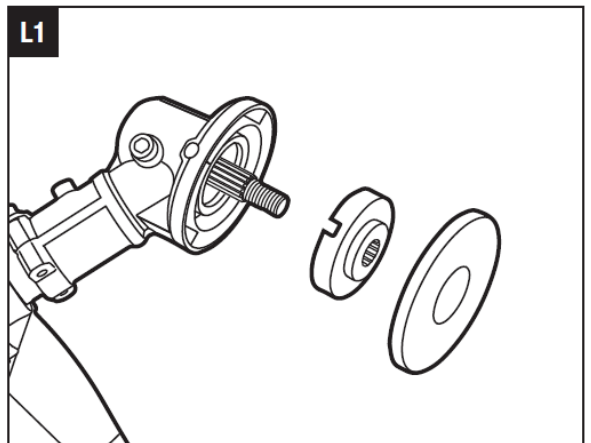
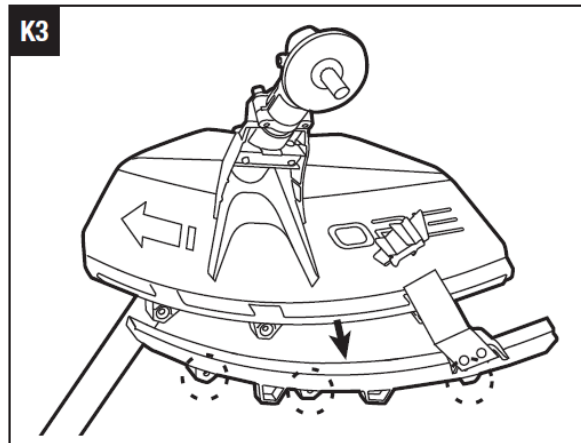
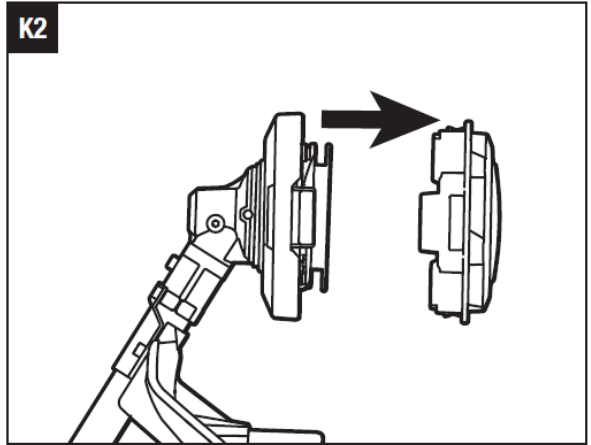
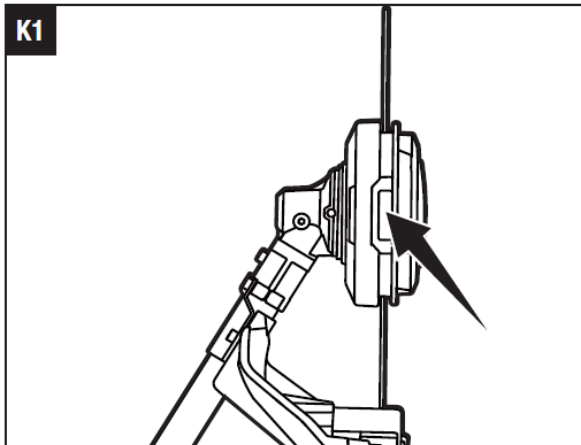
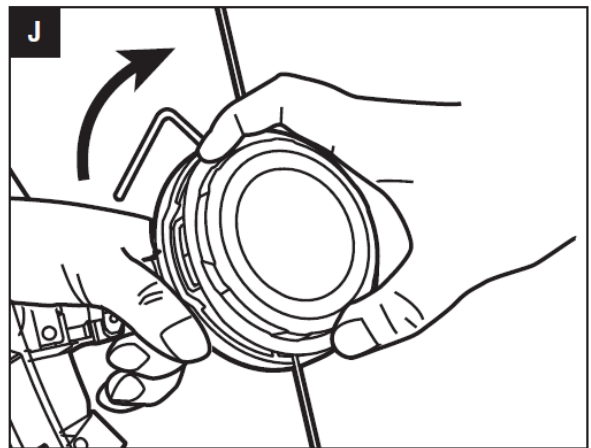
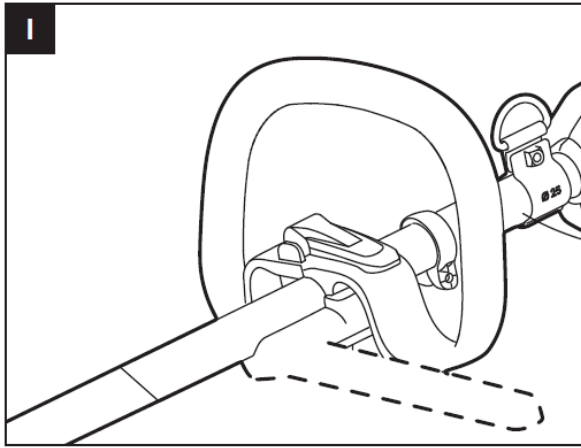

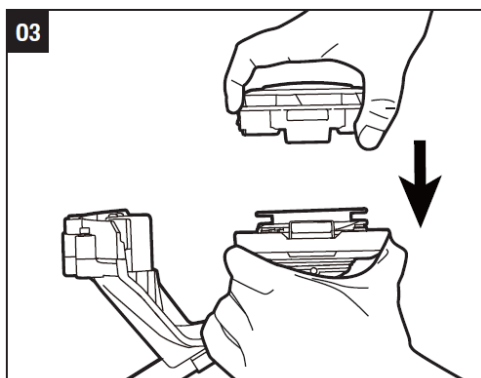
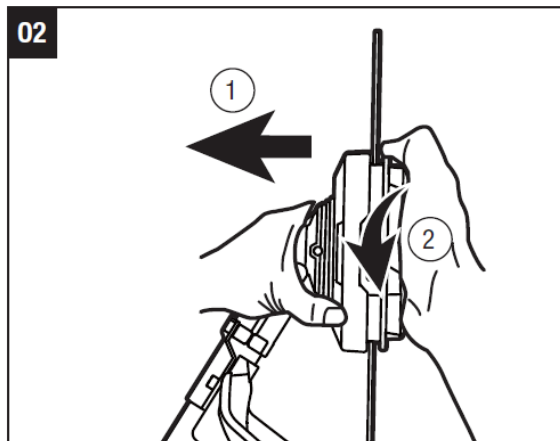
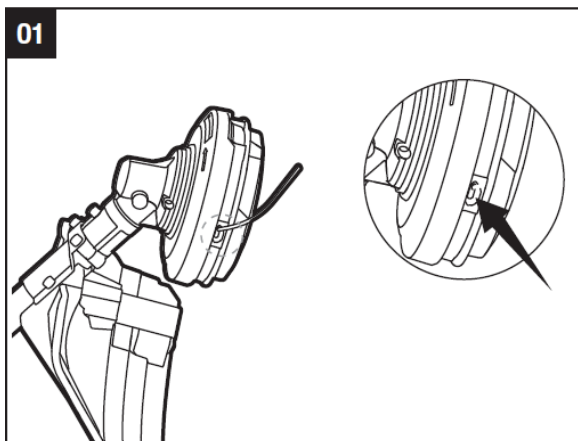
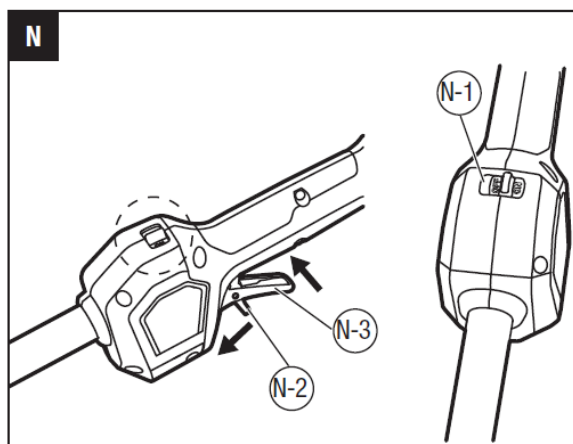
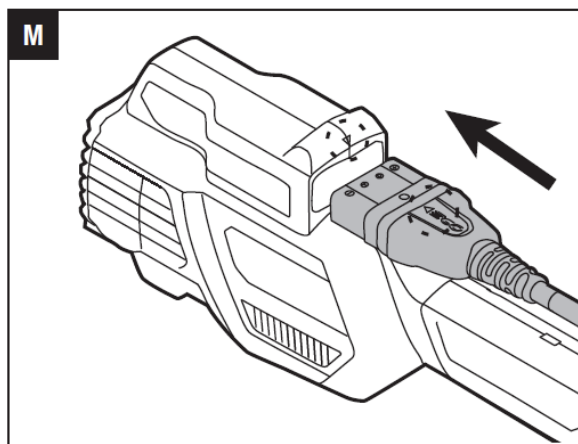

## DESCRIPTION

### KNOW YOUR LINE TRIMMER (Fig. A1)

1. Socket
2. Lock-off Lever
3. Threshold Ring
4. Loop Handle
5. Trimmer Line
6. Guard Assembly
7. Shaft
8. Trigger
9. Rear Handle
10. Trimmer Head(Bump head)
11. Release Tab

12. Line-cutting Blade
13. Safety Barrier Bar (For brush cutter head only)
14. Locking Pole For Safety Barrier Bar (For brush cutter head only)
15. Out Flange (For brush cutter head only)
16. Nut (For brush cutter head only)
17. Screw
18. Allen key
19. Nut

**Guard Assembly:**

The guard assembly provides protection and should be securely attached before use.

**WARNING:** If any parts are damaged or missing, do not operate this product until the parts are replaced. Use of this product with damaged or missing parts could result in serious personal injury.

**WARNING:** Do not attempt to modify this product or create accessories not recommended for use with this Line trimmer. Any such alteration or modification is misuse and could result in a hazardous condition leading to possible serious personal injury.

**WARNING:** To prevent accidental starting that could cause serious personal injury, always unplug the battery connector from the socket when assembling parts.

**WARNING:** When the tool is equipped with brush cutter head, the safety barrier bar should be mounted.

**MOUNTING THE GUARD**

**WARNING:** Always wear gloves when mounting or replacing the guard. Take care of the blade on the guard and protect your hand from cutting.

**WARNING:** Never operate the tool without the guard firmly in place. The guard must always be on the tool to protect the user! When the guard is fixed, never attempt to remove or adjust the guard, if a replacement is needed, it should be performed by a qualified service technician! Loosen and remove the two screws from the guard (Fig. B), align the guard mounting holes with the assembly holes and then lock the guard onto the shaft base with the two screws, together with two spring washers (Fig. C).



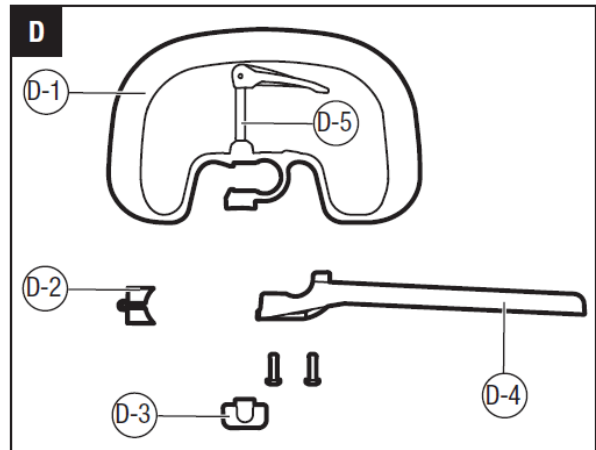
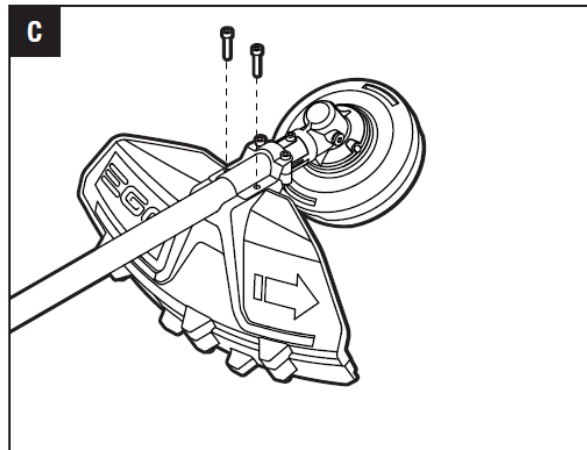
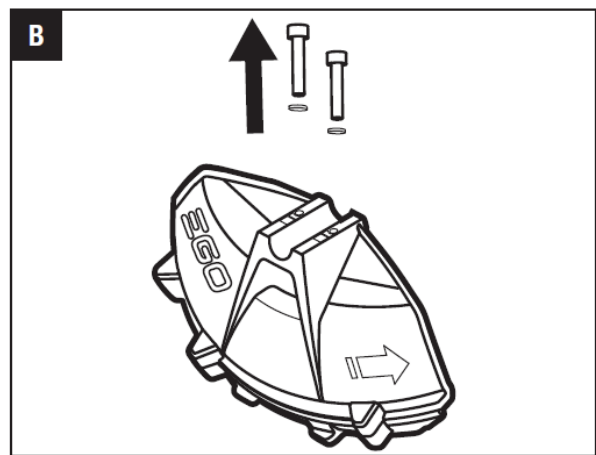
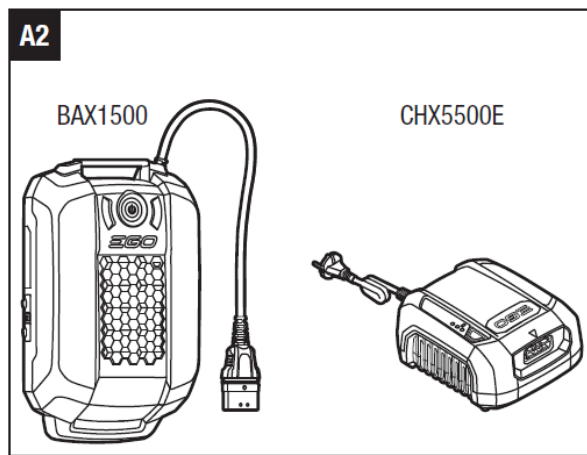

**WARNING:** Make sure the guard is fixed according to Fig. B & C, Lany reverse fixing will cause great danger!

## MOUNTING AND ADJUSTING THE LOOP HANDLE

1. Stop the motor and unplug the battery connector from the socket, if installed.
2. Loosen the wing nut to separate the adjustable loop handle (Fig. D).

**NOTICE:** Install the safety barrier bar assembly onto the loop handle with the two screws when the tool is equipped with brush cutter head.

**parts description see below:**

D-1	Loop handle	D-4	Safety barrier bar (Only for brush cutter head)
D-2	Clamping block	D-5	Locking pole
D-3	Wing nut		

**NOTICE:** There are two kinds of locking pole, the shorter one is for trimmer head. The longer one is for brush cutter head. Be carefully to choose the correct locking pole when using the tool.

3. Push the loop handle onto the shaft at the front of threshold ring. Never place it between the threshold ring and rear handle area.(Fig. E).

**NOTICE:** Adjust the loop handle between the threshold ring and the warning label when the tool is equipped with brush cutter head (Fig. F).

4. Insert the clamping block into the handle slot (Fig. G).
5. Mount the locking pole, and pre-tighten them with the wing nut. Make sure that the loop handle is upwards and

- points toward the top of the rear handle (Fig. H).
6. Adjust the loop handle between the threshold ring and the label until find the comfortable position when using the trimmer. .
  7. Lock the lever of the locking pole (Fig. I).

**WARNING:** Never operate the tool without the loop handle firmly in place.

**WARNING:** Only fix the loop handle between the threshold ring and the label.

## **REPLACE THE TRIMMER HEAD WITH THE 3-TEETH BLADE**

1. Remove the power plug from the string trimmer.
2. Rotate the trimmer head to align the slot in the flange with the shaft-locking hole in the gear case and insert a stabilizer into the hole (Fig. J).
3. Rotate the trimmer head **CLOCKWISE** to remove it (Fig. J).
4. Remove the guard accessory by loosening the three screws with washer (Fig. K3).  
**NOTICE:** To protect against injury, you have to wear gloves prior to any operation with the 3-teeth blade.
5. Mount the inner flange and flange cover into its place (Fig. L1).
6. Mount the blade onto the motor shaft, ensuring that the surface of the blade is flush with the surface of the inner flange bulge. Mount the outer flange and the nut (Fig. L2). Pre-tighten the nut in a **COUNTERCLOCKWISE** direction by hand.
7. Position the gear case against a solid surface for support. With one hand hold the brush cutter shaft and the other hand grasp the multi-function wrench to tighten the nut following the directional arrow icon marked on the outer flange (Fig. L3).

## **OPERATION**

- **WARNING:** Do not allow familiarity with this product to make you careless. Remember that a careless fraction of a second is sufficient to inflict serious injury.
- **WARNING:** Always wear eye protection, along with hearing protection. Failure to do so could result in objects being thrown into your eyes and other possible serious injuries.
- **WARNING:** Do not use any attachments or accessories not recommended by the manufacturer of this product. The use of attachments or accessories not recommended can result in serious personal injury.
- **WARNING:** To prevent serious personal injury, unplug the battery connector from the socket before servicing, cleaning, changing attachments or removing material from the unit.

## **APPLICATIONS**

The product may be used in rain. You may use this product for the purposes listed below:

**Trimming:** used for removing grass and weeds up against walls, fences, trees and borders.

**Cutting:** used for cutting the grass that is difficult to reach using a normal mower.

**NOTICE:** The tool is to be used only for its prescribed purpose. Any other use, for example hedge trimming, is deemed to be a case of misuse.

## **ATTACHING/DETACHING THE BATTERY CABLE**

Use only with EGO's battery packs and chargers listed in Fig.A2 Fully charge before first use.

### To Install Battery cable (Fig.M)

Align of plug with of line trimmer. Insert the plug into the machine until the green seal completely disappeared into the socket.

### To Remove

Release the battery cord from the mounting groove and pull out the plug from the line trimmer.

### HOLDING THE LINE TRIMMER

**WARNING:** Dress properly to reduce the risk of injury when operating this tool. Do not wear loose clothing or jewelry. Wear eye and ear/hearing protection. Wear heavy duty, long trousers, boots and gloves. Do not wear short trousers, sandals or go barefoot. Before operating, hold the trimmer with both hands, one hand on the rear handle and the other on the front-assist handle which shall be straight. Then check for balanced footing and a proper cutting distance.

**NOTICE:** The trimmer head is parallel to the ground at a proper cutting distance without the operator bending over.

### STARTING/STOPPING THE LINE TRIMMER (Fig. N)

#### To Start

Push the lock-off Lever to position "ON", push the locking tongue forward then depress the switch trigger. The trigger is stepless speed adjusting. The more you pull up the trigger, the higher speed it is.

N-1	Lock-off Lever	N-3	Switch Trigger
N-2	Locking tongue		

#### To Stop

Release the switch trigger and push the lock-off button back to position "OFF".

**WARNING:** Always unplug the battery connector from the socket during work breaks and after finishing work.

### USING THE LINE TRIMMER

**WARNING:** To avoid serious personal injury, wear goggles or safety glasses at all times when operating this unit. Wear a face mask or dust mask in dusty locations. Clear the area to be cut before each use. Remove all objects, such as rocks, broken glass, nails, wire, or line, that can be thrown or become entangled in the cutting attachment. Clear the area of children, bystanders, and pets. At a minimum, keep all children, bystanders and pets at least 15m away; there still may be risk to bystanders from thrown objects. Bystanders should be encouraged to wear eye protection. If you are approached, stop the motor and cutting attachment immediately.

#### Before each use, check for damaged/worn parts

Check the pump head, guard and loop handle and replace the parts that are cracked, warped, bent, or damaged in any way. The line-cutting blade on the edge of the guard can dull over time. It is recommended that you periodically sharpen it with a file or replace it with a new blade.

**WARNING:** Always wear gloves when mounting or replacing the guard or when sharpening or replacing the line-cutting blade. Note the location of the blade on the guard and protect your hands from injury.

#### Check for blockage of the trimmer head

- To prevent blockage, keep the trimmer head clean. Remove grass clippings, leaves, dirt and any other accumulated debris before and after each use.
- When blockage happens, stop the line trimmer and remove the battery, then remove any grass that may have

wrapped itself around the motor shaft or trimmer head.

**After each use, clean the trimmer.**

**CAUTION:** Obstructions in the vents will prevent the air from flowing into the motor housing and result in overheating or damaged of the motor.

- Use only mild soap and a damp cloth to clean the tool. Never let any liquid get inside the tool; never immerse any part of the tool into a liquid.
- Keep air vents in the motor housing from debris a times.

**WARNING:** Avoid using solvents when cleaning plastic parts. Most plastics are susceptible to damage from various types of commercial solvents. Use clean cloths to remove dirt, dust, oil, grease, etc.

**ADJUSTING CUTTING LINE LENGTH**

The trimmer head allows the operator to release more cutting line without stopping the motor. As line becomes frayed or worn, additional line can be released by lightly tapping the bump head on the ground while operating the trimmer.

**NOTICE:** Line release will become more difficult if the cutting line becomes too short.

**WARNING:** Do not remove or alter the line-cutting blade assembly. Excessive line length will cause the motor to overheat and may result in serious personal injury.

**Line replacement**

**NOTICE:** Always use the recommended nylon cutting line with a diameter that does not exceed 2.7 mm. Using line other than that specified may cause the line trimmer to overheat or become damaged.

**WARNING:** Never use metal-reinforced line, wire, or rope, etc. These can break off and become dangerous projectiles.

1. Remove the power plug from the string trimmer.
2. Remove the remaining cutting line, if necessary.
3. Cut 8m long cutting line, Insert the line into the mounting hole inside the eyelet (Fig. O1). Push and pull the line from the other side until equal amounts of line appear on both sides of the spool.
4. Press, while rotating the lower cover assembly in the arrow direction, to wind the line onto the spool until approximately 12 cm of line is showing on each side (Fig. O2).
5. Push the lower cover assembly down while pulling on the lines to manually advance the line and to check for proper assembly of the trimmer head.

**When the cutting line breaks from the line outlet or the cutting line is not released when the trimmer head is tapped, follow the steps below:**

1. Press the release tabs on the upper cover and remove the lower cover assembly by pulling it straight out (Fig. K1 & K2).
2. Remove the cutting line from the spool.
3. With one hand holding the lower cover assembly, use the other hand to grasp the lower cover assembly and align the tabs on the upper cover with the holes in the lower cover assembly (Fig. O3); Use your palm to press the lower cover assembly until the tabs lock with the upper cover.
4. Follow the instructions in "LINE REPLACEMENT" to reload the cutting line.

## MAINTENANCE

- **WARNING:** When servicing, use only identical replacement parts. Inspect and maintain the machine regularly. To ensure safety and reliability, all repairs should be performed by a qualified service technician.
- **WARNING:** Battery tools do not have to be plugged into an electrical outlet; therefore, they are always in operating condition. To prevent serious personal injury, take extra precautions and care when performing maintenance, service or for changing the cutting attachment or other attachments.
- **WARNING:** To prevent serious personal injury, unplug the battery connector from the socket before servicing, cleaning, changing add-on attachments or removing material from the unit.

### LUBRICATE THE GEAR CASE

For best operation and longer lifetime, lubricate the gear case with a special grease (4-5g each time) after every 50 hours operation.

The special grease should meet the following requirements.

1. Belong to DIN51818: NLGI-1 cone penetration degree.
2. Ester base grease.
3. Excellent low-temperature startup, EP, mechanical shearing, abrasion resistance and oxidative stability properties.
4. Operation temperature must contain -40~180°C. Remove the battery plug and the sealing screw. Lubricating the gear case through the oil-hole.

**WARNING:** Do not lubricate while the brush cutter is still connected with battery or running.

### SHARPENING THE LINE-CUTTING BLADE

**WARNING:** Always protect your hands by wearing heavy gloves when performing any maintenance on the line-cutting blade.

1. Remove the line-cutting blade from the guard.
2. Wear proper eye protection and gloves and be careful not to cut yourself.
3. Secure the blade in a vise.
4. Carefully file the cutting edges of the blade with a fine-tooth file or sharpening stone, maintaining the original cutting edge angle.
5. Replace the blade on the guard and secure it in place with the two screws.

### CLEANING THE UNIT

- Clean the unit using a damp cloth with a mild detergent.
- Do not use any strong detergents on the plastic housing or the handle. They can be damaged by certain aromatic oils, such as pine and lemon, and by solvents such as kerosene. Moisture can also cause a shock hazard. Wipe off any moisture with a soft dry cloth.

### STORING THE UNIT

- Unplug the battery connector from the socket from the line trimmer when it is not in use.

- Clean the tool thoroughly before storing it.
- Store the unit in a dry, well-ventilated area, locked-up or up high, out of the reach of children. Do not store the unit on or adjacent to fertilizers, petrol, or other chemicals.
- Use of a transport cover for metal blades during transport and storage.

**Protecting the environment**

Do not dispose of electrical equipment, used battery and charger into household waste! Take this product to an authorized recycler and make it available for separate collection. Electric tools must be returned to an environmentally compatible recycling facility.

**TROUBLESHOOTING**

PROBLEM	CAUSE	SOLUTION
Fail to start	■ The battery pack is not attached to the line trimmer.	■ Attach the battery pack to the line trimmer.
	■ No electrical contact between the trimmer and battery.	■ Re insert the battery pack with the specified charger.
	■ The battery pack is depleted.	■ Charge the battery pack.
Stop working	■ The guard is not mounted on the trimmer, resulting in an overly long cutting line and motor overloaded.	■ Unplug the battery connector from the socket and mount the guard on the trimmer.
	■ Heavy cutting line is used.	■ Use recommended nylon cutting line with diameter no greater than 3.0mm.
	■ The motor shaft or trimmer head is winded with grass.	■ Stop the trimmer, remove the battery, and remove the grass from the shaft and trimmer head.
	■ The motor is overloaded.	■ The machine will recover when the load is removed. For continuous working, reduce the load of the machine.
	■ The battery pack or line trimmer is too hot.	■ Allow the battery pack or trimmer to cool until the temperature drops below 67°C.
	■ The connector of battery pack is disconnected from the tool.	■ Re-plug in the connector again.
	■ The battery pack is depleted.	■ Charge the battery pack.
The cutting line can't be released.	■ The motor shaft or trimmer head is wound with grass.	■ Stop the trimmer, remove the battery and remove the grass from the motor shaft and trimmer head.
	■ There is not enough line in the trimmer head.	■ Remove the battery and replace the cutting line; follow the section "LINE REPLACEMENT" in this manual.
	■ The trimmer head is dirty.	■ Remove the battery and clean the lower cover assembly, spool and upper cover.
	■ Line is tangled in the trimmer head	■ Remove the battery, remove the line from the spool and rewind; follow the section "LINE REPLACEMENT" in this manual.
	■ The line is too short.	■ Remove the battery and pull the lines while alternately pressing down on and releasing the trimmer head.
Grass wraps around trimmer head and motor housing	■ Cutting tall grass at ground level.	■ Cut out the weeds into several sections from top to ground level.

## WARRANTY

## EGO WARRANTY POLICY

Please visit the website [egopowerplus.eu](http://egopowerplus.eu) for full terms and conditions of the EGO Warranty policy.

## Frequently Asked Questions (FAQ):

**Q: What is the cutting width of the trimmer?**

A: The cutting width of the line trimmer is 38 cm.

**Q: What type of cutting line does it use?**

A: The trimmer uses a 2.4 mm nylon twist line.

**Q: How much does the trimmer weigh without the battery pack?**

A: The trimmer weighs 5.8 kg without the battery pack.

## Documents / Resources

	<p><a href="#">EGO STX3800 Volt Lithium Ion Cordless Line Trimmer</a> [pdf] Instruction Manual STX3800 Volt Lithium Ion Cordless Line Trimmer, STX3800, Volt Lithium Ion Cordless Line Trimmer, Ion Cordless Line Trimmer, Cordless Line Trimmer, Line Trimmer, Trimmer</p>
---	---

## References

- [User Manual](#)

[Manuals+](#), [Privacy Policy](#)

This website is an independent publication and is neither affiliated with nor endorsed by any of the trademark owners. The "Bluetooth®" word mark and logos are registered trademarks owned by Bluetooth SIG, Inc. The "Wi-Fi®" word mark and logos are registered trademarks owned by the Wi-Fi Alliance. Any use of these marks on this website does not imply any affiliation with or endorsement.