

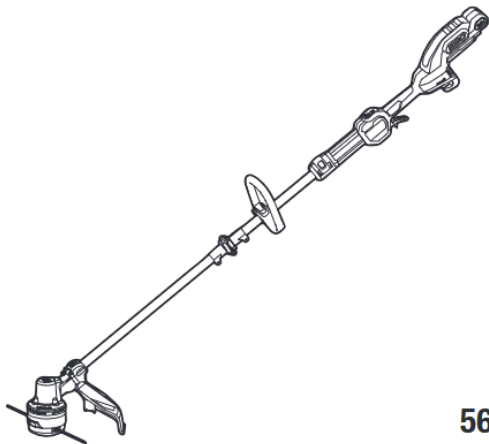

EGO ST1610E-T 56 Volt Lithium Ion Cordless Line Trimmer Instruction Manual

[Home](#) » [EGO](#) » EGO ST1610E-T 56 Volt Lithium Ion Cordless Line Trimmer Instruction Manual 

EGO ST1610E-T 56 Volt Lithium Ion Cordless Line Trimmer Instruction Manual



ST1610E-T

**56 VOLT LITHIUM-ION
CORDLESS LINE TRIMMER**

OP_EGO_ST1610E-T_EV03.31_250214

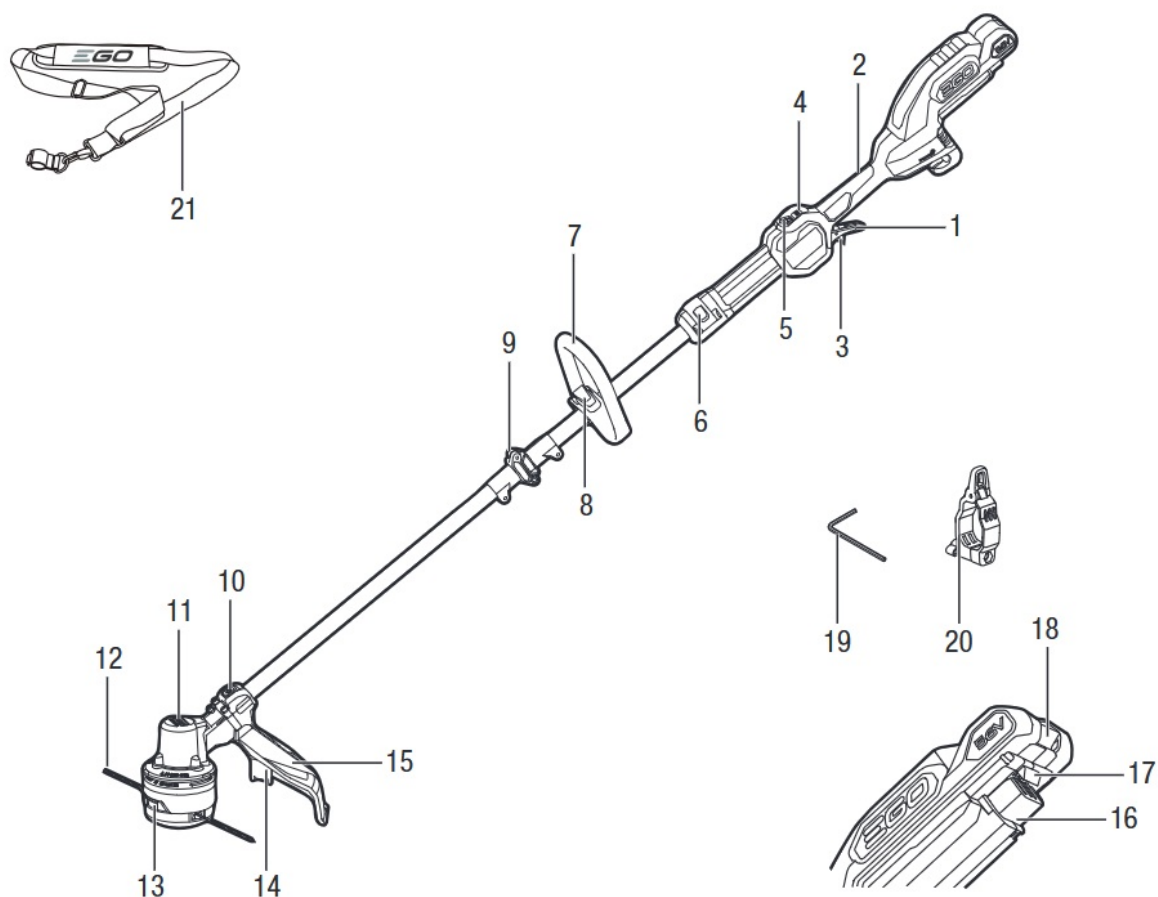

A2

BA1400, BA2800, CH2100E,
BA4200, BA1400T, CH3200E,
BA2240T, BA2242T, CH5500E,
BA2800T, BA3360T, CH7000E,
BA4200T, BA5600T, CH7000E-T
BA6720T

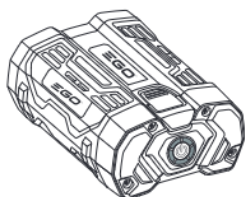
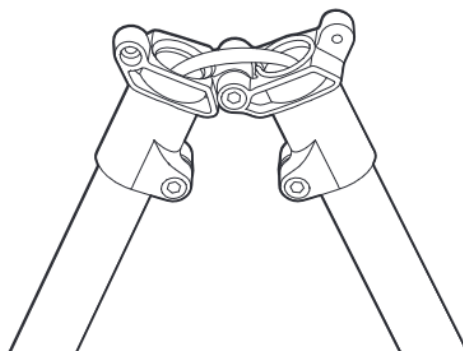
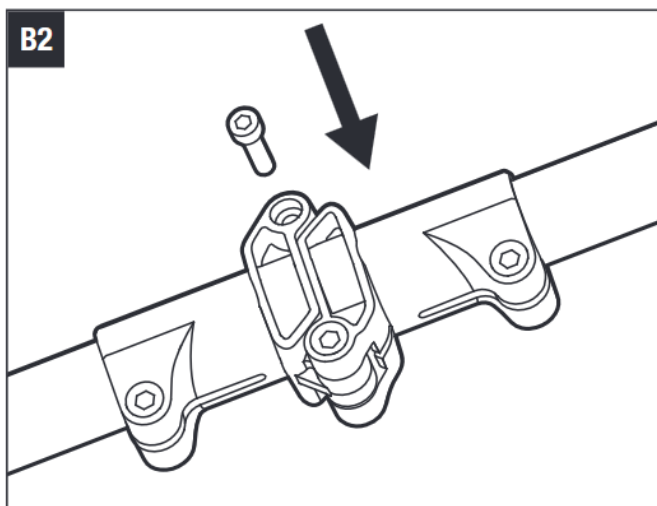
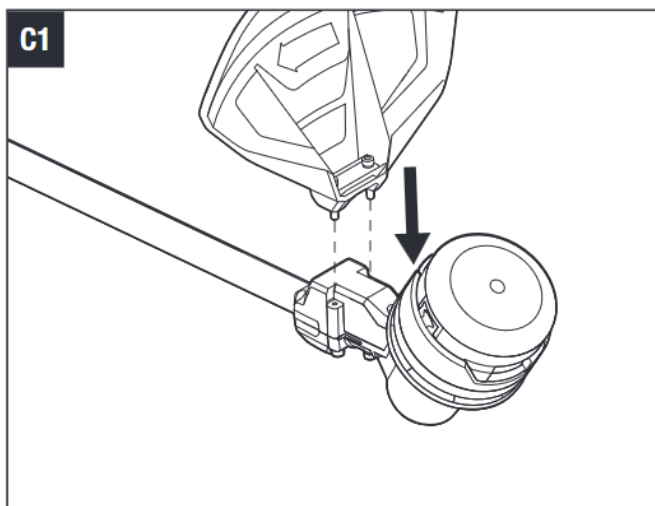
**B1****B2****C1**

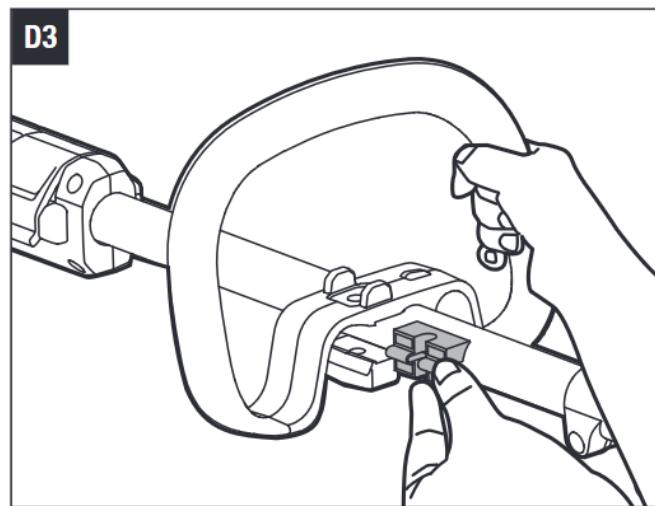
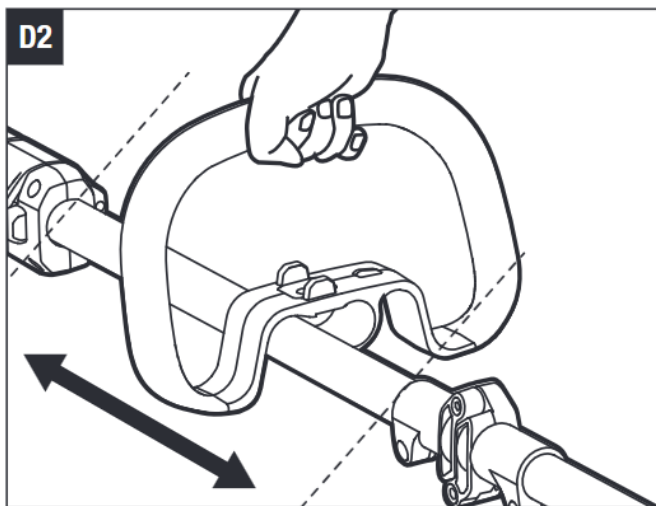
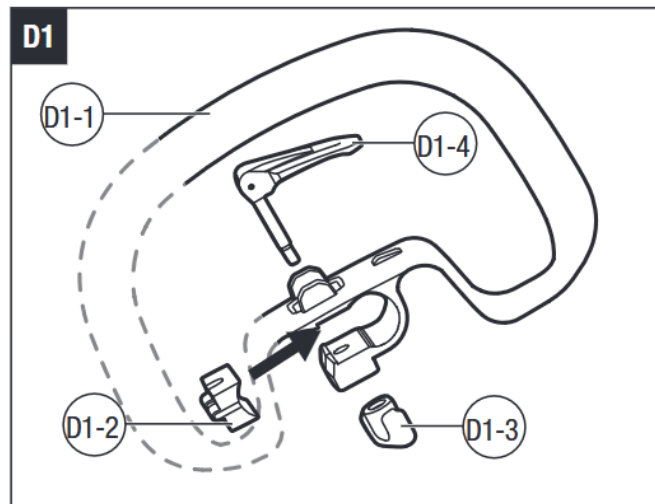
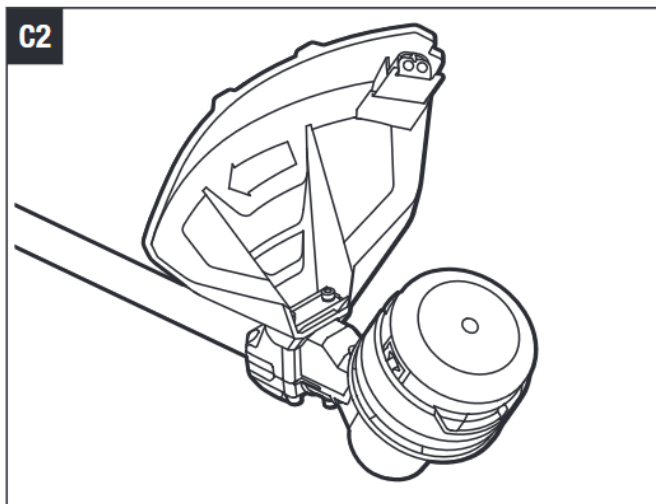

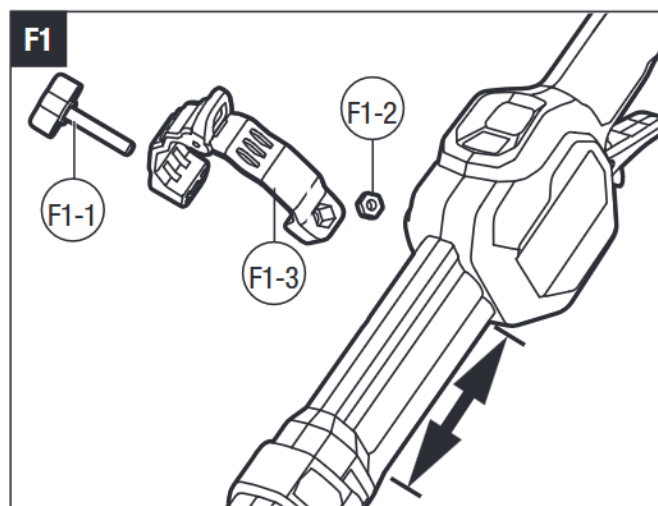
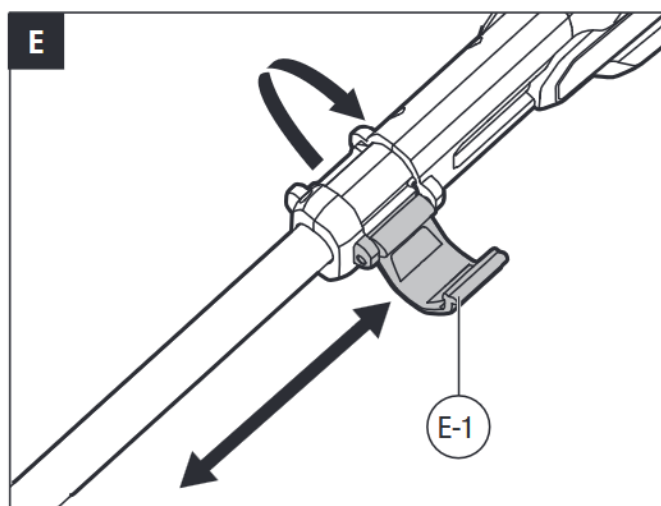
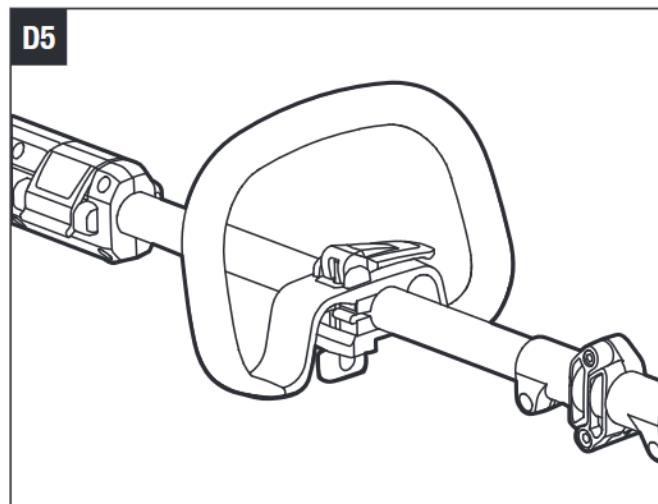
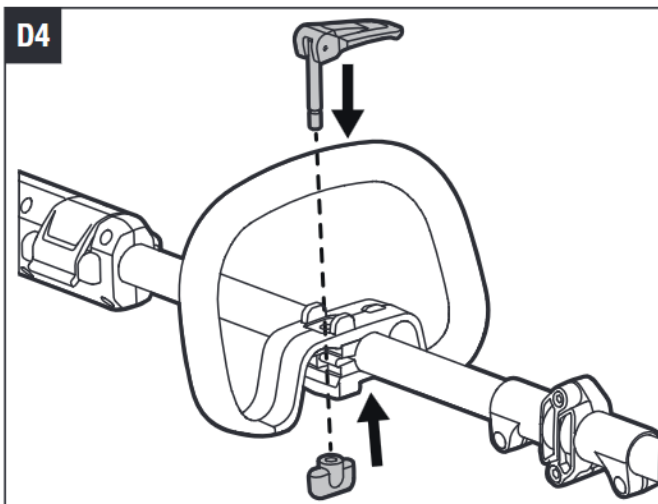

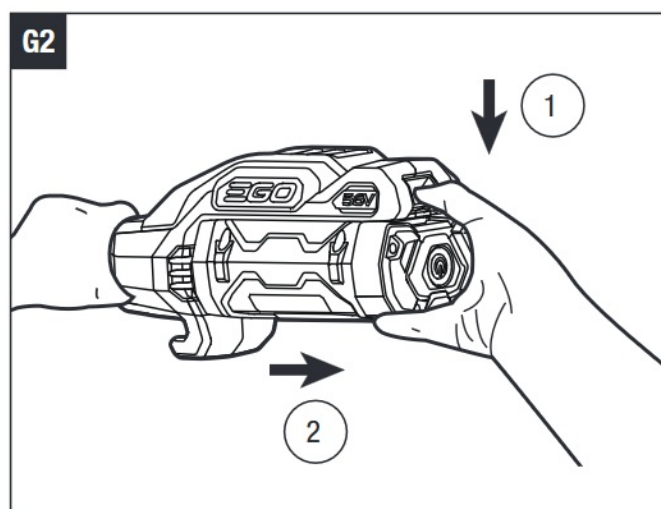
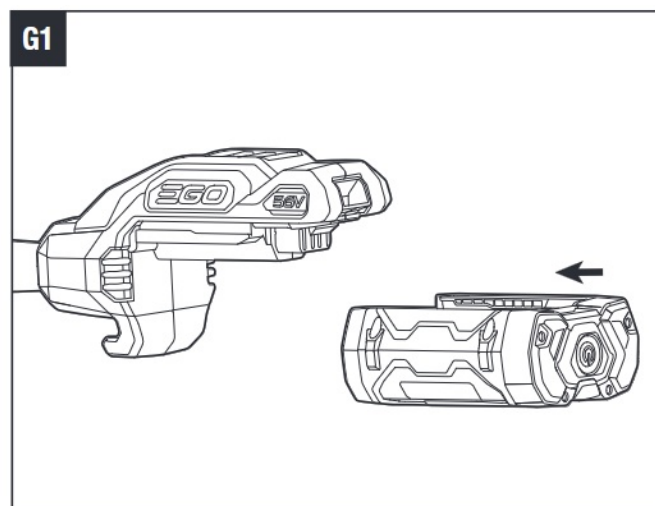
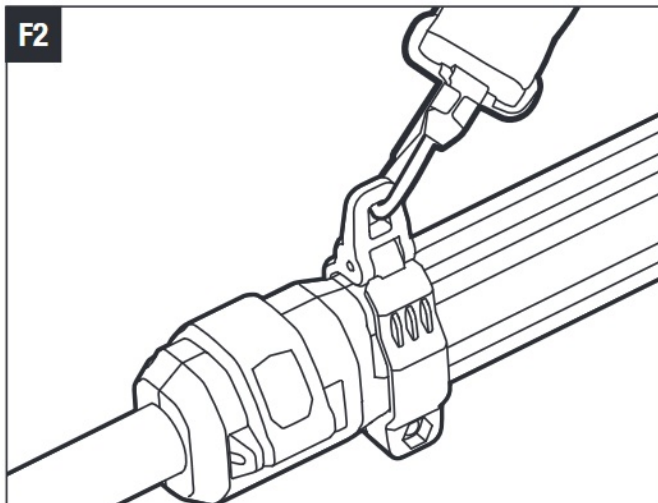

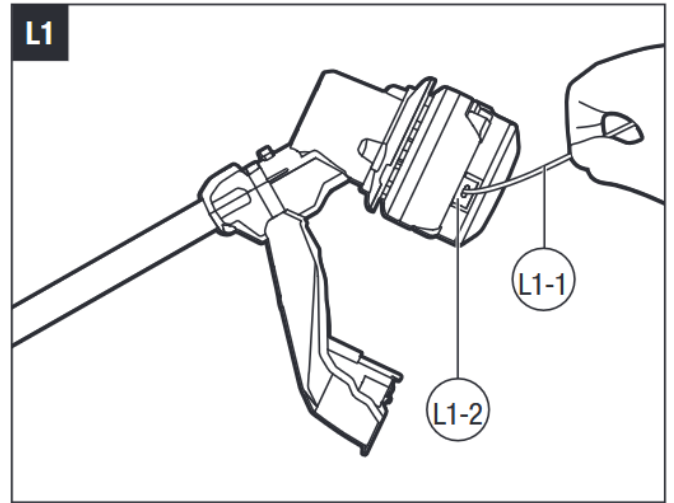
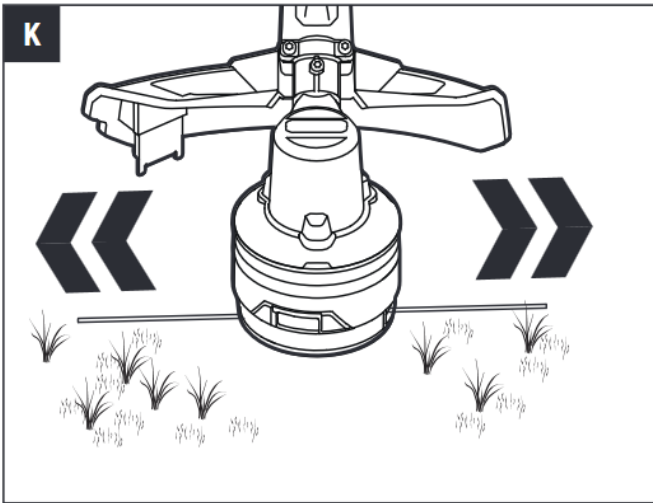
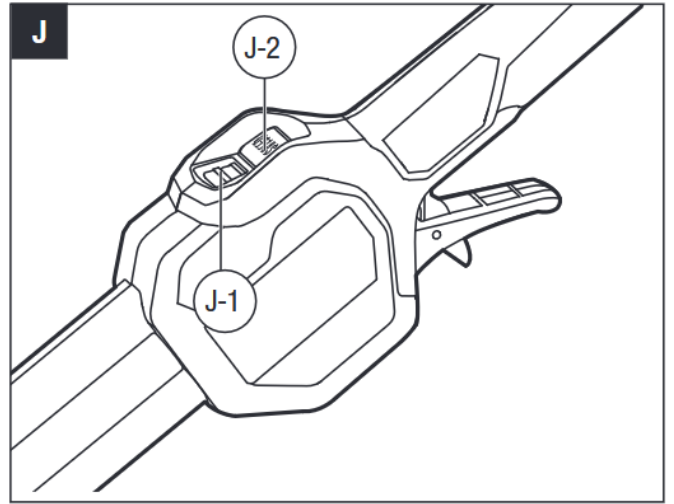
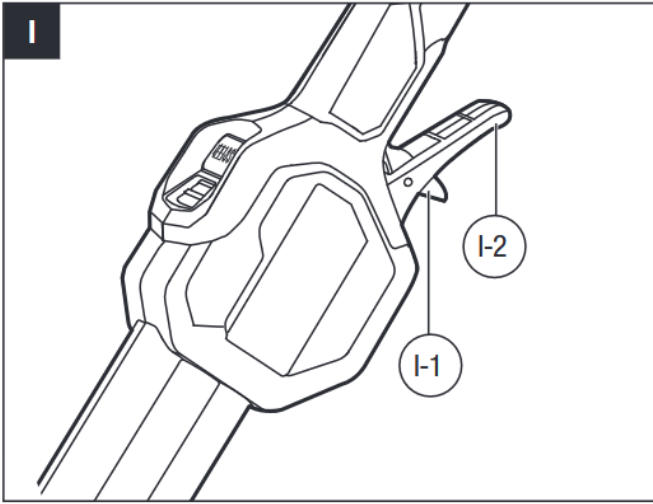

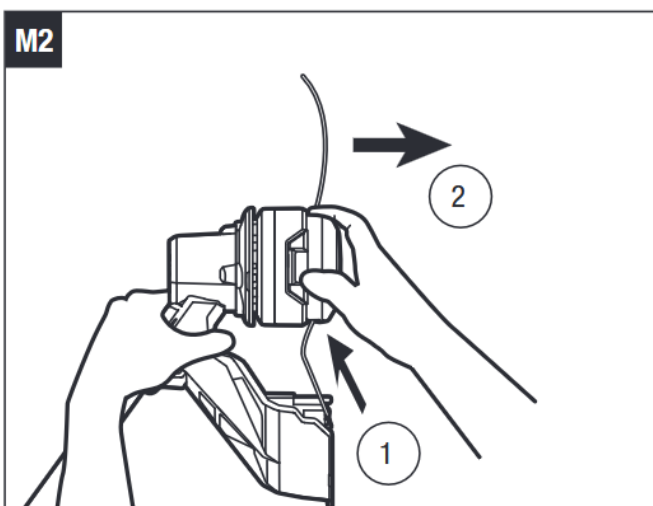
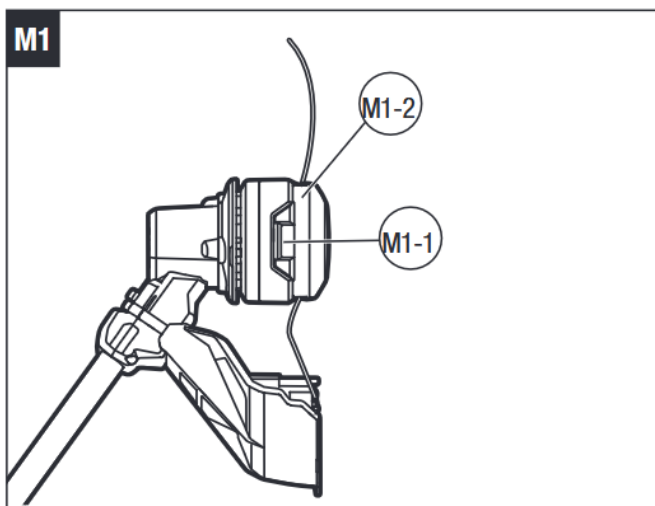
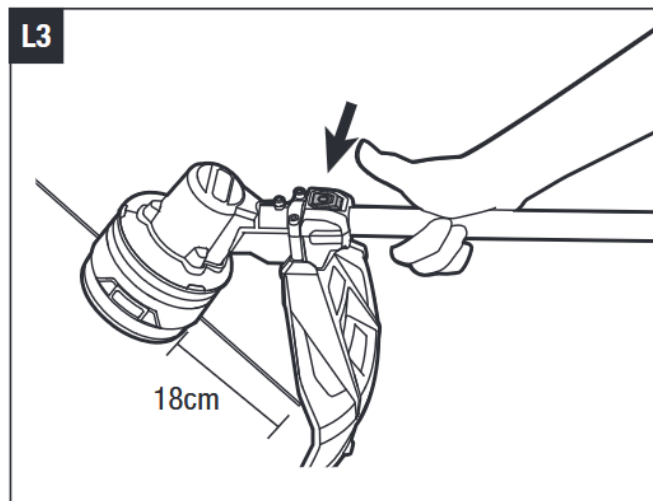
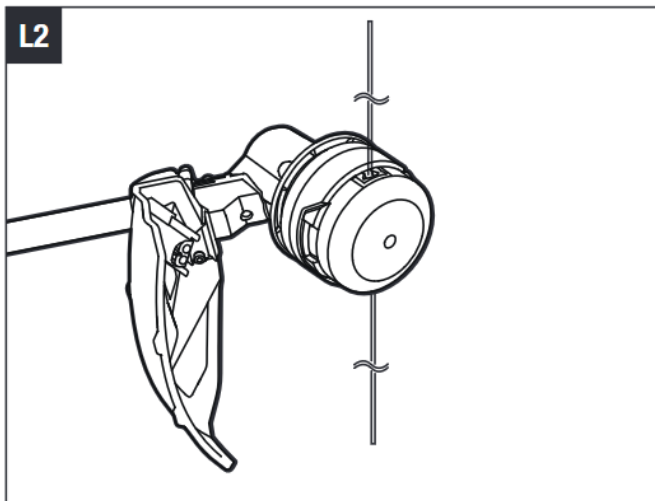

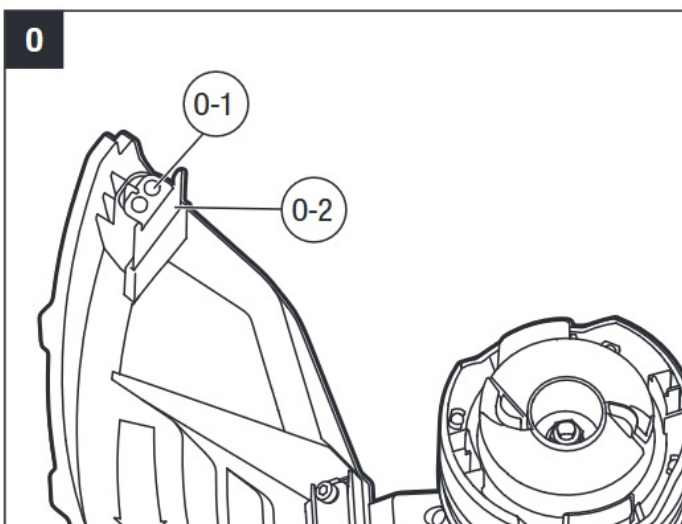
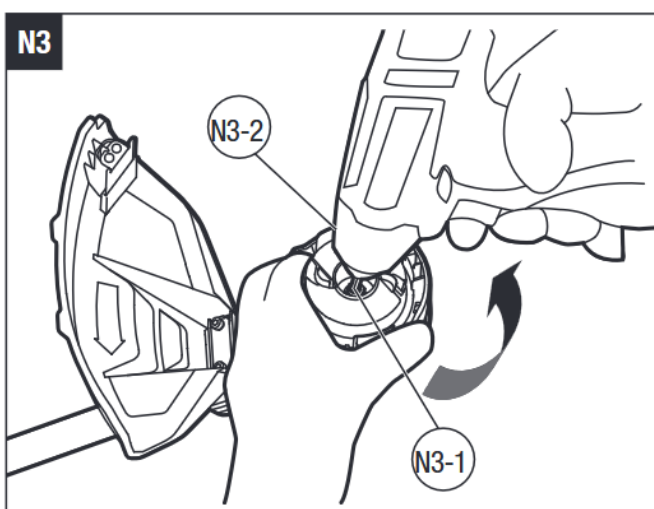
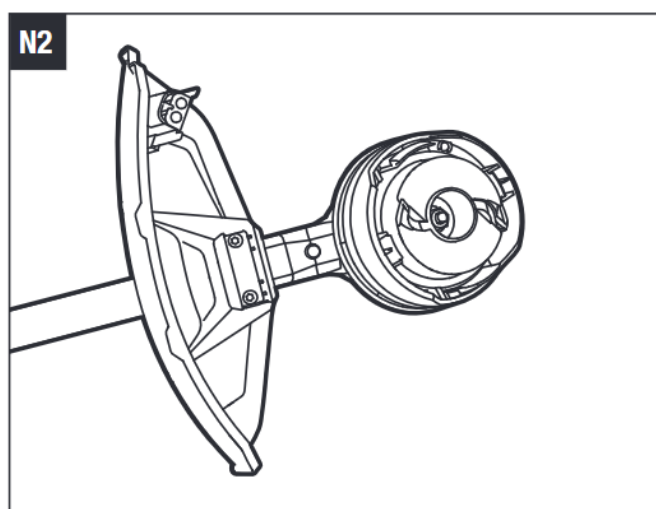
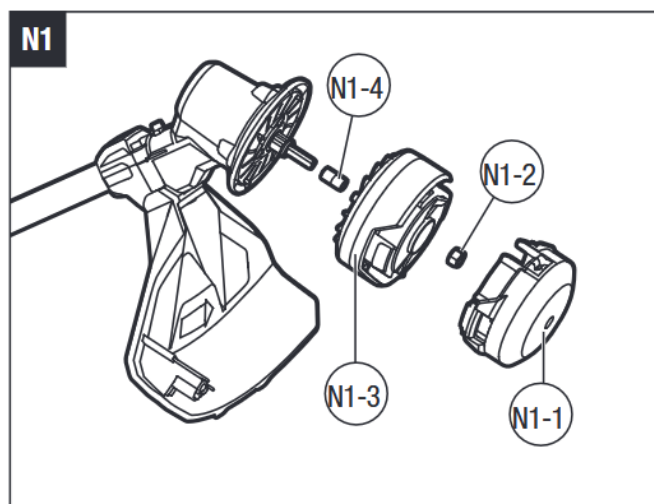
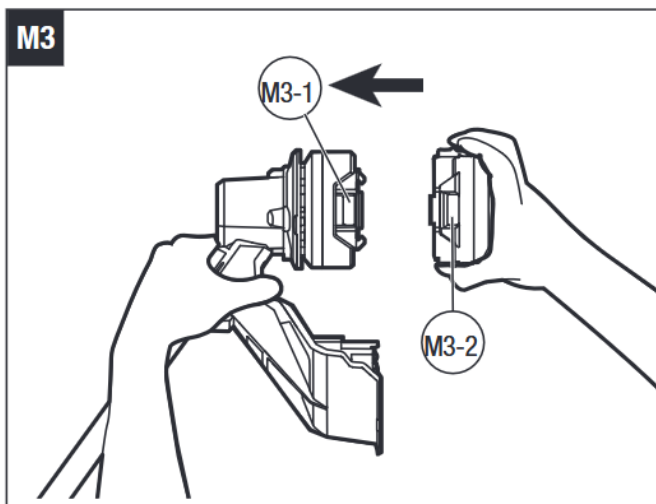

READ ALL INSTRUCTIONS!

READ OPERATOR'S MANUAL

⚠ Safety Alert



Wear Eye Protection-Always wear safety goggles or safety glasses with side shields and a full face shield when operating this product.



Wear Ear Protection—Always wear ear protection when operating this product.



Waste electrical products should not be disposed of with household waste. Take to an authorized recycler.



Keep safe distance —The distance between the machine and bystanders shall be at least 15m



Cutting width-The Max. cutting width of line trimmer



Disconnect the battery pack from the line trimmer before carrying out maintenance or cleaning work



This product is in accordance with applicable UK legislation.

A Amperes

cm Centimeter



Direct Current

Contents

- 1 SAFETY SYMBOL**
- 2 SPECIFICATIONS**
- 3 DESCRIPTION**
- 4 PACKING LIST (FIG. A1)**
 - 4.1 ASSEMBLY**
 - 4.2 UNFOLDING THE SHAFT**
 - 4.3 MOUNTING THE GUARD**
 - 4.4 ADJUSTING THE TRIMMER HEIGHT**
 - 4.5 ATTACHING SHOULDER STRAP**
- 5 OPERATION**
 - 5.1 ATTACHING/DETACHING THE BATTERY PACK**
 - 5.2 HOLDING THE LINE TRIMMER (Fig. H)**
 - 5.3 STARTING/STOPPING THE LINE TRIMMER (Fig. I)**
 - 5.4 SPEED ADJUSTMENT FUNCTION (Fig. J)**
 - 5.5 USING THE LINE TRIMMER**
 - 5.6 ADJUSTING THE CUTTING LINE LENGTH**
 - 5.7 LINE REPLACEMENT**
 - 5.8 RELOADING THE CUTTING LINE**
 - 5.9 TRIMMER HEAD REPLACEMENT**
- 6 MAINTENANCE**
 - 6.1 CLEANING THE UNIT**
 - 6.2 SHARPENING THE LINE-CUTTING BLADE**
 - 6.3 STORING THE UNIT**
- 7 TROUBLESHOOTING**
- 8 WARRANTY**
- 9 Documents / Resources**
 - 9.1 References**

SAFETY SYMBOL

The operation of any power tools can result in foreign objects being thrown into your eyes, which can result in severe eye damage. Before beginning power tool operation, always wear safety goggles or safety glasses with side shields and a full face shield when needed. We recommend a Wide Vision Safety Mask for use over eyeglasses or standard safety glasses with side shields.



To reduce the risk of injury, user must read the operator's manual.

IPX4 Protection from splashing water



Guaranteed sound power level.



Beware of thrown objects —Thrown objects can ricochet and result in personal injury or property damage. Ensure that other people and pets remain away from the line trimmer when it is in use.



Do not use the metal blades on the line trimmer



Line diameter-The Diameter of the nylon cutting line



This product is in accordance with applicable EC directives.

V Voltage

mm Millimeter

kg Kilogram

... /min Per Minute

SPECIFICATIONS

Voltage	56 V $\overline{\text{---}}$	
No-Load Speed	Low speed range: 3500-4800 min ⁻¹	
	High speed range: 4000-5500 min ⁻¹	
Cutting Line Mechanism	LINE-IQ FEEDING	
Cutting Line Type	2.4 mm nylon twist line	
Cutting Width	40 cm	
Recommended Operating Temperature	0°C - 40°C	
Storage Temperature	-20°C - 70°C	
Weight (without battery pack)	3.5 kg	
Measured sound power level L_{WA}	90 dB(A) K=2.5 dB(A)	
Sound pressure level at operator's ear L_{PA}	77 dB(A) K=3 dB(A)	
Guaranteed sound power level L_{WA} (measured according to 2000/14/EC)	92 dB(A)	
Valuation of vibration a_h	Front handle	3.9 m/s ² K=1.5 m/s ²
	Rear handle	2.7 m/s ² K=1.5 m/s ²

- The declared vibration total value has been measured in accordance with a standard test method and may be used for comparing one tool with another;
- The declared vibration total value may also be used in a preliminary assessment of exposure.

NOTICE: The vibration emission during actual use of the power tool can differ from the declared value in which the tool is used; In order to protect the operator, user should wear gloves and ear protectors in the actual conditions of use.

DESCRIPTION

KNOW YOUR LINE TRIMMER (Fig. A1)

1. Variable Speed Trigger
2. Rear Handle
3. Locking Tongue
4. 2-Speed Switch
5. Speed Indicator
6. Height Locking Collar
7. Quick Adjustable Front Handle
8. Quick-release Lever
9. Hinge & Locking Bolt
10. POWERLOAD™ Button
11. Trimmer Head (with LINE-IQ Feeding)

- 12. Cutting Line
- 13. Release Tab
- 14. Line-Cutting Blade
- 15. Guard
- 16. Ejection Mechanism
- 17. Latch
- 18. Battery Release Button
- 19. Hex Wrench
- 20. Shoulder Strap Loop
- 21. Shoulder Strap

PACKING LIST (FIG. A1)

ASSEMBLY

 **WARNING:** If any parts are damaged or missing, do not operate this product until the parts are replaced. Use of this product with damaged or missing parts could result in serious personal injury.

 **WARNING:** Do not attempt to modify this product or create accessories not recommended for use with this line trimmer. Any such alteration or modification is misuse and could result in a hazardous condition leading to possibly serious personal injury.

 **WARNING:** To prevent accidental starting that could cause serious personal injury, always remove the battery pack from the tool when assembling parts.

UNFOLDING THE SHAFT

 **WARNING:** In order to avoid pinching your hands or fingers, do not hold the shaft at the joint.

 **WARNING:** Do not attempt to start the trimmer until the shaft has been locked.

Unfold the shaft gently, ensuring the cable inside the shaft and lock it with the bolt by the supplied wrench (Fig. B1 & B2).

MOUNTING THE GUARD

 **WARNING:** Always wear gloves when mounting or replacing the guard. Be careful of the blade on the guard and protect your hands from being injured by the blade.

 **WARNING:** Never operate the tool without the guard firmly in place. The guard must always be on the tool to protect the user! When the guard is fixed, never attempt to remove or adjust the guard, if a replacement is needed, it should be performed by a qualified service technician!

Position your trimmer so that the trimmer head faces up (Fig. C1). Align the guard mounting holes with the assembly holes and then lock the guard on the shaft base with the two screws (Fig. C2).

NOTICE: Make sure the guard is fixed according to Fig. C1 & C2, any reverse fixing will cause great danger!

MOUNTING AND ADJUSTING THE FRONT HANDLE

1. Loosen and remove the quick-release lever and wing nut from the front handle (Fig. D1).

D1-1	Front handle	D1-2	Clamping block
D1-3	Wing nut	D1-4	Quick-release lever

2. Push the front handle onto the shaft within the mounting zone between the height locking collar and hinge (Fig. D2).
3. Insert the clamping block into the handle slot (Fig. D3).
4. Mount the quick-release lever and pretighten the wing nut. Make sure that the front handle is positioned upwards and points toward the top of the rear handle (Fig. D4).
5. Pull the quick-release lever up to move/rotate the front handle to a comfortable operating position, and then lock the quick-release lever (Fig. D5).

NOTICE: The front handle should be positioned on the shaft only within the mounting zone.



WARNING: The tool cannot be used without the front handle securely fixed.

ADJUSTING THE TRIMMER HEIGHT

If the length of the shaft is not suitable for operation, you can adjust the length of the shaft through the height locking collar.

1. Remove the battery pack from the trimmer.
2. To adjust the trimmer height (i.e., shaft length), open the height locking collar, and then slide the shaft up or down to desired height, securing it in place by depressing the height locking collar (Fig. E).

E-1: Height locking collar

NOTICE: The front handle may need to be repositioned after the trimmer height is changed.

ATTACHING SHOULDER STRAP

For safe and better operation, put the strap over one of your shoulders and across your back.

1. Loosen screw knob and hex nut from the shoulder strap loop (Fig. F1).

F1-1: Screw knob

F1-2: Hex nut

F1-3: Should strap loop

2. Place the shoulder strap loop at a comfortable operating position within the installation zone, and then fix it by tightening the screw knob and hex nut.
3. Depress the shoulder strap carabineer to open it and attach the shoulder strap to the hole on the strap loop (Fig. F2).
4. Adjust the shoulder strap length and placement to a comfortable operating position.



WARNING: When an emergency occurs, take the shoulder strap off from your shoulder immediately, no matter what way the strap is on.

You should not use the single-shoulder strap and double-shoulder strap simultaneously.

When wearing the strap, make sure there is no other wearable interferes with the release and removal of the strap.

OPERATION

 **WARNING:** Always wear safety goggles or safety glasses with side shield, along with hearing protection. Failure to do so could result in objects being thrown into your eyes and other possible serious injuries.

Trimming: grass and weeds from around porches, fences, and decks.

Cutting: grass that is difficult to reach using a normal mower.

ATTACHING/DETACHING THE BATTERY PACK

Use only with EGO's battery packs and chargers listed in Fig.A2

Fully charge before first use.

To Attach

Align the battery ribs with the mounting slots and press the battery pack down until you hear a "click" (Fig. G1).

To Detach

Depress the battery-release button and pull the battery pack out (Fig. G2).

HOLDING THE LINE TRIMMER (Fig. H)

For safe and better operation, put on the shoulder strap across the shoulder. Adjust the shoulder strap length and placement to a comfortable operating position – hold the trimmer with both hands: one hand on the rear handle and the other hand on the front handle.

NOTICE: The trimmer head is parallel to the ground at a proper cutting distance without the operator bending over.

 **WARNING:** When an emergency occurs, take the shoulder strap off from your shoulder immediately, no matter what way the strap is on.

STARTING/STOPPING THE LINE TRIMMER (Fig. I)

To Start

Move the locking tongue forward and then press the variable speed trigger.

The trigger is stepless speed adjusting. The more you pull up the trigger, the higher speed it is.

I-1: Locking tongue

I-2: Variable speed trigger

To Stop

Release the variable speed trigger.

SPEED ADJUSTMENT FUNCTION (Fig. J)

The line trimmer has two speed setting. Press the 2-speed switch to change cutting speed between the low and high.

The speed indicator will display the active speed status: one light for low speed and two lights for high speed. The low speed range provides better control of the trimmer and longer operating time per charge.

J-1: Speed indicator

J-2: 2-Speed switch

USING THE LINE TRIMMER

Clear the area to be cut before each use. Remove all objects, such as rocks, broken glass, nails, wire, or lien that can be thrown or become entangled in the cutting attachment. Clear the area of children, bystanders, and pets. At a minimum, keep all children, bystanders and pets at least 15 m away; there still may be risk to bystanders from thrown objects. Bystanders should be encouraged to wear eye protection. If you are approached, stop the motor and cutting attachment immediately.

Before each use check for damaged/worn parts

Check the trimmer head, guard, shoulder strap, shoulder strap loop, and front handle. Replace any parts that are cracked, warped, bent, or damaged in any way.

The line-cutting blade on the edge of the guard can dull over time. It is recommended that you periodically sharpen it with a file or replace it with a new blade.

 **WARNING:** Always wear gloves when mounting or replacing the guard or when sharpening or replacing the line-cutting blade. Note the location of the blade on the guard and protect your hands from injury.

Check for blockage of the trimmer head

- To prevent blockage, keep the trimmer head clean. Remove grass clippings, leaves, dirt and any other accumulated debris before and after each use.
- When blockage happens, stop the line trimmer and remove the battery, then remove any grass that may have wrapped itself around the motor shaft or trimmer head.

After each use, clean the trimmer.

ADJUSTING THE CUTTING LINE LENGTH

The Line-IQ feeding trimmer head is equipped with advanced technology.

If either end of the cutting line wears less than 18 cm during trimming, the trimmer head will release cutting line automatically, and the extra part of the cutting line will be cut off by the line-cutting blade (Fig. K).

NOTICE: No need to tap the trimmer head to release the cutting line. If you feel a slight tremor of the trimmer head when trimming the grass, it is the cutting line being automatically released.

 **WARNING:** Do not remove or alter the line- cutting blade assembly. Excessive line length will cause the motor to overheat and may result in serious personal injury.

LINE REPLACEMENT

NOTICE: Always use the recommended nylon cutting line with a diameter of 2.4 mm.

Using line other than that specified may cause the tool to overheat or become damaged.

 **WARNING:** Never use metal-reinforced line, wire, or rope, etc. These can break off and become dangerous projectiles.

The line trimmer is equipped with an advanced POWERLOAD™ system. The cutting line can be wound onto the spool simply by pressing a single button. Loading a full spool can usually be completed in 12 seconds. **Avoid repeated operation of the winding system in rapid succession to reduce the possibility of motor damage.**

1. Remove the battery pack.
2. Cut one piece of cutting line 4 m long.
3. Insert the line into the eyelet and push the line until the end of the line comes out of the opposite eyelet (Fig. L1).

L1-1: Cutting line

L1-2: Eyelet

NOTICE: It is not necessary to align the eyelets in order to insert the cutting line. If the line cannot be inserted into the eyelet, mount the battery pack onto the trimmer, then press the POWERLOAD button briefly to reset the winding mechanism.

4. Remove the battery pack if it has been mounted onto the trimmer in step 3.
5. Pull the line from the other side until equal lengths of the line appear on both sides of the trimmer head (Fig. L2).
6. Install the battery pack onto the line trimmer.
7. Press and hold the POWERLOAD button to start the line-winding motor. The line will be wound into the trimmer head continuously.
8. Watch the remaining line length carefully. Prepare to release the button as soon as approximately 22 cm of line are left on each side. Briefly press the line loading button to adjust the length until 18 cm of the line is showing on each side (Fig. L3).

NOTICE: In case the line is pulled into the trimmer head by accident, open the head and pull the cutting line out from the spool. Follow the section “**RELOADING THE CUTTING LINE**” in this manual to reload the line.

RELOADING THE CUTTING LINE

NOTICE: When the cutting line gets stuck in the trimmer head, you will need to remove the remaining cutting line from the trimmer head and follow the steps below to reload the line.

1. Remove the battery pack.
2. Press the release tabs on the trimmer head and remove the lower cover assembly of the trimmer head by pulling it straight out (Fig. M1 & M2).

M1-1: Release tab

M1-2: Lower cover assembly

3. Remove the cutting line from the trimmer head.

4. With one hand holding the trimmer, use another hand to grasp the lower cover assembly and align the slots in the lower cover assembly with the release tabs. Press the lower cover assembly until it snaps into place, at which time you will hear a distinct click sound (Fig. M3).

M3-1: Release tab

M3-2: Slot

5. Follow the instructions in the “**LINE REPLACEMENT**” section to reload the cutting line.

TRIMMER HEAD REPLACEMENT

 **WARNING:** If the head loosens after it is fixed in position, replace it immediately. Never use a trimmer with a loose cutting attachment. Replace a cracked, damaged or worn-out cutting head immediately, even if damage is limited to superficial cracks. Such attachments may shatter at high speed and cause serious injury.

Know the trimmer head (Fig. N1)

N1-1: Lower cover

N1-2: Nut

N1-3: Spool assembly

N1-4: Bushing

To remove the trimmer head

1. Remove the battery pack.
2. Press the release tabs on the trimmer head and remove the lower cover of the trimmer head by pulling it straight out (see Fig. M1 & M2).
3. Remove the cutting line from the trimmer head (Fig. N2).
4. Wear gloves. Use one hand to grasp the spool assembly to stabilize it and use the other hand to hold an impact wrench (not included) to loosen the nut in a counterclockwise direction (Fig. N3).

N3-1: Nut

N3-2: Impact wrench (not included)

5. Remove the spool assembly and bushing from the motor shaft. Save the bushing for later assembly.
6. Replace with a new trimmer head and mount it in following steps.

To install the new trimmer head

1. Mount the bushing in motor shaft and mount the spool assembly into place. Use an impact wrench to tighten the nut.
2. Mount the lower cover assembly (see Fig. M3).
3. Reload the cutting line.
4. Start the tool to see whether the line trimmer will work normally. If it does not, reassemble as described above.

MAINTENANCE

 **WARNING:** When servicing, use only identical replacement parts. Use of any other parts may create a hazard or cause product damage. To ensure safety and reliability, all repairs should be performed by a qualified service technician.

 **WARNING:** To prevent serious personal injury, remove the battery pack from the tool before servicing, cleaning, or removing material from the unit.

 **CAUTION:** Obstructions in the vents will prevent the air from flowing into the motor housing and result in overheating or damaged of the motor.

CLEANING THE UNIT

- Clean the unit using a damp cloth with a mild detergent. Never let any liquid get inside the tool; never immerse any part of the tool into a liquid.
- Do not use any strong detergents on the plastic housing or the handle. They can be damaged by certain aromatic oils, such as pine and lemon, and by solvents such as kerosene. Moisture can also cause a shock hazard. Wipe off any moisture with a soft, dry cloth.
- Use a small brush or the air discharge of a small vacuum cleaner brush to clean the air vents on the rear housing.
- Keep the air vents free of obstructions.

SHARPENING THE LINE-CUTTING BLADE

 **WARNING:** Always protect your hands by wearing heavy gloves when performing any maintenance on the line-cutting blade.

1. Loosen the two screws and remove the line-cutting blade from the guard (Fig. O).

O-1: Screws

O-2: Line-cutting blade

2. Secure the blade in a vise.
3. Carefully file the cutting edges of the blade with a fine-tooth file or sharpening stone, being careful to maintain the original cutting-edge angle.
4. Replace the blade onto the guard and secure it in place with the two screws.

STORING THE UNIT

- Remove the battery pack from the trimmer.
- Clean the tool thoroughly before storing.
- Store the unit in a dry, well-ventilated area, locked-up or up high, out of the reach of the children. Do not store the unit on or adjacent to fertilizers, gasoline, or other chemicals.

Protecting the environment



Do not dispose of electrical equipment, used battery and charger into household waste! Take this product to an authorized recycler and make it available for separate collection. Electric tools must be returned to an environmentally compatible recycling facility.

TROUBLESHOOTING

PROBLEM	CAUSE	SOLUTION
Line trimmer fails to start.	<ul style="list-style-type: none"> ■ The battery pack is not attached to the trimmer. ■ No electrical contact between the trimmer and battery. ■ The battery pack is depleted. ■ The lock off switch is not being moved forward before depressing the variable speed trigger. ■ The motor shaft or trimmer head is bound with grass. 	<ul style="list-style-type: none"> ■ Attach the battery pack to the trimmer. ■ Remove battery, check contacts and reinstall the battery pack. ■ Charge the battery pack. ■ Move the locking tongue forward and then press the variable speed trigger. ■ Remove the grass from the motor shaft and trimmer head.
Line trimmer stops while cutting.	<ul style="list-style-type: none"> ■ The guard is not mounted on the trimmer, resulting in an overly long cutting line and motor overload. ■ Heavy cutting line is used. ■ The battery pack or line trimmer is too hot. ■ The battery pack is disconnected from the tool. ■ The battery pack is depleted. 	<ul style="list-style-type: none"> ■ Remove the battery pack and mount the guard on the trimmer. ■ Use recommended nylon cutting line with diameter 2.4 mm. ■ Cool the battery or line trimmer. ■ Re-install the battery pack. ■ Charge the battery pack.
Trimmer head will not advance line.	<ul style="list-style-type: none"> ■ The motor shaft or trimmer head is bound with grass. ■ There is not enough line on the spool or the line breaks from the eyelet. ■ The line is tangled. ■ The line is too short. ■ Heavy cutting line is used. ■ Trimmer head malfunction. 	<ul style="list-style-type: none"> ■ Stop the trimmer, remove the battery, and clean the motor shaft and trimmer head. ■ Remove the battery and replace the cutting line following “LINE REPLACEMENT” section in this manual. ■ Remove the battery; remove the line from the trimmer head and rewind following “RELOADING THE CUTTING LINE” section in this manual. ■ Remove the battery and pull the lines manually while alternately pressing down and releasing the trimmer head. ■ Use recommended nylon cutting line with diameter 2.4 mm. ■ Call EGO Customer Service for help.

Trimmer head continues to release line automatically.	<ul style="list-style-type: none"> ■ Light cutting line is used. 	<ul style="list-style-type: none"> ■ Use recommended nylon cutting line with diameter 2.4 mm.
Grass is wrapped around trimmer head and motor housing.	<ul style="list-style-type: none"> ■ Cutting tall grass at ground level 	<ul style="list-style-type: none"> ■ Cut tall grass from the top down, removing no more than 20 cm in each pass to prevent wrapping.
The blade is not cutting the line.	<ul style="list-style-type: none"> ■ The line-cutting blade on the edge of the guard has become dull. 	<ul style="list-style-type: none"> ■ Follow instructions to sharpen the line-cutting blade with a file or replace it with a new blade.
Cracks on the trimmer head	<ul style="list-style-type: none"> ■ The trimmer head is worn out. 	<ul style="list-style-type: none"> ■ Replace the trimmer head immediately following “TRIMMER HEAD REPLACEMENT” in this manual.
The cutting line cannot be wound into the trimmer head properly.	<ul style="list-style-type: none"> ■ Improper cutting line is used. ■ Grass debris or dirt has accumulated in the trimmer head and blocked the movement of line spool. ■ Motor is overheated due to repeatedly operating the line winding system. ■ Low battery capacity ■ The line is not wound into the spool assembly. ■ Trimmer head is defective. 	<ul style="list-style-type: none"> ■ We suggest that you use EGO original nylon cutting line. If using EGO nylon line and the problem persists, please call EGO customer service for advice. ■ Remove the battery, open the trimmer head and clean it thoroughly. ■ Let the line trimmer work under no load for a few minutes to cool the motor, then try to reload the line. ■ Charge the battery ■ Pull out the line and reinsert it. ■ Call EGO Customer Service for help.
The cutting line cannot be passed through the trimmer head when inserting the line.	<ul style="list-style-type: none"> ■ The cutting line is split or bent at the end. 	<ul style="list-style-type: none"> ■ Cut the worn end of line and reinsert.

WARRANTY

EGO WARRANTY POLICY

Please visit the website egopowerplus.eu for full terms and conditions of the EGO Warranty policy.

Documents / Resources

	<p>EGO ST1610E-T 56 Volt Lithium Ion Cordless Line Trimmer [pdf] Instruction Manual ST1610E-T, ST1610E-T 56 Volt Lithium Ion Cordless Line Trimmer, 56 Volt Lithium Ion Cordless Line Trimmer, Lithium Ion Cordless Line Trimmer, Cordless Line Trimmer, Line Trimmer</p>
---	---

References

- [User Manual](#)

[Manuals+](#), [Privacy Policy](#)

This website is an independent publication and is neither affiliated with nor endorsed by any of the trademark owners. The "Bluetooth®" word mark and logos are registered trademarks owned by Bluetooth SIG, Inc. The "Wi-Fi®" word mark and logos are registered trademarks owned by the Wi-Fi Alliance. Any use of these marks on this website does not imply any affiliation with or endorsement.