



Contents [[hide](#)]

- 1 EGO RTA2300 Multitool Rotocut Brush Cutter Attachment
- 2 SAFETY SYMBOLS
- 3 SPECIFICATIONS
- 4 PACKING LIST
- 5 DESCRIPTION
- 6 ASSEMBLY
- 7 OPERATION
- 8 MAINTENANCE
- 9 TROUBLESHOOTING
- 10 WARRANTY
- 11 FAQ
- 12 Documents / Resources
 - 12.1 References



EGO RTA2300 Multitool Rotocut Brush Cutter Attachment



FOR USE ONLY WITH THE 56V LITHIUM-ION POWER HEAD
PH1400E/PH1420E/PHX1600

ROTOCUT ATTACHMENT

MODEL NUMBER RTA2300/RTA2320

WARNING: To reduce the risk of injury, the user must read and understand the Operator's Manual before using this product. Save these instructions for future reference.

READ ALL INSTRUCTIONS!

READ OPERATOR'S MANUAL

WARNING: To ensure safety and reliability, all repairs and replacements should be performed by a qualified service technician.

SAFETY SYMBOLS

The purpose of safety symbols is to attract your attention to possible dangers. The safety symbols and the explanations with them deserve your careful attention and

understanding. The symbol warnings do not, by themselves, eliminate any danger. The instructions and warnings they give are no substitutes for proper accident prevention measures.

 **WARNING:** Be sure to read and understand all safety instructions in this Operator’s Manual, including all safety alert symbols such as “DANGER,” “WARNING,” and “CAUTION” before using this tool. Failure to follow all instructions listed below may result in electric shock, fire, and/or serious personal injury.

SYMBOL MEANING



SAFETY ALERT SYMBOL: Indicates DANGER, WARNING, OR CAUTION, may be used in conjunction with other symbols or pictographs.



 **WARNING:** The operation of any power tools can result in foreign objects being thrown into your eyes, which can result in severe eye damage. Before beginning power tool operation, always wear safety goggles or safety glasses with side shields and a full-face shield when needed.

We recommend a Wide Vision Safety Mask for use over eyeglasses or standard safety glasses with side shields.

SAFETY INSTRUCTIONS

This page depicts and describes safety symbols that may appear on this product. Read, understand, and follow all instructions on the machine before attempting to assemble and operate it.

	Safety Alert	Precautions that involve your safety.
	Read Operator’s Manual	To reduce the risk of injury, user must read and understand operator’s manual before using this product.

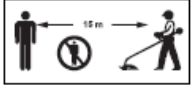
	Wear Eye Protection	Always wear safety goggles or safety glasses with side shields and a full face shield when operating this product.
	Wear Ear Protection	Always wear ear protection when operating this product.
	Wear Head Protection	Wear an approved safety hard hat to protect your head.
	Wear Protective Gloves	Protect your hands with gloves when handling blade or blade guard.
	Wear Slip- resistant Footwear	Wear non-slip safety footwear when using this equipment.
	WARNING -Beware of thrown objects	Thrown objects can ricochet and result in personal injury or property damage. Ensure that other people and pets remain away from the line trimmer when it is in use.
	WARNING -Beware of blade thrust	Warn the operator of the danger of blade thrust
	Keep Safe Distance	WARNING – The distance between the machine and bystanders shall be at least 15m.
	Noise	Guaranteed sound power level.

	WEEE	Waste electrical products should not be disposed of with household waste . Take to an authorised recycler.
---	------	--

	WARNING – Disconnect battery before maintenance	Disconnect the battery pack from the line trimmer before carrying out maintenance or cleaning work
V	Volt	Voltage
kg	Kilogram	Weight
n0	No Load Speed	Rotational speed, at n0 load
... /min	Per Minute	Revolutions per minute
°C	Celsius Degree	Temperature

IMPORTANT SAFETY INSTRUCTIONS

WARNING: Read all safety warnings, instructions, illustrations and specifications provided with this power tool. Failure to follow all instructions listed below may result in electric shock, fire and/or serious injury.

Save all warnings and instructions for future reference.

- Avoid Dangerous Environments – Don't use appliances on damp or wet slope.
- Keep guards in place and in working order.
- Keep hands and feet away from the cutting area.
- To reduce the risk of injury, never work on a ladder or on any other unstable support. Never hold the cutting unit above waist height.
- Check the cutting unit at regular short intervals during operation, or immediately if there is a noticeable change in cutting behavior.
- For best results, your battery should be charged in a location where the temperature is greater than 5°C and less than 40°C. Do not store it outside or in vehicles.

- If you are approached, stop the motor and cutting unit.
- Warn the operator of the danger of blade thrust.
- Blade thrust may occur when the spinning blade contacts an object that it does not immediately cut.
- Blade thrust can be violent enough to cause the unit and/or operator to be propelled in any direction, and possibly lose control of the unit.
- Blade thrust can occur without warning if the blade snags, stalls or binds.
- Blade thrust is more likely to occur in areas where it is difficult to see the material being cut.
- Do not attach any blade to a unit without proper installation of all required parts. Failure to use the proper parts can cause the blade to fly off and seriously injure the operator and/or bystanders. Discard blades that are bent, warped, cracked, broken, or damaged in any way. Use a sharp blade A dull blade is more likely to snag and thrust.
- A coasting blade/line can cause injury while it continues to spin after the motor is stopped or trigger is released. Maintain proper control until the blade/line has completely stopped rotating.
- Battery tools do not have to be plugged into an electrical outlet; therefore, they are always in operating condition. Be aware of possible hazards even when the tool is not operating. Take care when performing maintenance or service.
- Do not wash with a hose; avoid getting water in motor and electrical connections.
- If situations occur that are not covered in this manual, use care and good judgment. Contact the EGO Customer Service Centre for assistance.
- Use only with battery packs and chargers listed below.

BATTERY PACK	CHARGER
BA1400, BA1400T, BA2800, BA2800T, BA4200, BA4200T, BA5600T, BA6720T	CH2100E CH5500E CH7000E CH7000E-T

SAVE THESE INSTRUCTIONS!

SPECIFICATIONS

No-load Speed	450 min-1
---------------	-----------

Cutting Blade	ABR2300
Recommended Operating Temperature	0°C-40°C
Recommended Storage Temperature	-20°C-70°C
Weight(without battery pack)	2.6 kg

PACKING LIST

PART NAME	QUANTITY
ROTOCUT	1
Guard Assembly	1
Wrench	1
Allen Key	1
Operator's Manual	1

DESCRIPTION

KNOW YOUR ROTO CUT ATTACHMENT (Fig. A)

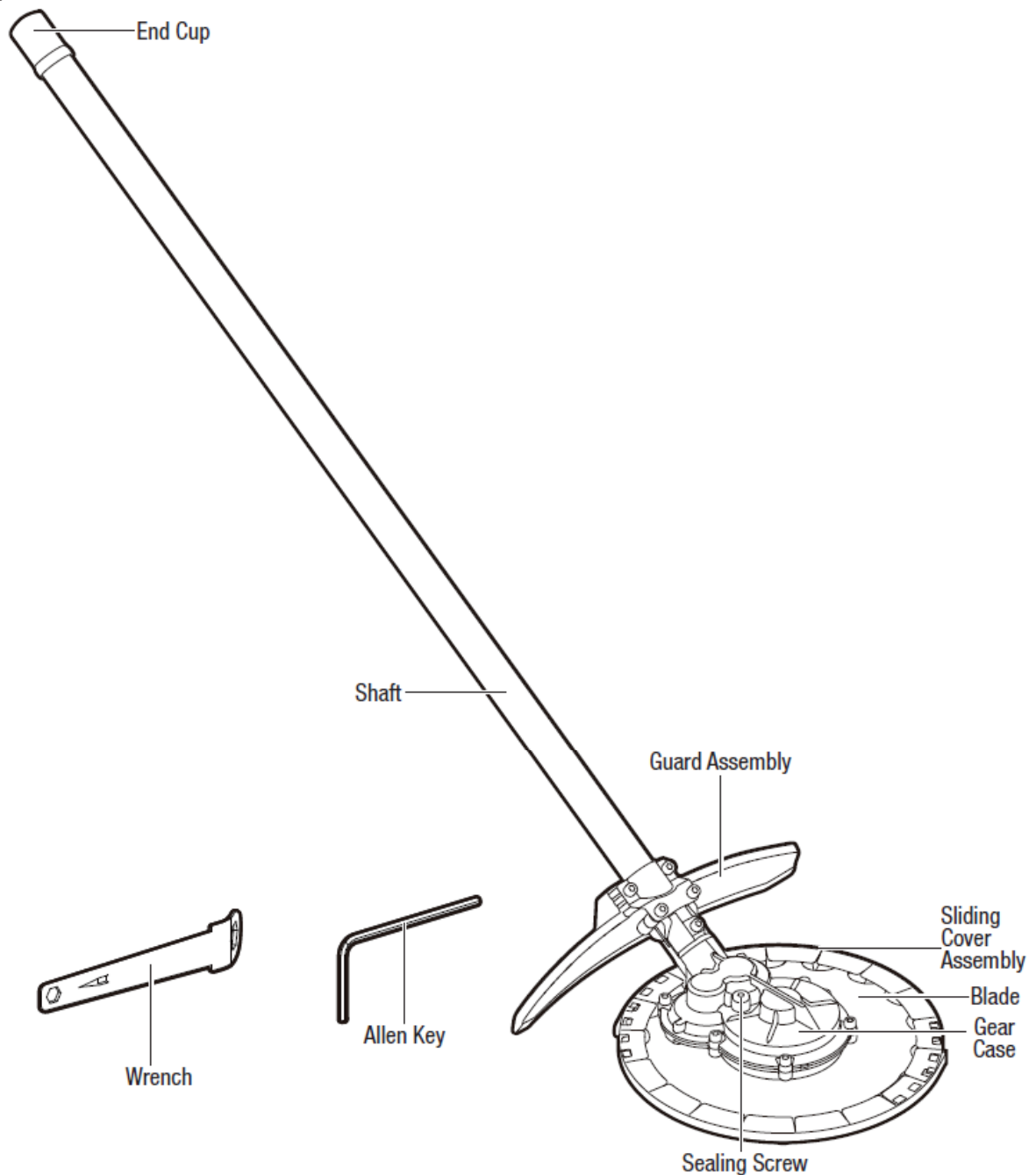
A

1. Sealing Screw
2. Gear Case
3. Blade
4. Sliding Cover Assembly
5. Guard Assembly
6. Shaft
7. End Cup
8. Wrench
9. Allen Key

ASSEMBLY

- **WARNING:** If any parts are damaged or missing, do not operate this product until the parts are replaced. Use of this product with damaged or missing parts could result in serious personal injury.
- **WARNING:** Do not attempt to modify this product or create accessories not recommended for use with this machine. Any such alteration or modification is misuse and could result in a hazardous condition leading to possible serious personal injury.

MOUNTING THE GUARD

- **WARNING:** Always wear gloves when mounting or replacing the guard. Take care of the blade on the guard and protect your hand from cutting.
- **WARNING:** Never operate the tool without the guard firmly in place. The guard must always be on the tool to protect the user! When the guard is fixed, never attempt to remove or adjust the guard, if a replacement is needed, it should be performed by a qualified service technician!
- Loosen and remove the two screws from the guard (Fig. B), align the guard mounting holes with the assembly holes and then lock the guard onto the shaft base with the two screws, together with two spring washers (Fig. C).
- **WARNING:** Make sure the guard is fixed according to Fig. B & C, any reverse fixing will cause great danger!

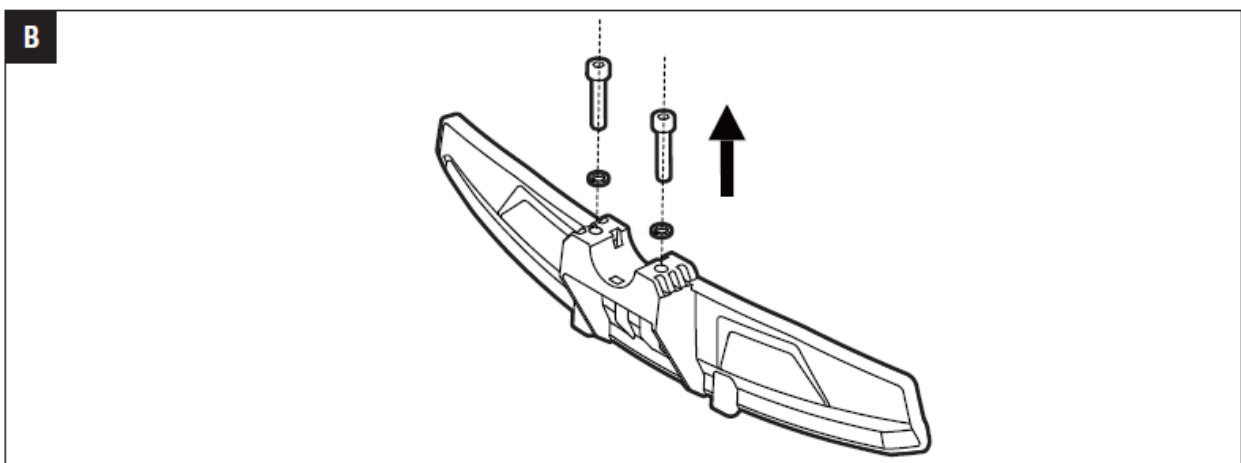

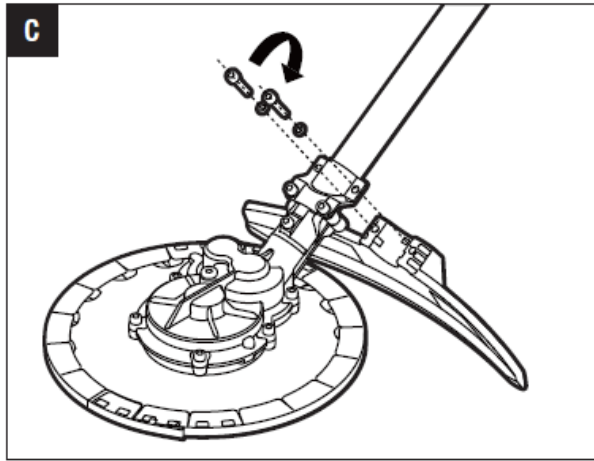

CONNECTING THE ROTOCUT ATTACHMENT TO THE POWER HEAD

- This rotocut attachment is designed for use with EGO Power Head PH1400E\PH1420E\PHX1600. See “ INSTALLING AN ATTACHMENT TO THE POWER HEAD ” section in the power head PH1400E operator’s manual or “ INSTALLING A POWER HEAD ATTACHMENT ” section in the power head PH1420E operator’s manual.

OPERATION

- **WARNING:** Do not allow familiarity with this product to make you careless. Remember that a careless fraction of a second is sufficient to inflict serious injury.
- **WARNING:** Do not use any attachments or accessories not recommended by the manufacturer of this product. The use of attachments or accessories not recommended can result in serious personal injury.
- You may use this product for the purposes listed below:
- **Cutting:** used for cutting the grass around stakes or guard rails, wall edges, road curbs, fences in the running traffic, or trimming the vegetation on parking lots.

NOTICE: When using the rotocut attachment, ensure that no foreign objects are thrown out which entails strong risks: broken windows, dented car bodies, slit fences, torn tree bark or personal injury.

USING THE ROTOCUT ATTACHMENT WITH POWER HEAD

WARNING: To avoid serious personal injury, wear goggles or safety glasses at all times when operating this unit. Wear a face mask or dust mask in dusty locations.

- Clear the area to be cut before each use. Remove all objects, such as rocks, broken glass, nails, wire, or line, that can be thrown or become entangled in the cutting attachment. Clear the area of children, bystanders, and pets. At a minimum, keep all children, bystanders and pets at least 15m away; there still may be risk to bystanders from thrown objects. Bystanders should be encouraged to wear eye protection. If you are approached, stop the motor and cutting attachment immediately.
- Before each use, check for damage/worn parts
- Check the rotocut attachment, guard and loop handle and replace the parts that are cracked, warped, bent, or damaged in any way.
- After each use, clean the tool.

CAUTION: Obstructions in the vents will prevent the air from flowing into the motor housing and result in overheating or damaged of the motor.

- Use only mild soap and a damp cloth to clean the tool. Never let any liquid get inside the tool; never immerse any part of the tool into a liquid.
- Keep air vents in the motor housing from debris at all times.

MAINTENANCE

- **WARNING:** When servicing, use only identical replacement parts. Inspect and maintain the machine regularly. To ensure safety and reliability, all repairs should be performed by a qualified service technician.
- **WARNING:** Battery tools do not have to be plugged into an electrical outlet; therefore, they are always in operating condition. To prevent serious personal injury, take extra precautions and care when performing maintenance, service or for changing the cutting attachment or other attachments.
- **WARNING:** To prevent serious personal injury, unplug the battery connector from the socket before servicing, cleaning, changing add-on attachments or removing material from the unit.

ROTOCUT BLADE REPLACEMENT

WARNING: If the blades become loose after it is fixed in position or the blades are badly worn, replace the blades immediately. Never use a tool with a loose or ineffective cutting attachment.

Know the ROTOCUT head as Fig. D1 shown.

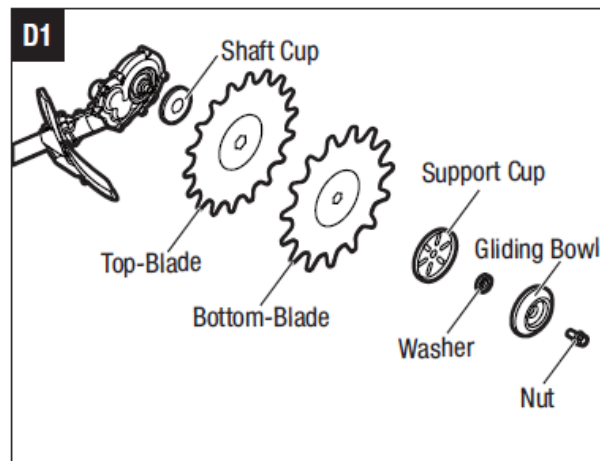

D-1	Shaft Cup	D-2	Top-Blade
D-3	Bottom-Blade	D-4	Support Cup
D-5	Washer	D-6	Gliding Bowl
D-7	Nut		

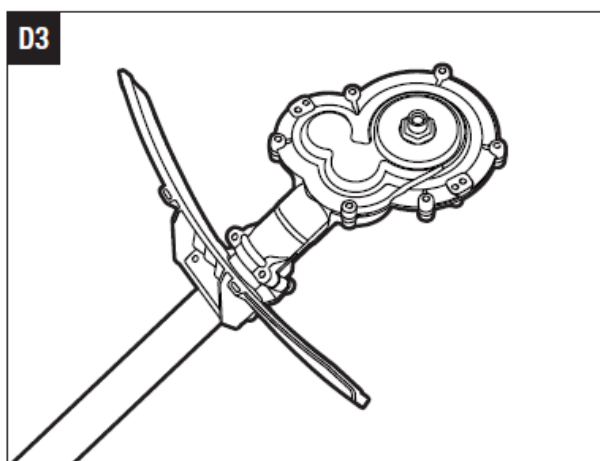
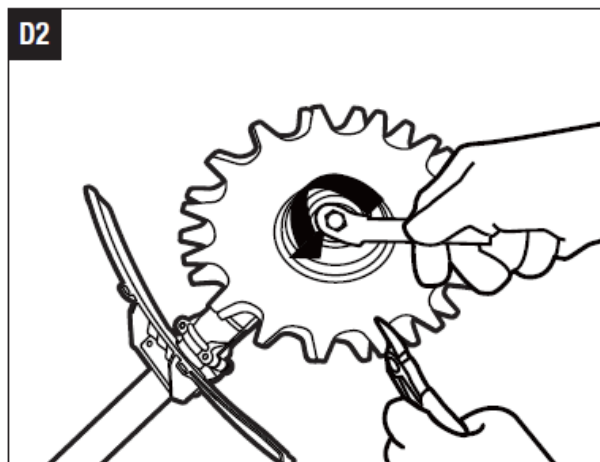

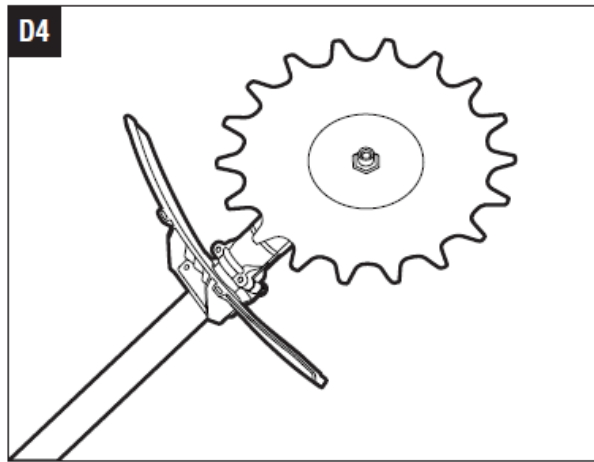

1.

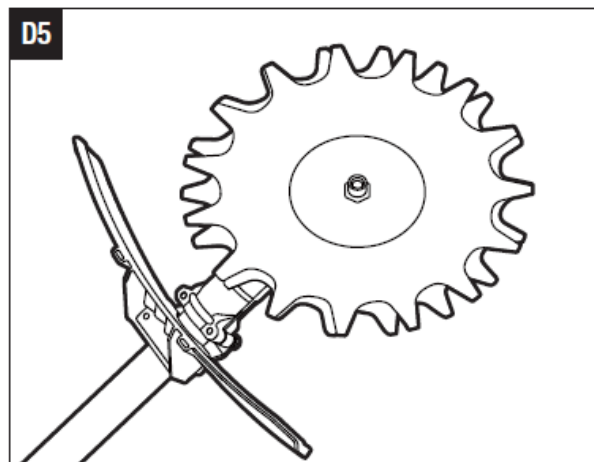

Place the gear case of the ROTOCUT head against a solid surface. Clamp the up and down blades with pliers or in a vise, then use the wrench to loosen the nut (Fig. D2).

2. Remove the nut, gliding bowl, washer, support cup, down blade, up blade and shaft cup in sequence as Fig. D1 shown.
3. Before installing new blades, put the shaft cup on the shaft (Fig. D3). Put the top-blade with big hexagonal hole onto the shaft with the surface printed “EGO” logo facing toward the gear case (Fig. D4), then put the bottom-blade with small hexagonal hole onto the shaft with the surface printed “EGO” logo facing toward operator (Fig. D5).

NOTICE: Make sure the hexagon holes on the blades and hexagon shaft shoulder fit in place. Otherwise once the blades are mounted reversely, the ROTOCUT ATTACHMENT cannot work correctly and will damage the blades.

4. Follow the sequence shown in Fig. D1 to reassemble them.

LUBRICATE THE GEAR CASE

For best operation and longer lifetime, lubricate the gear case with a special grease (4-

5g each time) after every 50 hours' operation.

The special grease should meet the following requirements.

1. Belong to DIN51818: NLGI-1 cone penetration degree.
2. Ester base grease.
3. Excellent low-temperature startup, EP, mechanical shearing, abrasion resistance and oxidative stability properties.
4. Operation temperature must contain -40~180°C. Remove the battery plug and the sealing screw. Lubricating the gear case through the oil-hole. **WARNING:** Do not lubricate while the machine is still connected with battery or running.

CLEANING THE UNIT

- Clean the unit using a damp cloth with a mild detergent.
- Do not use any strong detergents on the plastic housing or the handle. They can be damaged by certain aromatic oils, such as pine and lemon, and by solvents such as kerosene. Moisture can also cause a shock hazard. Wipe off any moisture with a soft dry cloth.

STORING THE UNIT

- Clean the tool thoroughly before storing it.
- Store the unit in a dry, well-ventilated area, locked-up or up high, out of the reach of children. Do not store the unit on or adjacent to fertilizers, petrol, or other chemicals.
- Use of a transport cover for metal blades during transport and storage.

PROTECTING THE ENVIRONMENT



-  Do not dispose of electrical appliances as unsorted municipal waste, use separate collection facilities.
- Contact your local government for information regarding the collection systems available.
- If electrical appliances are disposed of in landfills or dumps, hazardous substances

can leak into the groundwater and get into the food chain, damaging your health and well-being.

TROUBLESHOOTING

PROBLEM	CAUSE	SOLUTION
ROTOCUT fails to start.	<ul style="list-style-type: none">• The battery pack is not properly connected to the power head.• The battery pack is depleted.• The lock-off lever and trigger are not depressed simultaneously.	<ul style="list-style-type: none">• Connect the battery pack to the power head.• Charge the battery pack with an EGO charger listed in this manual.• Press the lock-off lever and hold it, then depress the trigger to turn on the unit.
ROTOCUT stops while cutting.	<ul style="list-style-type: none">• The motor is overloaded.• The battery pack is too hot.• The battery pack is disconnected from the tool.	<ul style="list-style-type: none">• The motor will recover when the load is removed. For continuous work, decrease the load on the ROTO CUT and avoid deep cutting; instead, make progressively deeper cuts.• Allow the battery pack to cool down naturally, or air blow to speed up the cooling.• Reconnect the battery pack.

WARRANTY

EGO WARRANTY POLICY

- For full warranty terms and conditions, warranty service or to make a claim, please visit our website egopowerplus.com.au/warranty-policy.
- Also see full warranty details & warranty table on the 'NEED HELP?' flyer contained

within this product.

- Alternatively you can contact EGO customer service via the following:

Australia

Address: Chervon Australia Pty Ltd, Unit 14, 5 Kelletts Rd, Rowville, VIC, 3178.

- Phone: 1300 000 346
- Email: support@egopowerplus.com.au

New Zealand

- Address: Chervon New Zealand Subsidiary Ltd, 4th Floor, Smith & Caughey Building, 253 Queen St, Auckland, 1141.
- Phone: 0508 000 346
- Email: support@egopowerplus.co.nz

FAQ

Can this tool be used with a different power head?

No, this Rotocut Multi Tool is designed for use only with the 56V Lithium-Ion Power Head models PH1400E, PH1420E, or PHX1600.

What should I do if the blade guard is damaged?

Do not use the tool if the blade guard is damaged. Contact a qualified service technician for repair or replacement.

Documents / Resources

	<p>EGO RTA2300 Multitool Rotocut Brush Cutter Attachment [pdf] Instruction Manual</p> <p>RTA2300 Multitool Rotocut Brush Cutter Attachment, RTA2300, Multitool Rotocut Brush Cutter Attachment, Rotocut Brush Cutter Attachment, Brush Cutter Attachment, Cutter Attachment, Attachment</p>
---	---

References

- [User Manual](#)

EGO attachment, Brush Cutter Attachment, Cutter Attachment, EGO, Multitool Rotocut Brush Cutter Attachment, Rotocut Brush Cutter Attachment, RTA2300, RTA2300 Multitool Rotocut Brush Cutter Attachment

Leave a comment

Your email address will not be published. Required fields are marked *

Comment *

Name

Email

Website

☐ Save my name, email, and website in this browser for the next time I comment.

Post Comment

Search:

e.g. whirlpool wrf535swhz

Search

[Manuals+](#) | [Upload](#) | [Deep Search](#) | [Privacy Policy](#) | [@manuals.plus](#) | [YouTube](#)

This website is an independent publication and is neither affiliated with nor endorsed by any of the trademark owners. The "Bluetooth®" word mark and logos are registered trademarks owned by Bluetooth SIG, Inc. The "Wi-Fi®" word mark and logos are registered trademarks owned by the Wi-Fi Alliance. Any use of these marks on this website does not imply any affiliation with or endorsement.