

EGO
EGO
LM2130E-SP
56V Lithium
Ion Cordless
Mower



EGO LM2130E-SP 56V Lithium Ion Cordless Mower Instruction Manual

[Home](#) » [EGO](#) » EGO LM2130E-SP 56V Lithium Ion Cordless Mower Instruction Manual 

Contents

- 1 EGO LM2130E-SP 56V Lithium Ion Cordless Mower
- 2 Product Usage Instructions
- 3 DESCRIPTION OF THE TOOL
- 4 TOOL SPECIFICATIONS
- 5 OPERATION
- 6 ASSEMBLY
- 7 APPLICATION
- 8 MAINTENANCE
- 9 Troubleshooting
- 10 WARRANTY TERMS
- 11 Frequently Asked Questions
- 12 Documents / Resources
 - 12.1 References
- 13 Related Posts



EGO LM2130E-SP 56V Lithium Ion Cordless Mower



Specifications

- Model: LM2130E-SP
- Power: 56V Lithium-Ion
- Self-Propel Switch
- Self-Propel Speed-Control Knob
- Safety Button
- LED Headlights
- Grass Bag
- Quick-Adjust Lever
- Cutting-height Adjustment Lever
- Rear Wheel
- Front Wheel
- Mower Deck

Product Description

The 56V Lithium-Ion Cordless Mower (LM2130E-SP) is designed for mowing grass in domestic gardens. It features a self-propel switch, LED headlights, and various adjustment levers for ease of use.

Product Usage Instructions

1. **Know Your Tool:** Familiarize yourself with the components of the mower as shown in Fig.1 of the manual.
2. **Safety Precautions:** Before use, ensure the area is clear of obstacles and bystanders. Always wear appropriate safety gear.
3. **Starting the Mower:** Press the safety button and switch button for LED headlights simultaneously to start the

mower.

4. **Mowing:** Adjust the cutting height using the cutting-height adjustment lever based on your preference.
5. **Cleaning and Maintenance:** After each use, clean the mower, remove grass clippings, and store it in a dry place.

DESCRIPTION OF THE TOOL

The product is intended for mowing grass in domestic gardens only. Please read the instructions carefully before use and use the product in strict accordance with the instructions in the instructions.

KNOW YOUR TOOL (Fig.1)

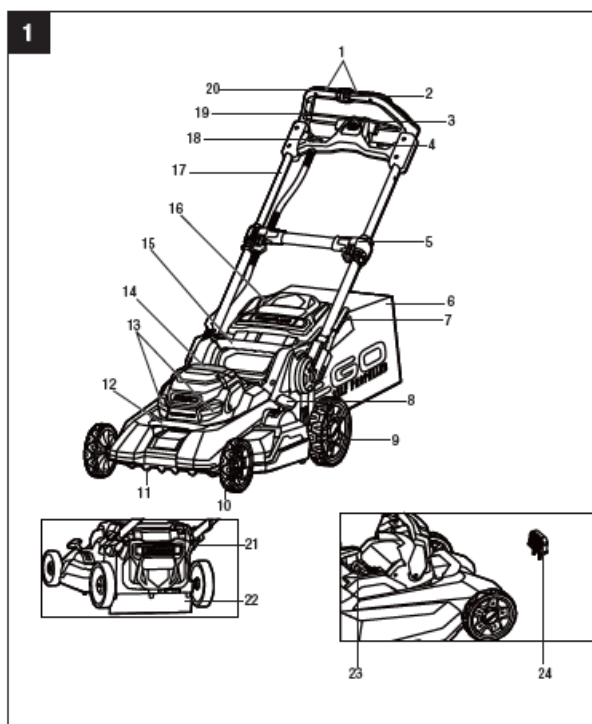

1. Self-Propel Switch
2. Self-Propel Speed-Control Knob
3. Safety Button
4. Switch Button for LED Headlights
5. Handle-Locking Clamp
6. Grass Bag
7. Quick-Adjust Lever
8. Cutting-height Adjustment Lever
9. Rear Wheel
10. Front Wheel
11. Mower Deck
12. Front Handle
13. LED Headlights
14. Battery Cover
15. Rear Handle
16. Rear Discharge Door
17. Side Rail

18. Mower-Status Indicator
19. Switch Lever
20. Handle
21. Support for Upright Storage
22. Trailing Shield
23. Battery-Release Button
24. Safety Key

TOOL SPECIFICATIONS

Model	LM2130E-SP
Rated voltage (V)	56 
No-load speed (rpm)	2700
Cutting height (mm)	25/ 32/ 40/ 51/ 64/ 77/ 90
Cutting height positions	7
Cutting width (cm)	52
Grass bag volume (L)	70
Blade model	AB2102D-E
Blade brake	YES
Weight (Without battery pack and grass bag /kg)	25.1
Recommended operating temperature (°C)	0-40
Recommended charging temperature (°C)	5-40
Recommended storage temperature (°C)	0-40

NOTE

1. Due to continuing program of development, the specifications herein are subject of change without prior notice.
2. When the machine is used for a long time, it may overheat. It is necessary to cool the machine to a suitable temperature before use to avoid damage to the machine.
3. The specific configuration of the product may be different due to different sales regions and production batches. Please refer to the actual products for details.

GENERAL POWER TOOL SAFETY WARNINGS

WARNING: Read all safety warnings , instructions , illustrations and specifications provided with this power tool. Failure to follow all the instructions listed below may result in electric shock, fire and/or serious injury.

Save all warnings and instructions for future reference.

The term “power tool” in the warnings refers to your mains-operated (corded) power tool or battery-operated (cordless) power tool.

Work area safety

- Keep work area clean and well lit. Cluttered and dark areas invite accidents.
- Do not operate power tools in explosive atmospheres, such as in the presence of flammable liquids, gases or dust. Power tools create sparks which may ignite the dust or fumes.
- Keep children and bystanders away while operating a power tool. Distractions can cause you to lose control.

Electrical safety

- Power tool plugs must match the outlet. Never modify the plug in any way. Do not use any adapter plugs with earthed (grounded) power tools. Unmodified plugs and matching outlets will reduce risk of electric shock.
- Avoid body contact with earthed or grounded surfaces, such as pipes, radiators, ranges and refrigerators. There is an increased risk of electric shock if your body is earthed or grounded.
- Do not expose power tools to rain or wet conditions. Water entering a power tool will increase the risk of electric shock.
- Do not abuse the cord. Never use the cord for carrying, pulling or unplugging the power tool. Keep cord away from heat, oil, sharp edges or moving parts. Damaged or entangled cords increase the risk of electric shock.
- When operating a power tool outdoors, use an extension cord suitable for outdoor use. Use of a cord suitable for outdoor use reduces the risk of electric shock.
- If operating a power tool in a damp location is unavoidable, use a residual current device (RCD) protected supply. Use of an RCD reduces the risk of electric shock.

Personal safety

- Stay alert, watch what you are doing and use common sense when operating a power tool. Do not use a power tool while you are tired or under the influence of drugs, alcohol or medication. A moment of inattention while operating power tools may result in serious personal injury.
- Use personal protective equipment. Always wear eye protection. Protective equipment such as a dust mask, non-skid safety shoes, hard hat or hearing protection used for appropriate conditions will reduce personal injuries.
- Prevent unintentional starting. Ensure the switch is in the off-position before connecting to power source and/or battery pack, picking up or carrying the tool. Carrying power tools with your finger on the switch or energising power tools that have the switch on invites accidents.
- Remove any adjusting key or wrench before turning the power tool on. A wrench or a key left attached to a rotating part of the power tool may result in personal injury.
- Do not overreach. Keep proper footing and balance at all times. This enables better control of the power tool in unexpected situations.
- Dress properly. Do not wear loose clothing or jewellery. Keep your hair and clothing away from moving parts. Loose clothes, jewellery or long hair can be caught in moving parts.
- If devices are provided for the connection of dust extraction and collection facilities, ensure these are connected and properly used. Use of dust devices can reduce dust-related hazards.
- Do not let familiarity gained from frequent use of tools allow you to become complacent and ignore tool safety principles. A careless action can cause severe injury within a fraction of a second.

Power tool use and care

- Do not force the power tool. Use the correct power tool for your application. The correct power tool will do the job better and safer at the rate for which it was designed.
- Do not use the power tool if the switch does not turn it on and off. Any power tool that cannot be controlled with the switch is dangerous and must be repaired.
- Disconnect the plug from the power source and/or the battery pack from the power tool before making any adjustments, changing accessories, or storing power tools. Such preventive safety measures reduce the risk of starting the power tool accidentally.
- Store idle power tools out of the reach of children and do not allow persons unfamiliar with the power tool or these instructions to operate the power tool. Power tools are dangerous in the hands of untrained users.
- Maintain power tools. Check for misalignment or binding of moving parts, breakage of parts and any other condition that may affect the power tools operation. If damaged, have the power tool repaired before use. Many accidents are caused by poorly maintained power tools.
- Keep cutting tools sharp and clean. Properly maintained cutting tools with sharp cutting edges are less likely to bind and are easier to control.
- Use the power tool, accessories and tool bits etc. in accordance with these instructions, taking into account the working conditions and the work to be performed. Use of the power tool for operations different from those intended could result in a hazardous situation.
- Keep handles and grasping surfaces dry, clean and free from oil and grease. Slippery handles and grasping surfaces do not allow for safe handling and control of the tool in unexpected situations.

Battery tool use and care

- Recharge only with the charger specified by the manufacturer. A charger that is suitable for one type of battery pack may create a risk of fire when used with another battery pack.
- Use power tools only with specifically designated battery packs. Use of any other battery packs may create a risk of injury and fire.
- When battery pack is not in use, keep it away from other metal objects, like paper clips, coins, keys, nails, screws or other small metal objects, that can make a connection from one terminal to another. Shorting the battery terminals together may cause burns or a fire.
- Under abusive conditions, liquid may be ejected from the battery; avoid contact. If contact accidentally occurs, flush with water. If liquid contact eyes, additionally seek medical help. Liquid ejected from the battery may cause irritation or burns.
- Do not use a battery pack or tool that is damaged or modified. Damaged or modified batteries may exhibit unpredictable behaviour resulting in fire, explosion or risk of injury.
- Do not expose a battery pack or tool to fire or excessive temperature. Exposure to fire or temperature above 130 °C may cause explosion.
- Follow all charging instructions and do not charge the battery pack or tool outside the temperature range specified in the instructions. Charging improperly or at temperatures outside the specified range may damage the battery and increase the risk of fire.

Service

- Have your power tool serviced by a qualified repair person using only identical replacement parts. This will ensure that the safety of the power tool is maintained.
- Never service damaged battery packs. Service of battery packs should only be performed by the manufacturer or authorized service providers

SAFETY RULES FOR CORDLESS LAWN MOWER

WARNING: When using cordless lawn mowers, basic safety precautions should always be followed to reduce the risk of fire, electric shock, and personal injury.

IMPORTANT

READ CAREFULLY BEFORE USE. KEEP FOR FUTURE REFERENCE.

SAFETY RULES FOR CORDLESS LAWNMOWERS:

CAUTION-DO NOT TOUCH ROTATING BLADE!

TRAINING

- Read the instructions carefully. Be familiar with the controls and the proper use of the appliance.
- Never allow people unfamiliar or children with these instructions to use the appliance. Local regulations can restrict the age of the operator.
- Never mow while people, especially children, or pets are nearby.
- The operator or user is responsible for accidents or hazards occurring to other people or their property.

PREPARATION

- While mowing, always wear substantial footwear and long trousers.
- Do not operate the appliance when barefoot or wearing open sandals. Avoid wearing clothing that is loose fitting or that has hanging cords or ties.
- Thoroughly inspect the area where the appliance is to be used and remove all stones, sticks, wires, bones, and other foreign objects.
- Before using, always visually inspect to see that the blades, blade bolts and cutter assembly are not worn or damaged. Replace worn or damaged blades and bolts in sets to preserve balance. Replace damaged or unreadable labels.

OPERATION

- Mow only in daylight or good artificial light.
- Avoid operating the appliance in wet grass, where feasible.
- Always be sure of your footing on slopes.
- Walk, never run.
- For wheeled rotary mowers, mow across the face of slopes, never up and down.
- Exercise extreme caution when changing direction on slopes.
- Do not mow on excessively steep slopes.

- Use extreme caution when reversing or pulling the appliance towards you.
- Stop the blade(s) if the appliance has to be tilted for transportation when crossing surfaces other than grass, and when transporting the appliance to and from the area to be mowed.
- Never operate the appliance with defective guards or shields, or without safety devices, for example deflectors and/or grass catchers, in place.
- Switch on the motor according to instructions and with feet well away from the blade(s).
- Do not tilt the appliance when switching on the motor, except if the appliance has to be tilted for starting. In this case, do not tilt it more than absolutely necessary and lift only the part which is away from the operator. Always ensure that both hands are in the operating position before returning the appliance to the ground. Do not start the machine when standing in front of the discharge opening.
- Do not put hands or feet near or under rotating parts. For rotary mowers, keep clear of the discharge opening at all times.
- Never pick up or carry an appliance while the motor is running.
- Switch off and remove detachable battery pack (or disabling device) and make sure that all moving parts have come to a complete stop before adjusting or cleaning:
 - Whenever you leave the machine;
 - Before clearing a blockage and unclogging chute;
 - Before checking, cleaning or working on the appliance;
 - After striking a foreign object. Inspect the appliance for damage and make repairs as necessary.
- If the appliance starts to vibrate abnormally (check immediately):
 - Inspect for damage;
 - Replace or repair any damaged parts;
 - Check for the tighten any loose parts.

MAINTENACE AND STORAGE

- Be careful during adjustment of the machine to prevent entrapment of the fingers between moving blades and fixed parts of the appliance.
- Keep all nuts, bolts, and screws tight to be sure the appliance is in safe working condition.
- Check the grass catcher frequently for wear or deterioration.
- Replace worn or damaged parts for safety.
- Cleaning and user maintenance shall not be made by children without supervision.
- When servicing the blades be aware that, even though the power source is switched off, the blades can still be moved.

PERSONAL SAFETY

Tragic accidents can occur if operator is not alert to the presence of children. Children are often attracted to the mower and mowing activity. They do not understand the dangers. Never assume that children will remain where you last saw them.









- Keep children out of the mowing area and under the watchful care of a responsible adult other than the operator.
- Be alert and turn the mower off if a child enters the area.
- Use extreme care when approaching blind corners, doorways, shrubs, trees, or other objects that may obscure

your vision of a child who may run into the mower.

- Children should be supervised to ensure that they are not playing with the mower.
- Always turn the mower off when removing the battery pack from the tool. Stop the blade(s) if the appliance has to be tilted for transportation when crossing surfaces other than grass, and when transporting the appliance to and from the area to be mowed.
- This appliance is not intended for use by persons(including children) with reduced physical, sensory or mental capabilities, or lack of experience and knowledge, unless they have been given supervision or instruction concerning use of the appliance by a person responsible for their safety.

SYMBOL

Some of the following symbols may be used on your tool. Please study them and learn their meaning. Proper interpretation of these symbols will allow you to operate the tool better and safer.

Symbol	Explanation
	Refer to instruction manual/booklet
	Ensure that other people and pets remain at least 30m away from the mower when it is in use.
	Keep feet & hand away
	Blades continue to rotate after the motor is switched off - Remove disabling device before maintenance. Switch off and remove detachable battery pack (or disabling device) before adjusting or cleaning.
	Environment protection.
	Don't drop into the trash.
	Direct current
	Caution

WARNING: Some dust created by power Cutting contains chemicals known to cause cancer, birth defects or other reproductive harm. Some examples of these chemicals are:

- Lead from lead-based paints
- Arsenics and chromium from chemically reacted lumber.

Your risk from these exposures varies, depending on how often you do this type of work. To reduce your exposure to these chemicals: work in a well ventilated area, and work with approved safety equipment.

OPERATION

WARNING: Remove the battery before carrying out any work on the power tool.

NOTE: Use only with compatible battery packs and chargers. Using other models of battery packs or chargers may cause a fire.

Model No.	Battery Pack No.	Charger No.
	BA1400T, BA2242T, BA2800T,	
LM2130E-SP	BA3360T, BA4200T, BA5600T,	CH2100E, CH5500E
	BA6720T	

NOTE: Please refer to the battery pack and charger manual for specific charging details.

ASSEMBLY

ASSEMBLING THE GRASS BAG

1. Slide the grass bag onto the frame (Fig. 2).
2. Assemble the top clips to the frame (Fig. 3), then assemble the two side clips. Assemble the bottom clip last.
3. The completely assembled grass bag is shown in Fig. 4.

NOTICE: Under normal usage, bag material is subject to wear. To reduce the risk of injury, frequently inspect the bag assembly and replace if there are any signs of wear or deterioration. Use only grass bags manufactured for this mower.

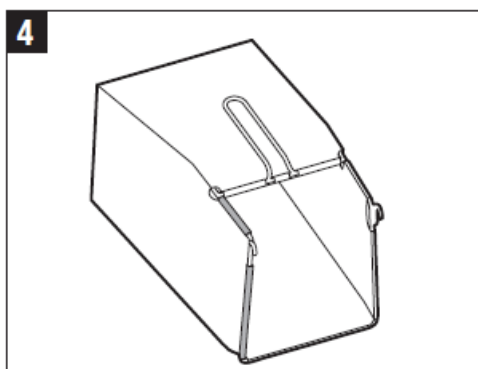
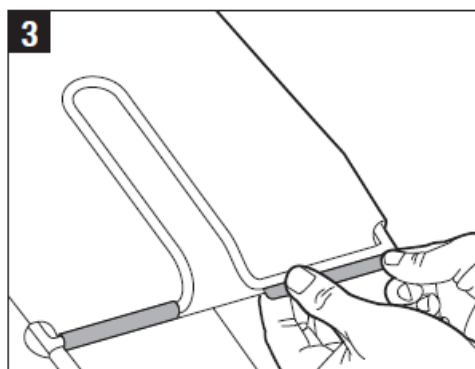
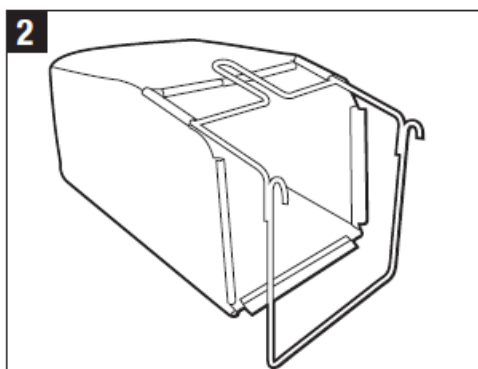

ADJUSTING THE FOLDABLE HANDLE

WARNING: Do not attempt to start the mower until the handle has been locked at one of the three preset operating positions (UPPER OPERATING POSITION, MIDDLE OPERATING POSITION and LOWER OPERATING

POSITION).

Your mower is shipped with the handle in the compact, LOCKED STORAGE POSITION (Fig. 5).

1. Press and hold the quick-adjust lever to release the handle from the LOCKED STORAGE POSITION.
2. Lift the handle from its folded position, then release the lever. Gently pivot the handle upward until you hear and feel the lock pin engage in one of the following different positions as shown in the Fig. 6.

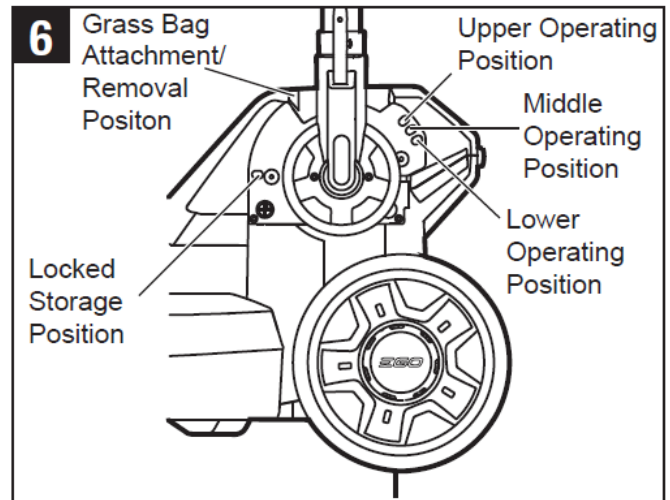
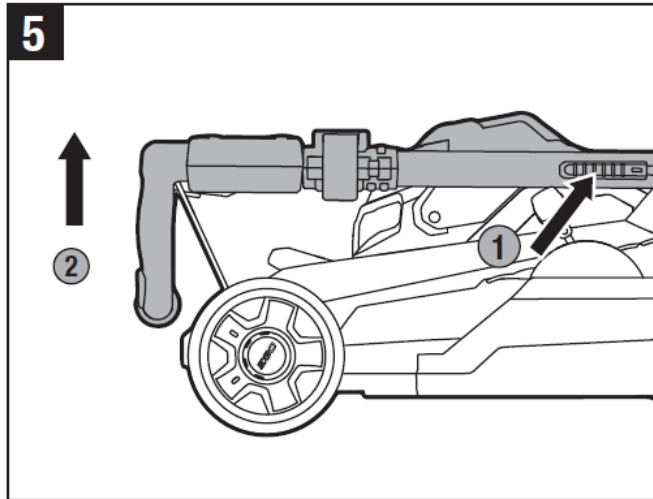

ATTACHING THE GRASS BAG

WARNING: Do not at any time make any adjustment to the lawn mower without first stopping the motor, removing the safety key and waiting for the blade to stop rotating.

NOTICE: Remove the mulching insert or side-discharge chute before attaching the grass bag on the mower.

- To Attach/Remove the Grass Bag (Fig. 7) Insert the board of the grass bag into the mower and hang the grass bag on the mower.

NOTICE: Remove the pre-installed mulching insert from the mower before attaching the grass bag to the mower.

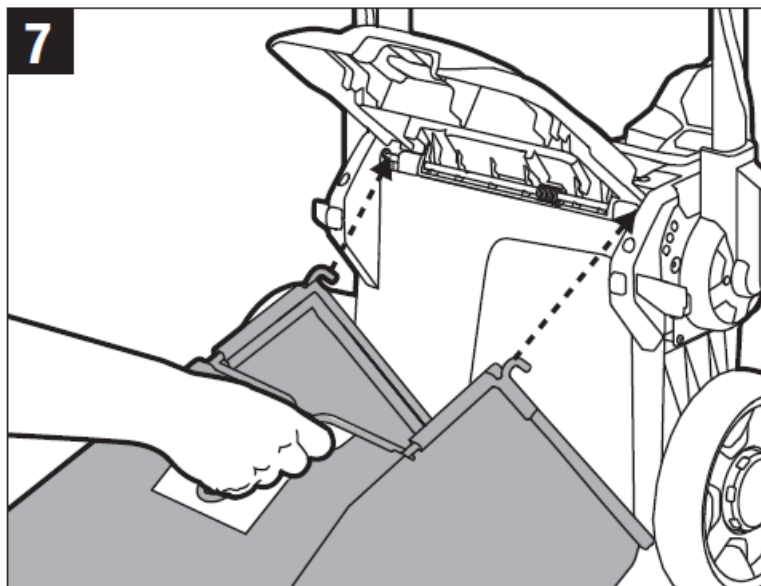

- To Attach/Remove the Mulching Insert (sold separately) (Fig. 8)

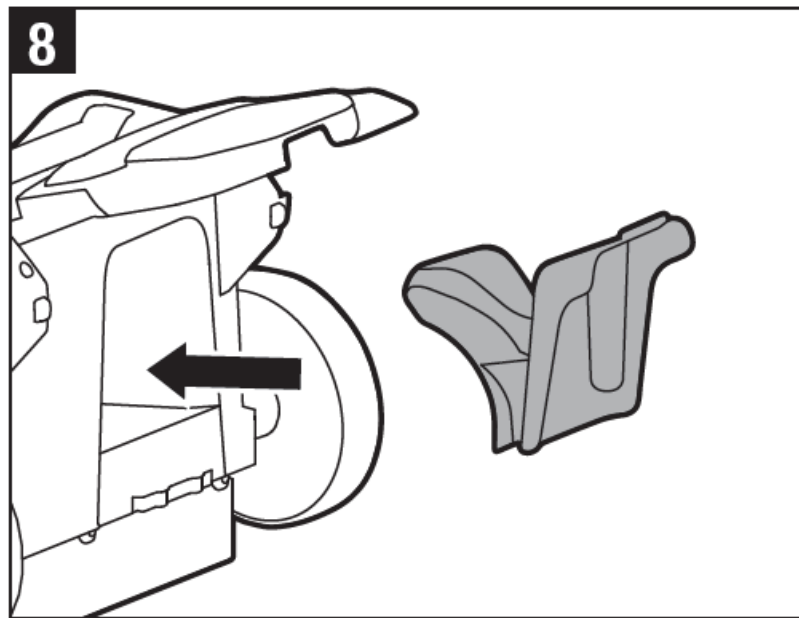

ADJUSTING THE CUTTING HEIGHT (Fig. 9)

WARNING: Keep your feet away from the deck when adjusting its height. The mower can be set to 7 cutting heights between 25mm and 90mm. Choose the proper cutting height according to the types and conditions of the grass.

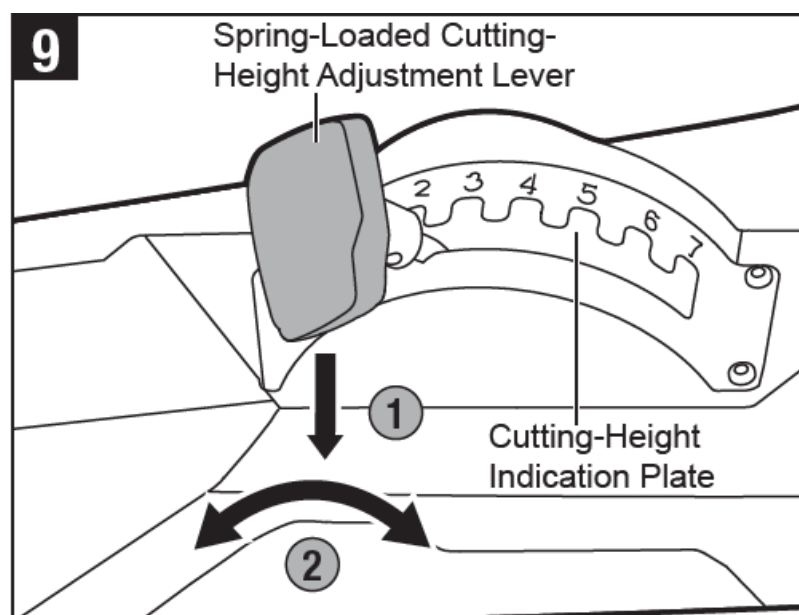

ATTACHING/DETACHING THE BATTERY PACK (Fig. 10)

CHARGE BEFORE FIRST USE.

WARNING: If any parts are broken or missing, do not attempt to attach the battery pack to the mower or operate the mower until the broken or missing parts are replaced. Failure to do so could result in serious injury.

- **To Attach**

Push the battery pack into the battery compartment until you hear a “click”.

- **To Detach**

Depress the battery-release button in the battery compartment.

NOTICE: Make sure that the latch on the mower snaps into place and that the battery pack is secured to the

mower before starting operation.

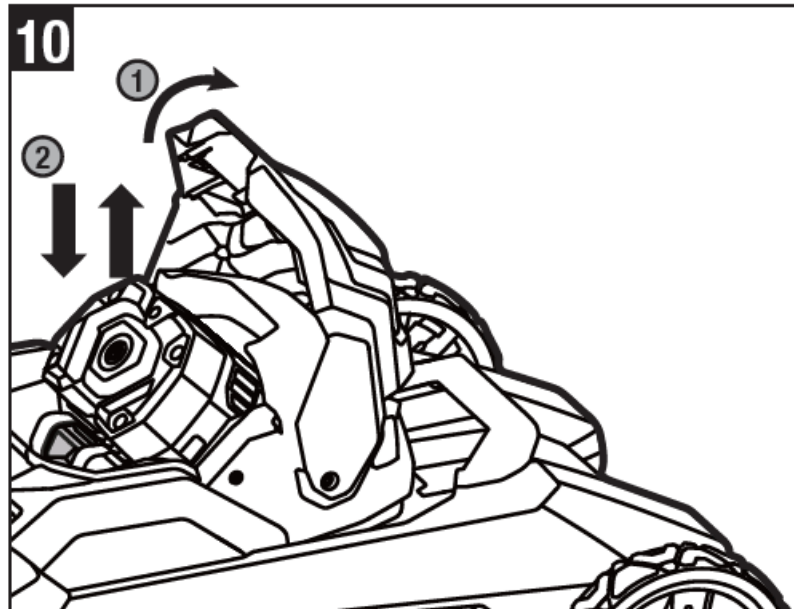

APPLICATION

STARTING/STOPPING THE MOWER (Fig. 11, 12 & 13)

WARNING:

- The operation of any lawn mower can result in foreign objects being thrown into your or other's eyes, which can damage eyes severely.
- Always wear safety glasses while operating the mower, or while performing any adjustments or repairs on it.

WARNING: The blade will continue to rotate for a few seconds after the mower is turned off. Allow the motor/blade to stop rotating before starting it again. Do not rapidly turn the mower off and on.



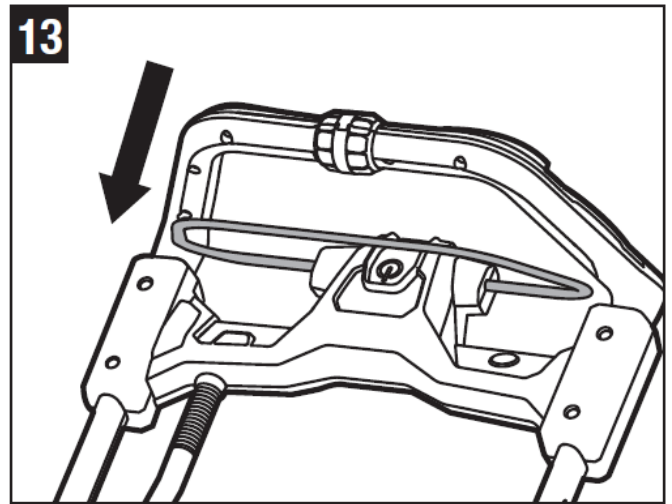
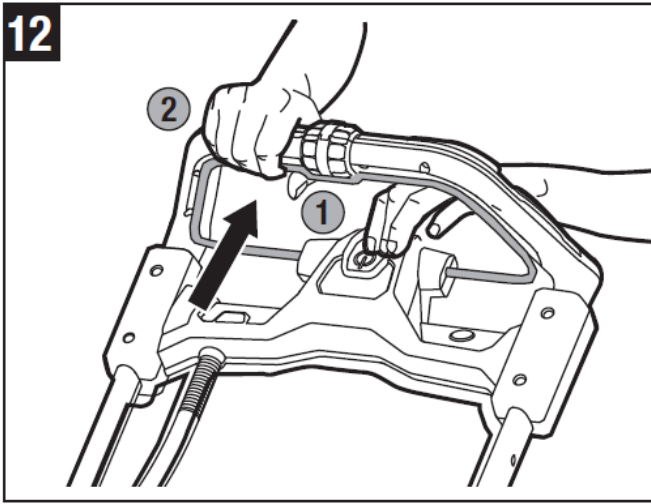

SAFETY KEY (Fig. 14)

In order to prevent accidental start-up or unauthorized use of your cordless mower, a removable safety key has been incorporated into the design of your mower. The mower will be completely disabled when the safety key has been removed from the mower.

DANGER: Rotating blades can cause serious injury. To prevent serious injury, remove the safety key when the mower is unattended, or when adjusting, cleaning, servicing, transporting, lifting, or storing the mower.

NOTICE: The motor cannot be started unless:

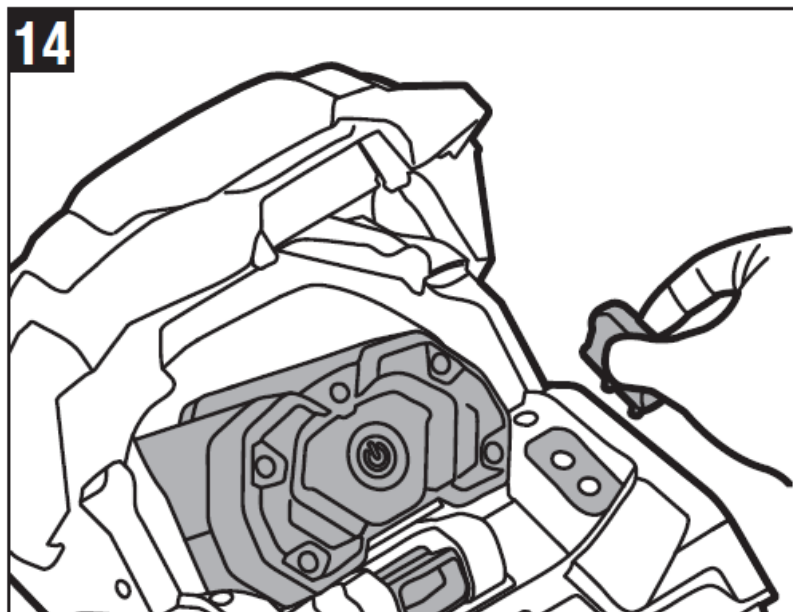

1. The handle is locked into one of the three operating positions, see ADJUSTING THE FOLDABLE HANDLE.
2. The side rails are fully extended
3. Both green handle-locking clamps are securely closed.

CAUTION: Do not attempt to override the operation of the safety button and bail switch.

To Start (Fig. 11 & 12)

1. Attach the battery pack to the mower, insert the safety key into the key slot and close the battery cover.
2. Depress the safety button.

3. With the safety button depressed, pull the bail switch upward to meet the handle and release the safety button.

To Stop (Fig. 13)

1. Fully release the bail switch.
2. The electric brake in the automatic braking mechanism will stop the blade rotation within 3 seconds of the bail switch release.

LED HEADLIGHTS (Fig. 1)

Press the switch button to turn on/off the LED headlights in the front of the battery compartment.

VARIABLE-SPEED SELF-PROPEL SYSTEM

- LM2130E-SP mower is equipped with variable-speed self-propel capability. This system is independent of the blade On-Off switch. it is not dependent on blade rotation.
- For example, when you have completed cutting your lawn, you can use the self-propel to propel the mower back to your storage location without blade rotation. Or you may choose to operate the mower as a non-selfpropelled mower to maximize battery running time.
- To operate the self-propel system without blade rotation, turn the self-propel speed-control knob on, press the self-propel trigger(s). There are two self-propel triggers.
- Press either trigger to start the self-propel function (Fig. 15).
- To turn the self-propel off, release the self-propel trigger, turn the self-propel speed-control knob off.

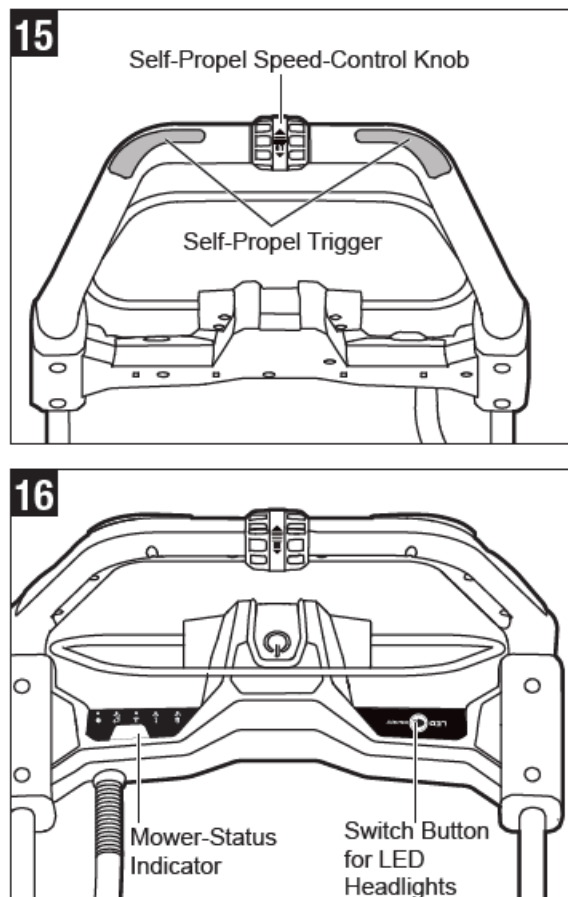

MOWER-STATUS INDICATOR ON THE MOWER (Fig. 16)

The mower is equipped with a power indicator to indicate the charge status of the battery pack and the working status of the mower. The power indicator will illuminate when the blade is rotating or when the LED headlights are turned on.

Mower- status indicator	Meaning	Action
Solid green	Mower is working properly; battery has at least 15% of its charge.	None required
Flashing green	The side rails are not fully extended .	Stop the mower and make sure that the side rails are fully extended
	The handle is not locked in an operating position	Stop the mower and make sure that the handle is locked in an operating position.
Flashing red	Low battery.	Stop the mower and charge the battery pack.

Solid orange	The mower stops due to overheat.	Remove the battery from the mower, move them to the shade and cool them at least 15 minutes.
Flashing orange	The mower is overloaded.	<ul style="list-style-type: none"> • First remove the battery pack, then check and clean if grass has collected beneath the deck. • Slow down your pace when cutting. • If this does not work, please contact EGO customer service center.
Flashing red/ green alternately	Error	Contact EGO customer service center.
Dark & LED on battery flashing	Battery over-heat. (See section “BATTERY HIGH-TEMPERATURE PROTECTION” in this manual)	Release the bail switch, wait until the battery pack cools down to approximately 67°C, then restart the mower.

MOWER OVERLOAD PROTECTION

To prevent overload conditions, do not try to remove too much grass at one time. Slow down your cutting pace or raise the cut height.

Your mower has built-in overload circuit protection. When the mower is overloaded, the motor will stop and the mower-status indicator on the mower will flash orange. Remove the battery pack from the mower. Check to see if grass has collected beneath the deck and clear it if necessary, then install the battery and restart the mower.

BATTERY HIGH TEMPERATURE PROTECTION

The battery pack will generate heat during operation. The heat dissipates more slowly in hot weather. If the battery temperature exceeds 70°C during operation, the protection circuit will immediately turn off the mower to protect the battery pack from heat damage. The mower-status indicator on the mower will off, please see ‘BATTERY PROTECTION’ section in battery operator’s manual for details.

Release the bail switch, wait until the battery pack cools.

REMOVING/INSTALLING THE BLADE

WARNING: Always protect your hands by wearing heavy gloves or wrapping the cutting edges with rags or other materials when performing any maintenance on the mower blade. Always remove the battery pack when servicing or transporting the mower.

- To Remove the Blade Following Fig. 17.

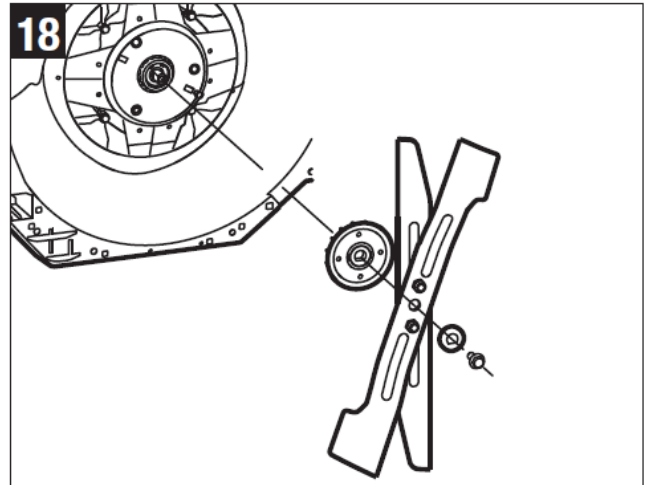
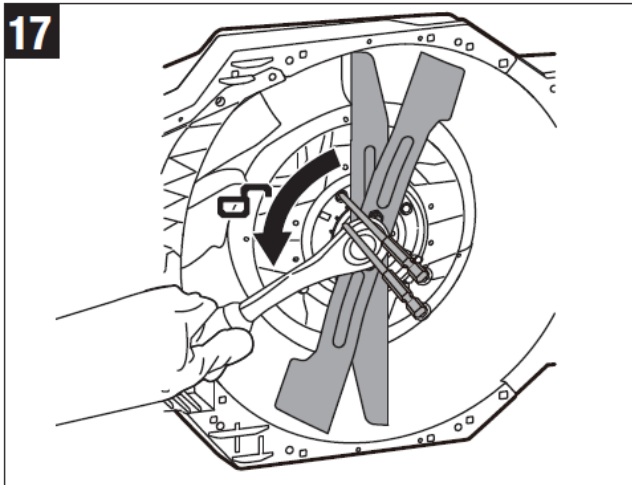

- To Install the Blade

Following the assembly sequence in Fig. 18, with the fan blade towards deck and the printed blade side towards outside, align the through holes in the fan with the holes in the blade (Fig. 19) and then tighten the blade as Fig. 20 shown.

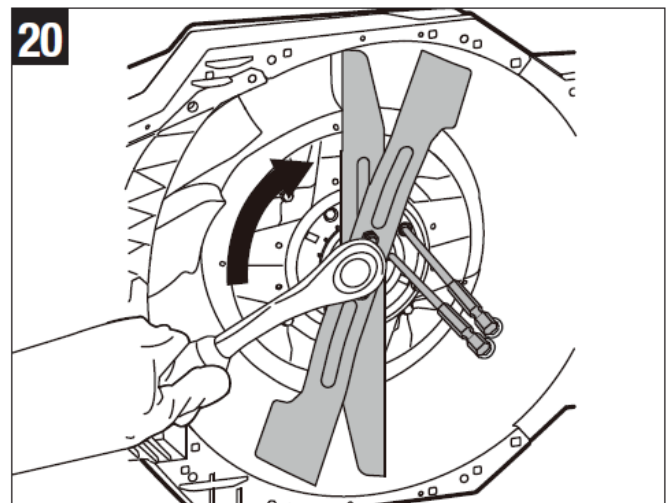
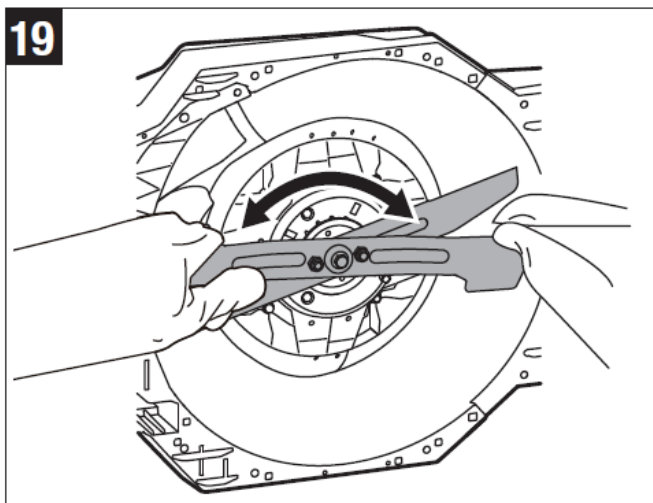

STORING THE MOWER

- Remove the battery pack from the mower and store it in a cool, dry and clean location. Do not store it next to corrosive materials, such as fertilizer or rock salt.
- Store the mower in a covered, enclosed space, that is cool and dry and out of the reach of children.
- Do not cover the lawn mower with a solid plastic sheet. Plastic coverings trap moisture around the mower, which causes rust and corrosion.
- The mower can be stored upright or flat. (Fig. 21 & 22).

WARNING: If the mower tips over from the upright position, mower damage or personal injury may result. Always keep the mower stable and out of the reach of children when it is in the upright position. If possible, lay it flat for storage.

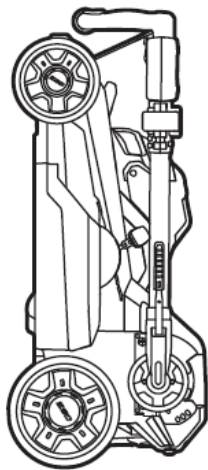
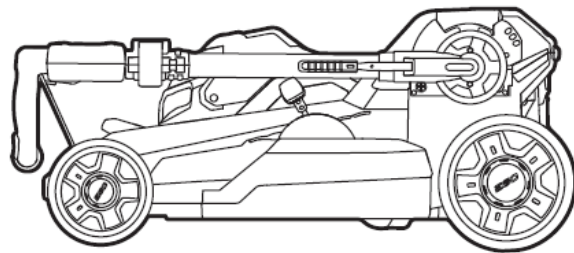
21**22**

MAINTENANCE

WARNING: When servicing, use only identical replacement parts. Use of any other parts may create a hazard or cause product damage. To ensure safety and reliability, all repairs should be performed by a qualified service technician. Before any work on the machine itself, remove the battery pack from the tool.

WARNING: To avoid serious personal injury, always remove the battery pack from the owner before cleaning or performing any maintenance. Always remove the safety key from the mower before cleaning, performing any maintenance or transporting the mower.

General Maintenance

WARNING: When servicing, use only identical replacement parts. Use of any other parts could create a hazard or cause product damage.

Cleaning

WARNING: The tool may be cleaned most effectively with compressed dry air. Always wear safety goggles when cleaning tools with compressed air. Ventilation openings and switch levers must be kept clean and free of foreign matter. Do not attempt to clean by inserting pointed objects through openings.

Keep the vents clean. Clean all parts of the tool, clean dust periodically. To prevent debris from entry.

WARNING: Certain cleaning agents and solvents damage plastic parts. Some of these are: gasoline, carbon tetrachloride, chlorinated cleaning solvents, ammonia and household detergents that contain ammonia.

Storage

Store the tool indoors in a place that is inaccessible to children. Keep away from corrosive agents.

ENVIRONMENT PROTECTION

1. Tool, accessories and packaging should be sorted for environment-friendly recycling.
2. Power tools and accessories at the end of their service life still contain large amounts of valuable raw materials and plastics which can likewise be fed back into a recycling process.

SERVICE

1. In case of guarantee, repair or purchase of replacement parts, always contact the qualified service center. And

supplied with the efficient service card and invoice.

2. It is without the scope of guarantee when the tool was normal wear, overload or improper use of damage.

Troubleshooting

Problems	Reasons	Solutions
The mower fails to start.	The battery pack is depleted.	Charge the battery pack.
	The battery pack is not mounted in place in the battery compartment.	Attach the battery pack to the mower; press it until you hear a click.
	The battery or mower circuitry is too hot. (The power indicator on the mower will illuminate in orange for 10 seconds)	Allow the battery pack or mower to cool until the temperature drops below 67°C.
	The side rails are not extended to their maximum length and the clamps are not locked in position.	Fully extend the handle and lock both clamps.
	The handle is not set at one of the three operating positions.	Adjust the handle to one of the three operating positions.
	The mower deck is clogged with grass and debris.	Clean the mower deck and make certain that the blade has freedom of movement.
The mower cuts unevenly.	The blade is dull.	Sharpen or replace the blade.
	The cutting height is not set properly.	Raise the deck to a higher cutting height setting.
	The blade is assembled incorrectly.	Reassemble the blade, following the section “ INSTALLING THE BLADE ” in this manual.
Short running time of the mower with included battery.	Grass conditions and cutting height setting will greatly affect the battery run time. The claimed run time is based on a light load condition.	Raise the blade height and slow your pace to reduce the cutting load.
The mower does not mulch properly.	Wet grass clippings are sticking to the underside of the deck.	Wait until the grass dries before mowing.
	The mower is set to cut too much grass at once.	Raise the deck to a higher cutting height setting.

The mower stops while mowing.	The battery pack is depleted.	Charge the battery pack.
	Mower is in overload condition.	Raise the cutting height or slow down the mowing.
	Mower deck is clogged with grass and debris.	Unclog the mower deck. Raise the cutting height, or cut a narrow swath.
	The battery or mower circuitry is too hot. (The power indicator on the mower will illuminate orange for 10 seconds.)	Allow the battery pack or mower to cool until the temperature drops below 67°C.
	The side rail is retracted a little by the pushing force applying on the handle.	Unlock the clamps. Fully extend the side rails and lock the clamps again.
There is excessive vibration.	The cutting blade is loose.	Tighten the blade bolt.
	The cutting blade is unbalanced.	Balance the blade following the instructions.
	The cutting blade is bent.	Replace the blade.
	The motor shaft is bent.	Contact the service center.
	The mower is set to cut too much grass at once.	Raise the deck to a higher cutting- height setting.
The handle locking clamps cannot be closed in position.	The side rails are not fully extended.	Fully extend the side rails, then lock the clamps.

WARRANTY TERMS

- When the products need to be repaired, please send them to the local EGO authorized maintenance center. The start date of products warranty is based on the date on the purchase invoice.
- If the product is defective for material failure or manufacture failure, not personal improper operation, the product will have warranty service with no extra charge within the warranty period.
- Warranty period—12 months of overall unit machine warranty; 12 months for batteries warranty; 12 month for chargers warranty.
- The warranty exclusive following situation:
 1. Any natural wear and loss caused by normal use — such as transmission gears and belts; The power cord of the charger; The chain, guide bar, and guide bar sleeve of the chain saw; Nylon straw ropes, blades, shields, and nylon rope boxes for line trimmer and trimmer; Metal blades and wheels of wheeled mowers; Blade and blade sheath of the hedge trimmer.
 2. Fading and aging of the casing caused by any natural factors; Discoloration, aging, etc. of the casing caused by the use of chemical or abrasive cleaning agents.
 3. Tool failures caused by non-compliance with operating instructions, abnormal environmental conditions, overloading, or insufficient maintenance – such as oil blockage caused by the use of unclean chain lubricating oil in the chain saw; Rust caused by the blade of the hedge machine not being cleaned in a timely manner.
 4. Tool failures caused by self or non EGO authorized maintenance center disassembly and repair.
 5. Defects caused by the use of non original EGO accessories.
 6. Tools that have been modified or added components.

7. Supplied accessories or accessories.
 8. Any equipment used for rental purposes.
- Your shopping receipt and the serial code of the machine are important warranty certificates, please keep them properly. If required by your local dealer, please present it as a warranty certificate.
 - If you have any questions during the warranty period, please consult the local dealer. The special warranty policy of the local dealer or the problem that is not listed does not conflict with the warranty terms, and the local dealer's policy shall prevail.

We reserve right to change specifications without prior notice.

Manufacturer: Nanjing Chervon Industry Co.,Ltd

Made in China

Frequently Asked Questions

- **Q: Can this mower handle tall grass?**
 - A: The mower is designed for regular grass maintenance. For tall grass, it is recommended to mow in stages to avoid overloading the motor.
- **Q: How do I store the mower?**
 - A: The mower can be stored upright using the support for upright storage to save space in your garage or shed.
- **Q: How often should I charge the battery?**
 - A: It is advisable to charge the battery after each use to ensure optimal performance during your next mowing session.

Documents / Resources

 <p>OPERATOR'S MANUAL 56 VOLT LITHIUM-ION CORDLESS MOWER MODEL: LM2130E-SP</p>	<p>EGO LM2130E-SP 56V Lithium Ion Cordless Mower [pdf] Instruction Manual LM2130E-SP 56V Lithium Ion Cordless Mower, LM2130E-SP, 56V Lithium Ion Cordless Mower, Ion Cordless Mower, Cordless Mower</p>
---	---

References

- [User Manual](#)

[Manuals+](#), [Privacy Policy](#)

This website is an independent publication and is neither affiliated with nor endorsed by any of the trademark owners. The "Bluetooth®" word mark and logos are registered trademarks owned by Bluetooth SIG, Inc. The "Wi-Fi®" word mark and logos are registered trademarks owned by the Wi-Fi Alliance. Any use of these marks on this website does not imply any affiliation with or endorsement.