

EGO FN1000E Cordless Misting Fan



EGO FN1000E Cordless Misting Fan Installation Guide

[Home](#) » [EGO](#) » EGO FN1000E Cordless Misting Fan Installation Guide 

Contents

- [1 EGO FN1000E Cordless Misting Fan](#)
- [2 Product Information](#)
- [3 Product Usage Instructions](#)
- [4 FAQ](#)
- [5 GENERAL SAFETY WARNINGS](#)
- [6 SPECIFICATIONS](#)
- [7 PACKING LIST](#)
- [8 ASSEMBLY](#)
- [9 OPERATION](#)
- [10 OSCILLATING FUNCTION](#)
- [11 MISTING FUNCTION](#)
- [12 COMMUNICATION TECHNOLOGY](#)
- [13 MAINTENANCE](#)
- [14 TROUBLESHOOTING](#)
- [15 WARRANTY](#)
- [16 Documents / Resources](#)
 - [16.1 References](#)





Product Information

Specifications

- **Product Name:** FAN TURBO FN1000E
- **Power Source:** 56 Volt Lithium-Ion Battery
- **Type:** Cordless Misting Fan

Product Usage Instructions

General Safety Guidelines

It is crucial to follow these safety precautions to avoid any risks of fire, electric shock, or injury.

- Read the instruction manual thoroughly to understand the fan's applications, limitations, and potential hazards.
- Always wear appropriate safety gear such as safety goggles, safety glasses with side shields, and a full face shield when operating the fan.
- Use a wide-vision safety Mask over eyeglasses or standard safety glasses for added protection.

Operation Instructions

1. Before using the misting fan, ensure the battery is fully charged.
2. Turn on the fan by pressing the power button.
3. To activate the misting function, locate and toggle the misting switch.
4. Adjust the fan speed and mist intensity according to your preference using the control settings.
5. After use, turn off the fan and clean the misting nozzles regularly to maintain optimal performance.

FAQ

• **Q: What should I do if the fan is not misting properly?**

- **A:** If the misting function is not working correctly, check the water reservoir for sufficient water level and ensure there are no clogs in the misting nozzles. Clean the nozzles as needed to resolve any issues.

• **Q: How long does the battery last on a full charge?**

- **A:** The battery life may vary based on usage and settings, but on average, a fully charged battery can power the fan for several hours of continuous operation.

READ ALL THE INSTRUCTIONS!



READ OPERATOR'S MANUAL

- **⚠ WARNING:** To ensure safety and reliability, all repairs should be performed by a qualified service technician.
- **⚠ WARNING:** Be sure to read and understand all safety instructions in this Operator's Manual, including all safety alert symbols such as "DANGER," "WARNING," and "CAUTION" before using this appliance.
- Failure to follow all instructions listed below may result in electric shock, fire, and/or serious personal injury.
- SAVE ALL WARNINGS AND INSTRUCTIONS FOR FUTURE REFERENCE.

GENERAL SAFETY WARNINGS

SAFETY SYMBOLS

- **⚠ WARNING:** The operation of any appliance can result in foreign objects being thrown into your eyes, which can result in severe eye damage.
- Before beginning appliance operation, always wear safety goggles or safety glasses with side shields and a full face shield when needed.
- We recommend a Wide Vision Safety Mask for use over eyeglasses or standard safety glasses with side shields.



Safety Alert



To reduce the risk of injury, user must read and understand operator's manual before using this product.



Guaranteed sound power level. Noise emission to the environment according to the European community's Directive.



Bluetooth® Symbol



Waste electrical products should not be disposed of with household waste. Take to an authorized recycler.



This product is in accordance with applicable EC directives.



Direct Current



This product is in accordance with applicable UK legislation.

IPX4 Protection from splashing water

GENERAL SAFETY WARNINGS

- **⚠️ WARNING:** To reduce risk of fire, electric shock, or injury.
- Know your misting fan. Read the instruction manual carefully. Learn the fan's applications and limitations as well as the specific potential hazards related to this fan.
- Following this rule will reduce the risk of electric shock, fire or serious injury.
- This appliance can be used by children aged 8 years and above and persons with reduced physical, sensory or mental capabilities or lack of experience and knowledge if they have been given supervision or instruction concerning the use of the appliance in a safe way and understand the hazards involved.
- Children shall not play with the appliance.
- Cleaning and user maintenance shall not be made by children without supervision

WORK AREA SAFETY

- Do not operate the fan in explosive atmospheres, such as in the presence of flammable liquids, gases or dust.
- Keep children and bystanders away while operating an appliance. Distractions can cause you to lose control.
- Use caution when using in windy conditions. Winds may carry mists into electrical wiring or devices.
- Do not expose the appliance to rain or wet conditions.
- Water entering an appliance will increase the risk of electric shock.

PERSONAL SAFETY

- Stay alert, watch what you are doing and use common sense when operating an appliance. Do not use the appliance while tired, upset, or under the influence of drugs, alcohol, or medication.
- A moment of inattention while operating an appliance may result in serious personal injury.
- Prevent unintentional starting. Ensure the switch is in the off-position before connecting to the battery pack, picking up or carrying the appliance.
- Carrying an appliance with your finger on the switch or energizing an appliance that has the switch on invites accidents.
- Remove any adjusting key or wrench before turning the appliance on. A wrench or a key left attached to a rotating part of the appliance may result in personal injury.
- Do not overreach. Keep proper footing and balance at all times. This enables better control of the appliance in unexpected situations.
- Dress properly. Do not wear loose clothing or jewellery. Keep your hair and clothing away from moving parts. Loose clothes, jewellery or long hair can be caught in moving parts.
- Verify that all connections are secure before operating the appliance.
- Do not let familiarity gained from frequent use of appliances allow you to become complacent and ignore the appliance safety principles. A careless action can cause severe injury within a fraction of a second.

USE AND CARE

- Do not use the appliance if the switch does not turn on and off. Any appliance that cannot be controlled with the switch is dangerous and must be repaired.
- Disconnect the battery pack from the appliance before making any adjustments, changing accessories, or storing the appliance. Such preventive safety measures reduce the risk of starting the appliance accidentally.
- Store idle appliances out of the reach of children and do not allow persons unfamiliar with the appliance or

these instructions to operate the appliance. Appliances are dangerous in the hands of untrained users.

- Maintain appliances and accessories. Check for misalignment or binding of moving parts, breakage of parts and any other condition that may affect the appliance's operation.
- If damaged, have the appliance repaired before use. Many accidents are caused by poorly maintained appliances.
- Use the appliance and accessories etc. under these instructions, taking into account the working conditions and the work to be performed. Use of the appliance for operations different from those intended could result in a hazardous situation.
- Keep handles and grasping surfaces dry, clean and free from oil and grease. Slippery handles and grasping surfaces do not allow for safe handling and control of the appliance in unexpected situations.
- **⚠ WARNING:** To reduce the risk of fire or electric shock, do not use this fan with any solid-state speed control device.

BATTERY APPLIANCE USE AND CARE

- Recharge only with the charger specified by the manufacturer. A charger that is suitable for one type of battery pack may create a risk of fire when used with another battery pack.
- Use appliances only with specifically designated battery packs. Use of any other battery packs may create a risk of injury and fire.
- When the battery pack is not in use, keep it away from other metal objects, like paper clips, coins, keys, nails, screws or other small metal objects, that can make a connection from one terminal to another.
- Shorting the battery terminals together may cause burns or a fire.
- Under abusive conditions, liquid may be ejected from the battery; avoid contact. If contact accidentally occurs, flush with water. If liquid contacts the eyes, additionally seek medical help. Liquid ejected from the battery may cause irritation or burns.
- Do not use a battery pack or appliance that is damaged or modified. Damaged or modified batteries may exhibit unpredictable behaviour resulting in fire, explosion or risk of injury.
- Do not expose a battery pack or appliance to fire or excessive temperature. Exposure to fire or temperature above 130°C may cause an explosion.
- Follow all charging Instructions and do not charge the battery pack or appliance outside the temperature range specified in the instructions.
- Charging improperly or at temperatures outside the specified range may damage the battery and increase the risk of fire.

SERVICE

- Have your appliance serviced by a qualified repair person using only identical replacement parts. This will ensure that the safety of the appliance is maintained.
- Never service damaged battery packs. Service of battery packs should only be performed by the manufacturer or authorized service providers.

SAFETY INSTRUCTIONS FOR CORDLESS MISTING FAN

- This appliance is not intended for use by persons (including children) with reduced physical, sensory or mental

capabilities, or lack of experience and knowledge unless they have been given supervision or instruction concerning the use of the appliance by a person responsible for their safety.

- Children should be supervised to ensure that they do not play with the appliance.
- Do not allow the fan to be used as a toy. Close attention is necessary when used by or near children.
- Children can fall into buckets and drown. Keep children away from buckets with even a small amount of liquid.
- ONLY use clean, cold water.
- Do not use this misting fan to spray pesticides, liquid fertilizers, chemicals, or any liquids other than clean water.
- Spraying these substances could result in serious injury or illness to the operator or bystanders.
- Never direct mist or water toward any electrical wiring or devices.
- Ensure that the battery compartment cover is completely closed to prevent water from contacting the battery or entering the battery port.
- Keep the appliance and its handle dry, clean and free from oil and grease. Always use a clean cloth when cleaning. Never use brake fluids, gasoline, petroleum-based products, or any strong solvents to clean your fan.
- Following this rule will reduce the risk of loss of control and deterioration of the enclosure plastic.
- Batteries can explode in the presence of a source of ignition, such as a pilot light. To reduce the risk of serious personal injury, never use any cordless product in the presence of a pen flame.
- An exploded battery can propel debris and chemicals. If exposed, flush with water immediately.
- Save these instructions. Refer to them frequently and use them to instruct others who may use this fan. If you loan this fan to someone else, also loan these instructions to them to prevent misuse of the product and possible injury.
- Be aware that high humidity levels may encourage the growth of biological organisms in the environment.
- Do not permit the area around the misting fan to become damp. If dampness occurs, turn the output of the misting fan down. If the misting fan output volume cannot be turned down, use the humidifier intermittently.
- Do not allow absorbent materials, such as carpeting, curtains, drapes, or tablecloths, to become damp.
- Never leave water in the reservoir when the appliance is not in use.
- Empty and clean the misting fan before storage. Clean the humidifier before the next use.
-  **WARNING:** Micro-organisms that may be present in the water or in the environment where the appliance is used or stored, can grow in the water reservoir and be blown in the air causing very serious health risks when the water is not renewed and the tank is not cleaned properly every 3 days.
- Rechargeable batteries are to be removed from the appliance before being charged.
- Exhausted batteries are to be removed from the appliance and safely disposed of.
- If the appliance is to be stored unused for a long period, the batteries should be removed.
- The supply terminals are not to be short-circuited.
- SAVE THESE INSTRUCTIONS

SPECIFICATIONS

Rated Voltage	56V 
Fan Blade Diameter	25.4 cm
Fan Speed Settings	6 (including "Turbo")
Max. Air Volume	1700 CFM
Max. Air Speed	32.2 km/h
Oscillation Angle	60°, 120°, 180°
Misting Water Volume	High: 5.7 L/h
	Medium: 4.9 L/h
	Low: 2.5 L/h
Weight (without battery pack)	4.7 kg
Recommended Storage Temperature	-20°C-70°C
Bluetooth Operating Frequency Band	2402-2480 MHz
Bluetooth Maximum Transmission Power	4 dBm

- The declared vibration total value has been measured by a standard test method and may be used for comparing one appliance with another;
- The declared vibration total value may also be used in a preliminary assessment of exposure.
- **NOTICE:** The vibration emission during the actual use of the appliance can differ from the declared value in which the appliance is used;
- To protect the operator, the user should wear gloves and ear protectors in the actual conditions of use.

PACKING LIST

DESCRIPTION

KNOW YOUR BLOWER (Fig. A1 & A2)

1. Control Panel (Fig. A2)
2. Oscillation Frame
3. Misting Nozzle
4. Top Handle
5. Fan Enclosure
6. Side Handle
7. Battery Compartment
8. Electric Contacts
9. Battery-release Button
10. Garden Hose Adaptor
11. Filter
12. Intake Tube
13. Air Speed Adjustment Buttons

14. TURBO Button
15. TURBO Indicator
16. Misting Indicator
17. Misting Mode Button
18. Power Button
19. Air Speed Indicator
20. Oscillating Indicator
21. Oscillating Mode Button

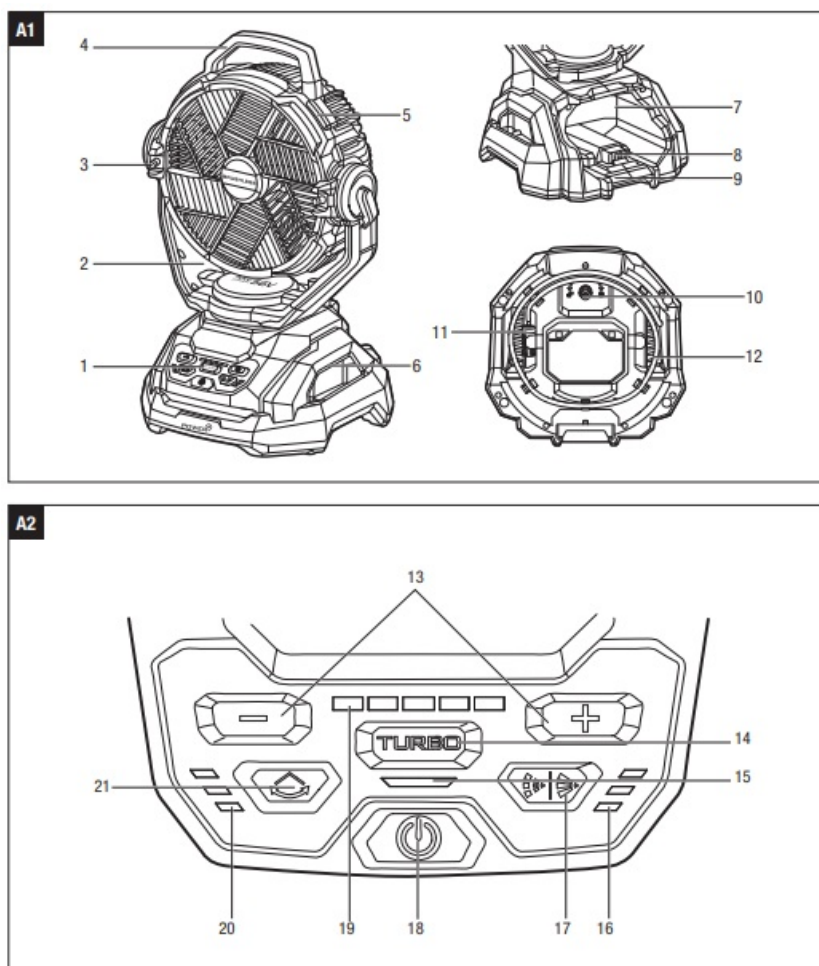

ASSEMBLY

- **⚠ WARNING:** If any parts are damaged or missing, do not operate this product until the parts are replaced. Use of this product with damaged or missing parts could result in serious personal injury.
- **⚠ WARNING:** Do not attempt to modify this product or create accessories not recommended for use with this product. Any such alteration or modification is misused and could result in a hazardous condition leading to possible serious personal injury.
- **⚠ WARNING:** To prevent accidental starting that could cause serious personal injury, always remove the battery pack from the machine when assembling parts.
- This product has been shipped completely assembled.
- Carefully remove the product and any accessories from the box. Make sure that all items shown in the “Packing List” are included.
- Inspect the product carefully to make sure that no breakage or damage occurred during shipping.
- Do not discard the packing material until you have carefully inspected and satisfactorily operated the product.

- If any parts are damaged or missing, please return the product to the place of purchase.

OPERATION

- **WARNING:** Do not allow familiarity with this product to make you careless. Remember that a careless fraction of a second is sufficient to inflict serious injury.
- **WARNING:** To prevent accidental starting that could cause serious personal injury, always remove the battery pack from the fan before servicing, making adjustments, cleaning, changing attachments or when not in use.
- **WARNING:** Do not use any attachments or accessories not recommended by the manufacturer of this product. The use of attachments or accessories not recommended can result in serious personal injury.
- Before each use, inspect the entire product for damaged, missing, or loose parts, such as screws, nuts, bolts, caps, etc. Securely tighten all fasteners and caps and do not operate this product until all missing or damaged parts are replaced.

APPLICATIONS

- You may use this product for the purposes listed below.
- General ventilation in most household applications.
- Outdoor cooling while connected to a water source.
- **NOTICE:** The product is to be used only for its prescribed purposes. Any other use is deemed to be a case of misuse.

ATTACHING/DETACHING THE BATTERY PACK

- Use only with EGO's battery packs and chargers listed in Fig.A3.
- **NOTE:** Fully charge the battery pack before first use.

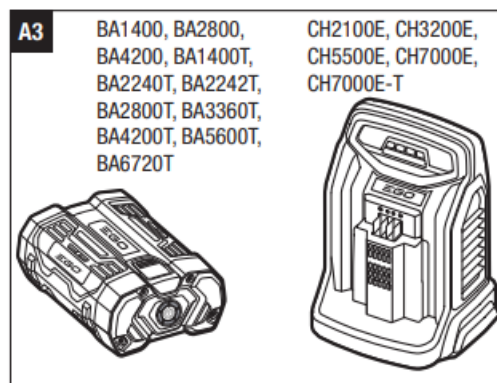

To Attach

- Align the battery ribs with the mounting slots and press the battery pack into the battery compartment until you hear a “click” (Fig. B1).

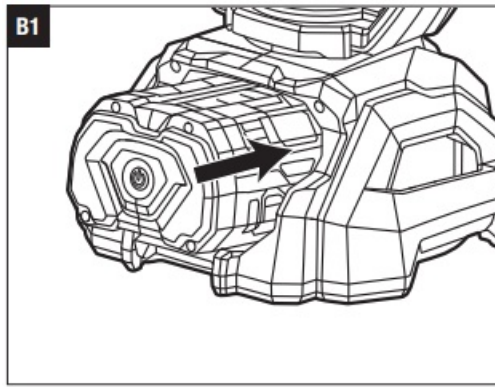

To Detach

- Depress the battery-release button and pull the battery pack out (Fig. B2).

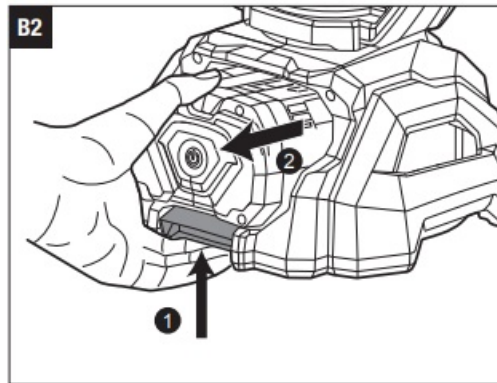

- **WARNING:** Always be aware of the location of your feet, children, or pets when pressing the battery-release button. Serious injury could result if the battery pack falls. NEVER remove the battery pack at a high location.

STARTING/STOPPING THE FAN

- **NOTE:** The initial factory setting for the airspeed is level 3. The fan will save the last used air speed setting and will revert to it upon restart. Turbo setting will not be saved.
- **NOTE:** The misting and oscillation settings will not be saved, and by default will be off every time the fan is turned on.
- Control Panel (Fig. A2)

Power Button

- Press the power button briefly to turn the fan on.
- Press the power button briefly again to turn the fan off.

Air Speed Adjustment Normal air speed

- Press the “+” airspeed adjustment button to accelerate the airspeed and press the “-” button to decrease the airspeed. There are 5 speed levels.
- The airspeed indicator displays green lights corresponding to the current speed levels.

TURBO mode

- **NOTE:** When in “TURBO” mode, the fan will achieve maximum airspeed.
- Press the “TURBO” button, the TURBO indicator will light up green and the fan will shift into “TURBO” mode, i.e. the highest airspeed.
- When in “TURBO” mode, press “the TURBO” button again, the TURBO indicator will turn off and the fan will resume the previously active airspeed.
- When in “TURBO” mode, press “the —” button, the TURBO indicator will turn off and the fan will shift to the air speed level 5.

OSCILLATING FUNCTION

(FIG. C)

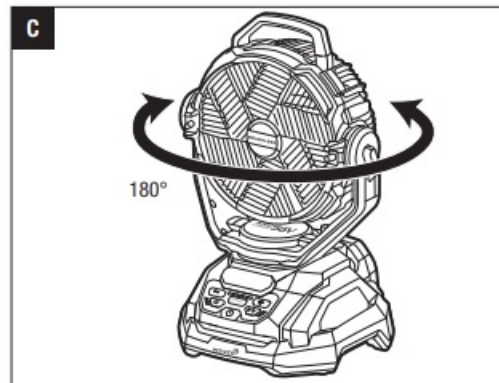

- Press the oscillating button once to start the oscillating function of the fan head, the oscillating indicator will light up the bottom green light, and the fan head will rotate 60° from side to side (from -30° to 30°).
- Press the oscillating button the second time, the oscillating indicator will light up two green lights, activating the 120° oscillating range (from -60° to 60°).
- Press the oscillating button the third time, the oscillating indicator will light up three green lights, activating the 180° oscillating range (from -90° to 90°).
- To turn the oscillating function off, press the oscillating button the fourth time.

ADJUSTING THE FAN ANGLE (FIG. D)

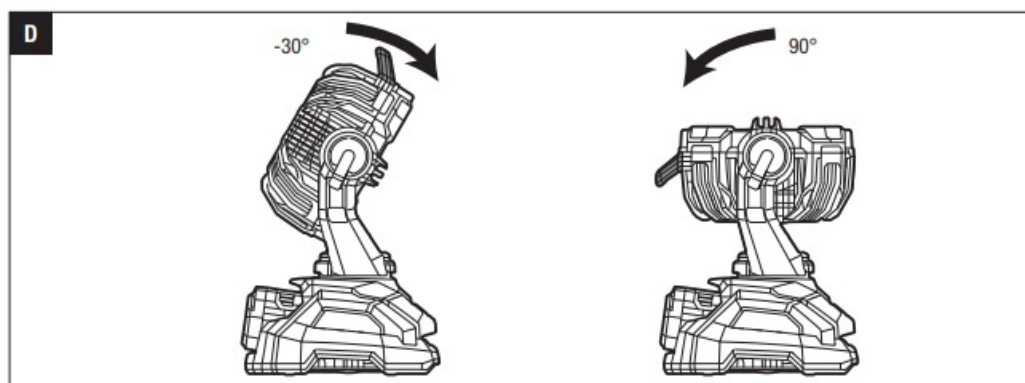

- The fan head can be set to multiple angles from -30° to 90°. To adjust the direction of the mist/airflow, grasp the fan by the top handle and tilt the fan head forward or backwards.

MISTING FUNCTION

Misting Mode Button

- Press the misting mode button once and the misting indicator will light up three green lights which indicates the heavy-flow continuous misting mode – misting a heavy flow of water without stopping.
- Press the misting mode button again and the misting indicator will light up two green lights which indicates the 'continuous' misting mode – misting all the time without stopping.
- Press the misting mode button the third time and the misting indicator will light up the bottom green light which indicates the 'intermittent' misting mode – misting for 10 seconds every 10 seconds.
- **NOTE:** It may take a few seconds before you see the mist coming out of the misting nozzles the first time.
- This delay is due to the time it takes for water to flow from the intake tube to the nozzles.
- When the misting is in 'intermittent' misting mode, press the misting mode button again and the misting indicator lights will turn off and the misting will stop.
- **NOTE:** When the misting operation is finished, disconnect the intake tube of the fan from the water source and run the fan in continuous misting mode until all the water clears from the tube.
- This helps prevent the residual water in the tube from causing unexpected misting when the fan is started again.

Using the Fan with A Water Bucket or Other Container (Not Included) (Fig. E)

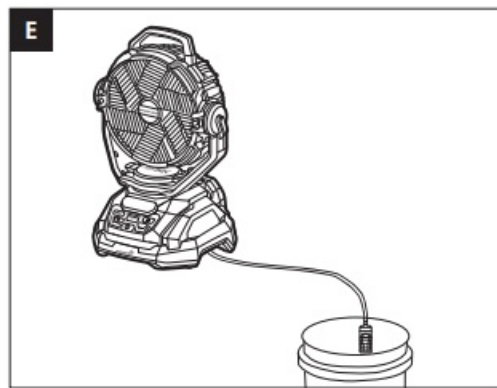

- **WARNING:** Children can fall into buckets and drown.
- Keep children away from buckets containing even a small amount of liquid.
- **NOTICE:** Clean the bucket with soap and water before each use.

1. Disconnect the battery pack.
2. Place the bucket on a flat, level surface.
3. Add ONLY clean, cold water into the bucket. Do not overfill.
4. Immerse the filter end of the intake tube down into the water.

- **NOTICE:** Do not bend the intake tube, and always make sure the water flows smoothly through the tube.

5. Install the battery pack.
6. Press the power button to turn the fan on.
7. Press the misting mode button to start misting.

Connecting the Fan to a Water Tap (Fig. F & Fig. G)

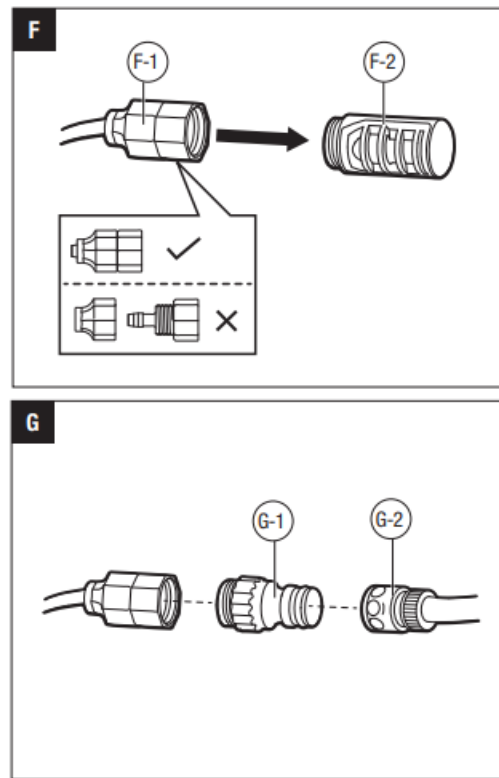

1. Unscrew the upper part of the filter in a counterclockwise direction and disconnect it from the lower part (Fig. F).

F-1	Filter Lower Part
F-2	Filter Upper Part

- **NOTICE:** Make sure the lower part is not separated into two parts during the upper part disconnection and stays together as a whole for connection to the garden hose adapter.
2. Unscrew (counterclockwise) the garden hose adapter stored at the bottom of the fan. Screw it (clockwise) into the lower part of the filter.
 3. Connect the garden hose adapter to a proper garden hose with a quick coupler (not provided). Attach the quick coupler to the garden hose adapter until you hear a clear click (Fig. G).

G-1	Garden Hose Adaptor
G-2	Typical Quick Coupler

- **NOTICE:** Do not attempt to connect the garden hose adapter while it is mounted on the bottom of the fan (Fig. G1).
4. Connect the garden hose to the water line.
 5. Install the battery pack.
 6. Press the power button to turn the fan on.
 7. Open the water tap fully, the fan will start misting.
 - **NOTICE:** The recommended maximum working pressure should not exceed 80 psi.
 - **NOTE:** Even if there is no power, the fan will start misting when the water tap is turned on.
 8. Press the misting mode button to select the misting mode for better working results.
 - **NOTE:** The small opening in the garden hose adapter makes it susceptible to hard water and mineral

deposit buildup. Clean the adapter frequently and use white vinegar or another de-scaling agent to remove the buildup.

Using the Fan without Misting

- If desired, this product may be used as a fan only, when not connected to a water source.
- When not in use, always coil the intake tube into its storage area (See section “TRANSPORTATION AND STORAGE” in this manual) to protect it from damage and contamination.

COMMUNICATION TECHNOLOGY

For information on our full range of connected products and services, including connection instructions, please scan the QR Code below or visit www.egopowerplus.eu/connect.



ELECTRONICS PROTECTION

- When the oscillating function is activated but the fan does not oscillate, the oscillating indicator will display three flashing green lights continuously to remind the operator to check whether the fan head is stuck and remove any foreign matter that is tucked into the fan head before restarting the feature.
- When the misting function is activated no water mist is coming out.
- The water pump will keep running for a short while, and then stop automatically to protect internal electronics.

The misting indicator will display three flashing green lights continuously as an alert for the operator to:

- **a.** Check if the intake tube is properly immersed in water.
- **b.** Check if the misting nozzle(s) is clogged, and clean according to the “NOZZLE MAINTENANCE” chapter.
- **c.** Press the misting mode selection button to restart misting.
- When the battery charge is low, the power button will flash a green light to remind the operator to charge or change a battery pack.
- When the battery pack or fan is too hot, the power button will flash a red light to warn the operator to turn off the fan and allow the battery pack or misting fan to cool until the temperature drops to the recommended operating temperature range before restarting the fan.

MAINTENANCE

- **⚠ WARNING:** When servicing, use only identical replacement parts. Use of any other parts may create a hazard or cause product damage. To ensure safety and reliability, all repairs should be performed by a qualified service technician.

- **⚠ WARNING:** To avoid serious personal injury, always remove the battery pack from the product when cleaning or performing any maintenance.

GENERAL MAINTENANCE

- All misting fan service, other than the items listed in these maintenance instructions, should be performed by competent misting fan service personnel.
- Avoid using solvents when cleaning plastic parts. Most plastics are susceptible to damage from various types of commercial solvents and may be damaged by their use.
- Use clean cloths to remove dirt, dust, oil, grease, etc.
- **⚠ WARNING:** Do not at any time let brake fluids, petrol, petroleum-based products, penetrating oils, etc., come in contact with plastic parts.
- Chemicals can damage, weaken or destroy plastic which may result in serious personal injury.
- **⚠ WARNING:** When cleaning the misting fan, DO NOT immerse it in water or other liquids.

NOZZLE MAINTENANCE (Fig. H)

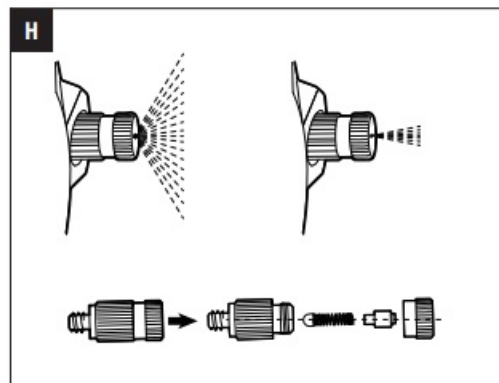

- **WARNING:** Ensure that all misting nozzle maintenance is performed properly to prevent water leaks. The leaks can result in a slippery surface creating a slip and fall hazard or causing property damage.
- Irregular mist patterns or leakage may be the result of a clogged or dirty nozzle.

To clear the nozzles

1. Turn off the fan and remove the battery pack.
2. Remove the clogged misting nozzles from the front grill guard of the fan enclosure by rotating them in a counterclockwise direction.
3. Disassemble each affected nozzle into parts.
4. To remove any foreign particles clogging or restricting the nozzles, flush the nozzle parts with water. To remove scale (mineral) buildup, clean the nozzle parts with white vinegar or other de-scaling agent as necessary.
5. Reassemble the nozzles.
 - **NOTICE:** To prevent clogging, make sure that the nozzle is assembled exactly as shown in Fig. H.
6. Reattach the clean nozzles to the front grill guard.

FILTER MAINTENANCE (Fig. I)

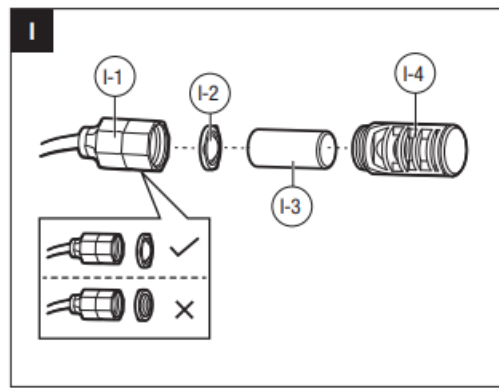

Periodically examine the filter at the end of the intake tube to make sure that it is in good condition.

1. Turn off the fan and remove the battery pack.
2. Unscrew the upper part from the lower part of the filter.

I-1	Lower Part	I-3	Sponge Mesh
I-2	Metal Mesh	I-4	Upper Part

- **NOTICE:** When unscrewing the upper part, make sure the lower part is not separated into two pieces.

The lower part must remain assembled to remove the metal mesh.

3. Take out the sponge mesh from the upper part and the metal mesh from the lower part.
4. Rinse the metal mesh and the sponge mesh or replace it if necessary.
5. Reassemble the filter.

- **NOTICE:** Make sure the metal mesh is assembled with the raised rim facing outward for easy disassembly next time.

GARDEN HOSE ADAPTER MAINTENANCE

- The small opening in the garden hose adapter makes it susceptible to hard water and mineral deposit buildup.
- Clean the adapter frequently and use white vinegar or other de-scaling agents to remove the buildup.

FAN ENCLOSURE MAINTENANCE (Fig. J & Fig. K)

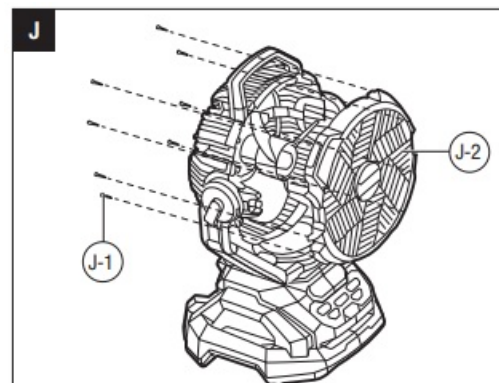

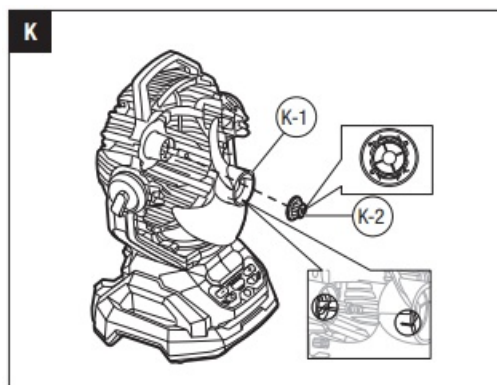

1. Turn off the fan and remove the battery pack.
2. Use a Phillips screwdriver (not included) to unscrew the eight screws from the back of the fan enclosure to remove the front grill guard.

J-1	Screw (x8)
J-2	Front Grill Guard

3. Hold the fan blade assembly to prevent it from rotating and turn the fan blade lock cover clockwise to release the fan blade assembly from the shaft.

K-1	Fan Blade Assembly
K-2	Lock Cover

4. Remove the fan blade assembly.
5. Clean the fan blade and the enclosure interior as necessary.
6. Reassemble them in reverse order, and make sure:
 - The mark on the fan blade assembly is aligned with the crossbar on the shaft.

TRANSPORTATION AND STORING (Fig. L)

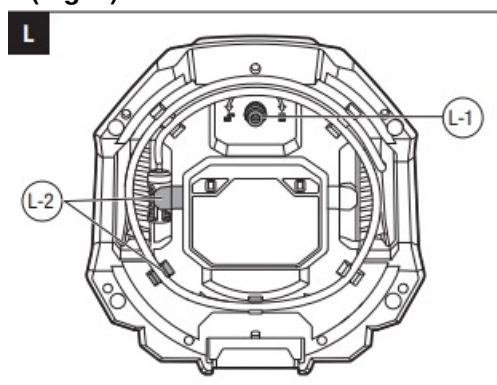

- Remove the battery pack.
- Clean the fan thoroughly.
- Empty the intake tube and filter.
- **NOTICE:** Winterizing the fan is essential to protect it from freezing temperatures, which can cause damage to the pump, hoses, and other components.
- Always disconnect the fan's intake tube from the water source and run the fan in continuous misting mode until

there is no residual water in the tube before storing the fan during the winter.

- Secure the intake tube and filter using clips located on the bottom of the fan base.
- Screw the garden hose adapter onto the threaded storage hole located on the bottom of the fan base.

L-1	Garden Hose Adaptor
L-2	Clips

- Carry the fan with the top handle or side handles when transporting it.
- Store the fan indoors, in a well-ventilated place.
- Keep away from corrosive agents such as garden chemicals and de-icing salts.

Protecting the environment



- Do not dispose of electrical equipment, used batteries and chargers into household waste!
- Take this product to an authorized recycler and make it available for separate collection. Electric tools must be returned to an environmentally compatible recycling facility.

TROUBLESHOOTING

PROBLEM	CAUSE	SOLUTION
The misting fan does not start.	■ The battery pack is not fully inserted into the housing.	■ Check if the battery is fully inserted into the housing.
	■ No electrical contact between the misting fan and battery pack.	■ Remove the battery pack, check the contacts, and reinstall the battery pack.
	■ The battery pack charge is depleted.	■ Charge the battery pack.
	■ The battery pack or fan is too hot.	■ Turn off the fan and allow the battery pack or misting fan to cool until the temperature drops to the recommended operating temperature range.
There is no water misting and the misting indicator flashes three green lights.	■ The intake tube pumps no water, activating the internal protection of the electric pump inside the fan.	■ Check and ensure that there is enough water in the bucket and that the intake tube is properly immersed in the water.
	■ The misting nozzle(s) got clogged during operation, activating the internal protection for the electric pump.	■ Clean the nozzle(s) according to the “ NOZZLE MAINTENANCE ” chapter and reassemble them as instructed.
The fan stops oscillating and the oscillating indicator flashes three green lights.	■ The fan head is stuck during oscillating.	■ Remove any foreign matter that prevents the fan head from oscillating.

WARRANTY

EGO WARRANTY POLICY

- Please visit the website egopowerplus.eu for the full terms and conditions of the EGO Warranty policy.
- 56 Volt lithium-ion cordless misting fan

Documents / Resources

	<p>EGO FN1000E Cordless Misting Fan [pdf] Installation Guide FN1000E Cordless Misting Fan, FN1000E, Cordless Misting Fan, Misting Fan, Fan</p>
---	--

References

- [User Manual](#)

[Manuals+.](#) [Privacy Policy](#)

This website is an independent publication and is neither affiliated with nor endorsed by any of the trademark owners. The "Bluetooth®" word mark and logos are registered trademarks owned by Bluetooth SIG, Inc. The "Wi-Fi®" word mark and logos are registered trademarks owned by the Wi-Fi Alliance. Any use of these marks on this website does not imply any affiliation with or endorsement.