



Efolen Lufitcode Smartwatch User Manual

[Home](#) » [Efolen](#) » Efolen Lufitcode Smartwatch User Manual

Efolen

Some features do not work properly such as cannot receive messages, calls, or watching disconnects, all those misfunction are due to NOT correctly setting background running permission. Here is a detailed guide for you to reinstall and reset background running permission. Thanks for reading.

Contents [[hide](#)]

- [1 Step One: Reinstall app Lufitcode](#)
- [2 Step Two: Add Device](#)
- [3 Step Three: Background setting running permission](#)
- [4 Documents / Resources](#)
- [5 Related Posts](#)

Step One: Reinstall app Lufitcode

1. Please make sure the watch BLE is gray. Swipe down watch face—check BLE gray.
If BLE is green, please go to Bluetooth settings—ignore “SmartWatch” first to make it disconnect.(Important) or else your smartphone may not find the watch again.



<http://qr32.cn/Cktrd0>

(BLE gray, scan QR code)



If BLE green, please go Phone Setting–Bluetooth—Ignore “Smartwatch” “Call Watch”

2. Install the Lufitcode app

Step Two: Add Device

1. Open Lufitcode —Device —ADD DEVICE

2. Swipe down your smartphone and open Bluetooth and Location

3. Connect the “SmartWatch” with series No., which is partly the same as your watch code. (Swipe down watch face and click “Settings”—About—unique watch code)

If your smartphone couldn't find ③SmartWatch Bluetooth, please turn off your phone, Reset and turn off the watch, and then go beginning from Step One again.

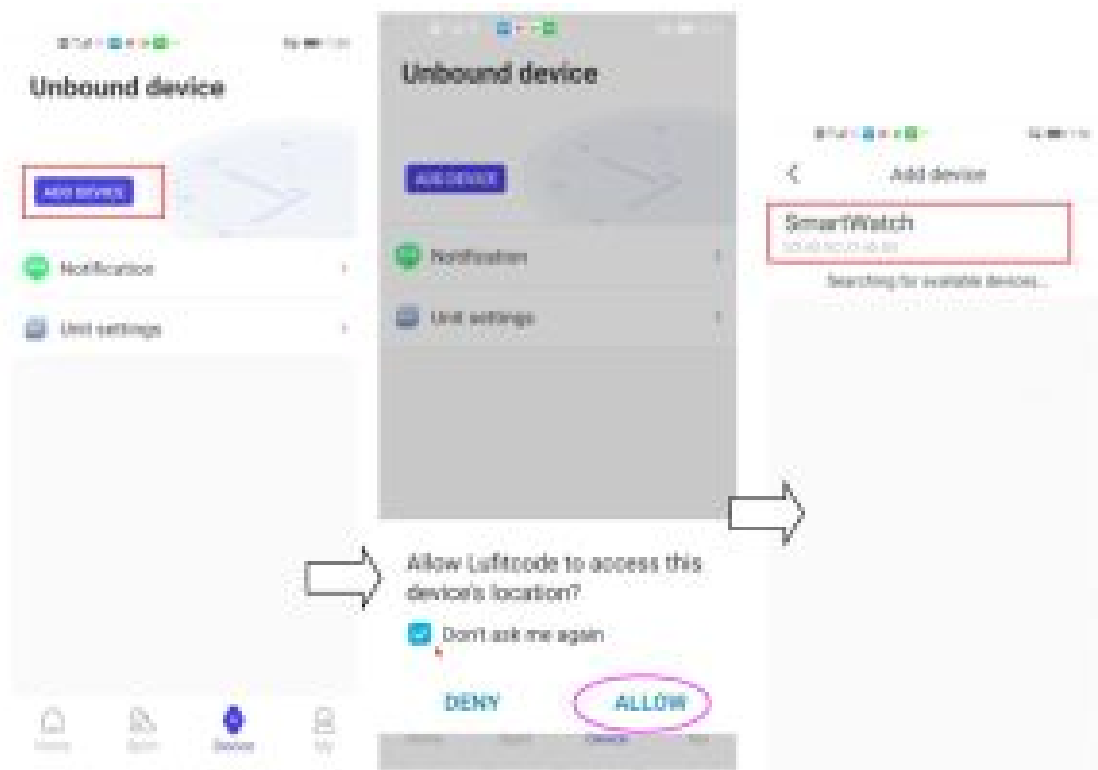

Step Three: Background setting running permission

This means, we should set the Lufitcode app to keep running always like a 24hours working machine without stopping, no matter you use the app at the moment or not use, It still keeps connecting with the watch, and deliver messages call notifications to the watch.

1. Open background operation permissions—OK
2. Ignore battery optimizations / Stop battery optimization —Allow
3. Keep running in the background—Battery Usage—Optimise battery usage—Turn off
4. Background application—Autorun app—Turn on; or select Keep the app running in the background / Never stop folders.
5. Always Allow Lufitcode to access those windows: photos, media, and files on your device, camera and record video, make and manage phone calls, device information permissions read phone call logs, contacts. (Important)
6. Notification access—allow Lufitcode to read all notifications—Allow
7. Open the permissions of suspension frame—OK —Allow permission APP Appear on top
8. Phone Settings—Apps—Lufitcode—Power usage details—App launch—Run in background (keep the app running in the background)

1

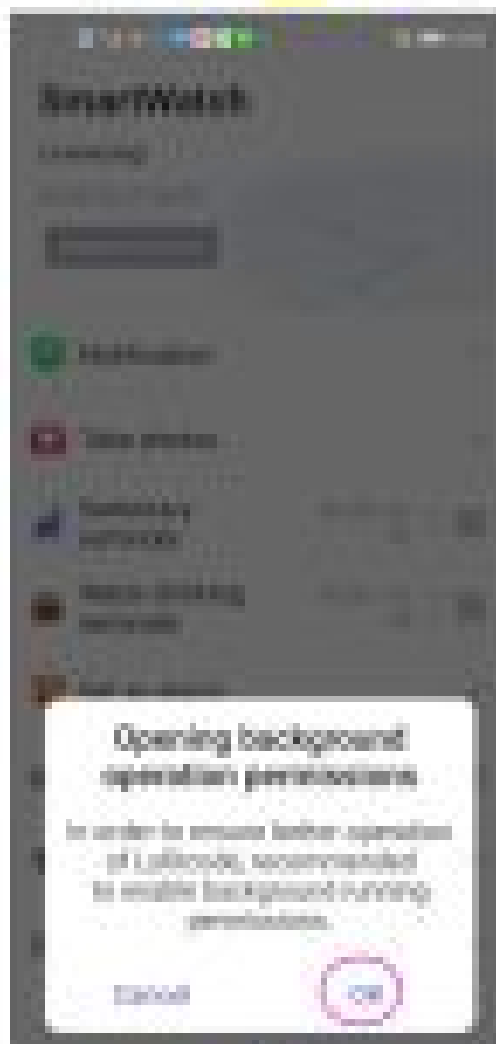

2



3

4

5

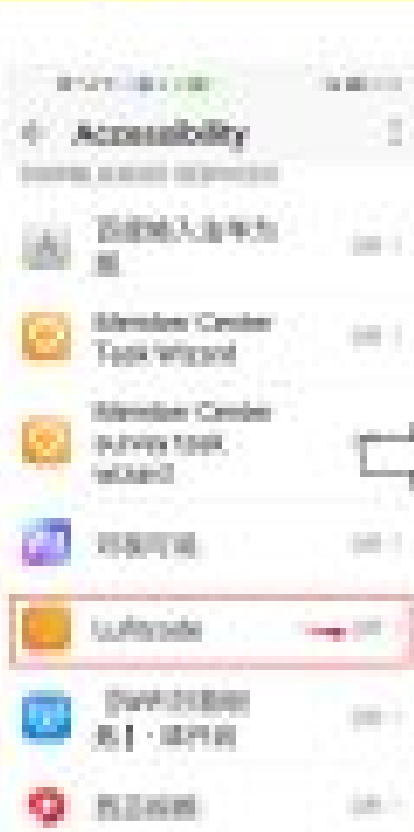
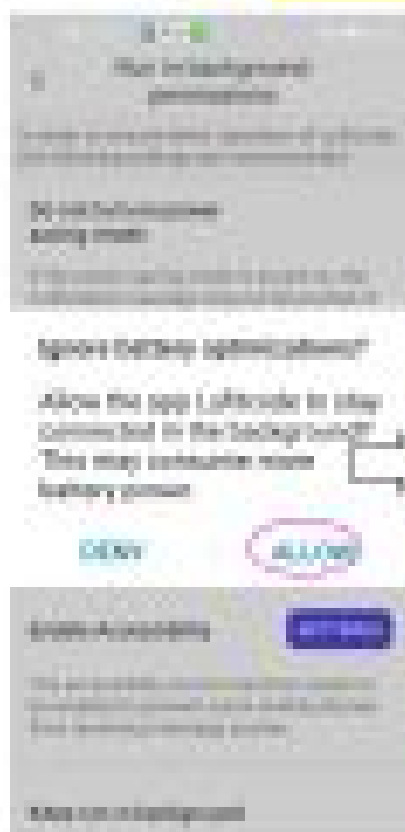

6

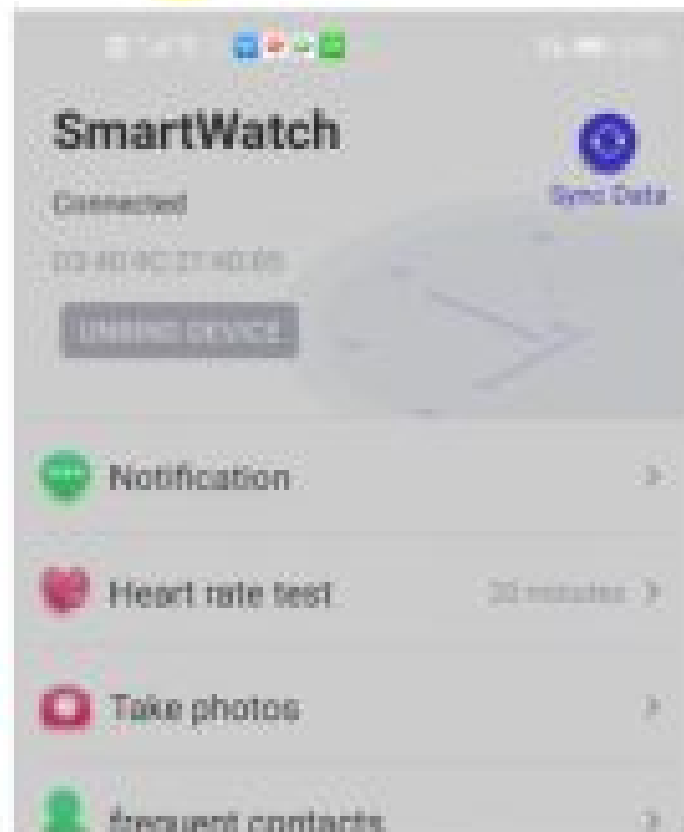

1 of 6

Allow Lufitcode to access
photos, media and files on your
device?



Don't ask me again

DENY

ALLOW

1-6 all click yes Don't ask me again, ALLOW

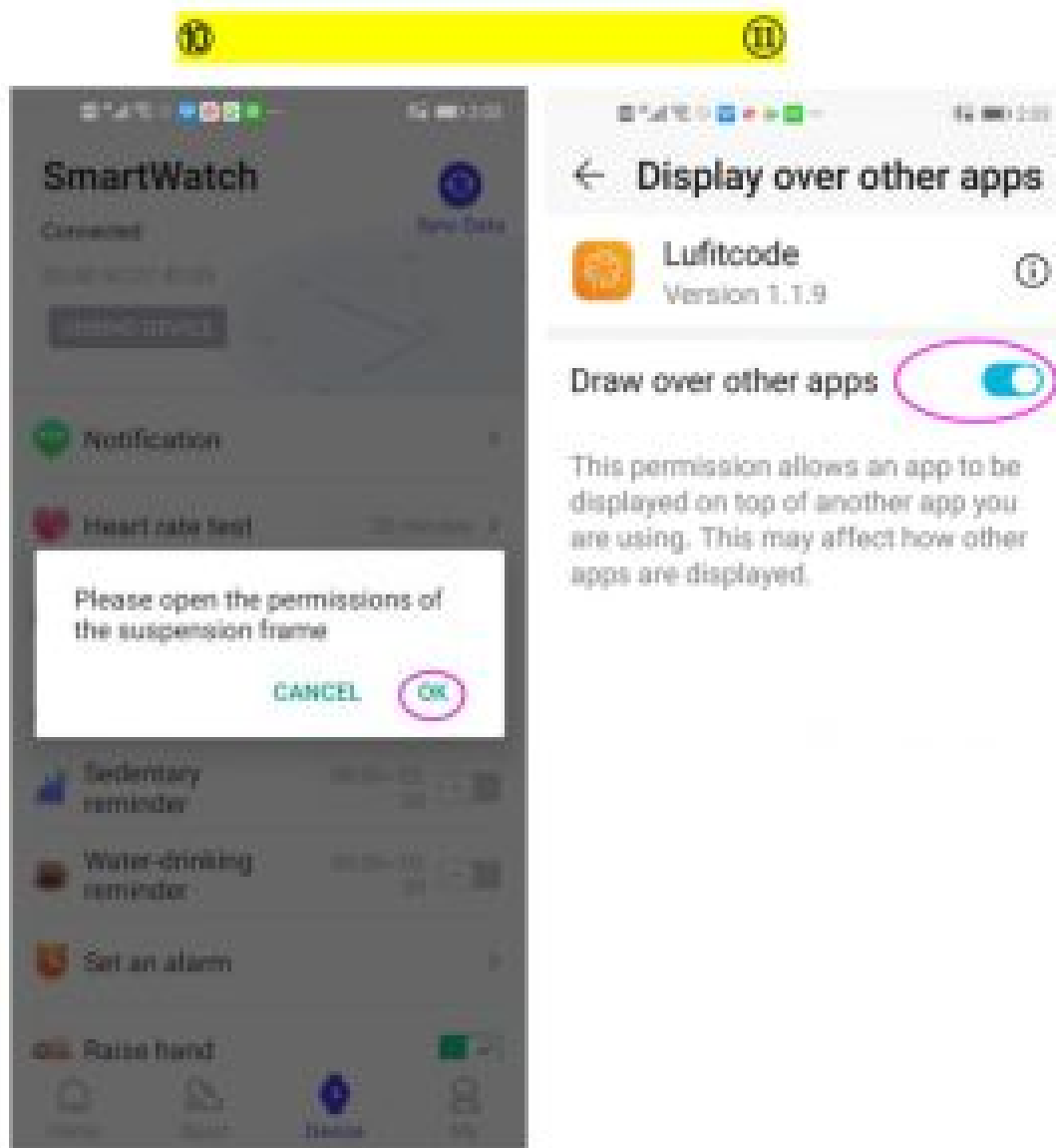
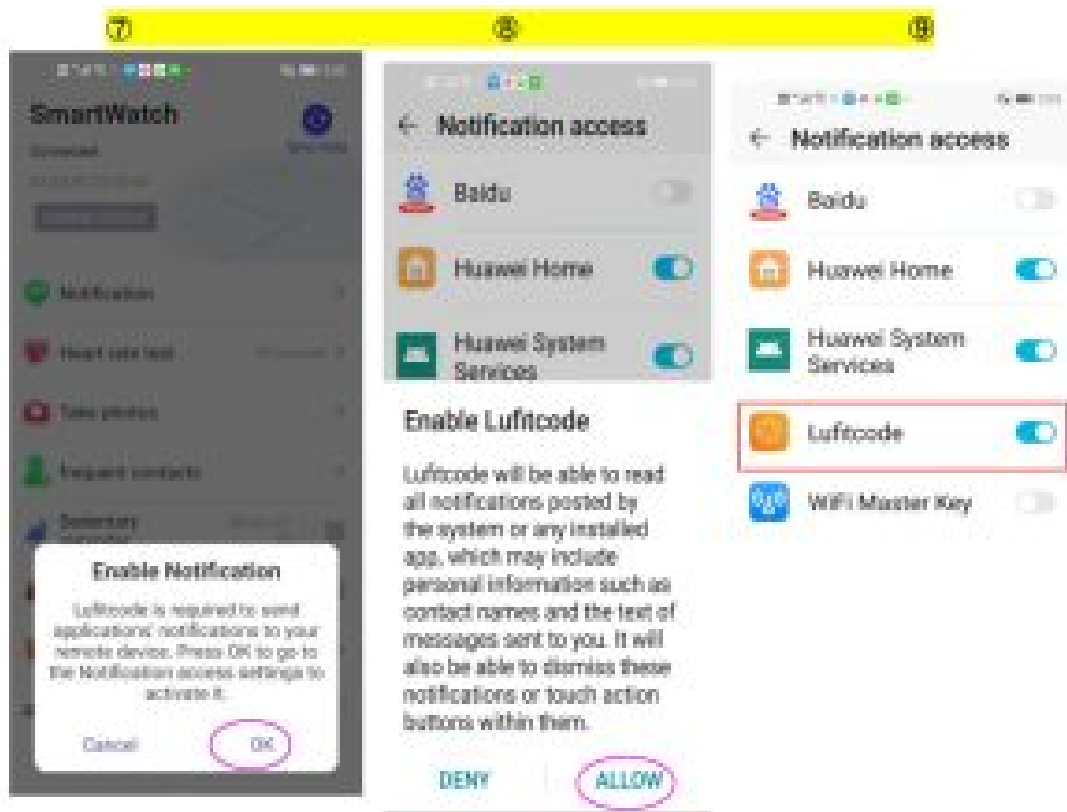

App setting finished. Please go to Phone's Settings—Apps—Lufitcode—Run in the background.

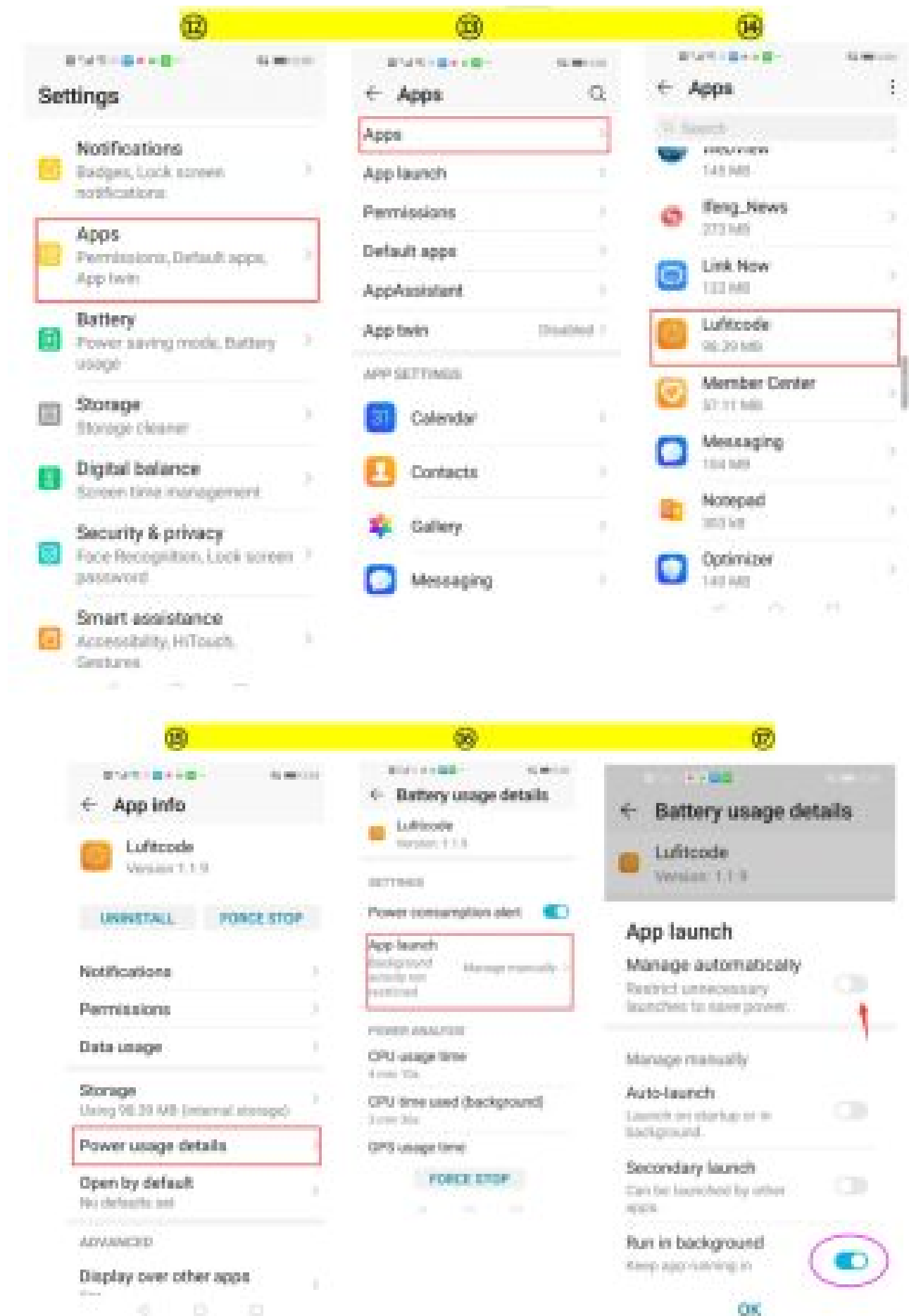

(Above pictures provided by Huawei smartphone. A different model of the smartphone has a different route of APP Launch)



Different Android phones may vary in setting a route, but the key theory is the same.

- ① Stop battery saving on this app or ignore battery saving mode, in case the app manages the system manually stops the app when you close the app window.
- ② Autostart app, keep app running in the background, make the app in the white list, keep the app running in the background/never stop folder
- ③ Access the phone's contacts/calls log/messages/camera/files, so the watch could sync the same information with your phone's new information. Otherwise, you couldn't receive message notifications.

All settings are finished. It's like 24 hours working machine that never stops, this ensures that the app keeps connected to the watch.

If your Android phones haven't been set above, you may disconnect.

Thanks for reading and setting. Happy use Efole smartwatch. Any further questions please feel free to contact us for help.

<https://www.amazon.com/gp/help/contact-seller/contactseller.html?>

Contact us at: Efolen_after-sales@163.com

Documents / Resources

	<p>Efolen Lufitcode Smartwatch [pdf] User Manual Lufitcode</p>
---	--