



EFNOTE 5X 7 Sensor Snare Drum User Guide

[Home](#) » [EFNOTE](#) » EFNOTE 5X 7 Sensor Snare Drum User Guide 

Contents

- [1 EFNOTE 5X 7 Sensor Snare Drum](#)
- [2 IMPORTANT SAFETY INSTRUCTIONS](#)
- [3 WARNING](#)
- [4 Important Information](#)
- [5 FCC INFORMATION](#)
- [6 Assembling](#)
- [7 Assembly](#)
- [8 Connection](#)
- [9 Basic Operation](#)
- [10 Specifications](#)
- [11 Documents / Resources](#)
 - [11.1 References](#)
- [12 Related Posts](#)

E F N O T E

EFNOTE 5X 7 Sensor Snare Drum





IMPORTANT SAFETY INSTRUCTIONS

FAILURE TO OBSERVE THE FOLLOWING SAFETY INSTRUCTIONS MAY RESULT IN FIRE, ELECTRIC SHOCK, INJURY TO PERSONS, OR DAMAGE TO OTHER ITEMS OR PROPERTY. You must read and follow these instructions, heed all warnings, before using this product. Please keep this guide for future reference.

About warnings and cautions

- **WARNING** Indicates a hazard that could result in death or serious injury
- **CAUTION** Indicates a hazard that could result in injury or property damage

About the symbols

	"Caution": Calls your attention to a point of caution
	"Do not ": Indicates a prohibited action
	"You must ": Indicates a required action

WARNING

To reduce the risk of fire or electric shock, do not expose this product to rain or moisture

- Do not use or store in the following locations
- Locations subject to water or rain
- Moist or humid locations (near a bath or shower, or on a wet floor)

- High temperature locations (in direct sunlight, near heating equipment)
- Locations subject to salt damage
- Excessively dusty locations

Turn the power off if an abnormality or accident occurs

- In the following situations, immediately turn off the power, disconnect the AC adapter from the AC outlet, and contact your dealer.
- If the AC adapter, power cord, or plug is damaged
- If smoke is emitted or an abnormal odor is noticed
- If liquid or a foreign object enters the product
- If an abnormality or malfunction occurs in the product

Do not plug or unplug the AC adapter with wet hands

- You risk electric shock. Do not drop or subject to strong impact
- Do not drop this product or subject it to strong impact.

Do not disassemble

- Do not disassemble or modify this product and AC adapter.

Do not damage the power cord

- Do not excessively bend the power cord or damage it. Do not place heavy objects on top of the power cord. Doing so may damage the power cord, causing fire or electric shock.

Use the included AC adapter

- Use only the included AC adapter. Use the adapter with the voltage that it specifies.

CAUTION

- Do not place the product in an unstable location
- Doing so may cause the product to overturn, causing personal injury.
- Do not sit or stand on the product, or place heavy objects on it
- Doing so may damage the product.
- You should also avoid applying excessive force to the buttons, knobs, display, and input/output jacks. Doing so will cause malfunctions.
- Do not use the product at a high volume for an extended time
- Using speakers or headphones at high volume for an extended time will damage your hearing.
- Grasp the power plug when connecting or disconnecting
- When connecting or disconnecting the AC adapter from the product, you must grasp the plug rather than pulling the power cord.

- Disconnect the power plug from the AC outlet during lightning storms or when unused for long periods of time
- Failure to do so may cause electric shock, fire, or malfunction.
- Disconnect all connections before moving the product
- Failure to do so may cause damage to the power cord or cables, or may cause people to trip over the cables.
- Handle the product with care
- Take care that your hands or fingers are not injured by corners, edges or openings of the product.
- Keep small parts out of reach of children
- Keep small parts out of reach of children who might accidentally swallow them.
- Supervise or give guidance when children use this product or children are present around this product
- Always take care that children are not injured with this product.

Important Information

Power supply

- A small amount of current flows even when the power is turned off.
- If you will not be using this product for an extended period of time, you may desire to unplug the AC adapter from the AC outlet.

Regulatory compliance for radio emission devices

- You should keep turning the Bluetooth off when using the product in a country/region other than where it sold.
- The following actions may violate the law.
 - Disassembling or modifying this product.
 - Removing the certification label on the product.

Placement

- Do not use this product near other electrical products such as televisions, radios. This product may cause noise in televisions or radios.

Cleaning

- Use a soft dry cloth to clean the product. Do not use benzene, thinner, detergent, or chemically treated cloth, since these can cause deformation or discoloration.

Data

- Please be aware that the manufacturer bears no responsibility for any consequences that may arise from damage to or loss of data.
- In some cases, equipment malfunction or incorrect operation can cause the contents of the memory to be lost. Please make a backup of any important data that is in the memory.

Copyright

- Duplication or reuse of the music and sound data contained in or included with this product without permission from the copyright holder is forbidden (with the exception of copying for personal use as permitted by copyright law).
- Copyright for the content (sound data, phrase data, audio data, image data, computer programs, etc.) contained in or included with this product is the property of Ef-Note Inc.
- Copyright law forbids you to use the above content without permission of Ef-Note Inc. for any purpose other than personal use.
- The above content that is contained in or included with this product may not be resold, distributed, or published, neither in its existing form nor in any way that resembles it.

Others

- ASIO is a trademark and software of Steinberg Media Technologies GmbH.
- The Bluetooth® word mark and logos are registered trademarks owned by Bluetooth SIG, Inc..
- Company names or product names etc. appearing in this document are the registered trademarks or trademarks of their respective corporate owners.
- EFNOTE is a trademark or registered trademark of Ef-Note Inc.
- All illustrations and screens appearing in this document are for the purpose of explaining operation, and may differ from the actual product or specifications.

Ef-Note Inc. cannot be held responsible for damage caused by improper use or modifications to the product, or loss of data.

For EU countries

- Ef-Note Inc. hereby declares that the type of radio equipment EFNOTE 5X (EFD5X-STDSET) complies with Directive 2014/53/EU. The full text of the EU Declaration of Conformity is available at : ef-note.com/compliance
- This symbol on the product means that used electrical and electronic equipment should not be mixed with general household waste.
- The correct disposal will help prevent potential negative effects on human health and the environment. For proper treatment, recovery and recycling, please contact your city office, waste disposal servicer or the shop which you purchased the product.

For the USA

- **WARNING:**This product contains a chemical known to the State of California to cause cancer, birth defects or other reproductive harm.

FCC INFORMATION

This equipment has been tested and found to comply with the limits for a Class B digital device, pursuant to part 15 of the FCC Rules. These limits are designed to provide reasonable protection against harmful interference in a residential installation. This equipment generates, uses and can radiate radio frequency energy and, if not installed and used in accordance with the instructions, may cause harmful interference to radio communications. However, there is no guarantee that interference will not occur in a particular installation. If this equipment does cause harmful interference to radio or television reception, which can be determined by turning the equipment off

and on, the user is encouraged to try to correct the interference by one or more of the following measures:

- Reorient or relocate the receiving antenna.
- Increase the separation between the equipment and receiver.
- Connect the equipment into an outlet on a circuit different from that to which the receiver is connected.
- Consult the dealer or an experienced radio/TV technician for help.

This device complies with part 15 of the FCC Rules.

Operation is subject to the following two conditions:

1. This device may not cause harmful interference, and
2. this device must accept any interference received, including interference that may cause undesired operation.

Assembling

Packing List

A	Sound Module	1 x	I	18" Standard Cymbal	1 x	Q	Multi-B Cable	1 x	
B	16" Kick	1 x	J	8" Splash Cymbal	1 x	R	Trigger Cable	4 x	
C	12" Snare with Side-Rim	1 x	K	Smartphone Tray	1 x	S	AC Adapter	1 x	
D	10" Tom	1 x	L	Floor Tom Leg	6 x	T	Beater Patch	1 x	
E	12" Floor Tom	1 x	M	Splash Mount Set	1 x	U	Splash Cymbal Rod	1 x	
F	13" Floor Tom	1 x	N	Tom Mount Set	1 x		Long (Alternative)		
G	14" Hi-Hat Cymbals	1 x	O	Module Mount Set	1 x		Tuning Key	1 x	
H	16" Standard Cymbal	2 x	P	Multi-AX Cable	1 x		Cable Tie	1 0 x	
							Quickstart Guide	1 x	

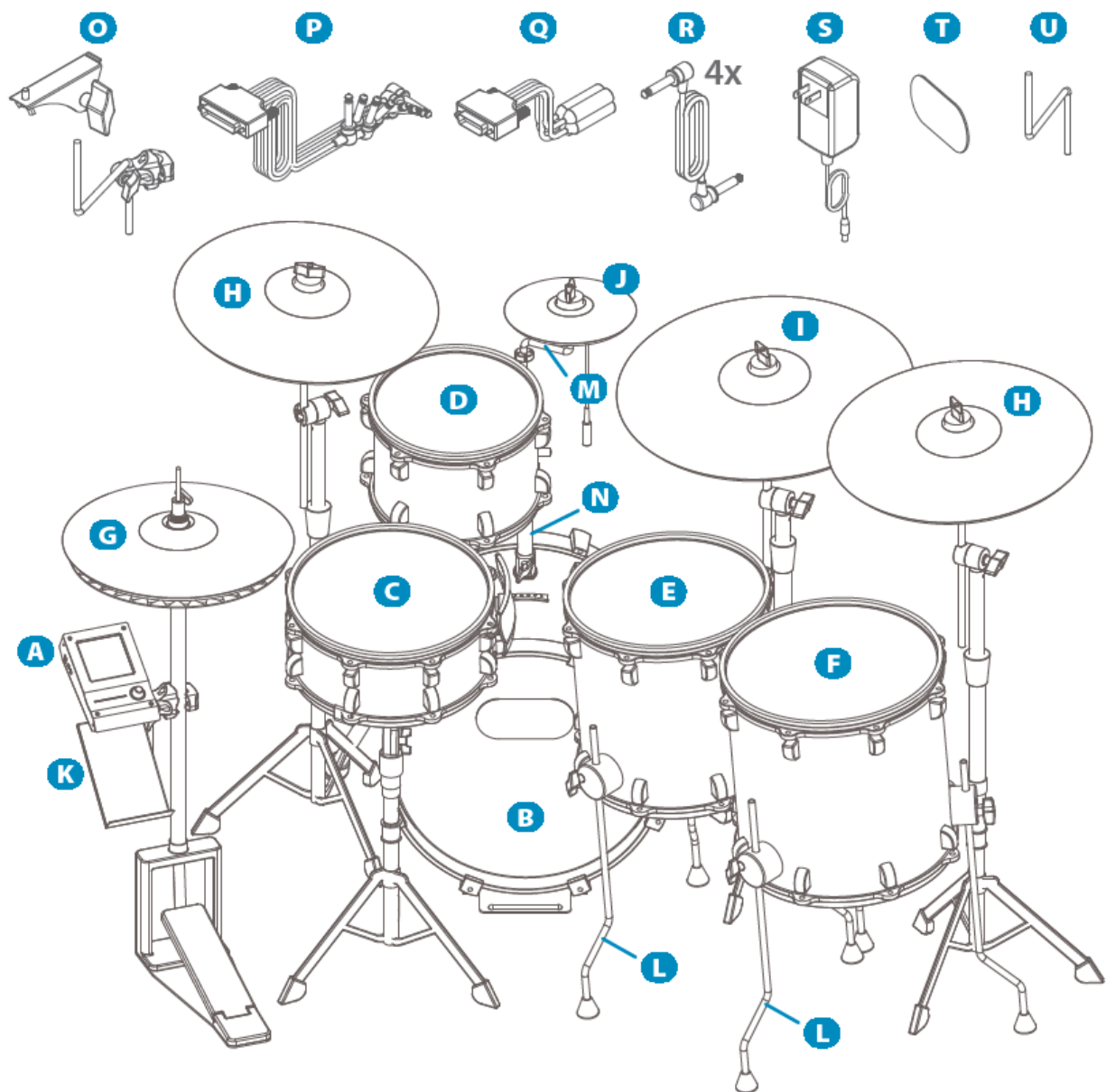

* Kick pedal and hi-hat stand not included.

Assembly

CAUTION Please take your time with assembly and contact us with any questions (p. 19).

1

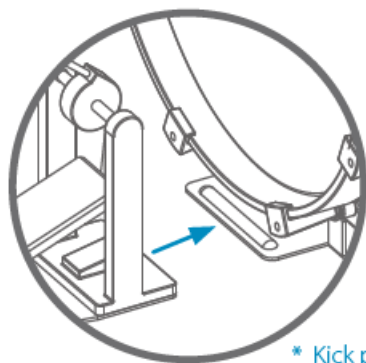

* Kick pedal not included

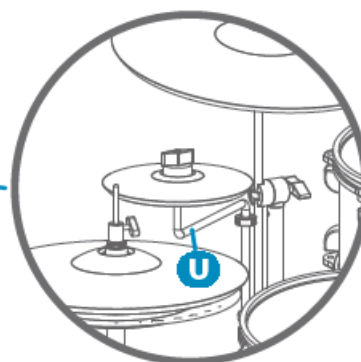
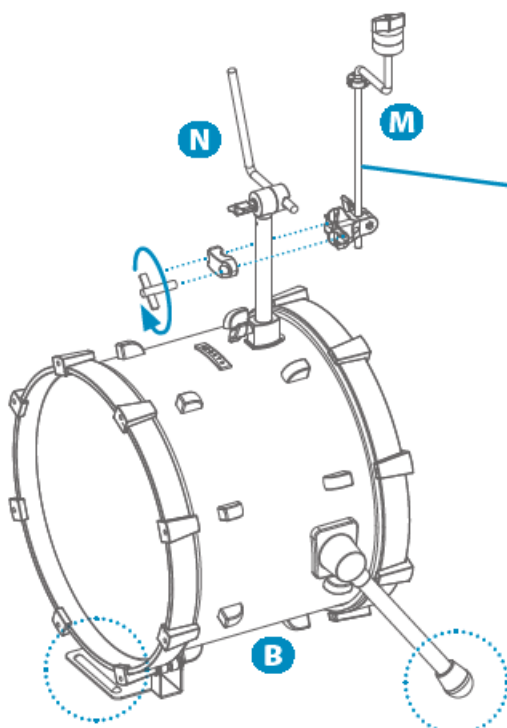

* You can use the alternative rod (long) to attach the splash cymbal on your cymbal stand.



* Be careful with the spikes

2

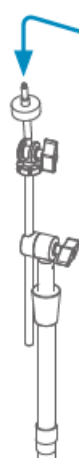
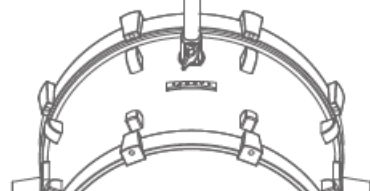
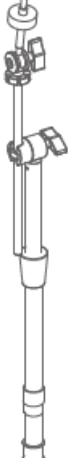
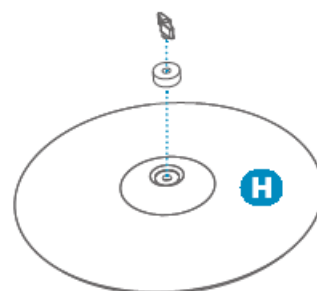
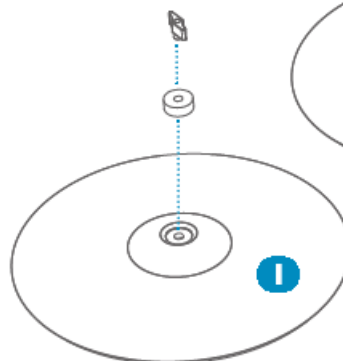
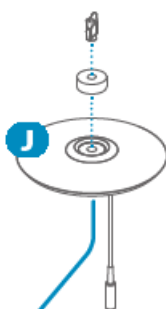
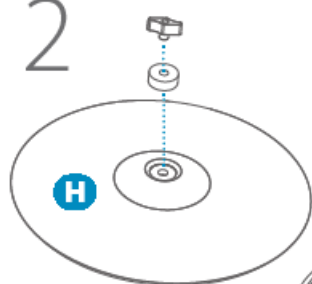

3

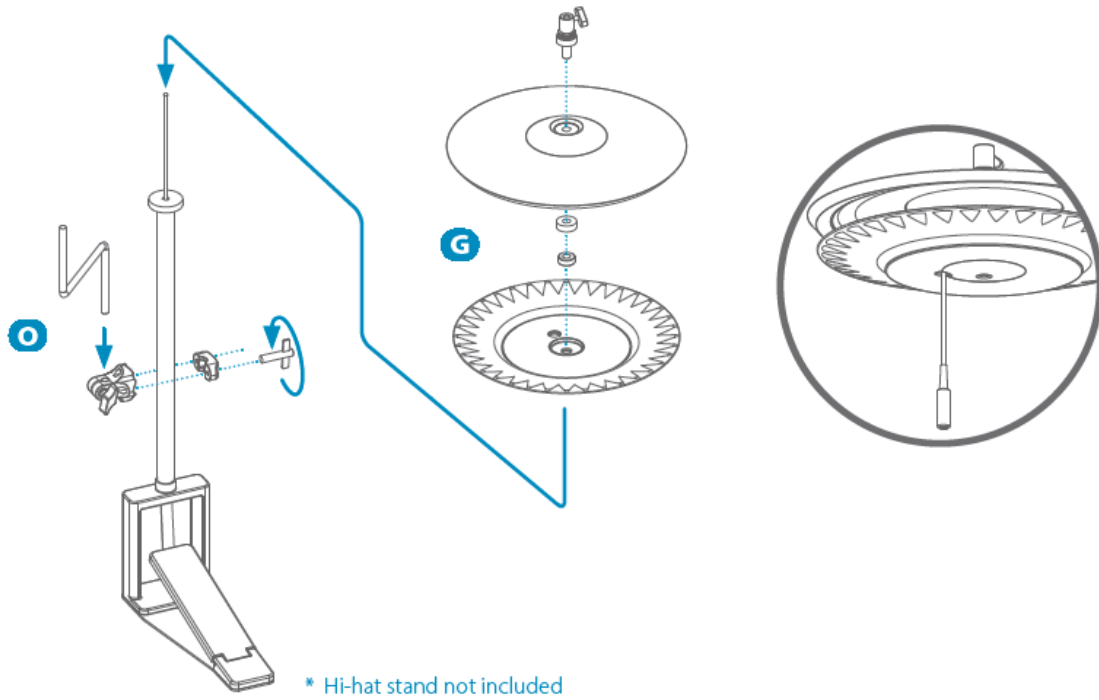

4

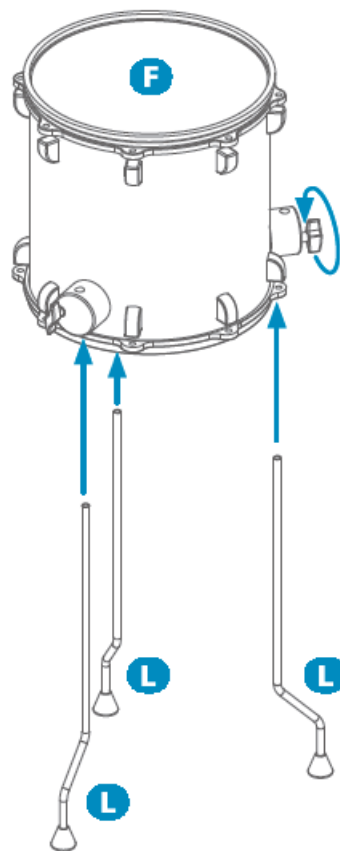
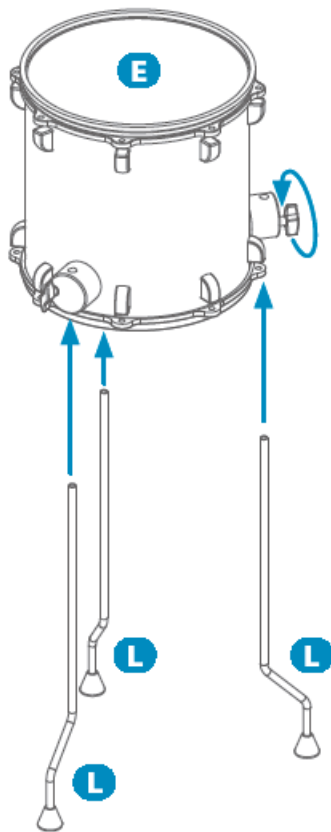

5

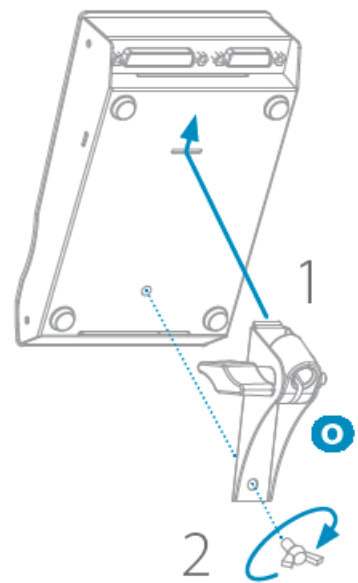

2

6

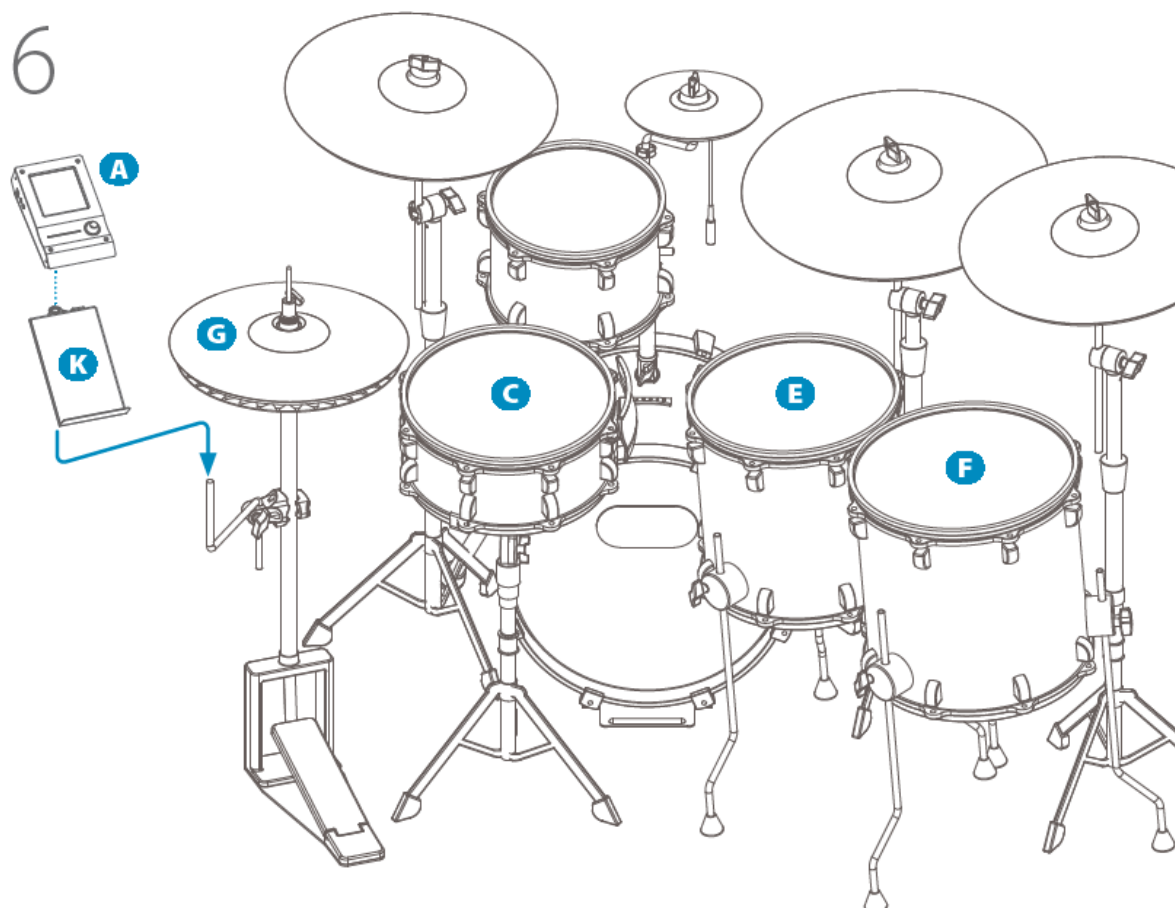

- Be sure to tighten all knobs and bolts firmly.
- Make sure that all stands are stable.
- Be careful that your smartphone does not fall from the smartphone tray.

Attaching the Beater PatchAttaching the Beater Patch

- Playing without the beater patch may cause damage of the head.
- The beater patch is a consumable item. Replace when it has worn.
- DO NOT USE FELT SIDED KICK BEATERS WITH MESH HEADS. This may affect your warranty.

Tuning the Head Tension

- Make sure the mesh drum heads are not too loose.
- Tighten up the tuning bolts evenly with the tuning key, if needed.
- The mesh drum head is a consumable item. Replace when it has worn.

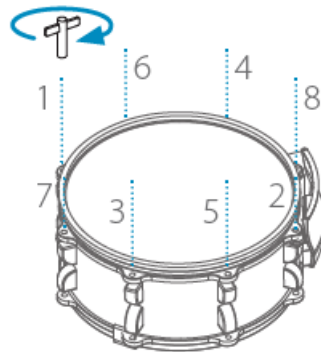
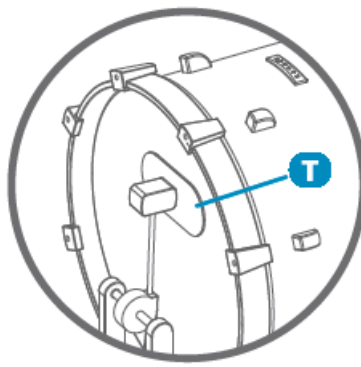

Connection

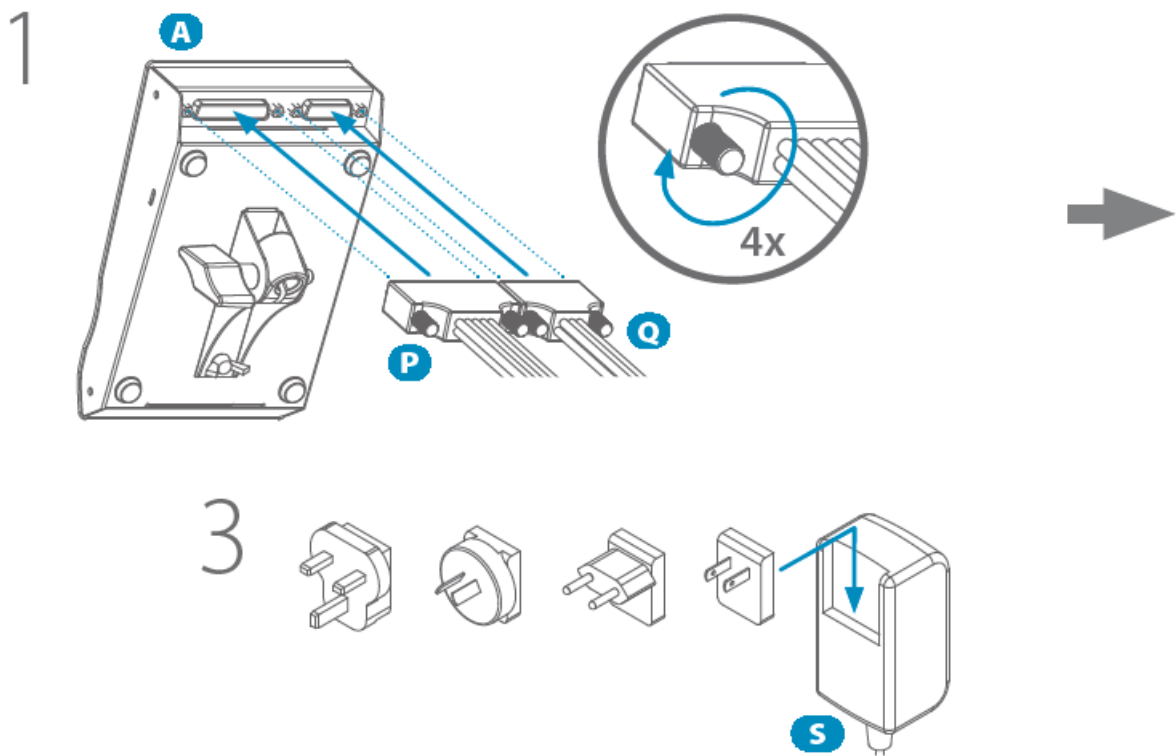

Firmly attach the included plug which is suitable for the outlet in your region. Use only the included AC adapter and plug.

4

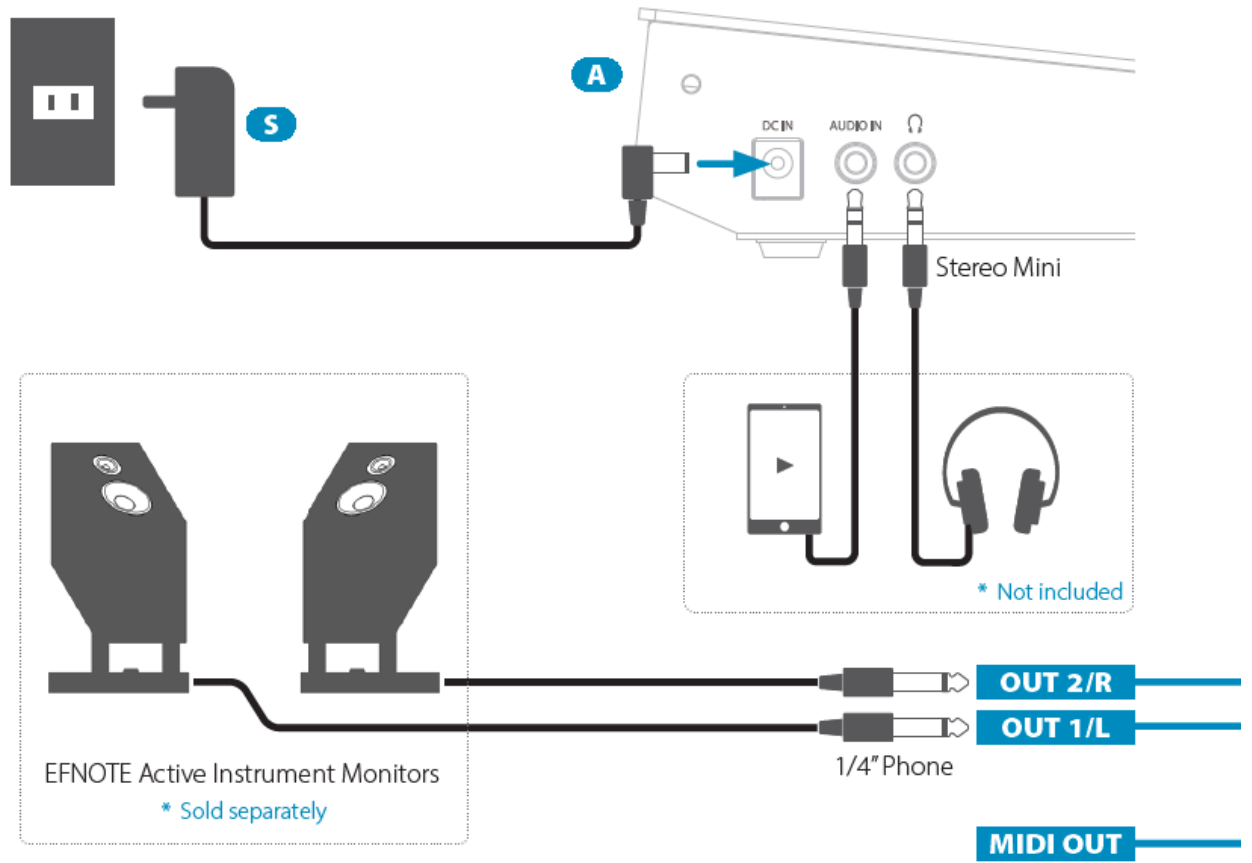

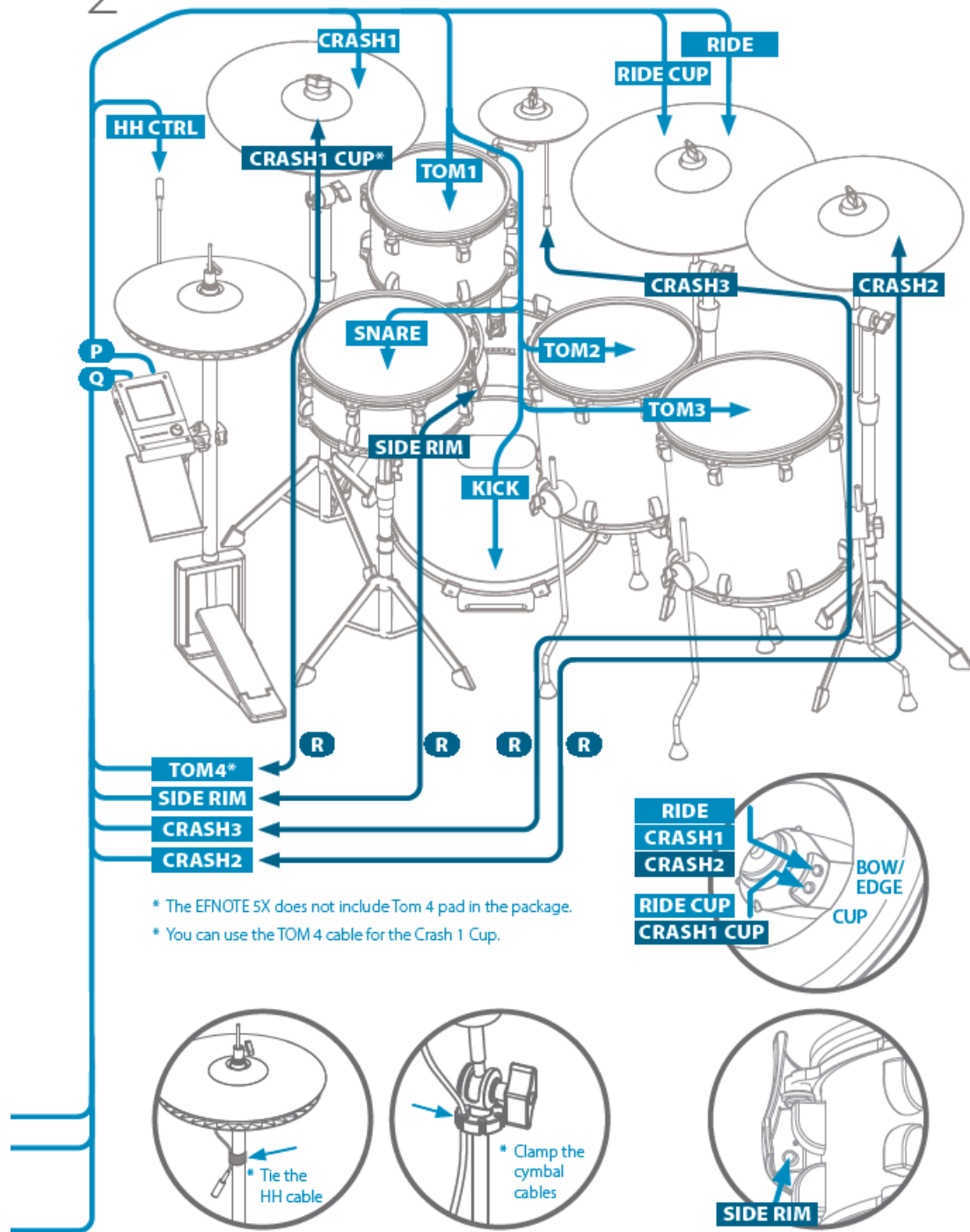

Basic Operation

Panel Description

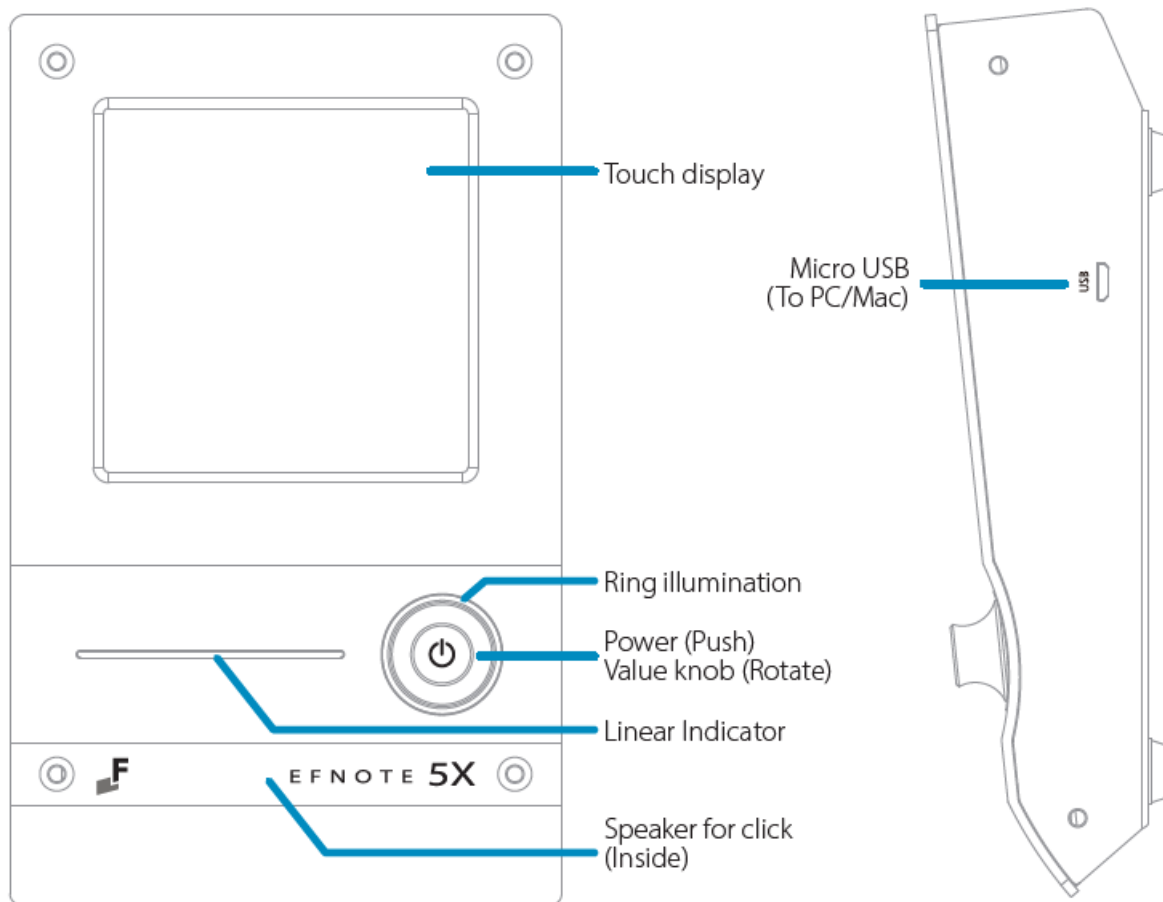

Power On/Off

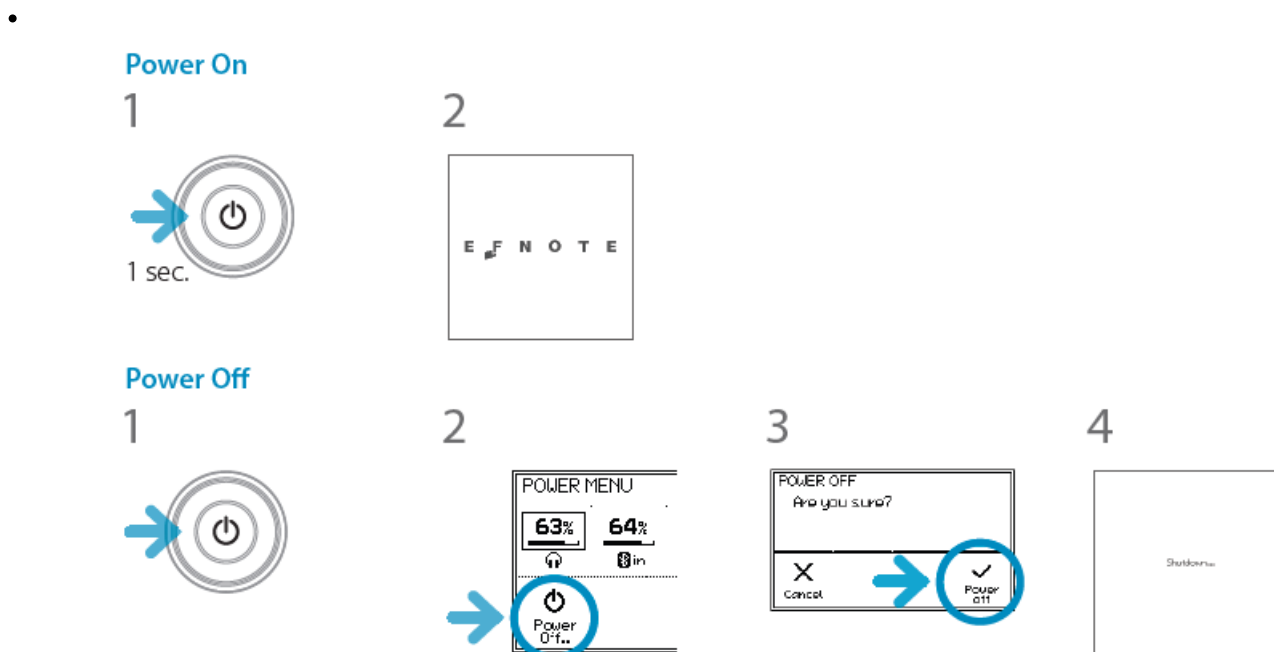

Without this procedure may result in loss of changes.

- The power save function will turn power off automatically after specified period. It can be disabled (p. 17).

Home Screen

Switching drum kits

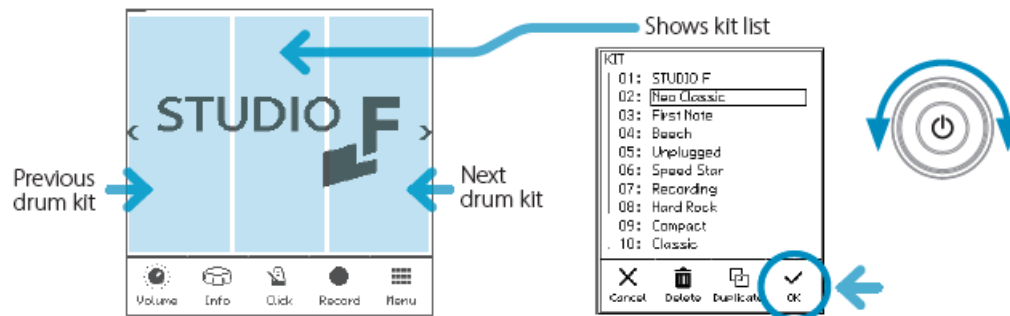

Volume



CAUTION Be sure not to listen to audio at a high volume. It can cause permanent hearing loss.

Inst Info

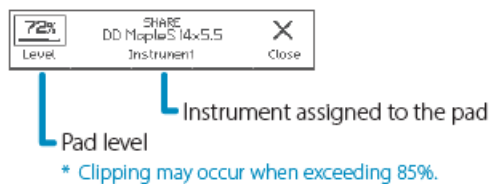

Click (Metronome)

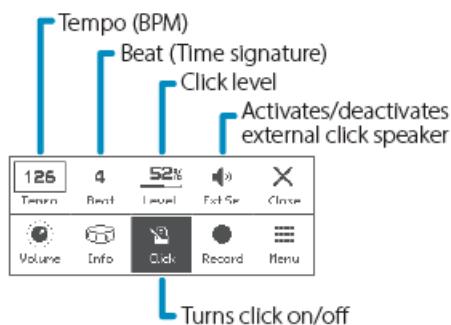

Recorder

Records your drum performances by MIDI.

* Any other audio sources are not recorded.



Rec Standby

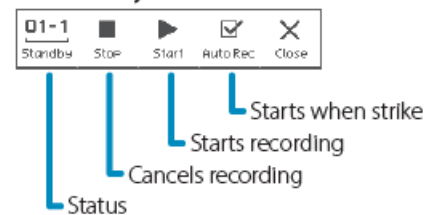

Recording



Playing



Menu

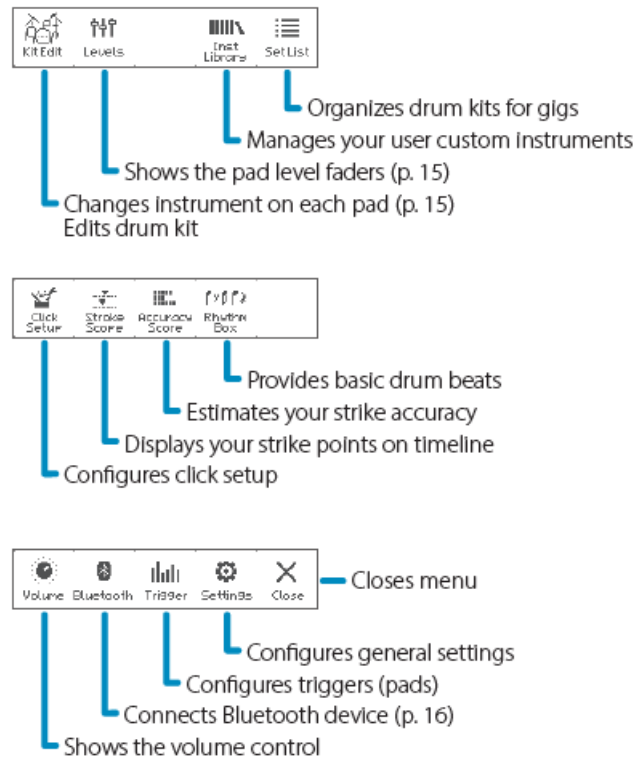

- For the detailed information about screens can be accessed from the menu, please refer to the “Reference Guide” available on the website below.
- ef-note.com/products/drums/EFNOTE5X/efnote5x.html#downloads.



Power Menu

You can access the power menu anytime.

1



* Push the knob again to close the menu.

2

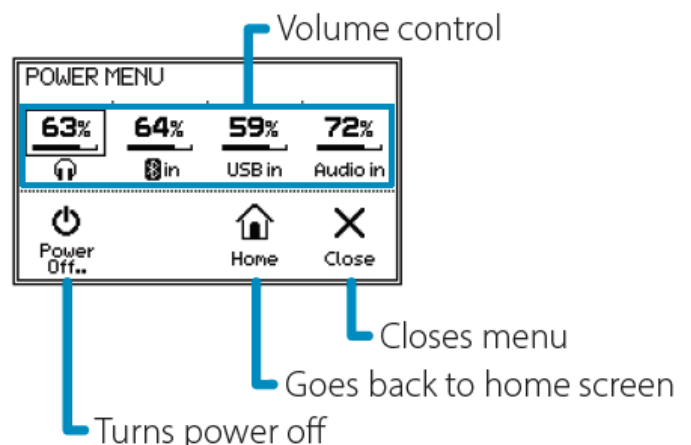

Changing the Instrument



2. Hit the pad you want to change its instrument.
3. Changes are saved automatically.

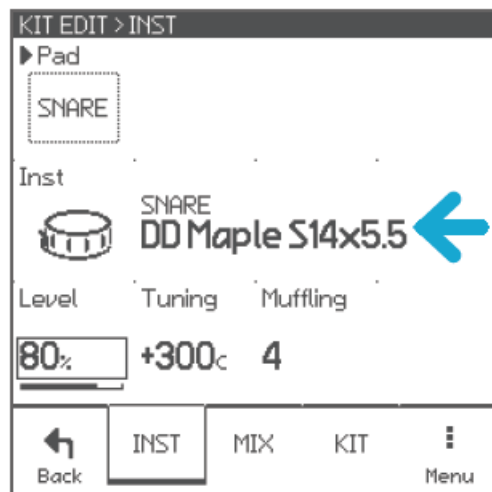

4.

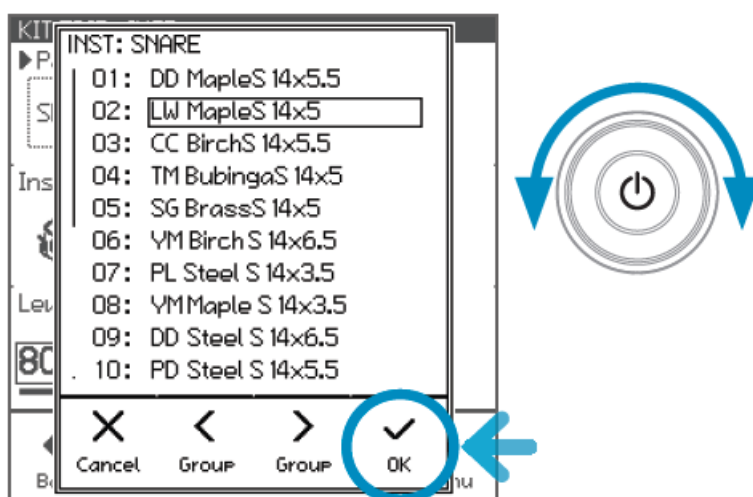

Adjusting the Pad Levels



2. Choose a pad.

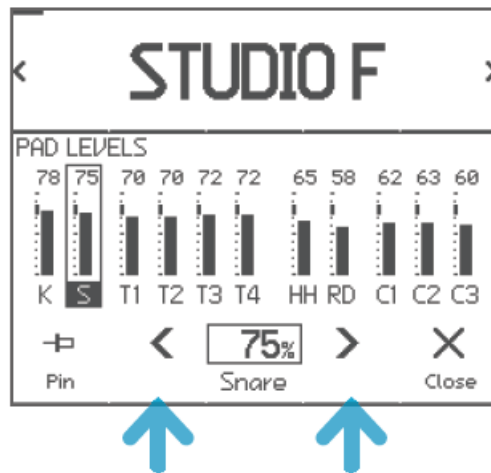

- You can also choose the pad by hitting it.
- If pinned, the selected pad cannot be changed by hit.
- Changes are saved automatically.

3. Adjust the level.



- Clipping may occur when exceeding 85%.

Connecting Your Smart Device with Bluetooth

You can connect your smart device to the EFNNOTE 5X to listen to audio with Bluetooth.

Connecting



- 1.
2. Make sure the status is "Ready to pair". If the status is "OFF", tap it to turn on.

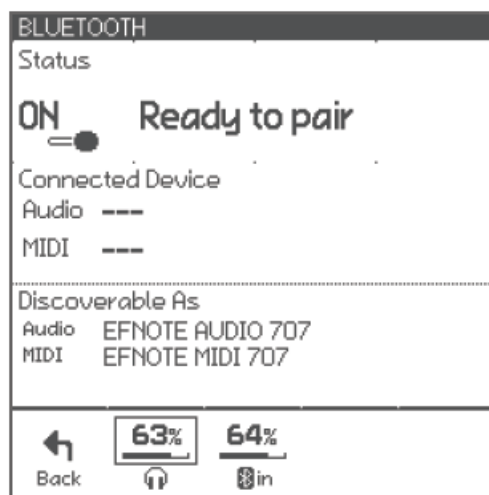

- On your smart device
3. Turn Bluetooth on.
 4. Find new device discoverable as "EFNOTE AUDIO xxx" (xxx is any value), and select it.

5. If pin code is required, enter “0000” (four zeros).
6. Tap [Pair].
7. Make sure the status changes to “Connected”, and your device name is displayed.



Controls Bluetooth
input volume

8. Now, you can listen to the audio playing on your smart device.

Make sure to increase the volume of your smart device.

CAUTION Be sure not to listen to audio at a high volume. It can cause permanent hearing loss.

Disconnecting

1. Tap [Disconnect] on your smart device.

Re-connecting

1. Tap [Connect] on your smart device.

Changing the Power Save Setting



- 1.
- 2.

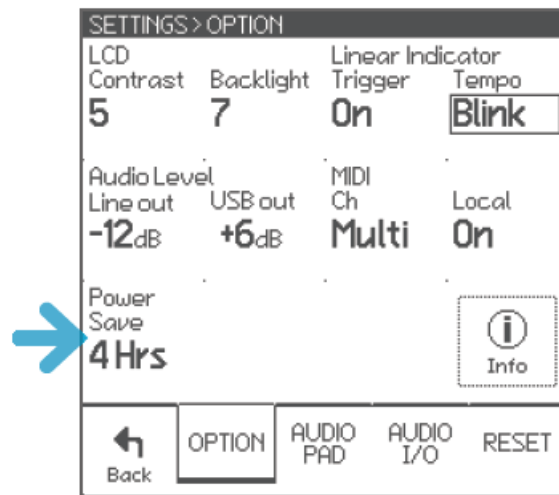

3. When “Off”, the module will not turn off automatically.



Adjusting the Hi-Hat (Auto Calibration)



- 1.
- 2.

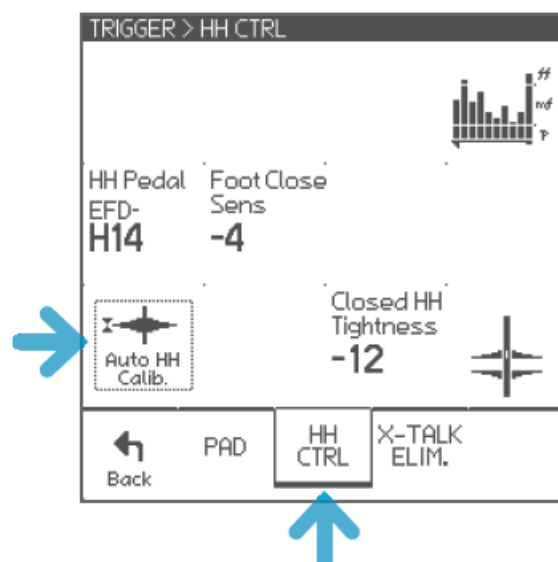

3. Drop the top hi-hat cymbal.

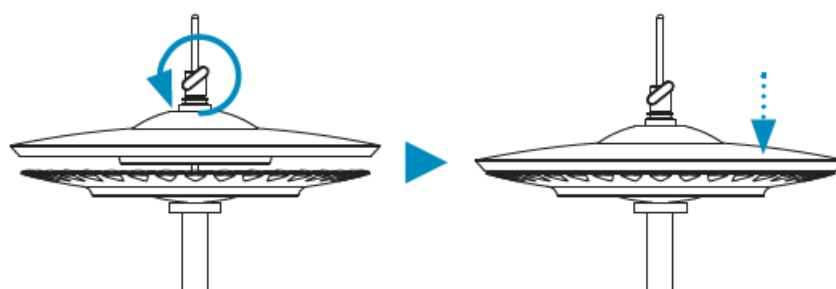

- 4.

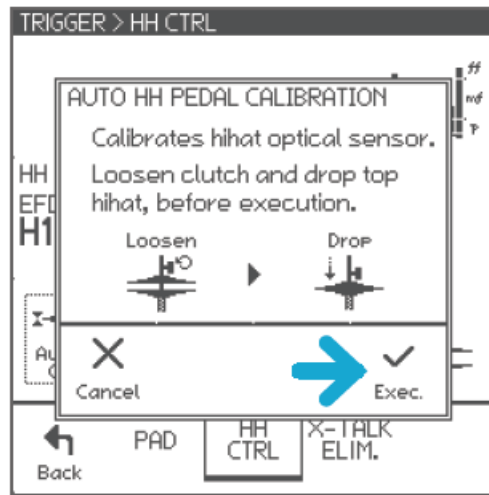

Adjusting the hi-hat manually

- When the hi-hat sound is not closed enough despite you press the pedal firmly, increase the “Closed HH Tightness” value.
- When the hi-hat sound is not open easily even if you slightly release the pedal,
- The default setting is “0”.

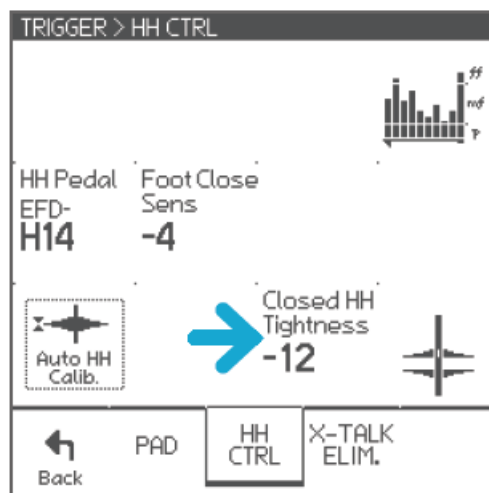

Specifications

Electronic Drum Kit:

- **EFNOTE 5X Sound Module:** EFD-5X

Item	Specifications
Trigger Interface	<ul style="list-style-type: none"> • 3-Zone: Snare, Crash 1/2*, Ride • 2-Zone: Tom 1/2/3/4, HH, Crash 3 • 1-Zone: Kick <p>* Crash 1 and Crash 2 inputs support 3-zone triggering with using TOM 4/CRASH 3 cable S .</p> <p>* Tom 4 pad is not included .</p>
Audio / MIDI Interface	<ul style="list-style-type: none"> • Line (1/2) Output: 2x 1/4" TS Phone (+4dBu, Unbalanced) • Phones (3/4) Output: Stereo Mini-Phone (320 mW + 320 mW @32Ω) • Audio Input: Stereo Mini-Phone (+2dBu Max) • USB: Audio 8-ch Output / 2-ch Input (Mac/Windows ASIO, USB 2.0 Hi-Speed), MIDI In/Out • Bluetooth: Audio Input (A2DP), MIDI In/Out (Bluetooth Low Energy/GATT) <p>Transmission Frequency: 2402–2480 MHz, Maximum Transmit Power: 2.5 mW EIRP</p> <ul style="list-style-type: none"> • MIDI Out: 5-pin DIN
Recorder	<ul style="list-style-type: none"> • Resolution: 480 TPQN • Tracks: 15 • Capacity: Approx . 8,000 Events/Track
Power supply	DC 12V, 500 mA (Nominal) / 800 mA (Max)
Dimensions / Weight	<p>172 (W) x 106 (D) x 47 (H) mm / 700 g</p> <p>* Excluding protrusions</p>

Pads and accessories:

Item	Specifications
Kick (EFD-K1612)	<ul style="list-style-type: none"> • Size: 16 x 12" • Zone: Head • Sensor: Multi • Connector: Head (1/4" TRS Phone)

Snare (EFD-S1250)	<ul style="list-style-type: none"> • Size: 12 x 5" • Zone: Head / Rim / Side-Rim • Sensor: Multi • Connector: Head/Rim, Side-Rim (2x 1/4" TRS Phone)
Tom (EFD-T1070) Floor Tom (EFD-T1212) Floor Tom (EFD-T1313)	<ul style="list-style-type: none"> • Size: 10 x 7" (Tom), 12 x 12" , 13 x 13" (Floor Tom) • Zone: Head / Rim • Sensor: Multi • Connector: Head/Rim (1/4" TRS Phone)
Hi-Hat (EFD-H14)	<ul style="list-style-type: none"> • Size: 14" (Top/Bottom) • Zone: Bow / Edge / Cup • Pad Sensor: Multi (360° flat sensing + choke) • Motion Sensor: Optical • Connector: 6-pin <p>* EFNOTE 5X sound module does not support hi-hat cup zone .</p>
Crash (EFD-C16) Ride (EFD-C18)	<ul style="list-style-type: none"> • Size: 16" (Crash), 18" (Ride) • Zone: Bow / Edge / Cup • Sensor: Multi (360° flat sensing + choke) • Connector: Bow/Edge, Cup (2x 1/4" TRS Phone)
Splash (EFD-C08)	<ul style="list-style-type: none"> • Size: 8" • Zone: Bow / Edge • Sensor: Multi (360° flat sensing + choke) • Connector: Bow/Edge (1/4" TRS Phone)
Accessories	<p>Brake-Out Cable (EFD-MULTI-AX), Brake-Out Cable (EFD-MULTI-B), 4x Trigger Cable 3.0 m (EFD- TRS-LL3), Splash Mount, Tom Mount, Module Mount, Splash Cymbal Rod (Long), Beater Patch, Smartphone Tray, AC Adapter, Cable Ties, Tuning Key, Quickstart Guide</p> <p>* Kick pedal, hi-hat stand, cymbal stand, snare stand, and drum throne are not included .</p>

Optional components and consumable parts

Option	Item	Description
Adding a 2nd tom	EFD-T1180-B O	Rack Tom 11" (Black Oak) * Using the TOM 4 cable .
	EFD-TM5	Tom Mount
Upsizing the ride cymbal + Adding a 4th crash cymbal	EFD-C20	Ride Cymbal 20" * Replacing the ride cymbal with the new 20", and using the 18" with TOM 4 cable . * In this case, you need to change instrument assigns for the Tom 4 pad .
	EFD-CS5	Cymbal Stand
Replacing the drum head	EFD-MDH10	Mesh Drum Head 10"
	EFD-MDH12	Mesh Drum Head 12"
	EFD-MDH13	Mesh Drum Head 13"
	EFD-MDH16	Mesh Drum Head 16"
Replacing the beater patch	EFD-KBP2	Kick Beater Patch

- When any optional pad is added, configure the Assign and Pad model in the Trigger screen. See the Reference Guide for the detail.
- Note that multiple options which use same cable cannot be applied.

Support

Please contact us with questions and comments, we love to hear from you.

- Artesia Pro Inc.
- info@artesia-pro.com.
- artesia-pro.com.



- ef-note.com.

Documents / Resources

	<p>EFNOTE 5X 7 Sensor Snare Drum [pdf] User Guide</p> <p>5X 7 Sensor Snare Drum, 5X, 7 Sensor Snare Drum, Snare Drum, Drum</p>
---	--

References

- [User Manual](#)