



Contents [[hide](#)]

- 1 [EFIC 228-SS Nugget Ice Maker](#)
- 2 [Product Usage Instructions](#)
- 3 [INTRODUCTION](#)
- 4 [IMPORTANT SAFETY INFORMATION](#)
- 5 [GETTING TO KNOW YOUR UNIT](#)
- 6 [OPERATING PROCEDURES & MAINTENANCE](#)
- 7 [USING YOUR ICE MAKER](#)
- 8 [TROUBLESHOOTING GUIDE](#)
- 9 [PRODUCT SPECIFICATIONS](#)
- 10 [LIMITED WARRANTY](#)
- 11 [Frequently Asked Questions](#)
- 12 [Documents / Resources](#)
 - 12.1 [References](#)

EFIC

EFIC 228-SS Nugget Ice Maker



Specifications

- **Model:** Crunchy Chewable Nugget Ice Maker
- **Power:** 110-115 VOLT 60 Hz
- **Outlet Requirement:** 15 AMP Grounded Outlet
- **Features:** Float switch, Secondary water reservoir, Water reservoir, Filter, Control Panel, Ice basket, Water drain cap, Ice scoop

Product Usage Instructions

Unpacking and Setup

1. Remove all exterior and interior packaging and check for all included accessories.
2. Remove any tapes on the unit and take out the accessory parts inside.
3. Clean the interior with lukewarm water and a soft cloth.
4. Place the ice maker on a level countertop table away from direct sunlight and heat sources.
5. Leave the refrigerant fluid to settle down for an hour before plugging in.
6. Ensure the power plug is easily accessible. Only fill with potable drinking water.

Operating Procedures

- Refer to the control panel for ice-making and cleaning options.
- Monitor the ring indicator light for status updates.
- Keep an eye on the water level and ice full indicator lights.

Maintenance

- Regularly clean the interior of the ice maker with lukewarm water and a soft cloth.
- Ensure the water drain cap is clean and free from blockages.
- Follow manufacturer guidelines for any additional maintenance requirements.

INTRODUCTION

Welcome to our family

- Thank you for bringing Frigidaire into your home! We see your purchase as the beginning of a long relationship together.
- This manual is your resource for the use and care of your product. Please read it before using your appliance. Keep it handy for quick reference. If something doesn't seem right, the troubleshooting section will help you with common issues.
- FAQs, helpful tips and videos, cleaning products, and kitchen and home accessories are available at www.frigidaire.com.
- When you unpack your ice maker, you may find a small amount of water inside.
- Your unit is brand new.
- Any water you may find is from the standard quality control testing that all of our ice makers undergo as part of the manufacturing process.
- Please follow the initial preparation and cleaning instructions as detailed in the User Guide before using your new icemaker.
- When using, please avoid direct sunlight.

Installation Checklist

- **Doors**
 - Door seals completely to the cabinet on all sides
- **Leveling**
 - The cabinet is set solidly on all corners

- **Electrical Power**

- The house power turned on

- **Ice Maker**

- The ice maker is turned ON





- **Final Checks**

- Shipping material removed

IMPORTANT SAFETY INFORMATION

-  **WARNING:** Please read all instructions before using this appliance.

Safety Definitions

-  This is the safety alert symbol. It is used to alert of potential personal injury hazards. Obey all safety messages that follow this symbol to avoid possible injury or death.
-  **DANGER** indicates an imminently hazardous situation which, if not avoided, will result in death or serious injury.
-  **WARNING** indicates a potentially hazardous situation which, if not avoided, could result in death or serious injury.
-  **CAUTION** indicates a potentially hazardous situation that, if not avoided, may result in minor or moderate injury.
-  **IMPORTANT** indicates installation, operation, or maintenance information that is important but not hazard-related.

Child Safety

- Destroy or recycle the carton, plastic bags, and any exterior wrapping material immediately after the Ice Maker is unpacked.
- Children should NEVER use these items to play.
- Cartons covered with rugs, bedspreads, plastic sheets, or stretch wrap may become airtight chambers and can quickly cause suffocation.

Safety Instructions

- DO NOT store or use gasoline or other flammable liquids in the vicinity of this or any other appliance. Read product labels for warnings regarding flammability and other hazards.
- Avoid contact with any moving parts of the automatic ice maker.
- Remove all staples from the carton.
- Staples can cause severe cuts and also destroy finishes if they come in contact with other appliances or furniture.

WARNING!

- Improper use of a grounded wire can result in the risk of electric shock.
- Consult a physician if necessary. Do not attempt to defeat this safety feature by modifying the plug.
- Avoid the use of an extension cord because it may overheat and pose a risk of fire. However, if it is necessary to use an extension cord:
 - **A.** Use only 3-wire extension cords with a 3-blade grounding plug.
 - **B.** The marked rating of an extension cord must be equal to or greater than the rating of this appliance.
 - **C.** It should be positioned such that it does not drape over the counter or tabletop, where it can be pulled on by children intentionally.

Attempting any maintenance or cleaning:

- To minimize the possibility of electric shock, unplug this appliance from the power supply or disconnect at the household distribution panel by removing the fuse or switching off the circuit breaker before attempting any maintenance or cleaning.
- **NOTE:** Pressing the Power ON/OFF button to an off position does not disconnect the appliance from the power supply.

Warning:

IMPORTANT NOTICE: Use Only Water

- We want to ensure the safe and efficient operation of your ice maker. Please be aware that this appliance is designed for one specific purpose – to make ice from water.
- Do not use any beverages, liquids, or substances other than water in this ice maker. Using anything other than water may lead to damage, malfunctions, and potentially hazardous situations, therefore voiding your warranty.

Why Use Only Water:

1. **Safety:**** Introducing beverages or non-water substances can result in chemical reactions or build-up that could pose safety risks.
2. **Performance:**** Using water ensures that your ice maker functions as intended, producing clean and odorless ice cubes.
3. **Durability:**** Water is the only liquid that will not corrode or damage the internal components of your ice maker, preserving its lifespan.

Consequences of Using Beverages:

- **Damage:**** Non-water substances can corrode, clog, or damage the internal components, resulting in costly repairs or replacement.
- **Health Concerns:**** Using beverages may introduce contaminants into the ice-making process, potentially impacting the safety of the ice produced.
- **Voided Warranty:**** Using beverages or non-water substances may void your appliance's warranty, leaving you responsible for any repair or replacement costs.
- To ensure the longevity and reliability of your ice maker, always follow these guidelines strictly. Only use clean, potable water in your ice maker to guarantee safe and refreshing ice for all your beverage needs.
- If you have any questions or concerns regarding the proper usage of your ice maker, please refer to the user manual or contact our customer support for assistance.

GETTING TO KNOW YOUR UNIT

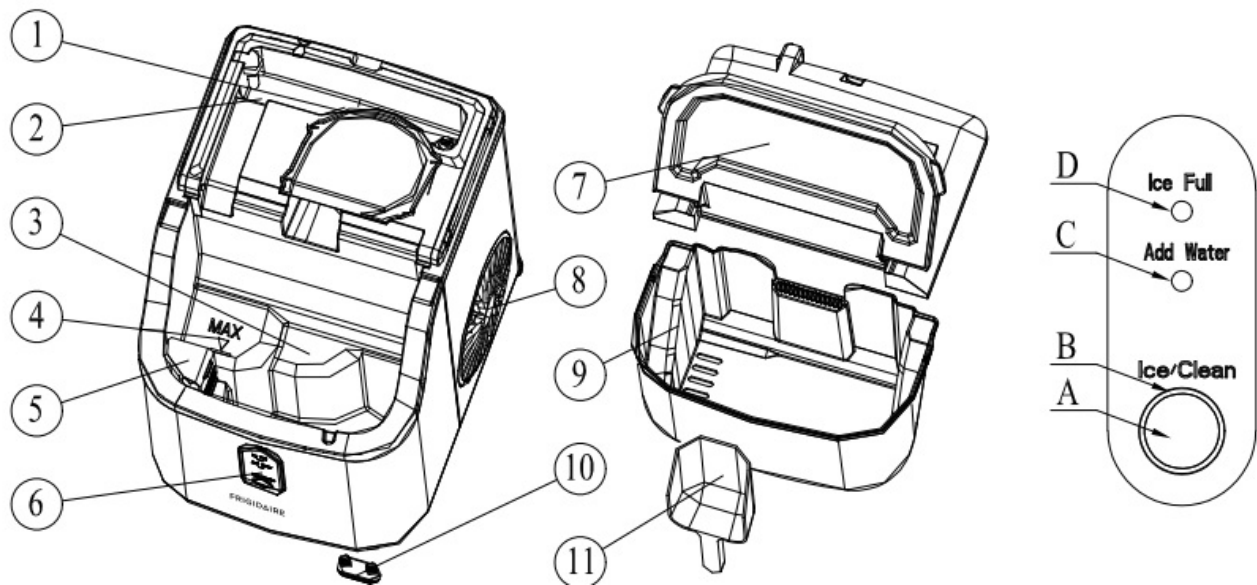

1. Float switch
2. Secondary water reservoir: It connects directly with the evaporator
3. Water reservoir
4. Maximum water level
5. Filter
6. **Control Panel:**
 - **A.** Ice-making and cleaning buttons
 - **B.** Ring indicator light
 - **C.** Water lack indicator light
 - **D.** Ice full indicator light
7. Top cover, removable from the top
8. Hot Air outlet
9. Ice basket
10. **Water drain cap:** at the front bottom side of the unit
11. Ice scoop
 - Come equipped with a convenient ice scoop, allowing for easy and hygienic handling of ice.

OPERATING PROCEDURES & MAINTENANCE

UNPACKING YOUR ICE MAKER

1. Remove the exterior and interior packaging, and then check that all the accessories are included. If any parts are missing, please contact our customer service.

2. Remove all the tapes on the unit; take out the accessory parts inside.
3. Clean the interior with lukewarm water and a soft cloth.
4. Locating your ice maker on a level counter table far from direct sunlight and other sources of heat (i.e., stove, furnace, and radiator). Make sure that there is at least 6 inches between the back and sides of your ice maker with the wall.
5. Allow one hour for the refrigerant fluid to settle down before plugging your ice maker in.
6. The power plug must be accessible directly.
 - **WARNING:** Fill with potable water only. Only use drinking water.

CONNECTING YOUR ICE MAKER



DANGER Improper use of the grounded plug can result in the risk of electrical shock. If the power cord is damaged, please call our customer service.

1. This unit should be properly grounded for your safety. The power cord of this appliance is equipped with a grounding plug that mates with standard grounding wall outlets to minimize the possibility of electric shock.
2. Plug your appliance into an exclusive, properly installed, grounded wall outlet. Do not be under any circumstances, damage the grounding means of the plug. Any questions concerning power and or grounding should be directed toward a certified electrician.
3. This appliance requires a standard 110- 120V, 60Hz electrical outlet with good grounding means.

CLEANING AND MAINTAINING YOUR ICE MAKER

Before using your ice maker, it is strongly recommended to clean it thoroughly. Unplug the unit before cleaning or performing any maintenance.

1. Take out the ice basket.
2. Clean the interior with commercial descaling solution specifically designed for ice makers, warm water, and a soft cloth. First, pour the warm water with diluted descaling solution into the internal water reservoir, and then use the soft cloth to wipe the surface.

3. Then rinse the inside parts with water, and drain out the water by unplugging the drain cap on the front bottom side.
4. The outside of the ice maker should be cleaned regularly with a mild commercial descaling solution specifically designed for ice makers and warm water.
5. Dry the interior and exterior with a clean, soft cloth.
6. When the machine is not in use for a long time, drain water completely out and dry the interior

USING YOUR ICE MAKER

How to start the unit

1. Remove the top cover, and take out the power cord.
2. Take out the ice basket, pour potable water into the water reservoir, 0.3 gallons of water at most at one time.
3. Put back the ice basket.
4. Plug in and the ring indicator will turn red light on. If you press the “Ice /Clean” button, the machine will start making ice; If long long-press the “Ice/Clean” button, it will do automatic cleaning.

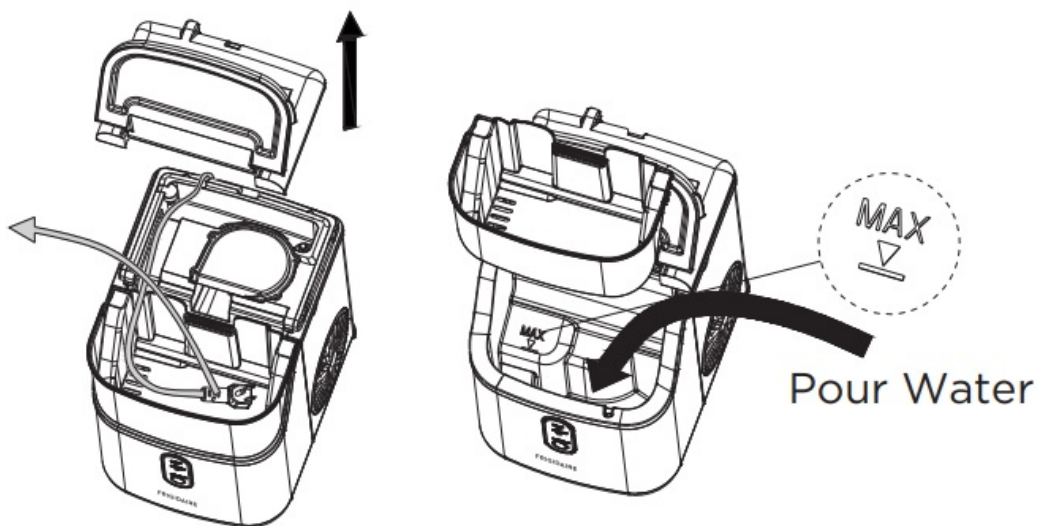

Clean

For the first time, or if the clean procedure has not been run for a long time, it is highly recommended to run this procedure first.

1. Before the cleaning procedure, please make sure the water drain cap has been

inserted into the appliance; otherwise, it will not work properly.

2. Press the “ICE/CLEAN” button for 5 seconds. The ring indicator light flashes white, it will run the cleaning procedure for 15 minutes, and automatically exit. Press this button again during the cleaning procedure, it will exit immediately.
3. After cleaning procedure, remove the top cover and the ice basket, rinse the main water reservoir and the secondary water reservoir, then move the appliance to the edge of the desktop, make sure that the appliance is placed steady, place a water container under the appliance, remove drain cap from the bottom, dirty water will drain into the water container, then reinsert the drain can.

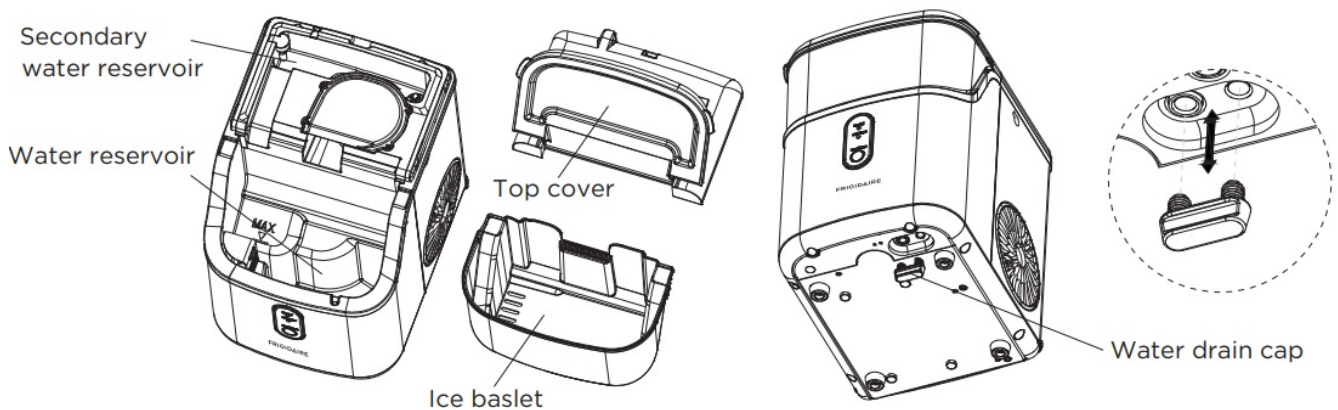

- **Tips:** remove the top back cover by pulling up the front clear cover gently.
- Change water in the water reservoir every 24 hours to ensure a reasonable hygiene level. If the unit isn't to be used, drain all water & dry the water reservoir.

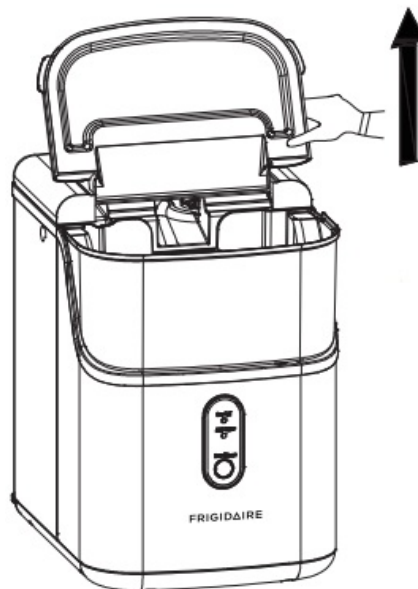

System Cleaning/Sanitizing Procedure

1. Unplug the nugget ice maker.

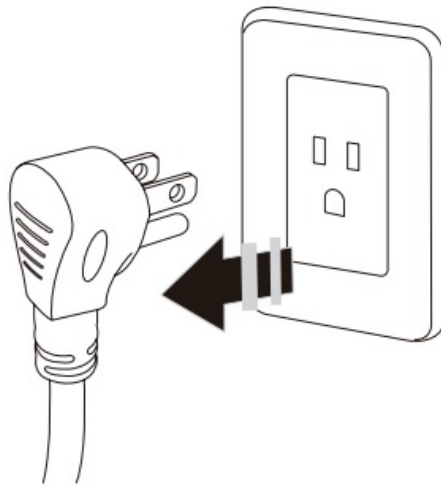

2. Take off the bottom drain cap and drain out the water to a sink.

- See the figure below.

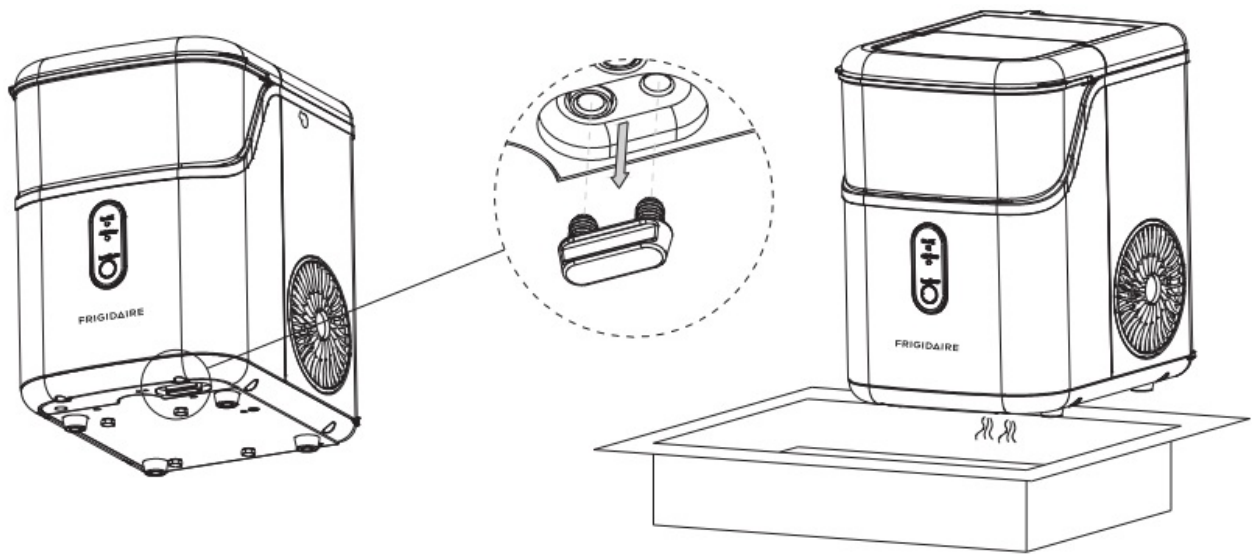

3. Solve by diluting one teaspoon of household bleach with five cups of water for daily cleaning.

- For monthly cleaning of removing mineral deposits, please use the white vinegar instead of the above water solution (and then plug in to turn on the “cleaning function” for about 5 minutes.
- After that, unplug it again to leave the white vinegar in the unit for more than 12hours.

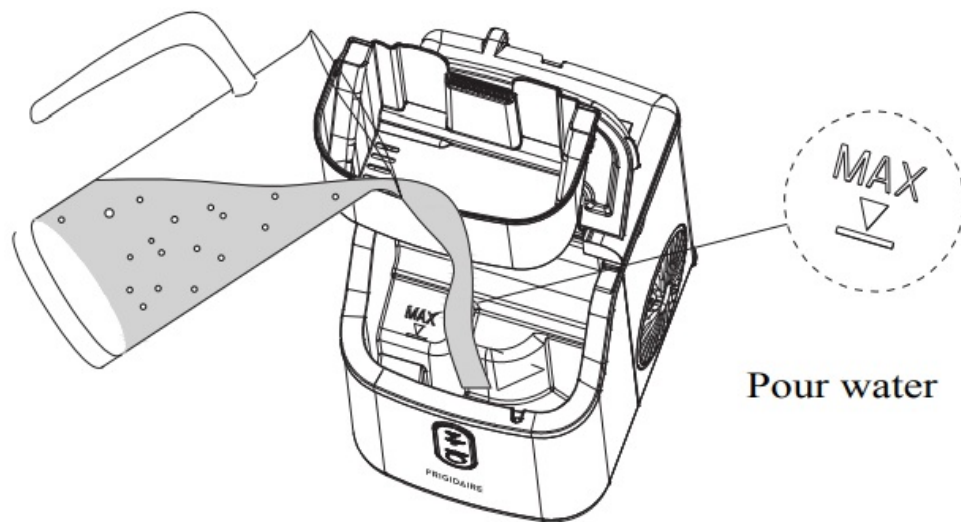

- Plug in the Nugget ice maker, press and hold the “Clean” button for 5 seconds to initiate the cleaning process(15 minutes). See the figure below.

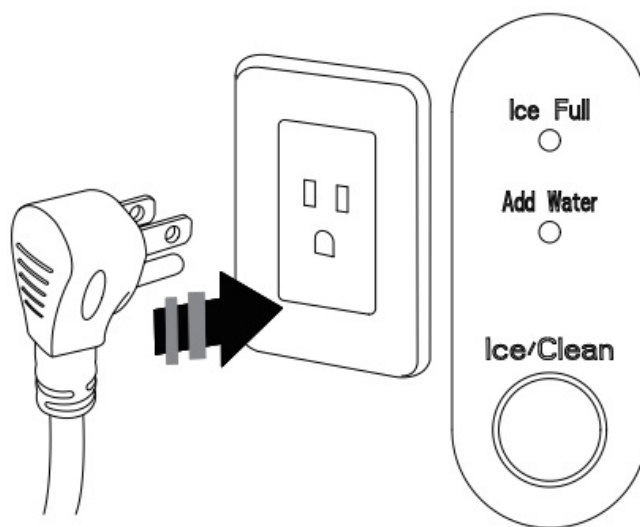

- When the “cleaning” indicator lights off, take off the drain cap and drain out the water into a sink.

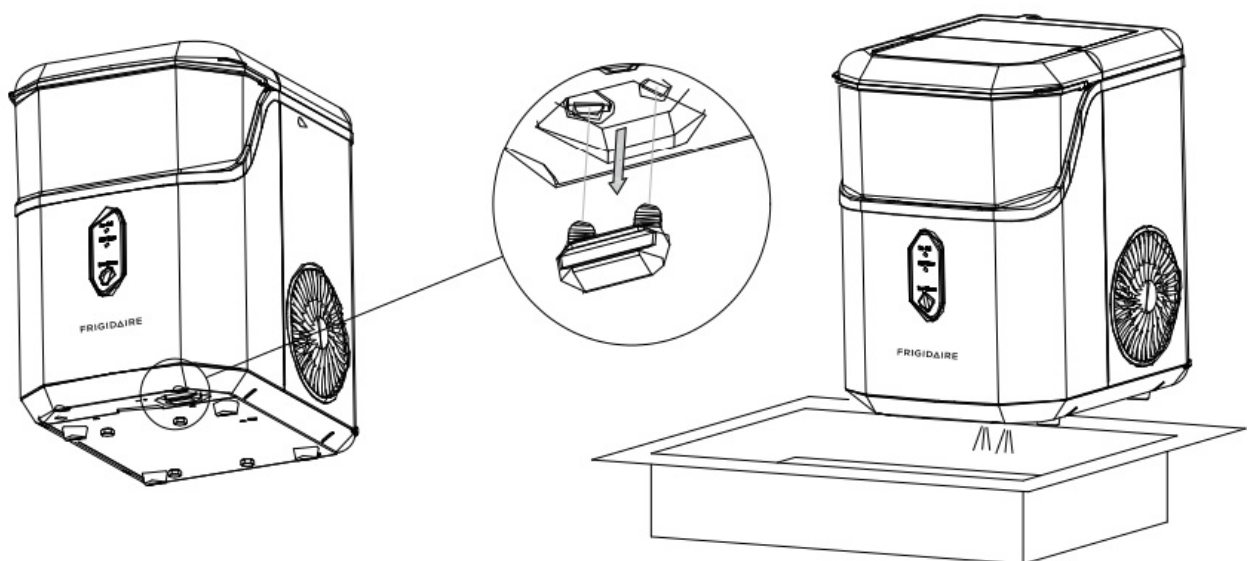

4. Repeat steps 4 to 6 with fresh water for two more cycles to rinse the inside.
5. Replace the drain cap on the bottom. See the figure below.

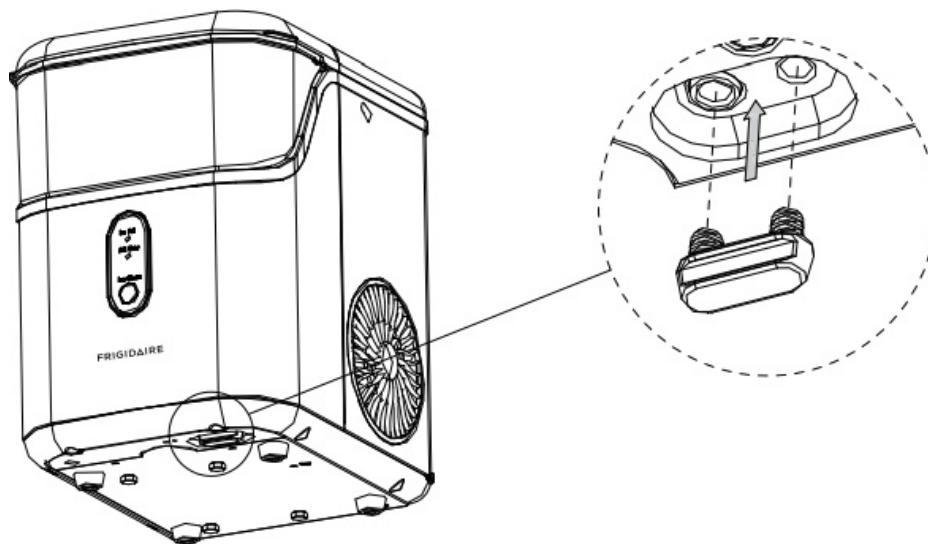

6. When completed, fill the unit with fresh water and press the “Ice” button to start ice ice-making process. See the figure below.

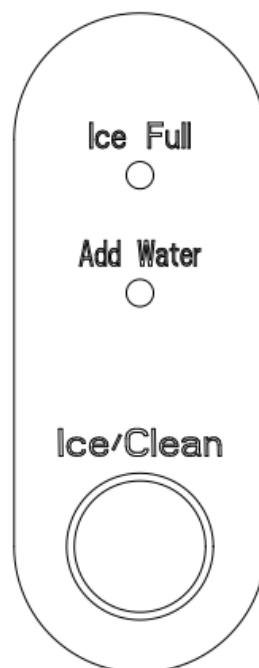

How to obtain the ice-cube

1. Before we start making ice, please make sure the water drain cap has been inserted into the appliance; otherwise, it will not work properly.
2. Press the “Ice/Clean” button, the ring indicator light flashes white, it begins to work, press this button again, it will stop making ice.
3. For the first time, or if the appliance has not been used for a long time, it is recommended to clean this appliance before you start to make ice.
4. In the process of making ice, if the “Add Water” indicator light is on, and the machine stops working, it needs to be filled with water. After adding water, please restart the machine; otherwise, it will need to wait for a long time and then automatically start

making ice again. When the ice-making machine is restarted, the compressor will have a waiting time of 3 minutes.

5. When the machine is full of ice, it will automatically stop working. The “Ice Full” indicator light will be on, and the ring indicator light will be white. After the ice is removed, the machine starts working automatically.

Ice scoop position

Put the scoop on the top back cover.

Ice scoop

Ice scoop holder

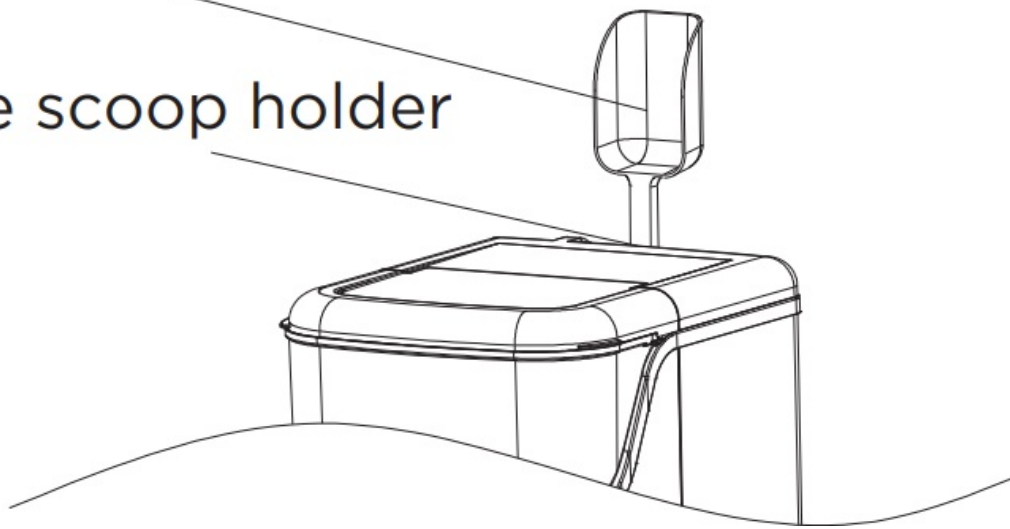

TROUBLESHOOTING GUIDE

PROBLEM	POSSIBLE CAUSES	SOLUTION
"ADD WATER" indicator light turns on.	Lack of Water.	Stop the ice maker, fill water, and press "ICE/CLEAN" button again to restart the unit.
"ICE FULL" indicator is on.	There is too much ice.	Suggest you to obtain the ice-cube.
	No ice cube inside.	Remove the probable obstacle inside or clean the inside wall of the ice storage.
Ring indicator light flashes red.	Ambient temperature or water temperature in inner tank is too high.	Please run the ice maker below 90 Fahrenheit degree ambient and pour colder water into tank.
	Refrigerant liquid leakage.	Press the ICE button twice, restart ice making program, if this problem show up again, verify by a qualified technician.
	Cover motor is broken.	
	Pipe in the cooling system is blocked.	
Making Ice too slowly.	Hot Air outlet has been blocked by something.	Hot Air outlet must be guaranteed to have more than 15 CM of ventilation distance.
	Water temperature in inner tank is too high.	Water temperature requirement between 44.6°F -89.6°F.
	Refrigeration system malfunctions.	Verify by a qualified technician.
Water leakage.	Drain plug not in place.	Put the drain plug in place.
	Pipe Joint in the appliance may loose.	Verify by a qualified technician.
	The seal has reached service life.	Verify by a qualified technician.

PRODUCT SPECIFICATIONS

- **Input Voltage:** 115V 60Hz
- **Power Consumption:** 192 W
- **Daily Ice Output:** 10-15 KGS / 24H
- **Refrigerant:** R600a

Dimensions

- **Product Depth (IN.)** 8.6
- **Product Height (IN.)** 11.3
- **Product Width (IN.)** 12.6
- **Out of Box Weight (lbs.):** 20.5
- **In Box Weight (lbs.):** 22.2

- **Box Dimensions (in.):** 9.9 X 12.5 X 14.3
- **Power Cord Length (in.):** 70.9
- **Amperage of power required when unit is running:** 2.7 A
- **Wattage of power required when unit is running:** 192 W

LIMITED WARRANTY

- To make a warranty claim, please email support2@curtiscs.com or call 18009689853.

1 Year warranty

- This product is warranted to be free from defects in material and workmanship for one (1) year from the date of original purchase. During this period, your exclusive remedy is repair or replacement of this product or component found to be defective, at our option; however, you are responsible for all costs associated with returning the product to us. If the product or component is no longer available, we will replace with a similar one of equal or greater value.
- Before a replacement is sent, the product must be rendered inoperable or returned to us.
- This warranty does not cover glass, filters, wear from normal use, use not in conformity with the printed directions, or damage to the product resulting from accident, alteration, abuse, or misuse.
- This warranty extends only to the original consumer purchaser or gift recipient. Keep the original sales receipt, as proof of purchase is required to make a warranty claim.
- This warranty is void if the product is used for anything other than single-family household use or subjected to any voltage and waveform other than as specified on the label (e.g., 120V~60Hz).
- We exclude all claims for special, incidental, and consequential damages caused by breach of express or implied warranty. All liability is limited to the amount of the purchase price. Every implied warranty, including any statutory warranty or condition of merchantability or fitness for a particular purpose, is disclaimed except to the extent prohibited by law, in which case such warranty or condition is limited to the duration of this written warranty. This warranty gives you specific legal rights.
- You may have other legal rights that vary depending on where you live. Some states

or provinces do not allow limitations on implied warranties or special, incidental, or consequential damages, so the foregoing limitations may not apply to you.

- For faster service, locate the model, type, and serial numbers on your appliance.
- ATTACH YOUR PROOF OF PURCHASE HERE PROOF OF PURCHASE IS REQUIRED TO OBTAIN WARRANTY SERVICE.
- Please have the following information available when you contact the Support Team.
- Name, address, and telephone number.
- Model number and serial number.
- A clear, detailed description of the problem.
- Proof of purchase, including dealer or retailer name, address, and date of purchase.

Canada

- **CURTIS INTERNATIONAL LTD 7045 BECKETT DRIVE, UNIT 15, MISSISSAUGA, ONTARIO L5S 2A3**
- **For service assistance and product information, please call: 18009689853.**
- **Curtis**
- **International Ltd. 7045 BECKETT DRIVE, UNIT 15, MISSISSAUGA, ON, L5S 2A3**
www.curtisint.com
- **Our home is your home.**

Visit us if you need help with any of these things:

- **Owner support**
- **service support2@curtiscs.com**
- **18009689853**
- **FRIGIDAIRE is a pending or registered trademark of Electrolux Home Products Inc. and used under a license from Electrolux Home Products, Inc.**

Frequently Asked Questions

- **Q: Can I use any type of water in the ice maker?**
 - **A:** No, it is recommended to only use potable drinking water in the ice maker to ensure the quality of the ice produced.
- **Q: What should I do if any parts are missing from the packaging?**

- **A:** Please contact our customer service for assistance if you find any parts missing from the packaging upon unpacking your ice maker.

Documents / Resources

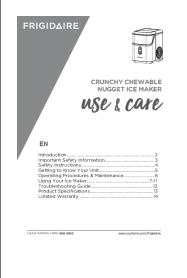
	EFIC 228-SS Nugget Ice Maker [pdf] Instruction Manual 228-SS, 228-SS Nugget Ice Maker, 228-SS, Nugget Ice Maker, Ice Maker, Maker
---	--

References

- [Curtis International - Affordable TVs, electronics and appliances](#)
- [User Manual](#)

◆ 228-SS, 228-SS Nugget Ice Maker, EFIC, Ice Maker, Maker, Nugget Ice

■ EFIC Maker

—Previous Post

[EFIC SP-1000 Portable Pocket Mini Ray Projector User Guide](#)

Leave a comment

Your email address will not be published. Required fields are marked *

Comment *

Name

Email

Website

☐ Save my name, email, and website in this browser for the next time I comment.

Post Comment

Search:

e.g. whirlpool wrf535swhz

Search

[Manuals+](#) | [Upload](#) | [Deep Search](#) | [Privacy Policy](#) | [@manuals.plus](#) | [YouTube](#)

This website is an independent publication and is neither affiliated with nor endorsed by any of the trademark owners. The "Bluetooth®" word mark and logos are registered trademarks owned by Bluetooth SIG, Inc. The "Wi-Fi®" word mark and logos are registered trademarks owned by the Wi-Fi Alliance. Any use of these marks on this website does not imply any affiliation with or endorsement.