



eero PoE 6 Powered Access points and PoE Gateway User Guide

[Home](#) » [eero](#) » eero PoE 6 Powered Access points and PoE Gateway User Guide 



PoE 6 Powered Access points and PoE Gateway User Guide

Contents

- [1 PoE 6 Powered Access points and PoE Gateway](#)
- [2 Documents / Resources](#)
 - [2.1 References](#)
- [3 Related Posts](#)

PoE 6 Powered Access points and PoE Gateway

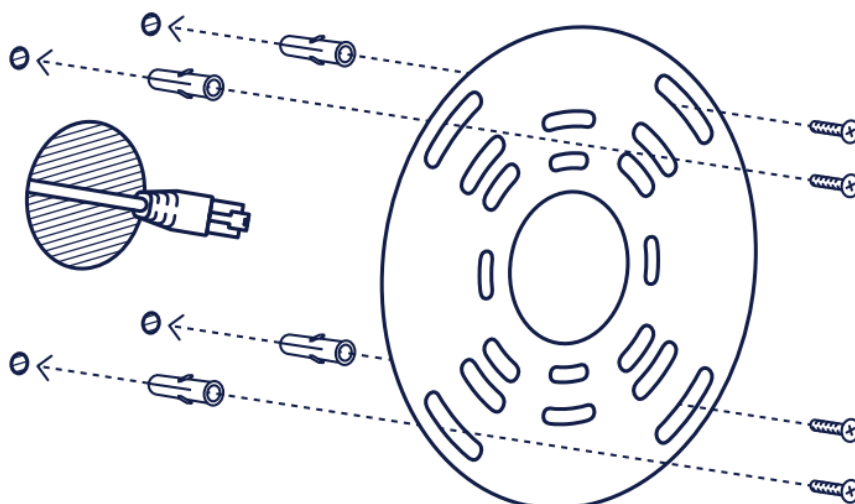

STEP 1

Mount bracket to the wall or ceiling with included mounting hardware. Thread the Ethernet cable and/or power adapter cable through the center or bottom of the bracket. Use ceiling mount for optimum coverage. When using a wall mount, eero PoE 6 is best suited on walls that face towards the center of the room/house/location.

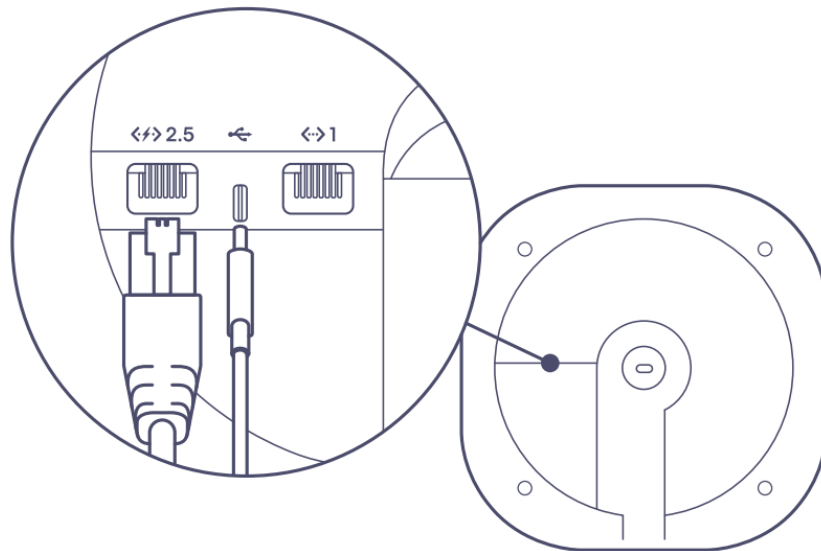

STEP 2

To power, the device, either plug the Ethernet cable into a 2.5 GbE port with a PoE power source or plug the power adapter cable into the USB-C port.

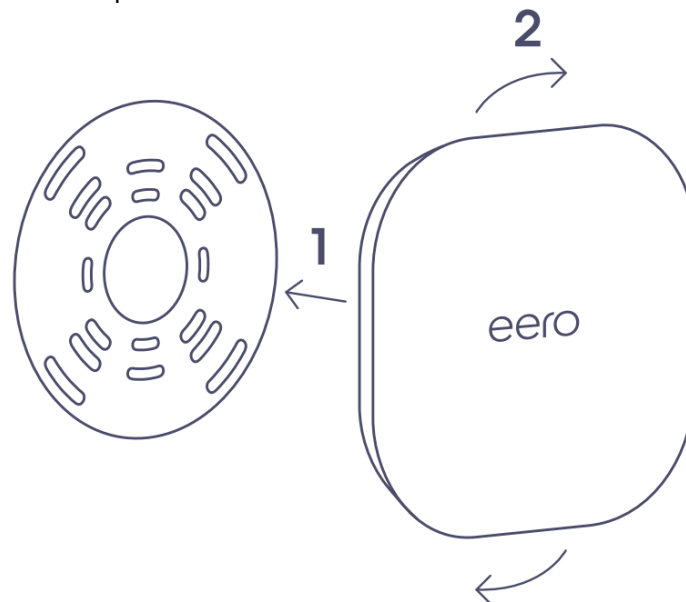

STEP 3

Attach the device to the bracket and rotate it to lock the device in place.

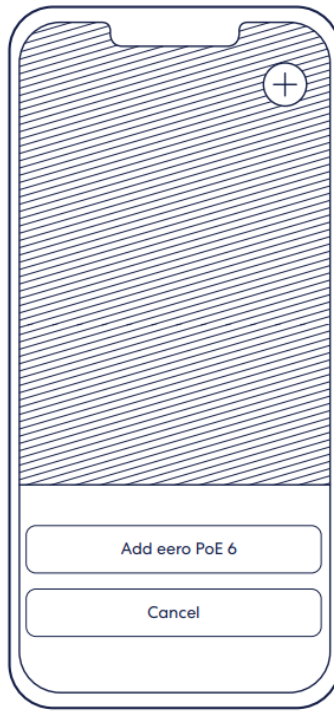

STEP 4

Open the app to add the device to your eero network.



©2022 Amazon.com, Inc. or its affiliates. Amazon, eero, and all related marks are trademarks of Amazon.com, Inc. or its affiliates.

Apple, App Store, and the Apple logo are trademarks of Apple Inc. Android, Google Play, and the Google Play logo are trademarks of Google LLC.

Documents / Resources

	<p>eero PoE 6 Powered Access points and PoE Gateway [pdf] User Guide PoE 6 Powered Access points and PoE Gateway, PoE 6, Powered Access points and PoE Gateway, Access points and PoE Gateway, PoE Gateway, Gateway</p>
---	---

References

- [a Amazon.com. Spend less. Smile more.](#)