

Contents [[hide](#)]

- [1 EDIFIER S350DB 2.1 Active Hi-Fi Speakers](#)
- [2 Illustrations](#)
- [3 Remote control](#)
- [4 Connections](#)
- [5 Optical and Coaxial Input](#)
- [6 PC/AUX Input](#)
- [7 Bluetooth Input](#)
- [8 Specifications](#)
- [9 Troubleshooting](#)
- [10 FAQs](#)
- [11 Documents / Resources](#)
 - [11.1 References](#)

EDIFIER

EDIFIER S350DB 2.1 Active Hi-Fi Speakers



Specifications

- Power input: 100-240V~ 50/60Hz 500mA
- Remote control: AAA batteries (2)
- Audio inputs: PC, AUX, Optical, Coaxial, Bluetooth
- Decoding capabilities: PCM signal with 44.1kHz/48kHz

Remote Control Usage:

To use the remote control:

1. Press the remote control battery cover downward with your thumb to remove the cover and insert two AAA batteries (observe polarity).
2. Replace batteries every 6 months or when control becomes less sensitive.
3. Avoid mixing old and new batteries, and follow safety precautions for battery handling.

Connections:

Optical and Coaxial Input:

1. Select the optical/coaxial input using the master volume control on the active satellite speaker or the OPT/COX button on the remote.
2. Connect audio sources using the provided optical or coaxial cable.
3. Adjust volume as needed.

PC/AUX Input:

1. Select PC/AUX input using the master volume control on the active satellite speaker or the PC/AUX button on the remote.
2. Connect audio sources (mobile phones, tablets, etc.) using the audio cable provided.
3. Adjust volume accordingly.

Bluetooth Input:

1. Switch to Bluetooth mode by pressing the Bluetooth button on the remote or using the master volume control on the active satellite speaker.

2. Pair your device with EDIFIER S350DB from your source device's Bluetooth settings.
3. Play audio tracks and adjust volume levels as desired.
4. To disconnect from Bluetooth, press and hold the button on the remote for 2 seconds.

What's In The Box

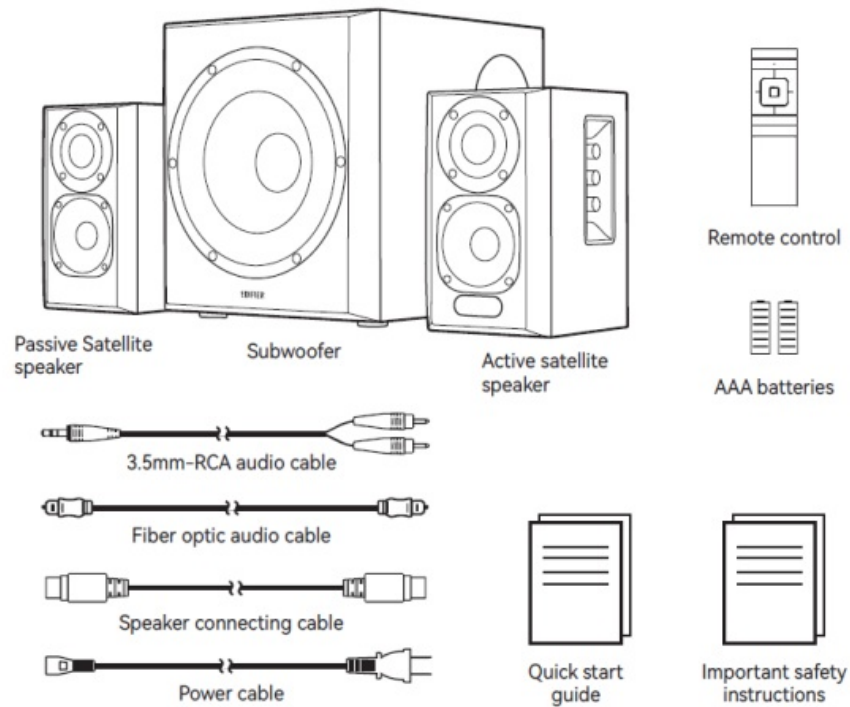

Note:

- Images are for illustrative purposes only and may differ from the actual product.
- For the need of technical improvement and system upgrade, information and specifications contained herein may be slightly different from the actual product. If any difference is found, the actual product prevails.

Illustrations

1. Power switch
2. Power cable connector
3. PC input
4. AUX input
5. Optical input
6. Coaxial input
7. Connect to satellite speaker(R)

8. Connect to satellite speaker(L)
9. Connect to the subwoofer
10. Display screen
11. Treble volume dial
12. Bass volume dial
13. Master volume dial/input selection

Press it to navigate between audio inputs: AUX→PC→Optical→Coaxial→Bluetooth.

Press and hold to enable and disable the standby function

14. Power indicator

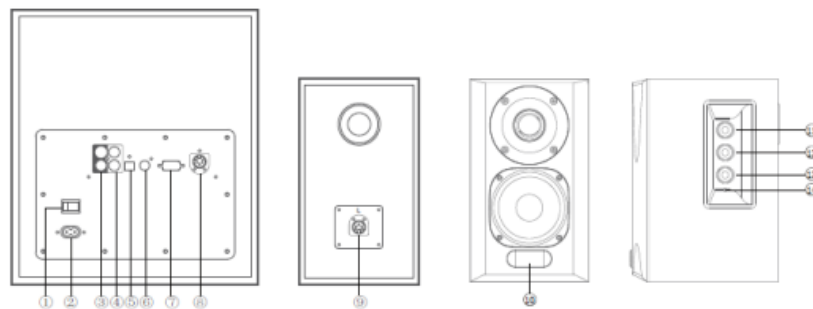

Remote control

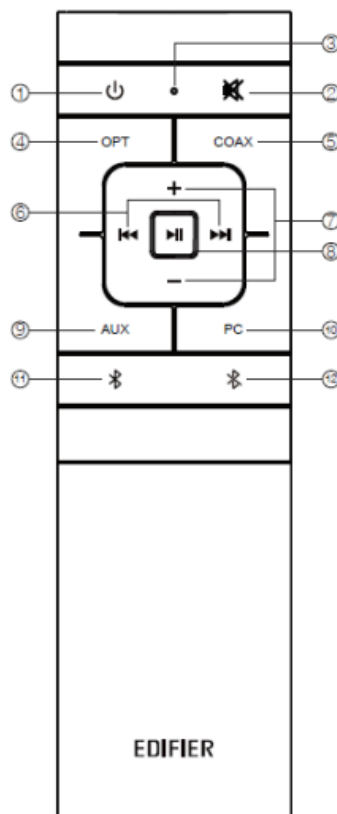

1. On/Off

2. Mute
3. Remote control indicator
4. Optical input
5. Coaxial input
6. Previous/next track
(Bluetooth audio sources only)
7. Volume up/down
8. Play/pause
(Bluetooth audio sources only)
9. AUX input
10. PC input
11. Bluetooth input
12. Press and hold to disconnect Bluetooth (connected status)

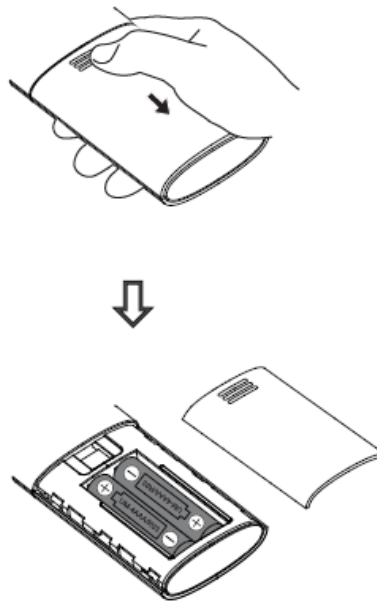

1. As the illustration shows, press the remote control battery cover downward with your thumb and follow the arrow direction to remove the cover. Use two AAA batteries (note the “+” and “-” poles).
2. The battery life is normally about 6 months; please replace them when the remote control is not sensitive or the control distance is shortened.
3. Never use old and new batteries together.

Note:

1. Do not place the remote control in places that are hot and humid.
2. Do not charge the batteries.
3. Remove the batteries when unused for a long period of time to avoid battery leakage.
4. The battery should not be exposed to excessive heat, such as direct sun, fire, or similar.
5. Danger of explosion if the battery is incorrectly replaced. Replace only with the same or equivalent type.

Connections

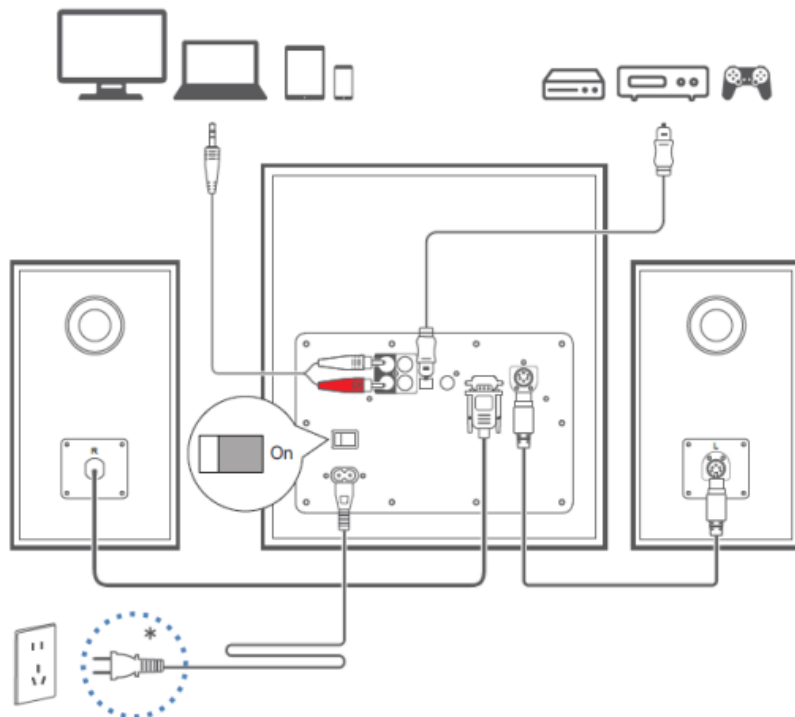

Power input: 100-240V~ 50/60Hz 500mA

This plug type is meant for illustrative purposes only.

Optical and Coaxial Input

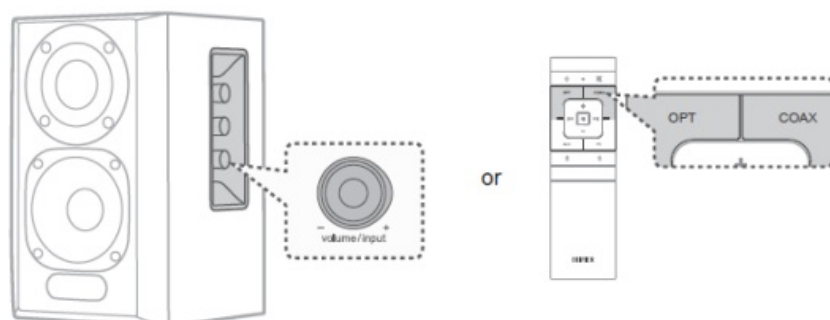

1. Press the master volume control on the active satellite speaker or press the

“OPT/COX” button on the remote control to select optical/coaxial input.

2. Use an optical or coaxial cable (optical cable included) to connect audio sources to your speaker.
3. Play from your devices and adjust the volume accordingly.

Note:

In optical and coaxial modes, only the PCM signal with 44.1kHz/48kHz can be decoded.

PC/AUX Input

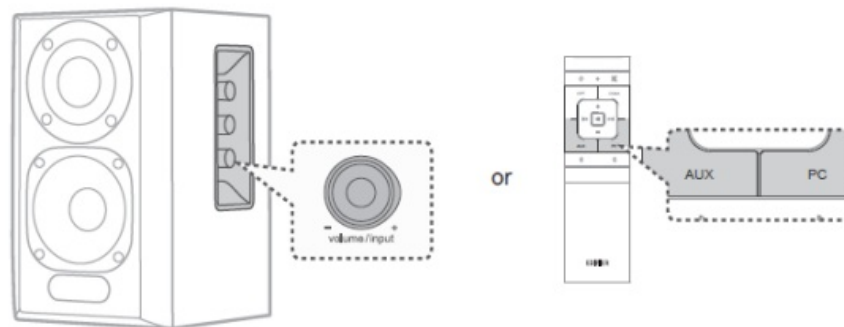

1. Press the master volume control on the active satellite speaker or press the “PC/AUX” button on the remote control to select PC/AUX input.
2. Use the audio cable to connect audio sources (mobile phones, tablets, etc) to your speaker.
3. Play from your device and adjust the volume accordingly.

Bluetooth Input

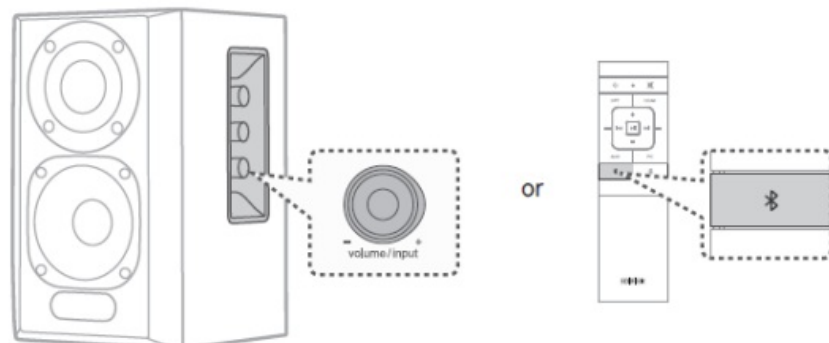

Pairing

1. Turn on the speaker and switch to Bluetooth mode by pressing the Bluetooth button on

the remote control, or press the master volume control on the active satellite speaker until the Bluetooth icon comes on.

2. Go to the setup on your source devices (mobile phones, tablets, etc.) and search for nearby Bluetooth devices. You will find “EDIFIER S350DB” in the list.
3. Pair your device with “EDIFIER S350DB”.
4. Play audio tracks on your device and adjust the volume to a desired level.
5. To disconnect from the current Bluetooth device, press and hold the ”  ” button on the remote control for 2 seconds.

Note:

1. Bluetooth on the product can be searched for and connected to only when the speaker is ON and switched to the Bluetooth input. When the speaker switches to other audio inputs, the Bluetooth connection will be disconnected. When switched to Bluetooth input, the speaker will try to connect to the last connected Bluetooth source device.
2. Bluetooth connectivity and compatibility may be different among different source devices, depending on the software version of the source devices.
3. To enjoy all Bluetooth functions of this product, make sure that your audio source device supports A2DP and AVRCP profiles.
4. PIN code for connection is “0000” if needed.
5. The built-in Qualcomm® aptX™ decoder in the product helps to achieve better wireless transmission sound quality; therefore, please use a device supporting Qualcomm® aptX™ as the audio source.

Specifications

- Total output power (RMS): R/L (Treble): 15W+15W
- R/L (Mid-range and bass): 25W+25W
- SW (Subwoofer): 70W
- Frequency response: R/L: 160Hz-20kHz, SW: 41Hz-160Hz
- Note: the rated test frequency is as follows: the treble test is 10kHz, the mid-range and bass test is 500Hz, and the bass test is 80Hz.
- Declaration for the EU
- Frequency Band: 2.402GHz ~ 2.480GHz

- RF Power output: ≤ 10 dBm (EIRP)
- There is no restriction on use.

Troubleshooting

Cannot connect to your Bluetooth device

- Make sure that the distance between this product and your Bluetooth device is less than 10 meters and there are no obstacles between them.
- Make sure that no device is connected to this product via Bluetooth.
- Make sure that this product is in Bluetooth pairing mode. If not, manually switch it to this mode.
- Restart this product, enable Bluetooth function on your Bluetooth device, and then try again.
- Reset this product to factory settings and try again.

No power

- Make sure that the power cable is properly connected.
- Make sure that the power supply is not disconnected.
- Make sure that the main power button on the rear panel is switched to "ON".

No sound

- Make sure that this product is powered on.
- Make sure that this product and your device are properly connected.
- Make sure that the playback is not paused.
- Make sure that this product and your device are not muted.
- Increase the volume of this product and your device.

Noise coming from speakers.

- EDIFIER speakers generate little noise, while the background noise of some audio devices is too high. Please unplug audio cables and turn the volume up. If no sound can be heard at

1 meter away from the speaker, there is no problem with this product.

- To learn more about EDIFIER, please visit www.edifier.com

For EDIFIER warranty queries, please visit the relevant country page on www.edifier.com and review the section titled Warranty Terms.

USA and Canada: service@edifier.ca

South America: Please visit www.edifier.com (English) or www.edifierla.com (Spanish/Portuguese) for local contact information.

FAQs

How often should I replace the remote control batteries?

The batteries should be replaced every 6 months or when the remote control becomes less sensitive.

Can I use old and new batteries together in the remote control?

: No, avoid mixing old and new batteries in the remote control

: What should I do to disconnect Bluetooth from my device?

Press and hold the Bluetooth disconnect button on the remote for 2 seconds to disconnect from the current Bluetooth device.

Documents / Resources

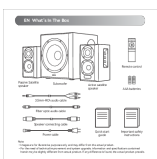

[EDIFIER S350DB 2.1 Active Hi-Fi Speakers \[pdf\]](#) User Guide

S350DB, S350DB 2.1 Active Hi-Fi Speakers, 2.1 Active Hi-Fi Speakers, Active Hi-Fi Speakers, Hi-Fi Speakers, Speakers

References

- [User Manual](#)

Leave a comment

Your email address will not be published. Required fields are marked *

Comment *

Name

Email

Website

☐ Save my name, email, and website in this browser for the next time I comment.

Post Comment

Search:

Search

[Manuals+](#) | [Upload](#) | [Deep Search](#) | [Privacy Policy](#) | [@manuals.plus](#) | [YouTube](#)

This website is an independent publication and is neither affiliated with nor endorsed by any of the trademark owners. The "Bluetooth®" word mark and logos are registered trademarks owned by Bluetooth SIG, Inc. The "Wi-Fi®" word mark and logos are registered trademarks owned by the Wi-Fi Alliance. Any use of these marks on this website does not imply any affiliation with or endorsement.