



# EDIFIER EDF100043 Active Speaker System User Manual

[Home](#) » [Edifier](#) » EDIFIER EDF100043 Active Speaker System User Manual 

## EDIFIER EDF100043 Active Speaker System User Manual



### Contents

- [1 Important safety instruction](#)
- [2 What's in the box](#)
- [3 Illustrations](#)
- [4 Remote control](#)
- [5 Connection](#)
- [6 Audio source Input](#)
- [7 Bluetooth input](#)
- [8 Specification](#)
- [9 Troubleshooting](#)
- [10 Documents / Resources](#)
  - [10.1 References](#)
- [11 Related Posts](#)

### Important safety instruction

1. Please read the instructions carefully. Keep it in safe place for future reference.
2. Use only accessories approved by the manufacturer.
3. Install the instrument properly by following the instructions in the device connection section.

4. Using the product in a 0-35°C environment is recommended. Shipping and storing the product in a 0-35°C environment is recommended.
5. To reduce the risk of fire and electric shock, do not expose the product to rain or moisture.
6. Do not use this product near water. Do not immerse the product into any liquid or have it exposed to dripping or splashing.
7. Do not install or use this product near any heat source (e.g. radiator, heater, stove, or other devices that generate heat).
8. Do not place any object filled with liquids, such as vases on the product; neither should any open fire, such as lighted candles be placed on the product.
9. Do not block any ventilation openings. Do not insert any object into ventilation openings or slots. It may cause fire or electric shock.
10. Keep sufficient clearance around the product to maintain good ventilation (minimum 5cm is recommended).
11. Do not force a plug into the jack. Before connection, check for blockage in the jack and whether the plug matches the jack and is oriented to the right direction.
12. Keep the provided accessories and parts (such as screws) away from children to prevent from being swallowed by mistake.
13. Do not open or remove the housing yourself. It may expose you to dangerous voltage or other hazardous risks. Regardless the cause of damage (such as damaged wire or plug, exposure to liquid splash or foreign object falling in, exposure to rain or moisture, product not working or being dropped, etc.), the repair has to be performed by an authorized service professional immediately.
14. Before cleaning the product with dry cloth, always turn off the product and disconnect the power plug first.
15. Never use strong acid, alkali, gasoline, alcohol, or other chemical solvents to clean the product surface. Use only neutral solvent or clear water for cleaning.
16. The product must be used at an altitude of lower than 2000m.



Excessively loud music may lead to hearing loss. Please keep the volume in a safe range.



Correct Disposal of this product. This marking indicates that this product should not be disposed with other household wastes throughout the EU. To prevent possible harm to the environment or human health from uncontrolled waste disposal, recycle it responsibly to promote the sustainable reuse of material resources. To return your used device, please use the return and collection systems or contact the retailer where the product was purchased. They can take this product for environmental safe recycling.



Use only with the cart, stand, tripod, bracket, or table specified by the manufacturer, or sold with the apparatus. When a cart is used, use caution when moving the cart/apparatus combination to avoid injury from tip-over.

#### **Power warning:**

1. Place the product near the power outlet for easy use.
2. Before use, make sure that the operating voltage is the same as your local power supply. Correct operating voltage can be found on the product plate.
3. For safety purpose, unplug the product during lightning storms or when unused for extended periods of time.

4. Under normal conditions, the power supply may get hot. Please keep good ventilation in the area and exercise caution.
5. Safety warning labels on the housing or bottom of the product or power adaptor.



This symbol is to alert the user to the presence of un-insulated dangerous voltage within the product's enclosure that may be of sufficient magnitude to constitute a risk of electric shock to persons.



This symbol is to warn the user not to disassemble the enclosure of the product and there is no user replaceable part inside. Take the product to an authorized service center for repair. Excessively loud music may lead to hearing loss. Please keep the volume in a safe range.



This symbol indicates that the product is for indoor use only.



This symbol indicates that the product is a CLASS II or double insulated electrical device with no earth requirement

The MAINS plug is used as the disconnect device, the disconnect device shall remain readily operable

#### **For wireless product:**

1. Wireless product may generate shortwave radio frequencies and interfere with the normal use of other electronic devices or medical equipment.
2. Turn off the product when it's disallowed. Do not use the product in medical facilities, on airplane, at gas stations, near automatic gates, automatic fire alarm system or other automated devices.
3. Do not use the product in the vicinity of a pacemaker within a 20cm range. The radio waves may affect the normal operation of the pacemaker or other medical devices.

#### **What's in the box**

##### **Box Contents**



- Power cable



3.5mm to RCA audio cable

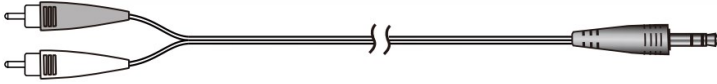

- Speaker connecting cable

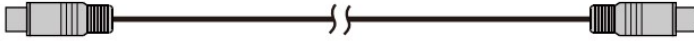

- Fiber optic audio cable

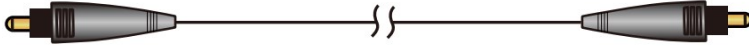

- RCA to RCA audio cable



- User manual

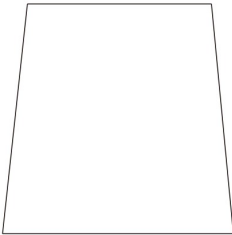

**Note:** Images are for illustrative purposes only and may differ from the actual product.

## Illustrations

1. Satellite speaker power switch
2. Power cable
3. Subwoofer pairing
4. PC/AUX input
5. Optical input
6. Coaxial input
7. To passive satellite speaker

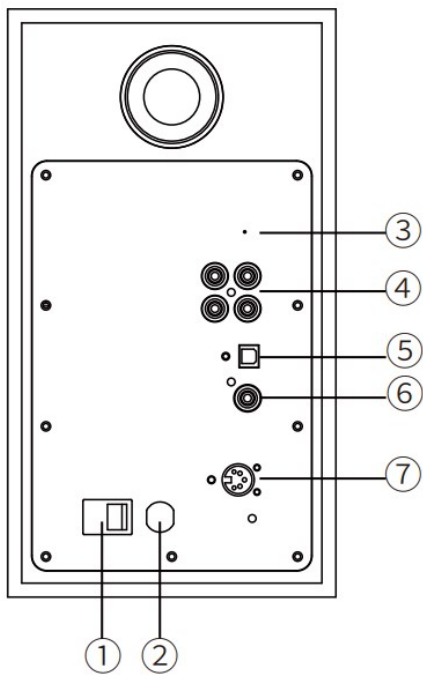

- 8. Power cable connector
- 9. Subwoofer power switch
- 10. Status indicator
- 11. Pair with satellite speaker

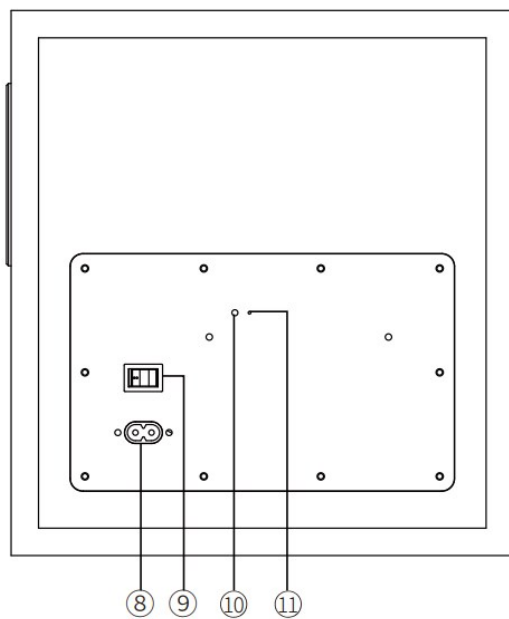

- 12. Connect to active satellite speaker

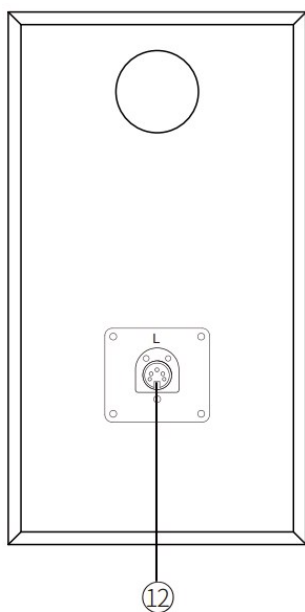

13. LED display

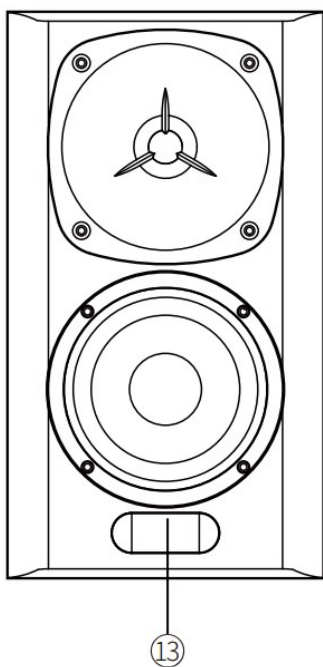

14. Treble control

15. Bass control

16. Volume adjustment/input selector

17. Status indicator

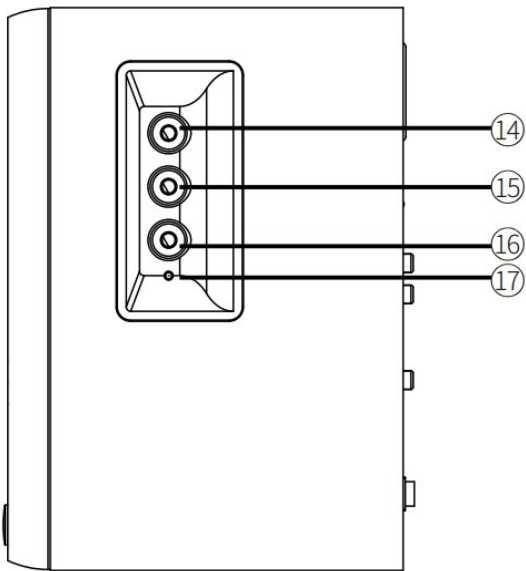

## Remote control

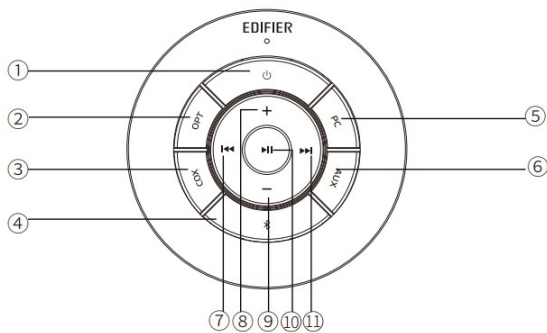

1. Power ON/OFF
2. Optical input
3. Coaxial input
4. Bluetooth input
5. PC input
6. AUX input
7. Previous track
8. Volume up
9. Volume down
10. Play/pause
11. Next track

Installation and replacement of controller battery: As the illustration, please insert a coin into the slot and rotate anticlockwise to the “ ” position to open battery cover, then place the CR2025 battery and rotate clockwise to the “ ” position to close the cover.

Open

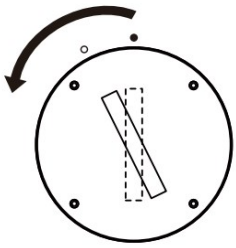

Close

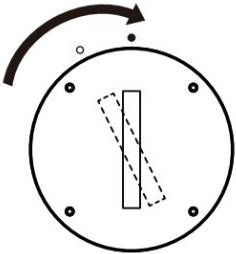

## **WARNING!**

1. Don't swallow the battery; danger of chemical burn.
2. The product includes a wafer battery. Swallowing this battery may lead to injury or death. Do not place the new or old battery in where children can get to it.
3. Don't use the product if the battery cover is missing or not closed, and keep the remote inaccessible to children.
4. Please go to the hospital immediately if the battery is swallowed.

## **Note:**

1. Do not place the remote control in places that are hot and humid.
2. Do not charge the batteries.
3. Remove the batteries when unused for a long period of time.
4. The battery should not be exposed to excessive heat such as direct sun, fire or similar.
5. Danger of explosion if battery is incorrectly replaced. Replace only with the same or equivalent type.

## **Connection**

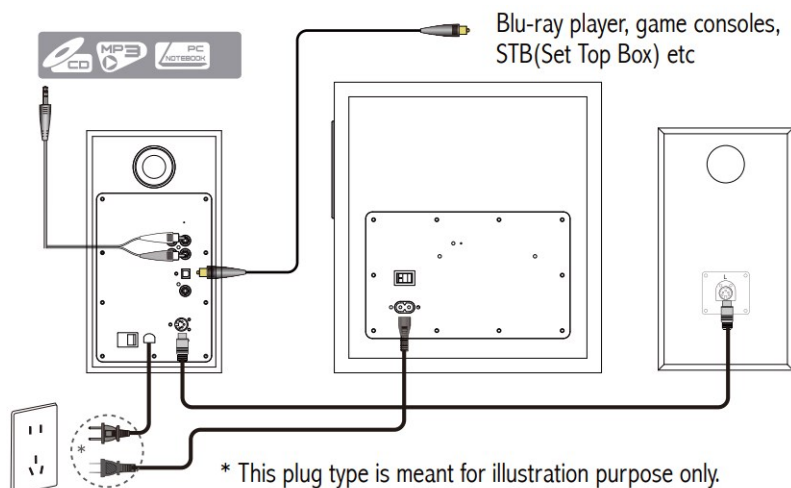



The active satellite speaker has been paired with the subwoofer before leaving factory. The wireless connection is supposed to resume automatically when both active satellite speaker and subwoofer are powered on, and the red indicator will be constantly lit. If the wireless connection fails to resume, please follow the steps below to complete the pairing again.

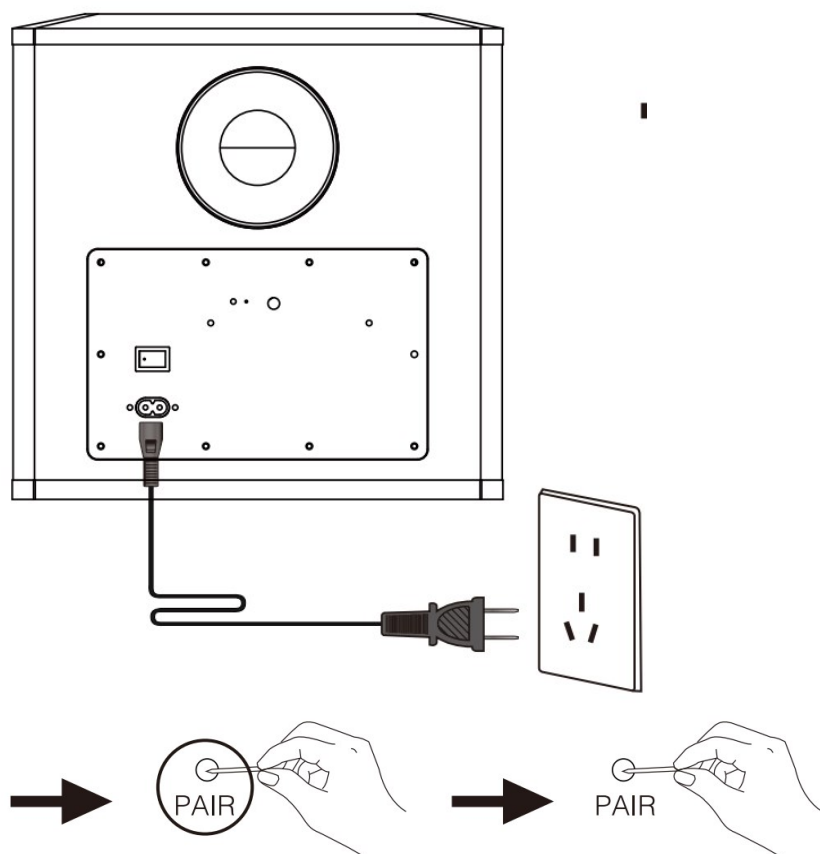

1. Power on the subwoofer, the red indicator should blink in a breathing pattern, which means no active wireless connection.
2. Press and hold the Pair button on back panel of subwoofer for 2 seconds to put it into pairing mode. The red indicator will blink rapidly.
3. Press and hold the “Pair” button on back panel of active satellite speaker to put it into pairing mode.
4. Wait until the red indicator on subwoofer is lit constantly. Then the pairing is done and wireless connection is made

- LED indicator blinks in a breathing pattern: subwoofer is disconnected and enters into standby mode
- LED indicator blinks rapidly: subwoofer enters into pairing mode
- LED indicator is constantly lit: subwoofer is connected and operates normally

## Audio source Input

### Optical/Coaxial input

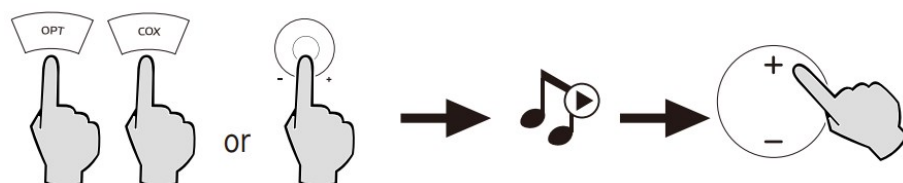

1. Press the “OPT/COX” button on the remote control or the volume adjustment/input selector knob on the active

satellite speaker to select OPT/COX input; indicator on the active satellite speaker is now lit.

2. Connect audio source (such as STB box and Blu-ray player etc) to OPT/COX input on the active satellite speaker rear panel using fiber optic audio cable included or coaxial audio cable excluded.
3. Play music and adjust to the desired volume.

**Note:**

Only the standard PCM audio signals (44.1KHz/48KHz/96KHz/192KHz) function in optical/coaxial mode.

**PC/AUX input**

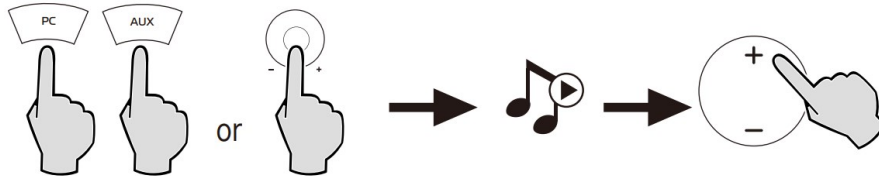

1. Press the “PC/AUX” button on the remote control or the volume adjustment/input selector knob on the active satellite speaker to select PC/AUX input; indicator on the active satellite speaker is now lit.
2. Connect audio source (such as mobile phone, tablet, etc) to PC/AUX input on the active satellite speaker rear panel (note the color matching) using 3.5mm to RCA audio cable included.
3. Play music and adjust to the desired volume.

**Bluetooth input**



1. Press the “” button on the remote control or the volume adjustment/input selector knob on the active satellite speaker to select Bluetooth input; indicator on the active satellite speaker is now lit.
2. Set your Bluetooth device (mobile phone, tablet etc.) to search for and select “EDIFIER S360DB”.

**Note:**

- The Bluetooth on S360DB can only be searched for and connected using Bluetooth input. The existing Bluetooth connection will be disconnected once the speaker is switched into other audio inputs. When switched back to Bluetooth input, the speaker will try to connect to the last connected Bluetooth audio source device.
- Pin code for connection is “0000” if needed.
- To disconnect Bluetooth, press and hold the “” button on the remote control.
- To enjoy all Bluetooth functions please ensure your audio source device has A2DP and AVRCP profile.
- Bluetooth connectivity and compatibility may be different among different source devices, depending on the

software versions of source devices.

- The built-in Qualcomm® aptX™ decoder in the product helps to achieve better wireless transmission sound quality, therefore please use the device supporting Qualcomm® aptX™ as the audio source.

## Specification

**Power output:** R/L: (Treble): 10W+10W

**R/L:** (Mid-range and bass): 30W+30W

**SW:** (Subwoofer): 75W

**Frequency response:** R/L: 60Hz-40KHz

**SW:** 40Hz-150Hz

**Input type:** PC/AUX/Optical/Coaxial/Bluetooth

## Troubleshooting

Problem	Solution
No sound	<ul style="list-style-type: none"><li>• Check if the power indicator light is ON.</li></ul>
	<ul style="list-style-type: none"><li>• Try to turn up the volume using either the master volume control or remote control.</li></ul>
	<ul style="list-style-type: none"><li>• Ensure the audio cables are firmly connected and the input is set correctly on the speakers.</li></ul>
	<ul style="list-style-type: none"><li>• Check if there is a signal output from the audio source.</li></ul>
Cannot connected via Bluetooth	<ul style="list-style-type: none"><li>• Make sure the speaker is switched to Bluetooth input. If it is in other audio input modes, Bluetooth will not connect. Disconnect from any Bluetooth device by pressing and holding  in Bluetooth mode, then try again.</li></ul>
	<ul style="list-style-type: none"><li>• <b>Effective Bluetooth transmission range is 10 meters:</b> please ensure that operation is within the range.</li></ul>
	<ul style="list-style-type: none"><li>• Try another Bluetooth device for connection.</li></ul>
The 536008 does not turn on	<ul style="list-style-type: none"><li>• Check if main power is connected, or if the wall outlet is switched on.</li></ul>

To learn more about EDIFIER, please visit [www.edifier.com](http://www.edifier.com)

For Edifier warranty queries, please visit the relevant country page on [www.edifier.com](http://www.edifier.com) and review the section titled Warranty Terms.

**USA and Canada:** [service@edifier.ca](mailto:service@edifier.ca)

**South America:** Please visit [www.edifier.com](http://www.edifier.com) (English) or [www.edifierla.com](http://www.edifierla.com) (Spanish/Portuguese) for local contact information.

For more information, please visit our website:  
[www.edifier.com](http://www.edifier.com)



@Edifiernlobal



@Edifier\_Global



@Edifier\_Global

**Model:** EDF100043  
Edifier International Limited  
P.O. Box 6264  
General Post Office  
Hong Kong  
**Tel:** +852 2522 6989  
**Fax:** +852 2522 1989

[www.edifier.com](http://www.edifier.com)

© 2022 Edifier International Limited. All rights reserved.  
Printed in China

#### **NOTICE:**

For the need of technical improvement and system upgrade, information contained herein may be subject to change from time to time without prior notice.

Products of EDIFIER will be customized for different applications. Pictures and illustrations shown on this manual may be slightly different from actual product. If any difference is found, the actual product prevails.

#### **Documents / Resources**

	<a href="#">EDIFIER EDF100043 Active Speaker System</a> [pdf] User Manual EDF100043, EDF100043 Active Speaker System, Active Speaker System, Speaker System, System
---	--

#### **References**

- [E Headphones, Speakers | A Passion for Sound - Edifier USA](#)
- [edifierla.com](http://edifierla.com)
- [E EU Declaration of Conformity - Edifier](#)